



FLOWMASTER 718100 Performance System Instruction Manual

[Home](#) » [FLOWMASTER](#) » FLOWMASTER 718100 Performance System Instruction Manual 



Installation Instructions

718100

2017-2022 FORD F-250 & F350

6.2L & 7.3L ENGINE

Contents

- [1 OVERVIEW:](#)
- [2 Installation Diagram](#)
- [3 Documents / Resources](#)

OVERVIEW:

1. Take a moment to read and understand these instructions before installing your Flowmaster performance system.

NOTE: Please inventory all parts now before continuing and if necessary, report any missing items to our tech line. This will avoid potentially stranding your vehicle until any missing replacement parts arrive.

ITM #	PART #	DESCRIPTION	Q T Y.
1	26855M	Inlet Pipe	1
2	26810M	Resonator Delete Pipe	1
3	72595-Z	Muffler	1
4	26733M	Right Tailpipe	1
5	26734M	Left Front Tailpipe	1
6	26735M	Left Rear Tailpipe	1
7	26856M	Side Exit Pipe	2
8	ST509B	Tips	2
9	PK1068	Hardware Package includes:	1
10	503HA	Left Rear Hanger	1
11	MC350BS	31/2" Stainless Band Clamp	1
12	MC300BS	3" Stainless Band Clamp	7
13	HA168	Red Rubber Hanger	1
14	HW502	7/16" Hanger Keeper	2
15	HW503	1/2" Hanger Keeper	1
16	HW505	15" Cable Tie	1

REMOVE STOCK EXHAUST SYSTEM:

2. Raise vehicle up on a hoist or rack to working height. If you don't have access to a hoist or rack, support vehicle with jack stands.

WARNING: Avoid serious burns! Allow your vehicle time to cool completely before touching any factory engine components.

To ease preparation and installation of your new kit:

- Apply penetrating lubricant to mounts, bolts and clamps before you remove them.
- Use stands as necessary to support parts as you detach them from your vehicle and again as you install new parts.

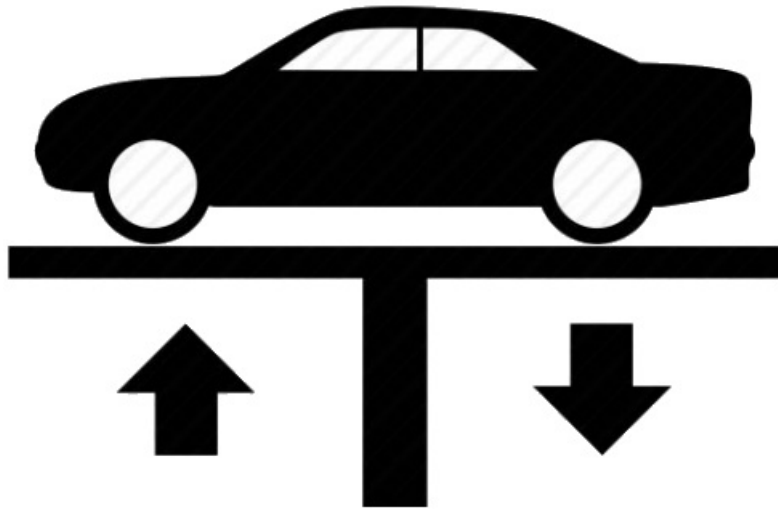

3. Cut tailpipe at muffler exit. Disassemble hanger wires from isolators and remove tailpipe section from vehicle.

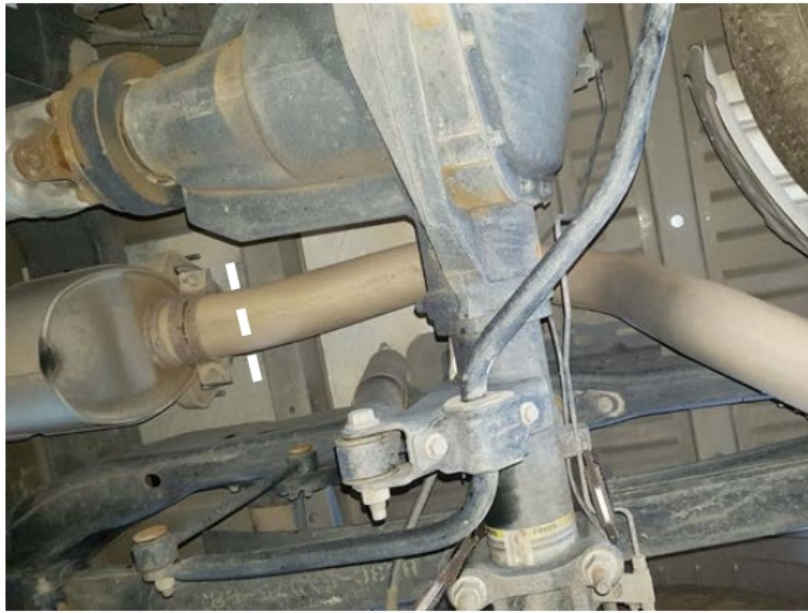

4. Support muffler and disassemble wire hangers from isolators. Loosen clamp, disconnect inlet pipe and remove exhaust system.



INSTALL FLOWMASTER EXHAUST SYSTEM:

5. Apply anti-seize compound to threaded fasteners for a more secure install.

NOTE: The image in this step is intended for illustrative purposes only and may or may not accurately reflect

components included in your kit.

6. Every slip fit connection in this kit must seat 3" deep except for muffler connections which must seat 2" deep. Find all slip fit components in your kit and mark them accordingly so your Flowmaster exhaust system fits properly onto your vehicle.



7. If applicable, you may choose to replace the resonator section of your vehicle using resonator delete pipe (2) and clamp (11), lining pipe notch up to front pipe tab.

NOTE: If your vehicle has a 160" wheelbase and you are replacing your resonator, trim 4" from the back of resonator delete pipe before installing it.



8. Place clamp (11) onto inlet pipe (1) then connect it to resonator pipe or factory pipe, lining pipe notch up to front pipe tab. Insert wire hanger in isolator and tighten clamp enough to allow for adjustment.

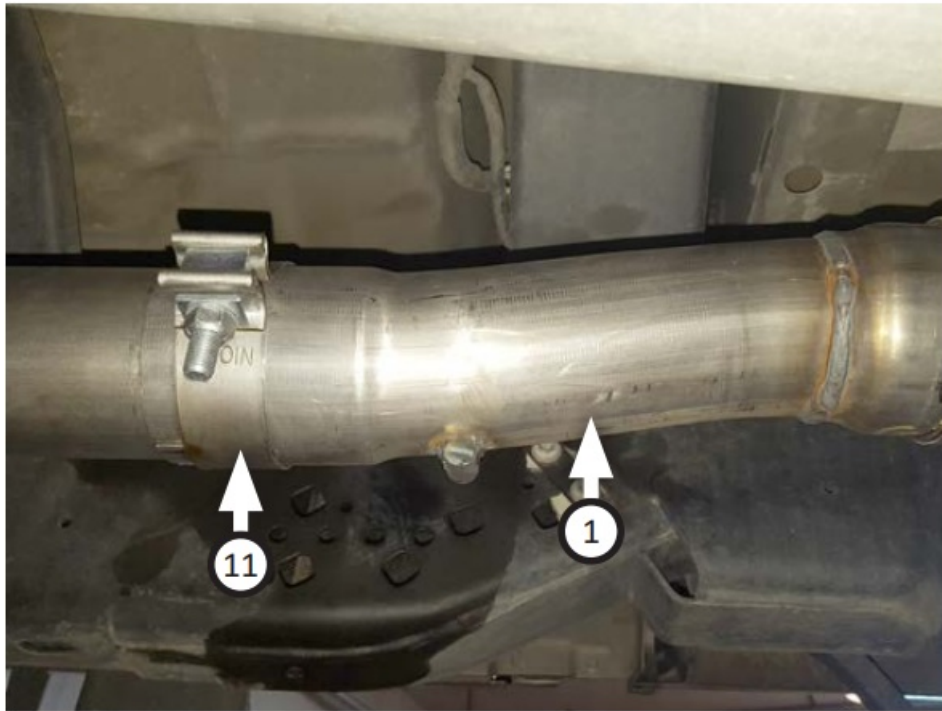

9. Place clamp (10) onto muffler (3) then connect it to inlet or resonator pipe. Tighten clamp just enough to allow for adjustment. Place (x2) clamps (8) onto muffler outlets.



10. Remove bolts (x2) indicated below and use them to secure left rear hanger (9) onto vehicle frame. Then install rubber hanger (12) as shown.

NOTE: If your truck does not have overload springs, secure left rear hanger using pre-requisite M10 – 1.5 bolts (x2).

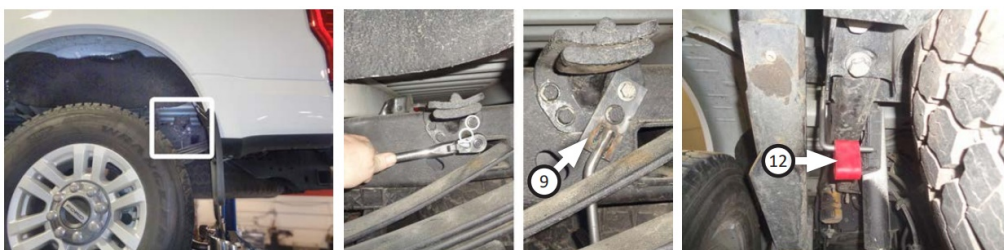

11. Route right (4) and left front (5) tailpipes over axle then connect them to muffler. Insert their wire hangers into isolators then tighten clamps just enough to allow for adjustment.



12. Place clamp (11) onto left rear tailpipe (6) and connect it to left front tailpipe. Insert wire hanger into isolator and tighten clamp just enough to allow for adjustment.

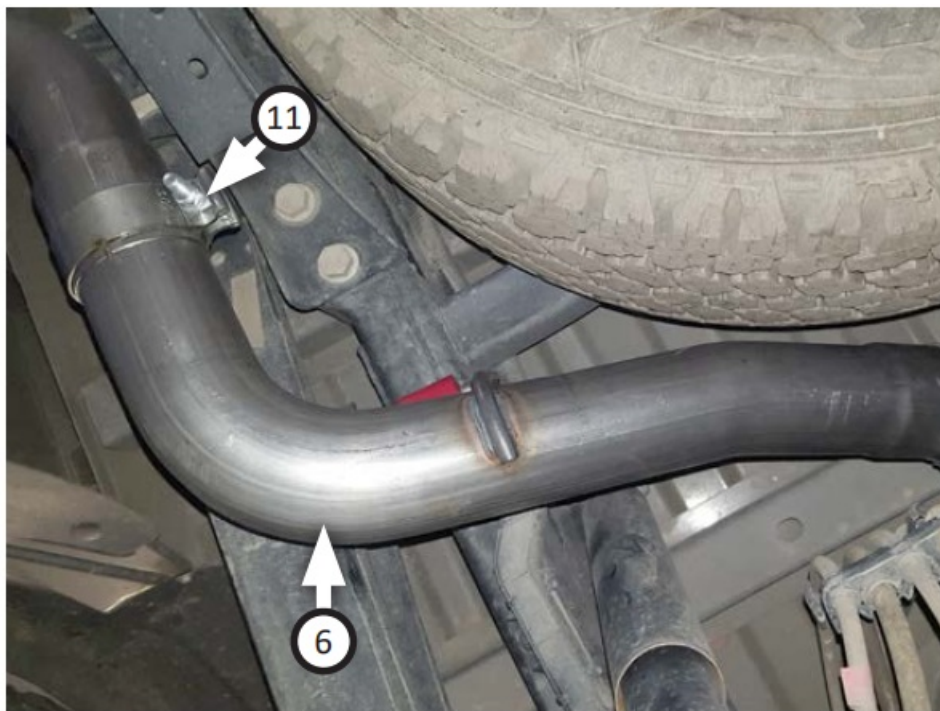

13. Place (x2 ea.) clamps (11) onto side exit pipes (7) then connect them to tailpipes and tighten clamps just enough to allow for later adjustment.



14. Use zip tie (15) to secure hose assembly away from exhaust pipe as shown.

15. Install (x2) tips (8) onto side exit pipes then tighten inlets just enough to allow for adjustment.



16. Adjust exhaust components for fit; maintaining 1/2" clearance and compensating for suspension, travel and vibration then tighten all clamps. Finally, fit hanger keepers (13, 14) onto each sideways hanger.

17. Recommended: Secure slip-fit connections with a 1-inch tack weld then apply high-temp paint to each weld.



Congratulations, the installation of your FLOWMASTER performance exhaust system is now complete!

Installation Diagram

718100

2017-2022 FORD F-250 & F350 6.2L & 7.3L ENGINE

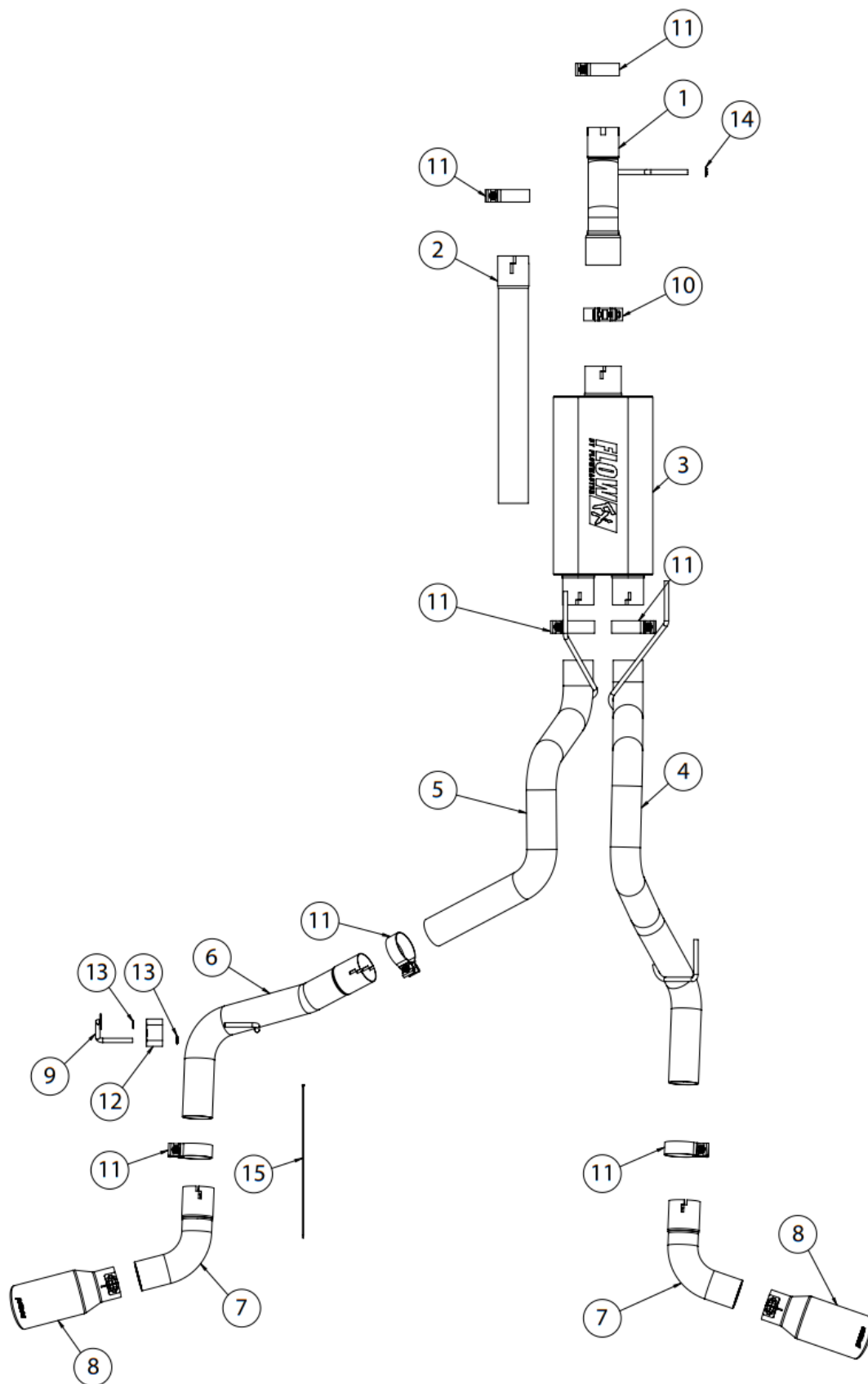

FLOW **FX**
BY FLOWMASTER

www.flowmastermufflers.com

Technical Support (866) 464-6553

Documents / Resources

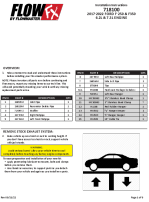

[FLOWMASTER 718100 Performance System](#) [pdf] Instruction Manual
718100 Performance System, 718100, Performance System, System