



717943 Flowmaster Flow FX Cat Back Instruction Manual

[Home](#) » [FLOW](#) » 717943 Flowmaster Flow FX Cat Back Instruction Manual 

Contents

- [1 717943 Flowmaster Flow FX Cat Back](#)
- [2 Product Information](#)
- [3 Product Usage Instructions](#)
- [4 OVERVIEW](#)
- [5 INSTALL FLOWMASTER EXHAUST SYSTEM:](#)
- [6 Installation Diagram](#)
- [7 Documents / Resources](#)
 - [7.1 References](#)



717943 Flowmaster Flow FX Cat Back



Product Information

- **Product Name:** Flowmaster Performance Exhaust System
- **Model Number:** 717943

- **Compatible Vehicle:** 2017-2021 Ford Super Duty with 6.2L & 7.3L Engine, 2/4 Wheel Drive & All Wheelbases

Contents:

- 1 x Inlet Pipe (Part #: 26809M)
- 1 x Resonator DLT Pipe (Part #: 26810M)
- 1 x Muffler (Part #: 74151-Z)
- 1 x Overaxle Pipe (Part #: 36079M)
- 1 x Exit Pipe (Part #: 36080M)
- 1 x Tips (Part #: ST508B)
- Hardware Package (Part #: PK1039) including:
 - 2 x 3" Stainless Band Clamp (Part #: MC300BS)
 - 3 x 3.5"/4" Stainless Band Clamp (Part #: MC350BS)

Product Usage Instructions

1. Before installing the Flowmaster performance system, carefully read and understand all instructions.
2. Check the inventory of all parts to ensure everything is included. If any parts are missing, contact the tech line for assistance.
3. Raise the vehicle using a hoist or jack stands to a suitable working height.
4. Allow the vehicle's engine components to cool completely before starting any work to avoid burns.
5. Cut the tailpipe just behind the muffler exit and remove the tailpipe section from the vehicle by disassembling hanger wires from isolators.
6. Remove the clamp in front of the muffler and then remove the muffler section from the vehicle.
7. Apply an anti-seize compound to the bolts of the stock and Flowmaster clamps, then re-install the nuts.
8. Ensure that every slip-fit connection in the kit seats 3 inches deep, except for muffler connections, which should seat 2 inches deep. Mark all slip-fit components accordingly for proper fitting.
9. If applicable, replace the resonator section of the vehicle using the resonator delete pipe and clamp. Trim 4 inches from the back of the resonator delete pipe for installation on a vehicle with a 160" wheelbase.
10. Attach the clamp onto the inlet pipe and connect it to the resonator delete pipe, straight tube, or resonator pipe. Insert a wire hanger into the isolator and tighten the clamp enough for adjustment.
11. Attach clamps onto the muffler and connect it to the inlet pipe. Tighten the clamps enough for adjustment.
12. Route the overaxle pipe over the axle and connect it to the muffler. Insert wire hangers into isolators and tighten the clamp enough for adjustment.
13. Attach the clamp onto the exit pipe and connect it to the overaxle pipe. Insert a wire hanger into the isolator and tighten the clamp enough for later adjustment.
14. Attach the tip onto the exit pipe and tighten inlets. Rotate the exit pipe and tip to the desired distance from the body or bumper for proper positioning of the angle cut on the tips.
15. Adjust all exhaust components for fit, ensuring proper clearance and compensating for suspension travel and vibration. Finally, tighten all clamps securely.

For further technical support, contact Flowmaster at (866) 464-6553 or visit their website:

www.flowmastermufflers.com.

Installation Instructions

717943

2017-21 FORD SUPER DUTY 6.2L & 7.3L ENGINE

2/4 Wheel Drive & All Wheelbases

OVERVIEW

1. Take a moment to read and understand these instructions before installing your Flowmaster performance system.

NOTE: Please inventory all parts now before continuing and if necessary, report any missing items to our tech line. This will avoid potentially stranding your vehicle until any missing replacement parts arrive.

ITM #	PART #	DESCRIPTION	QTY.
1	26809M	Inlet Pipe	1
2	26810M	Resonator DLT Pipe	1
3	74151-Z	Muffler	1
4	36079M	Overaxle Pipe	1
5	36080M	Exit Pipe	1
6	ST508B	Tips	1
N/A	PK1039	Hardware Package includes:	1
7	MC300BS	3" Stainless Band Clamp	2
8	MC350BS	3 1/2" Stainless Band Clamp	3

REMOVE STOCK EXHAUST SYSTEM:

2. Raise vehicle up on a hoist or rack to working height. If you don't have access to a hoist or rack, support vehicle with jack stands.

WARNING:

Avoid serious burns! Allow your vehicle time to cool completely before touching any factory engine components.

To ease preparation and installation of your new kit:

- Apply penetrating lubricant to mounts, bolts and clamps before you remove them.
- Use stands as necessary to support parts as you detach them from your vehicle and again as you install new parts.

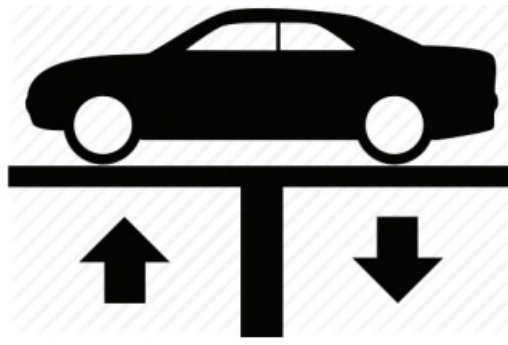

3. Cut tailpipe just behind muffler exit. Disassemble hanger wires from isolators then remove tailpipe section from vehicle.

3. Cut tailpipe just behind muffler exit. Disassemble hanger wires from isolators then remove tailpipe section from vehicle.



4. Remove clamp in front of muffler, then remove muffler section from vehicle.

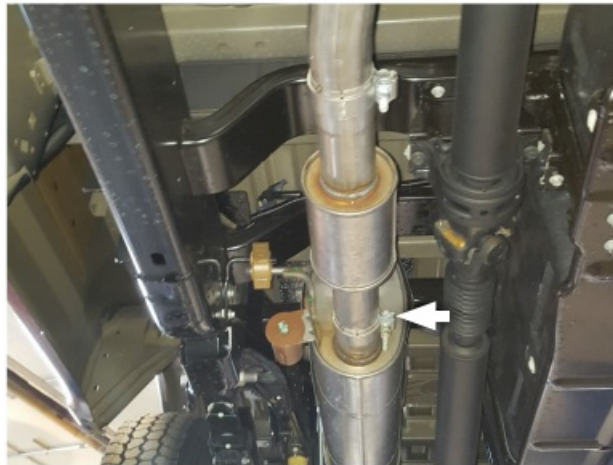

INSTALL FLOWMASTER EXHAUST SYSTEM:

5. Remove nuts from stock and Flowmaster clamps, apply anti-seize compound to bolts and re-install nuts.
NOTE: The image in this step is intended for illustrative purposes only and may or may not accurately reflect components included in your kit.
6. Every slip fit connection in this kit must seat 3" deep except for muffler connections which must seat 2" deep. Find all slip fit components in your kit and mark them accordingly so your Flowmaster exhaust system fits properly onto your vehicle.



7. If applicable, you may choose to replace the resonator section of your vehicle using resonator delete pipe (2) and (7) clamp.

NOTE: If your vehicle has a 160" wheelbase and you are replacing your resonator, trim 4" from the back of resonator delete pipe before installing it.



8. Place clamp (7) onto inlet pipe (1) then connect it to resonator delete pipe, straight tube or resonator pipe. Insert wire hanger in isolator and tighten clamp enough to allow for adjustment.

8. Place **clamp (7)** onto **inlet pipe (1)** then connect it to resonator delete pipe, straight tube or resonator pipe. Insert wire hanger in isolator and tighten clamp enough to allow for adjustment.

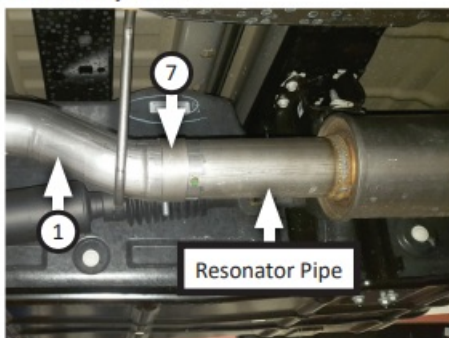

9. Place (x2) clamps (8) onto muffler (3) then connect it to inlet pipe. Tighten clamp just enough to allow for adjustment.

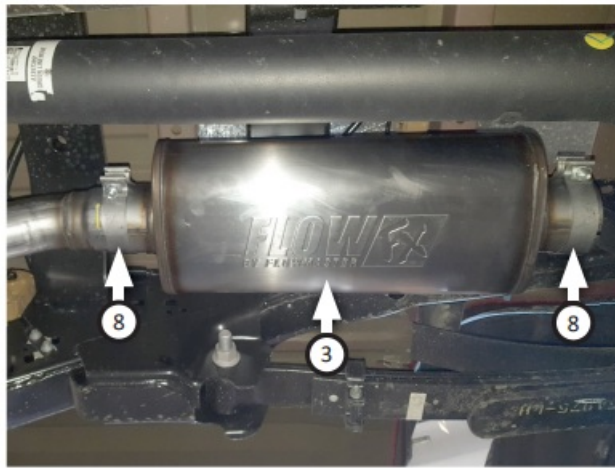

10. Route overaxle pipe (4) over axle then connect it to muffler. Insert wire hangers into isolators then tighten clamp just enough to allow for adjustment.

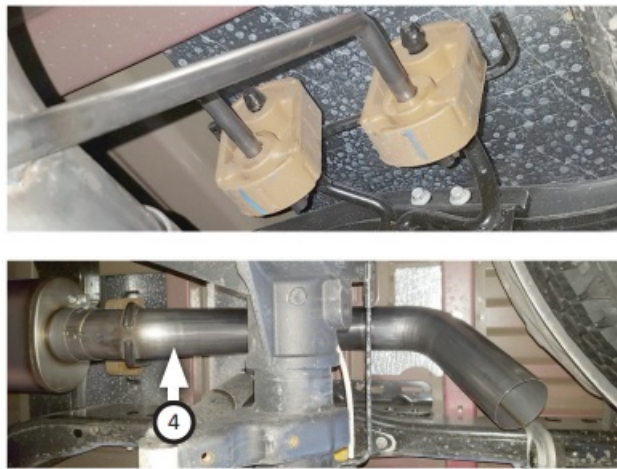

11. Place clamp (8) onto exit pipe (5) then connect it to overaxle pipe. Insert wire hanger into isolator then tighten clamp just enough to allow for later adjustment.
12. Place tip (6) onto exit pipe and tighten inlets. Rotate exit pipe and tip to desired distance from body or bumper, so angle cut on tips are properly positioned.
13. Adjust exhaust components for fit; maintaining 1/2" clearance and compensating for suspension, travel and vibration, then tighten all clamps.
14. Recommended: Secure slip-fit connections with a 1-inch tack weld then spray high-temp paint over each weld to prevent rust and premature corrosion.

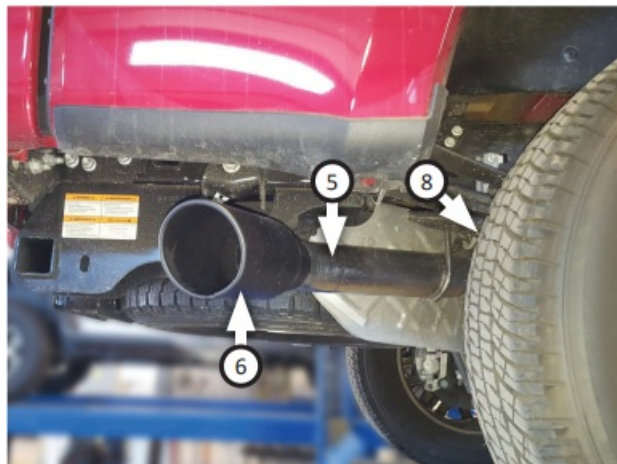

Congratulations, the installation of your FLOWMASTER performance exhaust system is now complete!



www.flowmastermufflers.com Technical Support (866) 464-6553

Installation Diagram

717943

20170-21 FORD SUPER DUTY 6.2L & 7.3L ENGINE

2/4 Wheel Drive & All Wheelbases

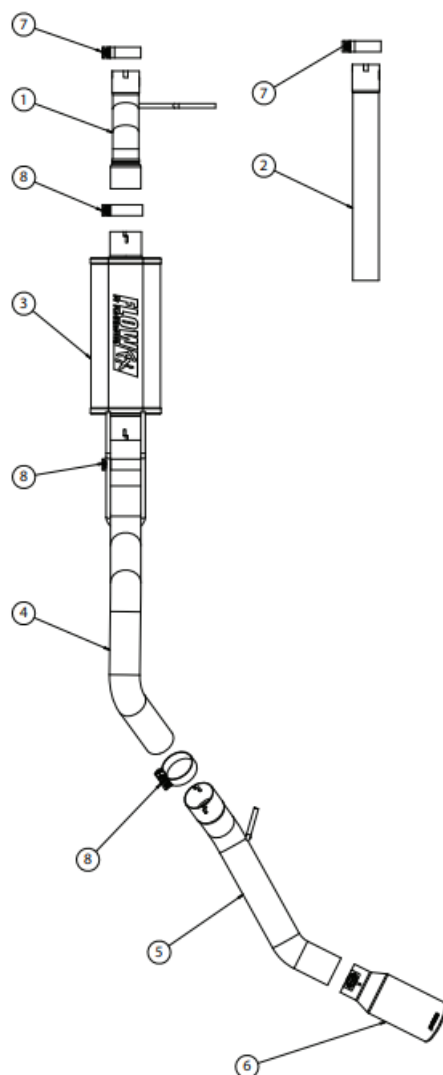

www.flowmastermufflers.com Technical Support (866) 464-6553

Documents / Resources

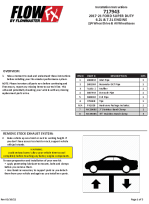
	<p>FLOW 717943 Flowmaster Flow FX Cat Back [pdf] Instruction Manual</p> <p>717943 Flowmaster Flow FX Cat Back, 717943, Flowmaster Flow FX Cat Back, Flow FX Cat B ack</p>
---	---

References

-  [The specialist motor insurer | ERS](#)