



Flittor DT-102 Training Collar System User Manual

[Home](#) » [Flittor](#) » Flittor DT-102 Training Collar System User Manual

Flittor



DT-102 Training Collar System
User ManualUser Manual
Training Collar System

Contents [[hide](#)

- [1 DT-102 Training Collar System](#)
- [2 Important Safety Information](#)
- [3 How the dog training system works?](#)
- [4 Features](#)
- [5 Key Definitions](#)
- [6 Collar receiver](#)
- [7 Operating Guide](#)
- [8 Frequently Asked Questions:](#)
- [9 Troubleshooting](#)
- [10 General Training Tips](#)
- [11 Addendum and Upgrading Notes:](#)
- [12 LIMITED 1-Year WARRANTY](#)
- [13 FCC Warning:](#)
- [14 Documents / Resources](#)
- [15 Related Posts](#)

DT-102 Training Collar System

Please read this entire manual before using this product.

Warning!!!

This product doesn't come with the charger. You can charge it by connecting your phone charger or computer with the USB cable. Please charge the product with 5V-Output charger only! Warranty Loss and charging damage may be caused by charging with improper charger.

Notes: You can see the output voltage information on the surface of the charger.

Important Safety Information

WARNING: NOT FOR AGGRESSIVE DOGS. Do not use this product if your dog is aggressive, or if your dog is prone to aggressive behavior, aggressive dogs can cause severe injury and even death to their owner and others. If you are unsure whether this product is appropriate for your dog, please consult your veterinarian or certified trainer.

CAUTION: Risk of skin damage: Please read and follow the instructions carefully in this guide, proper fit of the collar is important because a loose collar may cause inconsistent performance. A collar worn for too long or made too tight on the pet's neck may cause skin damage, ranging from redness to pressure ulcers (commonly known as bedsores). These collars can cause pressure necrosis if used incorrectly and is often misidentified as burns.

- Avoid leaving the collar on the dog for more than 12 hours per day.
- When possible reposition the collar on the pet's neck every 1 to 2 hours.
- Check the fit to prevent excessive pressure and it is okay to trim any excess strap length.
- Never connect a lead to the electronic collar because it may cause excessive pressure on the contacts.
- Wash the dog's neck area and contacts of the collar weekly with a damp cloth.
- Examine the contact area daily for signs of a rash or a sore.
- If a rash or sore is found, discontinue use of the collar until the skin has healed.
- If the condition persists beyond 48 hours, see your veterinarian.

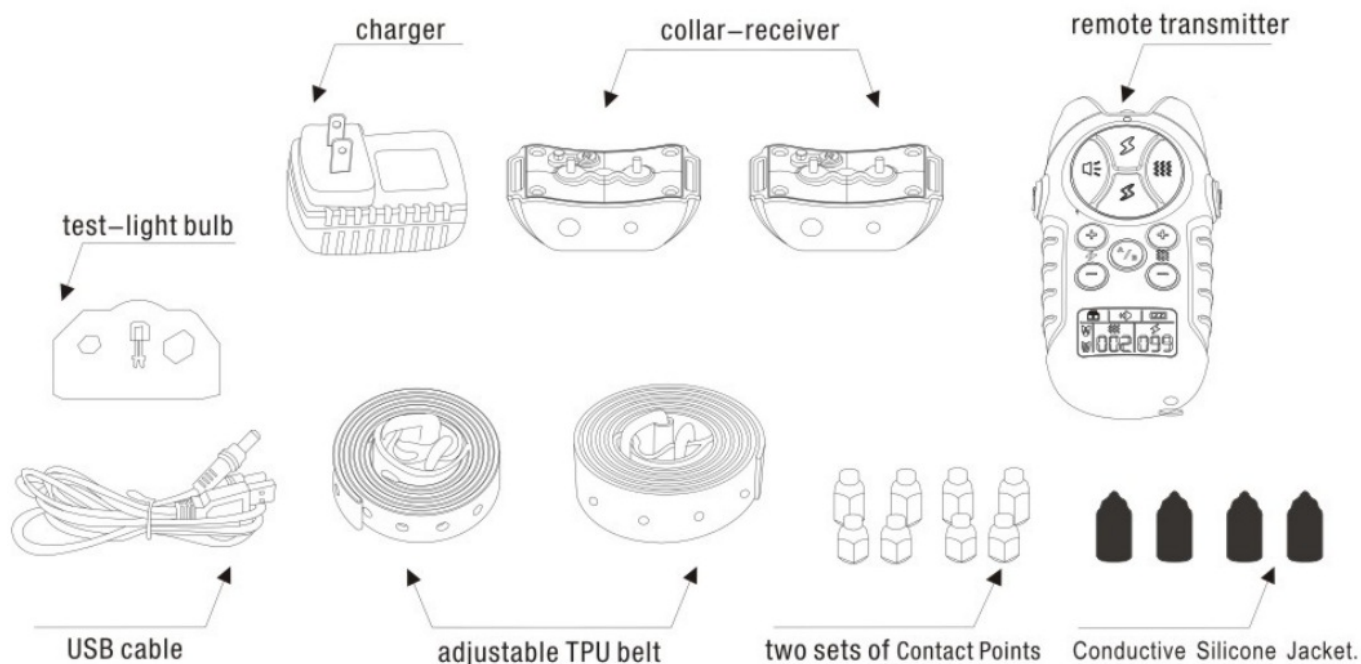
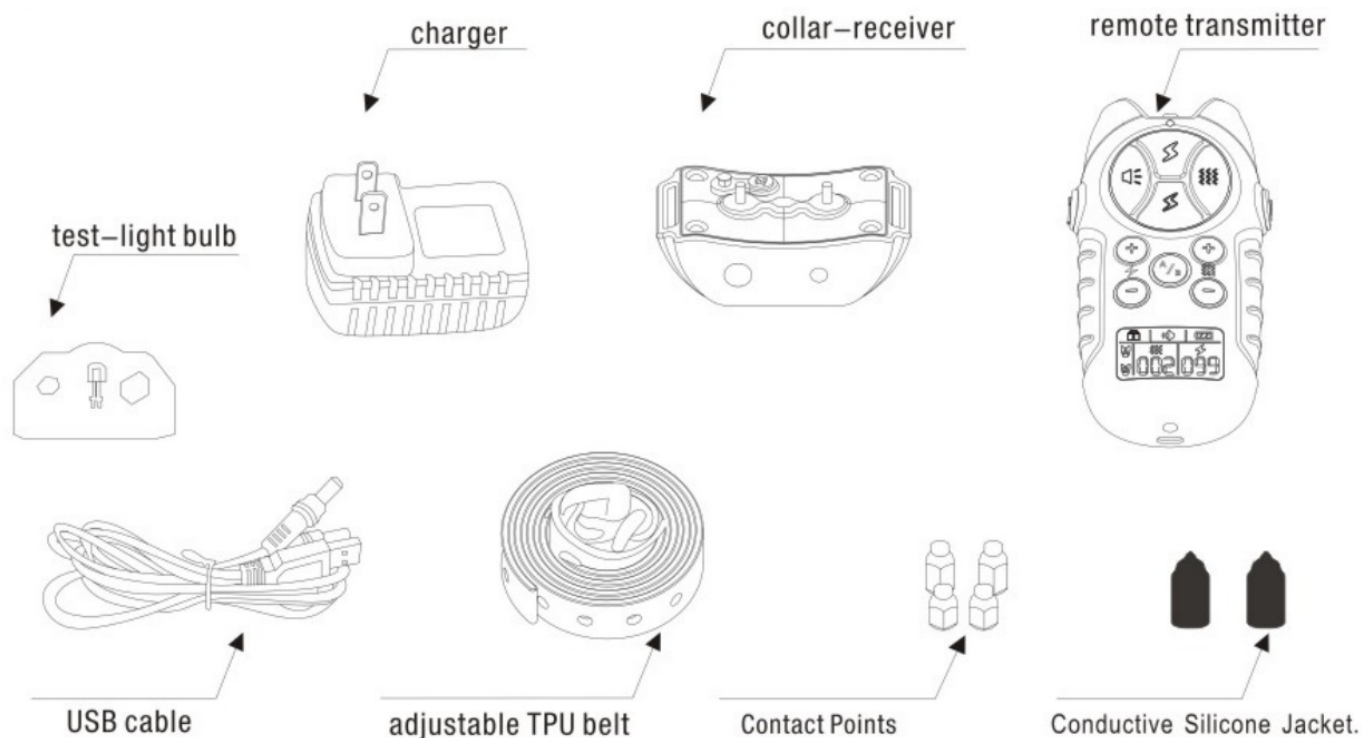

These steps will help your pet safe and comfortable. Millions of pets are comfortable while wearing stainless steel contacts. Some pets are sensitive to contact pressure. You may find after some time that your pet is very tolerant of the collar. If so you may relax some of these precautions, it is important to continue daily checks of the contact area. If redness or sores are detected, discontinue use until the skin has fully healed.

Thank you for choosing our product! You and your pet deserve a companionship that includes memorable moments and a shared understanding together. Our mission is to ensure your pet's safety by providing you the tools and techniques to successfully train your pet. Should you have any queries, please contact our customer service.

NOTE: Please charge before using the product.

Components

DT102-1(1 for 1)

DT102-21 1 for 2

How the dog training system works?

This system has been proven safe, comfortable, and effective for all pets over 15lbs, it assists you in controlling your pet without a leash in a range up to 1000M, At the push of a button, the remote transmitter sends a signal, activating the collar-receiver. Using the remote trainer consistently and correctly, most misbehaviors that your pet exhibits can be corrected or any basic obedience commands taught. It can also be used deter such unwanted behaviors as jumping up, digging and chasing. While the stimulation is startling it is harmless to your pet. Electronic training devices require interaction and training from the owner to achieve desired results.

Important: The system has a range up to 1000M. Depending on the way you hold the remote transmitter, the range may vary. Hold the remote transmitter in a horizontal position away from your body to achieve optimum range. Terrain, weather, vegetation, transmission from other radio devices. and other factors will affect the range of your remote transmitter.

Features

1. Rechargeable remote transmitter and collar-receiver.
2. Waterproof receiver collar
3. LCD display with backlight screen for night using
4. Standard Tone
5. 100 intensity levels of vibrations
6. 100 intensity levels of static shocks
7. Independent UP/DOWN buttons for the vibrations and static shocks
8. Two kinds of strength static shocks(the strength of stronger shocks is 1.2times than the weak shocks)
9. Power saving:
 - If the remote transmitter left unused for 10 seconds, will enter into "STANDBY" status; if unused for 5 minutes. it will enter into "DEEP SLEEP" status. To activate the transmitter in separate cases, you can simply press any button
 - Both of the transmitter and receiver can be tuned off manually
10. LED emergency flashlight
11. Three channels: Private Channel A, channel B and Public channel A+B.
12. Security keypad lock

Key Definitions

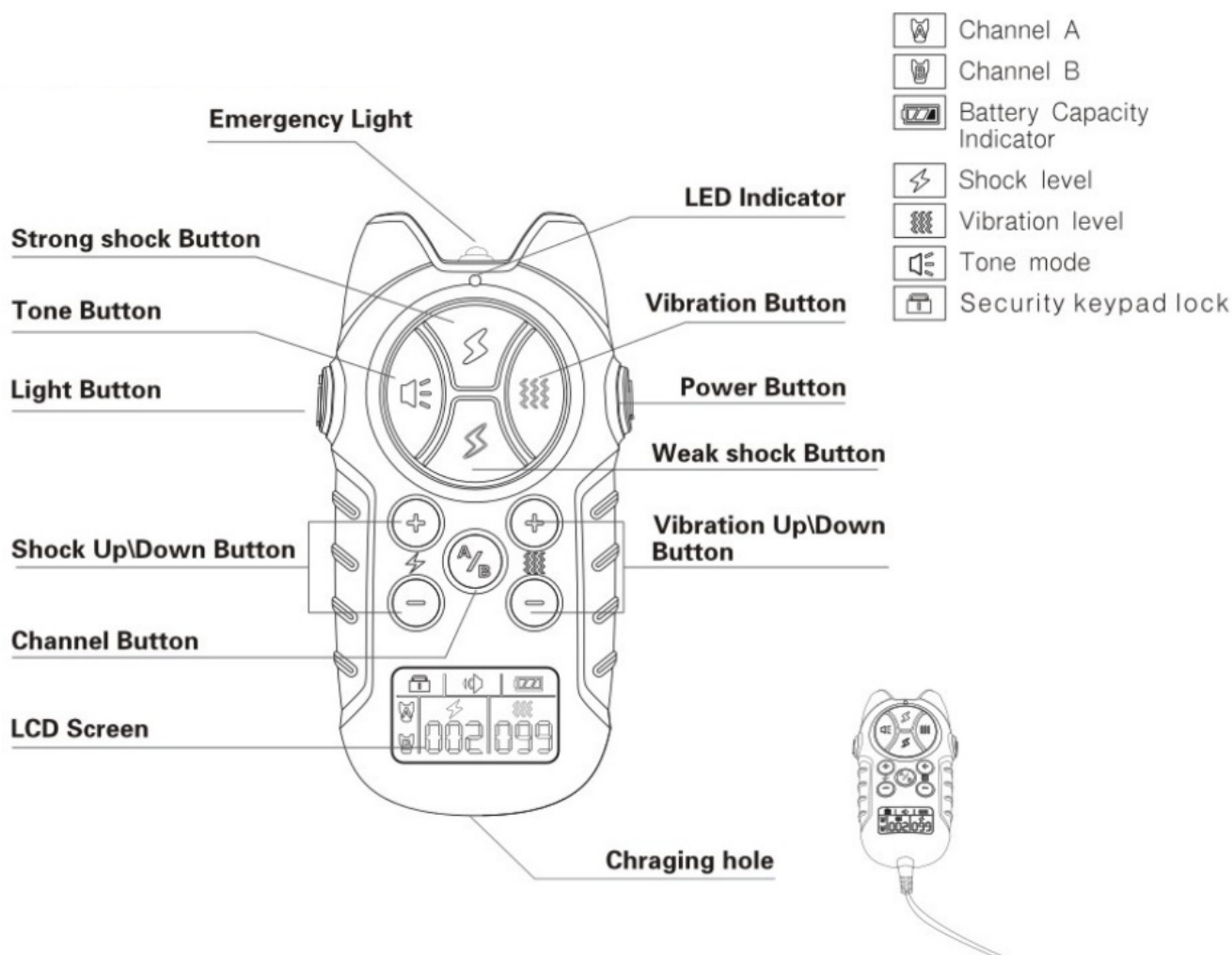

► Remote Transmitter

1. **Emergency light:** As the emergency lighting in the dark environment.
2. **LED Indicator:** When charging, the red LED light on, will turn green when full charged. It will flash green light when any of COMMAND button is pressed.
3. **Light Button:** when pressed, the emergency LED will light on/off.
4. **Power Button:**
 - Press it to lock 'unlock the keypad to prevent any misoperation on the remote transmitter.
 - Press and hold it for 2seconds to turn on/off the remote transmitter.
5. **Tone Button:** when it is pressed, the collar-receiver will give a warning beep.
6. **Vibration Button:** when it is pressed, the collar-receiver will vibrate, levels can be adjusted from 001 to 100 by pressing the VIBRATION UP/DOWN BUTTON.
7. **Weak shock Button:** when it is pressed, the collar-receiver will issue the weak shock, static shock levels can be adjusted from 001 to 100 by pressing the SHOCK UP/DOWN BUTTON.
8. **Strong shock Button:** when it is pressed. the collar-receiver will issue the stronger shock(about 1.2times than the weak shock), static shock levels can be adjusted from 001 to 100 by pressing the SHOCK UP/DOWN BUTTON
9. **Shock Up/Down Button:** Set the level of correction you wish to administer. (WARNING. ALWAYS BEGIN WITH A LOW-LEVEL SETTING IN THE INITIAL TRAINING STAGES)
10. **Vibration Up/Down Button:** Set the level of correction you wish to administer (WARNING ALWAYS BEGIN WITH A LOW-LEVEL SETTING IN THE INITIAL TRAINING STAGES)

11. **Channel Button:** When it is pressed, you can sync the collar-receiver and the transmitter via different channel(if encoded at the public channel of A+B", can control the collar-receiver at any of channels).
12. **LCD Screen:** Display the channel, intensity and Battery Fuel Gauge
13. **Charging Hole:** For remote transmitter charging.

Collar receiver

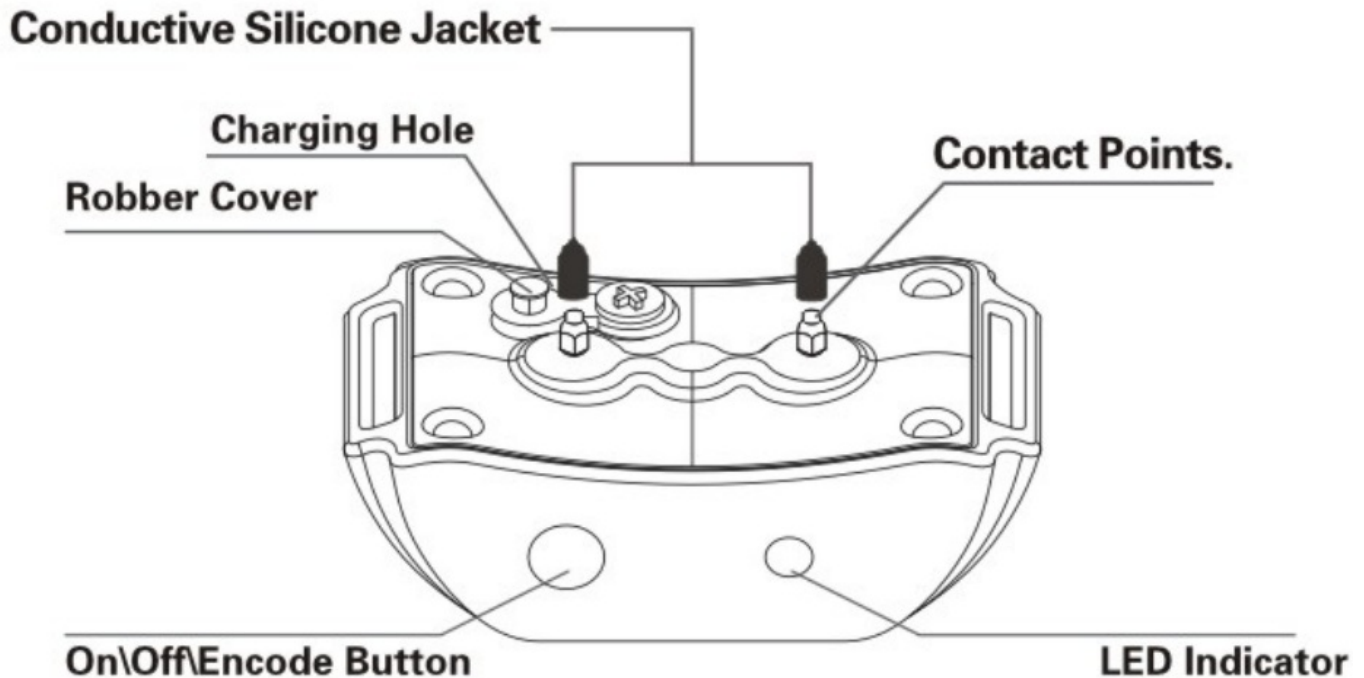

1. Contact Points: Deliver vibration and static shok
2. ON/OFF/Encode Button:
 - Turn on/off the collar-receiver;
 - Hold it for a few seconds to encode the receiver
3. Rubber Cover: After completion of charging please put the cover in place to safeguard the internal unit from dust and water.
4. Charging Hole: for collar-receiver charging
5. Conductive Silicone Jacket: Avoid the injury to the dog's skin because of the friction of metal contact points

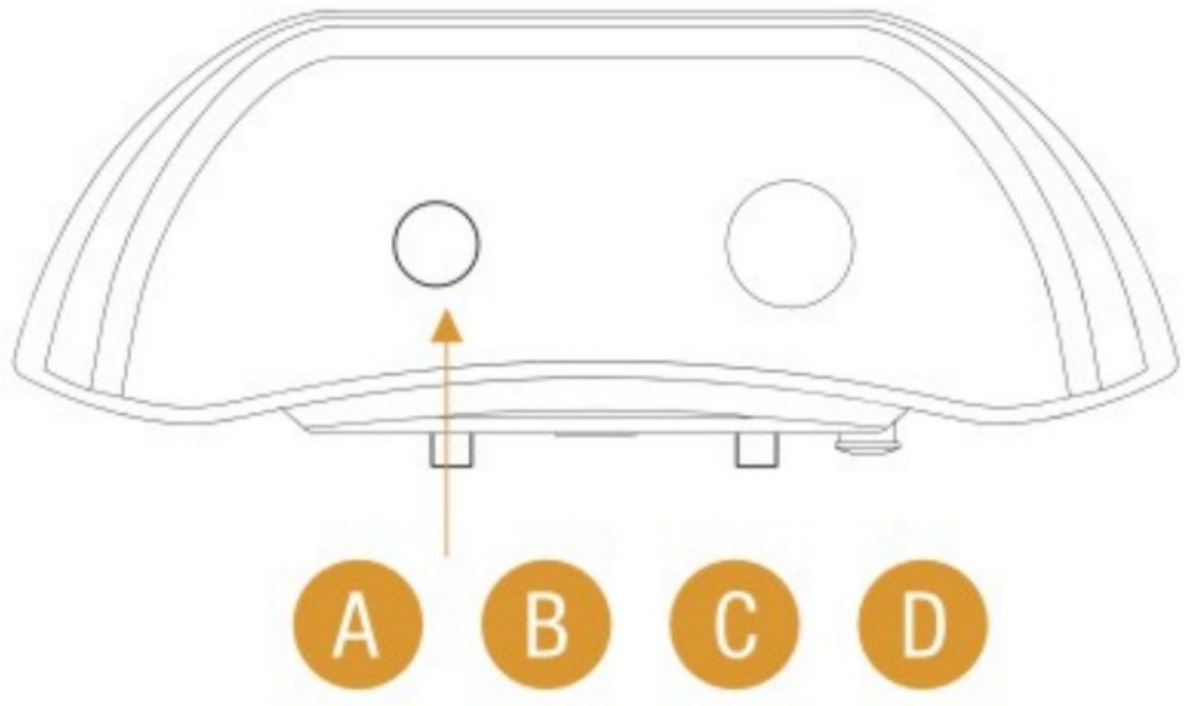

- A. When charging, the LED light is red; when fully charged, it turns to green
- B. In "standby" status, the LED light will flash green every 5 seconds, will flash red when the battery is at the low power mode (please charge it asap)
- C. The LED light will flash green when the receiver-collar receives the commands from the remote transmitter
- D. After turning on the receiver, press and hold the ON/OFF/ENCODE button for three seconds to encode it.

Operating Guide

Step :Prepare the remote transmitter: Charge the remote transmitter

1. Connect the charger connector to the charging hole. 5V Output charger only
2. Plug the charger into a standard outlet.
3. The red light in the transmitter will be on, indicating that charging is taking place.
4. Charge the transmitter at least 2 hours for first charge or until indication that charging is complete.
5. When charging is complete, the red light will turn green. Also the Battery Capacity Indicator will not flash any more.
6. When battery capacity * ir Indicator is empty, please charge it asap. Press and hold the power button for a few seconds on the transmitter to turn on/off the transmitter

How to use the remote transmitter

1. Press and hold the power button for a few seconds on the transmitter to turn on/off the transmitter
2. Press UP/DOWN buttons to adjust the intensity level of vibration or static shock.
3. "A/I3*(112) button indicates either channel A , channel B or channel A+B on the transmitter. Select one channel for use with one collar-receiver. if encoded at the public channel of -A+B", you can control the collar-receiver at any of channels.

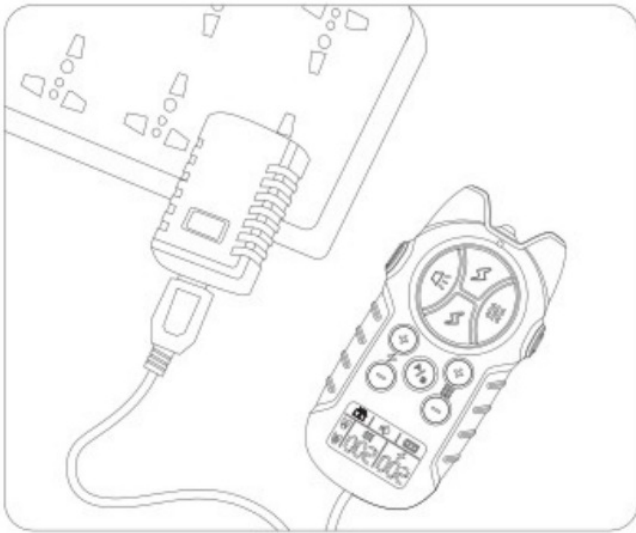

The remote transmitter will go into STANDBY MODE if no operation for 10 seconds and will go into SLEEP MODE if no operation for 5 minutes. Can be activated by press any of the function buttons.

Step 2: Prepare the Collar-receiver:

Charge the collar-receiver

1. Connect the charger connector to the charging jack. 5V Output cH
2. Plug the charger into a standard outlet.
3. The red LED light in the collar-receiver will turn on. (A)
4. Charge the collar-receiver for at least 2 hours for the first charge or until indication that charging is complete.
5. After the receiver has been fully charged, the LED light will turn green. (B)
6. When charging is finished, put the rubber cover in place to keep the internal unit from dust and water.

NB: The collar-receiver will flash red at STANDBY mode if it needs recharging.

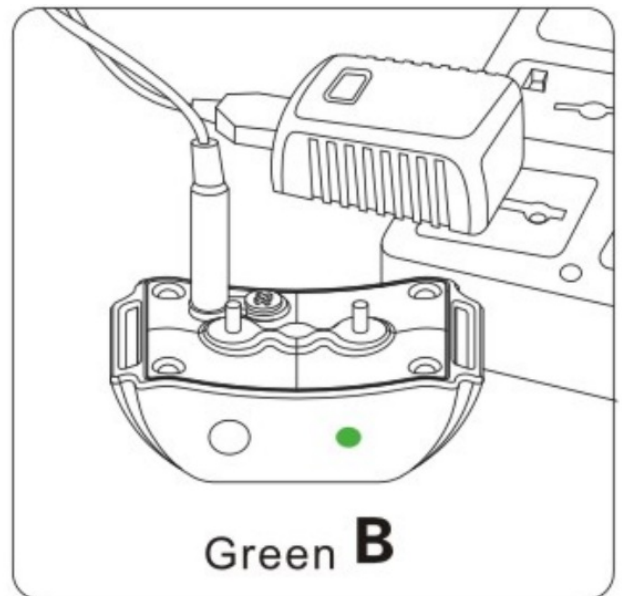
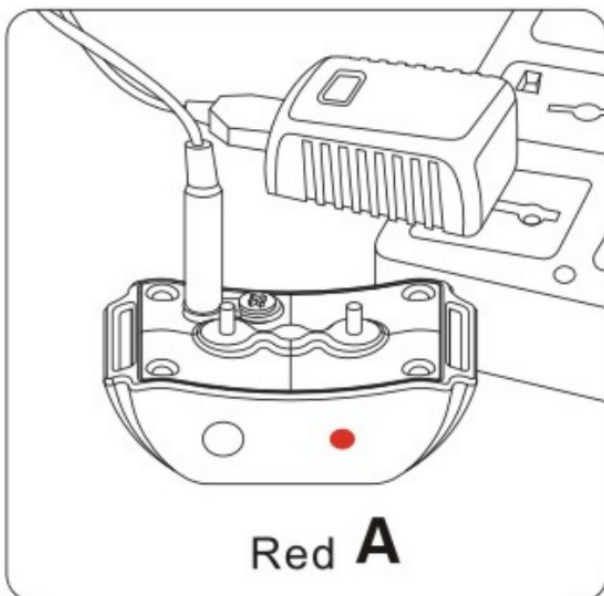

Step3: Sync transmitter with collar-receiver :

1. Power on the remote transmitter by pressing and hold the POWER button on the transmitter.
2. Select channel A, B or A+B.
3. Power on the Receiver Collar by press the ON/OFF button on collar, a beep will sound.
4. Press ON/OFF button afresh and hold it for 5 seconds, and then the LED light will start to flash green quickly

for 10 seconds.

5. Now you can hear the first beep from the collar-receiver and then press any of the command button(tone,shock or vibration) of the transmitter before the green light on the receiver stop flashing quickly.
6. You will hear the second beep from the receiver, which signifies that the transmitter and the receiver have been synced.
7. To sync the transmitter and the second receiver, repeat step 2 through 6.
8. Please be sure to choose the other channel.

NB: According to the factory default settings, when the collar-receiver has been turned on the syncing should be completed within 10 seconds, thereby you have to press the COMMAND BUTTON in good time or press it at least within 10 seconds. Please DO NOT try to sync the transmitter with the two collar-receivers (if any) at the same time.

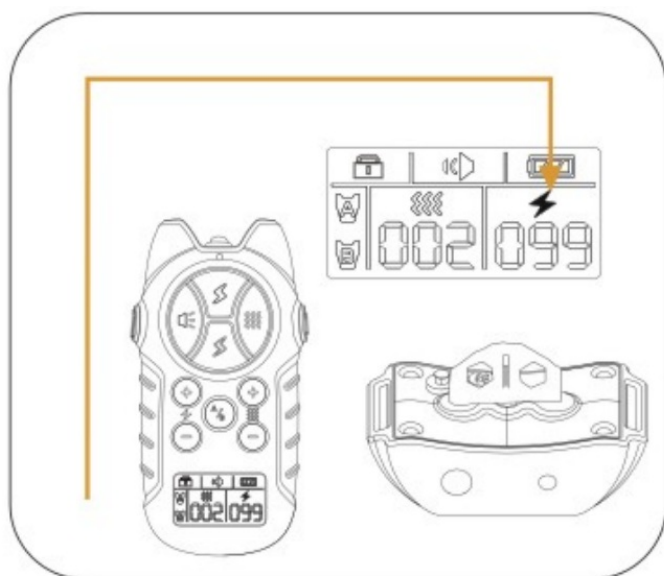

(Figure 2-1)

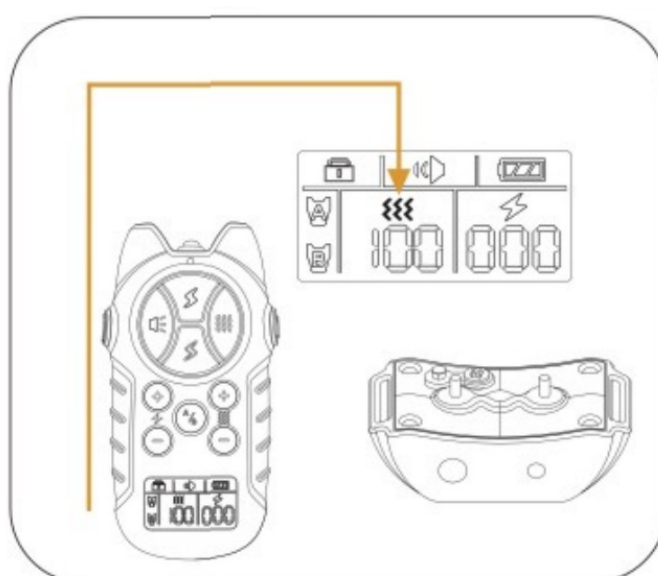

(Figure 2-2)

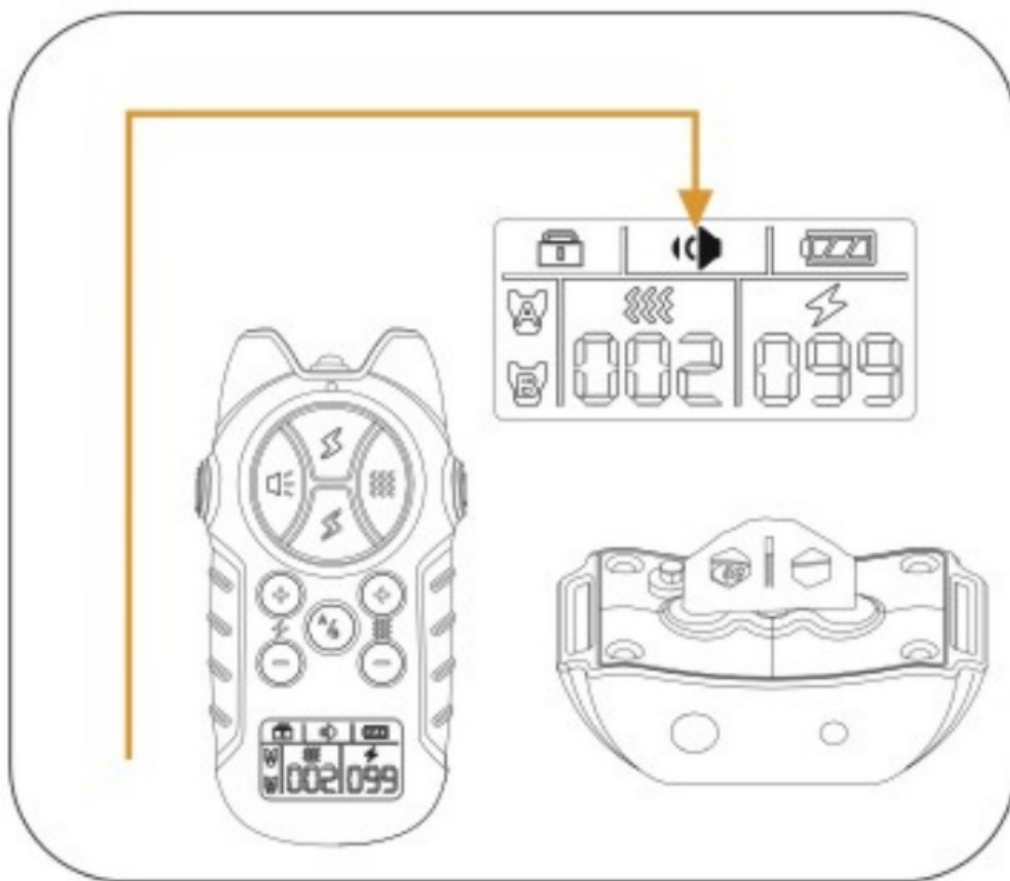

(Figure 2-3)

Step 4: Test the training system

The following testing methods will help you ascertain whether this training system functions swimmingly. Please make sure that you have connected the transmitter and collar-receiver before testing.

Test the static shock function (Figure 2-1)

Install the Contact Points on the screws of the collar receiver and pull on the Conductive Silicone Jacket. then put bottom of the test light(NOT the hexagonal hole) on the Conductive Silicone Jacket. Turn on the remote transmitter, press the UP/DOWN button to adjust the intensity level.

Press strong/weak shock button and the bulb will flash, signifying that the SHOCK function works. Please make sure the SHOCK level is above 10 when testing the function to see more clearly.

Note. If wanting to test the shock function on yourself, please ensure your finger or hand is across both contact points to ensure the connection is complete. Otherwise, user will feel no stimulation.

Test the vibration functions (Figure 2-2)

Turn on the remote transmitter, press the UP/DOWN button to adjust the vibration level.

Press vibration button one the remote transmitter and the collar-receiver will vibration, signifying the VIBRATION function works.

Test the beep function (Figure 2-3)

Turn on the remote transmitter.

Press vibration button, the collar- receiver will beep, signifying the BEEP function works.

NB:

1. To save power, the transmitter will go into STANDBY mode if there's no operation in 5 minutes, you can press any COMMAND button to activate it and then its screen will display.
2. The collar-receiver will go into SLEEP mode if there is no operation for 2 minutes, the LED stop flashing. Will be activated within 60 milliseconds once receiving the command(shock,vibration or tone) from the transmitter

Step 5 Fit the collar-receiver

Important. The proper fit and placement of the collar-receiver is essential for effective training. The metal contact probes must have direct contact with your dog's skin as follows:

1. To fit the collar-receiver you will need to attach the collar-strap to the receiver box. Ensure you have selected the appropriate length metal probes for your dog (i.e. long-length probes for long-haired dogs and short-length for short-haired dogs) (3A)
2. With your dog standing in front of you, place the collar-receiver around its neck so the receiver box and probes are on the underside of your dog's neck, making direct contact with the skin. You may need to trim the fur to ensure good contact (3B)
3. Fasten the collar-strap. The fit should be snug, but not taut. You should be able to place one finger beneath the collar-strap around your dog's neck (3C)
4. Allow your dog to wear the collar-receiver for several minutes and then check the strap again. As your dog becomes more familiar with the collar-receiver, you should ensure the fit is comfy and flattering.

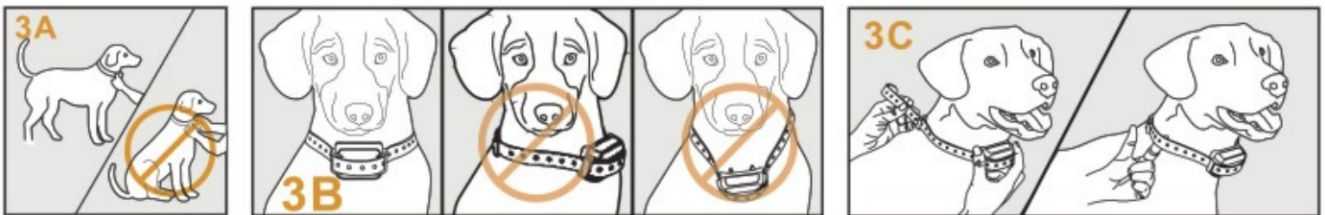

CAUTION: RISK OF SKIN DAMAGE

- For comfort, safety and effectiveness of this product please see to it that you check the fit of your pet's collar frequently. If any skin irritation is observed, discontinue the use of the collar for a few days. If the condition persists beyond 48 hours, see your veterinarian.
- Do not attach a leash to the collar, which can result in squeezing the metal probes too tightly against your pet's neck.
- The collar-receiver is not designed to be worn constantly. We recommend the collar not be worn for more than 12 hours out of every 24-hours period.
- Most pets feel uncomfortable when wearing the collar for the very first time. Don't use any functions before the pet has gotten accustomed to the collar.
- We suggest you give the dog VIBRATION before starting the STATIC SHOCK. After a time of training, the dog will learn that shock will come after vibration. In this way, the vibration alone can effectively curb the misbehaviors of your dog. The STATIC SHOCK only acts as a menace that might be unnecessary sometimes.

Step 6: Re-thread the collar (as diagram)

Regular Maintenance

- Check the metal probes for tightness on a weekly basis.
- Rinse the metal probes with alcohol on a weekly basis. **(NB: Please turn off the collar-receiver before touching the metal probes.)**
- Check your dog's neck for irritation and wash it on a weekly basis

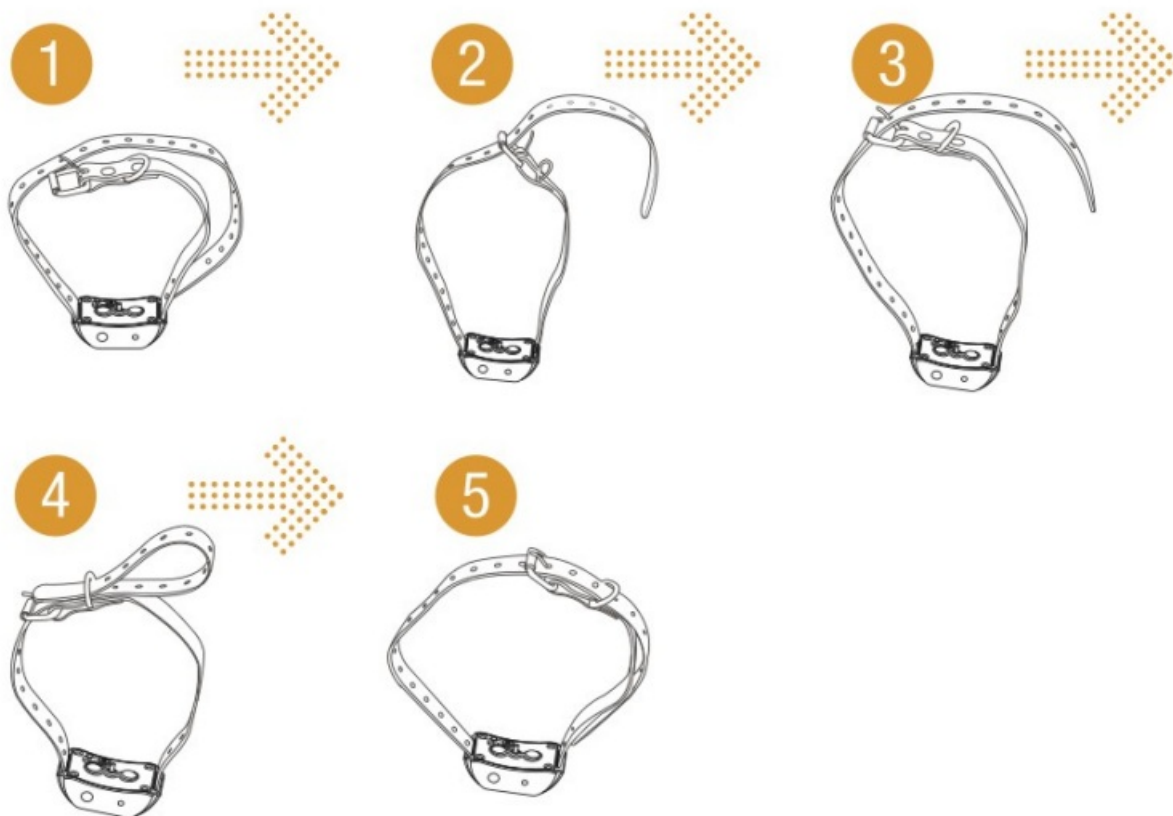

Frequently Asked Questions:

How old does a pet have to be before using the system?

– Your pet should be able to learn basic obedience commands such as “sit” or “stay”. The collar-receiver maybe too large for dog under 15lbs.

Once my pet is trained and has been obeying my commands, will he have to continue to wear the collar?

– Probably not. But you may try to reinforce training with the collar.

Can I use the rechargeable training collar with more than one pet?

– Yes, you just need to add another collar to the system.

How long can I continuously deliver vibration or static shock to my pet?

– Ten seconds. After ten seconds, the transmitter will time out and should be started again.

Is the collar-reserver waterproof?

– Yes, yet you have to ensure that its charging hole is sealed by the rubber cover.

Can I rise the system on aggressive pets?

– No. Please do not use this system to correct or eliminate any form of aggression or biting behavior. In the event your dog is showing signs of aggressive behavior then contact a professional dog trainer in your vicinity.

Will I get exactly 1000m of range with this rechargeable training collar?

– The range you get with this system will vary according to terrain, vegetation, as well as transmission from other radio devices. To get the maximum amount of range, please refer to “how the system works” section of this guide.

What do I do if my pet’s neck becomes red and irritated?

– Discontinue use of the collar until the skin has healed. If the condition persists beyond 48 hours, see your

veterinarian.

Can I replace the collar-receiver with another kind of collar?

– No.

Can I attach a leash to the collar-receiver?

– No. This can result in pulling the metal probes too tightly against your dog's neck. Attach a leash to a separate, nonmetallic collar or a harness, ensuring the extra collar does not put pressure on the metal probes.

How will I know when to charge the system?

– For the remote transmitter: the symbol will show up on the LCD screen; for the receiver: if the LED indicator flash red per 3 seconds, you will need to charge the receiver.

What's the life-span of the lithium batteries of the remote transmitter and the collar -receiver?

– They can be charged over 400 times

How long can I leave collar-receiver on my dog?

– As the collar is not designed to be worn constantly, we recommend the collar not be worn for more than 12 hours out of every 24-hour period.

How should I use the SCSSIOIN for 111V pH?

– Make the training sessions short and positive, between 10-15 minutes long, each time. This enables your dog to keep its attention focused on you.

What kind of dogs is this rechargeable training collar suitable for?

– The collar is adjustable from length 5.9 “(15cm) to 23.6” (60cm), if your pet's neck circumference is smaller than 5.9”, you have to rethread it, if your pet's neck circumference is larger than 24”, this collar may not be suitable for your pet. This collar is NOT suitable for dogs under 151bs.

Troubleshooting

My pet is not responding after the pet training system has been installed successfully.

- You need to charge the remote transmitter and the collar- receiver for 2 H separately before initial use.
- Check to see if the remote transmitter and the collar-receiver have been turned on.
- Check the intensity levels of vibration and static shock.
- Make sure the collar-receiver has sufficient power to operate.
- Restart the collar-receiver by pressing the ON/OFF button.
- Please test the 3 functions (BEEP, VIBRATION AND, STATIC SHOCK) before initial use. See the “test the training system” part of this guide for testing methods.
- Check whether the collar-receiver has entered into the DEEP SLEEP mode.
- Check if the collar fits snugly with your pet's neck.
- Check the thickness of your pet's fur and use appropriate length metal probes. If necessary, please trim your pet's neck hair so that the metal probes come in direct contact with your pet's skin.
- If all of the above have been addressed and your pet still gives no response. Please try to re-connect the remote transmitter and the collar-receiver.

The remote transmitter does not work.

- Check if the remote transmitter is in low battery status. If the Battery Capacity “Indicator is empty, battery exhaustion is imminent.
- You have to press and hold the power button on the transmitter to turn it on.
- Check if the transmitter has entered into the STANDBY or DEEP SLEEP status.

My collar-receiver works great for some time, yet it does not work after charging.

- First, check if the receiver has been charged correctly. Check the “prepare the collar-receiver” part of the guide for the correct charging method.
- Check if the receiver has been turned on.

I want to test the collar-receiver on myself, but it does not work.

- When testing the receiver on your hands, please touch the 2 electrodes at the same time as touching one single electrode will not work.

General Training Tips

The following are tips on how to get the best out of your Remote Pet Training Collar:

1. Make the training sessions short and positive (between 10-15 minutes long for each time), which will enable your dog to keep its attention focused on you.
2. Train one dog at a time.
3. During initial training sessions, keep your dog in a familiar outdoor environment e.g. an enclosed area of the garden and away from other dogs/animals and people. Training in new locations may cause your dog to become distracted causing you to reinforce your commands with the remote collar-receiver more often collar-receiver more than accordingly.
4. Use a long leash fastened to a non-metallic collar to help his/her learning. Ensure the additional collar and leash does not interfere with the skin contact of the metal probes on the collar-receiver. Do not use the remote training collar without a long leash until your dog is fully trained.
5. You will have more success by teaching the dog a command first before trying to reinforce to command with the remote trainer.
6. For basic obedience training, VIBRATION and AUDIO modes are more useful.
7. Issue an obedience command at a time, which will focus your dog's attention and reduce confusion. Do not use the remote collar to correct commands that have not already been covered.
8. During training, look for all the positive changes in your dog's behavior and remember to reinforce them promptly with ample praise and reward.
9. Avoid over-correcting your dog. Use as few remote corrections as possible during the training process.
10. When your dog has become apparently perplexed. shift the focus of the training session by drawing his/her attention to a command they are familiar with, e.g. sit. Give your dog praise and encouragement galore on successful completion of the command. Repeat this several times before returning to training with remote corrections
11. If you know a particular misbehavior your dog does, then reinvent this situation during a training session. You will have far more success if you deal with one misbehavior at a time in a controlled situation.

12. Be consistent; give your dog a tone, vibration or static-stimulation correction for each misbehavior. When reinforcing a command with a correction. It is critical that you do so without emotion then immediately praise and reward your dog for marking the right decision
13. When your dog seems to react in a timid and frightened fashion to either the tone, vibration or static-stimulation, particularly in early training sessions, do not be flabbergasted. Shift the focus of the training session by drawing his/her attention to a command they are familiar with. E.G. sit and give your dog abundant praise and encouragement on successful completion of the command.
14. Do not use Remote Pet Training Collar to correct or eliminate form of aggression or biting behavior. When your dog is showing signs of aggressive behavior then contact a professional dog trainer in your vicinity
15. Please be reminded that you should keep training sessions short and end every session on a high note. Stop training and play with your dog as soon as he/she has accomplished a new level of proficiency.

SIZE	NECK GIRTH (IN)	NECK GIRTH (IN)	BACK LENGTH (IN)	WEIGHT(LBS)	BREED
x-SMALL	7.8-8.6	9.8-11.8	7.	1-10	Chihuahua,yorkshire,terrier
SMALL	7.8-9.4	11.4-14.1	9.0	11-25	Poodle,Pomeranian
MEDIUM	9.0-11.0	13.7-16.5	11.0	26-40	Shih Tzu,Maltese Dog
LARGE	10.6-12.2	16.1-18.5	12.	41-70	Miniature Schnauzer,Pekingese
LARGE	11.8-13.3	18.1-20.8	14.	71-90	English Cocker Spaniel
LARGE	12.9-14.5	20.4-23.2	16.	91-110	Beagle
X-LARGE	16.9-18.9	29.9-33.0	24.	N/A	Husky
X-LARGE	18.5-20.4	34.6-38.1	24.	N/A	Labrador Retriever
X-LARGE	20.4-24.4	36.2-39.3	28.	N/A	Golden Retriever Old English Sheepdog

Addendum and Upgrading Notes:



Maximum range



Typical range



Maximum range

The range of “up to 1000m” specified in the user manual denotes the maximum valid value that can be possibly achieved in ideal conditions. According to multiple hands-on field experiments, this training system has an effective range up to 600-900.

Avoid touching the antenna(at the backside of the LED indicator in transmitter) or the range may decrease substantially.

LIMITED 1-Year WARRANTY

We warrant this product to be free of defects in parts, materials and workmanship for a period of 1 year, from date of purchase. Should any repairs or servicing under this warranty be required, contact Customer Service by phone or email for instructions on how to pack and ship the product

FCC Warning:

This equipment has been tested and found to comply with the limits for a Class B digital device, pursuant to part 15 of the FCC Rules. These limits are designed to provide reasonable protection against harmful interference in a residential installation. This equipment generates, uses and can radiate radio frequency energy and, if not installed and used in accordance with the instructions, may cause harmful interference to radio communications. However, there is no guarantee that interference will not occur in a particular installation. If this equipment does cause harmful interference to radio or television reception, which can be determined by turning the equipment off and on, the user is encouraged to try to correct the interference by one or more of the following measures:

- Reorient or relocate the receiving antenna.
- Increase the separation between the equipment and receiver.
- Connect the equipment into an outlet on a circuit different from that to which the receiver is connected.
- Consult the dealer or an experienced radio/TV technician for help.

Caution: Any changes or modifications to this device not explicitly approved by manufacturer could void your authority to operate this equipment.

This device complies with part 15 of the FCC Rules. Operation is subject to the following two conditions: (1) This device may not cause harmful interference, and (2) this device must accept any interference received, including interference that may cause undesired operation.

This equipment complies with FCC radiation exposure limits set forth for an uncontrolled environment. This equipment should be installed and operated with minimum distance 0cm between the radiator and your body.

	<p>Flittor DT-102 Training Collar System [pdf] User Manual</p> <p>DT102A, 2ATEO-DT102A, 2ATEODT102A, DT-102, Training Collar System, Collar System, Training Collar, Collar</p>
---	---