



FLEXIT GO Powerline Network Adapter User Manual

[Home](#) » [FLEXIT](#) » FLEXIT GO Powerline Network Adapter User Manual 

Contents

- [1 FLEXIT GO Powerline Network Adapter](#)
- [2 General](#)
- [3 Overview](#)
- [4 How to do](#)
- [5 Overview](#)
- [6 Overview of LEDs](#)
- [7 FAQ – Frequently asked questions](#)
- [8 Documents / Resources](#)
 - [8.1 References](#)
- [9 Related Posts](#)



FLEXIT GO Powerline Network Adapter



General

The Powerline adapter uses your home's electrical circuits to expand your existing data network. The integrated electric socket on the Powerline adapter enables you to connect other electronic devices to the same socket. The built-in noise filter eliminates electrical signal noise, thereby guaranteeing high-quality data transfer via your home's power cables. The devices are used to connect Flexit ventilation products to the Internet in places where a network cable cannot be fitted. When the unit is connected to the network, you can register it in Flexit's cloud service with the Flexit GO app.

Overview

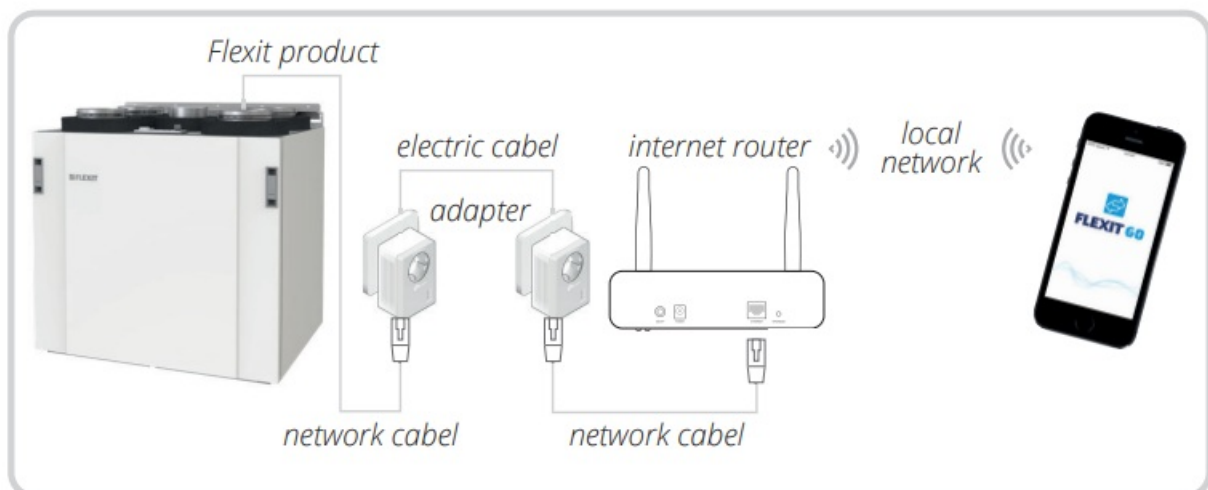

For optimum function, both adapters must be connected to the same electrical phase.

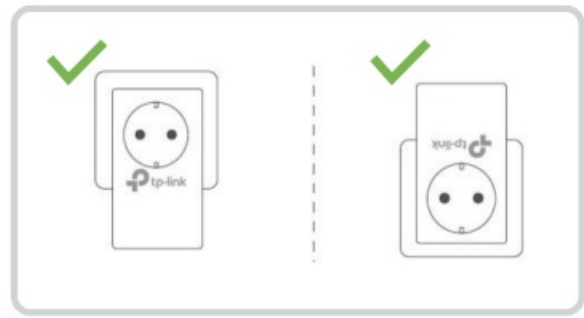
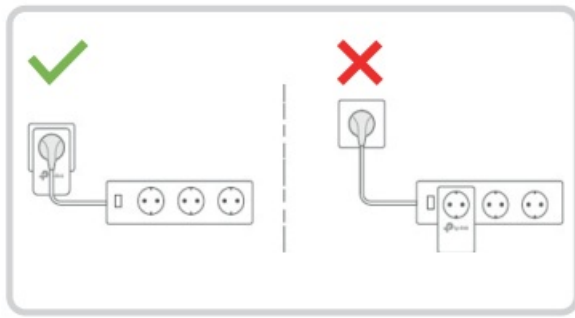

How to do

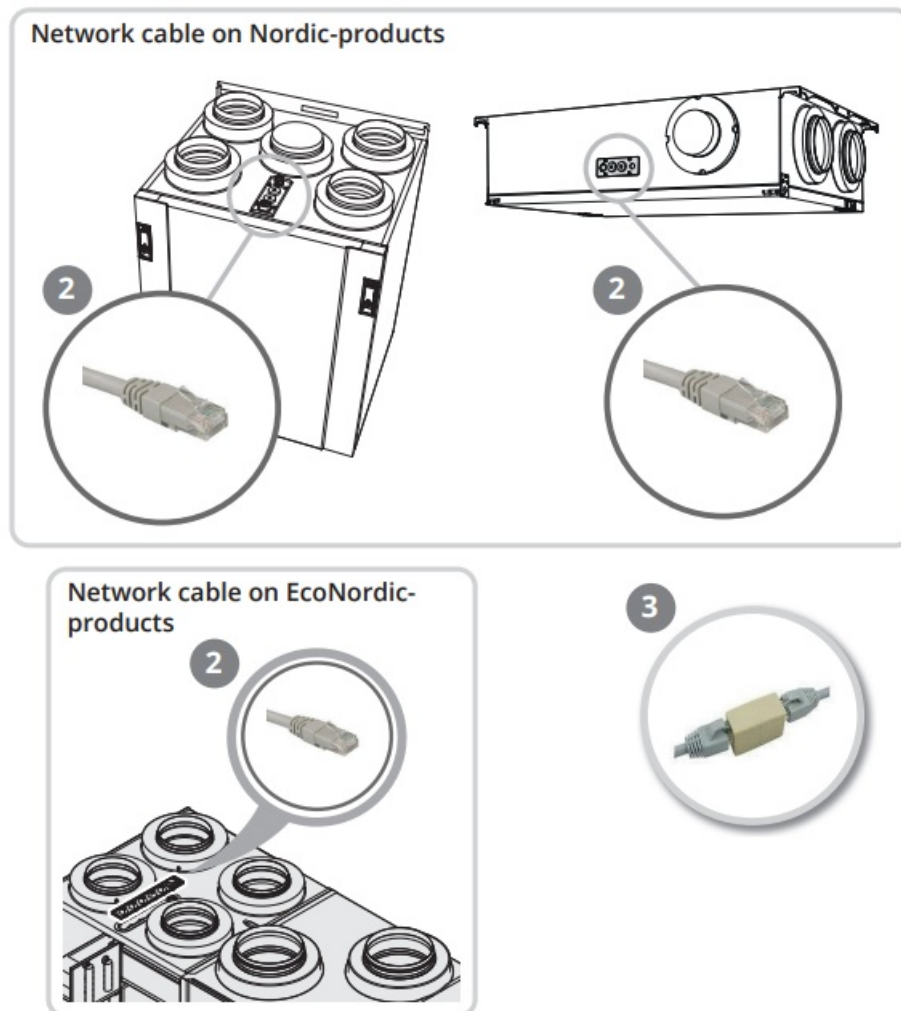

1. Connect the first Powerline adapter to the wall SOcket nearby the product.
2. Connect a network cable between the products and the adapter. See sktech

If the network cable from the device is not long enough, use the network cable supplied with the adapter and connect it to the lead connector on the cable from the device. See sketch.



3. Connect the second Powerline adapter nearby the home's Internet router.
4. Then plug the included network cable between the adapter and the router. When connection is complete, wait for the  Powerline lyser stabil. to show a constant light, which means that the adapters are communicating with each other.
5. Now you can download the Flexit GO app and connect your unit to the cloud service. Then you can be sure that the unit always has the latest software and that Flexit can help you remotely when needed. In addition, you can control the unit from the phone or tablet.

If you have several Powerline devices in the same house, you can pair the adapters together to avoid interference.

1. Check that the  power lamps on the Powerline devices show a constant light.
2. Press the Pair button on one of the devices for one second. The  power LED will start to flash
3. Within two minutes, press and hold in the Pair button for one second on the other Powerline adapter. The Power lamp will start to flash. When the Powerline LED lights up, the pairing process is complete.

Overview

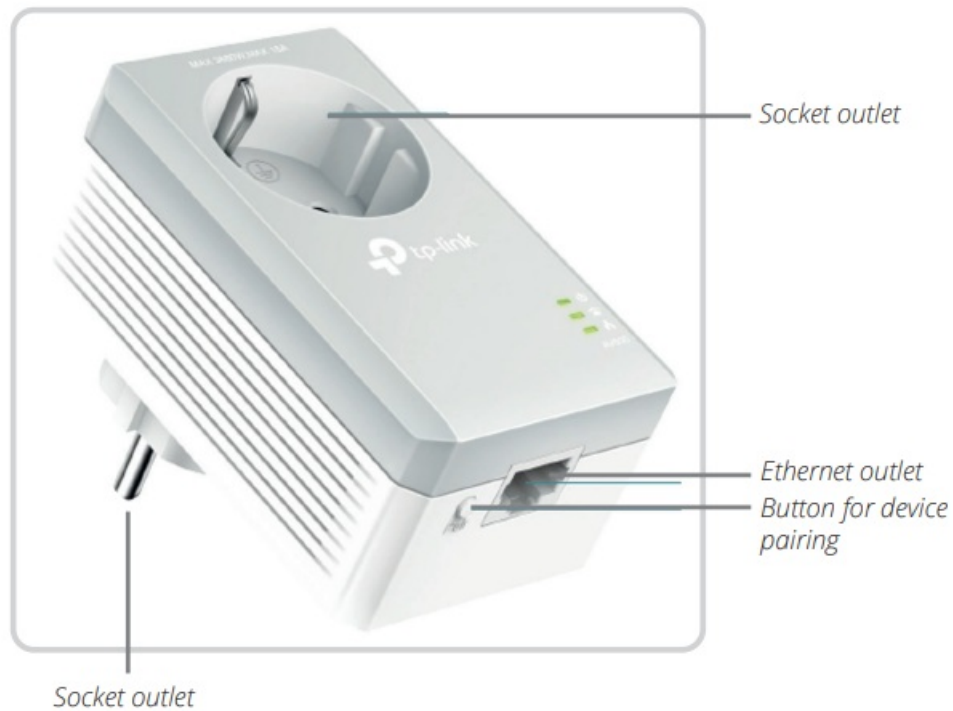

Overview of LEDs

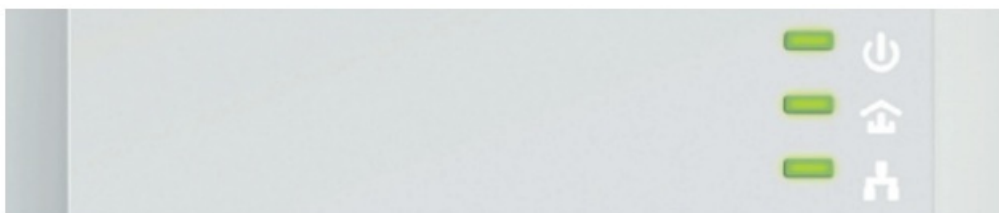

• Power

- Constant light – The device is connected.
- Rapid flashing – The devices are being paired.
- Slow flashing The device is in standby mode'.

• Powerline

- On – The device is Connected to the receiver.
- off- The device is not connected to the receive.

• Ethernet

- On -The Ethernet port is connected.
- Off – The Ethernet port is not connected.

FAQ – Frequently asked questions

• How do I reset my Powerline adapter?

- Make sure the Powerline adapter is connected to the wall socket.
- Hold the pairing button in for more than 6 seconds, until the power lamp  goes out for a moment and then relights again.

• What do I do if the Powerline LEDs have gone out?

Try a different wall socket, and make sure that both Powerline devices are connected to the same electrical phase. Try to create a stable network by pairing the devices. – See the section above.

• What action do I take if there is no Internet connection via my Powerline adapters?

Make sure that both adapters are connected to the same electrical phase. Make sure that the Powerline LEDs light up on both your Powerline devices. If not, pair the adapters together. Make sure that all devices are correctly connected. Check that you have an Internet connection by connecting your computer directly to the router.

• What can I do if a paired device does not reconnect after moving it to a new position?

- Try a different socket on the same electrical phase.
- Try to pair it up again, and see if the Powerline LEDs light up.
- Check any interference from washing machines, dishwashers or other household products.
- You can connect the appliances too the socket in the adapter in order to eliminate any interference from them.
- If there are several products, a terminal block can be Connected to the adapter to provide more Outlets.

Flexit AS, Televeien 15, N-1870 Ørje www.flexit.no

Documents / Resources

	<p>FLEXIT GO Powerline Network Adapter [pdf] User Manual GO Powerline Network Adapter, GO, Powerline Network Adapter, Network Adapter, Adapter</p>
---	--

References

-  [Bedre inneklima - Flexit](#)