



FLEXISPOT H6W-2816 Height Adjustable Overbed Table Installation Guide

[Home](#) » [FLEXISPOT](#) » FLEXISPOT H6W-2816 Height Adjustable Overbed Table Installation Guide 

FLEXISPOT H6W-2816 Height Adjustable Overbed Table Installation Guide



Contents

- 1 Specifications
- 2 Accessory Package
- 3 Parts Included
- 4 Step 1: Connect the lifting column to the tabletop
- 5 Step 2: Install the foot
- 6 Step 3: Adjust the height of the tabletop
- 7 Attention
- 8 Recycling and Disposal
- 9 Limited Warranty
- 10 Documents / Resources
- 11 Related Posts

Specifications

Column Stage	2
Max. Load Capacity	15.4 lbs (7KG)
Tabletop Dimension	27.6" (700mm) x 15.7" (400mm)
Min. Height	25.6" (650mm)
Max. Height	40.5" (1030mm)

Accessory Package

Figures shown are for reference only. Please contact customer service if there are any accessories or tools missing.

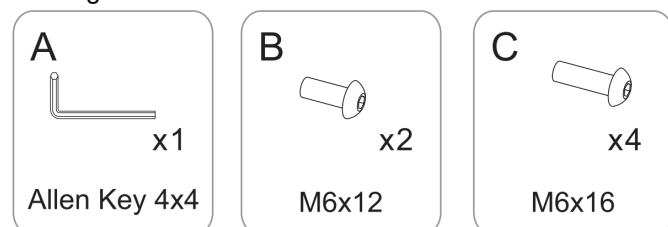

Parts Included

- 1. GD Tabletop
- 2. Lifting Column
- 3. Footx1

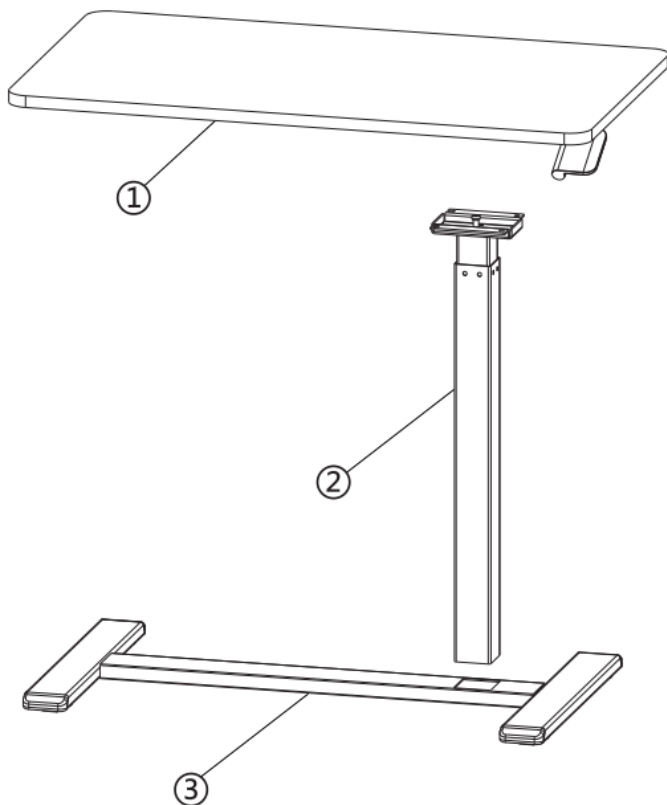

Step 1: Connect the lifting column to the tabletop

Connect the lifting column (2) to the tabletop (1) with M6x12 screws (B) and use the 4x4 allen key (A) to tighten.
 —11CThr—,

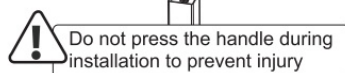

Remove the gas spring cover before installation.

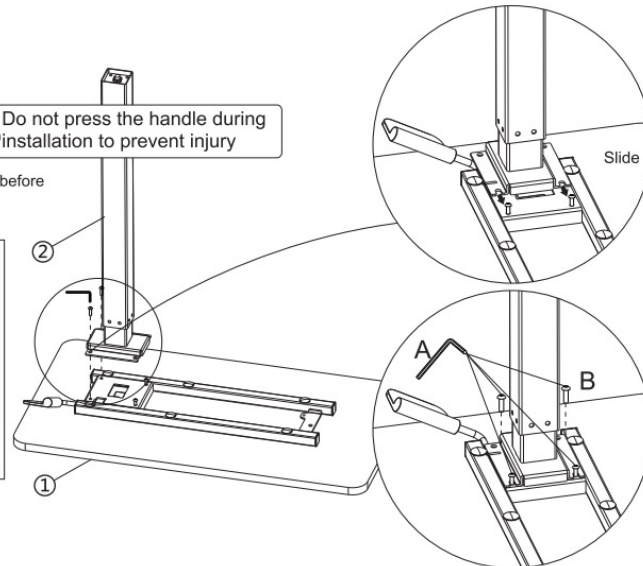
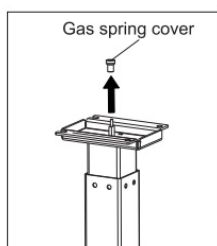

Step 2: Install the foot

Connect the foot (3) to components in **STEP 1** with M6x16 screws (C) and use the 4x4 allen key (A) to tighten. .0

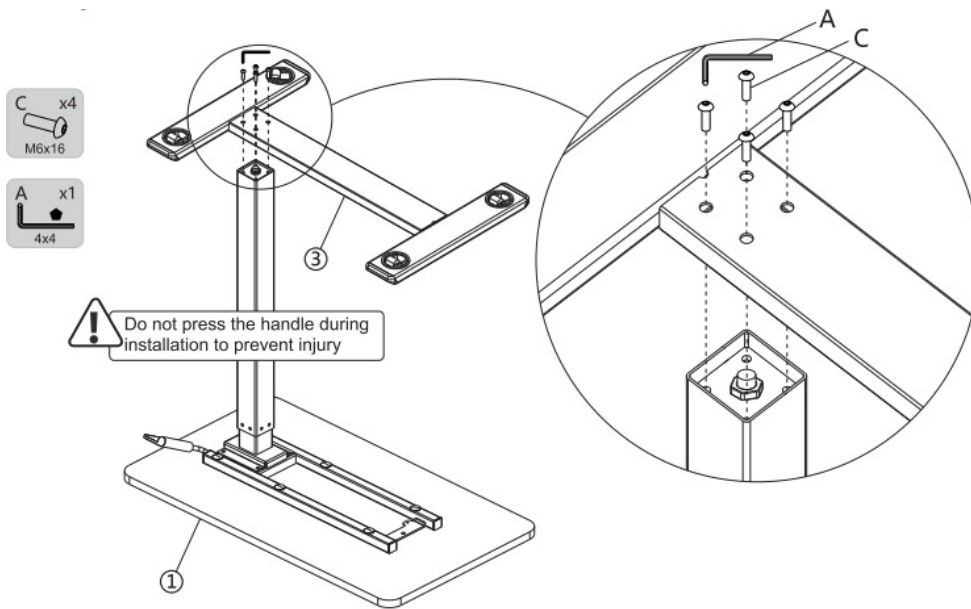

Step 3: Adjust the height of the tabletop

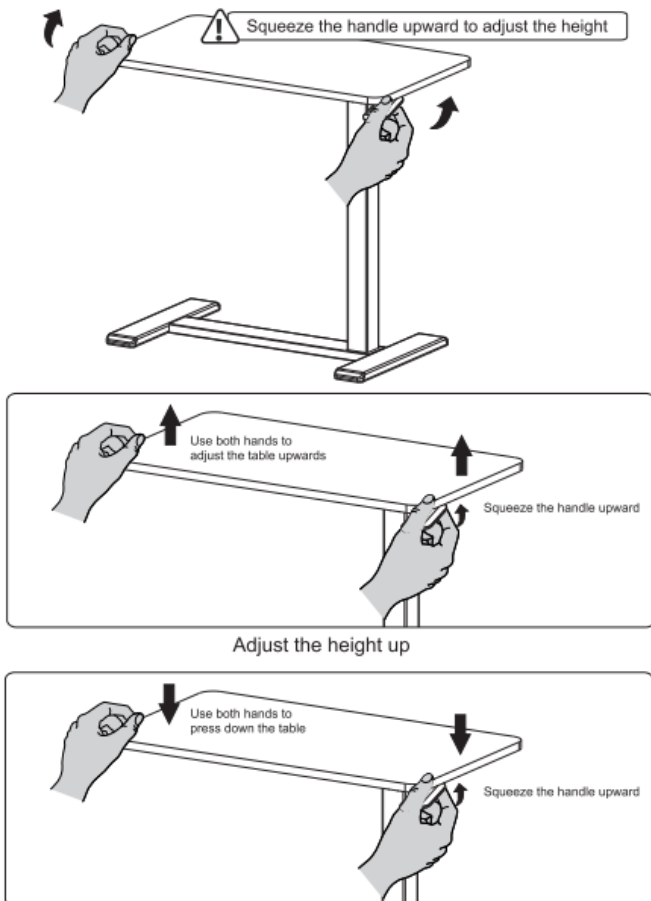

Attention

There are spare parts in the package which will lead to asphyxia if swallowed by accident. Please keep the spare parts out of the reach from children.

- Make sure you have read and understood the manual for installation. Please contact the specialized persons if there's any confusion in the steps.
- Children are forbidden to play on the product because of unforeseen action when playing so any dangerous

consequences caused by this improper action will not occur.

- This appliance can be used by children aged from 8 years and above and persons with reduced physical, sensory or mental capabilities or lack of experience and knowledge if they have been given supervision or instruction concerning use of the appliance in a safe way and understand the hazards involved. Children shall not play with the appliance.
- Children must not perform cleaning and user maintenance without supervision.
- Please make sure there are no hazard sources in your operating environment. e.g., do not litter the tools around. Always be careful to treat the packaging materials in order to avoid any possible danger, e.g. plastic bag may lead to a choking hazard to children.
- Keep the original package of the equipment in case of future use in transportation or whenever necessary.
- The electric box contains electronic components, metals, plastics, wires etc., so dispose of it in accordance with each country's environmental legislation, not the general household waste.

Recycling and Disposal



This product cannot be disposed of as household waste. To prevent damage to the environment, this product should be recycled. Please use the relevant recycling systems available to you or contact the distributor or manufacturer for recycling assistance.

Limited Warranty

This limited warranty covers defects in material or workmanship in new products. This warranty extends to the original purchaser only and is non-transferable.

What is Covered?

The limited warranty covers our products against defects in material or workmanship as follows:

Mobile Standing Desk

All mobile standing desks feature a 5-year warranty for the frame and 3-year warranty for the gas spring system and other mechanisms.

What are your Remedies?

We will replace at no charge to the consumer the defective parts only or, at our option, replace any product or part of the product that is defective because of improper workmanship and/or material, under normal installation, use, service and maintenance. If we are unable to provide a replacement and repair is not practical or cannot be completed in a timely fashion, we may elect to refund the purchase price in exchange for the return of the product. In the rare event that your product is defective, we will provide you with a replacement item shipped at no cost to you within the continental United States. The shipping method for replacement products is FedEx Ground, but expedited shipping is available if you choose to pay the additional expense. In addition, you will need to pay the shipping costs if any products need to be shipped to you at an address outside the continental United States.

REPAIR OR REPLACEMENT (OR, IN LIMITED CIRCUMSTANCES, REFUND OF THE PURCHASE PRICE) AS PROVIDED UNDER THIS WARRANTY IS THE EXCLUSIVE REMEDY OF THE PURCHASER. WE NEITHER ASSUME NOR AUTHORIZE ANY PERSON TO CREATE FOR ANY OTHER OBLIGATION OR LIABILITY IN CONNECTION WITH THIS PRODUCT.

What is Not Covered?

Our limited warranty does not cover any problem that is caused by:

1. Conditions, malfunctions or damage not resulting from defects in material or workmanship.
2. Conditions, malfunctions or damage resulting from normal wear and tear, improper installation, improper maintenance, misuse, abuse, negligence, accident or alteration.
3. Accessories, connected materials and products, or related products not manufactured by ours.
4. Conditions, malfunctions or damage resulting from failure to follow the instructions and guidelines relating to the product's intended use. Our limited warranty is void if a product is returned with removed, damaged or tampered labels or any alterations **(including removal of any component or external cover)**.

How to File a Claim?

In order to receive the benefit of our limited warranty, you need to process your claim in compliance with the terms of this limited warranty and follow proper return procedure. To request warranty service, please contact customer service, toll free at +1 (855) 585-5618. You will need to provide the sales receipt or other evidence of the date and place of purchase for your product.

Implied Warranties and Limitation of Damages

EXCEPT TO THE EXTENT PROHIBITED BY APPLICABLE LAW, ALL IMPLIED WARRANTIES (INCLUDING WARRANTIES OF MERCHANTABILITY AND FITNESS FOR A PARTICULAR PURPOSE) SHALL BE LIMITED IN DURATION TO THE DURATION OF THIS WARRANTY, AND WE SHALL NOT BE LIABLE FOR ANY INCIDENTAL, INDIRECT, SPECIAL, OR CONSEQUENTIAL DAMAGES, INCLUDING BUT NOT LIMITED TO LOSS OF PROFITS OR REVENUE, RESULTING FROM ANY BREACH OF EXPRESS OR IMPLIED WARRANTY OR CONDITION, OR UNDER ANY OTHER LEGAL THEORY, EVEN IF WE HAVE BEEN ADVISED OF THE POSSIBILITY OF SUCH DAMAGES. Some jurisdictions do not allow limitations on the duration of an implied warranty or the exclusion or limitation of special, indirect, incidental or consequential damages, so the above limitations or exclusions may not apply to you.

Governing Law

This Warranty shall be governed by the laws of the State of California, USA, without giving effect to any conflict of laws principles that may provide the application of the law of another jurisdiction.

How State Law Applies

This Warranty gives you specific legal rights, and you may also have other rights which vary from state to state.

Item No. H6W-2816/H6B-2816

Documents / Resources

	FLEXISPOT H6W-2816 Height Adjustable Overbed Table [pdf] Installation Guide H6W-2816 Height Adjustable Overbed Table, H6W-2816, Height Adjustable Overbed Table, Adjustable Overbed Table, Overbed Table
---	--