

FlatFrog
EFLEXTT-S01
Flex
Team
Tablet



FlatFrog EFLEXTT-S01 Flex Team Tablet User Guide

[Home](#) » [FlatFrog](#) » FlatFrog EFLEXTT-S01 Flex Team Tablet User Guide 

Contents

- [1 FlatFrog EFLEXTT-S01 Flex Team Tablet](#)
- [2 Specifications](#)
- [3 Product Usage Instructions](#)
- [4 FCC STATEMENT](#)
- [5 FAQ](#)
- [6 Documents / Resources](#)
 - [6.1 References](#)
- [7 Related Posts](#)



FlatFrog EFLEXTT-S01 Flex Team Tablet



Specifications

- Product: TeamTablet™ Flex

- Antennas: EU, US, UK
- Connectivity: HDMI input/output, USB C-A, USB A-B
- Power adapter: EU, US, UK
- Optional: HDMI splitter, mount with hangers

Contents

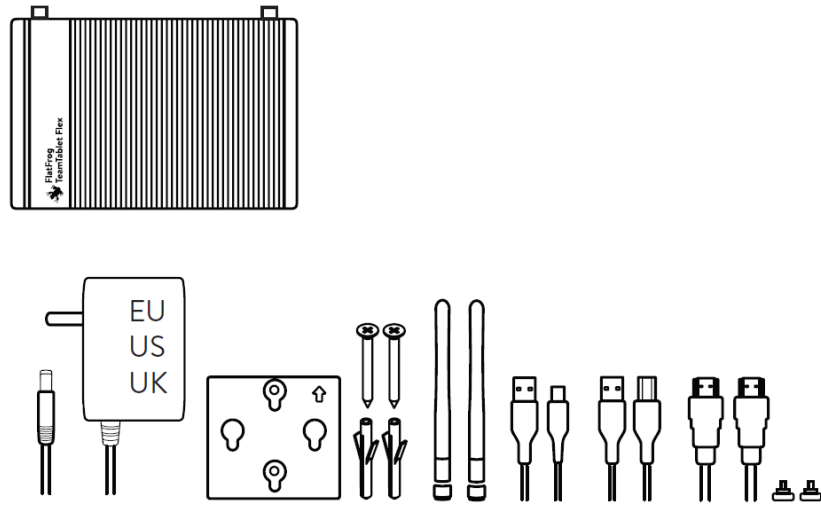

Product Usage Instructions

1. Attaching Antennas

Attach the antennas according to your region (EU, US, UK).

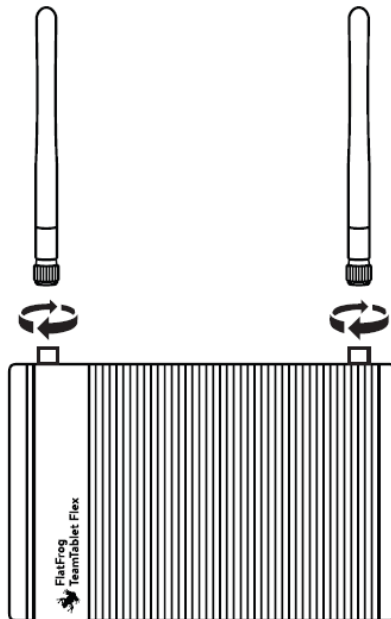

2. Connecting the Device

Connect the device using the provided cables and ports as follows:

- All-In-One: Video Bar – HDMI input (cable not included)
- Video Bar: Touch output USB C-A
- Power adapter: EU, US, UK
- Touch input USB A-B
- HDMI output

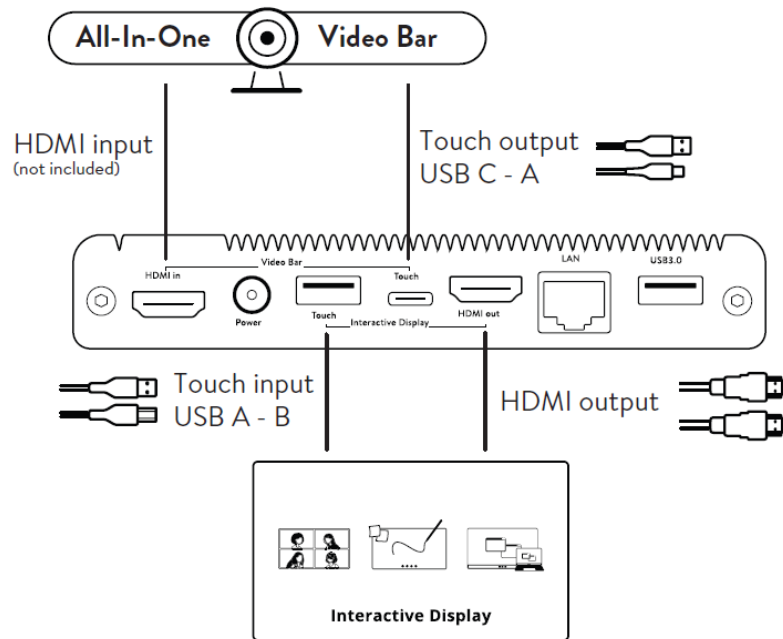
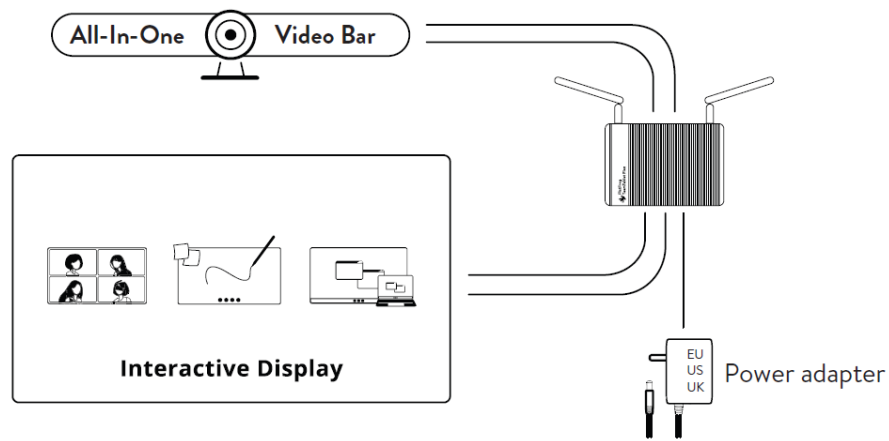

HDMI Splitter Setup

For details on setting up the HDMI output splitter, scan the QR code on the backside. (HDMI splitter and additional cables sold separately).

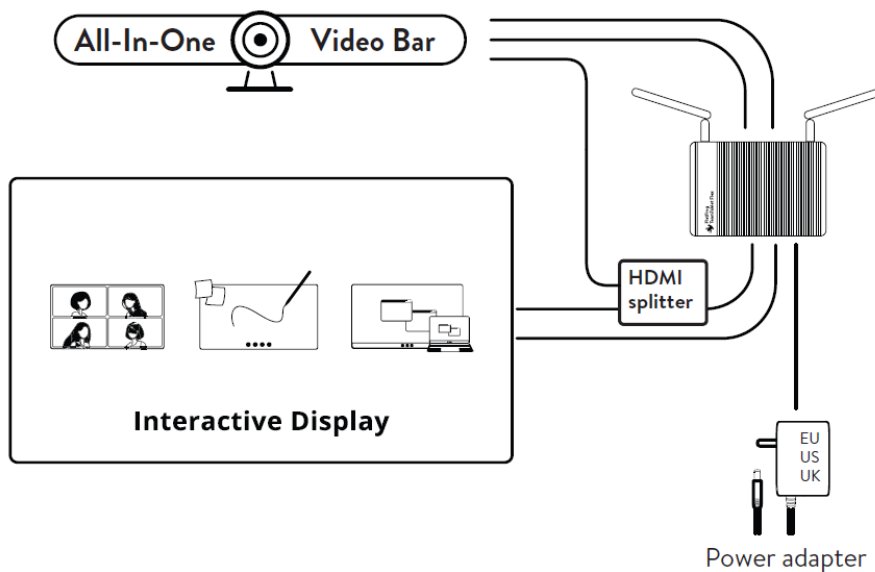

Optional Mount with Hangers

Install the optional mount with hangers for added convenience.

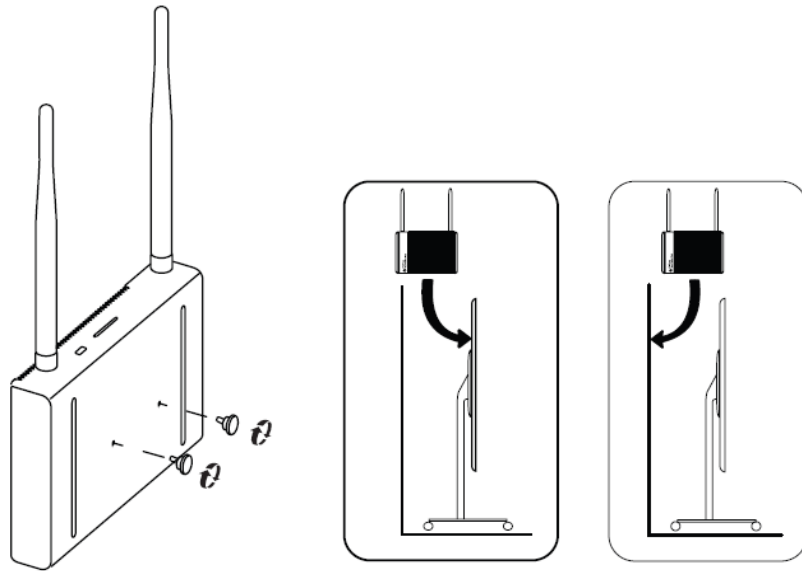

FCC STATEMENT

FCC Warning

This device complies with part 15 of the FCC rules. Operation is subject to the following two conditions: (1) this device may not cause harmful interference, and (2) this device must accept any interference received, including interference that may cause undesired operation. Changes or modifications not expressly approved by the party responsible for compliance could void the user's authority to operate the equipment.

NOTE: This equipment has been tested and found to comply with the limits for a Class B digital device, pursuant to part 15 of the FCC Rules. These limits are designed to provide reasonable protection against harmful interference in a residential installation. This equipment generates uses and can radiate radio frequency energy and, if not installed and used in accordance with the instructions, may cause harmful interference to radio communications. However, there is no guarantee that interference will not occur in a particular installation. If this equipment does cause harmful interference to radio or television reception, which can be determined by turning the equipment off and on, the user is encouraged to try to correct the interference by one or more of the following measures:

- Reorient or relocate the receiving antenna.
- Increase the separation between the equipment and receiver.
- Connect the equipment into an outlet on a circuit different from that to which the receiver is connected.
- Consult the dealer or an experienced radio/TV technician for help.

Radiation Exposure Statement

This equipment complies with FCC radiation exposure limits set forth for an uncontrolled environment. This equipment should be installed and operated with minimum distance 20cm between the radiator and your body.

FAQ

Q: What should I do if I encounter interference?

A: Ensure the device is compliant with FCC rules and maintain a minimum distance of 20cm between the device and your body to reduce interference.

Q: Can I modify the device?

A: Any changes or modifications not approved by the responsible party may void the user's authority to operate the equipment.

For more information please follow the link.

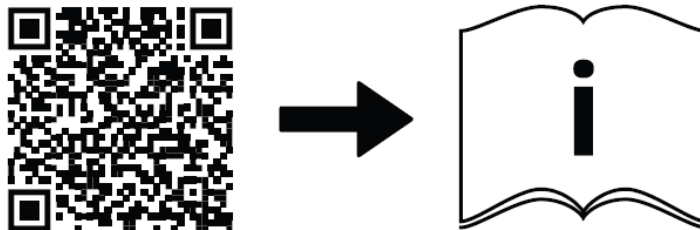

<https://help.flatfrog.com/en/knowledge/teamtablet-flex>

Documents / Resources

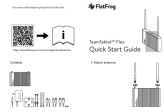
	<p>FlatFrog EFLEXTT-S01 Flex Team Tablet [pdf] User Guide EFLEXTT-S01, EFLEXTT-S01 Flex Team Tablet, Flex Team Tablet, Team Tablet, Tablet</p>
---	--

References

- [User Manual](#)

[Manuals+](#), [Privacy Policy](#)

This website is an independent publication and is neither affiliated with nor endorsed by any of the trademark owners. The "Bluetooth®" word mark and logos are registered trademarks owned by Bluetooth SIG, Inc. The "Wi-Fi®" word mark and logos are registered trademarks owned by the Wi-Fi Alliance. Any use of these marks on this website does not imply any affiliation with or endorsement.