

## FLASHFORGE Adventurer 4 Pro 3D Printer User Guide

[Home](#) » [FLASHFORGE](#) » FLASHFORGE Adventurer 4 Pro 3D Printer User Guide 

### FLASHFORGE Adventurer 4 Pro 3D Printer

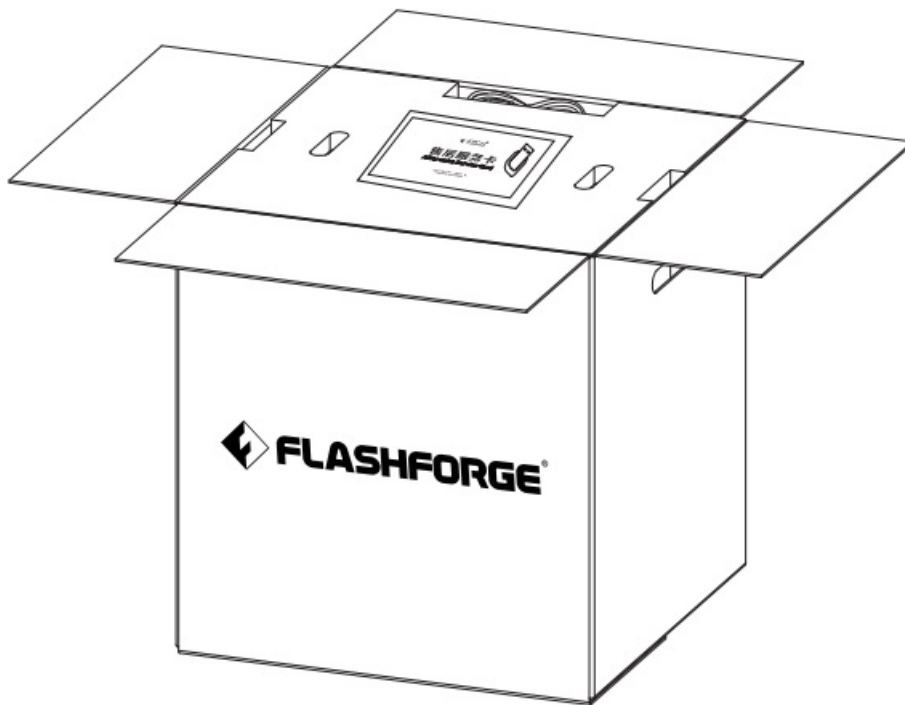

## Contents

- 1 **WARNING**
- 2 **Unpacking**
- 3 **Kit Contents**
- 4 **Getting to Know your Adventurer 4Pro**
- 5 **First Printing**
- 6 **Customer Service**
- 7 **Documents / Resources**
- 8 **Related Posts**

## WARNING



1. Do not remove the wrapping around the nozzle .
2. Hot! Avoid touching the heating nozzle in operation .
3. Moving parts in the printer may cause injuries. Do not wear gloves or other sources of entanglement in operation.

This guide is only applicable to FLASHFORGE Adventurer 4Pro 3D printer.



Scan the QR code to view the unboxing video, which is also accessible on the USB flash drive.

Please go to Flashforge's Official Website ([www.flashforge.com](http://www.flashforge.com)) – select [Support] – [Download Center] – [Adventurer 4 Pro] to download and view the electronic User Guide.

## Unpacking

1. Open the carton.

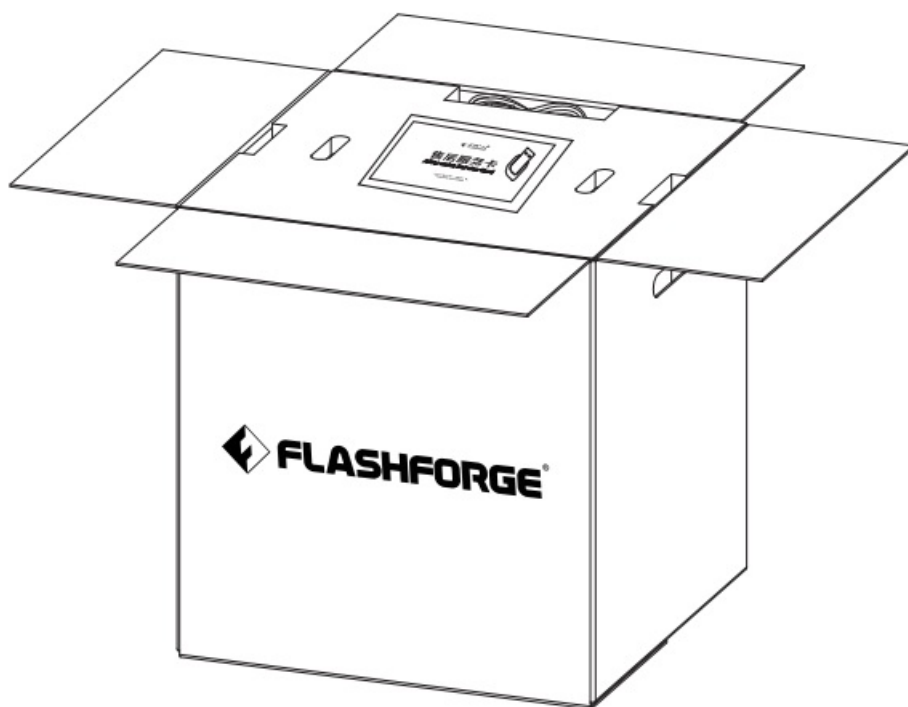

2. Take out the top foam box, power cord, after-sales service card, user guide and USB flash drive.

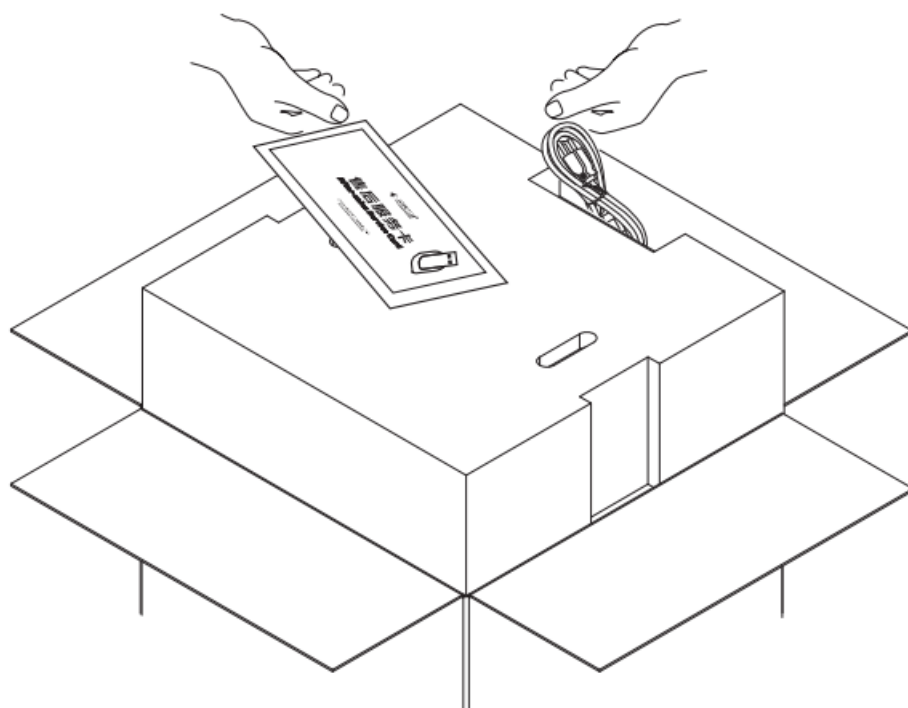

3. Take out the printer from the carton, and remove the bubble wrap around the printer. Tear off the fixing tapes and the front door protective bag.

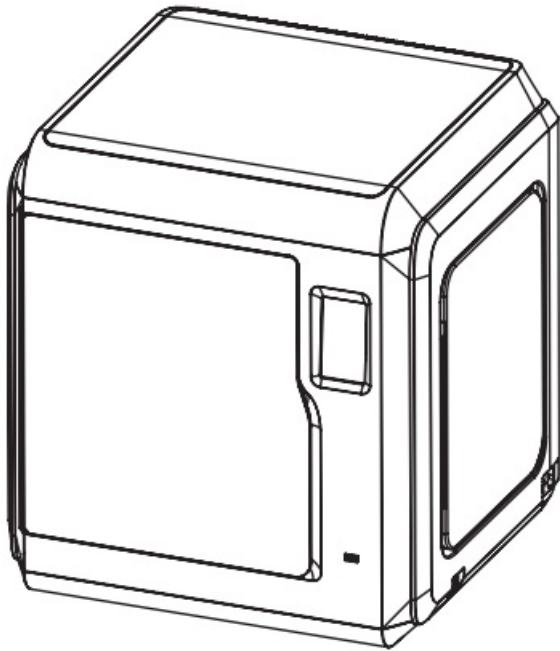

4. Open the front door of the printer and take out the EPE foam filled inside and filament.

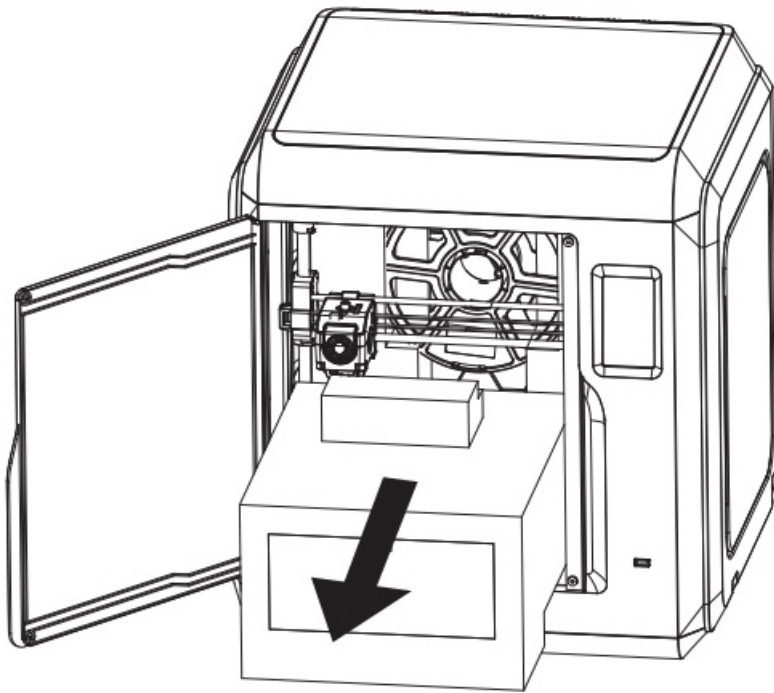

5. Take out the printer from the carton, and remove the bubble wrap a round the printer. Tear off the fixing tapes and the front door protective bag.

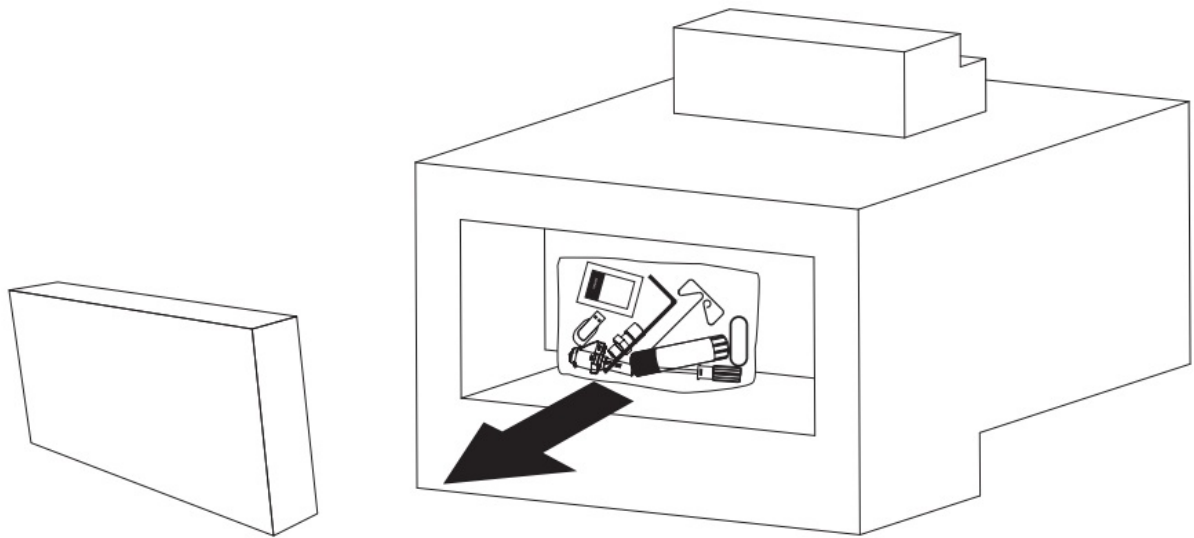

6. Open the side door of the printer and the cover above the filament chamber, take out the EPE foam filled inside, and unpacking is finished.

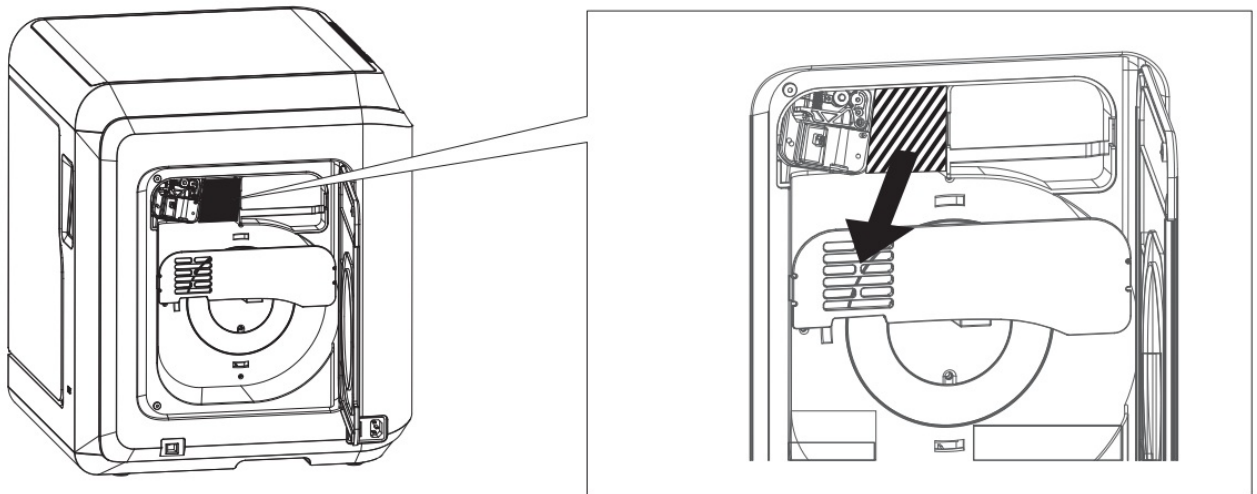

## Kit Contents

- 3D Printer

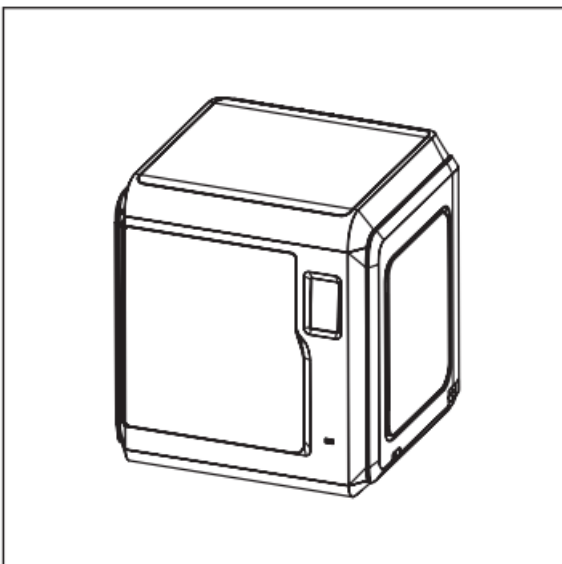

- Filament

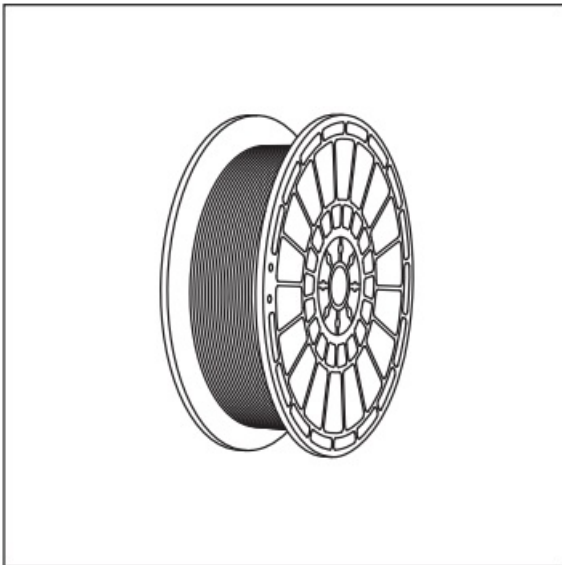

- Power Cable

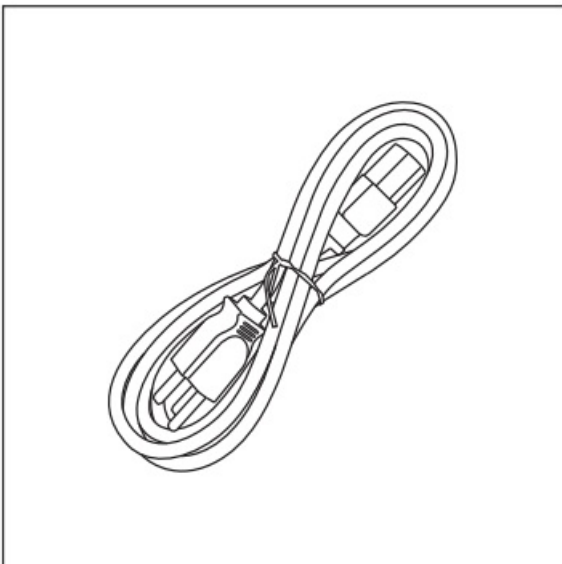

- After-Sales Service Card



- Quick Start Guide

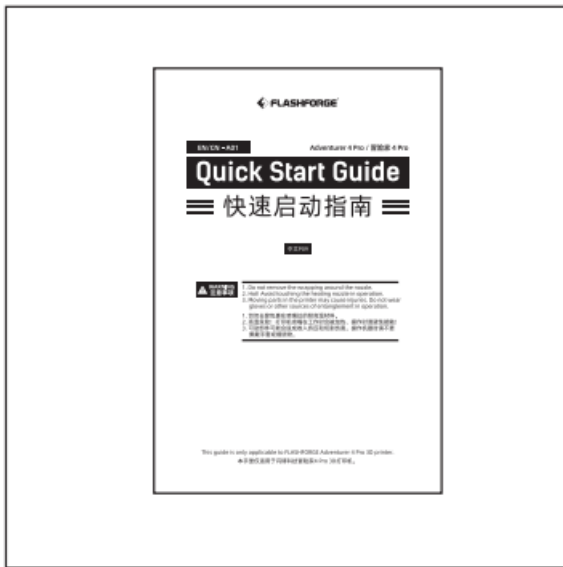

- 0.6-265 Nozzle

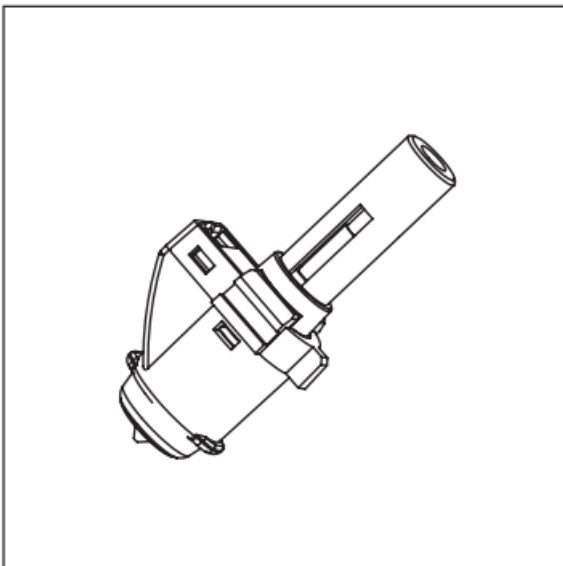

- Screwdriver

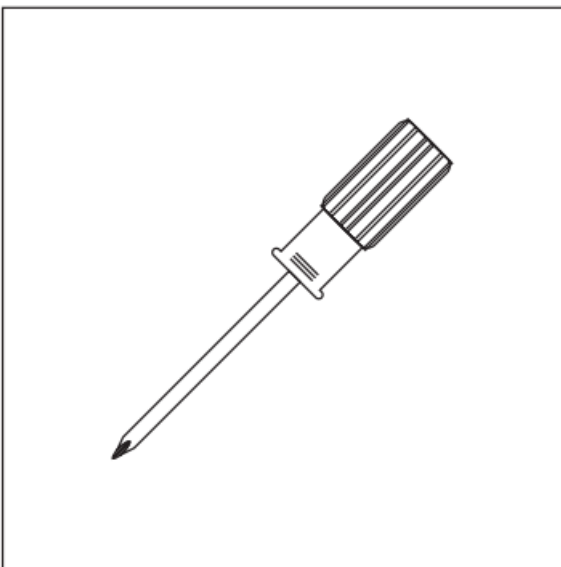

- Unclogging Pin Tool

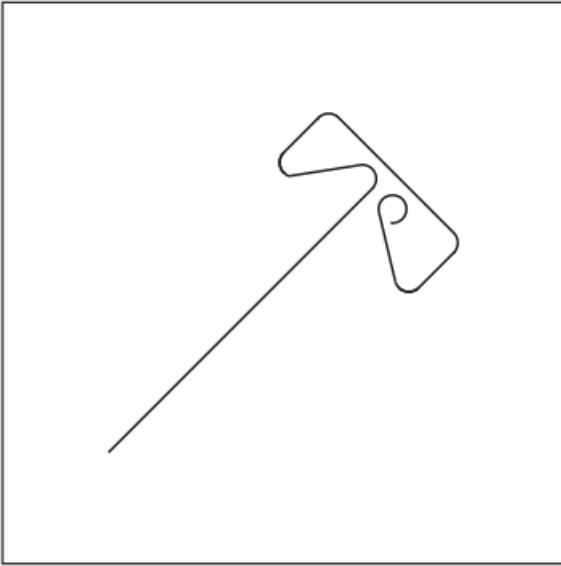

- Allen Wrench

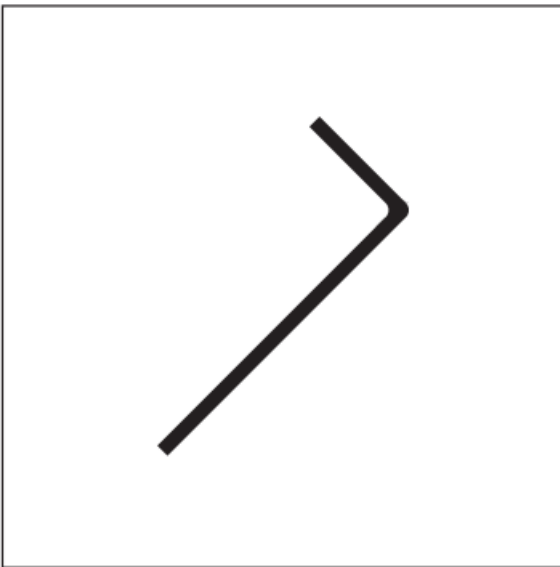

- Grease

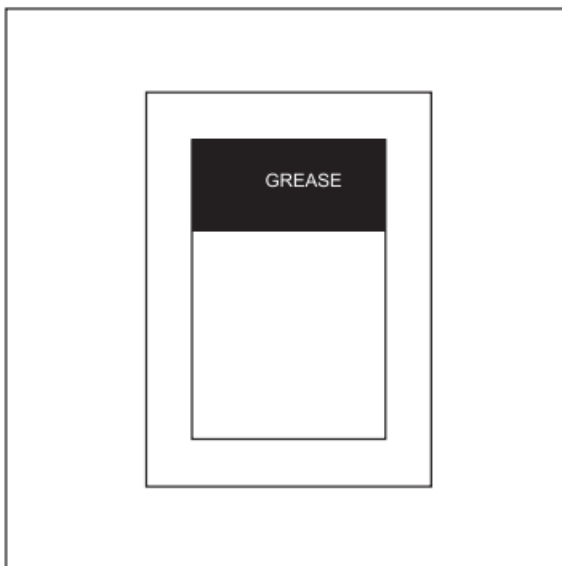

- USB Flash Drive



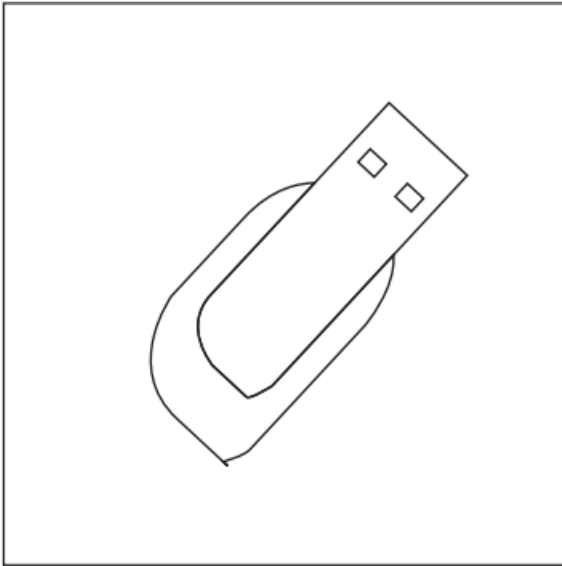

- Leveling Card

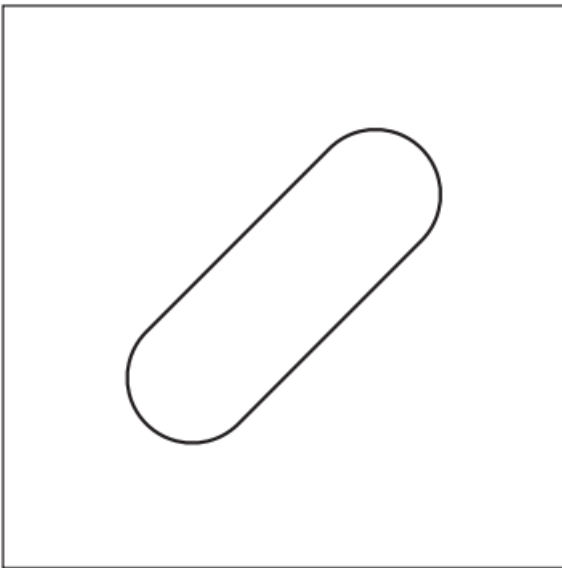

- Filament Guide Tube Joint

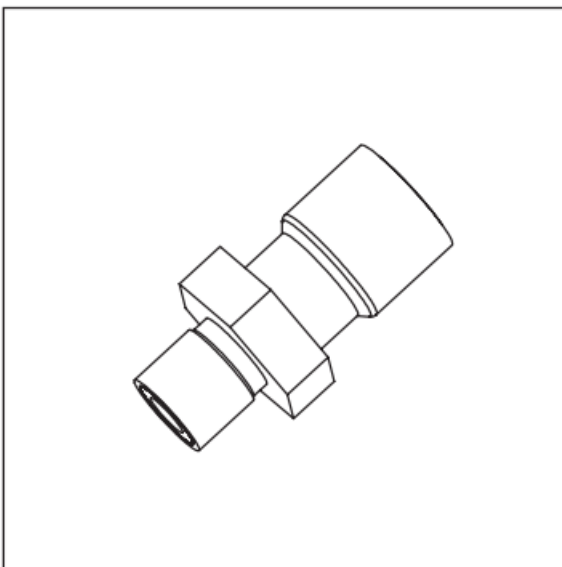

- Glue Stick

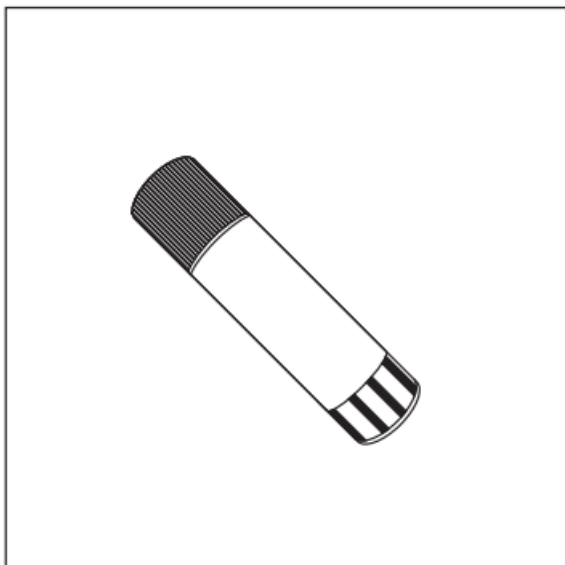

## Getting to Know your Adventurer 4Pro

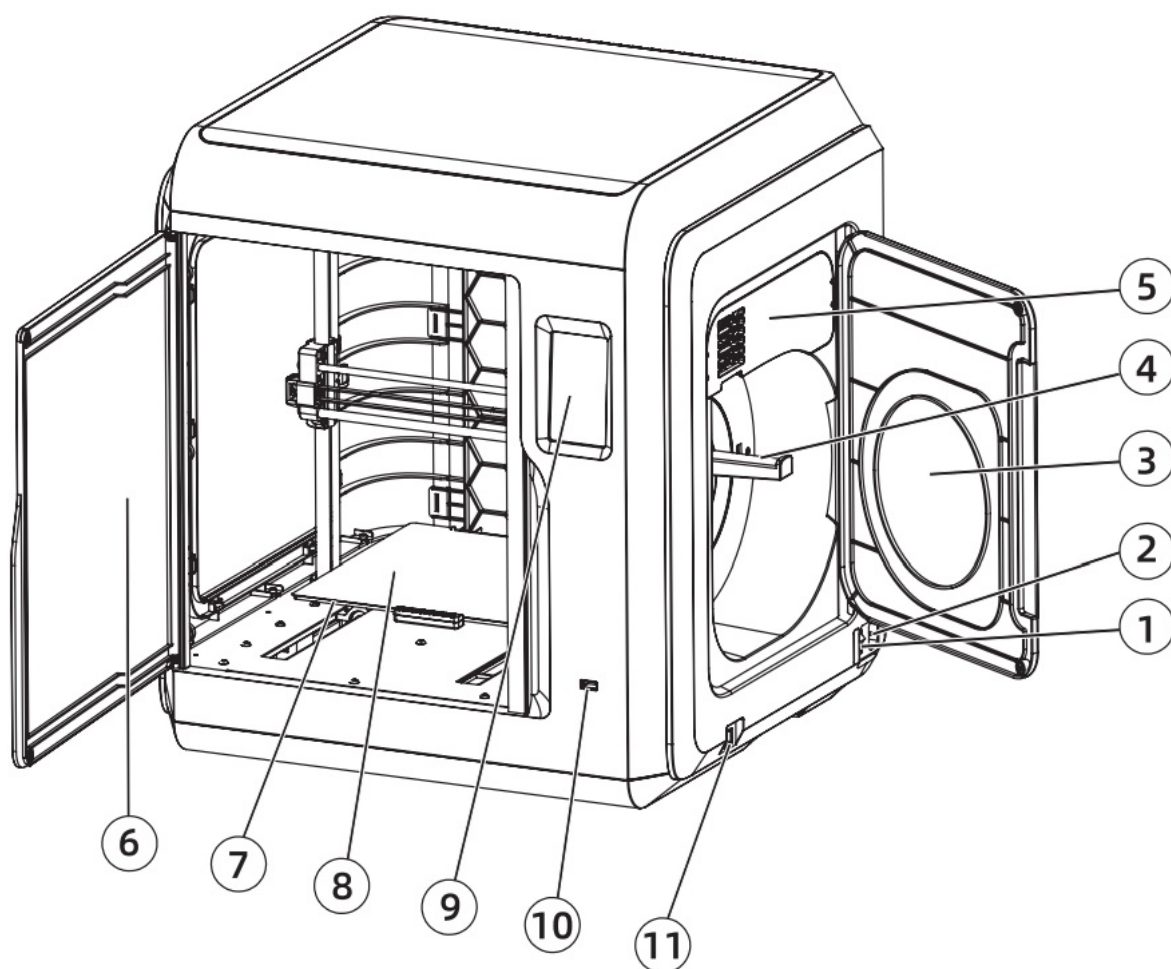

1. Power switch
2. power socket
3. Filament Cover
4. Spool holder
5. Filament intake cover
6. front cover

- 7. Platform base
- 8. Builds plate
- 9. Touch Screen
- 10. USB
- 11. Ethernet input

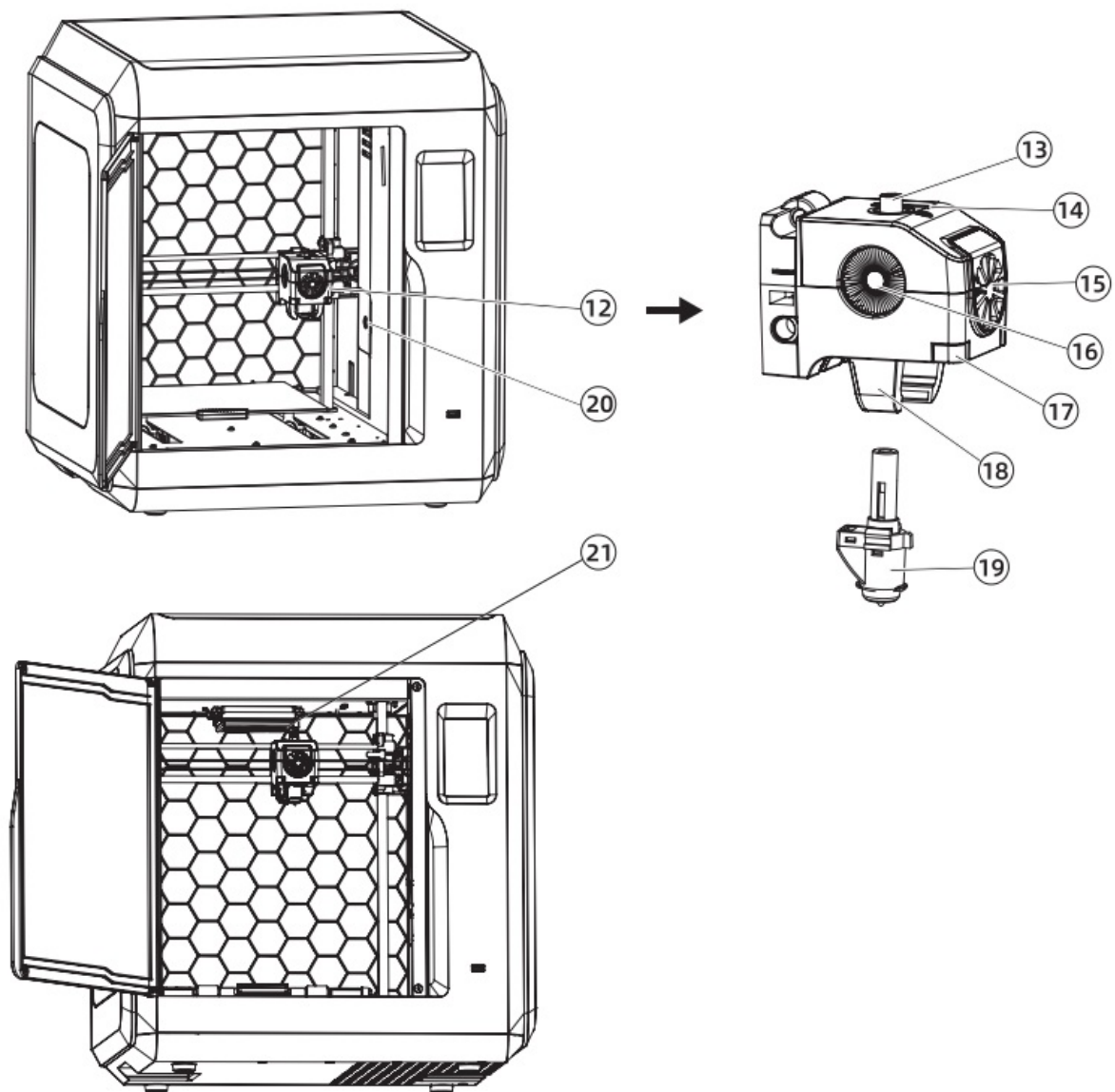

- 12. Extruder
- 13. Filament guide tube joint
- 14. Cable slot
- 15. Fan for cooling the extruder
- 16. Fan for cooling the model
- 17. Buckle
- 18. Air duct
- 19. Nozzle
- 20. Camera
- 21. Air filter

## First Printing

## Connect to power

Connect the cable to the printer, turn on the switch and the screen lights up.

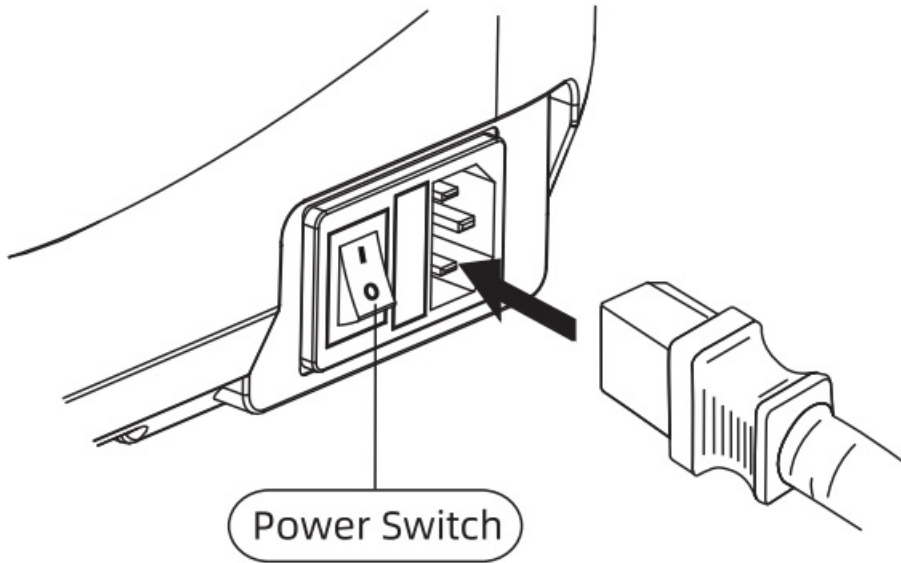

## Leveling and calibration

### Note

The equipment has been leveled and calibrated before delivery, but due to transportation or other influences, the distance between nozzle and platform may change. It is recommended to conduct [Calibration] after unpacking.

1. Click on [Maintain] – [Calibration]- [Normal Mode] to start pre-calibration. The first point is to calibrate the initial distance between the extruder and the platform. Click the Up and Down arrows to adjust the Z-axis deviation value; Insert a leveling card between the nozzle and the platform. If it can not be inserted, it means that the nozzle and the platform are too close. Click the Up arrow to make the nozzle away from the platform.

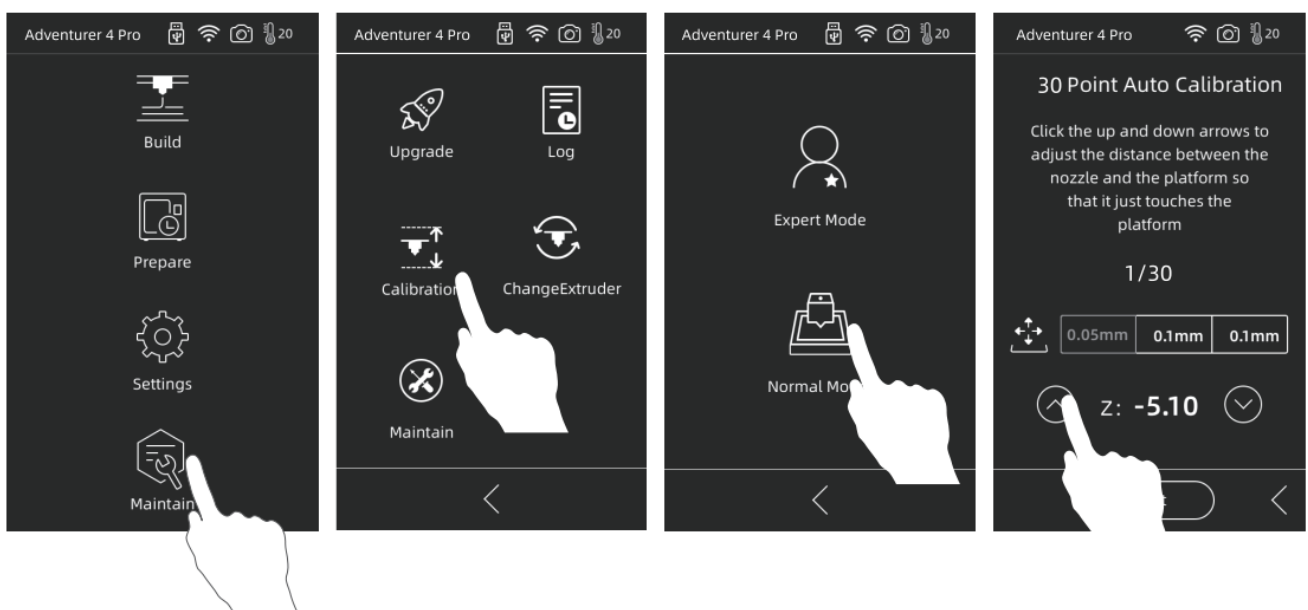

2. Insert and slide the leveling card. If there is no frictional resistance, click the Down arrow to make the nozzle

closer to the platform; When there is slight friction resistance, it means that the distance is appropriate.

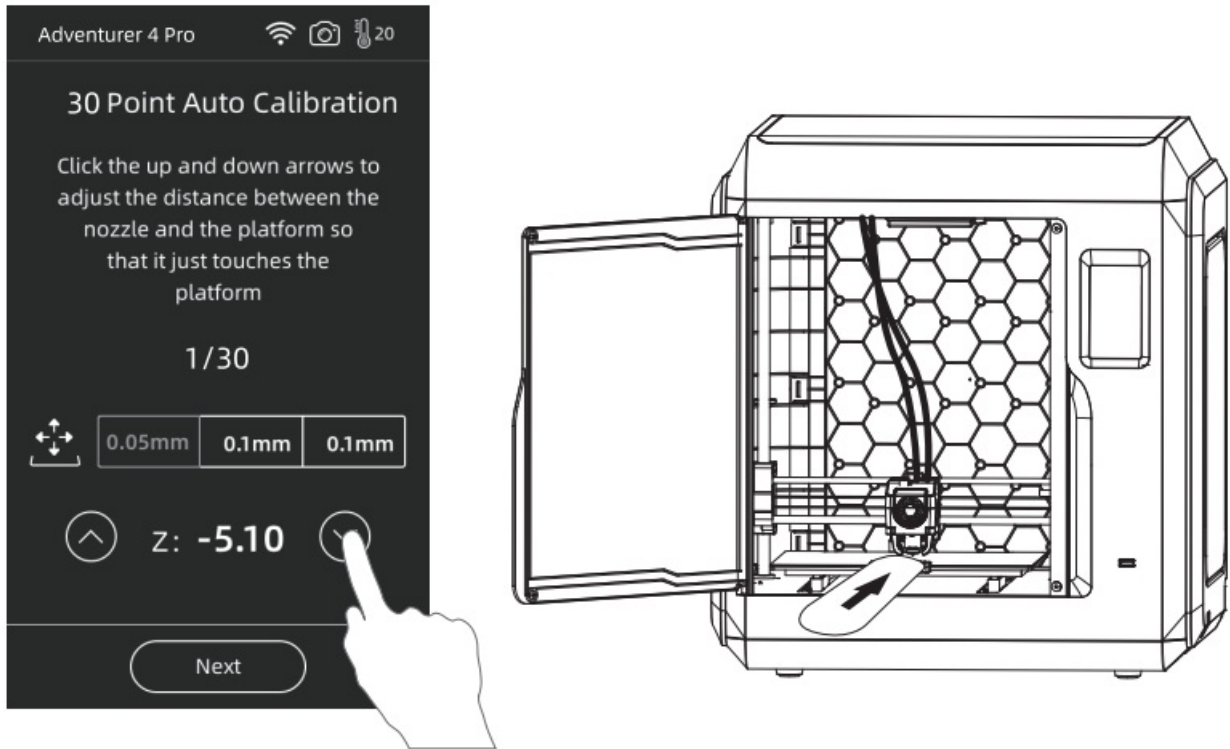

3. After calibrating the first point, please follow the on-screen prompts to continue the 30-point automatic leveling.

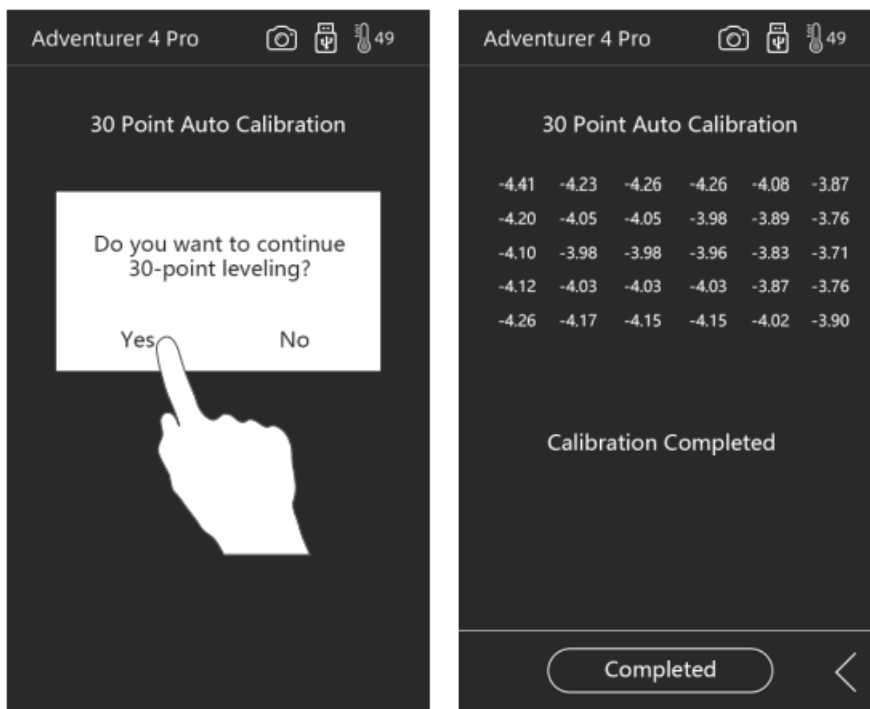

For specific operation, you can refer to the video.

**The link path is as follows:**

Flashforge's Official Website – Support – Video Center – select [Operation Videos] – [Adventurer 4 Pro] Scan the QR code to view the video.



## Filament Loading

1. Open the filament cover on the right side, insert the filament into the filament intake, push the filament into the feeding wheel until some resistance is sensed.

### Note

Please make sure the filament is inserted into the feeding wheels!

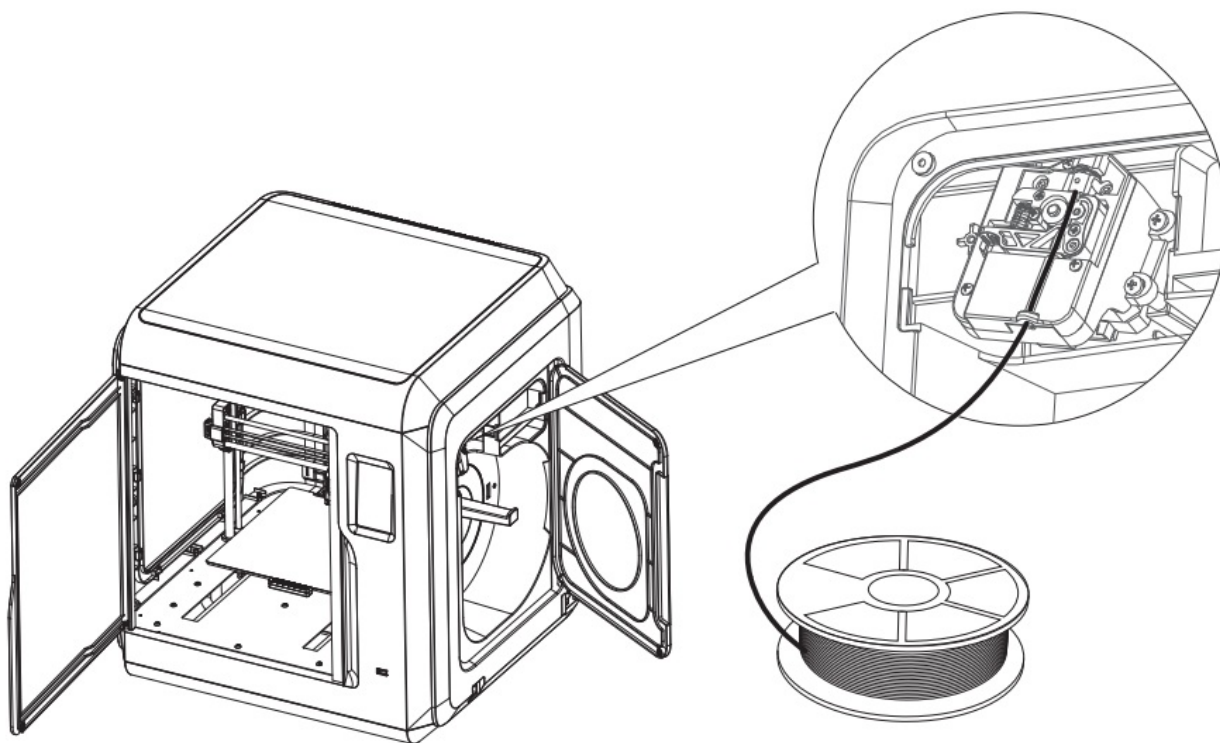

2. Put the spool of filament on the spool holder and close the filament cover.

Mind the loading direction of filament. Make sure it is clockwise as the picture shows. If the filament is loose, please arrange it according to the filament extrusion direction and then put it back on the spool holder.

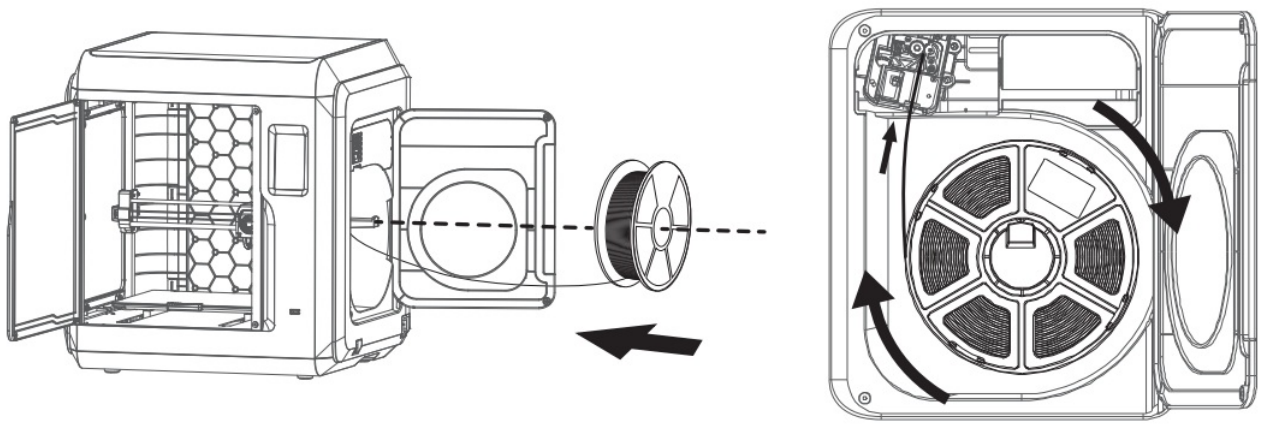

3. Tap [Prepare]-[Filament]-[Load]. Follow the instruction, filament coming out of the nozzle indicates a success.

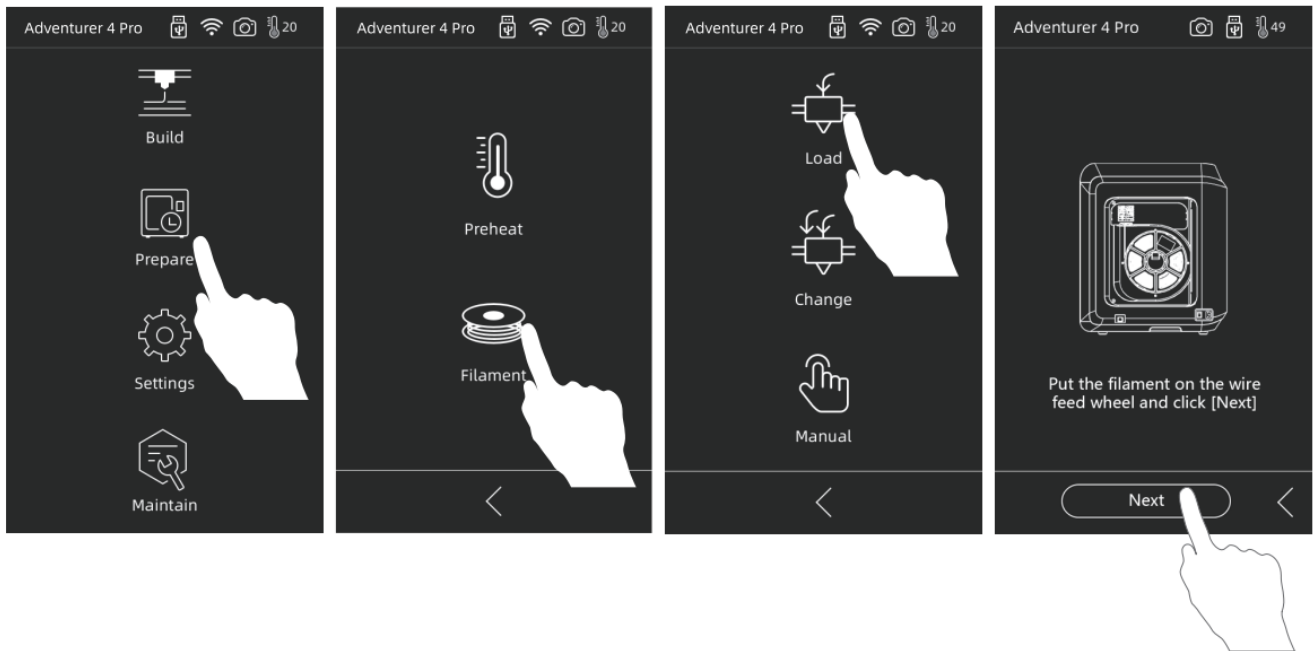

## Model Printing

**Method 1:** Print local files Select [Build], and then select [Local Files]. Select a model file in the list to pr

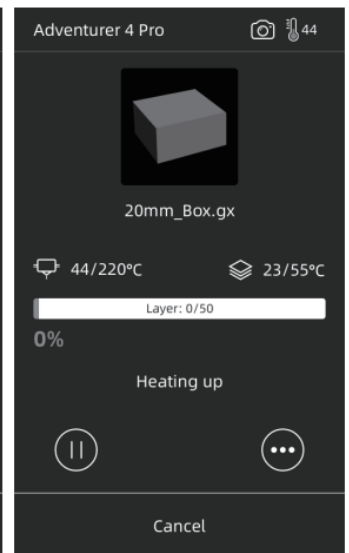
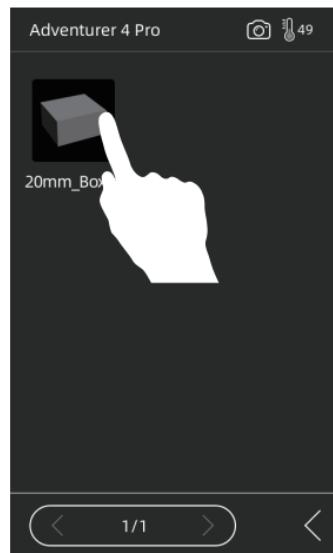
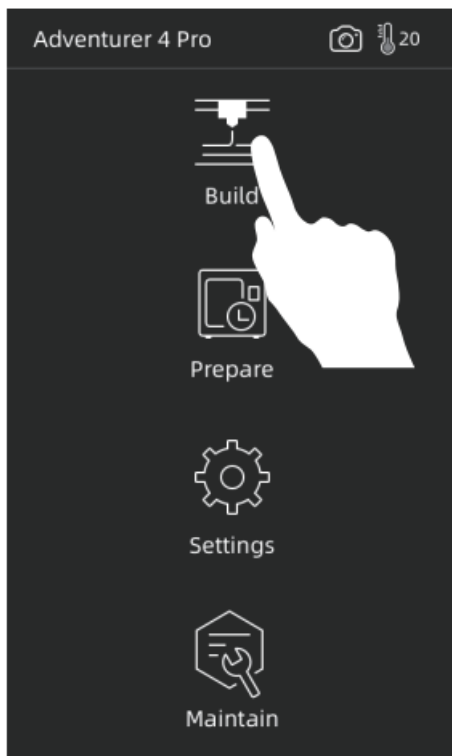

## Method 2: Print from a USB flash drive.

Insert the randomly delivered USB flash drive, which contains sliced test files, into the printer. It can be directly used to complete the first printing.

Click [Build] – [USB Device], open the Test file, select the model file, and enter the printing interface to start printing.



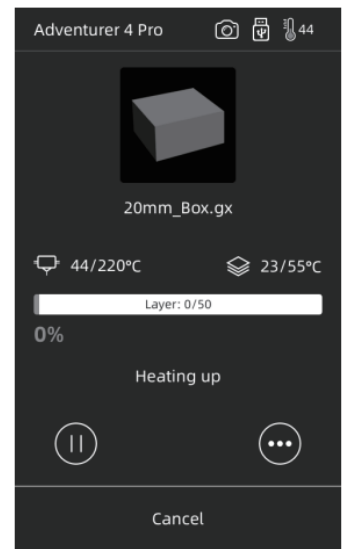
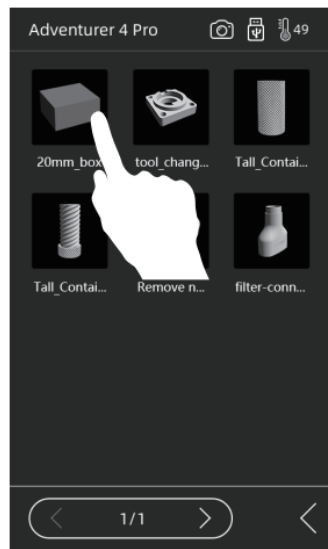
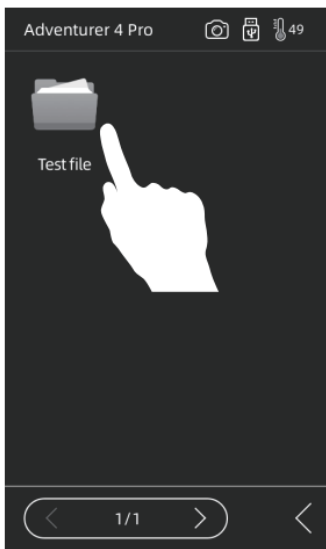
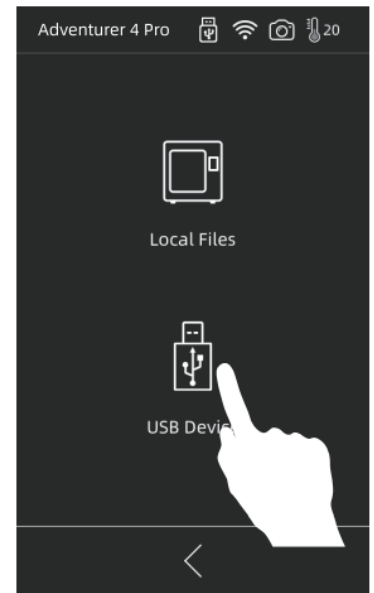
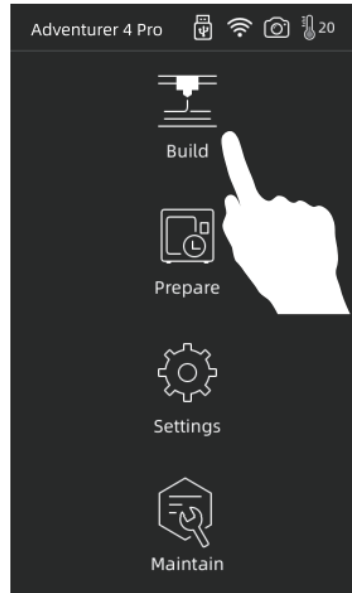
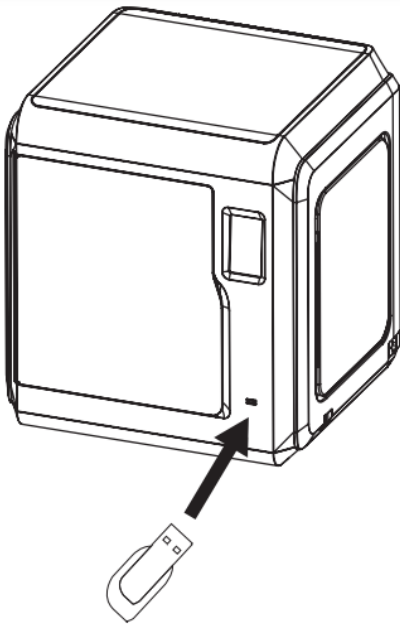

## Model Removal

Take out the removable build plate, and bend the plate to get the model. When printing for the second time, please ensure that there is no residual filament on the platform.

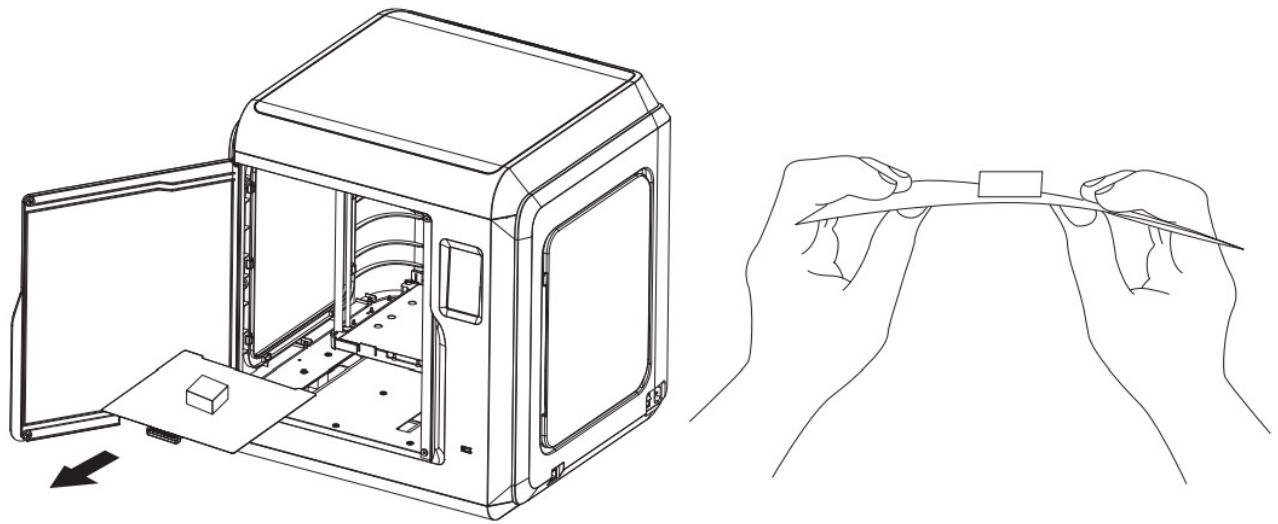

### Note

- The nozzle and build plate are still hot after finishing printing. Please wait for them to cool down before conducting operation.
- The back side of the build plate is designed exclusively for PETG. Please use the back when printing with PETG.
- Please remove models after the platform has cooled down. If models are removed when the platform is not completely cooled down, bubbles will occur on the surface of the platform.
- It is recommended to take the platform to the outside of the equipment for model removal, otherwise the model debris will remain in the equipment. Please keep the inside of the printer clean.



### Customer Service

Zhejiang Flashforge 3D Technology Co., Ltd.  
Address: No.518 XianYuan Road, Jinhua City, Zhejiang Province, China



Documents / Resources

	<p><a href="#">FLASHFORGE Adventurer 4 Pro 3D Printer</a> [pdf] User Guide Adventurer 4 Pro, Adventurer 4 Pro 3D Printer, 3D Printer, Printer</p>
---	---