



# FLASH FLZ-2000 DMX Fog Machine UP with LED 3 In 1 User Manual

[Home](#) » [FLASH](#) » FLASH FLZ-2000 DMX Fog Machine UP with LED 3 In 1 User Manual 

## Contents

- [1 FLASH FLZ-2000 DMX Fog Machine UP with LED 3 In 1](#)
- [2 INTRODUCTION](#)
- [3 SAFETY INFORMATION](#)
- [4 PRODUCT INFORMATION](#)
- [5 INSTALLATION](#)
- [6 OPERATION](#)
- [7 Documents / Resources](#)
  - [7.1 References](#)
- [8 Related Posts](#)



**FLASH**

**FLASH FLZ-2000 DMX Fog Machine UP with LED 3 In 1**



## INTRODUCTION

THANK YOU FOR PURCHASING FLZ-2000 DMX FOG MACHINE UP + LED 3in1. FOR SAFETY REASONS AND TO ENSURE THE TROUBLE-FREE OPERATION, CAREFULLY READ THE INSTRUCTIONS.

## SAFETY INFORMATION

### Attention

- Please obey all notices about operation, safely and repair to avoid getting an electric shock and keep the excellent effect. Keep clean. For indoor use only. The power must same as located. Put in the horizontal direction and don't incline or place upside down. Pull out plug after use. The unit is not waterproof, if there are same humidity, water or fog liquid in, please switch off power and contact distributor as soon as possible.
- There are no spare parts inside the machine. If you need to repair it, please contact distributor or professional repair works. Defective mains cables may only be replaced by specialists. Danger of shock hazard! Do not leave the packaging material lying around carelessly since it can become a source of danger for children playing with it.
- The accident prevention regulations and the regulations of the employers' liability insurance association should be observed at commercial institutions. If you are not sure about the correct connection or if questions arise which are not answered by the operating instructions, please do not hesitate to contact support or a specialist of your choice. Consult a specialist if you are in doubt the operating principle or the safety of the product.
- Only for adults operate. Keep out of the reach of children and be particularly attentive during operation. This appliance is not intended for use by persons (including children) with reduced physical, sensory or mental capabilities, or lack of experience and knowledge, unless they have been given supervision or instruction

concerning the use of the appliance by a person responsible for their safety.

- Children should be supervised to ensure that they do not play with the appliance. Don't spray it to people directly and far away fire.
  - **IMPORTANT:** Do not point strong light output from other fixtures at the FLZ-2000 DMX, as intense illumination can damage the parts.

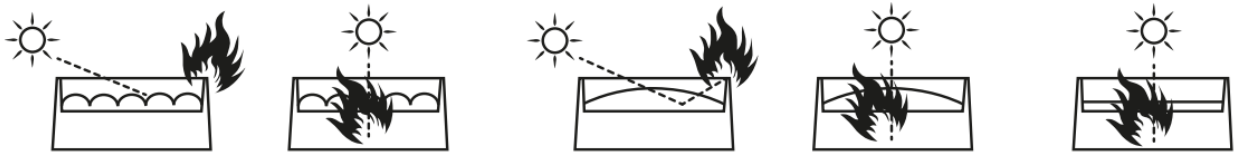

- Lenses can focus sunlight and strong light, presenting a risk of fire and damage to the fixture. Shield or shade the head if necessary.
- The temperature of the sprayer is very high so that keep the space between the machine and other material, things more than 300cm. (40°C-80°C)
- Put the machine in a well-ventilated place and don't cover the cooling holes to ensure sufficient cooling. Keep a minimum distance of 1m around the unit to ensure sufficient cooling.
- The apparatus shall not be exposed to dripping or splashing and that no objects filled with liquids, such as vases, shall be placed on the apparatus. Do not obstruct the ventilation openings or the fans by objects such as newspapers, table cloths, curtains, etc. Do not put any heat-generating devices or open fire such as candles on the unit.
- The unit should only be used in moderate climates.
- Don't add flammable liquid such as oil, gas, perfume, and etc. in the fog machine. Pay attention to all notices and operation instructions on all machines.
- Please use the high-quality fog liquid recommended by distributors. Bad-quality fog liquid may get blasted or spray oil. Often check whether there is enough fog liquid. Get out all fog liquid before transport or post.
- Don't eat fog liquid otherwise; see the doctor immediately. Use clean water to wash skin and eyes once fog liquid touches them.

## PRODUCT INFORMATION

- **Power:** 2000 W
- **Tank capacity:** 2L
- **Source of light:** 24PCS x 3W RGB LED
- **Warm-up time:** 5min
- **Fog:** 18000 cu.ft/min
- **Remote control range:** 20m
- DMX – wired / wireless
- **Power supply:** 230V AC – 50/60Hz
- **Weight:** 7,8 kg

## INSTALLATION



1. Open carton to check whether all necessary spare parts include according the specification list. Please contact distributor if there is something missing.
2. Check the appearance of machine and power line to see whether they have same obvious damage. Please contact distributor once you find something and stop to use fog machine.
3. Take away all packing material, specially the spray mouth.
4. Set in the horizontal direction and open the cover of liquid can.
5. Add high quality fog liquid in the machine and screw the cover of liquid can. Bad quality fog liquid will damage fog machine. Use only recommended by the manufacturer (see website).
6. Plug the remote control receiver into the remote control socket on the rear panel of the unit.

### Voltage specification

Input Voltage	Total Power	Frequency
230V	2000W	50/60Hz

### OPERATION

1. Connect the power lead to the power socket with earth line. The machine will start heating.
2. You have to wait same time (about 10 minutes) until the machine has sufficiently warmed up. Press the „A” or „B” key on the remote controller. The machine will spray fog and the LEDs will light in different colours. Press it as long as you need. For safety reasons, the pump will only work when the machine is hot enough.
3. Can set the machine at a high place (with bracket) or on the ground. Do not spray fog to people directly and the lean angle should less than 15°C.
4. Often check whether there is enough fog liquid in the tank. The unit might be seriously damaged if it operates without fog liquid.
5. If the fog is small, plum has noise or there has a no fog, please power off and check fog liquid, fuse, the connector of remote console and power plug. If the problem could not be solved aftercheck these parts, please stop check and send it back to distributor for repair. Repair: Please clean the fog machine to avoid the damage of spare parts and decrease the repair charge. Don't let the fog machine become dirty. Close the cap of liquid can after add fog liquid. After about 40 hours continually use, please use 80% distilled water and 20% vinegar to clean the dirty in refractory pipe. Disassemble the spray mouth and use vinegar to clean it to keep expedite before heat. Reequip the spray mouth after cool and add fog liquid for next use. Others: Clean regularly to extend the lifetime of machine. Use dry cloths to clean machine and keep dry while stare. Unplug the machine from the mains prior to cleaning, refilling the tank, changing the fuse, repairing or doing any other maintenance.

Channel	Description
CH1	Fog output
CH2	Auto colour change mode red-blue-green
CH3	Red ON
CH4	Green ON
CH5	Blue ON
CH6	No function

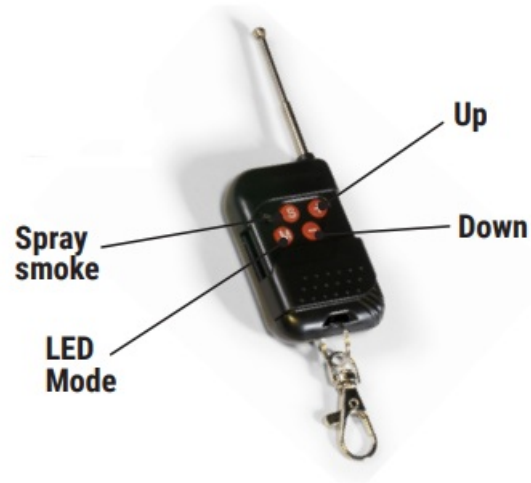

**Main Menu**

No	Display	Mode/Function	Button	Function	Features
	A001-A511	DMX Mode	MENU	Auto	Under DMX, pls do not operate in manual mode
			UP	DMX ADD UP	
			DOWN	DMX ADD DOWN	
			ENTER	1st save, 2nd spay	

## LED Setting

No	Display	Mode/Function	Button	Function
1	C***	Single color mode	M	Next menu
			+	Next color
			—	Last color
			S	Spray fog
2	Tb_*	hopping change mode,	M	Next menu
			+	hopping change, speed down, total 6 class
			—	hopping change speed up, total 6 class
			S	Spray fog
			M	1st menu

3	Jb_*	gradient change mode	+	gradient change, total 6 class
			—	gradient change speed down, a total 6 class
			S	Spray fog

[www.flash-butrym.pl](http://www.flash-butrym.pl)

## Documents / Resources

 <p>FLASH FLZ-2000 DMX FOG MACHINE UP + LED 3in1</p>	<p><b><a href="#">FLASH FLZ-2000 DMX Fog Machine UP with LED 3 In 1</a></b> [pdf] User Manual          FLZ-2000, DMX Fog Machine UP with LED 3 In 1, FLZ-2000 DMX Fog Machine UP with LED 3 In 1, FLZ-2000 DMX Fog Machine UP, DMX Fog Machine UP, DMX Fog Machine, F5100343</p>
---	--

## References

-  [Flash-Butrym](http://Flash-Butrym)

[Manuals+](#).