



FIXROL-BK Fixed Roll Holder with Wireless Charging User Manual

[Home](#) » [FIXED](#) » [FIXROL-BK Fixed Roll Holder with Wireless Charging User Manual](#) 



FIXED ROLL USER MANUAL

Thank you for purchasing the FIXED Roll holder with wireless charging. The holder allows wireless charging of the phone during driving. Read this manual before use.

Contents

- [1 HOLDER INSTALLATION](#)
- [2 TECHNICAL SPECIFICATION](#)
- [3 Documents / Resources](#)
- [4 Related Posts](#)

HOLDER INSTALLATION

1. Unscrew the nut on the holder and attach the bracket to the vent.
2. Adjust the spacing of the holder clamps (1 and 2) to the size of your mobile phone.
3. Squeeze the clip (3) and slide the vent mount (4) into the ventilation grille in the car.
4. Plug the USB cable into the charging connector (5). Connect the USB cable to the car charger. To support Fast Charge, it is necessary to use a car charger with Fast Charge support (9V/2A output).
5. Insert the phone into the holder. The rollers on the clamps ensure a firm hold and manipulation of the phone in

the holder.

6. The LED indication (7) indicates the charging of the inserted phone (blue when plugged in the charger, red when charging the phone).

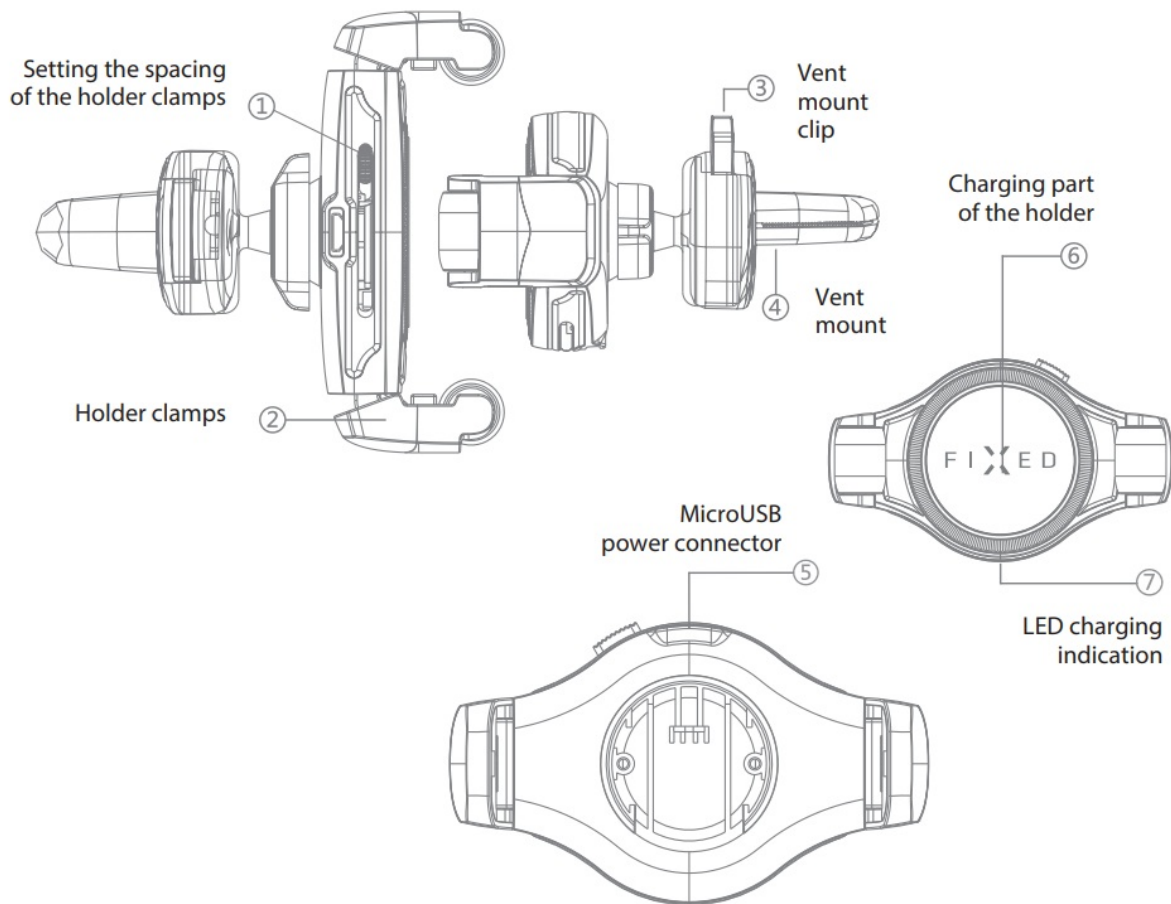

TECHNICAL SPECIFICATION

Input: DC 5V/2A; 9V/2A

Output: DC 5V/1A; 9V/1.1A

Power: 5W/7.5W/10W

Weight: 99 g

Frequency: 110-205kHz

NOTES

When charging the phone in the holder, warm air must not flow out of the ventilation outlet.

When heating the car interior, close the air supply of the ventilation outlet on which you have attached the holder.

To achieve optimal charging, connect to the holder a car charger with a sufficiently strong output power. The product is under warranty in accordance with the regulations in force in the countries where it is sold. In case of service problems, contact the dealer from which you purchased the product. FIXED assumes no liability for damage caused by improper use of the product.

Keep the manual.



This product is CE marked in accordance with EMC directive 2014/30/EU and RoHS 2011/65/EU. FIXED.zone a.s. declares that this product is in compliance with essential requirements and other relevant provisions of EMC directives 2014/30/EU and 2011/65/EU.

Documents / Resources

	<p>FIXED FIXROL-BK Fixed Roll Holder with Wireless Charging [pdf] User Manual FIXROL-BK Fixed Roll Holder with Wireless Charging, FIXROL-BK, Fixed Roll Holder with Wireless Charging</p>
---	--

[Manuals+](#)