

FIRSTECH
NSP2-NI3
Frontier Intelli
Key PTS AT



FIRSTECH NSP2-NI3 Frontier Intelli Key PTS AT Installation Guide

[Home](#) » [FIRSTECH](#) » FIRSTECH NSP2-NI3 Frontier Intelli Key PTS AT Installation Guide 

Contents

- [1 FIRSTECH NSP2-NI3 Frontier Intelli Key PTS AT](#)
- [2 Product Usage Instructions](#)
- [3 Vehicle Coverage and Preparation Notes](#)
- [4 Installation and Configuration](#)
- [5 WIRING](#)
- [6 CARTRIDGE INSTALLATION](#)
- [7 MODULE PROGRAMMING PROCEDURE](#)
- [8 Documents / Resources](#)
 - [8.1 References](#)



FIRSTECH NSP2-NI3 Frontier Intelli Key PTS AT



Product Usage Instructions

- Before installation, ensure you have the necessary firmware and modules for Type 2 configuration.
- Follow the vehicle coverage notes to determine compatibility.
- Securely connect the NSP2 harness to the appropriate connectors as specified in the manual.
- Ensure correct configuration of CAN connections between the white 14-pin and Black 40-pin BCM connectors.
- Configure POC1 output based on the switch type for hazard light settings.
- Make required I/O changes for Type 2 configuration, especially regarding CN1 blue wire for IGN output.
- Refer to the manual for specific controller settings based on the model (CM7/CMX or CM9) for POC configurations and I/O changes.
- Exercise caution when connecting BCM connectors to avoid vehicle damage.
- Connect T-harnesses one at a time and confirm proper positioning before proceeding.

Vehicle Coverage and Preparation Notes

Make	Model	Year	Install	CAN	Lights	BCM	POC	I/O Changes
DL-NI3 Nissan	Frontier Intelli-Key PTS AT	2020-24	Type 2	Type A	Park / Auto POC 1 Hazard1/2	RSC	See note	Green White/Blue None/IGN

- **Install Type 2** requires BLADE-AL(DL)-NI3 firmware, flash module and update the controller firmware before installing.
- **CAN:** The NSP2 harness, when configured for NI3 applications, does not require a specific configuration of the harness CAN connector, the NI3 CAN connections are hardwired between the white 14-pin connector and the Black 40-pin BCM connector.
- **Lights:** Visual status confirmations and diagnostic information are provided via hazard lights when using the NSP2 harness.
- The controller POC1 output must be configured for one of the following settings (depending on switch type):
 - Hazard light [30] momentary hazard switch
 - Hazard light 2 [23] latching hazard switch

POC Configuration:

- CM7/CMX: POC2 – 2nd START [2]
- POC3 – 2nd IGN [3]
- CM9: POC3 – (-) START
- POC4 – (-) IGNITION

I/O Changes: Type 2 requires configuring the CN1 blue wire for IGN output, controller specific settings are listed on the next page.

Vehicle Damage Warning

Caution should be taken to avoid mixing up the BCM connectors, vehicle damage will result if the connectors are positioned improperly. It is advised that you make the BCM connections one at a time, confirming that each T-harness connection is at the correct BCM position before proceeding to the next connection, attempting to program, or attempting to remote start.

Installation and Configuration

FTI-NSP2: Installation and Configuration Notes

- **A:** REQUIRED CONNECTIONS – SECURE UNUSED I/O CONNECTORS
- **B:** REQUIRED CONNECTIONS – SEE WARNING ABOVE
- **C:** REQUIRED CONNECTION
- **D:** REQUIRED CONNECTION – REQUIRES JUMPER/SETTING CONFIGURATION
- **E:** NOT REQUIRED



FEATURE COVERAGE															
IMMOBILIZER DATA	SECURE TAKEOVER	PRIORITY UNLOCK	DOOR LOCK	DOOR UNLOCK	ARM OEM ALARM	DISARM OEM ALARM	POWER LIFTGATE	TRUNK/HATCH RELEASE	DOOR STATUS	HOOD STATUS	TRUNK STATUS	BRAKE STATUS	TACH OUTPUT	E-BRAKE STATUS	

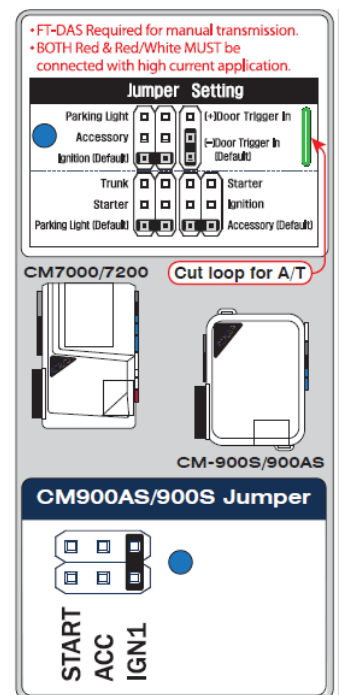

WIRING

FTI-NSP2 – DL-NI3 – Type 2 LED Programming Error Codes

Module LED flashing RED during programming

- 1x – No CAN activity, check connectors, check CAN voltages
 - 2x – No immobilizer data, confirm connectors used
 - 3x – VIN detection error, contact support
 - 4x – No ignition, confirm connection and voltage
- 2020-24 Nissan Frontier Intelli-Key PTS AT

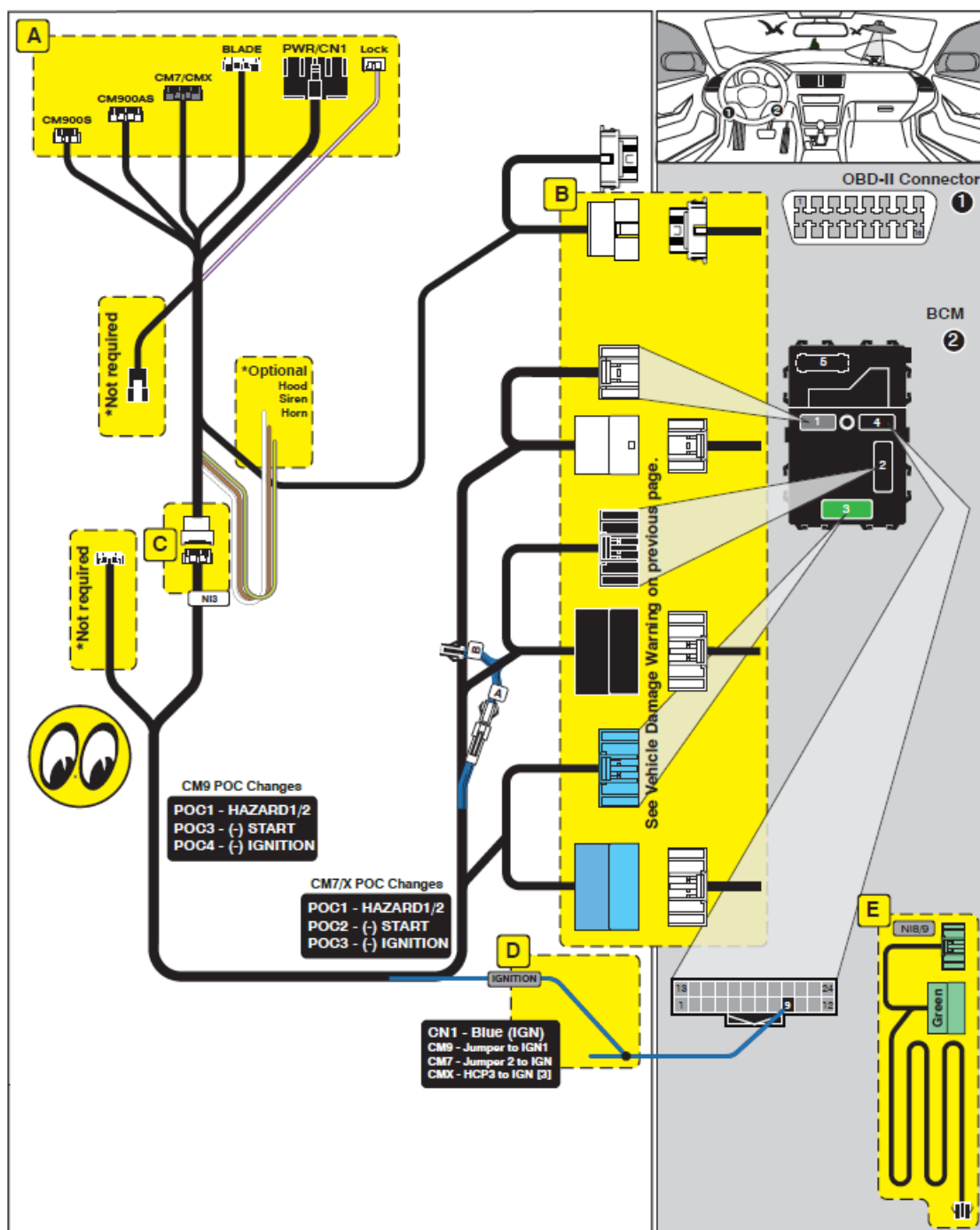

LED Programming Error Codes

Module LED flashing RED during programming

- 1x – No CAN activity, check connectors, check CAN voltages
- 2x – No immobilizer data, confirm connectors used
- 3x – VIN detection error, contact support
- 4x – No ignition, confirm connection and voltage

CARTRIDGE INSTALLATION

1. Slide cartridge into unit. Notice button under LED.

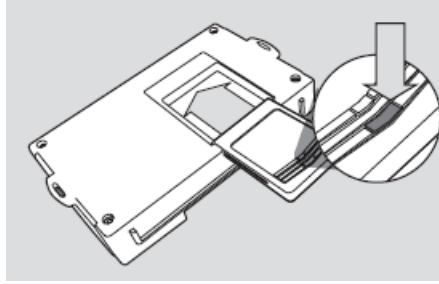

2. Ready for Module Programming Procedure.

MODULE PROGRAMMING PROCEDURE

1. Push start button twice [2x] to ON position.

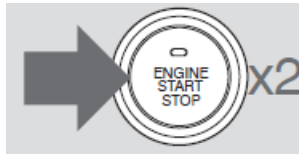

2. Wait, LED will turn solid BLUE for 2 seconds.

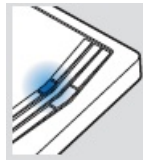

3. Push start button once [1x] to OFF position.

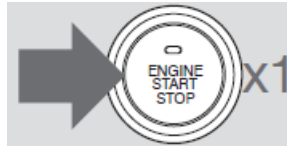

4. Module Programming Procedure completed.

PUSH TO START VEHICLE TAKE OVER PROCEDURE – TO THE VEHICLE OWNER

NOTE

This procedure is to be followed during remote starter runtime prior to entering vehicle.
All vehicle doors must be closed.

1. Press UNLOCK on after-market remote or OEM fob.



2. Open vehicle door.

Enter vehicle WITH THE OEM FOB.

Close vehicle door.

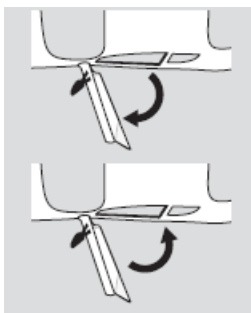

3. Wait for the LED indicator of the push button to be in the ON position.

OR

Wait for the ORANGE LED indicator of the push button to turn on.



4. Press and release BRAKE pedal.

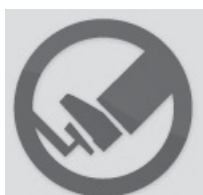

5. It is safe to select gear ONLY AFTER LED indicator is in ON position.

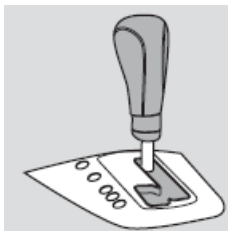

6. Push to Start vehicle take over procedure completed.

Failure to follow procedure may result in vehicle displaying CHECK ENGINE or TIRE PRESSURE error messages.

WWW.IDATALINK.COM Automotive Data Solutions Inc. © 2020

Documents / Resources

	<p>FIRSTTECH NSP2-NI3 Frontier Intelli Key PTS AT [pdf] Installation Guide</p> <p>FTI-NSP2-NI3-Nissan Frontier Intelli-Key PTS AT_20-24_ENX, NSP2-NI3 Frontier Intelli Key PTS AT, NSP2-NI3, Frontier Intelli Key PTS AT, Intelli Key PTS AT, Key PTS AT, PTS AT, AT</p>
--	--

References

- [iDatalink - Home](#)
- [User Manual](#)

This website is an independent publication and is neither affiliated with nor endorsed by any of the trademark owners. The "Bluetooth®" word mark and logos are registered trademarks owned by Bluetooth SIG, Inc. The "Wi-Fi®" word mark and logos are registered trademarks owned by the Wi-Fi Alliance. Any use of these marks on this website does not imply any affiliation with or endorsement.