

FIRSTECH,LLC

**GMT3-GM8 Vehicle
Preparation and
Coverage**



FIRSTECH GMT3-GM8 Vehicle Preparation and Coverage Installation Guide

[Home](#) » [FIRSTECH](#) » FIRSTECH GMT3-GM8 Vehicle Preparation and Coverage Installation Guide 

Contents

- [1 FIRSTECH GMT3-GM8 Vehicle Preparation and Coverage](#)
- [2 Specifications](#)
- [3 Instruction](#)
- [4 FTI-GMT3 – DL-GM8 – Type 1](#)
- [5 CARTRIDGE INSTALLATION](#)
- [6 MODULE PROGRAMMING PROCEDURE](#)
- [7 TAKE OVER PROCEDURE – TO THE VEHICLE OWNER](#)
- [8 Frequently Asked Questions \(FAQ\):](#)
- [9 Documents / Resources](#)
 - [9.1 References](#)



FIRSTECH GMT3-GM8 Vehicle Preparation and Coverage

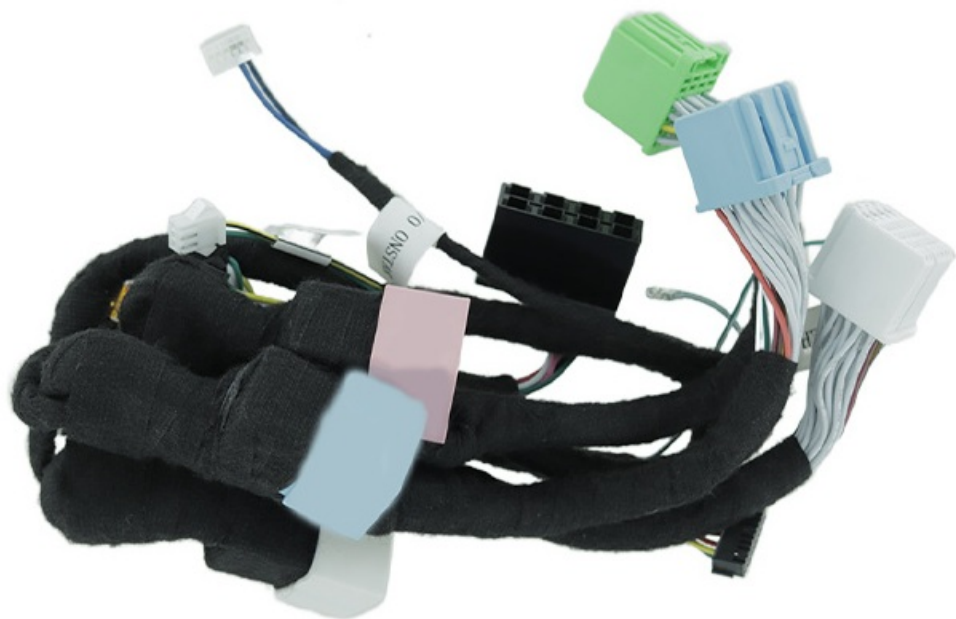

Specifications

- **Make:** DL-GM8 Chevrolet
- **Model:** Trailblazer PTS AT
- **Year:** 2021-2024
- **Install Type:** 2
- **Lights:** Park / Auto
- **BCM Configuration:** LSCC
- **Feature Option:** None

Instruction

Make	Model	Year	Install	CAN	Lights	Type	BCM	Configuration
DL-GM8					Park / Auto			Feature Option
Chevrolet	Trailblazer PTS AT	2021-24	Type 2	Type B	Type A	PTS	LSCC	None

- **Firmware:** This installation uses BLADE-AL(DL)-GM8, flash module and update the controller firmware before installing.
- **Install:** Type 2 installation sources CAN data from the white connector of the BCM, requiring the use of the 'B'-connector, the connector marked 'A' is not used.
- **Lights:** Type A lights (standard parking lights) are provided, as are Type H (hazard lights), both incorporated in the harness for visual display of runtime status/diagnostics. Re-pinning of the CM I/O (gray) harness is required, regardless of which type you choose to use, both options have been provided for your selection. If you choose hazards you will also need to configure the selected POC for one of the following hazard control

- **Locks:** The CM lock connector is not required for this installation type. Door locks are handled via data signals so analog connections are not necessary. Secure the harness connector as needed.

FTI-GMT3 – Installation and Configuration Notes

- REQUIRED CONNECTION, SEE NOTE ABOVE
- CONNECTION NOT REQUIRED
- REQUIRED CONFIGURATION – CAN TYPE ‘B’
- REQUIRED CONFIGURATION – KEY TYPE ‘PTS’

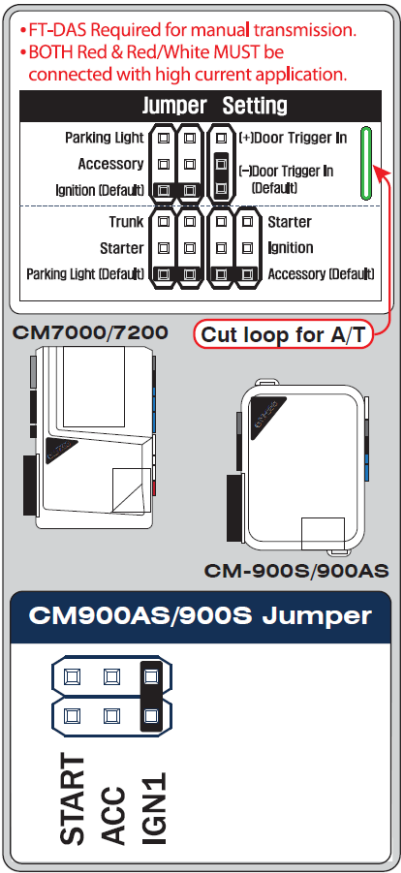

Feature Coverage					
Immobilizer Data					
Priority Unlock					
Door Lock					
Door Unlock					
Arm OEM Alarm					
Disarm OEM Alarm					
Trunk/Hatch Release					
3X Lock Start					
Door Status					
Trunk Status					
Rap Shutdown					
Brake Status					
E-Brake Status					
Tach Output					
Data/Mux Ign/St					
Hood Status					
Secure Takeover					
Parking Lights					
Hazard Lights					

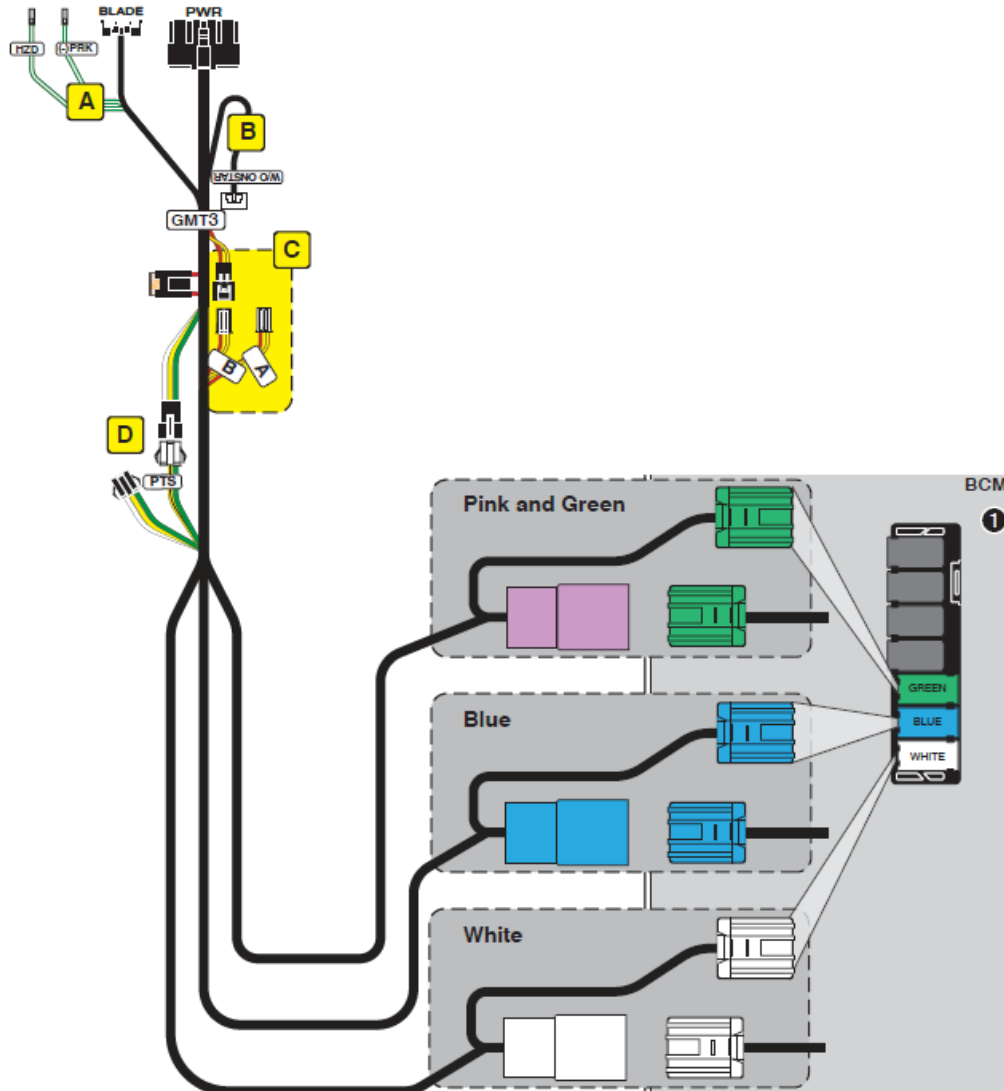
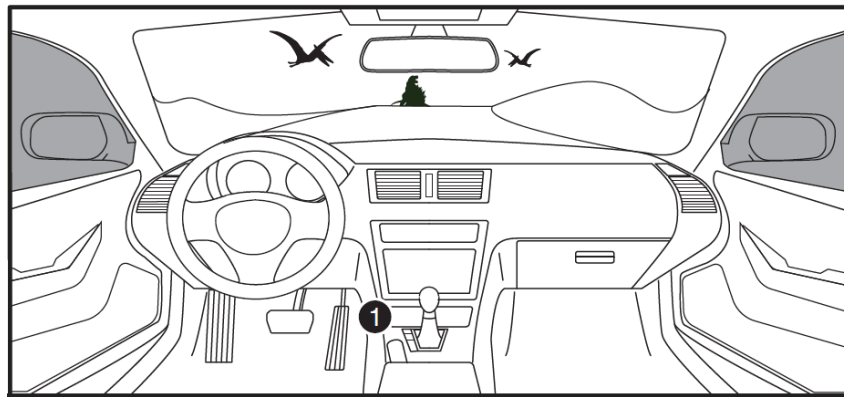

LED Programming Error Codes

Module LED flashing RED during programming

- **1x** – No SWC data, check BLUE connector and CAN selection
- **2x** – No immobilizer data, confirm GREEN and BLADE connectors
- **3x** – No HS CAN
- **4x** – No ignition, check BLUE connector and CAN selection
- **5x** – VIN not matching Weblink data, contact engineering
- **6x** – No immobilizer data, check GREEN connector or hold IGN
- **7x** – Immobilizer data error, confirm only using one key
- **8x** – No immobilizer data, check GREEN and BLADE connectors
- **9x** – Immobilizer data error, see above

- **10x** – Klon data error, reset module and repeat programming
- **11x** – No ignition, check BLUE connector and CAN selection

CARTRIDGE INSTALLATION

1. Slide cartridge into unit. Notice button under LED.

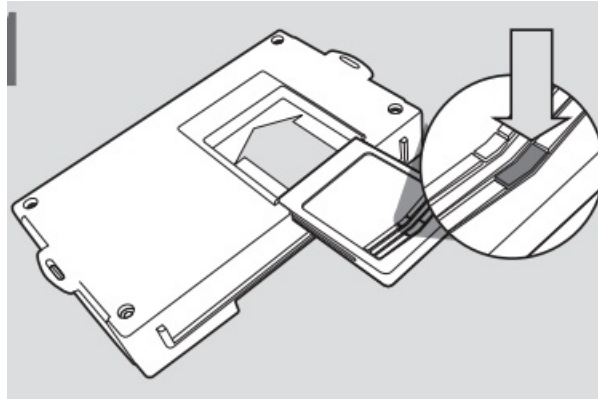

2. Ready for Module Programming Procedure.

MODULE PROGRAMMING PROCEDURE

NOTE

When programming, only one key fob will be used. The other one must be located at least 10 feet away from the vehicle.

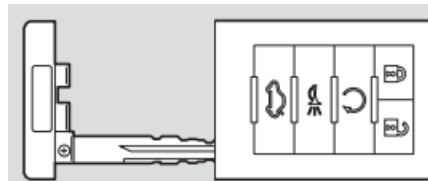

1. Remove battery from key fob. Place key fob on key reader in armrest or center console.

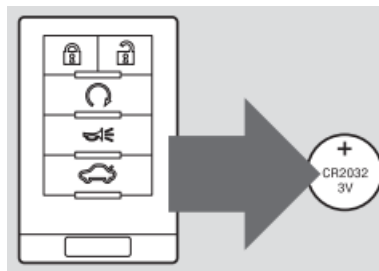

2. Close driver door. Re-open driver door to wake up data bus.

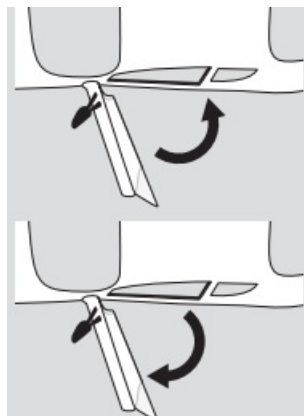

3. Push start button twice [2x] (or press start button 5 seconds) to ON position.

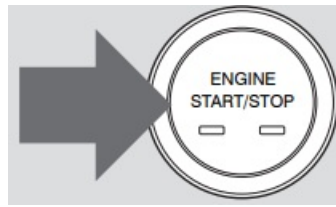

4. Wait, LED will turn solid RED.

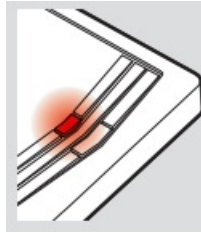

5. Push start button once [1x] to OFF position.

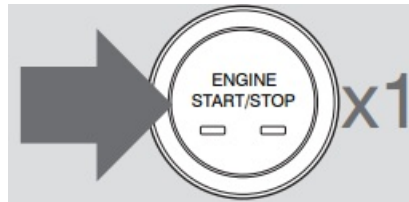

6. Wait, LED will flash BLUE rapidly.

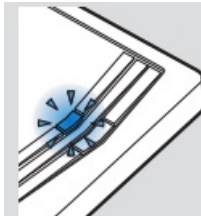

7. **WARNING:**

- Disconnect power last.
- Disconnect RS from vehicle.

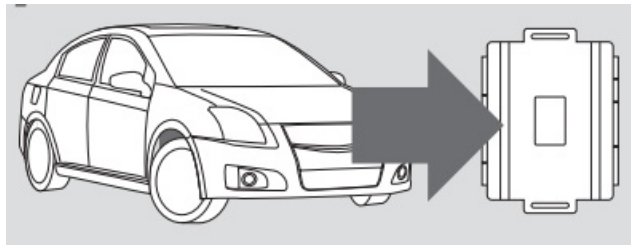

8. Connect RS to computer and proceed with extended programming.

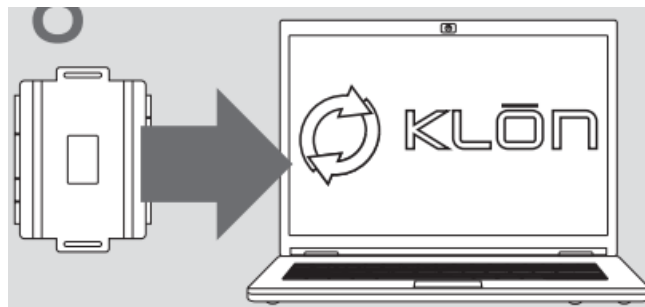

9. **WARNING:** Do not press RS programming button. Connect power first. Connect RS to vehicle.

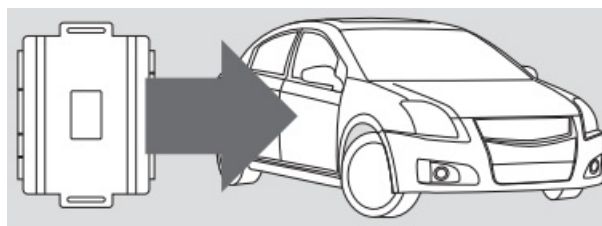

10. Push start button twice [2x] (or press start button 5 seconds) to ON position.

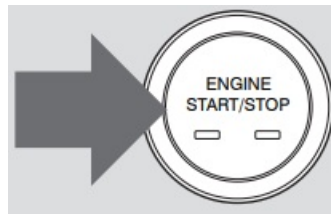

11. Wait, LED will turn solid BLUE for 2 seconds.

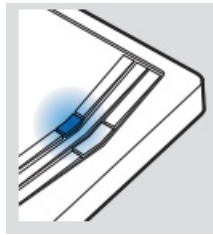

12. Push start button once [1x] to OFF position.

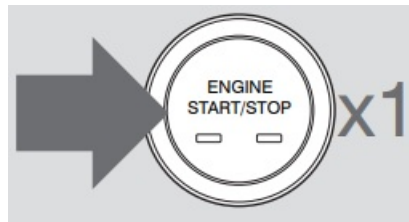

13. Remove key fob from key reader. Insert battery in key fob.

1. If the vehicle is equipped with a power liftgate:

Open and close the power liftgate with the OEM keyfob.

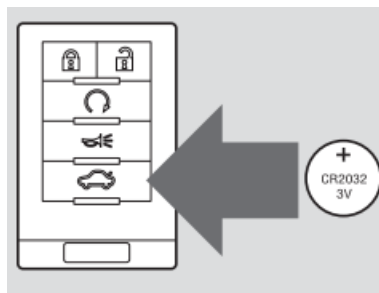

14. Module Programming Procedure completed.

WARNING: READ BEFORE REMNO OTICETE STARTING THE VEHICLE

IMPORTANT

All vehicle doors must be closed and locked prior to remote start sequence. Failure to comply will result in remote starter malfunction.

TAKE OVER PROCEDURE – TO THE VEHICLE OWNER

NOTE

All vehicle doors must be closed and locked prior to remote start sequence.

TIME RESTRICTI N COMING UP !

1. Press unlock on OEM or aftermarket remote or request switch.



2. TIME RESTRICTION

Within 45 SECONDS from previous step:

- Open vehicle door.
- Enter vehicle.
- Close vehicle door.
- Press and release BRAKE pedal.

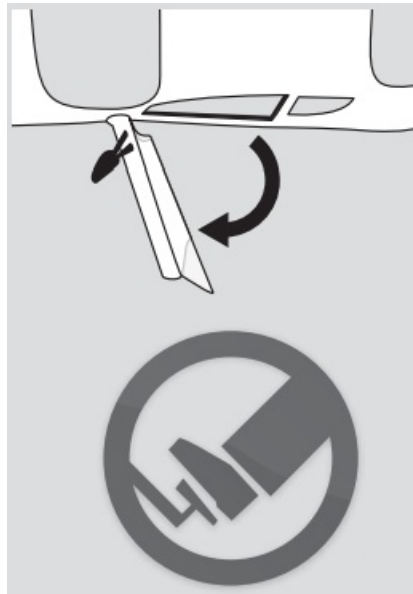

3. Take over procedure completed.

Failure to follow procedure within time restriction will result in vehicle engine shutdown.

WWW.IDATALINK.COM

Automotive Data Solutions Inc. © 2020

COM-BLADE-AL(DL)-GM8-EN

Doc. No.: ##75068##20210331

Frequently Asked Questions (FAQ):

Q: What should I do if my remote starter malfunctions?

A: Ensure all vehicle doors are closed and locked before initiating the remote start sequence to avoid malfunctions.

Q: How do I know if the module programming procedure was successful?

A: The LED will indicate different colors at specific steps during the programming process. Follow the instructions carefully and ensure each step is completed as described.

Documents / Resources

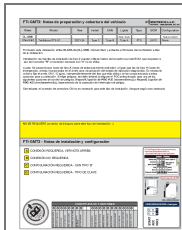

[FIRSTECH GMT3-GM8 Vehicle Preparation and Coverage](#) [pdf] Installation Guide
GMT3-GM8, CM7000-7200, CM-900S-900AS, GMT3-GM8 Vehicle Preparation and Coverage,
GMT3-GM8, Vehicle Preparation and Coverage, Preparation and Coverage, Coverage

References

- [!\[\]\(38441ceaa711016e0bf2ad46ad394ff4_img.jpg\) **iDatalink - Home**](#)
- [**User Manual**](#)

[Manuals+](#), [Privacy Policy](#)

This website is an independent publication and is neither affiliated with nor endorsed by any of the trademark owners. The "Bluetooth®" word mark and logos are registered trademarks owned by Bluetooth SIG, Inc. The "Wi-Fi®" word mark and logos are registered trademarks owned by the Wi-Fi Alliance. Any use of these marks on this website does not imply any affiliation with or endorsement.