



FIRSTECH FTI-STK1 Wrx Std Key At Installation Guide

[Home](#) » [FIRSTECH](#) » FIRSTECH FTI-STK1 Wrx Std Key At Installation Guide 

Contents

- 1 FIRSTECH FTI-STK1 Wrx Std Key At
- 2 FTI-STK1: Installation and Configuration Notes
- 3 CARTRIDGE INSTALLATION
- 4 MODULE PROGRAMMING PROCEDURE
- 5 Documents / Resources
 - 5.1 References
- 6 Related Posts



FIRSTECH FTI-STK1 Wrx Std Key At



FTI-STK1: Vehicle Coverage and Preparation Notes

Make	Model	Year	Install	CAN	IMMO	BCM	Clutch	I/O Changes
Subaru	WRX STD KEY AT (USA)	2022	Type 3	20-Pin	A	DSD	N/A	N/A

Covered vehicles use BLADE-AL-SUB9 firmware and the following required accessories: Weblink Hub & ACC RFID1. Flash the module and update the controller firmware.

Please follow the directions for RFID programming before attempting to program the BLADE module to the vehicle.

- **CAN:** Type 3 CAN connections are made using the 20-Pin BCM adapter and require connecting the white 2-pin connectors at marker [D] of the illustration.
- **Immobilizer:** Type A IMMO requires connecting the white male and female 2-pin connectors at marker [C] of the illustration.
- **Lights:** Parking lights are pre-wired in the FTI-STK1 harness. Replace the green/white wire of the CM I/O connector with the pre-terminated green/white wire of the harness.
- **ACC-RFID1 (REQUIRED):** SUB9 firmware does not provide immobilizer data, an ACC-RFID1 is therefore required for remote start.
- **2nd START:** The FTI-STK1 harness is pre-wired with a red/black 2nd START output (not required in TYPE 1), cut and insulate the provided wire to prevent short circuits when not used.
- **I/O Changes:** None required.

Advisory 1: Program ACC-RFID1 before attempting to program the BLADE module to the vehicle.

Advisory 2: Secure all 2-pin connections, both used and unused, to the main harness body.

FTI-STK1: Installation and Configuration Notes

- **A:** REQUIRED ACCESSORY
- **B:** ADAPTER REQUIRED
- **C:** REQUIRED CONFIGURATION (TYPE A IMMO)
- **D:** NO CONNECTION
- **E:** NO CONNECTION

Feature Coverage

- IMMOBILIZER DATA
- ARM OEM ALARM
- DISARM OEM ALARM
- DOOR LOCK
- DOOR UNLOCK
- PRIORITY UNLOCK
- TRUNK/HATCH RELEASE
- TACH OUTPUT
- DOOR STATUS
- TRUNK STATUS
- BRAKE STATUS
- E-BRAKE STATUS
- A/M ALRM CONTROL FROM OEM REMOTE
- A/M RS CONTROL FROM OEM REMOTE
- AUTOLIGHT CTRL

LED Programming Error Codes

Module LED flashing RED during programming:

- 1x RED = Unable to communicate with RFID or immobilizer data.
- 2x RED = No CAN activity. Check the CAN wire connections.
- 3x RED = No ignition detected. Check the ignition wire connection and CAN.
- 4x RED = Required ignition output diode not detected.

Install Guide

Cartridge Installation

1. Slide cartridge into unit. Notice button under LED.
2. Ready for Module Programming Procedure.

Module Programming Procedure

1. For this installation, the Weblink HUB is required.
2. Remove OEM key 1 from keychain.

- Place all other keyfobs at least 1 foot away from the Weblink HUB. Failure to comply may result in damage to other keyfobs or interfere with the keyfob reading process.
- Flash the module using the Weblink HUB. Follow the on-screen instructions to complete the keyfob reading process.
- WARNING:** Do not press the module programming button. Connect power first. Connect module to vehicle.
- Using OEM key 1, turn key to ON position.
- Wait, LED will turn solid BLUE for 2 seconds.
- Turn key to OFF position.
- Module Programming Procedure completed.

Specifications

Component	Specification
Firmware	BLADE-AL-SUB9
Required Accessories	Weblink Hub & ACC RFID1
CAN Connection	Type 3, 20-Pin
Immobilizer	Type A IMMO

FAQ

- What is required for the installation of the FTI-STK1?**

The installation requires the BLADE-AL-SUB9 firmware, Weblink Hub, and ACC RFID1.

- How do I handle unused 2-pin connections?**

Secure all 2-pin connections, both used and unused, to the main harness body.

- What should I do if the module LED flashes RED?**

Refer to the LED Programming Error Codes section for troubleshooting steps based on the number of RED flashes.

FTI-STK1: Vehicle Coverage and Preparation Notes

Make	Model	Year	Install	CAN	IMMO	BCM	Clutch	I/O Changes
DL-SUB9 Subaru	WRX STD KEY AT (USA)	2022	Type 3	20-Pin	Type A	DSD	N/A	Green White/Blue N/A

- Covered vehicle use BLADE-AL-SUB9 firmware and the following required accessories, Weblink Hub & ACC RFID1.
- Flash module, and update the controller firmware. Please follow the directions for RFID programming before attempting to program the BLADE module to the vehicle.
- CAN:** Type 3 CAN connections are made using the 20-Pin BCM adapter and require connecting the white 2-pin connectors at marker [D] of the illustration.
- Immobilizer:** Type A IMMO requires connecting the white male and female 2-pin connectors at marker [C] of the illustration.

- Advisory 1:** Program ACC-RFID1 before attempting to program the BLADE module to the vehicle.
Advisory 2: Secure all 2-pin connections, both used and unused, to the main harness body.

- REQUIRED ACCESSORY
- ADAPTER REQUIRED
- REQUIRED CONFIGURATION (TYPE A IMMO)
- NO CONNECTION
- NO CONNECTION

[illegible]

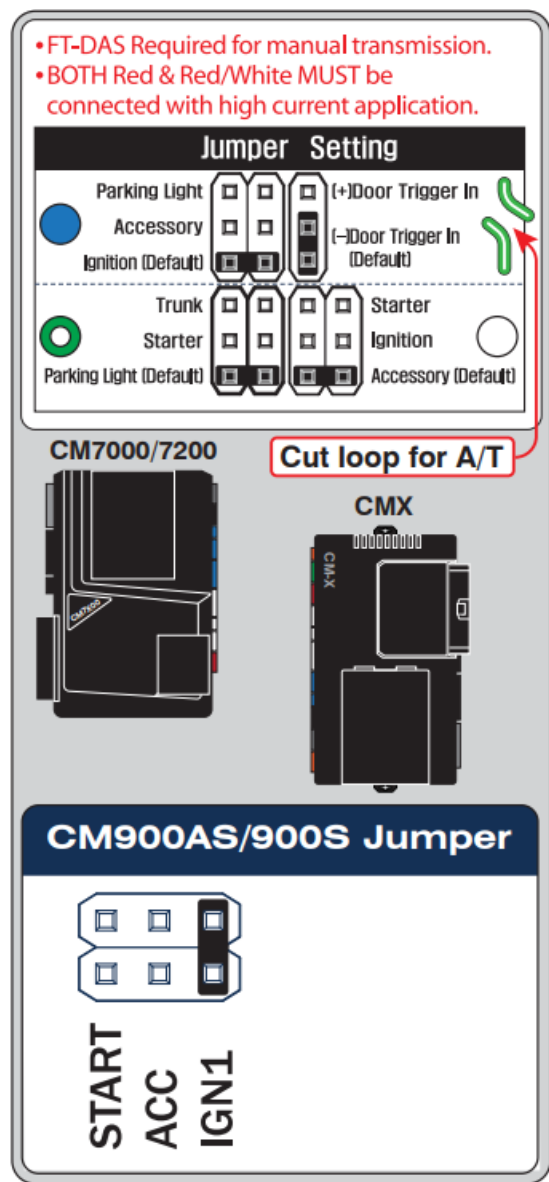

FTI-STK1 – AL-SUB9 – Type 3

2022 Subaru WRX STD KEY AT (USA)

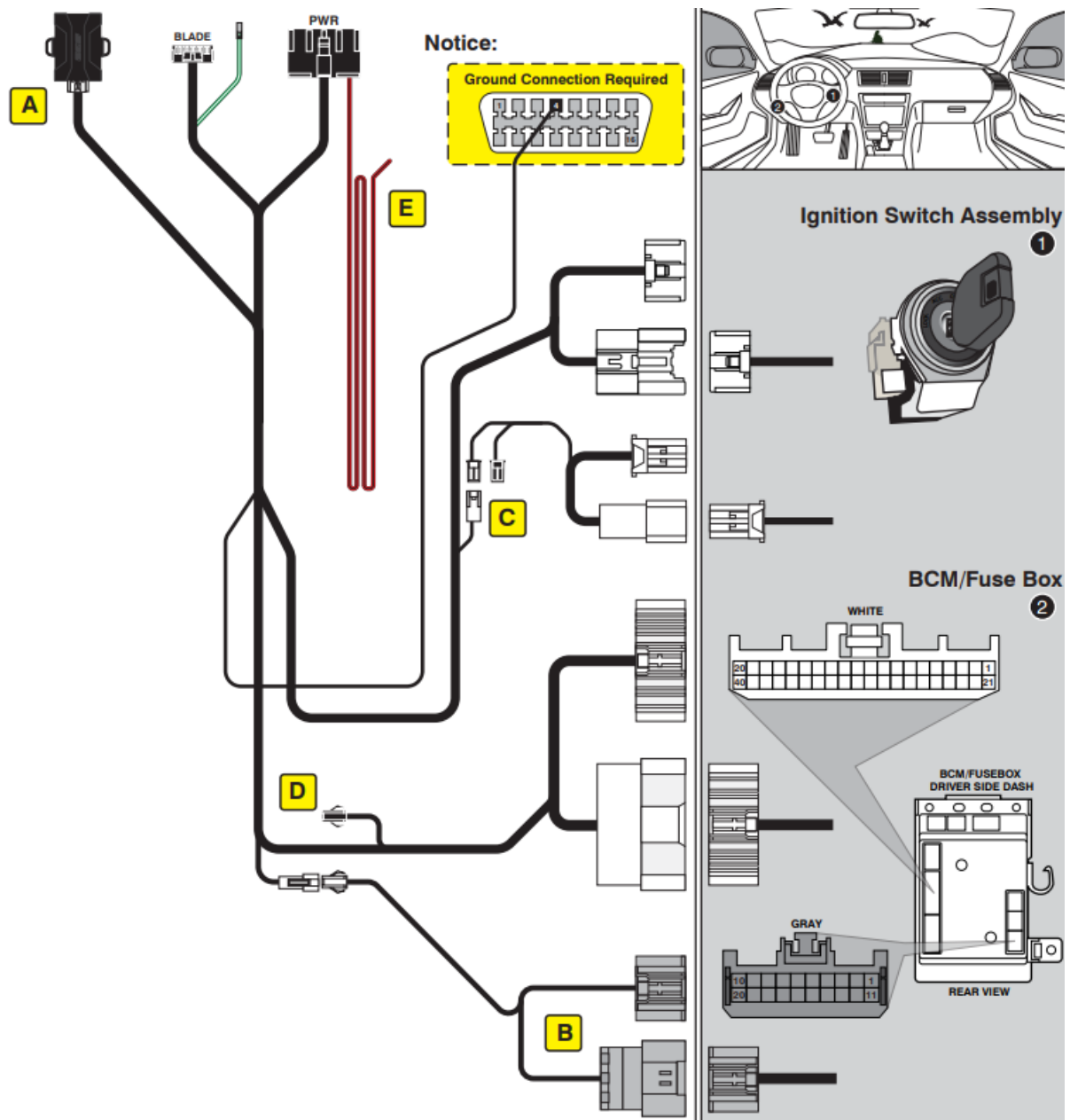

LED Programming Error Codes

Module LED flashing RED during programming

- 1x RED = Unable to communicate with RFID or immobilizer data.
- 2x RED = No CAN activity. Check the CAN wire connections.
- 3x RED = No ignition detected. Check the ignition wire connection and CAN.
- 4x RED = Required ignition output diode not detected.

CARTRIDGE INSTALLATION

1. Slide cartridge into unit. Notice button under LED.

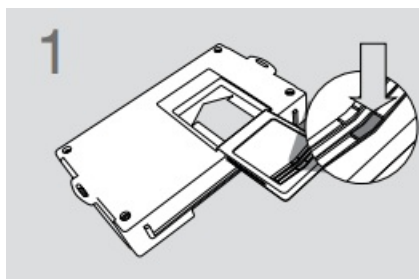

2. Ready for Module Programming Procedure.

MODULE PROGRAMMING PROCEDURE

1. For this installation, the Weblink HUB is required.
2. Remove OEM key 1 from keychain.

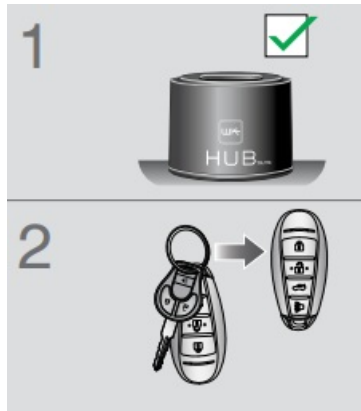

Place all other keyfobs at least 1 foot away from the Weblink HUB. Failure to comply may result in damage to other keyfobs or interfere with the keyfob reading process.

3. Flash the module using the Weblink HUB. Follow the on screen instructions to complete the keyfob reading process.



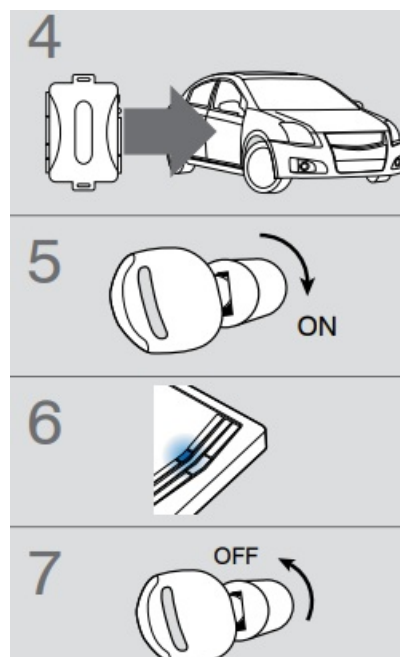

WARNING:

4. Do not press the module programming button.
Connect power first. Connect module to vehicle.
5. Using OEM key 1, turn key to ON position.
6. Wait, LED will turn solid BLUE for 2 Second .
7. Turn key to OFF position.
8. Module Programming Procedure completed.

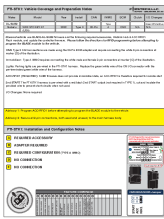

Documents / Resources

	<p>FIRSTTECH FTI-STK1 Wrx Std Key At [pdf] Installation Guide</p> <p>CM7000, CM7200, CM7X00, CM-X, CM-900S, CM-900AS, FTI-STK1 Wrx Std Key At, FTI-STK1, Wrx Std Key At, Std Key At, Key At, At</p>
	<p>FIRSTTECH FTI-STK1 WRX STD KEY AT [pdf] Installation Guide</p> <p>Fortin, Product Name FTI-STK1, Model Numbers CM7000-7200, CM-900, CM-900S-900AS, FTI-STK1 WRX STD KEY AT, FTI-STK1, WRX STD KEY AT, STD KEY AT, KEY AT, AT</p>

References

- [iDatalink - Home](#)
- [User Manual](#)

Manuals+, Privacy Policy

This website is an independent publication and is neither affiliated with nor endorsed by any of the trademark owners. The "Bluetooth®" word mark and logos are registered trademarks owned by Bluetooth SIG, Inc. The "Wi-Fi®" word mark and logos are registered trademarks owned by the Wi-Fi Alliance. Any use of these marks on this website does not imply any affiliation with or endorsement.