

FIRSTECH
FIRSTECH FTI-STK1
Outback STD KEY AT



FIRSTECH FTI-STK1 Outback STD KEY AT Installation Guide

[Home](#) » [FIRSTECH](#) » FIRSTECH FTI-STK1 Outback STD KEY AT Installation Guide 

Contents

- 1 FIRSTECH FTI-STK1 Outback STD KEY AT
- 2 FTI-STK1: Vehicle Coverage and Preparation Notes
- 3 CARTRIDGE INSTALLATION
- 4 MODULE PROGRAMMING PROCEDURE
- 5 Documents / Resources
 - 5.1 References
- 6 Related Posts



FIRSTECH FTI-STK1 Outback STD KEY AT



FTI-STK1: Vehicle Coverage and Preparation Notes

Make	Model	Year	Install	CAN	IMMO	BCM	Clutch	I/O Changes
Subaru	Outback STD KEY AT (Canada)	2020-24	Type 1	20-Pin	B	DSD	N/A	N/A

Covered vehicles use BLADE-AL-SUB9 firmware and the following required accessories: Weblink Hub & ACC RFID1. Flash module, and update the controller firmware. **Please follow the directions for RFID programming before attempting to program the BLADE module to the vehicle.**

- **CAN:** Type 1 CAN connections are made using the 20-Pin BCM adapter and require connecting the white 2-pin connectors at marker [D] of the illustration.
- **Immobilizer:** Type B IMMO requires connecting the black and white 2-pin connectors at marker [C] of the illustration.
- **Lights:** Parking lights are pre-wired in the FTI-STK1 harness. Replace the green/white wire of the CM I/O connector with the pre-terminated green/white wire of the harness.
- **ACC-RFID1 (REQUIRED):** SUB9 firmware does not provide immobilizer data, an ACC-RFID1 is therefore required for remote start.
- **2nd START:** The FTI-STK1 harness is pre-wired with a red/black 2nd START output (not required in TYPE 1), cut and insulate the provided wire to prevent short circuits when not used.
- **I/O Changes:** None required

Advisory 1: Program ACC-RFID1 before attempting to program the BLADE module to the vehicle.

Advisory 2: Secure all 2-pin connections, both used and unused, to the main harness body.

FTI-STK1: Installation and Configuration Notes

- **A:** REQUIRED ACCESSORY
- **B:** ADAPTER REQUIRED
- **C:** REQUIRED CONFIGURATION (TYPE B IMMO)
- **D:** NO CONNECTION
- **E:** NO CONNECTION

Feature Coverage

- IMMOBILIZER DATA
- ARM OEM ALARM
- DISARM OEM ALARM
- DOOR LOCK
- DOOR UNLOCK
- PRIORITY UNLOCK
- TRUNK/HATCH RELEASE
- TACH OUTPUT
- DOOR STATUS
- TRUNK STATUS
- BRAKE STATUS
- E-BRAKE STATUS
- A/M ALRM CONTROL FROM OEM REMOTE
- A/M RS CONTROL FROM OEM REMOTE
- AUTOLIGHT CTRL

FTI-STK1 – AL-SUB9 – Type 1

2020-24 Subaru Outback STD KEY AT (CA)

LED Programming Error Codes

- 1x RED = Unable to communicate with RFID or immobilizer data.
- 2x RED = No CAN activity. Check the CAN wire connections.
- 3x RED = No ignition detected. Check the ignition wire connection and CAN.
- 4x RED = Required ignition output diode not detected.

Install Guide

Cartridge Installation

1. Slide cartridge into unit. Notice button under LED.
2. Ready for Module Programming Procedure.

Module Programming Procedure

1. For this installation, the Weblink HUB is required.
2. Remove OEM key 1 from keychain.
3. Place all other keyfobs at least 1 foot away from the Weblink HUB. Failure to comply may result in damage to other keyfobs or interfere with the keyfob reading process.
4. Flash the module using the Weblink HUB. Follow the on-screen instructions to complete the keyfob reading process.
5. WARNING: Do not press the module programming button. Connect power first. Connect module to vehicle.
6. Using OEM key 1, turn key to ON position.
7. Wait, LED will turn solid BLUE for 2 seconds.
8. Turn key to OFF position.
9. Module Programming Procedure completed.

Specifications

Component	Description
Weblink HUB	Required for installation
ACC-RFID1	Required for remote start

FAQ

1. What is the purpose of ACC-RFID1?

ACC-RFID1 is required for remote start as the SUB9 firmware does not provide immobilizer data.

2. Can I use the FTI-STK1 harness without modifications?

Yes, but the red/black 2nd START output should be cut and insulated if not used.

3. What should I do if the LED flashes red during programming?

Refer to the LED Programming Error Codes section to diagnose the issue.

Make	Model	Year	Install	CAN	IMMO	BCM	Clutch	I/O Changes
Subaru	Outback STD KEY AT (Canada)	2020-24	Type 1	20-Pin	B	DSD	N/A	N/A

FTI-STK1: Vehicle Coverage and Preparation Notes

- Covered vehicle use BLADE-AL-SUB9 firmware and the following required accessories, Weblink Hub & ACC RFID1.
- Flash module, and update the controller firmware. Please follow the directions for RFID programming before attempting to program the BLADE module to the vehicle.
- CAN: Type 1 CAN connections are made using the 20-Pin BCM adapter and require connecting the white 2-pin connectors at marker [D] of the illustration.
- Immobilizer: Type B IMMO requires connecting the black and white 2-pin connectors at marker [C] of the illustration.
- Lights: Parking lights are pre-wired in the FTI-STK1 harness. Replace the green/white wire of the CM I/O connector with the pre-terminated green/white wire of the harness.

1. Advisory 1: Program ACC-RFID1 before attempting to program the BLADE module to the vehicle. Advisory
2. 2: Secure all 2-pin connections, both used and unused, to the main harness body.

- REQUIRED ACCESSORY
- ADAPTER REQUIRED
- REQUIRED CONFIGURATION B IMMO)
- NO CONNECTION
- NO CONNECTION

[illegible]

- FT-DAS Required for manual transmission.
- BOTH Red & Red/White MUST be connected with high current application.

Jumper Setting	
Parking Light	(+)Door Trigger In
Accessory	(-)Door Trigger In (Default)
Ignition (Default)	
Trunk	Starter
Starter	Ignition
Parking Light (Default)	Accessory (Default)

CM7000/7200



Cut loop for A/T

CMX



CM900AS/900S Jumper



START
ACC
IGN1

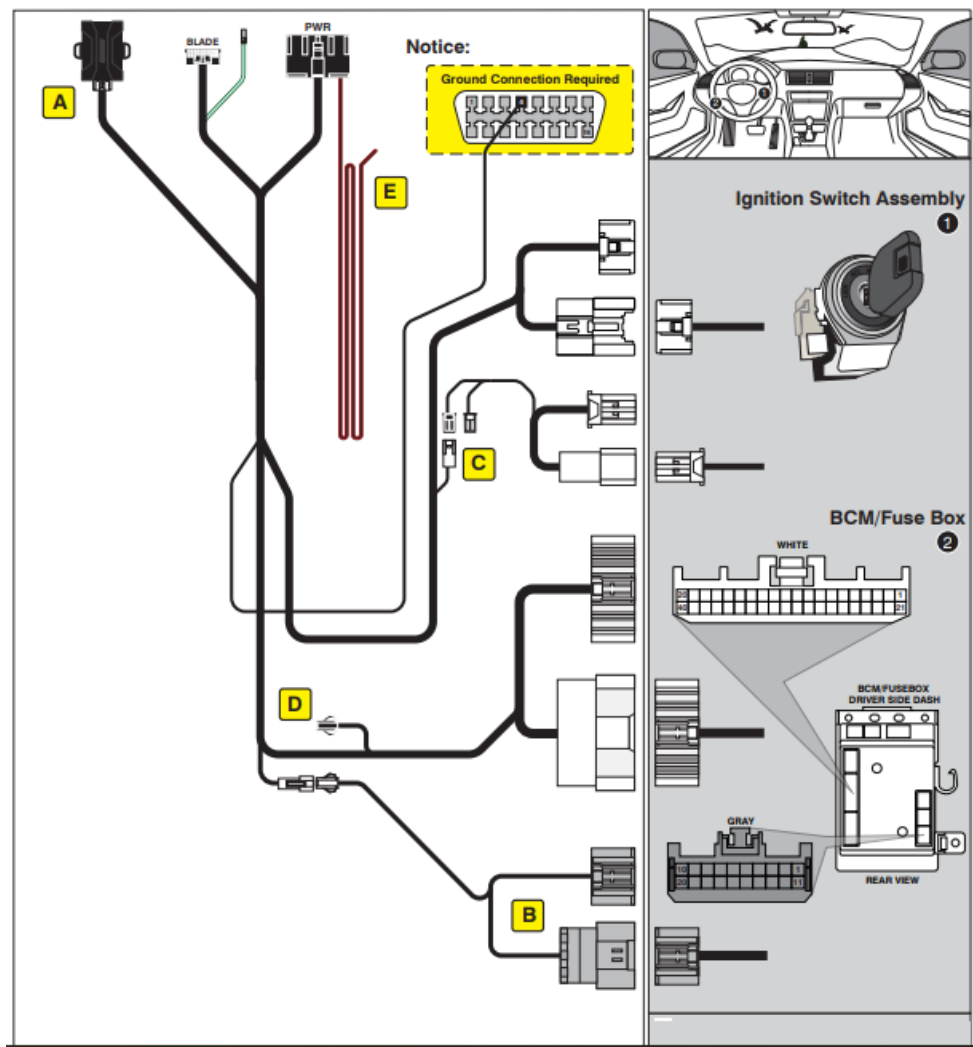

LED Programming Error Codes

Module LED flashing RED during programming

1x RED = Unable to communicate with RFID or immobilizer data. 2x RED = No CAN activity. Check the CAN wire connections. 3x RED = No ignition detected. Check the ignition wire connection and CAN. 4x RED = Required ignition output diode not detected.

CARTRIDGE INSTALLATION

1. Slide cartridge into unit. Notice button under LED.
2. Ready for Module Programming Procedure.

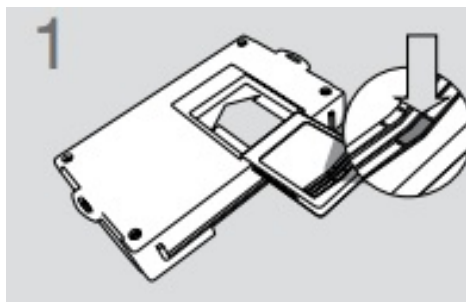

MODULE PROGRAMMING PROCEDURE

1. For this installation, the Weblink HUB is required.

2. Remove OEM key 1 from keychain.

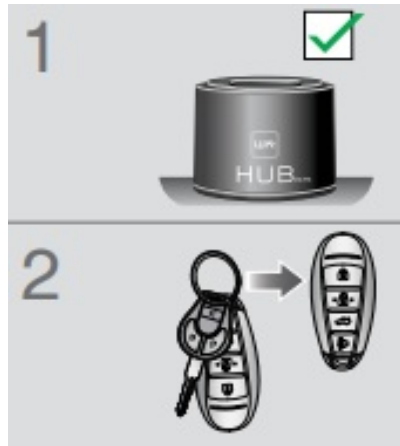

3. Flash the module using the Weblink HUB. Follow the on screen instructions to complete the keyfob reading process.

WARNING:

Place all other keyfobs at least 1 foot away from the Weblink HUB. Failure to comply may result in damage to other keyfobs or interfere with the keyfob reading process.

4. Do not press the module programming button.



5. Using OEM key 1, turn key to ON position.



6. Wait, LED will turn solid BLUE for

7. Turn key to OFF position.

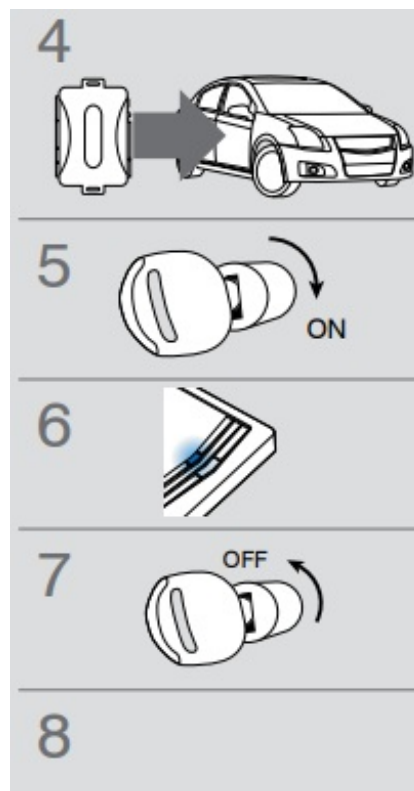
8. Module Programming Procedure completed.

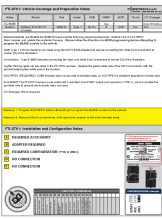

Documents / Resources

	<p>FIRSTTECH FTI-STK1 Outback STD KEY AT [pdf] Installation Guide BLADE-AL-SUB9, Weblink Hub, ACC RFID1, FTI-STK1 Outback STD KEY AT, FTI-STK1, Outback STD KEY AT, STD KEY AT, KEY AT, AT</p>
	<p>FIRSTTECH FTI-STK1 Outback STD KEY AT [pdf] Installation Guide BLADE-AL-SUB9, CM7000-7200, CM-X, FTI-STK1 Outback STD KEY AT, FTI-STK1, Outback STD KEY AT, STD KEY AT, KEY AT, AT</p>

References

- [User Manual](#)

[Manuals+](#), [Privacy Policy](#)

This website is an independent publication and is neither affiliated with nor endorsed by any of the trademark owners. The "Bluetooth®" word mark and logos are registered trademarks owned by Bluetooth SIG, Inc. The "Wi-Fi®" word mark and logos are registered trademarks owned by the Wi-Fi Alliance. Any use of these marks on this website does not imply any affiliation with or endorsement.