

**FIRSTECH**  
FIRSTECH FTI-STK1  
WrX Std Key At



## FIRSTECH FTI-STK1 Legacy STD KEY AT Installation Guide

[Home](#) » [FIRSTECH](#) » FIRSTECH FTI-STK1 Legacy STD KEY AT Installation Guide 

### Contents

- [1 FIRSTECH FTI-STK1 Legacy STD KEY AT](#)
- [2 MODULE PROGRAMMING PROCEDURE](#)
- [3 Documents / Resources](#)
  - [3.1 References](#)
- [4 Related Posts](#)



### FIRSTECH FTI-STK1 Legacy STD KEY AT



### FTI-STK1: Vehicle Preparation and Coverage Notes

Make	Model	Year	Instal I	CAN	IMM O	BC M	Clut c h	I/O Changes
Subaru	Legacy STD KEY AT (Canada )	2020-24	Type 1	20-Pin	B	DSD	N/A	Green White/Blue

### Vehicle Coverage Details

The vehicle covered uses the BLADE-AL-SUB9 firmware and the following required accessories: Weblink Hub and ACC RFID1. Update and activate the controller firmware. Follow instructions for RFID programming before attempting to program the BLADE module in the vehicle.

### CAN

CAN Type 1 connections are made with the 20-pin BCM adapter, requiring connections to the white and black connectors of 2 pins in the harness [D] of the illustration.

### Immobilizer

IMMO Type B requires connecting two white and black pins in marker [C] of the illustration.

### Lights

Parking lights are pre-wired in the FTI-STK1 harness. Replace the green/white wire of the CM I/O with the green/white wire provided in the harness.

### ACC-RFID1 (Required)

The SUB9 firmware does not provide immobilizer data, requiring an ACC-RFID1 for remote start.

### 2nd Start

The FTI-STK1 harness is pre-wired with a 2nd Start red/black output (not required in Type 1), which must be short-circuited when not used.

### I/O Changes

No changes required.

### Installation and Configuration Notes

- **A:** Required Accessory
- **B:** Adapter Required
- **C:** Configuration Required (Type B IMMO)
- **D:** No Connection
- **E:** No Connection

### Function Coverage

Function	Status
Immobilizer Data	Available
Arm OEM Alarm	Available
Disarm OEM Alarm	Available
Door Lock	Available
Door Unlock	Available
Priority Unlock	Available
Trunk/Hatch Release	Available
Tach Output	Available
Door Status	Available
Trunk Status	Available
Brake Status	Available
E-Brake Status	Available
A/M Alarm Control from OEM Remote	Available
A/M RS Control from OEM Remote	Available
Autolight Control	Available

## Installation Guide

### Cartridge Installation

1. Slide cartridge into unit. Notice button under LED.
2. Ready for Module Programming Procedure.

### Module Programming Procedure

1. For this installation, the Weblink HUB is required.
2. Remove OEM key 1 from keychain. Place all other keyfobs at least 1 foot away from the Weblink HUB to avoid interference.
3. Flash the module using the Weblink HUB. Follow on-screen instructions to complete the keyfob reading process.
4. Warning: Do not press the module programming button. Connect power first. Connect module to vehicle.
5. Using OEM key 1, turn key to ON position.
6. Wait, LED will turn solid BLUE for 2 seconds.
7. Turn key to OFF position.
8. Module Programming Procedure completed.

### LED Programming Error Codes

- ## Specifications

## FAQ

- No I/O changes are required.

Make	Model	Year	Install	CAN	IMMO	BCM	Clutch	I/O Changes
DL-SUB9 Subaru	Legacy STD KEY AT (Canada)	2020-24	Type 1	20-Pin	Type B	DSD	N/A	Green White/Blue N/A

[illegible]

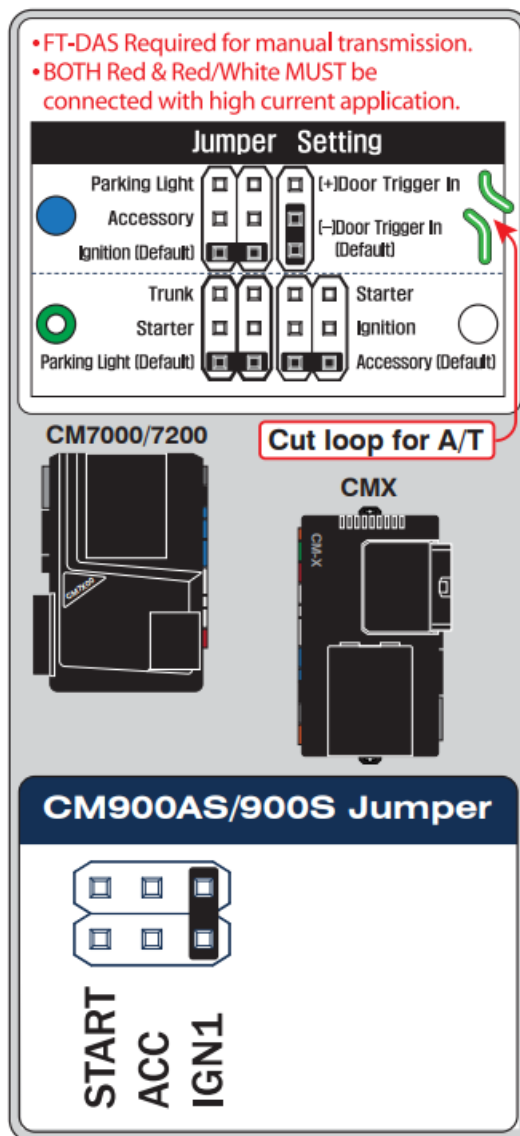

**FTI-STK1 – AL-SUB9 – Type 1**  
 2020-24 Subaru Legacy STD KEY AT (CA)

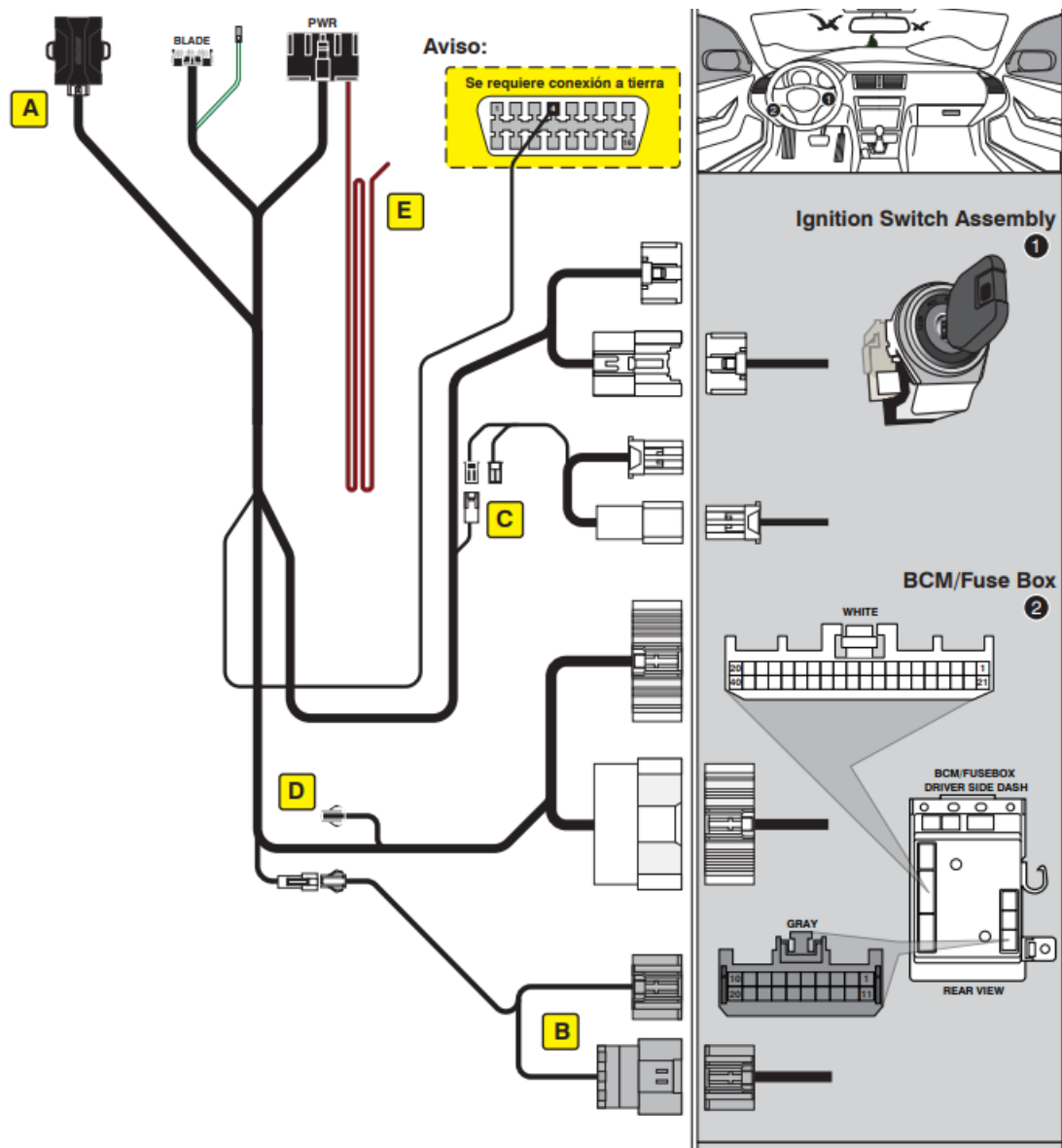

## CARTRIDGE INSTALLATION

1. Slide cartridge into unit. Notice button under LED.

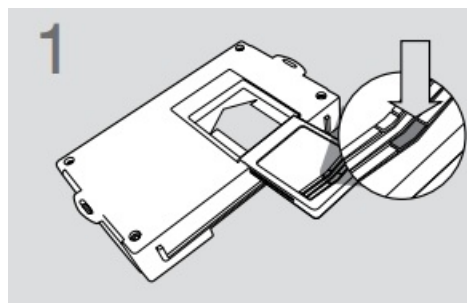

2. Ready for Module Programming Procedure.

## MODULE PROGRAMMING PROCEDURE

1. For this installation, the Weblink HUB is required.
2. Remove OEM key 1 from keychain.

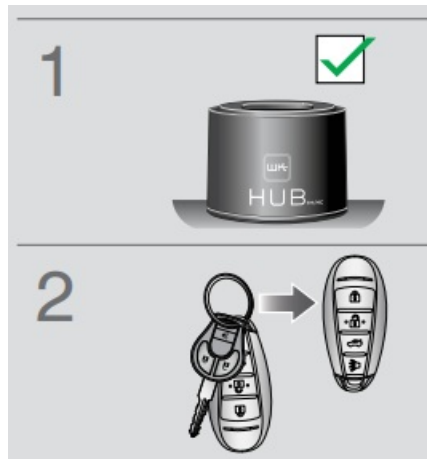

Place all other keyfobs at least 1 foot away from the Weblink HUB. Failure to comply may result in damage to other keyfobs or interfere with the keyfob reading process.

3. Flash the module using the Weblink HUB. Follow the on screen instructions to complete the keyfob reading process.



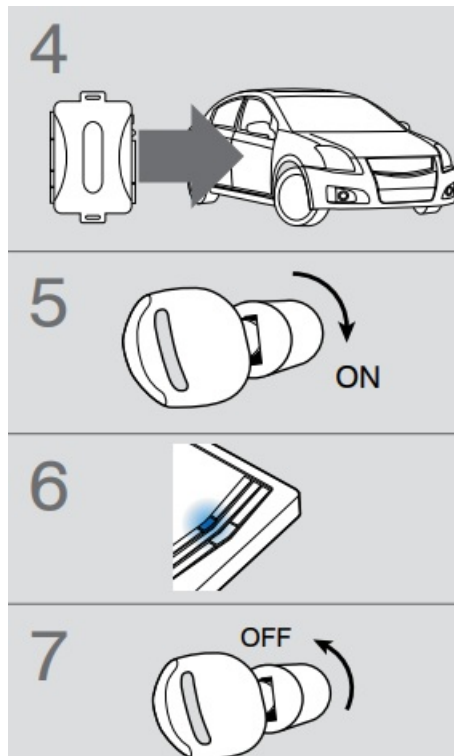

**WARNING:**

4. Do not press the module programming button.  
Connect power first.  
Connect module to vehicle.
5. Using OEM key 1, turn key to ON position.
6. Wait, LED will turn solid BLUE for 2 Second .
7. Turn key to OFF position.
8. Module Programming Procedure completed.



## Documents / Resources

	<p><a href="#">FIRSTTECH FTI-STK1 Legacy STD KEY AT</a> [pdf] Installation Guide            CM7000-7200, CM-900S-900AS, CM-900, FTI-STK1 Legacy STD KEY AT, FTI-STK1, Legacy S            TD KEY AT, STD KEY AT, KEY AT</p>
	<p><a href="#">FIRSTTECH FTI-STK1 Legacy STD KEY AT</a> [pdf] Installation Guide            BLADE-AL-SUB9, CM7000-7200, CM-X, FTI-STK1 Legacy STD KEY AT, FTI-STK1, Legacy ST            D KEY AT, STD KEY AT, KEY AT</p>
	<p><a href="#">FIRSTTECH FTI-STK1 Legacy STD KEY AT</a> [pdf] Installation Guide            Type 3 2020-24, FTI-STK1 Legacy STD KEY AT, FTI-STK1, Legacy STD KEY AT, STD KEY AT,            AT</p>

## References

- [!\[\]\(48a7667d09d5a06397e047ee4537bb6f\_img.jpg\) iDataLink - Home](#)
- [User Manual](#)

[Manuals+](#), [Privacy Policy](#)

This website is an independent publication and is neither affiliated with nor endorsed by any of the trademark owners. The "Bluetooth®" word mark and logos are registered trademarks owned by Bluetooth SIG, Inc. The "Wi-Fi®" word mark and logos are registered trademarks owned by the Wi-Fi Alliance. Any use of these marks on this website does not imply any affiliation with or endorsement.