



FIRSTTECH FTI-NSP8  
Vehicle Preparation  
and Coverage



# FIRSTTECH FTI-NSP8 Vehicle Preparation and Coverage Installation Guide

[Home](#) » [FIRSTTECH](#) » FIRSTTECH FTI-NSP8 Vehicle Preparation and Coverage Installation Guide 

## Contents

- [1 FIRSTTECH FTI-NSP8 Vehicle Preparation and Coverage](#)
- [2 Product Information](#)
- [3 Product Usage Instructions](#)
- [4 MODULE PROGRAMMING PROCEDURE](#)
- [5 TAKE OVER PROCEDURE – PUSH TO START – TO THE VEHICLE OWNER](#)
- [6 Documents / Resources](#)
  - [6.1 References](#)
- [7 Related Posts](#)



## FIRSTTECH FTI-NSP8 Vehicle Preparation and Coverage



Product Information

Specifications

- Make: DL-NI8 Nissan
- Model: Altima PTS AT
- Year: 2019-2024 Type 1
- Compatible with CAN BCM Lights
- POC I/O Changes: Park/Auto, POC 1, DSD
- Color Coding: Green White/Blue

Product Usage Instructions

Installation

1. Connect the white 2-pin female door lock connector to the white 2-pin male BCM bridge (A).
2. Ensure secure connections for E/S connectors not used.
3. Follow all warnings during the installation process.

Module Programming

1. Set ignition to ON position.
2. Wait for LED to turn solid RED, then solid BLUE for 1 second, then solid RED.
3. Disconnect power last and connect module to computer for extended programming.

Remote Start Sequence

1. Ensure all vehicle doors are closed and locked before initiating the remote start sequence.
2. Follow the take-over procedure for push-to-start vehicles.
3. Open vehicle door, enter, close door, press and release brake pedal within 45 seconds from the previous step.

FAQ

- **Q: What should I do if the LED flashes blue rapidly during programming?**  
A: Proceed with step 7 of the module programming procedure.
- **Q: What is the warning regarding power disconnection during module programming?**  
A: Disconnect power last and ensure the module is disconnected from the vehicle before proceeding with extended programming.
- **Q: Why is it important to have all vehicle doors closed and locked before remote start?**  
A: Failure to comply may result in remote starter malfunction.

Make	Model	Year	Install	CAN	Lights	BCM	POC	I/O Changes
DL-NI8 Nissan	Altima PTS AT	2019-24	Type 1	BCM	Park / Auto POC 1	DSD	Hazard 1/2	Green White/Blue

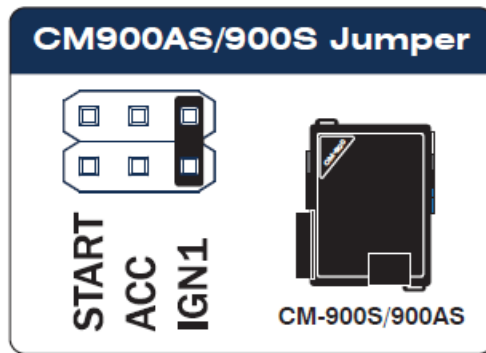

COBERTURA DE FUNCIONES																			
<input type="checkbox"/>	<input type="checkbox"/>	<input type="checkbox"/>	<input type="checkbox"/>	<input type="checkbox"/>	<input type="checkbox"/>	<input type="checkbox"/>	<input type="checkbox"/>	<input type="checkbox"/>	<input type="checkbox"/>	<input type="checkbox"/>	<input type="checkbox"/>	<input type="checkbox"/>	<input type="checkbox"/>	<input type="checkbox"/>	<input type="checkbox"/>	<input type="checkbox"/>	<input type="checkbox"/>	<input type="checkbox"/>	<input type="checkbox"/>
IMMOBILIZER DATA		DOOR LOCK	DOOR UNLOCK	ARM OEM ALARM	DISARM OEM ALARM					DOOR STATUS	TRUNK STATUS		BRAKE STATUS	E-BRAKE STATUS	TACH OUTPUT			SECURE TAKEOVER	HAZARD LIGHTS

- FT-DAS Required for manual transmission.
- BOTH Red & Red/White MUST be connected with high current application.

**Jumper Setting**

<input type="radio"/>	Parking Light	<input type="checkbox"/>	<input type="checkbox"/>	<input type="checkbox"/>	(+)Door Trigger In	
<input type="radio"/>	Accessory	<input type="checkbox"/>	<input type="checkbox"/>	<input type="checkbox"/>	(-)Door Trigger In (Default)	
<input type="radio"/>	Ignition (Default)	<input type="checkbox"/>	<input type="checkbox"/>	<input type="checkbox"/>		
<input type="radio"/>	Trunk	<input type="checkbox"/>	<input type="checkbox"/>	<input type="checkbox"/>	<input type="checkbox"/>	Starter
<input type="radio"/>	Starter	<input type="checkbox"/>	<input type="checkbox"/>	<input type="checkbox"/>	<input type="checkbox"/>	Ignition
<input type="radio"/>	Parking Light (Default)	<input type="checkbox"/>	<input type="checkbox"/>	<input type="checkbox"/>	<input type="checkbox"/>	Accessory (Default)

**CM7000/7200**

**CMX**

**Cut loop for A/T**

#### CMX High Current Programmable (+) Output Channels

HCP #1 – Parking Light

HCP #2 – Accessory

HCP #3 – Ignition

[ 2 ] 2ND START

[ 3 ] 2ND IGNITION

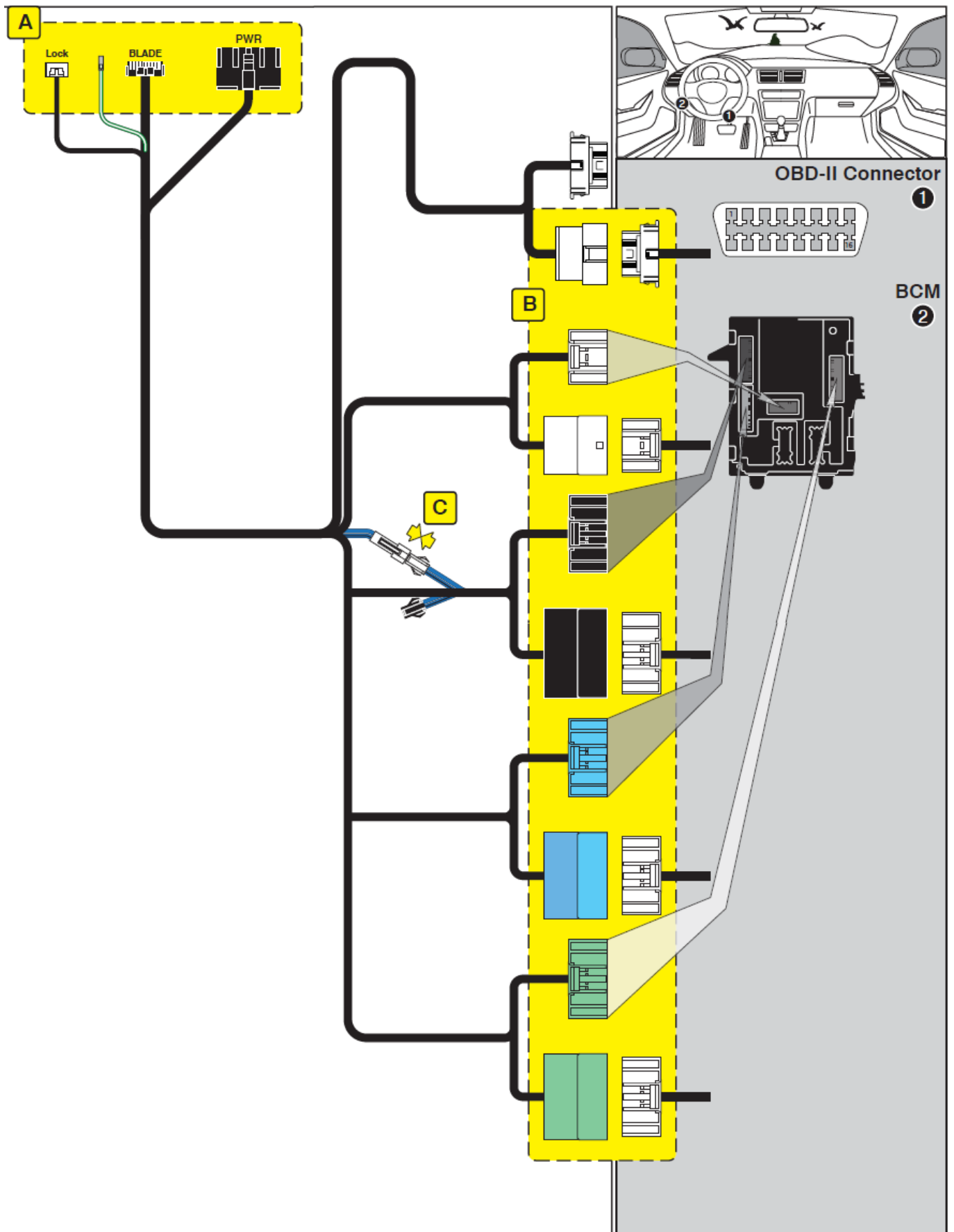

## CARTRIDGE INSTALLATION

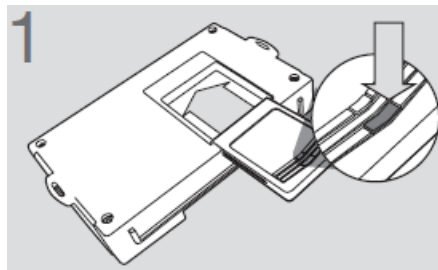

Slide cartridge into unit. Notice button under LED.

## MODULE PROGRAMMING PROCEDURE

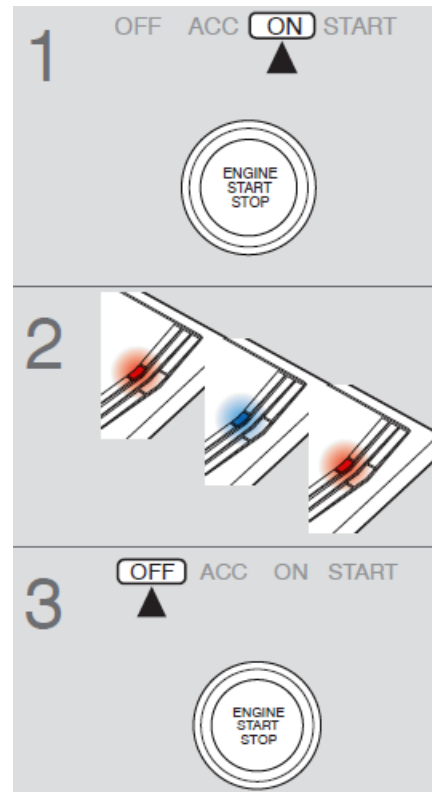

1. Set ignition to ON position.
2. Wait, LED will turn solid RED, then solid BLUE for 1 second, then solid RED.
3. Set ignition to OFF position.
- 4.

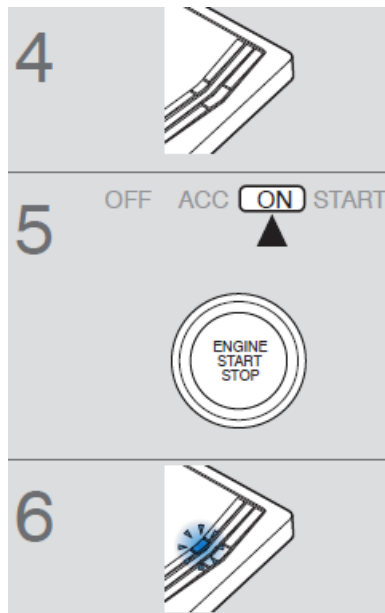

Wait, LED will turn OFF.

5. Set ignition to ON position.

6. If LED flashes BLUE rapidly, proceed with step 7. If LED turns solid BLUE for 2 seconds, proceed with step 13.

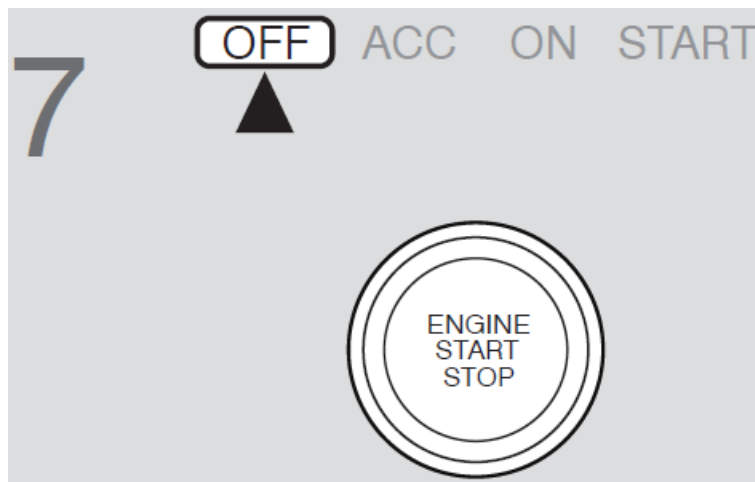

7. Set ignition to OFF position.

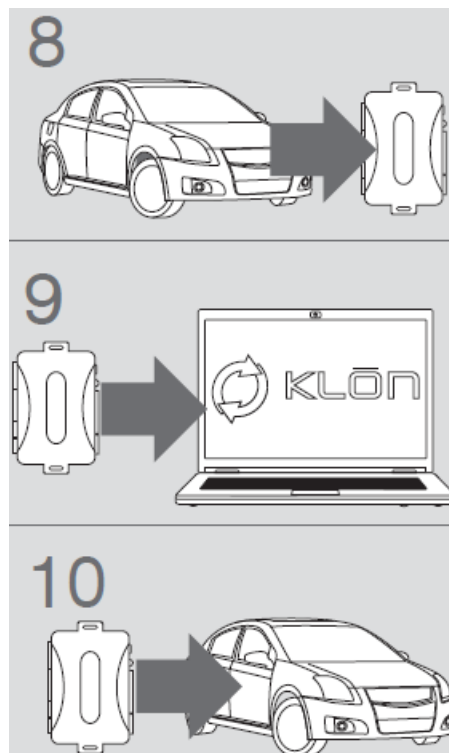

8. WARNING:

Disconnect power last. Disconnect module from vehicle.

9. Connect module to computer and proceed with extended programming.

10. **WARNING:** Connect power first. Connect module to vehicle.



11. Set ignition to ON position.

12. Wait, LED will turn solid BLUE for 2 seconds.

13. Set ignition to OFF position.

14. Module Programming Procedure completed.

**WARNING: READ BEFORE REMNO OTICETE STARTING THE VEHICLE**

**IMPORTANT**

All vehicle doors must be closed and locked prior to remote start sequence. Failure to comply will result in remote starter malfunction.

**TAKE OVER PROCEDURE – PUSH TO START – TO THE VEHICLE OWNER**

**NOTE**

All vehicle doors must be closed and locked prior to remote start sequence.



1. Unlock vehicle door using OEM or after-market remote, or door request switch.



## 2. TIME RESTRICTIN

Within 45 SECONDS from previous step:

Open vehicle door.

Enter vehicle.

Close vehicle door.

Press and release BRAKE pedal.

## 3. Take over procedure completed.

Failure to follow procedure will result in vehicle engine shutdown.

[WWW.IDATALINK.COM](http://WWW.IDATALINK.COM)

## Documents / Resources

	<p><a href="#">FIRSTTECH FTI-NSP8 Vehicle Preparation and Coverage [pdf]</a> Installation Guide FTI-NSP8, NI8-Nissan Altima PTS AT_19-24_SPX, FTI-NSP8 Vehicle Preparation and Coverage, FTI-NSP8, Vehicle Preparation and Coverage, Preparation and Coverage, Coverage</p>
--	---

## References

- [iDatalink - Home](#)
- [User Manual](#)

[Manuals+](#), [Privacy Policy](#)

This website is an independent publication and is neither affiliated with nor endorsed by any of the trademark owners. The "Bluetooth®" word mark and logos are registered trademarks owned by Bluetooth SIG, Inc. The "Wi-Fi®" word mark and logos are registered trademarks owned by the Wi-Fi Alliance. Any use of these marks on this website does not imply any affiliation with or endorsement.