



FIRSTECH FTI-NSP3 Frontier Intelli Key PTS AT Installation Guide

[Home](#) » [FIRSTECH](#) » FIRSTECH FTI-NSP3 Frontier Intelli Key PTS AT Installation Guide 



Contents

- 1 FTI-NSP3: Vehicle Coverage and Preparation Notes
- 2 FTI-NSP3 – DL-NI3 – Type 2 2020-24 Nissan Frontier Intelli-Key PTS AT
- 3 CARTRIDGE INSTALLATION
- 4 MODULE PROGRAMMING PROCEDURE
- 5 Documents / Resources
 - 5.1 References

FTI-NSP3: Vehicle Coverage and Preparation Notes

Make	Model	Year	Install	IGN	Lights	BCM	POC	I/O Changes
DL-NI3 Nissan	Frontier Intelli-Key PTS AT	2020-24	Type 2	YES	Park / Auto POC 1 Hazard1/2	RSC	See note	Green White/Blue None/IGN

- Install Type 2 requires BLADE-AL(DL)-NI3 firmware, flash module and update the controller firmware before installing.
- **CAN:** The NSP3 harness does not require any additional connections or special configuration of the harness for CAN data connections, the NI3 CAN connections are hardwired between the black 20-pin BLADE and black 40-pin BCM connectors.
- **Lights:** Visual status confirmations and diagnostic information are provided via hazard lights when using the NSP3 harness.
- The controller POC1 output must be configured for one of the following settings (depending on switch type):
 - Hazard light [30] (momentary hazard switch)
 - Hazard light 2 [23] (latching hazard switch)

POC Configuration:

- CMX: POC2 – 2nd START [2]
- POC3 – 2nd IGN [3]
- CM9: POC3 – (-) START
- POC4 – (-) IGNITION

I/O Changes: Type 2 requires configuring the CN1 blue wire for ACC output, controller specific settings are listed.

Vehicle Damage Warning:

Caution should be taken to avoid mixing up the BCM connectors, vehicle damage will result if the connectors are positioned improperly. It is advised that you make the BCM connections one at a time, confirming that each T-harness connection is at the correct BCM position before proceeding to the next connection, attempting to program, or attempting to remote start.

FTI-NSP3: Installation and Configuration Notes

- **A** REQUIRED CONNECTIONS – SECURE UNUSED I/O CONNECTORS
- **B** REQUIRED CONNECTIONS – SEE WARNING ABOVE
- **C** REQUIRED CONNECTION



FEATURE COVERAGE															
IMMOBILIZER DATA															
PRIORITY UNLOCK															
DOOR LOCK															
DOOR UNLOCK															
ARM OEM ALARM															
DISARM OEM ALARM															
TRUNK/HATCH RELEASE															
HOOD STATUS															
DOOR STATUS															
TRUNK STATUS															
BRAKE STATUS															
E-BRAKE STATUS															
TACH OUTPUT															
SECURE TAKEOVER															
HAZARD LIGHTS															

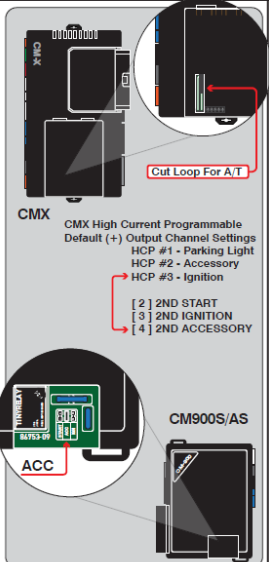

CMX
CMX High Current Programmable
Default (+) Output Channel Settings
HCP #1 - Parking Light
HCP #2 - Accessory
HCP #3 - Ignition

[2] 2ND START
[3] 2ND IGNITION
[4] 2ND ACCESSORY

CM900S/AS

FTI-NSP3 – DL-NI3 – Type 2 2020-24 Nissan Frontier Intelli-Key PTS AT

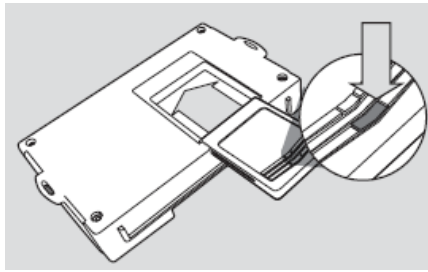

2. Ready for Module Programming Procedure.

MODULE PROGRAMMING PROCEDURE

1. Push start button twice [2x] to ON position.

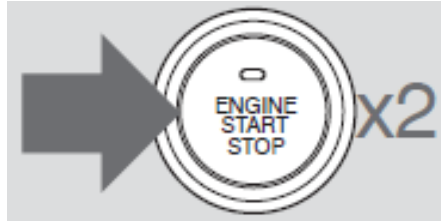

2. Wait, LED will turn solid BLUE for 2 seconds

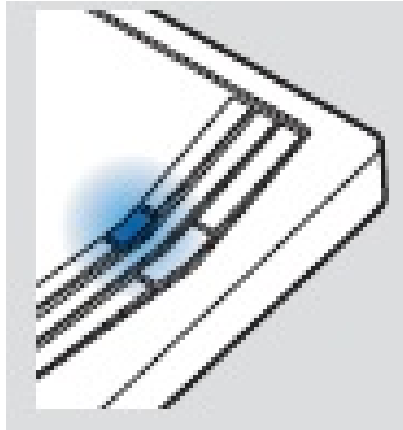

3. Push start button once [1x] to OFF position.

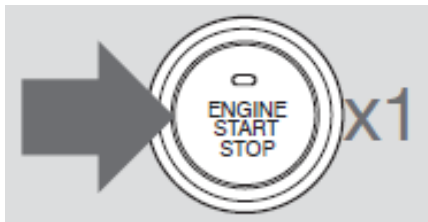

4. Module Programming Procedure completed.

PUSH TO START VEHICLE TAKE OVER PROCEDURE – TO THE VEHICLE OWNER

NOTE

This procedure is to be followed during remote starter runtime prior to entering vehicle.
All vehicle doors must be closed.

1. Press UNLOCK on after-market remote or OEM fob.



2. Open vehicle door.
Enter vehicle WITH THE OEM FOB.
Close vehicle door.

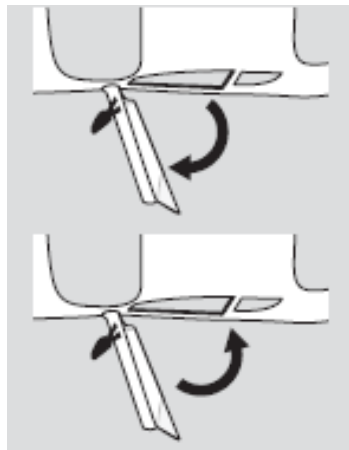

3. Wait for the LED indicator of the push button to be in the ON position.

OR

Wait for the ORANGE LED indicator of the push button to turn on.

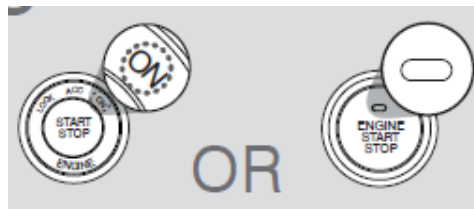

4. Press and release BRAKE pedal.



5. It is safe to select gear ONLY AFTER LED indicator is in ON position.

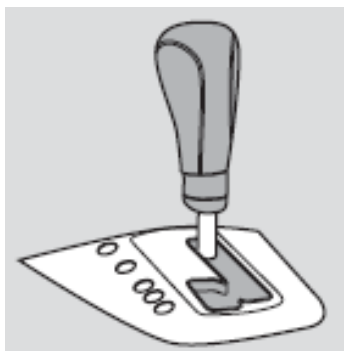

6. Push to Start vehicle take over procedure completed.

Failure to follow procedure may result in vehicle displaying CHECK ENGINE or TIRE PRESSURE error messages.



© 2020 Automotive Data Solutions Inc.
WWW.IDATALINK.COM

Documents / Resources

	FIRSTTECH FTI-NSP3 Frontier Intelli Key PTS AT [pdf] Installation Guide FTI-NSP3 Frontier Intelli Key PTS AT, FTI-NSP3, Frontier Intelli Key PTS AT, Intelli Key PTS AT, Key PTS AT, PTS AT, AT
---	--

References

- [iDataLink - Home](#)
- [User Manual](#)

[Manuals+](#), [Privacy Policy](#)

This website is an independent publication and is neither affiliated with nor endorsed by any of the trademark owners. The "Bluetooth®" word mark and logos are registered trademarks owned by Bluetooth SIG, Inc. The "Wi-Fi®" word mark and logos are registered trademarks owned by the Wi-Fi Alliance. Any use of these marks on this website does not imply any affiliation with or endorsement.