



FIRSTECH FTI-NSP2 Vehicle Preparation and Coverage Installation Guide

[Home](#) » [FIRSTECH](#) » FIRSTECH FTI-NSP2 Vehicle Preparation and Coverage Installation Guide 



Contents

1 FTI-NSP2 Vehicle Preparation and Coverage

2 Installation and Configuration

3 MODULE PROGRAMMING PROCEDURE

4 CONTACT

5 WWW.IDATALINK.COM Automotive Data Solutions Inc. © 2020

6 Documents / Resources

6.1 References

FTI-NSP2 Vehicle Preparation and Coverage

Product Usage Instructions

- When connecting the harness, follow these guidelines:
- CAN: The NSP2 harness is pre-configured for NI3 applications.
- Lights: Use hazard lights for visual status confirmation.
- POC Configuration: Configure POC1 output based on switch type.
- I/O Changes: No configuration is needed for Type 3 CN1 blue wire.

Exercise caution to avoid damaging the vehicle during installation. Connect BCM connectors one at a time, ensuring correct positioning before proceeding.

FTI-NSP2: Vehicle Coverage and Preparation Notes

Make	Model	Year	Install	CAN	Lights	BCM	POC	I/O Changes
DL-NI3 Nissan	Murano Intelli-Key PTS AT	2015-24	Type 3	Type A	Park / Auto POC 1 Hazard1/2	BIC	See note	Green White/Blue None/None

- Install Type 3 requires BLADE-AL(DL)-NI3 firmware, flash module, and update the controller firmware before installing.
- CAN: The NSP2 harness, when configured for NI3 applications, does not require a specific configuration of the harness CAN connector, the NI3 CAN connections are hardwired between the white 14-pin connector and the Black 40-pin BCM connector.
- Lights: Visual status confirmations and diagnostic information are provided via hazard lights when using the NSP2 harness.
- The controller POC1 output must be configured for one of the following settings (depending on the switch type):
- Hazard light [30] momentary hazard switch
- Hazard light 2 [23] latching hazard switch

POC Configuration

- CM7/CMX: POC2 – 2nd START [2] POC3 – 2nd IGN [3]
- CM9: POC3 – (-) START POC4 – (-) IGNITION

I/O Changes: Type 3 requires no configuration of the CN1 blue wire, make no connection or configuration

Vehicle Damage Warning

Installation and Configuration

A: REQUIRED CONNECTIONS – SECURE UNUSED I/O CONNECTORS

C: REQUIRED CONNECTION

E: NOT REQUIRED

[illegible]

• FT-DAS Required for manual transmission.
 • BOTH Red & Red/White connected with high current application.

Jumper Setting			
Parking Light			(+)Door Trigger In
Accessory Ignition (Default)			(-)Door Trigger In (Default)
Trunk Starter			Starter Ignition
Parking Light (Default)			Accessory (Default)

CM7000/7200

Cut loop for A/T

CM-900S/900AS

CM900AS/900S Jumper

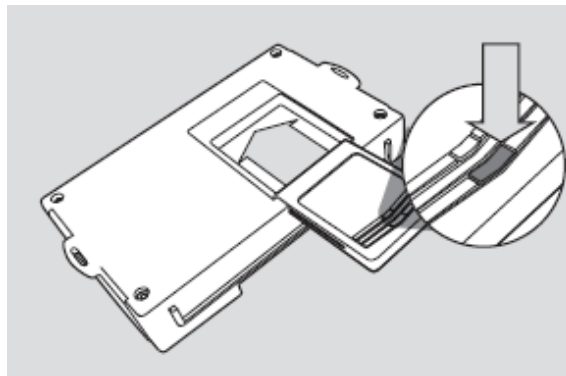

2. Ready for Module Programming Procedure.

MODULE PROGRAMMING PROCEDURE

1. Push the start button twice [2x] to the ON position.

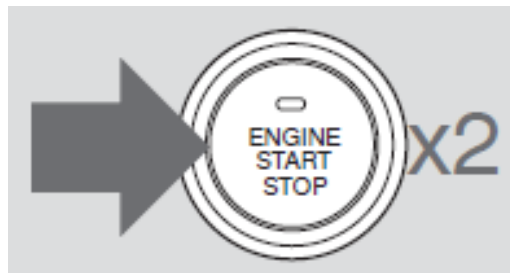

2. Wait, the LED will turn solid BLUE for 2 seconds.

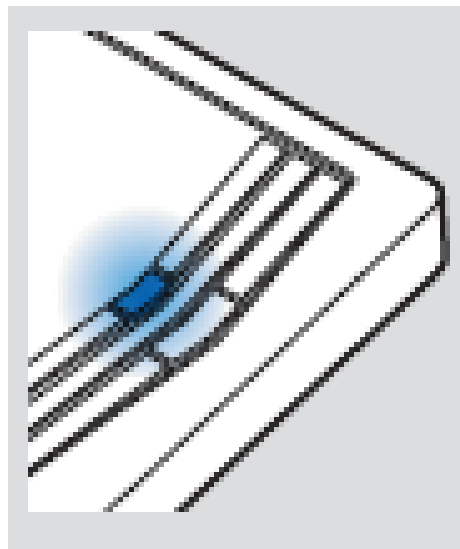

3. Push the start button once [1x] to the OFF position.

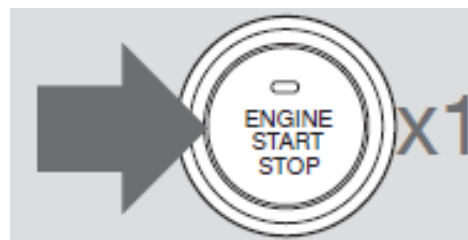

4. Module Programming Procedure completed.

PUSH TO START VEHICLE TAKEOVER PROCEDURE – TO THE VEHICLE OWNER

NOTE

This procedure is to be followed during remote starter runtime before entering the vehicle.
All vehicle doors must be closed.

1. Press UNLOCK on the after-market remote or OEM fob.



2. Open the vehicle door.

Enter the vehicle WITH THE OEM FOB.

Close the vehicle door.

- 3.

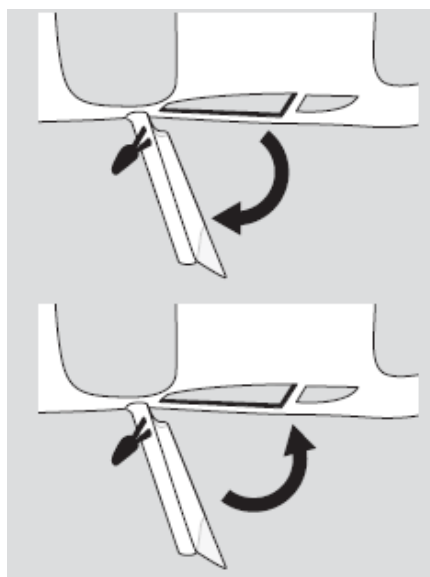

Wait for the LED indicator of the push button to be in the ON position.

OR

Wait for the ORANGE LED indicator of the push button to turn on.



4. Press and release the BRAKE pedal.



5. It is safe to select gear ONLY AFTER LED indicator is in the ON position.

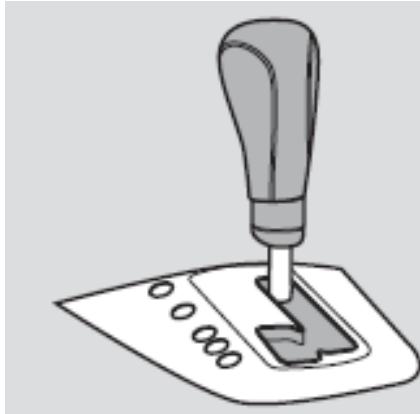

6. Push to Start vehicle takeover procedure completed.



Failure to follow procedure may result in a vehicle displaying CHECK ENGINE or TIRE PRESSURE error messages.

CONTACT

- Patent No. US 8,856,780 CA 2759622



Documents / Resources

	<p>FIRSTTECH FTI-NSP2 Vehicle Preparation and Coverage [pdf] Installation Guide FTI-NSP2 Vehicle Preparation and Coverage, FTI-NSP2, Vehicle Preparation and Coverage, Preparation and Coverage, Coverage</p>
--	---

References

- [!\[\]\(eae20f1adff742df783f6f7e3bbe72d1_img.jpg\) iDatalink - Home](#)
- [User Manual](#)

[Manuals+](#), [Privacy Policy](#)

This website is an independent publication and is neither affiliated with nor endorsed by any of the trademark owners. The "Bluetooth®" word mark and logos are registered trademarks owned by Bluetooth SIG, Inc. The "Wi-Fi®" word mark and logos are registered trademarks owned by the Wi-Fi Alliance. Any use of these marks on this website does not imply any affiliation with or endorsement.