



First Co A2L Sensor and TXV



First Co A2L Sensor and TXV Installation Guide

[Home](#) » [First Co](#) » First Co A2L Sensor and TXV Installation Guide 

Contents

- [1 First Co A2L Sensor and TXV](#)
- [2 Product Information](#)
- [3 Operation](#)
- [4 Maintenance](#)
- [5 FAQ](#)
- [6 SAFETY CONSIDERATIONS](#)
- [7 Bill of Materials](#)
- [8 A2L Sensor Mounting](#)
- [9 A2L Sensor Wiring](#)
- [10 Label Placement](#)
- [11 Installation](#)
- [12 Final Check](#)
- [13 Documents / Resources](#)
 - [13.1 References](#)



First Co A2L Sensor and TXV



Product Information

Specifications

- Model: A2L Sensor and TXV Ceiling Fan Coils
- Installation Manual: IOM # IOM4100 Rev. # A

Operation

- Ensure proper installation to avoid explosion, fire, electrical shock, or other hazardous conditions.
- Use adequate personal protection equipment when installing and performing maintenance.
- Verify a safe condition with an electrical tester after switching off and locking out an electrical disconnect.

Maintenance

- Refer to the individual instructions packaged with kits or accessories when performing maintenance.
- Discharge a capacitor before handling any PSC motor and wiring.
- Use eye protection and cut-resistant gloves and sleeves to protect against metal edges and screws.

FAQ

Q: What should I do if I need to replace parts?

A: Ensure to use of factory-authorized parts to avoid voiding the warranty or causing adverse operational performance.

Q: Are there specific safety considerations to keep in mind?

A: Yes, always follow the safety considerations outlined in the manual to prevent personal injury or damage.

ATTENTION: Read all instructions thoroughly and retain all manuals for future reference.

COPYRIGHT

The manufacturer works to continually improve its products and as a result, it reserves the right to change design and specifications without notice.

WARNING TO INSTALLER, SERVICE PERSONNEL AND OWNER

Altering the product or replacing parts with non-authorized factory parts voids all warranty or implied warranty and may result in adverse operational performance and/or a possible hazardous condition to service personnel and occupants. Company employees and/or contractors are not authorized to waive this warning.

SAFETY CONSIDERATIONS

1. READ THE ENTIRE MANUAL BEFORE BEGINNING INSTALLATION.
2. Improper installation, adjustment, alteration, service, maintenance, or use can cause explosion, fire, electrical shock, or other conditions which may cause personal injury or damage.
3. Consult a qualified licensed installer, service agency, or your distributor for information assistance. The qualified licensed installer or service agency must use factory-authorized kits or accessories when servicing this product.
4. Refer to the individual instructions packaged with kits or accessories when installing.
5. Follow all safety codes.
6. Read these instructions thoroughly and follow all warnings or cautions attached to the unit. Consult local building codes and National Electrical Code (NEC) for special requirements.
7. This appliance is not to be used by persons (including children) with reduced physical, sensory or mental capabilities, or lack of experience and knowledge, unless they have been given supervision or instruction. Children should be supervised to ensure that they do not play with the appliance. Use adequate personal protection equipment when installing and performing maintenance. After switching off and locking out an electrical disconnect, verify a safe condition with an electrical tester. Discharge a capacitor before handling any PSC motor and wiring. Use eye protection and cut resistant gloves and sleeves to protect against metal edges and screws.

RECOGNIZE THE FOLLOWING SAFETY NOTATIONS THROUGHOUT THIS MANUAL AND POSTED ON THE EQUIPMENT:

WARNING

Indicates a potentially hazardous situation or unsafe practices that could result in severe personal injury or death and/or damage to property.

WARNING

ELECTRIC SHOCK HAZARD

Signifies potential electrical shock hazards that could result in personal injury or death.

CAUTION

Indicates a potentially hazardous situation that may result in minor or moderate personal injury.

IMPORTANT

Suggests important procedure steps to insure proper installation, reliability, or operation.

NOTE

Used to highlight suggestions, which may result in enhanced installation, reliability or operation.

Bill of Materials

Components in Kit
Thermal Expansion Valve (TXV)
Tailpiece/liquid line attachment
O-rings (x2)
Nut
A2L Sensor
A2L Sensor Mounting Bracket
A2L Wire Kit
Self-Tapping Screws (4)
A2L Label – Flammable
A2L Label – Warning
A2L Label – TXV
A2L Label – Height Requirements
Strain Relief Bushing
Installation Instructions
Zip Ties

A2L Sensor Mounting

1. Remove control box cover.
2. Attach A2L sensor to bracket with provided screws. Figure 1.1
3. Attach bracket to unit as shown in Figure 1.2. Use provided screws. Bracket is installed on the header side.
4. Remove knockout, and attach bushing in Figure 1.4 to protect sensor wire kit.
5. Connect the A2L harness (Figure 1.5) from the sensor (Figure 1.3) to the unit wiring kit Molex. Refer to the unit wiring diagram for sensor wiring. Figure 2 shows an example wiring diagram excerpt.
6. Use zip-ties (provided in kit) to tidy any long wires. Keep loose wires away from fan.

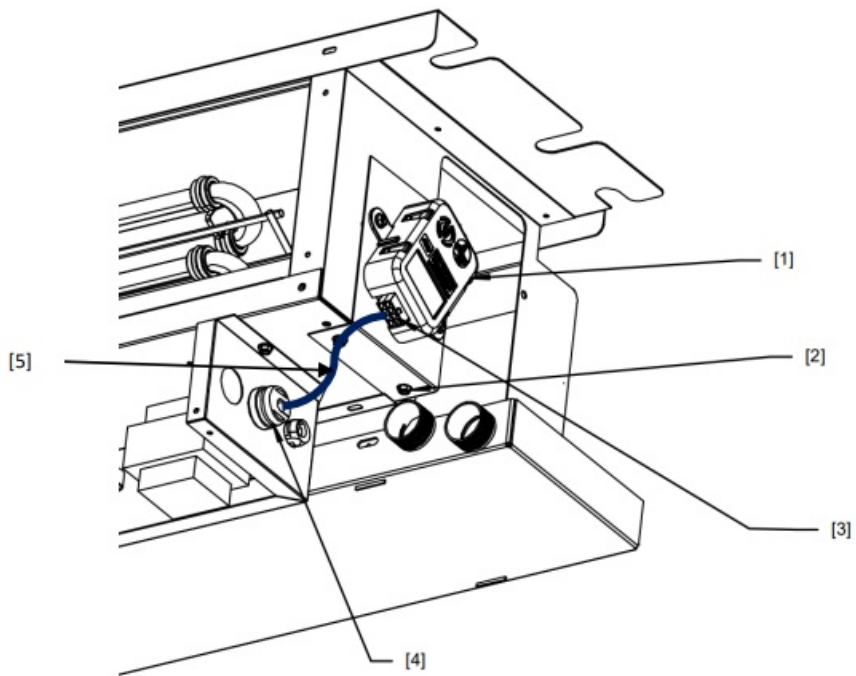

Figure 1: A2L Sensor Placement

A2L Sensor Wiring

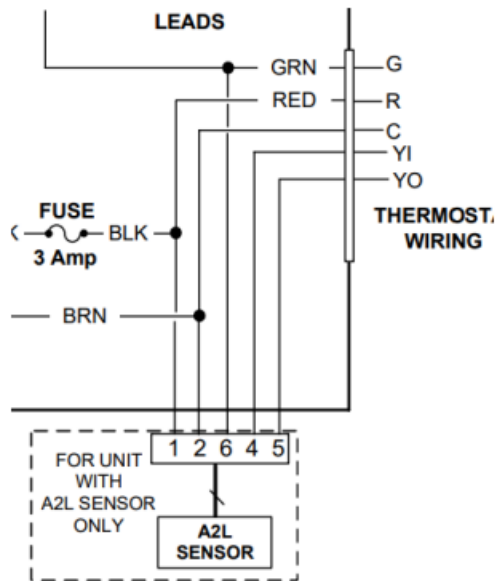
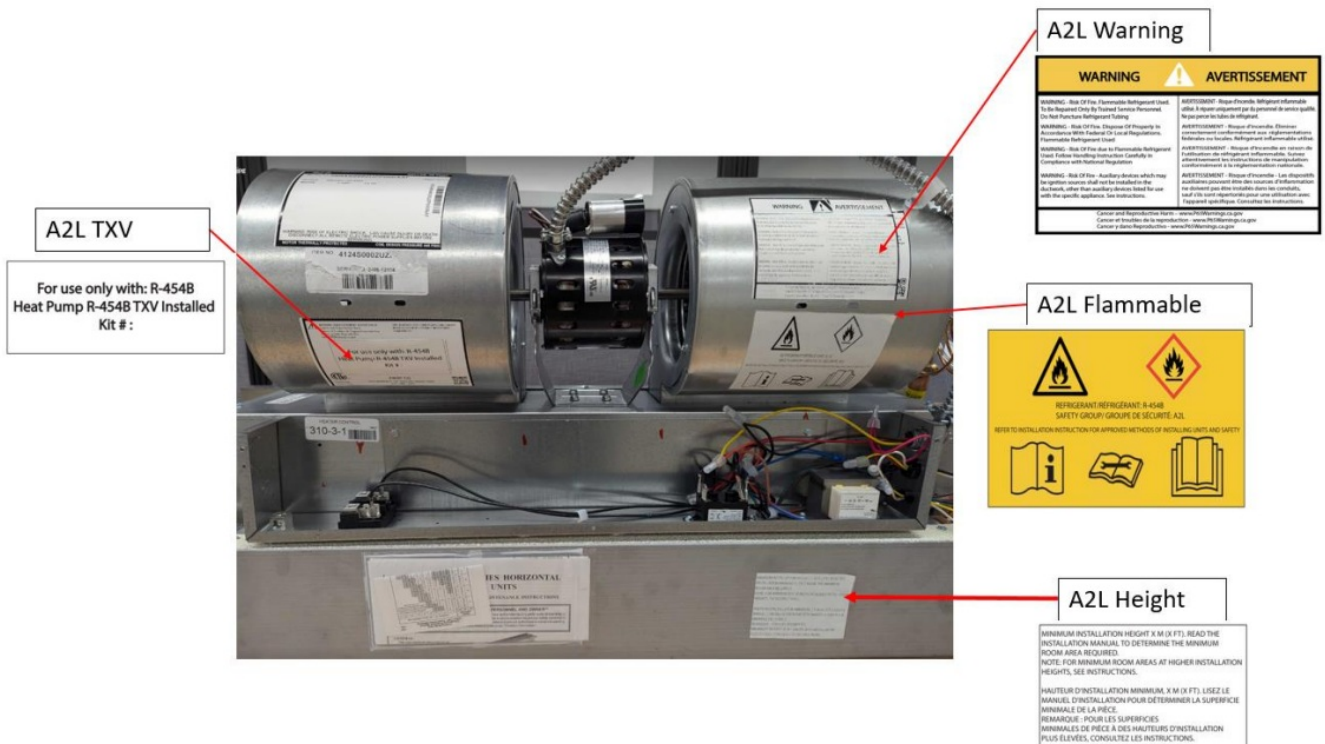

Figure 2: A2L Sensor example wiring

Label Placement

1. Attach the 4 labels provided in kit as shown in Figure 3.



Installation

1. Depressurize Schrader valve, remove liquid line tube from piston distributor body and discard.
2. Remove piston/orifice from inside of distributor body and discard. See figure 4.
3. Remove 1/4" cap from suction line equalizer fitting.
4. Check to make sure expansion valve has the correct refrigerant rating (R410A, R454B or R32).
5. Braze on liquid line to TXV attachment. Figure 5.1
6. Attach liquid line and nut to expansion valve male thread. Use provided O-rings. See figure 5.2. a.Torque to 260 in-lbs.
7. Attach expansion valve nut to distributor male thread. Use provided O-rings. See figure 5.3 a.Torque to 260 in-lbs.
8. Carefully bend and secure 1/4" equalizer tube to suction line equalizer fitting with a wrench. Figure 5.4. No valvecore is required. a.Torque to 125 in-lbs.
9. Locate and mount expansion valve sensing bulb on suction line above the centerline of the tube. Figure 5.5 Position should be between 9 and 3 o'clock.

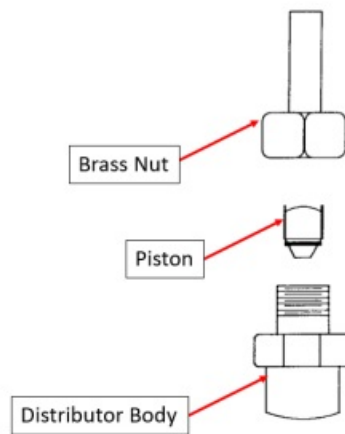

Figure 4: Piston (to be removed)

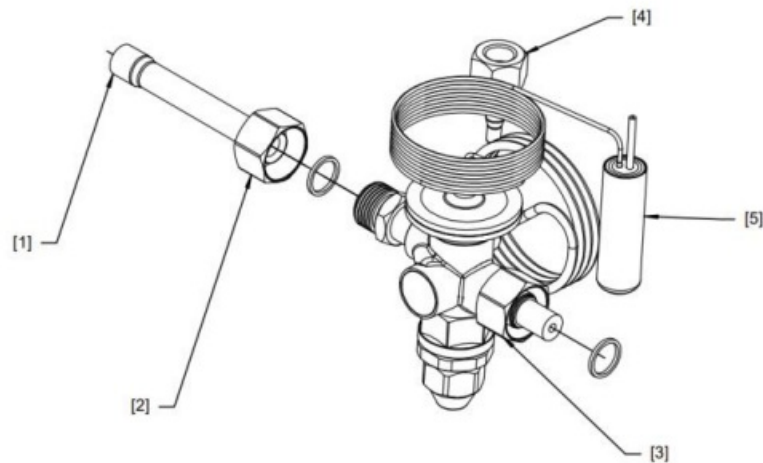

Figure 5: TXV attachment

Final Check

- Leak check all connections after unit has been pressurized.
- Follow manufacturer system guidelines for charging.
- Follow best HVAC installation practices for installing fittings.

P.O. Box 270969 Dallas, TX 75227

www.firstco.com or www.ae-air.com

The manufacturer works to continually improve its products, reserving the right to change design and specifications without notice.





©2022 First Co., Applied Environmental Air

Documents / Resources



[First Co A2L Sensor and TXV](#) [pdf] Installation Guide
IOM4100-A2L-Sensor.pdf, IOM IOM4100 Rev. A, A2L Sensor and TXV, A2L, Sensor and TXV, a
nd TXV

References

-  [AE Air | Commercial HVAC Solutions | Dallas, TX](#)
-  [AE Air | Commercial HVAC Solutions | Dallas, TX](#)
-  [First Co. – American-Made. Family-Owned.](#)
-  [First Co. – American-Made. Family-Owned.](#)
- [User Manual](#)

[Manuals+](#), [Privacy Policy](#)

This website is an independent publication and is neither affiliated with nor endorsed by any of the trademark owners. The "Bluetooth®" word mark and logos are registered trademarks owned by Bluetooth SIG, Inc. The "Wi-Fi®" word mark and logos are registered trademarks owned by the Wi-Fi Alliance. Any use of these marks on this website does not imply any affiliation with or endorsement.