

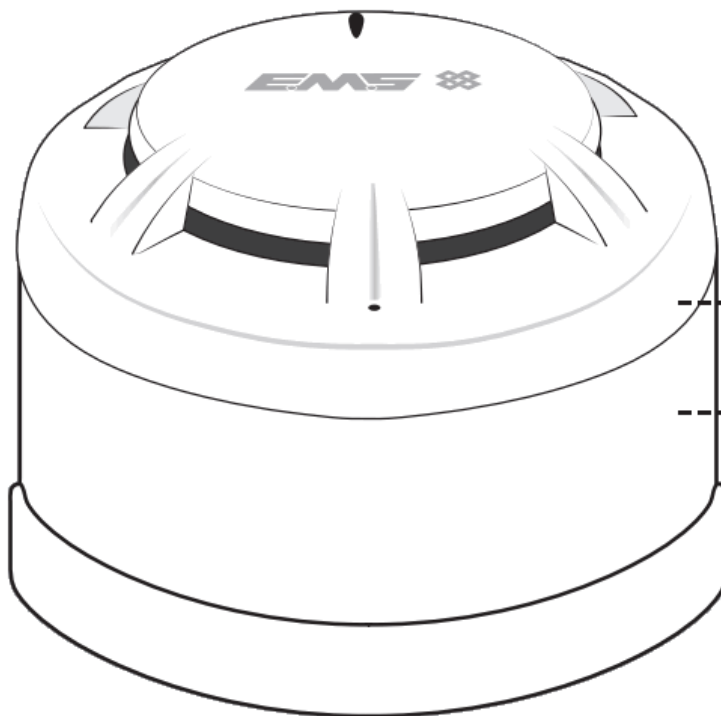

## Firecell FCX-170-001 Wireless Detector Installation Guide

[Home](#) » [firecell](#) » Firecell FCX-170-001 Wireless Detector Installation Guide 



Example shown:

FCX-177-001

FCX-170-001

Part no	Product Description	CPR
FCX-170-001	Wireless Detector Base Only	[3]
FCX-174-001	Multisensor Smoke Detector Only	[4]
FCX-175-001	Heat A1R Detector Only	[1]
FCX-176-001	Heat CS Detector Only	[1]
FCX-177-001	Optical Smoke Detector Only	[2]

See the Specification section for compliance information.

## Contents

- [1 Pre-installation](#)
- [2 Components](#)
- [3 Fix mounting plate](#)
- [4 Power device](#)
- [5 Optional device locking](#)
- [6 Device unlocking](#)
- [7 Configuration](#)
- [8 IMPORTANT](#)
- [9 Specification](#)
- [10 Regulatory information](#)
- [11 Documents / Resources](#)
  - [11.1 References](#)
- [12 Related Posts](#)

## Pre-installation



Installation must conform to applicable local installation codes and should only be installed by a fully trained competent person.

- Ensure that the device is installed as per the site survey.
- The use of a non-metallic spacer should be considered if mounting the device onto a metal surface.
- Do NOT Press the Log On button on a pre-programmed device, as this will cause communication with the Control
- Panel to be lost. Should this happen, delete the device from the system and add it back on.
- This device contains electronics that may be susceptible to damage from Electrostatic Discharge (ESD). Take appropriate precautions when handling electronic boards.

## Components

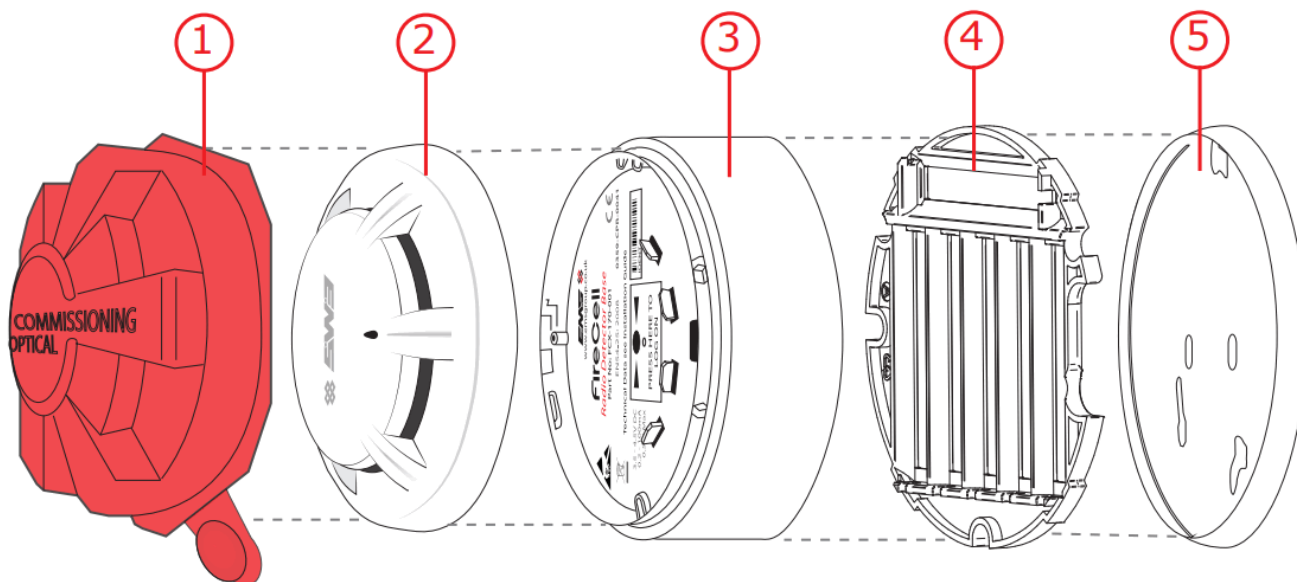

1. Dust cover
2. Detector
3. Wireless module
4. Battery retaining plate
5. Mounting plate

### Fix mounting plate

Remove the mounting plate by turning the device **ANTICLOCKWISE**, to release it from the mounting plate.  
Use both mounting holes to ensure a firm fixing.  
Use suitable fasteners and fixings.

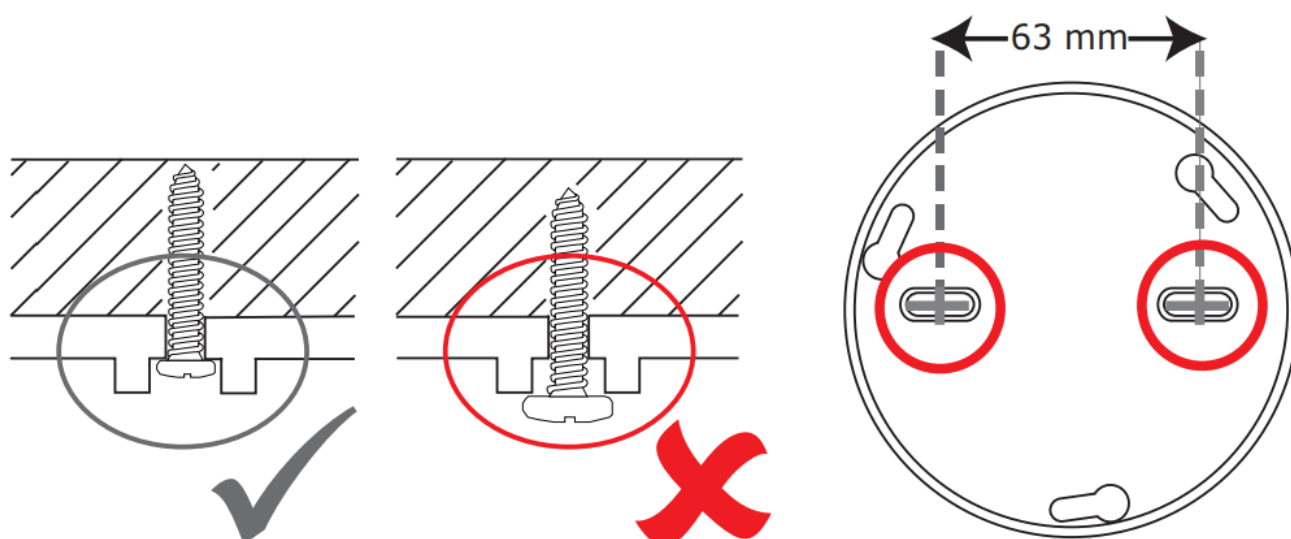

### Power device

- Unclip the battery retaining plate from the wireless module.
- When fitting / replacing batteries; observe correct polarity, using only specified batteries.
- Connect the power jumper across the PIN header.

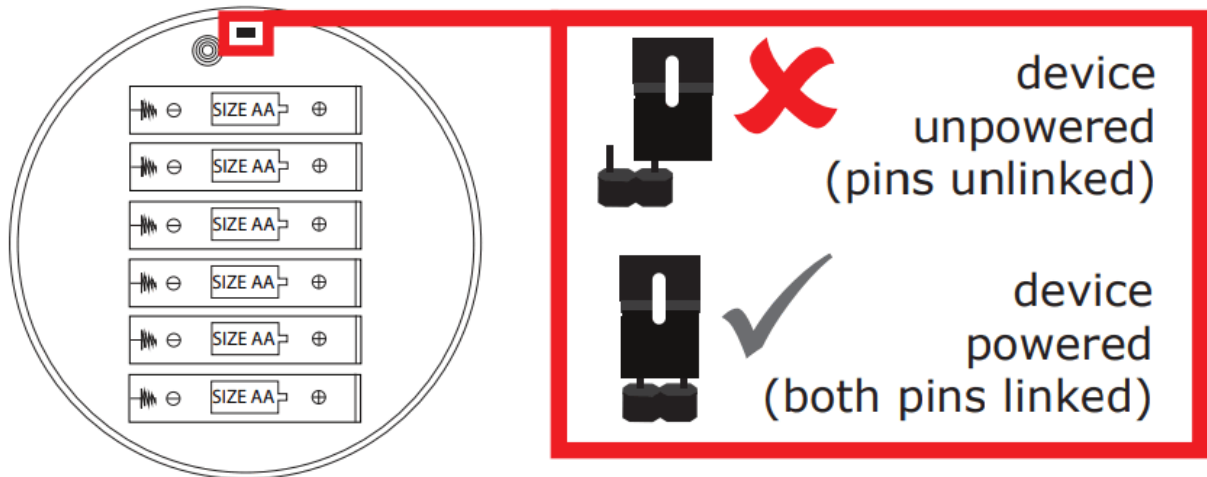

- Once powered, reassemble the device.

### Optional device locking

- To lock the wireless module into the mounting plate, insert a 1.5 mm Allen key into the Allen key slot and turn clockwise as shown.
- The detector can also be locked into the wireless module. To do so, prior to refitting the detector, remove the cut-out (shaded) sections shown.

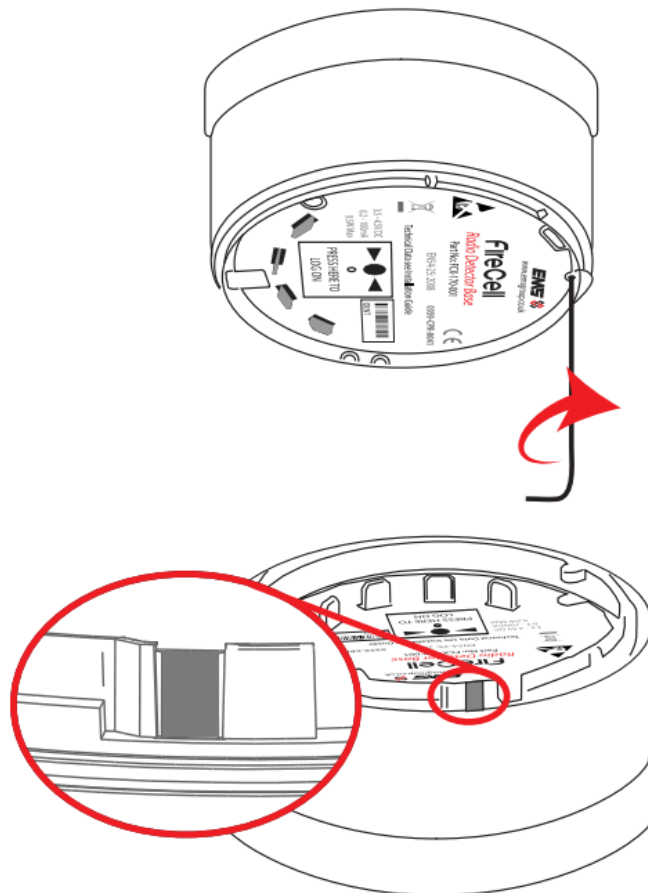

### Device unlocking

- To unlock the wireless module from the mounting plate, insert a 1.5 mm Allen key and turn anticlockwise to

release as shown.

- To unlock the detector from the wireless module, insert a 1.5mm Allen key and lever the Allen key towards the outside of the device whilst turning the detector anticlockwise to release as shown.

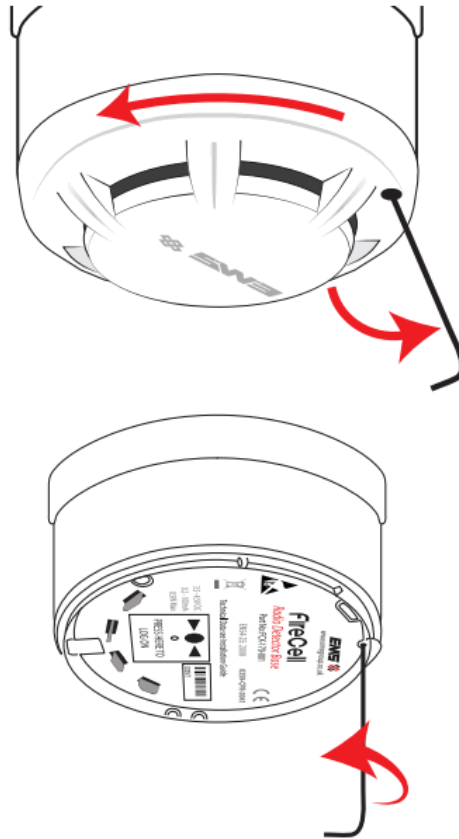

## Configuration

The device's loop address is configured within the user interface's menu structure. Refer to the programming manual for full programming details.



FireCell = MK98  
Fusion = TSD062  
WSM = TSD143

Free to download from [www.emsgroup.co.uk](http://www.emsgroup.co.uk)

## **IMPORTANT**

### **Remove dust cover before use.**

- The device should be tested upon installation and in accordance with local requirements.
- Testing should only be carried out by a fully trained competent person.
- The manufacturer recommends regular functional testing at least once per annum or in accordance with local codes of practice.
- Cleaning and repairs must be undertaken by the manufacturer's authorized representative.
- Do not open the case to clean inside the detector.

### **Specification**

Operating temperature	-10 to +55 °C
Storage temperature	5 to 30 °C
Humidity	0 to 95% non-condensing
Supply	6x AA alkaline (Panasonic LR6AD Powerline / Varta 4006 Industrial)

### **CAUTION!**

The fitting of an incorrect battery type invalidates the product certification and may result in poor performance.

IP rating	IP23
Operating frequency	868 MHz
Output transmitter power	Auto-adjusting 0 to 14 dBm (0 to 25 mW)
Dimensions (Ø x D)	113 x 40 mm (without detector) 113 x 76 mm (with smoke detector) 113 x 81 mm (with heat detector) 113 x 87 mm (with multisensor detector)
Weight	0.40 kg (with detector)
Location	Type A: For indoor use

### **Regulatory information**

Manufacturer	Carrier Manufacturing Polska Sp. Z o.o. Ul. Kolejowa 24. 39-100 Ropczyce, Poland
Year of manufacture	See device serial number label
Certification	CE <sub>10[1][2][3]</sub> CE <sub>20[4]</sub>
Certification body	0905
CPR DoP	See part listing for associated products: [1]0359-CPR-0015, [2]0359-CPR-0017, [3]0359-CPR-0041 & [4]0905-CPR-202126
Approved to	See part listing for associated products: EN54-5:2001. Incorporating Amendment No. 1. Fire detection and fire alarm systems. Part 5: Heat detectors – Point Detectors. [1] EN54-7:2001. Incorporating Amendment No. 1. Fire detection and fire alarm systems. Part 7: Smoke detectors – Point detectors using scattered light, transmitted light, or ionization. [2][4] EN54-25:2008. Incorporating corrigenda September 2010 and March 2012. Fire detection and fire alarm systems. Part 25: Components using radio links. [3]
European Union directives	EMS declares that this device is in compliance with Directive 2014/53/EU. The full text of the EU declaration of conformity is available at the following internet address: <a href="http://www.emsgroup.co.uk">www.emsgroup.co.uk</a>
	2012/19/EU (WEEE directive): Products marked with this symbol cannot be disposed of as unsorted municipal waste in the European Union. For proper recycling, return this product to your local supplier upon the purchase of equivalent new equipment, or dispose of it at designated collection points. For more information see <a href="http://www.recyclethis.info">www.recyclethis.info</a> Dispose of your batteries in an environmentally friendly manner according to your local regulations.

©2021 EMS Ltd. All rights reserved

## Documents / Resources

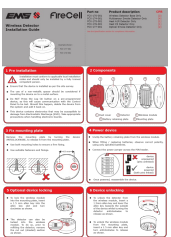
	<a href="#">Firecell FCX-170-001 Wireless Detector</a> [pdf] Installation Guide FCX-170-001, FCX-174-001, FCX-175-001, FCX-176-001, FCX-170-001 Wireless Detector, FCX-170-001, Wireless Detector
---	--

## References

- [Leading brand of Wireless Fire alarms systems - EMS Firecell](#)

