



finder 22.32 Modular Contactor 25A Instructions

[Home](#) » [finder](#) » [finder 22.32 Modular Contactor 25A Instructions](#) 

Contents

- [1 finder 22.32 Modular Contactor 25A](#)
- [2 MODULAR CONTACTORS 25 A](#)
- [3 CONNECTION DIAGRAM](#)
- [4 OUTLINE DRAWINGS](#)
- [5 FRONT VIEW](#)
- [6 ACCESSORIES](#)
- [7 Documents / Resources](#)
 - [7.1 References](#)
- [8 Related Posts](#)



finder 22.32 Modular Contactor 25A



MODULAR CONTACTORS 25 A

Contact gap ≥ 3 mm for NO contacts only; NC contacts ≥ 1.5 mm. Compliant with EN 61095: 2009. AC/DC silent coil (with varistor protection)

CONNECTION DIAGRAM

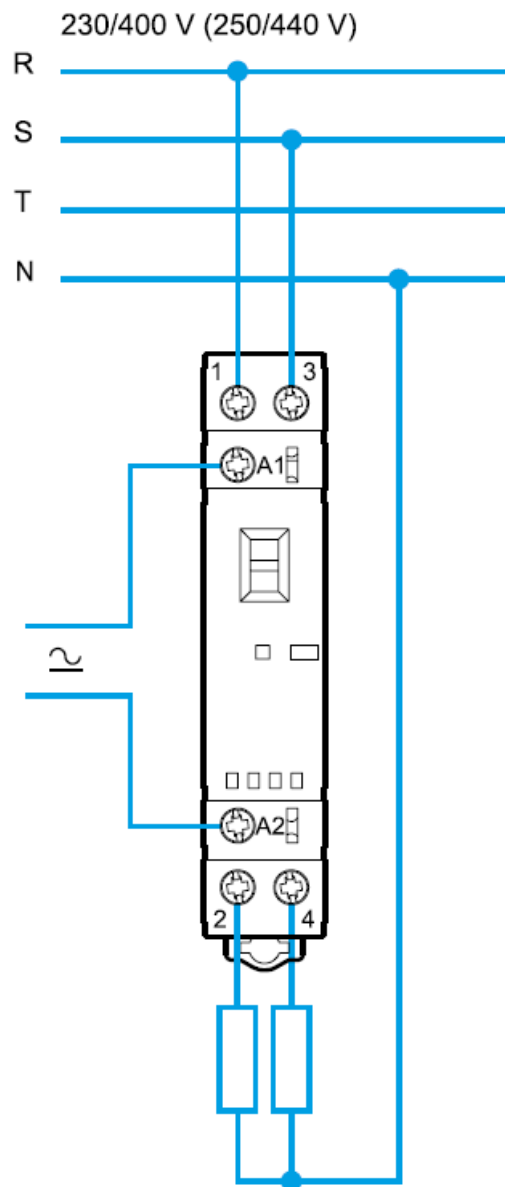

OUTLINE DRAWINGS

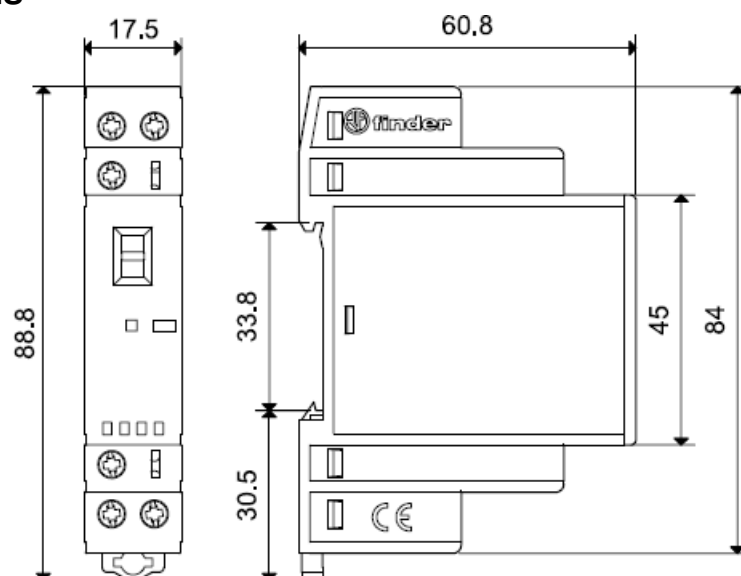

FRONT VIEW

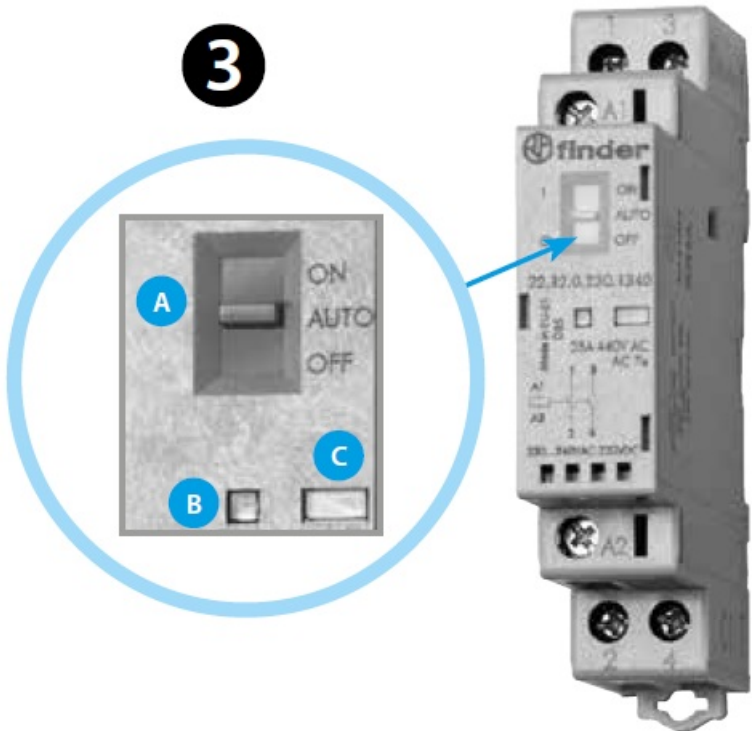

022.33	2 NO (DPST- NO)
022.35	1 NO (SPST- NO) + 1 NC (SPST- NC)
	lth 6 A AC15 700 VA (230 V AC)



A = Selector (22.32.0.xxx.xx40)

The three-position manual selector has the following functions:

- ON position
The contacts are latched in the operating state (NO contacts -closed and NC contacts – open), the mechanical indicator is visible in its window, the LED is not illuminated.
- AUTO position
The state of contacts, mechanical indicator and LED follow the coil supply voltage.
- OFF position
Even if terminals A1 – A2 are supplied with rated voltage, the coil is not energized, and so the contacts remain in the non-operated state, the mechanical indicator is not visible and the LED is not illuminated.
 - B = LED
 - C = Mechanical indicator

ACCESSORIES

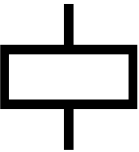
22.32.0.xxx.xxx0

	<p>U_N (12 – 24 – 48 – 60 – 120 – 230)V AC (50/60 Hz) / DC $U_{min} - U_{max}$ (0.8-1.1)U_N</p> <p>P 2 VA / 2.2 W</p>	
	<p>22.32...x3x0</p>	<p>22.32...x5x0 22.32...x4x0</p>
	<p>25 A 440 V AC (EN 61095)</p>	
	<p>AC1/ AC-7a (250 V)</p>	<p>6250 VA</p>
	<p>AC3/ AC-7b</p>	<p>10 A</p>
	<p>AC5a (250 V)</p>	<p>15 A</p>
	<p>AC15 (230 V AC)</p>	<p>1800 VA</p>

	M (230 V AC)	1 kW
	DC1 (30 /110/ 220)V	(25/5 /1)A
	AC-7c	– (10 A – 22.32...4xx0)
		800 W (2000 W – 22.32...4xx0)
		300 W (800 W – 22.32...4xx0)
	CFL–LED	100 W (200 W – 22.32...4xx0)
	(-20...+50)°C	
IP20		

- Auxiliary contact module available, “Quick assembly” with the main contactor 022.33/022.35
- It is not possible to assemble the auxiliary module on 22.32.0.xxx.x4x0 (2 NC versions)

OTHER DATA

It is suggested an air gap of 9 mm between adjacent relays for installations and working conditions close to the limit (that is, ambient temperature 40°C, coil operated for a prolonged period of time, all contacts loaded with

current > 20 A).

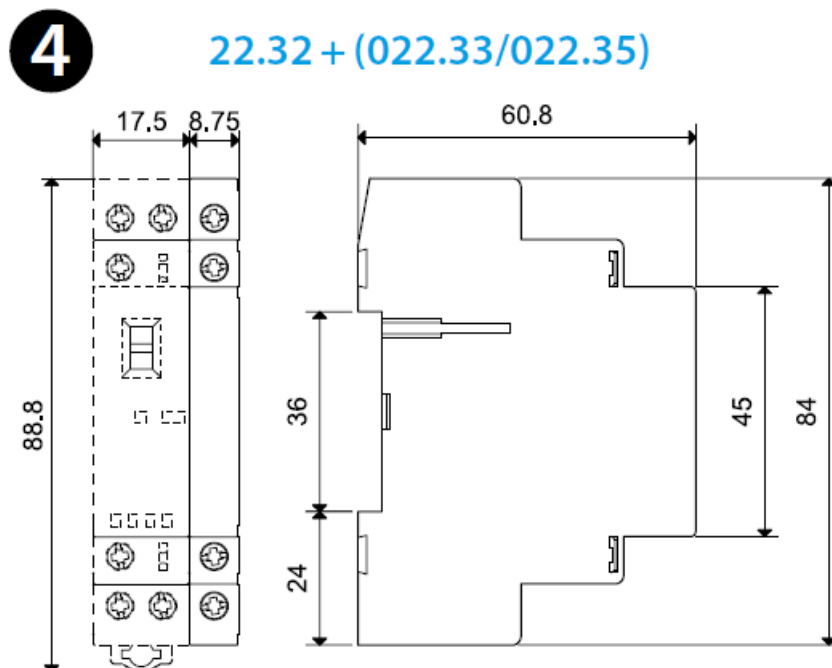

LIST

- Open Type Device – Pollution degree 2 Installation Environment
- Maximum Surrounding Air Temperature 50°C
- The minimum distance among modular contactors 9 mm
 - Field Wiring Terminals:
 - Use 60/75°C copper conductor only and wire ranges
 - No. 10-12-18-24 AWG, Solid only
 - Terminal tightening torque 7.0 lb.in. (0.8 Nm)
- Suitable for use on a circuit capable of delivering not more than 5000 ARMS Symmetrical, 240 V ac, when protected by Listed Cartridge Fuses, rated K5 Class (No Current Limiting, Non-Time Delay, max 600 Vac, 30 A, 50 kA A.I.C.) or RK5
 - Class (Current Limiting, Time Delay, max 600 Vac, 15 A, 50 kA A.I.C.) or equivalent
- For use in a circuit protected by Type1 or Type2 Surge Protective Devices with “Max Voltage Protection” rating of 3.7 kVpk and
 - “Minimum Nominal Discharge Current” of 5 kA (at 6 kV)

Documents / Resources

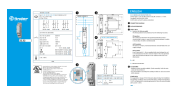

[finder 22.32 Modular Contactor 25A](#) [pdf] Instructions
22.32, Modular Contactor 25A

References