



Fiilex V3 COLOR Viewing Lamp User Guide

[Home](#) » [Fiilex](#) » Fiilex V3 COLOR Viewing Lamp User Guide 

Contents

- [1 Fiilex V3 COLOR Viewing Lamp](#)
- [2 Specifications](#)
- [3 Parts Diagram](#)
- [4 FAQs](#)
- [5 Documents / Resources](#)
 - [5.1 References](#)

Fiilex V3 COLOR Viewing Lamp

Fiilex



Specifications

- **Model:** V3
- **Power Input:** DC 14-30V
- **Display:** OLED
- **Ports:** DMX Output (TRRS), DC Input Port, USB Type-C Port

Product Usage Instructions

Parts Diagram

1. Vent Holes
2. Foam Rubber Bumper
3. T Handle
4. Accessory Locking Magnet
5. Accessory Locking Pin
6. Ball Joint Handle
7. INT Knob
8. USB Type-C Port (For updating firmware/RPU)
9. On / Off Button
10. OLED Display

- 11. Menu Knob
- 12. DMX Output (TRRS)
- 13. DC Input Port (14-30V)

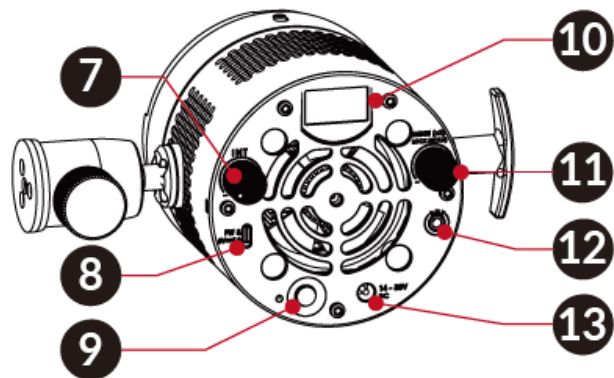
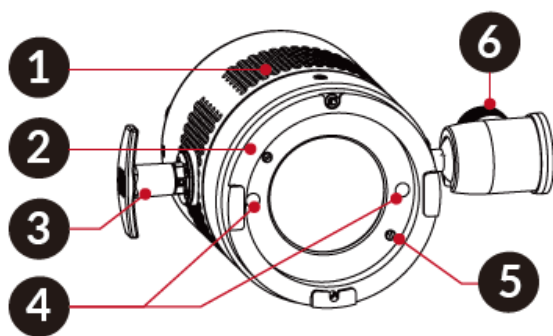

- 14. Power Cable
- 15. Clamp
- 16. Rotation Locking Knob
- 17. Adjustable Arm
- 18. DC Power Plug

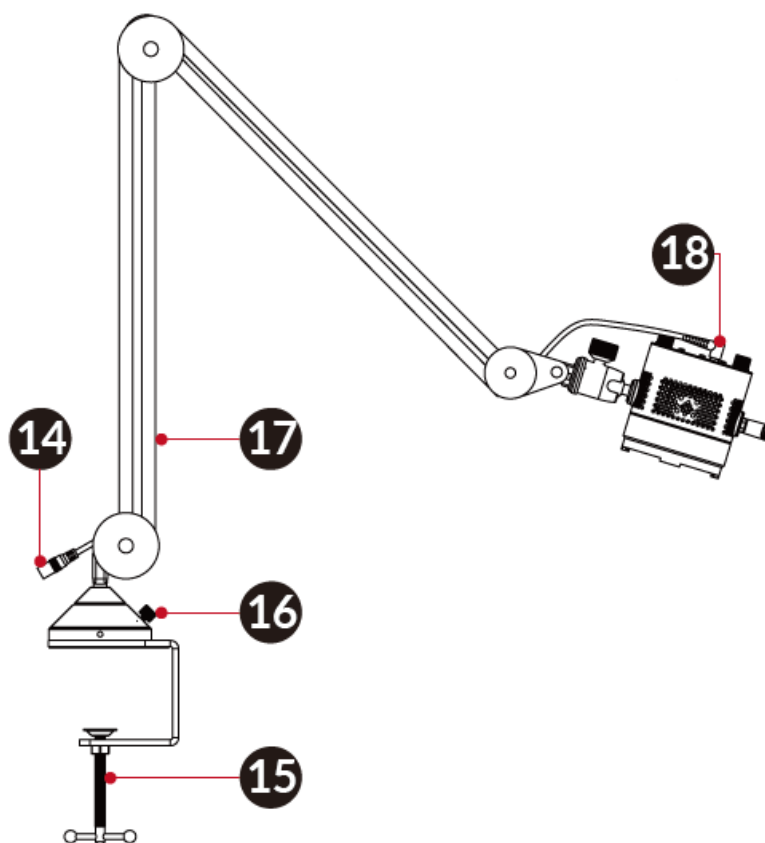

Mounting the Fixture

1. Twist the clamp handle clockwise to loosen the clamp.

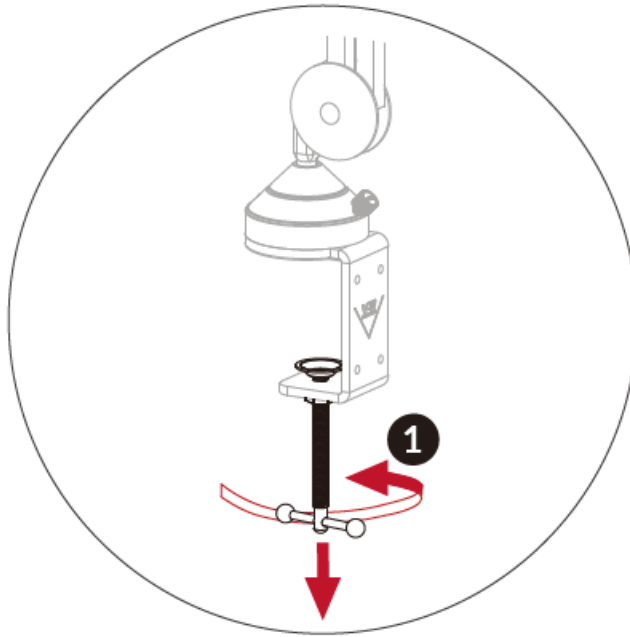

2. Insert the clamp at the side of the desired surface. Twist the clamp handle counter-clockwise to mount the fixture to the side of the table.

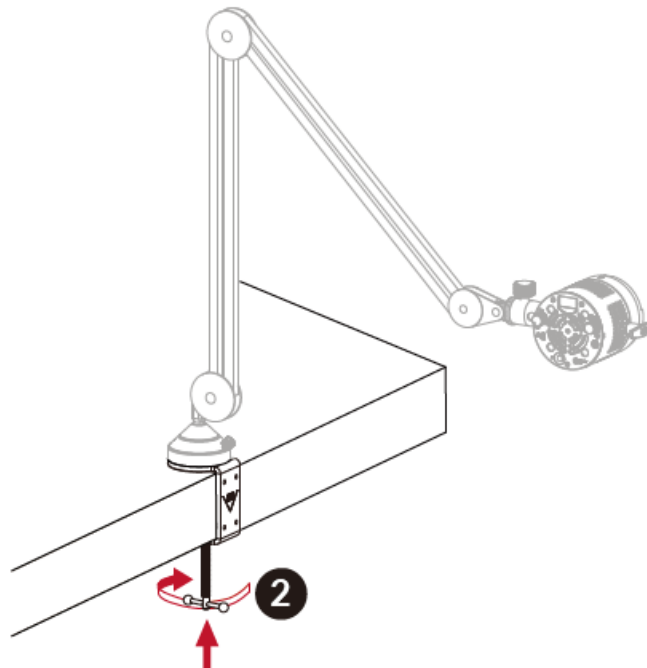

3. Rotate the adjustable arm to the desired location and twist the rotation locking knob to secure the position of the lamp.

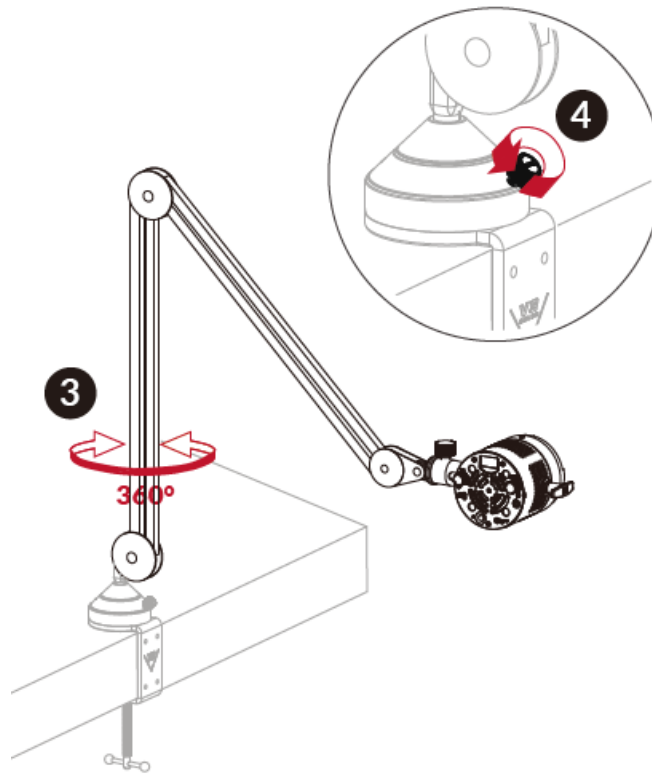

4. Twist the ball joint handle (5) counter-clockwise to release V3 head. After adjusting the V3 head to the desired angle, reverse the process to secure.

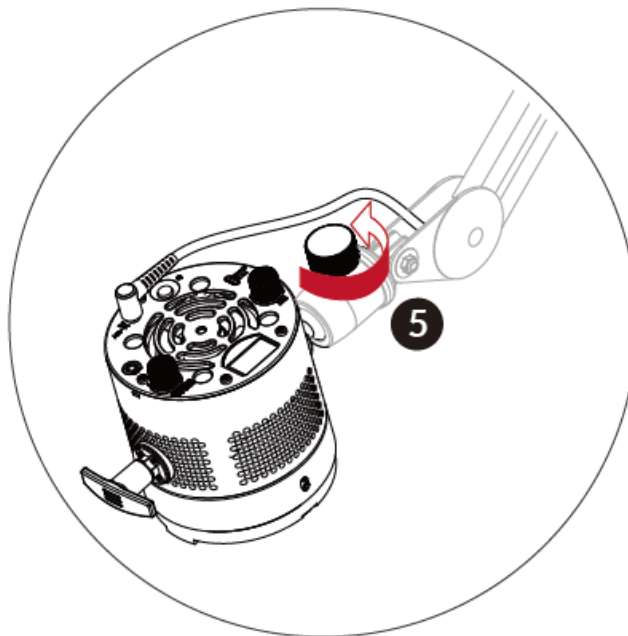

Accessories



RPU
FLXRPV



P3 Dome Diffuser 1-Stop
FLXP3CLR-DOME1S



P3 Fresnel Lens 20deg
FLXP3LR-FRNL20

Adjusting the Fixture

1. Twist the ball joint handle counter-clockwise to release V3 head.
2. Adjust the V3 head to the desired angle.
3. Reverse the process to secure the V3 head in place.

Control Panel Guide

- Control panel overview

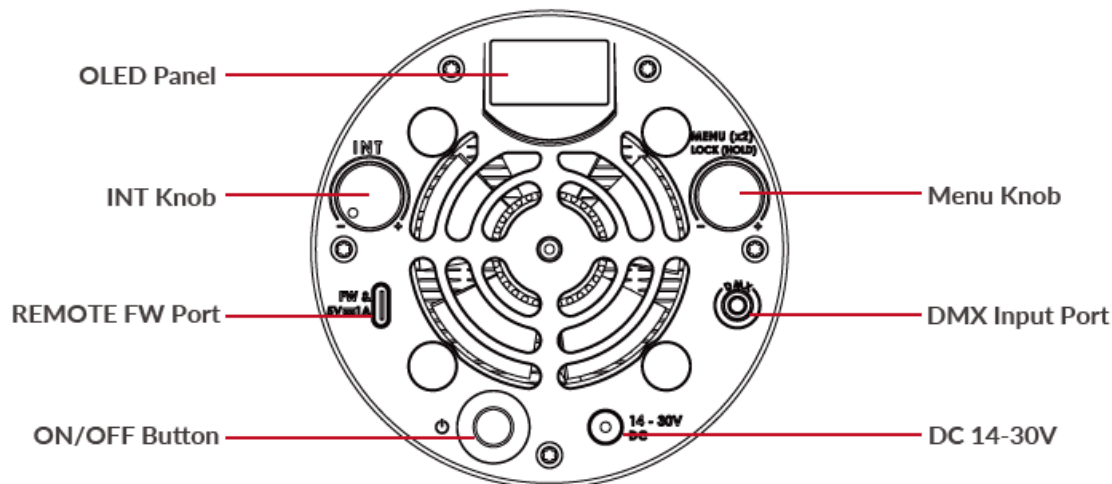





• Intensity Controls

- Use the INT Knob to modify brightness in any mode

• Menu Knob Controls

- Use the menu knob to adjust all other parameters, navigate the menu, and change modes.

			
INT	Menu	Menu	Menu
Twist	1x Press	Twist	2x Press
Adjust fixture output	Enter edit mode/ Press again to Confirm	Select/ Adjust	Enter Mode Selection and Advanced Setting

Select / Change Mode

1. Once the fixture is powered on, twist menu knob until menu appears, tap once.



2. Twisting the menu knob will move through other settings that can be changed.
3. Press the menu button once while the Mode is on the screen.

- Two arrows will appear in the center of the screen at the top and bottom.



4. Twist the menu knob until the appropriate mode is selected, and press the menu knob to enter.
- A Full list of available modes can be found on the webpage.



CCT Mode Operation

1. The “INT” knob controls the overall fixture output.



2. To make adjustments to the CCT, twist the menu knob until “CCT” is highlighted.

- Press the menu knob once. Two arrows will appear in the above and below the current CCT value.
- Twist the menu knob to make adjustments and press the menu knob to save.



3. To adjust the Green / Magenta shift, twist the menu knob until “GN” is highlighted.

- Press the menu knob once. Two arrows will appear above and below the current GN value.
- Twist the menu knob to make adjustments and press the menu knob to save.



HSI Mode Operation

1. The “INT” knob controls the overall fixture output.



2. To make adjustments to the HUE, twist the menu knob until “HUE” is highlighted.

- Press the menu knob once. Two arrows will appear above and below the current HUE value.
- Twist the menu knob to make adjustments and press the menu knob to save.



3. To adjust the Saturation shift, twist the menu knob until “SAT” is highlighted.

- Press the menu knob once. Two arrows will appear above and below the current SAT value.
- Twist the menu knob to make adjustments and press the menu knob to save.



RGBW Mode Operation

1. The “INT” knob controls the overall fixture output.



2. To make adjustments to the Red shift, twist the menu knob until “R” is highlighted.



3. Press the menu knob once. Two arrows will appear above and below the current red value. Twist the menu knob to make adjustments and press the menu knob to save.



4. Repeat process in order to change the rest of the settings.

- For advanced mode control and more options, visit the main Fiilex webpage.

Safety Instructions

- DO NOT obstruct the fixture’s air vents.
- DO NOT install the light fixture in damp locations.
- DO NOT disassemble the light fixture. This will void the warranty.
- DO NOT look into the light source. Be cautious of the high-intensity beam.
- Use a safety cable (not included) when rigging the light fixture overhead.
- Shields and lenses shall be changed if they have become visibly damaged.
- If damaged, the luminaire must be repaired or replaced before further use.
- Only use Fiilex-approved power supply and accessories. Failure to do so may damage the fixture and will void the fixture’s warranty.

About Us

- 1689 Regatta Blvd. Richmond, CA 94804
- [510-620-5155](tel:510-620-5155)
- fiilex@fiilex.com
- www.fiilex.com

FAQs

Q: How do I modify brightness using the INT Knob?

Use the INT Knob to adjust the brightness in any mode.

Q: How do I navigate the menu and change modes using the Menu Knob?

Twist the Menu Knob to navigate through settings and change modes. Press once to enter edit mode, again to confirm. Press twice for mode selection and advanced settings.

Q: How do I adjust CCT and HSI modes?

CCT Mode Operation

1. Use the INT knob to control overall fixture output.
2. To adjust CCT, twist the menu knob until CCT is highlighted, make adjustments, and press to save.
3. To adjust Green/Magenta shift, twist the menu knob until GN is highlighted, make adjustments, and press to save.

HSI Mode Operation

1. Use the INT knob to control overall fixture output.
2. To adjust HUE, twist the menu knob until HUE is highlighted, make adjustments, and press to save.

Documents / Resources

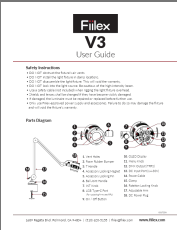
	<p>Fiilex V3 COLOR Viewing Lamp [pdf] User Guide 031725A, V3 COLOR Viewing Lamp, V3, COLOR Viewing Lamp, Viewing Lamp, Lamp</p>
---	---

References

- [User Manual](#)

[Manuals+.](#) [Privacy Policy](#)

This website is an independent publication and is neither affiliated with nor endorsed by any of the trademark owners. The "Bluetooth®" word mark and logos are registered trademarks owned by Bluetooth SIG, Inc. The "Wi-Fi®" word mark and logos are registered trademarks owned by the Wi-Fi Alliance. Any use of these marks on this website does not imply any affiliation with or endorsement.