



# Fieldpiece Instruments MR45 Digital Recovery Machine Instruction Manual

[Home](#) » [Fieldpiece Instruments](#) » Fieldpiece Instruments MR45 Digital Recovery Machine Instruction Manual 

## Contents

- 1 Fieldpiece Instruments MR45 Digital Recovery Machine
- 2 Features
- 3 Specifications
- 4 Product Usage Instructions
- 5 Safety Information
- 6 Features
- 7 Specifications
- 8 Certifications
- 9 Tech Tips
- 10 Port Routing Control
- 11 Functions
- 12 Troubleshooting
- 13 Maintenance
- 14 Documents / Resources
  - 14.1 References



**Fieldpiece Instruments MR45 Digital Recovery Machine**



## 45 Digital Recovery Machine Product Information

**Product Name:** Refrigerant Recovery Machine

**Model:** MR45 (for models with Zero Stop)

### Description

The MR45 is the first recovery machine with a smart variable speed DC motor that accelerates during vapor recovery. It has an oversized compressor that allows you to pump refrigerant more easily and quietly than ever before. Connect your hoses without lifting the pump off the ground. View status messages and pressures directly on the large backlit display. Its lightweight size allows you to easily transport the machine to and from the job site. Turn the single rubberized control valve to route refrigerant through MR45, and use the self-purge function to pump the last traces of refrigerant into the recovery cylinder instead of leaving it in the machine or releasing it into the environment. The MR45 is compatible with Class A2L refrigerants for a wide range of jobs. To avoid contaminating recovered refrigerant, MR45 automatically stops at 0 psig/bar by default.

### Features

- Smart variable speed DC motor for accelerated vapor recovery
- Oversize compressor for easy and quiet refrigerant pumping
- Large backlit display for viewing status messages and pressures
- Lightweight and portable design
- Single rubberized control valve for easy refrigerant routing
- Self-purge function for pumping residual refrigerant into the recovery cylinder
- Compatible with Class A2L refrigerants
- Automatic stop at 0 psig/bar to prevent contamination of recovered refrigerant

### What's Included

- MR45 Refrigerant Recovery Machine

- 10 Extra Mesh Screens for Input Port
- 3 Extra O-rings for Input Port
- Operator's Manual
- 1 Year Warranty

## **Specifications**

- Display: 2 x 10000 count LCD with status messages
- Backlight: Blue color
- Measurement rate: 3.3 times per second, nominal
- Auto-stop Levels: 0 psig (default), -10 inHg, -20 inHg
- Input Port Pressure Sensor Range: -30 inHg to 600 psig (-76 cmHg to 4100 kPa)
- Output Port Pressure Sensor Range: -30 inHg to 600 psig (-76 cmHg to 4100 kPa)
- High-Pressure Cutoff: 558 psig (3850 kPa), nominal
- Resolution and Units: 1 psig (1 inHg), 0.05 bar (2 mmHg), 0.01 Mpa (2 mmHg), 5 kPa (2 mmHg)
- Pressure Sensor Accuracy:  $\pm 1\%$  of reading  $\pm 1$  digit, nominal

## **Certifications**

WEEE (Do not dispose through typical waste streams.)

IN ACCORDANCE WITH SECTION 608 OF THE CLEAN AIR ACT: THIS EQUIPMENT HAS BEEN CERTIFIED BY UNDERWRITERS LABORATORIES INC. TO MEET EPA'S MINIMUM REQUIREMENTS FOR RECOVERY EQUIPMENT INTENDED FOR USE WITH CATEGORY III, IV, AND V REFRIGERANTS OUTLINED IN AHRI 740, TABLE 4.

## **Product Usage Instructions**

### **Safety Information**

- Read, understand, and follow the entire manual, with special attention given to Warning and Caution statements before operating this machine.
- This machine is intended for use only by qualified and certified technicians in the safe use, handling, and transporting of refrigerants.
- Refer to flammable refrigerant safety guides, regional codes, and legislation for more information.

### **Warnings**

- Failure to heed the hazards and actions mentioned can result in serious injury or death.
- Additional safety instructions are provided for recovering A2L refrigerants.

### **Caution**

- Failure to heed the hazards and actions mentioned can cause equipment damage.

## **Product Setup**

- Ensure the machine is placed on a stable and level surface.
- Connect the necessary hoses securely to the input and output ports of the machine.

### **Product Operational Controls**

- Use the single rubberized control valve to route refrigerant through the MR45.
- View status messages and pressures directly on the large backlit display.

### **Product Functions**

- Perform a self-test to ensure the proper functioning of the machine.
- Utilize the self-purge function to pump residual refrigerant into the recovery cylinder.
- Purge a recovery cylinder to remove any remaining traces of refrigerant.
- Perform direct liquid/vapor recovery or push/pull recovery as required.

### **Troubleshooting**

- Refer to the troubleshooting section in the manual for guidance on resolving issues.
- Pay attention to status messages and other symptoms to identify potential problems.

### **Maintenance**

- Follow the general maintenance guidelines provided in the manual.
- Clean the mesh screen filter regularly to ensure optimal performance.

### **Limited Warranty**

Refer to the warranty section in the manual for information on obtaining service and warranty coverage.

### **Safety Information**

Read, understand, and follow this entire manual, with special attention given to Warning and Caution statements before operating this machine.

For use only by qualified and certified technicians in the safe use, handling, and transporting of refrigerants. This machine is designed to recover most CFC, HFC, HCFC, and some HFO refrigerants that have an A1 or A2L flammability rating only. Please refer to flammable refrigerant safety guides, regional codes and legislation for more information.

### **WARNING**

**FAILURE TO HEED THESE HAZARDS AND ACTIONS CAN RESULT IN SERIOUS INJURY OR DEATH**

- Do not operate in a wet location as an electrical shock risk.
- The machine is only rated for use on 110VAC mains power
- Always use a grounded outlet
- Always wear Proper Protective Equipment (PPE), which includes gloves and safety glasses and earplugs

- Know proper safety and handling requirements of the refrigerant in the Safety Data Sheet (SDS)
- Avoid breathing refrigerant and oil vapors
- Handle hoses and equipment carefully as refrigerant is under high pressure and can cause frostbite
- Do not operate in or near explosive atmospheres
- Do not use with hydrocarbons (HC)
- Perform leak detection in accordance with recommended practice to verify working environment is free from leaking refrigerant as it can be toxic and or flammable
- Only work in well-ventilated areas (at least 4 air exchanges per hour)
- Ensure power and extension cords are in good working condition to prevent shock and spark hazards
- Prevent motor overheating by using 14AWG minimum and 50AWG maximum cord size
- Make power connection of the recovery machine and other equipment outside of the Temporary Flammable Zone
- Bond the recovery machine outlet port to the recovery tank's unpainted fitting with a grounding strap to dissipate static electricity build up during recovery process
- Ensure area around the machine is free of debris that could enter the machine and cause accidental sparking
- Always remain in attendance and observant when the machine is running
- Do not mix flammable refrigerants with air
- Use an evacuated DOT recovery tank
- If the system has a suspected leak, stop recovery at 0 psig/bar to prevent air from entering the recovery tank
- After recovery, purge the system with 100% nitrogen before opening the system for repair

## **CAUTION**

### **FAILURE TO HEED THESE HAZARDS AND ACTIONS CAN CAUSE EQUIPMENT DAMAGE**

- Ensure that the recovery machine, hoses, tank, and other equipment are in good working condition
- If the power cable is damaged, it must be replaced by the manufacturer, its service agent, or similarly qualified persons in order to avoid a hazard
- Avoid overfilling recovery tanks by following the refrigerant manufacturer's filling instructions and using a weight scale
- Avoid cross-contamination (mixing) of refrigerants
- Ensure the mesh screen filter is installed & clean (page 30)
- Use a filter drier on the input port and change it often to protect the machine from contaminated refrigerants
- Ensure the power switch is OFF before plugging into power
- Disconnect power and allow a fan to stop before opening or servicing the recovery machine
- Perform a self-test periodically (page 22)

## **Description**

The MR45 is the first recovery machine with a smart variable speed DC motor that accelerates during vapor recovery. It has an oversize compressor that allows you to pump refrigerant more easily and quietly than ever before. Connect your hoses without lifting the pump to the ground. View status messages and pressures directly on the large backlit display. Its lightweight size allows you to easily transport the machine to and from the job site. Turn the single rubberized control valve to route refrigerant through MR45, and use the self-purge function to pump the last traces of refrigerant into the recovery cylinder instead of leaving it in the machine or releasing it into the environment. Class A2L compatibility for a wide range of jobs. To avoid contaminating recovered refrigerant,

MR45 automatically stops at 0 psig/bar by default.

## Features

- Lightweight (22 lbs)
- Smooth and Fast Operation (1 HP DC Motor)
- Digital Display with Status Messages
- Reliable Rubberized Construction
- Easy-to-Access Port Design
- Hex Nut Secures Input Port During Hose Removal
- Power Cord Storage
- Ceramic Cylinders
- Class A2L Refrigerant Compatible
- Zero Stop (3 Selectable Auto-stop Levels)
- Self Purge
- Wide Operating Voltage (95 to 130 VAC)
- UL Verified to Section 608 of EPA Clean Air Act
- UL Verified to AHRI Standard 740

## What's Included

MR45 Refrigerant Recovery Machine 10 Extra Mesh Screens for Input Port 3 Extra O-rings for Input Port Operator's Manual 1 Year Warranty

## Specifications

- **Display:** 2 x 10000 count LCD with status messages
- **Backlight** Blue color
- **Measurement rate** 3.3 times per second, nominal
- **Auto-stop Levels** 0 psig (default), -10 inHg, -20 inHg
- **Input Port Pressure Sensor Range** -30 inHg to 600 psig (-76 cmHg to 4100 kPa)
- **Output Port Pressure Sensor Range** -30 inHg to 600 psig (-76 cmHg to 4100 kPa)
- **High-pressure cutoff** 558 psig (3850 kPa), nominal
- **Resolution and Units** 1 psig (1 inHg), 0.05 bar (2 mmHg), 0.01 Mpa (2 cm), 5 kPa (2 mmHg)
- **Pressure Sensor Accuracy**
  - $\pm 0.5$  inHg,  $\pm 1.3$  cmHg (Vacuum)
  - $\pm (0.6\%$  of reading +2 psig),  $\pm (0.6\%$  of reading +14 kPa) Final Recovery Vacuum: 14.9 inHg, 38 cmHg
- **Compressor:** Twin-cylinder reciprocating (oil-less)
- **DC Motor:** 1 HP (variable smart speed)
- **Power Source** 120 VAC @ 60 Hz 1 phase
- **Nominal Current Draw:** 12.0 AAC
- **Valve:** Single dual-route ball valve
- **Input Port Filtration: 9 mm mesh screen, stainless** **Dimensions:** 14.8 in x 9.8 in x 13.5 in (376 mm x 250 mm x 344 mm) **Weight:** 22 lbs (10kg)
- **Operating Environment** 32°F to 104°F (0°C to 40°C)
- **Storage Environment** -4°F to 140°F (-20°C to 60°C)

- **Common Representative Refrigerant** R12, R22, R32\*, R134A,

R143A\*, R401A, R401B, R401C, R402A, R402B, R404A, R407A, R407B, R407C, R407D, R408A, R409A, R410A, R448A, R452A, R454B\*, R500, R502, R507, R509, R1234YF\*, R1234ZE\*

\* Class A2L refrigerants

**US Patent:** [www.fieldpiece.com/patents](http://www.fieldpiece.com/patents)

## Certifications

WEEE (Do not dispose through typical waste streams.) IN ACCORDANCE WITH SECTION 608 OF THE CLEAN AIR ACT: THIS EQUIPMENT HAS BEEN CERTIFIED BY UNDERWRITERS LABORATORIES INC. TO MEET EPA'S MINIMUM REQUIREMENTS FOR RECOVERY EQUIPMENT INTENDED FOR USE WITH CATEGORY III, IV, AND V REFRIGERANTS OUTLINED IN AHRI 740, TABLE 4. <SA44565>

## UL Verified Performance Data

## Tech Tips

### General

1. Store in the self-purge or recover position. Do not store in the CLOSED position as trapped air and refrigerant can expand and damage components.
2. For extended storage, purge with nitrogen, set to RECOVER, and screw non-sealing caps onto the ports.
3. Recovery machines are not vacuum pumps and should not be used for deep evacuations.
4. Do not run the machine without the mesh screen filter (page 30). Doing so will void the warranty and damage the machine.
5. Understand the refrigerant safety data sheet (SDS).

### Setup

1. Know the refrigerant of the system and make sure your recovery cylinder matches that type.
2. Hoses: Short as possible (3/8" hose with 1/4" fitting). Core depressors removed. Ball valve shutoffs instead of low loss fittings. Replace if worn.
3. Manifold gauges are not necessary for recovery but can make it more convenient and increase speed by having 2 system hook ups.
4. Use a Schrader valve core removal tool to temporarily remove valve cores from service valves.
5. Use the push-pull method if recovering over 30 lbs (14kg).
6. Evacuate your empty recovery cylinders to -29.6 inHg (-75 cmHg) before use.
7. Know how much refrigerant you expect to recover before starting.
8. Ensure there's enough room in the recovery cylinder to not exceed 80% filled during the job, or monitor and have a second cylinder ready.
9. Always purge hoses before recovery. If cylinder is too hot, use an ice bath to reduce the temperature and pressure of the cylinder.
10. If cylinder pressure is higher than expected, you can purge non-condensable into another cylinder (page 23).

## Operational

1. Recover as much liquid as possible before recovering vapor.
2. Recovery is faster when the recovery cylinder is cooler.
3. You can use a heat gun to warm refrigerant lines to boil trapped refrigerant.
4. Recover from both suction and liquid lines at the same time for faster vapor recovery.

## Controls

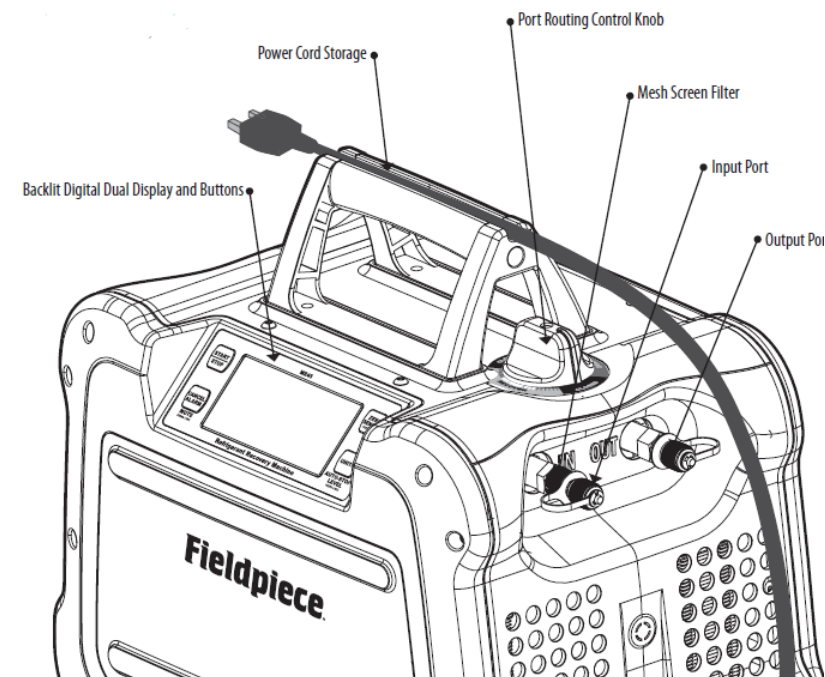

## Display and Buttons

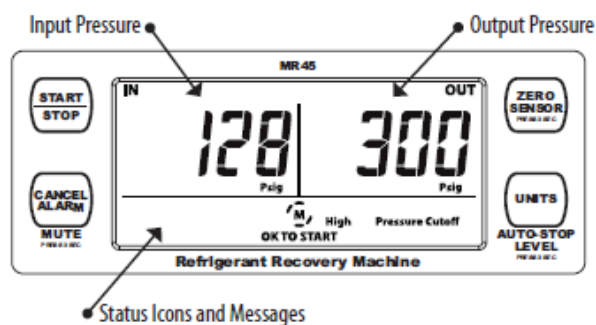

- **START/STOP**  
Start or Stop the motor.
- **ZERO SENSOR** (press 3 seconds)  
Zero pressure sensors. Ports must be open to atmosphere.
- **CANCEL ALARM**  
Cancel alarm currently sounding (temporarily mute).
- **MUTE** (press 3 seconds)



Toggle mute for all sounds (setting is saved).

- **UNITS**

Select pressure/vacuum units.

- **AUTO-STOP LEVEL** (press 3 sec. to enter setup)

Once entered, press to change the pressure/vacuum level that triggers the first automatic stop: 0 psig (default), -10 inHg, -20 inHg. Wait 5 seconds to exit setup, automatically saving desired setting

## **Status Icons and Messages**

The icon rotates when the motor is running.

The icon is shown when MR45 is set to MUTE.

## **OK TO START**

Motor stopped. Temperatures, voltages, and pressures are currently safe to start the motor again.

- **COMPLETE / Low-Pressure Cutoff**

Motor stopped. Input pressure/vacuum reached one of three auto-stop levels for 10 seconds: 0 psig, -10 inHg, or -20 inHg (0 bar, -25 cmHg, or -50 cmHg)

- **Input Closed**

Cannot zero pressures. Open input port.

- **Output Closed**

Cannot zero pressures. Open output port.

- **High Voltage Warning**

Motor stopped. Voltage was above 130 VAC.

- **Low Voltage Warning**

Motor stopped. Voltage was below 95 VAC.

- **High-Pressure Cutoff**

Motor stopped. Output (cylinder) approached dangerous pressure.

- **Motor Fault 1**

Motor stopped. Motor temp. measured above the operating range.

- **Motor Fault 2** ("throttle" shows on display)

Motor stopped. Motor current (amps) rose above the operating range. Throttle RECOVERY to reduce cylinder pressure (page 19).

- **Motor Fault 3**

The motor stopped for an unknown reason.

## **Port Routing Control**

### **CLOSED**

- Input and Output closed.
- Set to either closed position to close off both ports during setup.

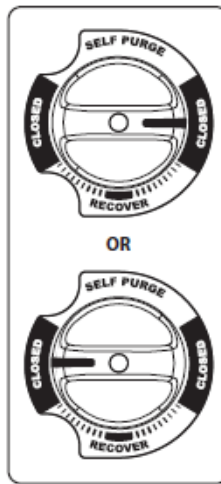

## SELF PURGE

- Input closed, Output open.
- After the recovery is complete and the motor has stopped, set it to CLOSED before you START the purge.
- Press START and slowly rotate to SELF PURGE, closing the IN port and purging MR45.



## RECOVER

- Input and Output are fully open.
- Set to this fully open position for most of the recovery process.



## RECOVER (throttled)

- Input and Output are partially open.
- Rotate away from RECOVER in either direction to reduce liquid slugging if knocking occurs. This slows the flow of refrigerant so the machine operates more smoothly.
- Only throttle as much as needed for smooth operation.

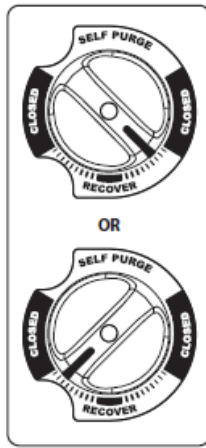

## MR45 Refrigerant Flow

Refrigerant liquid and vapor are pulled through the machine by the pressure difference created by the compressor. For maximum performance, increase the IN pressure and reduce the OUT pressure. See Tech Tips (page 12).

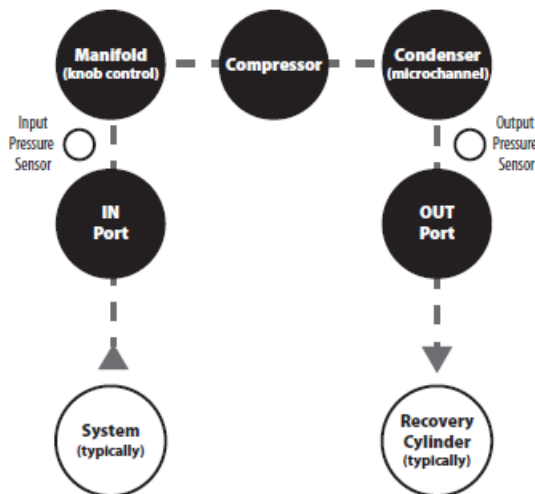

## Dynamic Pressure Measurement

MR45 pressure readings are designed only for monitoring pressures. Do not use MR45 for diagnostic pressure measurements. If a system's pressure is stable, MR45 pressure readings will be close to your other pressure gauges. If a system's pressure is changing, pressure measurements at different locations within that system will be different. For every 3 feet of 1/4" hose, the pressure may have a difference of approximately  $\pm 20$  psig ( $\pm 150$  kPa).

## Functions

### Self Test

Perform this test to ensure the high-pressure cutoff and pump are operational.

1. Set the knob to RECOVERY.
2. Open IN port to air.
3. Connect a ball valve to the OUT port. (Included caps are not sealed.)
4. Close the ball valve.
5. Press START to create pressure at the OUT port.
6. Press START a second time to continue if MR45 stops automatically after 10 seconds at 0 psig (0 kPa), the

default auto-stop level.

7. MR45 is working well if High Pressure Cutoff occurs around 550 psig (3800 kPa) within 45 seconds. Cutoff time can increase if a hose is placed in front of your ball valve.

### **Self Purge**

Use the SELF-PURGE feature at the end of every recovery to pump the last bit of refrigerant out of MR45. Benefits include increased machine life, reduced environmental impact, and most importantly, prevention of refrigerant mixing.

1. After recovery is complete, set the knob to CLOSED.
2. Press START and slowly rotate the knob to SELF-PURGE to empty MR45 into the recovery cylinder without any sudden changes in pressure. This closes the IN port and routes the MR45 condenser to the intake of the MR45 compressor.
3. Once the machine reaches an auto-stop level (page 16) for 10 seconds, the motor stops automatically.

### **Purging a Recovery Cylinder**

When the cylinder pressure is higher than expected you may have non-condensable at the top of the cylinder. Use a second deeply evacuated cylinder to pull out the non-condensables.

1. Leave pressurized cylinder undisturbed overnight.
2. Use a vacuum pump to evacuate another cylinder.
3. Use your manifold gauges to connect the closed vapor ports of the two cylinders.
4. Measure the vapor temperature of the pressurized refrigerant cylinder.
5. Use a P/T chart or digital manifold to find specified pressure.
6. Open the evacuated vapor port.
7. Open (purge) the pressurized vapor port until pressure is reduced to 5 psi above specified pressure.
8. Close valves.
9. If desired, repeat after 15 minutes to allow the tank to settle again.

### **Direct Liquid/Vapor Recovery**

This is the typical recovery method. Vapor and liquid lines are routed through your manifold, into MR45, and out to the recovery cylinder.

**CAUTION** Understand all class A2L refrigerant warnings and notices if applicable (pages 4-6).

1. Close valves of recovery cylinder, MR45, and manifold.
2. Set up as shown in the diagram.
3. Open valves of hoses and removal tools.
4. Set MR45 to RECOVER.
5. Open the high side of the manifold for liquid recovery.
6. To purge air from hoses, briefly unseat the hose fitting at the cylinder until vapor is seen. Unseat the hose fitting at the low side of the manifold to purge low side hose.
7. Fully open vapor valve of recovery cylinder.
8. Press START to begin recovery.
9. Adjust the knob as needed to throttle refrigerant flow if liquid slugging (knocking) occurs.
10. When liquid recovery is complete, open the low side of the manifold for vapor recovery.

11. MR45 stops automatically at one of three auto-stop levels: 0 psig (default), -10 inHg, -20 inHg (0 bar, -25 cmHg, -50 cmHg). If needed, press START to continue recovering until the next level is reached. Press STOP to manually halt recovery at any time. (If pressure rises back above an auto-stop level it re-activates that auto-stop level).
12. Set the knob to CLOSED. Press START and slowly rotate to SELF PURGE to empty MR45 (stops automatically).
13. Close manifold and cylinder valves after self-purge is complete.
14. Remove hoses from MR45, set knob to RECOVER, and cap ports.

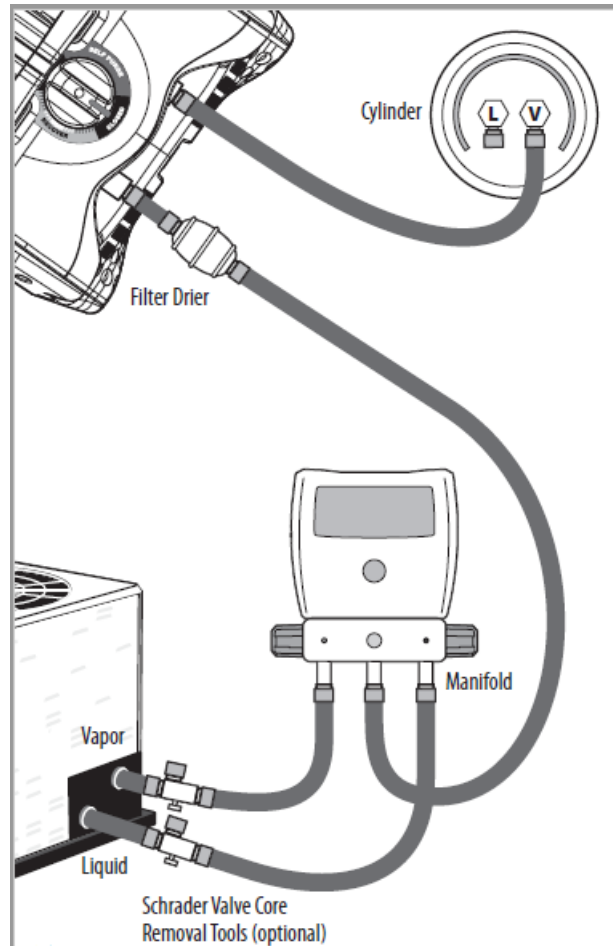

### **Push/Pull Recovery**

This method is only for larger systems with at least 30 lbs (14 kg) of liquid refrigerant. It's used to recover liquid before recovering vapor.

CAUTION: Understand all class A2L refrigerant warnings and notices if applicable (pages 4-6).

1. Close valves of the recovery cylinder and MR45.
2. Set up as shown in the diagram.
3. Open valves of liquid hose and removal tool at liquid system port.
4. To purge air from the system liquid hose, briefly unseat the hose fitting at the cylinder's liquid port until vapor is seen.
5. Fully open the liquid valve of the recovery cylinder and allow to pressurize.
6. Set MR45 to RECOVER.
7. Press START to begin recovery.
8. Fully open vapor valve of recovery cylinder.

9. To purge air from hoses briefly unseat hose fitting at the vapor system port until vapor is seen.
10. Open valves of vapor hose and removal tool at vapor system port.
11. When liquid recovery is complete, press STOP to stop the motor.
12. Close all valves and proceed to Direct Vapor Recovery (page 25).

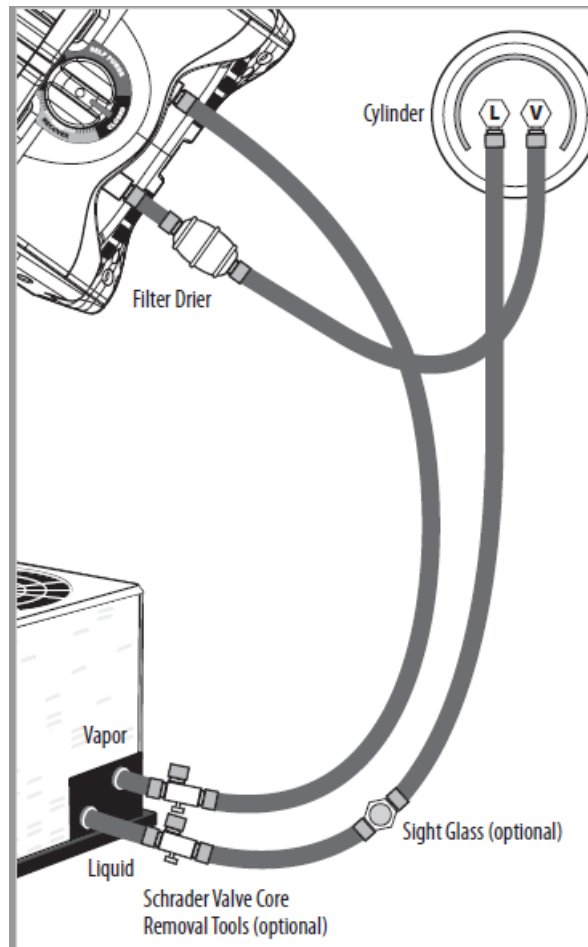

## Troubleshooting

### Status Messages

- **Input Closed**

Cannot zero the displayed pressure because the pressure sensor is not open to the atmosphere. Open input port.

- **Output Closed**

Cannot zero the displayed pressure because the pressure sensor is not open to the atmosphere. Open output port.

- **High Voltage Warning**

Voltage was above 130 VAC. Motor stopped. Ensure power network voltage is between 95 and 130 VAC @ 60 Hz.

- **Low Voltage Warning**

Voltage was below 95 VAC. Motor stopped. Check the power network to ensure the voltage is between 95 and 130 VAC @ 60 Hz.

### High-Pressure Cutoff

- Output (cylinder) reached dangerous pressure. Motor stopped. Ensure all valves after the output port are open. The cylinder may need to be cooled or replaced to reduce pressure.

- **Low-Pressure Cutoff**

Input reached one of three auto-stop levels. Motor stopped. It's normal to see this after RECOVERY or SELF-PURGE is complete. If unexpected, ensure valves before the input port are open and the knob is not set to CLOSED.

- **Motor Fault 1**

Motor temperature measured above operating range. Motor stopped. Extremely high ambient temperature, extended liquid recovery time, or high cylinder pressure can be the cause. Allow time for the motor to cool down before resuming, and throttle the RECOVERY (page 19).

- **Motor Fault 2**

Motor current (amps) rose above the operating range. Motor stopped. Extremely high ambient temperature, harsh liquid slugging, extended recovery time, or high cylinder pressure can be the cause. Throttle RECOVERY and start the motor. If fault occurs again, throttle even more and start the motor (page 19).

- **Motor Fault 3**

The motor stopped for an unknown reason. If this occurs repeatedly, there may be something wrong with MR45.

### **Other Symptoms**

MR45 never reaches -10 inHg or -20 inHg. Press START to continue recovery if the auto-stop level is reached. Check for leakage before the input port. For -10 inHg, the recovery cylinder should be below 475 psig. For -20 inHg, the recovery cylinder should be below 230 psig.

### **The input port shows frost or signs of leakage.**

Ensure the grooved input fitting is hand-tight before tightening the hex nut (page 30).

### **Recovery is slower than normal.**

There could be an input blockage. Check the mesh screen filter for blockage. Ensure the knob is set to RECOVER.

### **The display does not turn on when plugged in.**

Ensure the power cord and outlet are okay.

### **Excessive noise during liquid recovery.**

MR45 is experiencing a high load. Rotate the knob of MR45 to throttle the refrigerant flow.

## **Maintenance**

### **General**

Wipe with a damp cloth to clean the exterior. Do not use solvents. To extend the life of internal seals, occasionally pump a teaspoon of mineral oil through MR45.

### **Mesh Screen Filter**

When the mesh screen filter becomes dirty and clogged, it means it's working to keep your MR45 working well for a long time. You need to clean or replace this screen often. Visit our website for information on obtaining extra mesh screens.

1. Loosen (counterclockwise) the securing hex nut on the IN port.
2. Unscrew (counterclockwise) the grooved input fitting.

3. Clean or replace the mesh screen.
4. Hand tightens (clockwise) the grooved input fitting.
5. Tighten (clockwise) the securing hex nut with a 1/8 turn with a wrench.

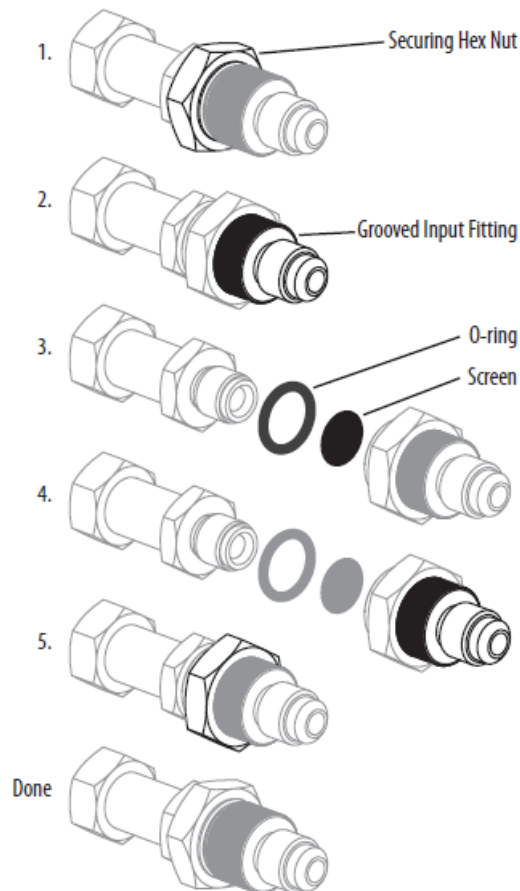

### Limited Warranty

This machine is warranted against defects in material or workmanship for one year from date of purchase from an authorized Fieldpiece dealer. Fieldpiece will replace or repair the defective unit, at its option, subject to verification of the defect. This warranty does not apply to defects resulting from abuse, neglect, accident, unauthorized repair, alteration, or unreasonable use of the machine. Any implied warranties arising from the sale of a Fieldpiece product, including but not limited to implied warranties of merchantability and fitness for a particular purpose, are limited to the above. Fieldpiece shall not be liable for loss of use of the machine or other incidental or consequential damages, expenses, or economic loss, or for any claim of such damage, expenses, or economic loss. State laws vary. The above limitations or exclusions may not apply to you.

### Obtaining Service

Visit [www.fieldpiece.com/rma](http://www.fieldpiece.com/rma) for the latest information on how to obtain service. Warranty for products purchased outside of the U.S. should be handled through local distributors. Visit our website to find your local distributor.



---

## Documents / Resources

<p><b>Fieldpiece</b> Refrigerant Recovery Machine <b>OPERATOR'S MANUAL</b> <small>Model MR45 (for models with Zero Step)</small></p> 	<p><a href="#">Fieldpiece Instruments MR45 Digital Recovery Machine</a> [pdf] Instruction Manual MR45 Digital Recovery Machine, MR45, Digital Recovery Machine, Recovery Machine, Machine</p>
--	---

## References

- [F Patents - Fieldpiece Instruments](#)
- [F Warranty & Repair - Fieldpiece Instruments](#)