



FIELD TUFF 220 LBS Utility Wagon with High Speed Hub Owner's Manual

[Home](#) » [FIELD TUFF](#) » FIELD TUFF 220 LBS Utility Wagon with High Speed Hub Owner's Manual



**2200 LBS Utility Wagon
With High Speed Hub
OWNER'S MANUAL**



**WARNING:**

Carefully read and understand all ASSEMBLY AND OPERATION INSTRUCTIONS before operating. Failure to follow the safety rules and other basic safety precautions may result in serious personal injury.

Item# ATV-2200HSH

Thank you very much for choosing this product! For future reference, please complete the owner's record below:

Model: _____ ATV-2200HSH _____ Purchase Date: _____

Save the receipt, the warranty, and these instructions. It is important that you read the entire manual to become familiar with this product before you begin using it.

This product is designed for certain applications only. The manufacturer cannot be responsible for issues arising from modification. We strongly recommend that this product not be modified and/or used for any application other than that for which it was designed. If you have any questions relative to a particular application, DO NOT use the product until you have first contacted us to determine if it can, or should, be performed on the product.

For technical questions, please call **1-218-943-6290**.

Contents [[hide](#)][1 TECHNICAL SPECIFICATION](#)[2 GENERAL SAFETY RULES](#)[3 WORK AREA](#)[4 PERSONAL SAFETY](#)[5 UTILITY WAGON USE AND CARE](#)[6 ASSEMBLY](#)[7 OPERATION](#)[8 MAINTENANCE](#)[9 DIAGRAM & PARTS LIST](#)[10 WARRANTY](#)[11 Documents / Resources](#)[12 Related Posts](#)**TECHNICAL SPECIFICATION**

Item	Description
Capacity	2200 lbs.
Tires	4-PR, 16", 35 psi MAX
Bearings	Tapered, 15 mph maximum
Construction	Steel
Dimensions	59" Long x 32.5" Wide x 30" High

GENERAL SAFETY RULES



WARNING: Read and understand all instructions. Failure to follow all instructions listed below may result in serious injury.



CAUTION: Do not allow persons to operate or assemble this utility wagon until they have read this manual and have developed a thorough understanding of how the utility wagon works.



WARNING: The warnings, cautions, and instructions discussed in this instruction manual cannot cover all possible conditions or situations that could occur. It must be understood by the operator that common sense and caution are factors that cannot be built into this product but must be supplied by the operator.

SAVE THESE INSTRUCTIONS

WORK AREA

- **Keep work area clean**, free of clutter, and well lit. Cluttered and dark work areas can cause accidents.
- **Keep children and bystanders** away while operating a utility wagon. Distractions can cause you to lose control, so visitors should remain at a safe distance from the work area.
- **Be alert of your surroundings.** Using a utility wagon in confined work areas may put you dangerously close to sharp tools and rotating parts.

PERSONAL SAFETY

- **Stay alert**, watch what you are doing, and use common sense when using a utility wagon. Do not use a utility wagon while you are tired or under the influence of drugs, alcohol, or medication. A moment of inattention while operating a utility wagon may result in serious personal injury.
- **Dress properly.** Do not wear loose clothing, dangling objects, or jewelry. Keep your hair, clothing, and gloves away from moving parts. Loose clothes, jewelry, or long hair can be caught in moving parts.
- **Use safety apparel and equipment.** Use safety goggles or safety glasses with side shields that comply with current national standards or, when needed, a face shield. Use a dust mask if working in dusty work conditions. This applies to all persons in the work area. Also use non-skid, safety shoes, hard hats, heavy-duty work gloves, dust collection systems, and hearing protection when appropriate.

UTILITY WAGON USE AND CARE

- **Do not modify the utility wagon in any way.** Unauthorized modification may impair the function and/or safety and could affect the life of the equipment. There are specific applications for which the utility wagon was designed.
- **Always check for damaged or worn-out parts before using the utility wagon.** Broken parts will affect the utility wagon operation. Replace or repair damaged or worn parts immediately.
- **Do not exceed the utility wagon load capacity.**
- **Distribute the load evenly.** Uneven loads may cause the utility wagon to tip, resulting in personal injury to the operator or others.
- **Use the utility wagon on flat and level surfaces** capable of supporting the utility wagon and its maximum load. Pulling or pushing a load on a slanted or uneven surface can result in loss of control.

- **Store idle utility wagon.** When a utility wagon is not in use, store it in a secure place out of the reach of children. Inspect it for good working condition prior to storage and before re-use.
- **Check connections** to make sure all are tight and secure. Grease any fittings at joints and wheels.

ASSEMBLY

Do not tighten bolts and nuts until assembly is complete.

Step 1: Remove Tongue Bolt (#12), Lock Nut (#4), Tongue Washers (#10), and Spacer (#11) from the center of the Front Axle (#5). Align hole in center of the Front Axle (#5) with hole in center of the Tongue (#2). Insert Spacer (#11) in between the Tongue Yoke and Axle Frame. Insert Tongue Bolt (#12) with Washer (#10) through hole. Next, slide on Washer (#10) and Lock Nut (#14). Do not tighten hardware until all assembly steps have been completed.

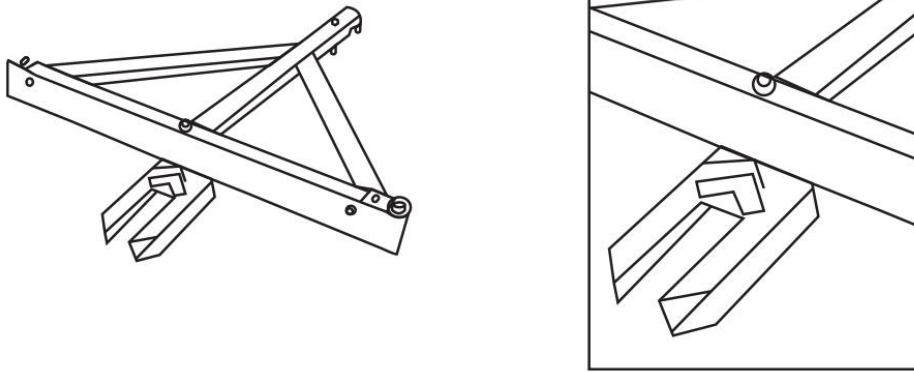

Note: Tongue Attachment is shipped secured to the tie rods and Front Axle (#5)

Step 2: Slide Wheel (#1) onto each side of the Front Axle (#5), followed by inserting the bearing(#18), the Hub Washer (#19), the Hub Castle Nut (#20), then insert the Cotter Pin (#7) into the hole of the axle, finish by adding Hub Cap (#21). Please be sure to push the cap all the way down, a rubber hammer may be used to assist. Do not tighten hardware until all assembly steps have been completed.

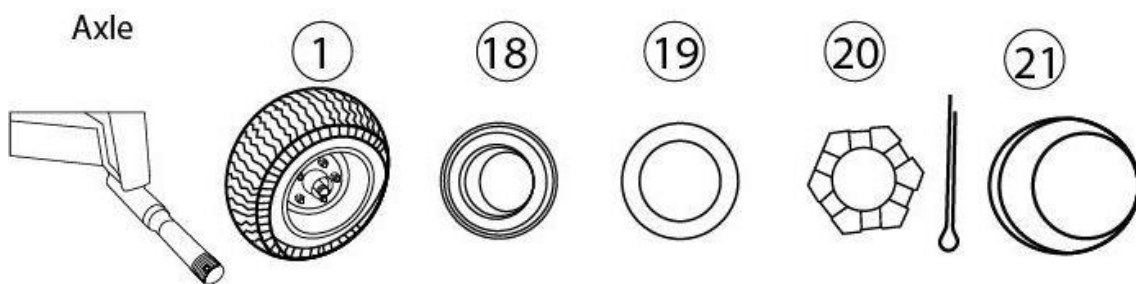

Step 3: Repeat the same step for the wheels on the Back Axle (#3). Do not tighten hardware until all assembly steps have been completed.

Step 4: Position both Front Axle Assembly and Back Axle Assembly as shown below and insert Frame Adapter (#4) into ends of both Axles. Slide in until you align holes of the Frame Adapter (#4) with the holes of the Axles. Secure in place using 12x70mm Bolt (#15), Washer (#10), and Lock Nut (#14). Install Bolts from the bottom. Do not tighten hardware until all assembly steps have been completed.

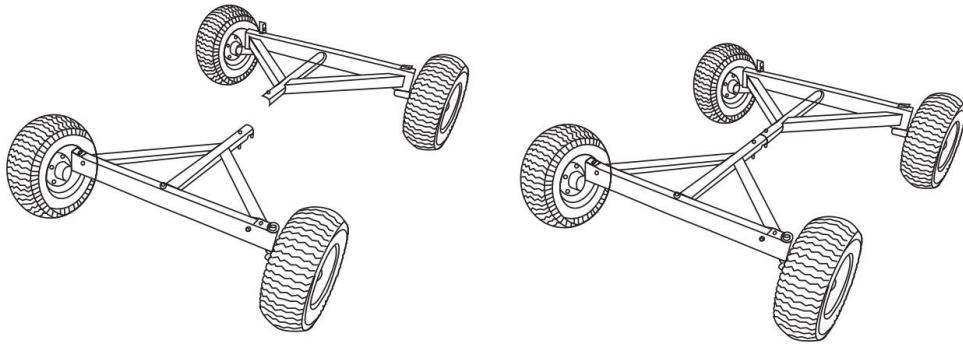

NOTE: There are 2 sets of holes on the Frame Adapter. Determine the desired length and adjust using holes accordingly.

Step 5: Align holes on the Tongue (#2) with the holes on the Tongue Attachment. Secure in place with a 12x80mm Bolt (#13), Washer (#10), and Lock Nut (#14). Do not tighten hardware until all assembly steps have been completed.

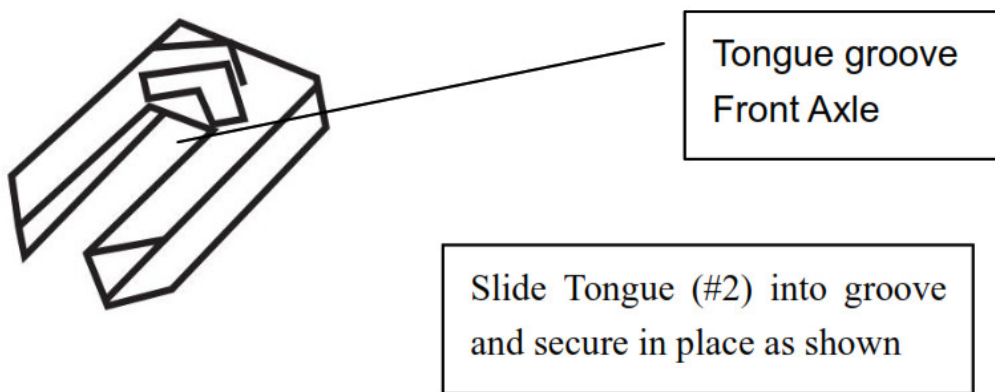

Note: Hitch pin (#9) and R-Pin (#8) are provided for pulling.

Step 6: Tighten all hardware. Check wheels for proper inflation.

OPERATION



WARNING: DO NOT load the wagon with more than 2200 lbs, with a balanced load. DO NOT allow children to use the wagon. This wagon is NOT a toy. DO NOT overinflate the tires. The maximum speed is 15 mph.

MAINTENANCE

- Maintain your utility wagon. It is recommended that the general condition of any utility wagon be examined before it is used. Keep your utility wagon in good repair by adopting a program of conscientious repair and maintenance. If any abnormal vibrations or noise occurs, have the problem corrected before further use. Have necessary repairs made by qualified service personnel.

DIAGRAM & PARTS LIST

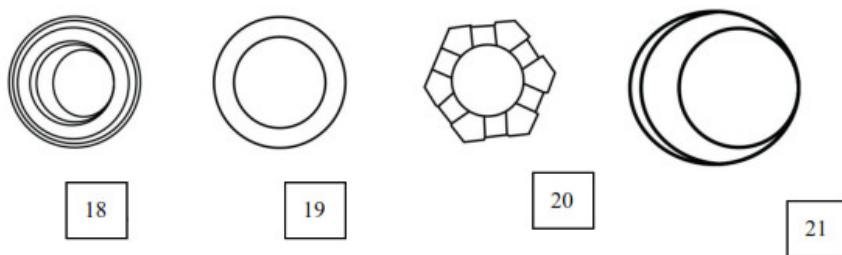
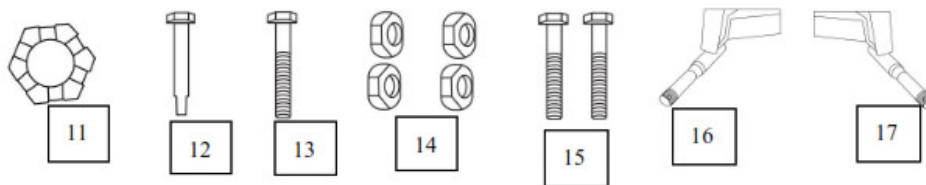
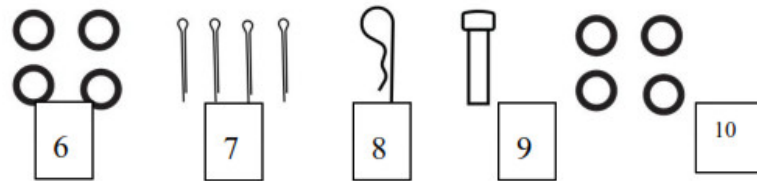
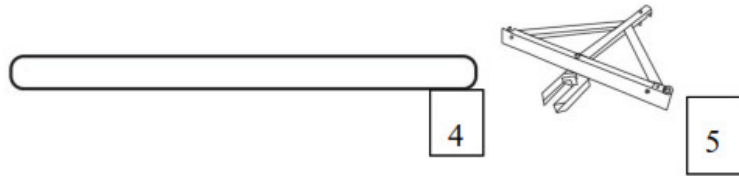
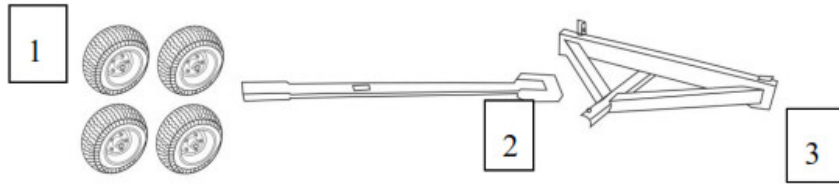

Part#	Description	Qty.	Part#	Description	Qty.
1	Wheel	4	12	Tongue Bolt M16xM12x125mm	1
2	Tongue	1	13	Bolt 12x80mm	1
3	Back Axle	1	14	Lock Nut M12x9mm	4
4	Frame Adaptor	1	15	Bolt 12x70mm	2
5	Front Axle	1	16	Left Axle Assembly	1
6	Large Washer M20mm	4	17	Right Axle Assembly	1
7	Cotter Pin M2.5x35mm	8	18	Hub Bearing (4 are pre-assembled)	8
8	R-Pin M3mm	1	19	Hub Washer	4
9	Hitch Pin M11x60mm	1	20	Hub Castle Nut	4
10	Washer M12mm	4	21	Hub Cap	4
11	Spacer M28xM16x11mm	1			

For replacement parts and technical questions, please call 1-218-943-6290.

WARRANTY

One-year limited parts warranty.



BAC
PO BOX 155
Miltona, MN 56354
Made in China

Documents / Resources

	<p>FIELD TUFF 220 LBS Utility Wagon with High Speed Hub [pdf] Owner's Manual</p> <p>220 LBS Utility Wagon with High Speed Hub</p>
---	---