



---

[Home](#) » [FIDLOCK](#) » **FIDLOCK Single and Double Hip Belt Instruction Manual** 

**Contents** [ [hide](#) ]

- [1 FIDLOCK Single and Double Hip Belt](#)
- [2 Intended use](#)
- [3 TECHNICAL DATA](#)
- [4 USE](#)
- [5 Opening the HERMETIC compartment](#)
- [6 CLEANING](#)
- [7 STORAGE](#)
- [8 LEGAL INFORMATION](#)
- [9 Documents / Resources](#)
  - [9.1 References](#)



## **FIDLOCK Single and Double Hip Belt**



Please read these instructions carefully before assembly and first use Andd keep them in a safe place!

### **IMPORTANT: SAFETY INFORMATION**

To avoid possible damage, read and follow the instructions below:

Danger to life due to interference with pacemakers or defibrillators ('CD) by static magnetic fields! Always keep a sufficient distance between the product and pacemakers or defibrillators (ICDs). Danger to life due to use as survival or emergency equipment! DO not store any equipment, objects or medicines that are vital for your survival in the product.

Risk of injury from use on motor vehicles, aircraft, watercraft or extreme sports! Do not use the product on the outside of motor vehicles, aircraft or watercraft. Remove the product from your equipment before engaging in extreme sports. Do not use the product while doing extreme sports. Danger of injury due to detachment of the TWIST module(s) from the product if the filling weight is too high! DO not exceed a maximum total weight of 700g/24.690z for a filled TWIST module. Risk of injury due to defects of any kind that have occurred in the product! Immediately discontinue use and contact a specialist dealer.

### **Intended use**

- The intended use of the HIP BELT single/double is as a carrying system on the hip when running or cycling.
- TWIST is a magnetic-mechanical holder system consisting of a base (Fig. A ) and a connector (Fig. B).

## ***TWIST***

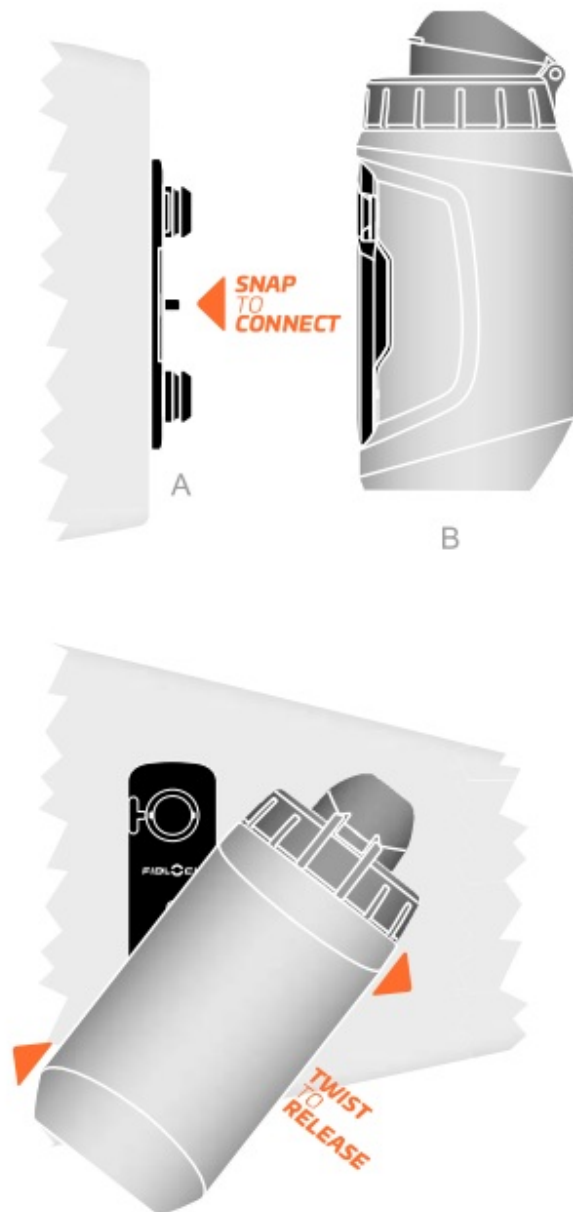

- The HIP BELT single/double may only be used with the original TWIST products intended for this purpose. Otherwise, this will prevent mechanical engagement.
- Any use that deviates from this intended use is considered improper and can lead to injuries, damage or malfunctions.

## **TECHNICAL DATA**

### **HIP BELT single**

- Maximum load of TWIST tex base: 700g/24.69 oz
- Material of TWIST tex base: PA66GF, neodymium; Made in China
- Material of HERMETIC compartment: TPIJ, neodymium; Made in China
- Material of belt: Polyester, PA, PE, PU, HDPE, POM; Made in Vietnam
- Material of HOOK 25 belt LL: PA66GF, neodymium; Made in China

## **HIP BELT double**

- Maximum load per TWIST tex base: 700 g 124.69 oz
- Material of TWIST tex base: PA66GF, neodymium; Made in China
- Material of HERMETIC compartment: TPIJ, neodymium; Made in China
- Material of belt: Polyester, PA, EVA, PE, PU, PR, POM; Made in Vietnam
- Material of HOOK 40 belt LL: PA66GF, PA6GF, neodymium; Made in China
- Material of SNAP buckle combo 20. PA66GF, neodymium; Made in China

## **USE**

### **WARNING**

- Risk of injury from use on motor vehicles, aircraft, watercraft or extreme sports! Do not use the product on the outside of motor vehicles, aircraft or watercraft.
- Remove the product from your equipment before engaging in extreme sports. Do not use the product while doing extreme sports.

### **CAUTION**

- Property damage due to extreme temperatures! Do not expose the product to temperatures outside of approximately. OOC/320F to approx.
- Before use, familiarise yourself with how to handle the product and accessories and check that they function properly.
- Wearing the HIP BELT single or double on the hip

### **DANGER**

- Danger to life due to interference with pacemakers or defibrillators ('CD) by static magnetic fields!

- Always keep a sufficient distance between the product and pacemakers or defibrillators ('CD).
- To open the belt, pull the pull-tab of the HOOK 25/HOOK 40 belt LL (Fig. C).

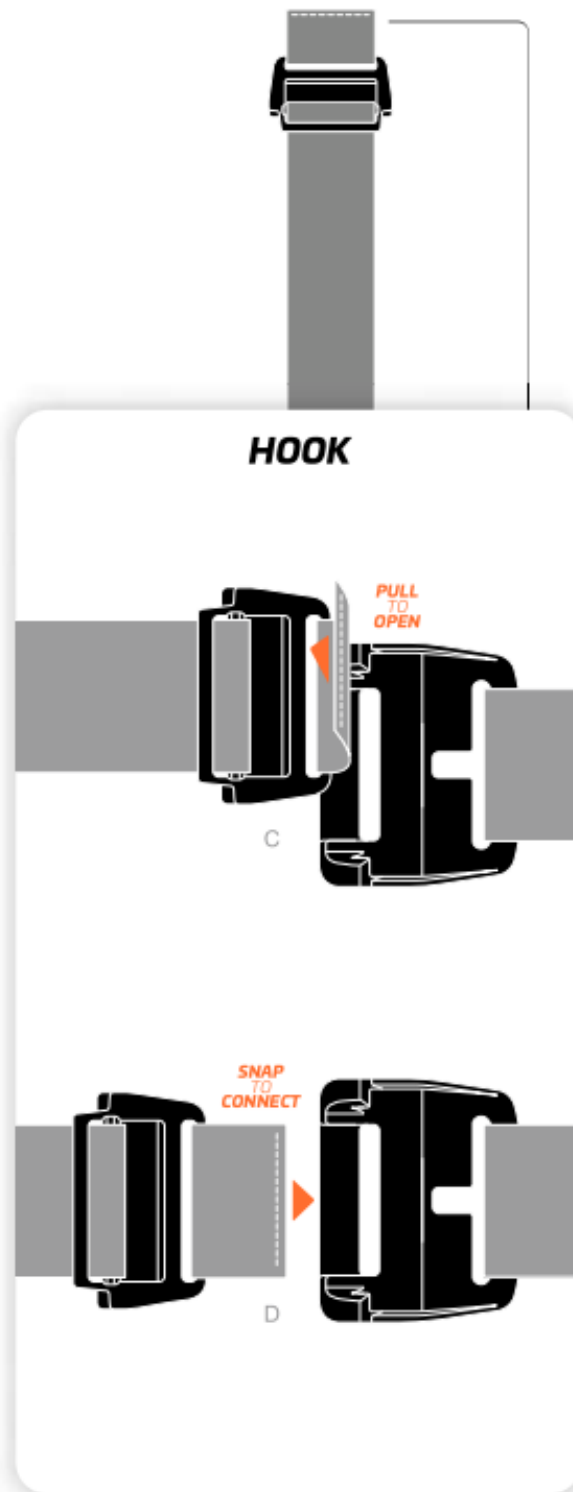

- Place the belt around your waist and adjust to the appropriate length.
- To close, bring the belt ends together and snap the two parts of the HOOK251HOOK 40 belt LL together (Fig. D).
- You will hear a “click” sound when it engages.
- Using the compression straps (only with the HIP BELT double)

## WARNING

The danger of falling due to objects getting into the spokes or other moving parts of the bicycle! Before riding, make sure that Objects attached to the compression straps cannot get into the spokes or other moving parts of the bicycle.

## **WARNING**

Danger of falling due to the magnetic attraction of open magnetic closures! Opened magnetic closures can be attracted to me- tall objects, e.g. on a bicycle, and cause falls. Always close the com- pression straps.

1. To open the SNAP buckle combo 20, push it upwards (Fig. E).

### ***SNAP***

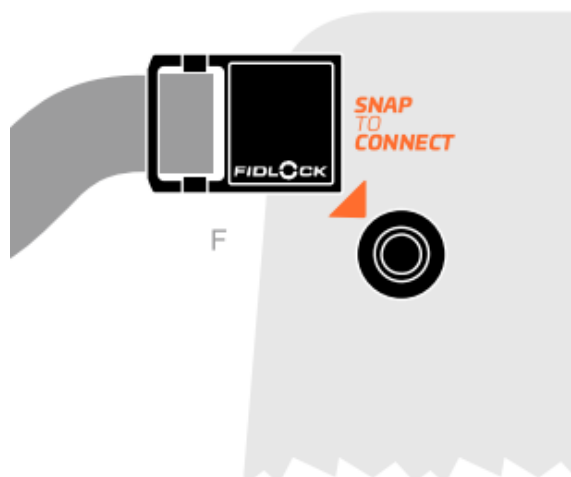
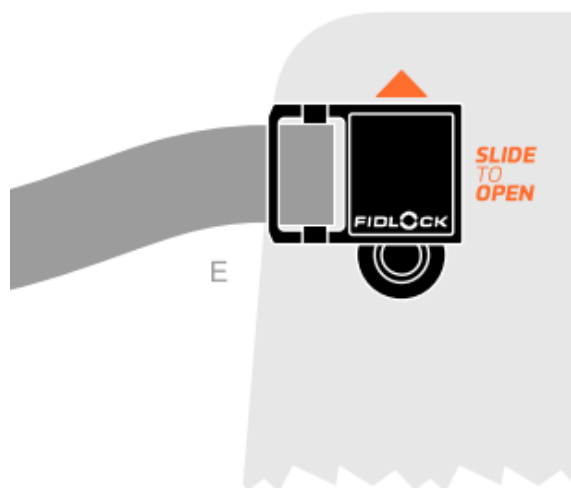

2. To close, bring the ends of the compression strap together and snap the two parts of the SNAP buckle combo 20 together (Fig. F). You will hear a “click” sound when it engages.
3. Connecting/disconnecting a TWIST module with the TWIST text base

## **WARNING**

- Danger of injury due to detachment of the TWIST-moduled (s) from the product if the filling weight is too high!
- Do not exceed a maximum total weight of 700 g/24.69 oz for a filled TWIST module.
- Refer to the instructions for use of the TWIST module(s).

## **Opening the HERMETIC compartment**

### **CAUTION**

- Functional impairment of magnetic stripe cards due to proximity to the magnetic HERMETIC closure!
- Keep a distance of 2 cm / 0.78 in between the HERMETIC closure and the magnetic strip on e.g. credit cards and parking cards.
- Chips on credit cards, electronics, and SD cards are not affected by the HERMETIC closure.

### **CAUTION**

Damage to the HERMETIC compartment by sharp-edged or pointed objects! Do not store sharp-edged or pointed objects in the HERMETIC compartment.

Items can be stored in the HERMETIC compartment to protect them from water and sand.

1. Fold up the tab on the HERMETIC closure.
2. Pull the tabs apart (Fig. G).
3. Closing the HERMETIC compartment

### **CAUTION**

Functional impairment due to dirt on the HERMETIC closure! Dirt or foreign bodies such as metal dust or ferrous sand, on the HERMETIC closure prevents it from closing properly. Before each use, make sure that the HERMETIC closure is free from dirt or foreign bodies.

1.

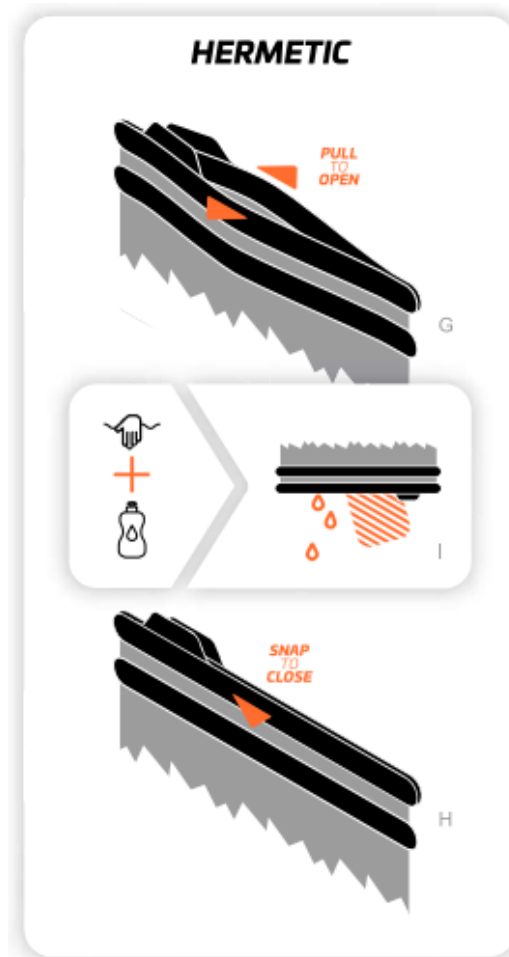

Release the HERMETIC closure and snap it shut (Fig. H).

2. Make sure that the HERMETIC compartment is firmly closed.

## CLEANING

### CAUTION

Property damage caused by cleaning in the dishwasher or washing machine! Do not clean the product in the dishwasher or washing machine.

### CAUTION

Property damage due to cleaning with unsuitable cleaning- ing agents! Do not clean the product with washing powder, fabric softener, chlorine bleach, all-purpose cleaners, detergents containing alcohol or abrasive detergents.

1. Clean the product by hand with clear water and a small drop of washing-up liquid (Fig. I).





2. After cleaning, wipe the inside of the HERMETIC compartment dry with a soft cloth.
3. Clap a dry kitchen sponge in the HERMETIC closure so that the HER-
4. MThe ETIC compartment remains open and can air dry completely (Fig. I).

## **STORAGE**

### **CAUTION**

Property damage due to extreme temperatures! Do not expose the product to temperatures outside of approximately. OOC/32 OF to approx. Store the product in a dry place.

### **DISPOSAL**

The product can be disposed of in household waste. Please observe the applicable environmental regulations in your country regarding disposal.

### **LIABILITY**

We have gone to great lengths to ensure that the instructions for use are correct, complete and as accurate as possible. However, deviations cannot be entirely ruled out, and no liability can be accepted for errors in the instructions for use provided. We accept no liability for damage caused by failure to observe the instructions for use or by improper use. If the product is used improperly or for another purpose, or is repaired by the user, no liability is accepted for any damages.

## LEGAL INFORMATION

The HERMETIC, HOOK, SNAP and TWIST technologies are legally protected by patents/patent applications. For more information on the patent protection of the HERMETIC, HOOK, SNAP and TWIST product ranges, please visit:

[www.fidlock.com/patents](http://www.fidlock.com/patents). See our website for more information:

[www.fidlock.com/consumer](http://www.fidlock.com/consumer) FIDLOCK GmbH, Kirchhorster Straße 39, 30659 Hanover, Germany, Hanover Local Court, HRB 204281, Email: [info-bike@fidlock.com](mailto:info-bike@fidlock.com)

## Documents / Resources

	<p><a href="#">FIDLOCK Single and Double Hip Belt [pdf]</a> Instruction Manual</p> <p>Single and Double Hip Belt, Double Hip Belt, Hip Belt, Belt</p>
---	---

## References

- [User Manual](#)

 Belt, Double Hip Belt, FIDLOCK, Hip Belt, Single and Double Hip

 FIDLOCK Belt

---

## Leave a comment

Your email address will not be published. Required fields are marked \*

Comment \*

Name

Email

Website

☐ Save my name, email, and website in this browser for the next time I comment.

Post Comment

Search:

e.g. whirlpool wrf535swhz

Search

[Manuals+](#) | [Upload](#) | [Deep Search](#) | [Privacy Policy](#) | [@manuals.plus](#) | [YouTube](#)

This website is an independent publication and is neither affiliated with nor endorsed by any of the trademark owners. The "Bluetooth®" word mark and logos are registered trademarks owned by Bluetooth SIG, Inc. The "Wi-Fi®" word mark and logos are registered trademarks owned by the Wi-Fi Alliance. Any use of these marks on this website does not imply any affiliation with or endorsement.