



FESTOOL DL I-CT26-48 Compressed Air Module Instruction Manual

[Home](#) » [FESTOOL](#) » FESTOOL DL I-CT26-48 Compressed Air Module Instruction Manual 

FESTOOL DL I-CT26-48 Compressed Air Module Instruction Manual



Contents

- 1 Safety warnings
- 2 Symbols
- 3 Parts of the device
- 4 Technical data
- 5 Intended use
- 6 Commissioning
- 7 Settings
- 8 Maintenance and care
- 9 Environment
- 10 General information
- 11 Documents / Resources
 - 11.1 References
- 12 Related Posts

Safety warnings



WARNING! Read all safety warnings and instructions. Failure to follow the

safety warnings and instructions may result in electric shock, fire and/or serious injury.

Save all safety warnings and instructions for future reference.

Safe handling of the machine

- **Do not use the module on its own as a switching unit.** Only use the module on the connected mobile dust extractor. There is a risk of a fire developing if the appliance is operated unattended.
- **If intact following a visual inspection,** work in a dry environment according to instructions.
- Only use **the electrical outlet module on the machine** for its stated purpose.
- **Check the plug and the cable regularly** in order to prevent a hazard. In the event of damage, these must be replaced by an authorised service workshop only.
- **Only operate the machine within the operating limits specified in the technical data** (see section 4).
- **No serial coupling allowed.** Do not connect the device with an extension lead or multiple socket strip.
- **Operation only** from earthed electrical outlet modules.
- Check for damage **before operation**.
- **Do not touch connections and electrical contacts** with fingers, jewelry or other metal objects.
- **Do not clean with liquids** (in particular, do not use a pressure washer).
- **Do not use chemicals, fuels and lubricants** (e.g. for cleaning).
- **When dismantling,** there is a risk that the housing will break. This can expose live cables. Carefully dismantle the machine and visually check for damage.

Connecting consumers

- **Comply with local regulations for safe operation of electrical consumers at all times, especially for operation of mobile power generators.**
- **Use a consumer with restart protection if possible.**
- **Do not use faulty consumers.** Consumers, including the mains power cable, must be in flawless technical

condition.

- **During operation with connected consumers, ensure stable footing** (ensure good access to the connected consumer and sufficiently long cable; do not place the charging cable and mains power cable under tension).
- **Before connecting consumers, ensure that the consumers are switched off.**
- **Always switch off connected consumers after use.**

Symbols



Warning of general danger



Warning of electric shock



Read the operating manual and safety warnings.



Wear a dust mask.



Tip or advice

- Handling instruction



Do not dispose of it with domestic waste.

Parts of the device

1. Programmable electrical outlet module
2. Connection button
3. Connection display
4. Snap-in nose
5. Connection for compressed-air tool
6. Connection for compressed-air supply
7. Lock
8. Plug
9. Bracket for rubber band
10. Pins for assembly
11. Module support

The specified figures appear at the beginning of the operating manual.

Technical data

Compressed air module		DL I-CT26-48
Max. electrical outlet module connected load	EU, F, BEL CH DK GB	3520 W 2300 W 3680 W 2990 W
Air pressure	Max. inlet pressure	6.2 bar (90 psi)
	Recommended minimum	5 bar (72.5 psi)
Compressed air grade according to DIN ISO 8573-1		Class 5
Mains power cable length		40 cm
Protection class		IPX4
Frequency		2402–2480 Mhz
Equivalent isotropically radiated power (EIRP)		< 10 dBm
Dimensions L x W x H		160 x 122 x 97 mm[2]
Weight		0,6 kg

Service unit (VE)

The most important prerequisite for function, reliability, long service life and economical operation of machines and systems operated by compressed air is properly treated compressed air. We therefore recommend using compressed air of at least quality class 5 according to ISO 8573-1.

This is achieved by installing the service unit (VE) upstream and setting it correctly.

To ensure that automatic switch-on works perfectly, the flow pressure of the tool must be at least 6 bar.

Intended use

Compressed-air module suitable for

- Connection of an electric tool.
- Connection of a compressed-air tool.
- Use with Festool mobile dust extractors of series CT 26 to CT 48.
- Indoor use only.



The user is liable for improper or non-intended use.

Commissioning



WARNING

Unauthorized voltage or frequency!

Risk of accidents

- Observe the specifications on the machine's name plate.
- Observe country-specific regulations.



Hazardous dust

Damage to the respiratory passage

- When operating electric or compressed-air tools, ensure that the connected mobile dust extractor is switched on.
- When operating power tools at the left socket, ensure that the operating mode is set to automatic switch-on (auto).
- Inserting a module [2]
- Visually check for any faults on the module and module support.
- Insert the module support [1-11] into the recess provided for it on the mobile dust extractor using pins [1-10].
- Fix the module support to the hook [1-9] using the rubber band.
- Insert the module into the module support.
- Insert the mains plug [1-8] into the electrical outlet module on the mobile dust extractor.

Connecting the module to the mobile dust extractor

To ensure that the module works properly, an active Bluetooth® connection must be available.

- Hold down the connection button [1-2] on the module for three seconds.
The connection display [1-3] rapidly flashes blue.
The module is ready for connection for 60 seconds.
- Press the connection button of the corresponding Festoon mobile dust extractor.
- The right-hand LED of the connection display lights up blue, the module is connected to the mobile dust extractor.

 Connecting a new mobile dust extractor overwrites the previous connection.

 The connection allows the operating mode to be switched between automatic switching (auto) and continuous power at the left electrical outlet module (see 7.1).

Connecting power tools



Risk of injury

- Observe the maximum electrical outlet module connected load (see “Technical data” section).
- Switch off the power tool.

Connecting a mains-powered power tool to the module

- Connect the power tool to the electrical outlet module **[1-1]** on the module.
- The power tool is connected to the module via the power cable.

Connecting a compressed-air tool



Risk of injury

- Switch off the compressed-air tool.



Risk of injury

There is a lot of noise when disconnecting the compressed-air hose. In addition, the quick coupling can fly away uncontrollably.

- Wear safety glasses and ear protection.
- Plug in the compressed-air tool at the upper compressed-air connection **[1-5]**.
- Plug in the compressed-air supply at the lower compressed-air connection **[1-6]**.

Festool Work app*

The module can be configured with the Festool Work app.

- Hold down the connection button **[1-2]** on the module for three seconds.
The connection display **[1-3]** flashes rapidly.
The module is ready for connection for 60 seconds.
- Follow the instructions provided in the Festool Work app.

* Not available in all countries.

Settings

Switching operating mode

The left electrical outlet module **[1-1]** can be switched from automatic switch-on (auto) to continuous power via the connection button **[1-2]** or the Festool Work app.

 The left-hand LED of the connection display [1-3] lights up green when supplied with continuous power.

Maintenance and care



Risk of injury, electric shock

- Always pull the mains plug from the socket before performing any servicing and maintenance work.
- All maintenance and repair work which requires the housing to be opened should always be carried out by an authorised service workshop.



Customer service and repairs must only be carried out by the manufacturer or service workshops.

Find the nearest address at:

www.festool.co.uk/service

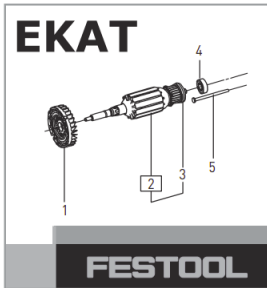

Always use original Festool spare parts. Order no. at:

www.festool.co.uk/service

Environment



Do not dispose of the device in the household waste! Recycle devices, accessories and packaging. Observe applicable national regulations.

In accordance with the European Directive on waste electrical and electronic equipment and implementation in national law, used power tools must be collected separately and handed in for environmentally friendly recycling. Information on collection points for proper disposal can be found at www.festool.co.uk/recycling.

Information on REACH: www.festool.co.uk/reach

General information

Connection display [1-3] lights up red

There is a malfunction. Please contact Festool Customer Service.

Bluetooth®

The Bluetooth® word mark and the logos are registered trademarks of Bluetooth SIG, Inc.; they are used by TTS Tooltechnic Systems AG & Co. KG, and therefore by Festool, under licence.

Information on data privacy

The power tool contains a chip which automatically stores machine and operating data. The data saved cannot be traced back directly to an individual.

The data can be read in a contactless manner using special devices and shall only be used by Festool for fault diagnosis, repair and warranty processing and for quality improvement or enhancement of the power tool. The data shall not be used in any other way without the express consent of the customer.

USA: Federal Communications Commission (FCC) Interference Statement

NOTE: This equipment has been tested and found to comply with the limits for a Class B digital device, pursuant to part 15 of the FCC

Rules. These limits are designed to provide reasonable protection against harmful interference in a residential installation. This equipment generates, uses and can radiate radio frequency energy and, if not installed and used in accordance with the instructions, may cause harmful interference to radio communications. However, there is no guarantee that interference will not occur in a particular installation. If this equipment does cause harmful interference to radio or television reception, which can be determined by turning the equipment off and on, the user is encouraged to try to correct the interference by one or more of the following measures:

- Reorient or relocate the receiving antenna.
- Increase the separation between the equipment and receiver.
- Connect the equipment into an outlet on a circuit different from that to which the receiver is connected.
- Consult the dealer or an experienced radio/TV technician for help.

NOTE: Any changes or modifications not expressly approved by the party responsible for compliance could void the user's authority to operate the equipment.

This device complies with part 15 of the **FCC Rules**. Operation is subject to the following two conditions:

1. This device may not cause harmful interference, and
2. this device must accept any interference received, including interference that may cause undesired operation.

Canada: RSS Compliance Statement

This device contains licence-exempt transmitter(s)/receiver(s) that comply with Innovation, Science and Economic Development Canada's licence-exempt RSS(s). Operation is subject to the following two conditions:

1. This device may not cause interference.
2. This device must accept any interference, including interference that may cause undesired operation of the device.

Canada: Radio frequency (RF) Exposure Information

The radiated output power of the Wireless Device is below the Innovation, Science and Economic Development (ISED) radio frequency exposure limits. The Wireless Device should be used in such a manner such that the potential for human contact during normal operation is minimized.

This equipment should be installed and operated with a minimum distance of 20 cm between the radiator and your body.

Imported into the UK by

Festool UK Ltd
1 Anglo Saxon Way
Bury St Edmunds
IP30 9XH
Great Britain

FESTOOL

Documents / Resources

	<p>FESTOOL DL I-CT26-48 Compressed Air Module [pdf] Instruction Manual DL I-CT26-48, DL I-CT26-48 Compressed Air Module, Compressed Air Module, Air Module, Module</p>
--	--

References

- [F Festool United Kingdom](#)
- [F Festool customer service | Service for you and for your tool](#)
- [F Festool Worldwide - Tools for the toughest demands](#)
- [F Elektrowerkzeuge für professionelle Handwerker | Festool Deutschland](#)
- [F Festool Kundenservice | Service für Sie und Ihr Werkzeug](#)
- [F Festool España | Fabricando Herramientas Profesionales desde 1925](#)
- [F Nuestros Servicios Personalizados | Rendimiento sin concesiones ? Festool](#)
- [F Festool Services | Le service après-vente pour vous et votre machine](#)
- [F Festool customer service | Service for you and for your tool](#)
- [F Festool Kundenservice | Service für Sie und Ihr Werkzeug](#)
- [F Nuestros Servicios Personalizados | Rendimiento sin concesiones ? Festool](#)
- [F Festool Services | Le service après-vente pour vous et votre machine](#)
- [User Manual](#)

[Manuals+](#), [Privacy Policy](#)

This website is an independent publication and is neither affiliated with nor endorsed by any of the trademark owners. The "Bluetooth®" word mark and logos are registered trademarks owned by Bluetooth SIG, Inc. The "Wi-Fi®" word mark and logos are registered trademarks owned by the Wi-Fi Alliance. Any use of these marks on this website does not imply any affiliation with or endorsement.