



# FEIYUTECH Vimble 3 Handheld 3-Axis Smartphone Gimbal Stabilizer User Guide

[Home](#) » [FeiyuTech](#) » FEIYUTECH Vimble 3 Handheld 3-Axis Smartphone Gimbal Stabilizer User Guide 

## Contents

- [1 FEIYUTECH Vimble 3 Handheld 3-Axis Smartphone Gimbal Stabilizer](#)
- [2 Overview](#)
- [3 Quick Experience](#)
- [4 Charging](#)
- [5 Landscape & Portrait Mode Switching](#)
- [6 Extend and Reset the Handle](#)
- [7 Tripod](#)
- [8 Connection](#)
  - [8.1 Bluetooth Connection](#)
  - [8.2 App Connection](#)
- [9 Common Operation](#)
- [10 Indicator](#)
- [11 Specification](#)
- [12 Documents / Resources](#)
  - [12.1 References](#)
- [13 Related Posts](#)



**FEIYUTECH Vimble 3 Handheld 3-Axis Smartphone Gimbal Stabilizer**



## Overview

1. Roll axis
2. Cross arm
3. Tilt axis
4. Vertical arm
5. Pan axis
6. Upper trigger button  
(Custom functions in APP)
7. Lower trigger button
8. Handle (Built-in battery)
9. USB-C port for accessories
10. Limitation  
This product does NOT include smartphones.
11. A button
12. B button
13. Zoom button
14. Smartphone holder
15. Extendable rod  
(Extendable range 0~198mm)
16. Joystick
17. Dial
18. Dial the function switching button
19. Status indicator
20. Battery indicator
21. Album button
22. Mode button

- 23. Shutter button
- 24. USB-C port
- 25. Power button
- 26. 1/4 inch thread hole
- 27. Tripod

## Quick Experience

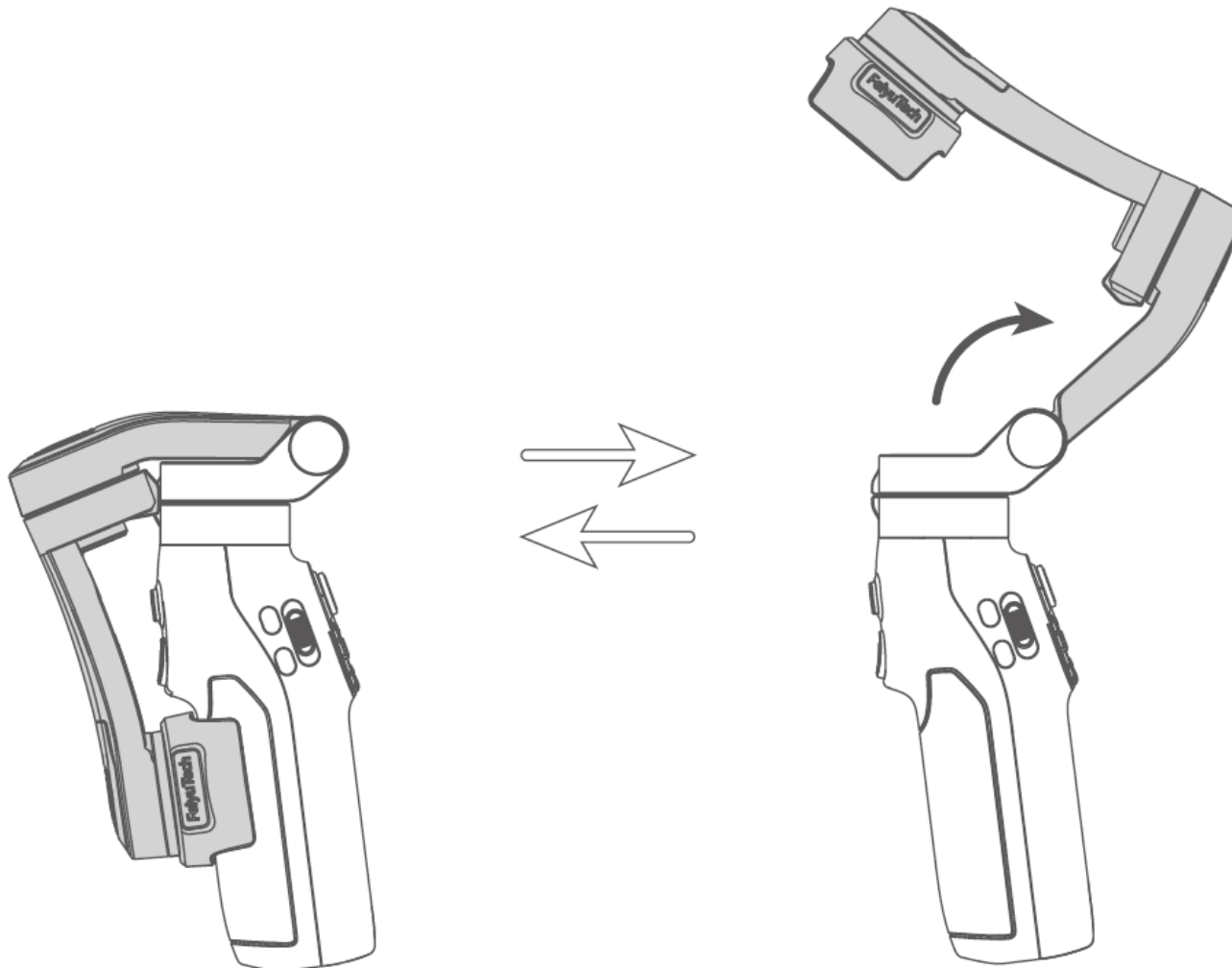

1. **Step1:** Unfold and fold

### 2. **Step2 Smartphone Installation**

It is recommended to remove the smartphone case before installation.

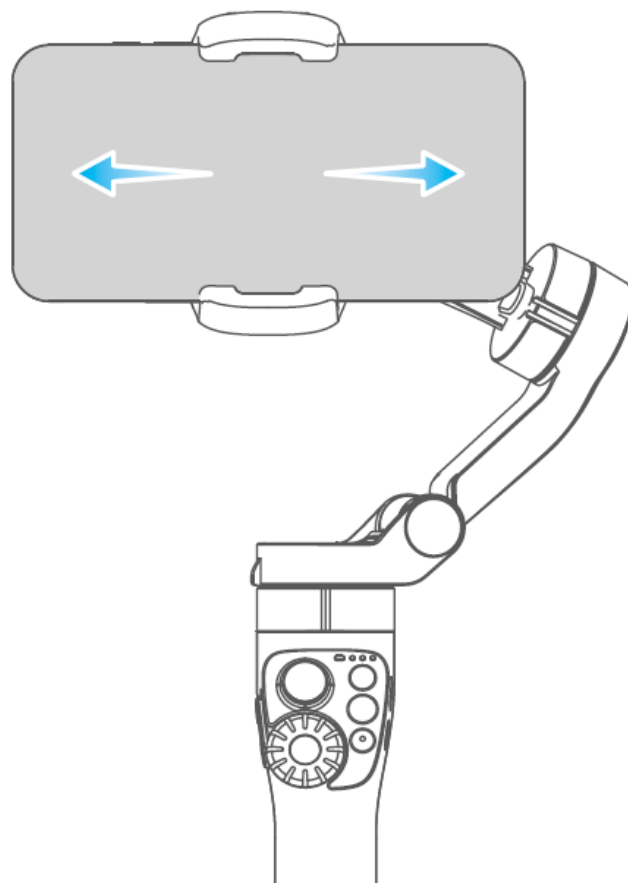
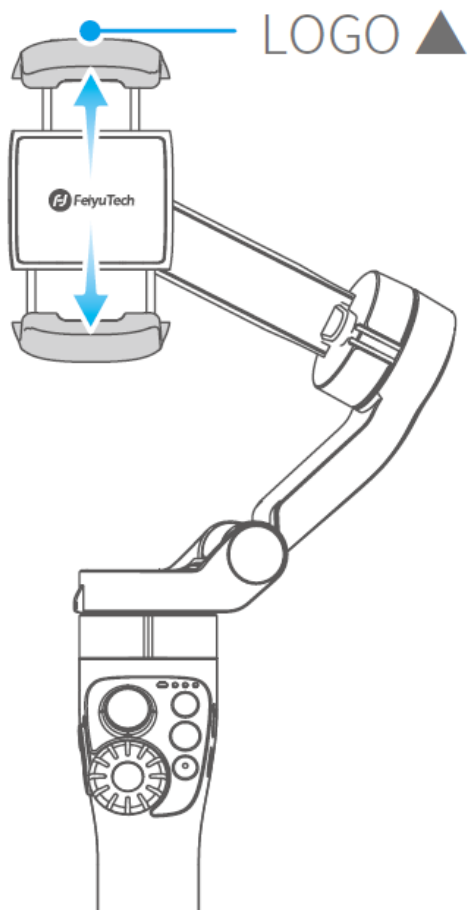

Keep the logo of the smartphone holder upward. Keep the smartphone holder in the center. If the smartphone is tilted, please move the smartphone left or right to make it horizontal.

### 3. Step3: Power ON/OFF

Long press the power button and release it when you hear the tone.

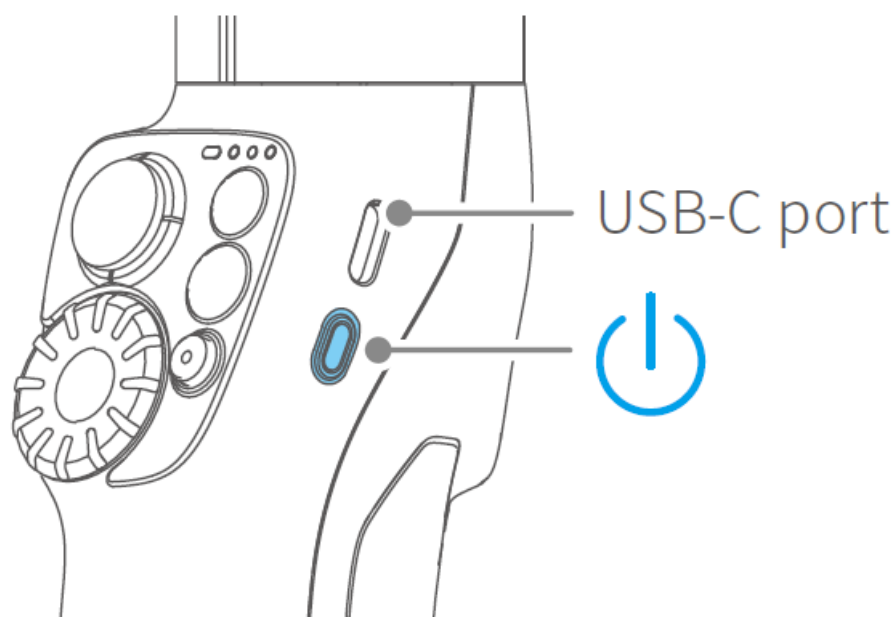

## Charging

Please fully charge the battery before powering on the gimbal for the first time.

Connect the USB 2.0 to the USB-C cable to charge. The indicator light is red while charging, and turns green after charging is complete.

## Landscape & Portrait Mode Switching

Double click the function button or manually rotate the smartphone holder to switch between landscape and portrait mode. Do not make an anti-clockwise rotation in landscape mode, and Do not make a clockwise rotation in portrait mode.

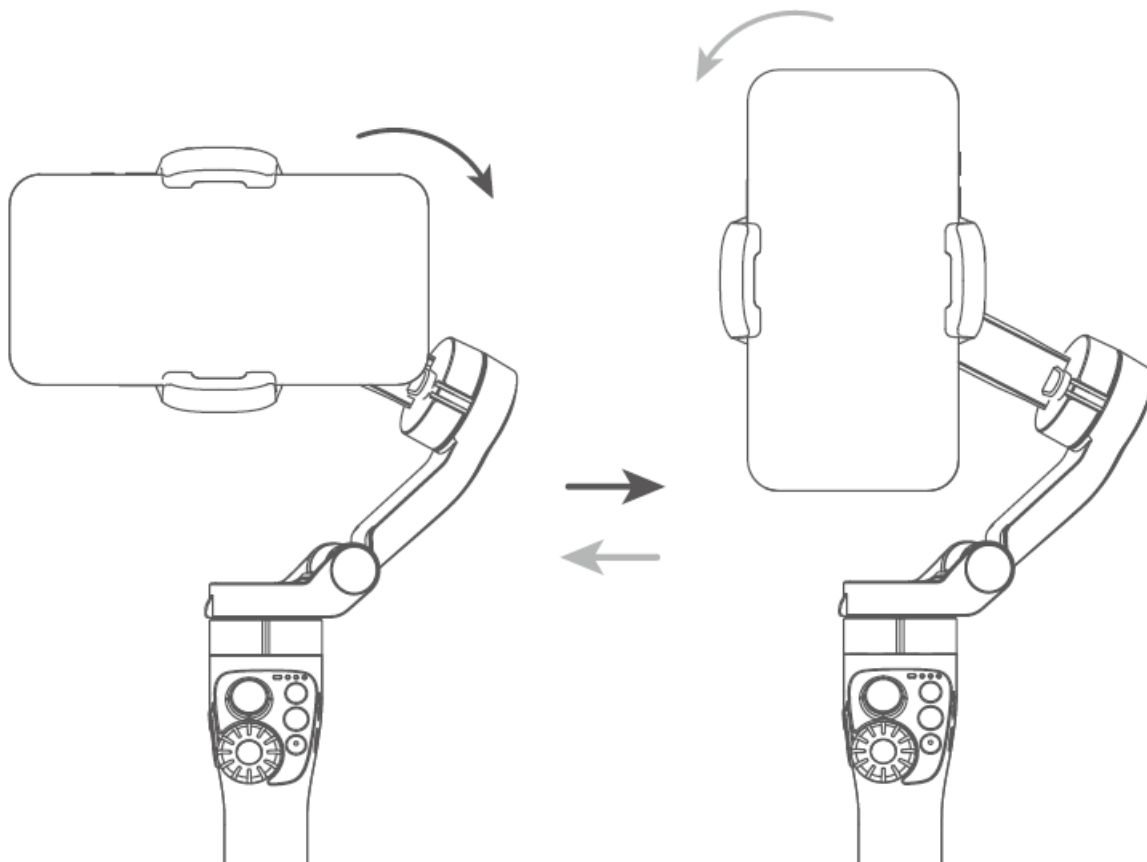

## Extend and Reset the Handle

1. Hold the handle with one hand, and hold the bottom of the pan axis with another hand.
2. **Extending:** Pull the extendable rod out to a suitable length (Extendable range 0~198mm).  
**Reset:** Push the upper grip to make the extendable bar down to the handle part.

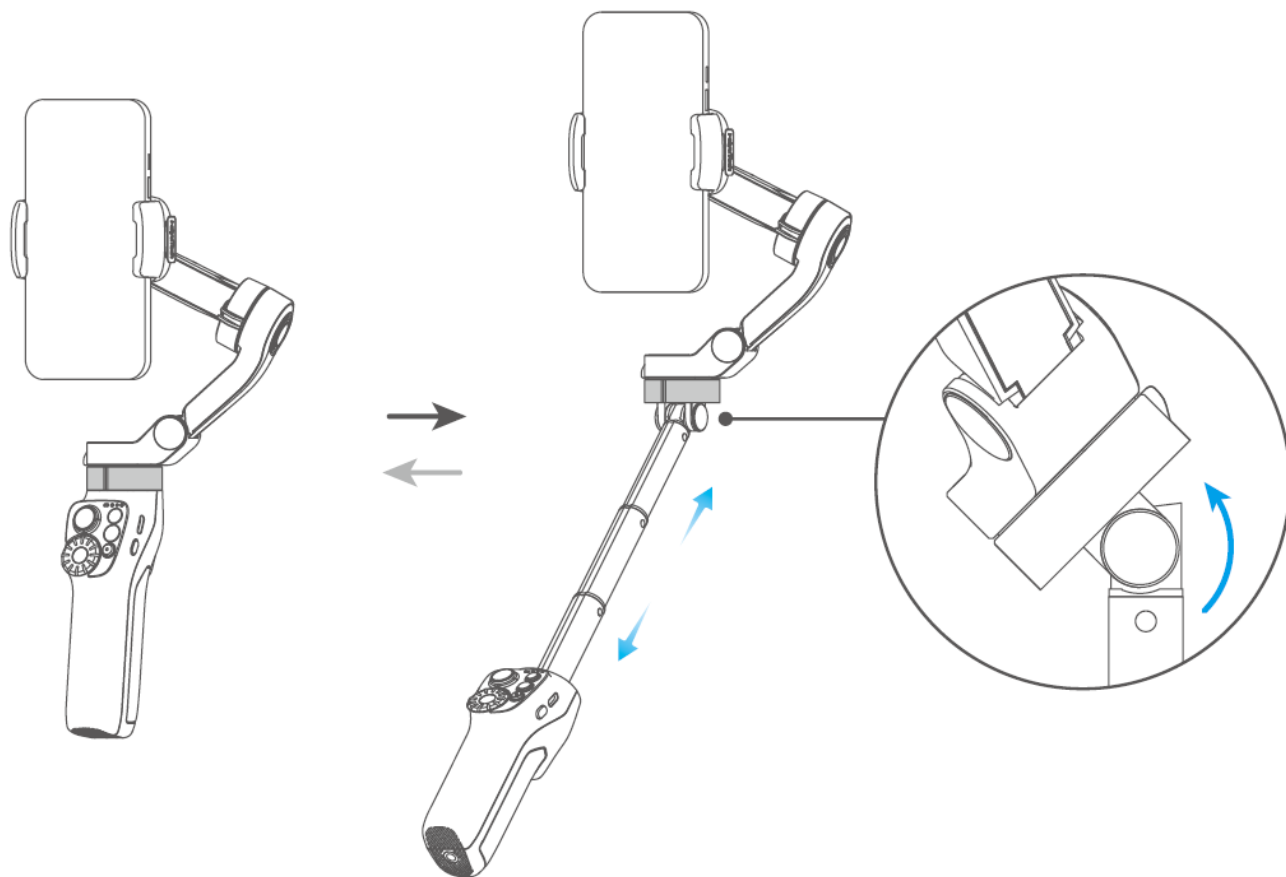

## Tripod

The tripod is attached to the bottom of the gimbal in a rotating manner. According to the needs of shooting, choose whether to install it.

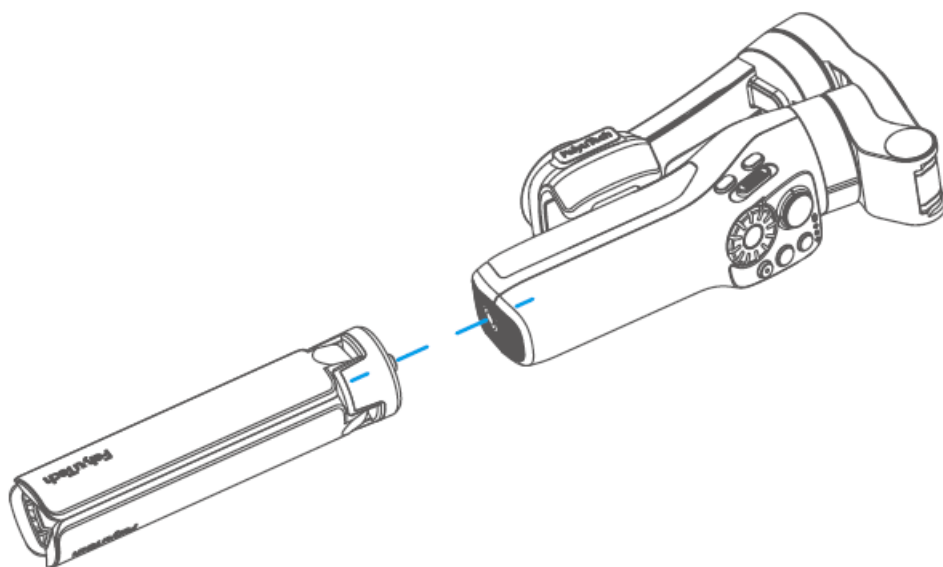

## Connection

### Bluetooth Connection

#### Turn on the gimbal.

- **Method one:** Download and install Feiyu ON App, run the App, and follow the prompts to turn on and connect with the Bluetooth.

- **Method two:** Turn on the smartphone Bluetooth, and connect the gimbal Bluetooth in the setting of the phone, e.g. FY\_Vimble3\_xx. (If the Bluetooth can't be found, please turn off Feiyu ON App in the background.)

## App Connection

### Download the Feiyu ON App

Scan the QR code to download the app, or search for "Feiyu ON" in the App Store or Google Play. Requires iOS 9.0 or above, Android 6.0 or above.



iOS



Android

## Common Operation

1. **Basic:** Vimble 3 can achieve those functions after a balanced gimbal.
2. **Bluetooth:** New available function achieved after connecting smartphone via Bluetooth with the functions in condition
  - **Still available**
  - **APP:** New available function achieved via Feiyu
    1. ON APP with the functions in conditions
    2. **still available.**



Diagram	Button	Condition	Function
	Power button	Basic	Power off: · Long press: power on · Single tap: check battery level (while charging) Power on: · Long press: power off · Double tap: standby mode (single tap at standby mode: to wake up the gimbal)
		APP	Power on: Single tap: enter/quit shortcut menu in APP
	Joystick	Basic	Control the movement of the tilt and pan axes
		APP	· Select setting option · After enter album: move to left to choose previous photo/video; move to right to choose next photo/video; move upward to play/pause; move downward to play/pause







Diagram	Button	Condition	Function
	Dial	Basic	· Rotate: control roll axis to rotate
		APP	· Rotate: control zoom(default)/focus
	Dial function switching button	Basic	Switch the control object of dial: · Single tap: Switch to control focus when controlling zoom; In other cases, switch to control zoom · Long press: switch to control roll axis/zoom
	Album button	APP	Single tap: enter/exit album
	Mode button	Basic	· Single tap: switch among follow mode, pan follow, all follow mode cyclically (default to be follow mode) · Double tap: landscape and portrait mode switching
	Shutter button	Bluetooth	When original camera APP is in photo/video mode: · Single tap: take photo, start/stop recording
		APP	· Press halfway: focus · Single tap: take photo, start/stop recording · Long press: Switch between photo/video
	Zoom button	Bluetooth	Slide up and down to adjust focus. · Slide up (T direction): zoom in · Slide down(W direction): zoom out

Diagram	Button	Condition	Function
	A/B button	Basic	<ul style="list-style-type: none"> <li>· Long press: mark the current axes position as A/B(while dial is controlling roll axis)</li> <li>· Single tap: return to the position A/B that you have marked</li> </ul>
		APP	<ul style="list-style-type: none"> <li>· Long press: mark the current zoom/focus/axes position as A/B(while dial is controlling zoom/focus/roll axis)</li> <li>· Single tap: return to the position A/B that you have marked</li> </ul>
	Upper trigger button	Basic	Long press: enter flash mode (release it to exit)
		APP	Can be customized as: switch front/rear camera, etc
	Lower trigger button	Basic	<ul style="list-style-type: none"> <li>· Long press: enter lock mode (release it to exit)</li> <li>· Double tap: recenter</li> </ul>
		APP	Triple tap: Switch front/rear camera

### Indicator





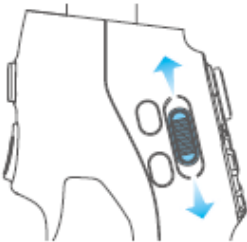
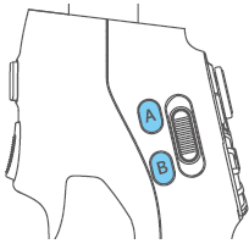
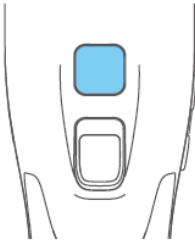
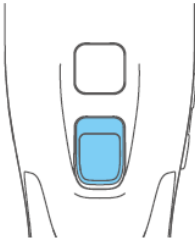
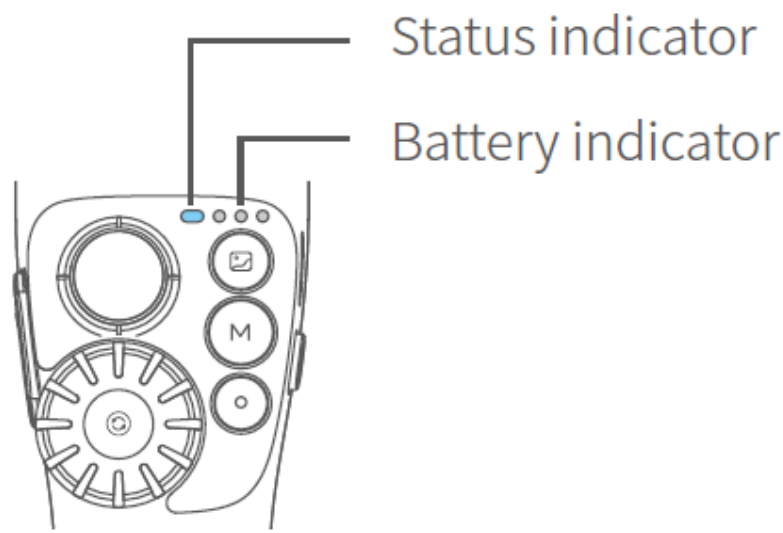

### Status indicator

Status indicator	Status
Constant Blue light	Bluetooth connected
Blue light flash	Bluetooth disconnected
Blue light keeps flashing	Unpairing Bluetooth

Status indicator	Status
Green light stays on	Charging completed
Green light flash	Initializing
Breathing light (green)	Standby mode
Red light stays on	Charging
Red light flash	Low power, will auto power off

#### Battery indicator

Battery indicator	Battery
	Fully charged
	Medium level of battery
	Low power
	(Flashing) Please change the gimbal

#### Specification

- Product name: Feiyu Vimble 3 3-Axis Handheld Gimbal for Smartphone
- Product model: VB3
- Max. Tilt Range: -35° ~ +35°
- Max. Roll Range: -50° ~ +50°
- Max. Pan Range: -80° ~ +174°
- Size: About 115×176×65mm (folded)
- Net gimbal Weight: About 387g (not including tripod)
- Battery: 1300mAh
- Charging time: About 2.5h
- Theoretical Battery Life: About 10h (for a different smartphones you installed, it's slightly different)
- Payload Capability: ≤ 260g (after balanced)
- Adapter smartphones: iPhone and Android phones (the width of the phone ≤ 88mm )

#### Documents / Resources

FeiyuTech  
VIMBLE 3  
Handheld 3-Axis  
Smartphone Gimbal  
Stabilizer  
Model: VIMBLE 3  
Version: 1.0  
© 2018 FeiyuTech



**[FEIYUTECH Vimble 3 Handheld 3-Axis Smartphone Gimbal Stabilizer](#)** [pdf] User Guide  
Vimble 3, Handheld 3-Axis Smartphone Gimbal Stabilizer, Vimble 3 Handheld 3-Axis Smartpho  
ne Gimbal Stabilizer

## References

- [FeiyuTech - Official Website](#)
- [After sales service--FeiyuTech](#)