



FeiyuTech AK2000C 3-Axis Stabilized Handheld Gimbal for Camera User Guide

[Home](#) » [FeiyuTech](#) » FeiyuTech AK2000C 3-Axis Stabilized Handheld Gimbal for Camera User Guide 



3-Axis Stabilized Handheld Gimbal for Camera
Quick Start Guide
V 2.0

Tutorial Videos



<https://www.feiyu-tech.com/play/131.html>

Contents

- 1 Quick Experience
- 2 Touch Screen
- 3 Charging
- 4 Download the Feiyu ON App
- 5 Official Social Media
- 6 Specifications
- 7 Overview
- 8 Documents / Resources
 - 8.1 References
- 9 Related Posts

Quick Experience

Step 1: Unlock and lock

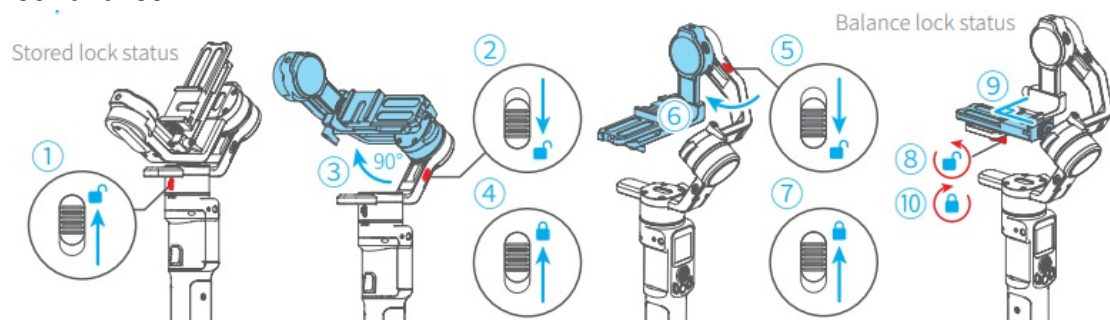

Step 2: Camera installation

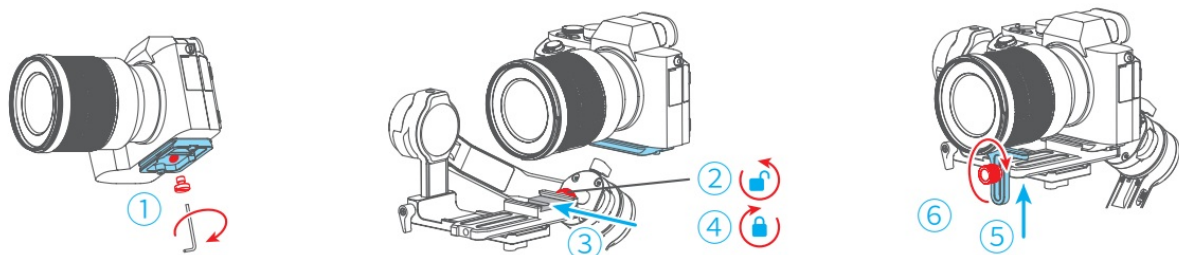

Step 3: Gimbal balancing (Balanced standard: the camera can stay stably at any angle)

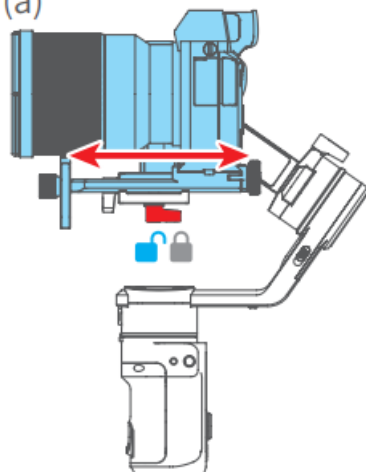
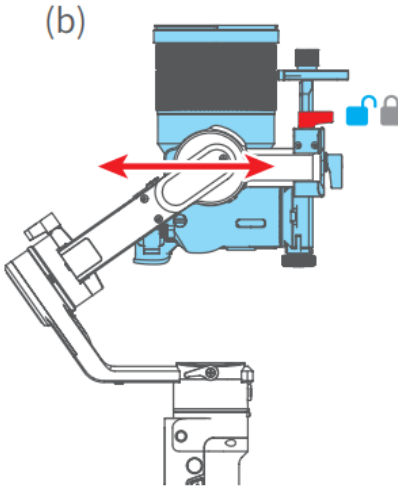
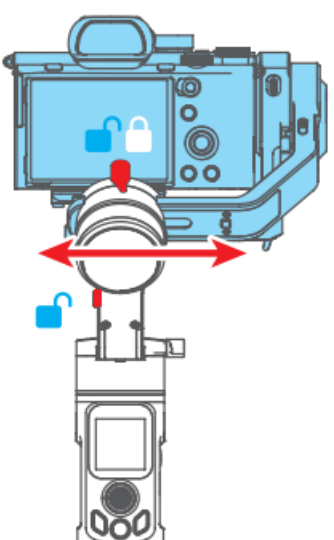
<p>(1)Balance tilt axis</p> <p>(a)</p> 	<p>(b)</p> 	<p>(2)Balance roll axis</p> <p>(c)</p> 
<ul style="list-style-type: none"> ·Turn the camera lens forward. ·Unlock the safety lock(red). ·Move the camera to balance. ·Lock the safety lock after the camera can keep horizontally forward. 	<ul style="list-style-type: none"> Turn the camera lens upwards. ·Loosen the lock screw(red). ·Move the camera to balance. ·Tighten the lock screw after balanced. 	<ul style="list-style-type: none"> Turn the camera lens forward. ·Unlock the safety lock(red). ·Loosen the lock screw (red). ·Move the camera to balance. ·Tighten the lock screw after balanced.

Step4: Power ON/OFF





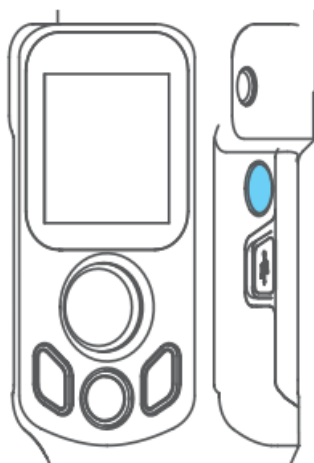

Check before powering on: Gimbal has enough energy, all the position locks have been unlocked, safety lock, lock screw have been tightened. The camera is ready to shoot. (The lens cover should be removed from the camera and the memory card and battery needs to be inserted into the camera to complete all the connections.)

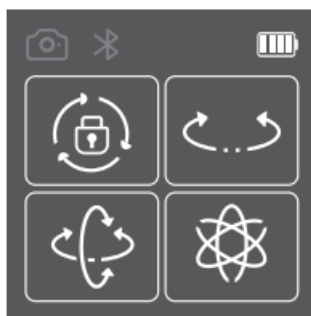
The long press power button, release the button until it shows LOGO on display.



Touch Screen



	Camera connection
	Bluetooth
	Battery level
	All Lock mode
	Pan mode
	Follow mode
	All follow mode

Charging



Please fully charge the battery before powering on the gimbal for the first time.

Open the USB rubber cover. Connect the USB 2.0 AM to the USB-C MALE cable to charge. A quick charge is available.

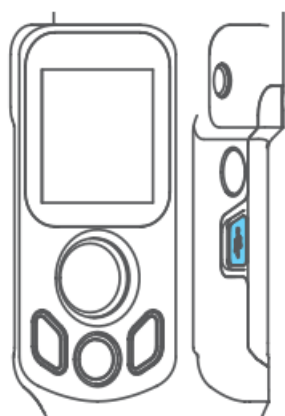

USB 2.0 AM to USB-C MALE

Download the Feiyu ON App

Scan the QR code to download the app, or search for “Feiyu ON” in the App Store or Google Play.

* Requires iOS 9.0 or above, Android 6.0 or above.



iOS Version



Android Version

https://cdn1.feiyu-tech.com/dl/app/Feiyu_On.apk

<https://itunes.apple.com/us/app/feiyu-on/id1170606381?mt=8>

Official Social Media



Facebook



Youtube



Instagram



Twitter

<https://www.youtube.com/user/FeiyuChannel>

<https://www.facebook.com/feiyutech>

<http://www.twitter.com/feiyutech>

<http://www.twitter.com/feiyutech>

Specifications

Max. Tilt Range: 230°

Max. Roll Range: 306°

Max. Pan Range: 360°

Tilt Follow Speed: 2°/s ~ 75°/s

Pan Follow Speed: 3°/s ~ 150°/s

Theoretical Battery Life: 12h (well-balanced)

Weight: 1078g

Payload Capability: 2200g (well-balanced)

Compatible Cameras*: Canon, SONY, Panasonic and etc.

* Please download the detailed manual for the specific compatible camera and lens.

Scan the QR code to get the latest user manual or download it from the official website



<https://www.feiyu-tech.com/ak2000c/>

Overview

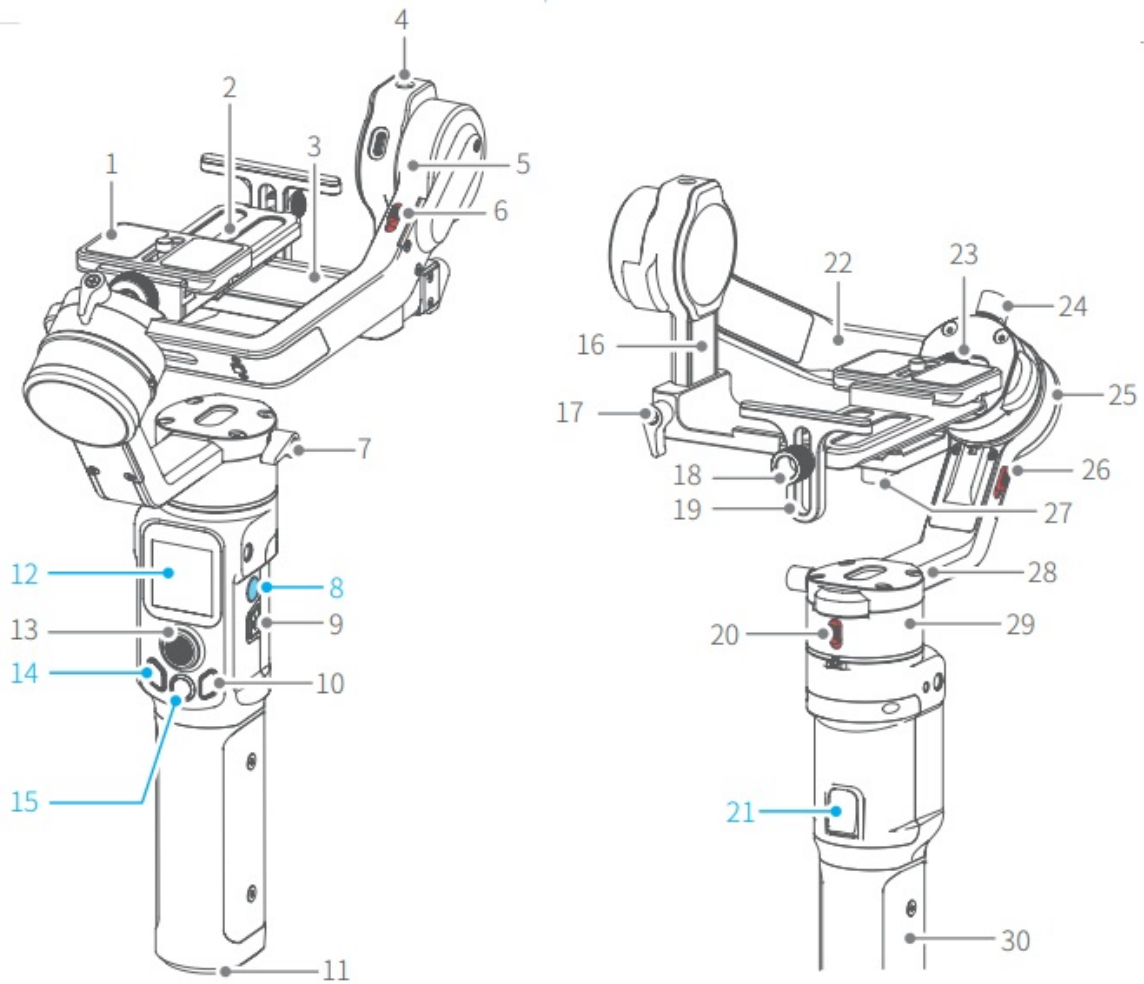

1. Arca quick release plate 2. Quick release plate 3. Fixed plate 4. 1/4 inch thread hole 5. Tilt axis 6. Tilt axis position lock 7. Vertical arm lock screw 8. Power button ·Long press: power on/off ·Control the touch screen: Single tap: lock/unlock screen/ return to homepage ·Double tap: standby mode (single tap at standby mode: to wake up the gimbal) 9. USB-C port 10. Function button ·Single tap: switch betw een video/photo mode	11. 1/4 inch thread hole 3/8 inch thread hole 12. Touch screen 13. Joystick 14. Mode button ·Single tap: switch between pan mode & lock mode ·Double tap: follow mode ·Triple tap: all follow mode 15. Shutter button ·Press halfway: focus ·Single tap: photo shooting/video recording ·Long press for 5 seconds: auto-burst shot (press again to quit) 16. Sliding arm 17. Sliding arm lock screw 18. Thumbscrew	19. Lens holder 20. Pan axis position l 21. Trigger button ·Press & hold: follow m ·Double tap: reset ·Triple tap: selfie mode turn 180° to shoot) 22. Cross arm 23. Arca quick release 24. Cross arm lock scr 25. Roll axis 26. Roll axis position l 27. Quick release plat 28. Vertical arm 29. Pan axis 30. Handle (built-in ba
---	---	---

* This product does not include the camera.

Disclaimer

Thanks for using the FeiyuTech product. The information in this document affects your safety and your legal rights and responsibilities. Read the entire document carefully to ensure proper configuration before use. Failure to read and follow instructions and warnings in this document may result in serious injury to yourself or others, or damage to your products, or damage to other objects in the vicinity.

By using this product, you hereby signify that you have read this disclaimer and warning carefully and that you understand and agree to abide by the terms and conditions herein. You agree that you are solely responsible for your own conduct while using this product, and for any consequences thereof. You agree to use this product only for purposes that are proper and in accordance with all applicable laws, rules, and regulations, and all terms, precautions, practices, policies, and guidelines FeiyuTech has made and may make available. FeiyuTech accepts no liability for damage, injury, or any legal responsibility incurred directly or indirectly from the use of the product. FeiyuTech will not provide any service for any product obtained from abnormal channels.

Notice

1. Make sure motor spinning is not blocked by external force when the product is power on.
2. The product DO NOT contact water or other liquid if the product is not marked waterproof or splash-proof.
Waterproof and splash-proof products DO NOT contact seawater or other corrosive liquid.
3. DO NOT disassembly the product except marked detachable. It need send to FeiyuTech after-sales or authorized service center to fix it if you accidentally disassemble it and cause abnormal work. The relevant costs are borne by the user.
4. Prolonged continuous operation may cause the product surface temperature to rise, please operate carefully.
5. DO NOT drop or strike the product. If the product is abnormal, contact FeiyuTech after-sales support.

Storage and Maintenance

1. Keep the product out of the reach of children and pets.

2. DO NOT leave the product near heat sources such as a furnace or heater. DO NOT leave the product inside of a vehicle on hot days.
3. Please storage the product in a dry environment.
4. DO NOT overcharge or overuse the battery, otherwise, it will cause damage to the battery core.
5. Never use the product when the temperature is too high or too low.

FeiyuTech Global Service Center

United Kingdom
Technical Support:

 0845 8623088

 feiyutech-support@lencarta.com

 Mondy-Friday
10:00-17:00
(UTC/GMT±0)



Guilin Feiyu Technology Incorporated Company
For more information, please visit our official website

www.feiyu-tech.com

E-mail: service@feiyu-tech.com



Tel: +86 773 2320865

Due to software and hardware improvements, your actual product might differ from the descriptions and pictures in this user manual. You can get the latest user manual from the official website.

Documents / Resources

	FeiyuTech AK2000C 3-Axis Stabilized Handheld Gimbal for Camera [pdf] User Guide AK2000C, 3-Axis Stabilized Handheld Gimbal for Camera
---	--

References

-  [Turner Rooms for Rent](#)
-  [FeiyuTech - Official Website](#)
-  [AK2000C](#)