



Feiyu Technology Vcam3S Remote Control Handle User Guide

[Home](#) » [Feiyu Technology](#) » Feiyu Technology Vcam3S Remote Control Handle User Guide 

Feiyu Technology Vcam3S Remote Control Handle User Guide



Contents

- 1 [Connection](#)
- 2 [Overview](#)
- 3 [Start to Use](#)
 - 3.1 [Charging](#)
- 4 [Button Operations](#)
- 5 [Specifications](#)
- 6 [FCC regulatory conformance](#)
- 7 [Documents / Resources](#)
 - 7.1 [References](#)
- 8 [Related Posts](#)

Connection

USB-C connection

Put the dovetail slot which at the button of Feiyu Pocket 3 stabilized camera aim to the convex slot of remote handle, and slide in along the slot to connect the USB-C port. Then users can control the camera through the remote handle after power on.

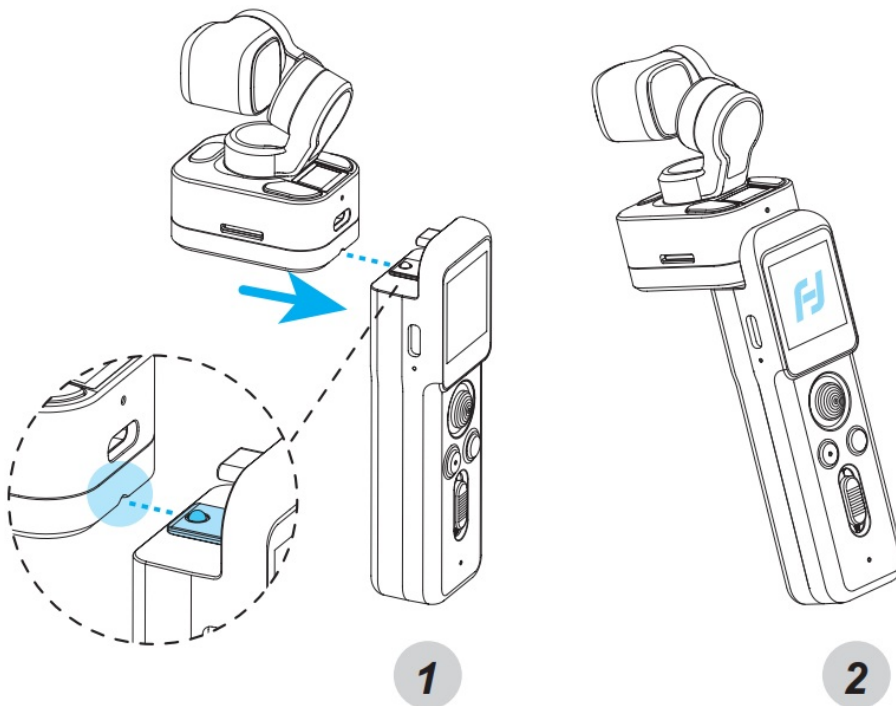

Bluetooth connection

Before using for the first time, please pair the remote handle with camera. Connect the remote handle with camera through USB-C port, and they will be paired automatically, after power on.

After they are paired successfully, detach the remote handle and the stabilized camera, then the remote handle can control the camera wirelessly.

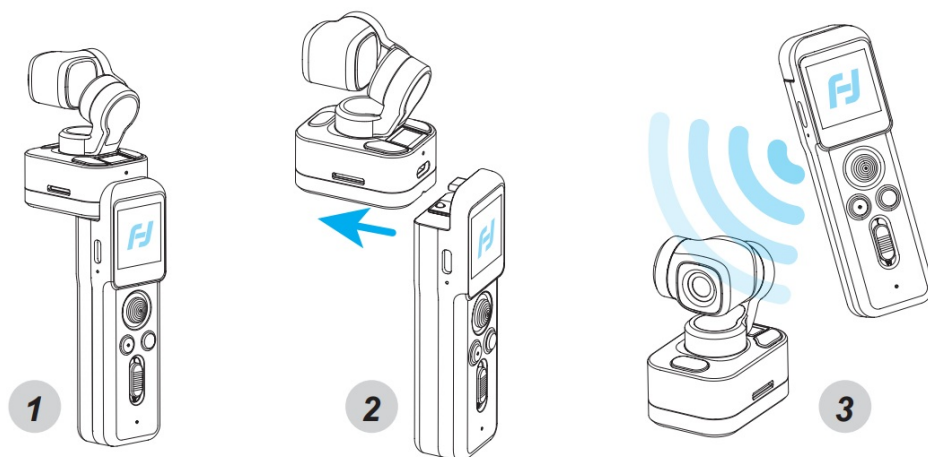

Overview

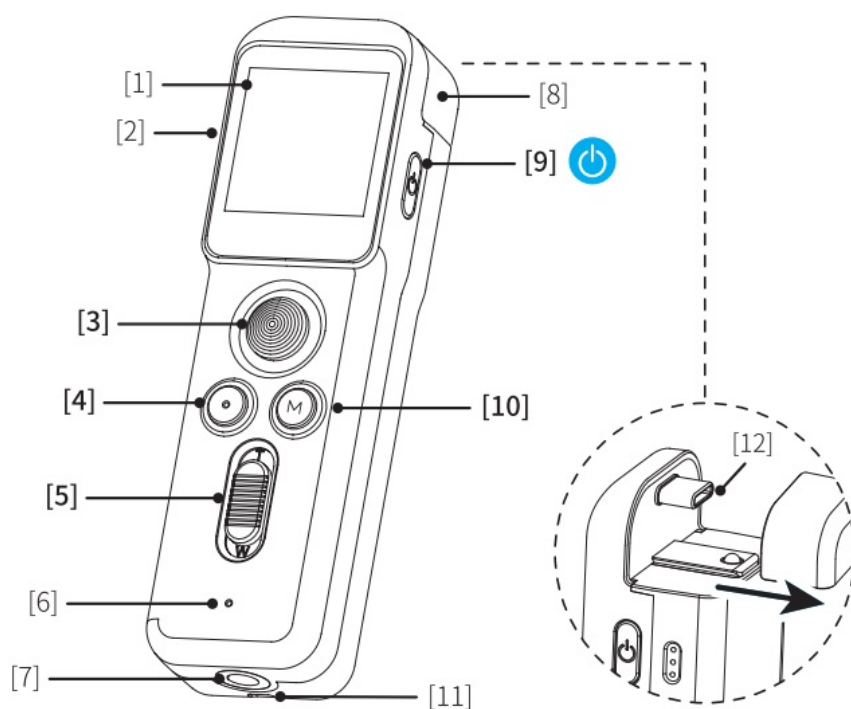



1. Touch screen
2. USB-C charging port
3. Joystick
4. Shutter button
5. Zoom button
6. Microphone
7. 1/4 inch thread Hole
8. USB-C port cover
9. Power button
10. Gimbal mode button
11. Wrist strap Hole
12. Gimbal connecting plug

Start to Use

Charging

Connect USB-C cable with charging port to charge remote handle.

We recommend that you charge your handle at least once a month.

Charging Status	While Working (Screen status)	While OFF (Indicator status)
Charging	 Display	Red light is on
Complete	 Disappear	Green light is on

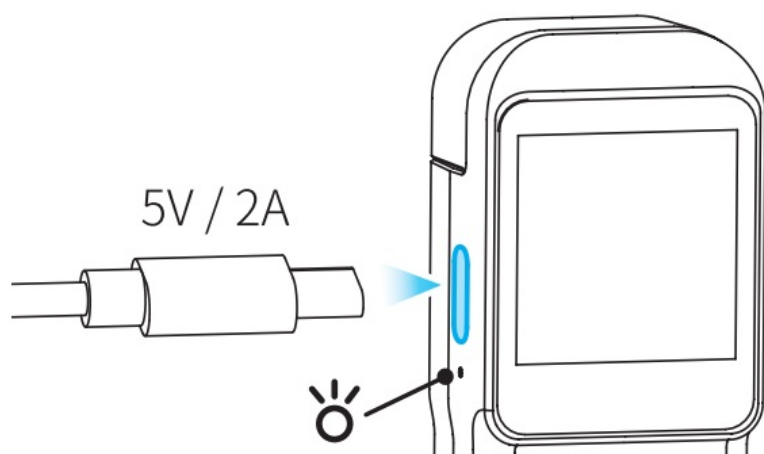

Button Operations

Power Button

Long press for 1s: Power ON/OFF

Single tap:

1. Switch among video/ Photo mode/ Recently used function
2. Return to the previous menu

Joystick

Push: Control the movement of the tilt and pan axes

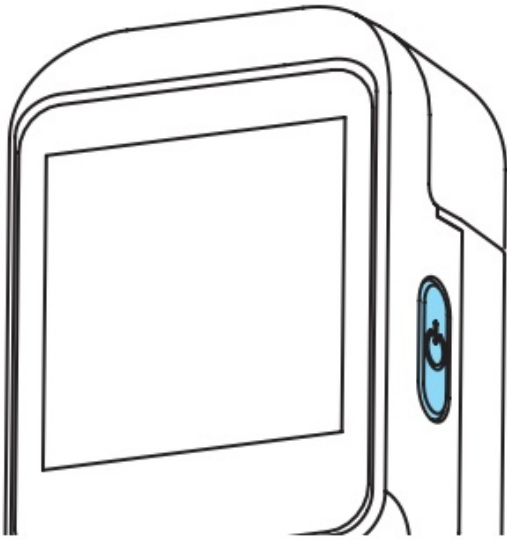

Joystick

Push: Control the movement of the tilt and pan axes.

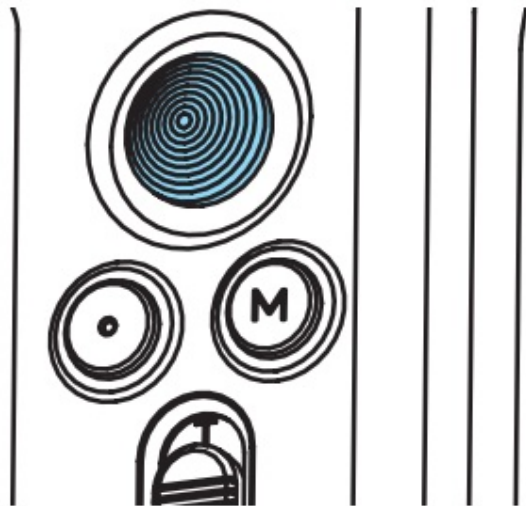

Gimbal mode button

Single tap: Follow mode/All follow mode/Pan mode (Switch in turn)

Double tap: Recenter

Triple tap: Enter/exit selfie mode

Press and hold: Enter lock mode

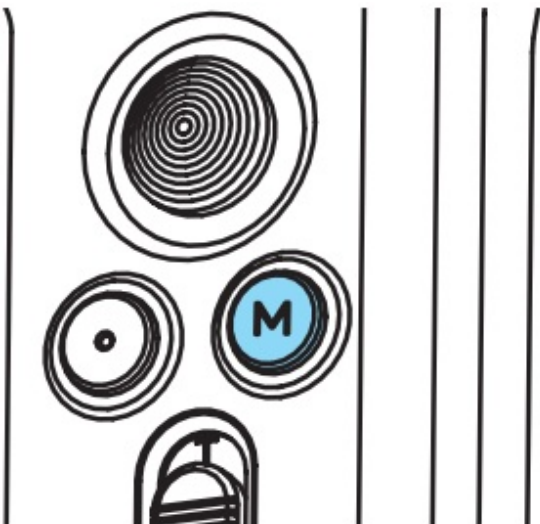

Shutter Button

Single tap: Start/stop recording/Take photo/ Return to the home page.

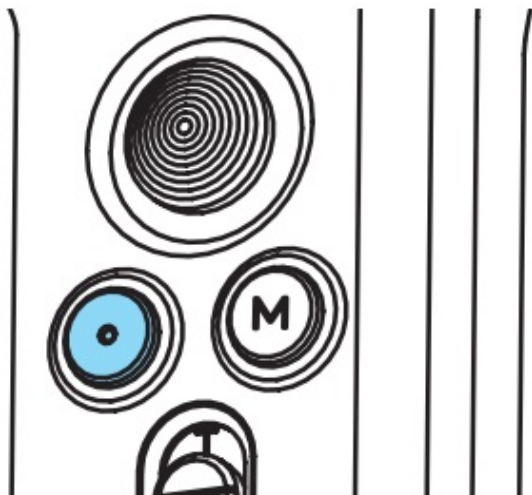

Zoom button

Slide up (T): z00min

Slide down(W): zoom out

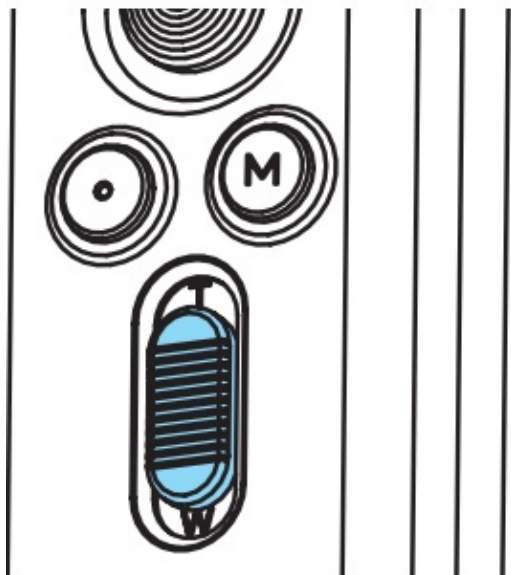

Specifications

Product name: Remote Handle for Feiyu Pocket 3

Product model: FeiyuVCAM3SRH

Battery Capacity: 750mAh

Charging Time: 1.2h

Weight: 73g

Product Size: 105.3*30.8*23.1mm

List :Remote Handle x 1, USB-C Cable x 1, Portable bag x 1, Wrist strap x 1, Manual x 1

FCC regulatory conformance

This device complies with Part 15 of the FCC Rules. Operation is subject to the following two conditions:

1. This device may not cause harmful interference
2. This device must accept any interference received, including interference that may cause undesired operation.

NOTE

This equipment has been tested and found to comply with the limits for a Class B digital device, pursuant to part 15 of the FCC Rules. These limits are designed to provide reasonable protection against harmful interference in a residential installation.

This equipment generates uses and can radiate radio frequency energy and, if not installed and used in accordance with the instructions, may cause harmful interference to radio communications. However, there is no guarantee that interference will not occur in a particular installation. If this equipment does cause harmful interference to radio or television reception, which can be determined by turning the equipment off and on, the user is encouraged to try to correct the interference by one or more of the following measures:

- Reorient or relocate the receiving antenna
- Increase the separation between the equipment and receiver
- Connect the equipment into an outlet on a circuit different from that to which the receiver is connected.
- Consult the dealer or an experienced radio/TV technician for help.

NOTE

The manufacturer is not responsible for any radio or TV interference caused by unauthorized modifications to this equipment. Such modifications could void the user's authority to operate the equipment.

RF Exposure

The SAR limit of USA (FCC) is 4.0 W/Kg averaged over ten gram of tissue. Device has also been tested against this SAR limit, the testing distance of limbs is 0mm.

Guilin Feiyu Technology Incorporated
Company

www.feiyu-tech.com

support@feiyu-tech.com

+86 773-2320865



Documents / Resources

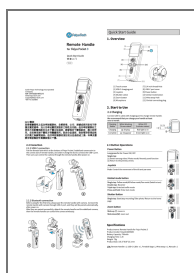

[Feiyu Technology Vcam3S Remote Control Handle](#) [pdf] User Guide

Vcam3S Remote Control Handle, Vcam3S, Remote Control Handle, Control Handle, Handle

References

- [User Manual](#)

[Manuals+](#), [Privacy Policy](#)