

Feiyu Technology VB4 Tracking Module



Feiyu Technology VB4 Tracking Module User Guide

[Home](#) » [Feiyu Technology](#) » Feiyu Technology VB4 Tracking Module User Guide 

Contents

- 1 Feiyu Technology VB4 Tracking Module
- 2 Product Usage Instructions
- 3 Overview
- 4 Quick Experience
- 5 Charging
- 6 Landscape & Portrait Mode Switching
- 7 Tripod
- 8 Extend and Reset the Handle
- 9 Connection
- 10 Common Operation
- 11 Indicator
- 12 Specifications
- 13 Storage and Maintenance
- 14 FCC regulatory conformance
- 15 Warranty Card
- 16 Documents / Resources
 - 16.1 References



Feiyu Technology VB4 Tracking Module



Specifications:

- **Model:** VB 4
- **Version:** 1.0
- **Compatibility:** iOS 12.0 or above, Android 8.0 or above
- **Connectivity:** Bluetooth
- **Power Source:** USB-C cable

Product Usage Instructions

Overview

The product is a gimbal designed for smartphones to stabilize video recordings and enhance shooting capabilities.

Quick Experience Step 1: Unfold and Fold

- Unfold the gimbal to prepare for installation.
- Ensure the smartphone holder logo is upward and centred for proper alignment.
- Adjust the smartphone position if tilted to make it horizontal.

Smartphone Installation

It is recommended to remove the smartphone case before installation. Keep the smartphone holder centred and aligned with the logo facing upward.

Power ON/OFF/Standby

- Install your smartphone and balance the gimbal before powering it on.

- To power on/off, long press the power button and release it when you hear the tone.
- Double-tap the power button to enter standby mode; tap again to wake up.

Charging

Before first use, fully charge the battery using the provided USB-C cable.

Landscape & Portrait Mode Switching

To switch between landscape and portrait mode, double-click the M button or manually rotate the smartphone holder. Avoid counter-clockwise rotation in landscape mode and clockwise rotation in portrait mode.

Extend and Reset the Handle

To adjust the handle length, extend or reset by pulling out or pushing in the extendable rod respectively.

Tripod

The tripod can be installed at the bottom of the gimbal for additional stability based on shooting needs.

Connection

Bluetooth Connection

- To connect via Bluetooth, follow the instructions provided in the manual or Feiyu the u ON App.
- If unable to find Bluetooth, try resetting the connection as described in the manual.

App Connection

Download and install the Feiyu ON App to access additional features and functions.

FAQ:

- **Q: Can this gimbal be used with any smartphone?**

A: The gimbal is designed to be compatible with smartphones running iOS 12.0 or above and Android 8.0 or above.

- **Q: How do I reset the Bluetooth connection if I encounter issues?**

A: To reset the Bluetooth connection, shut down any related apps, move the joystick downward, and triple-tap the power button simultaneously. Reconnection may require a gimbal reboot.

Overview

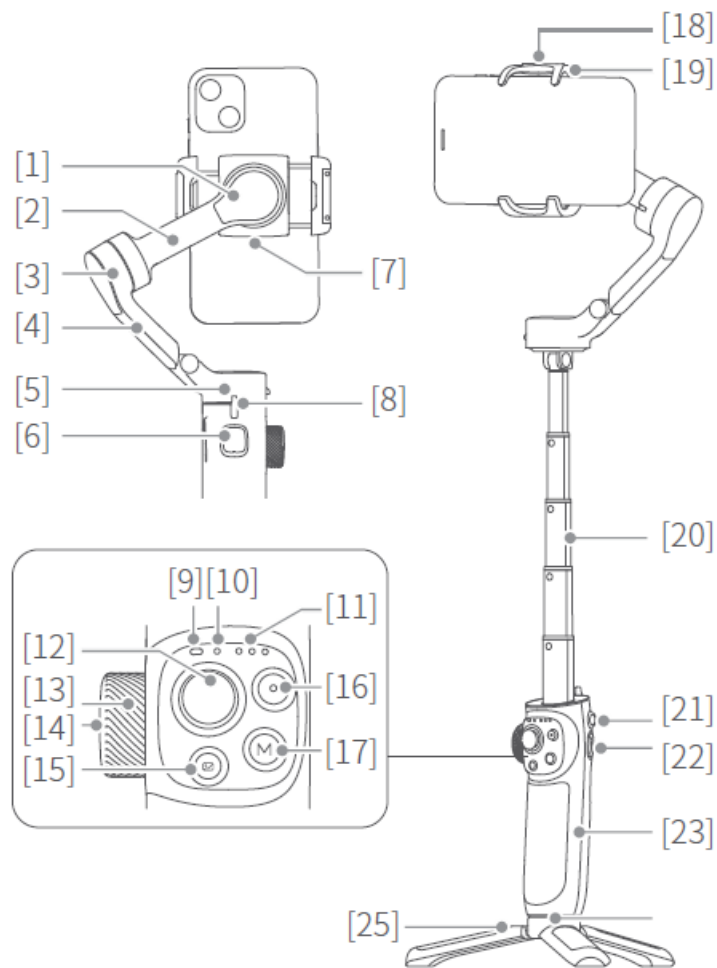

1. Roll axis
2. Cross arm
3. Tilt axis
4. Vertical arm
5. Pan axis
6. Trigger button (custom functions in App)
7. USB-C port for accessories
8. Limitation
9. Status/Battery indicator
10. Bluetooth indicator
11. Follow status indicator
12. Joystick
13. Dial
14. Dial function switching button
15. Album button
16. Shutter button
17. M button (custom functions in the App)
18. Magnetizable nameplate
19. Smartphone holder
20. Extendable rod
21. Power button
22. USB-C port

- 23. Handle (built-in battery)
- 24. 1/4 inch thread hole
- 25. Tripod

This product does NOT include a smartphone.

Quick Experience

Step 1: Unfold and fold

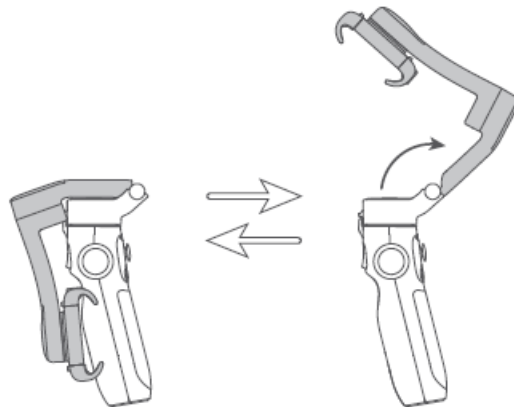

Step 2: Smartphone Installation

It is recommended to remove the smartphone case before installation.

- Keep the logo of the smartphone holder upward. Keep the smartphone holder in the centre.
- If the smartphone is tilted, please move the smartphone left or right to make it horizontal.

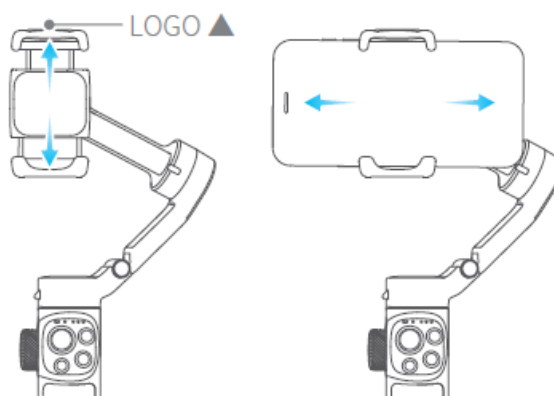

Step 3: Power ON/OFF/Standby

It is recommended to install your smartphone and balance the gimbal before powering on the gimbal.

- **Power ON/OFF:** Long press the power button and release it when you hear the tone.
- **Enter standby mode:** Double tap the power button to enter standby mode. Tap again to wake up.

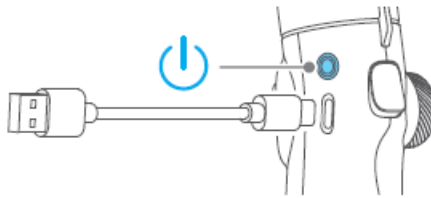

Charging

- Please fully charge the battery before powering on the gimbal for the first time.
- Connect the USB-C cable to charge.

Landscape & Portrait Mode Switching

- Double-click the M button or manually rotate the smartphone holder to switch between landscape and portrait mode.
- Do not make the anti-clockwise rotation in landscape mode,
- Do not make clockwise rotations in portrait mode.

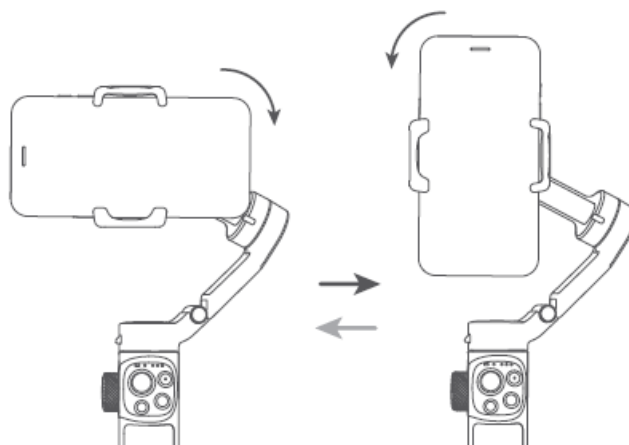

Tripod

The tripod is attached to the bottom of the gimbal in a rotating manner. According to the needs of shooting, choose whether to install it.

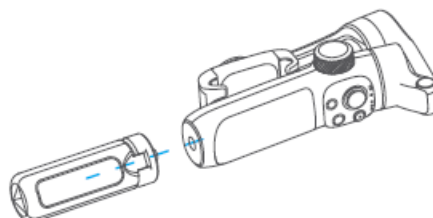

Extend and Reset the Handle

Hold the handle with one hand, and hold the bottom of the pan axis with the other hand.

- **Extending:** Pull the extendable rod out to a suitable length.

- **Reset:** Push the upper grip to make the extendable bar down to the handle part.

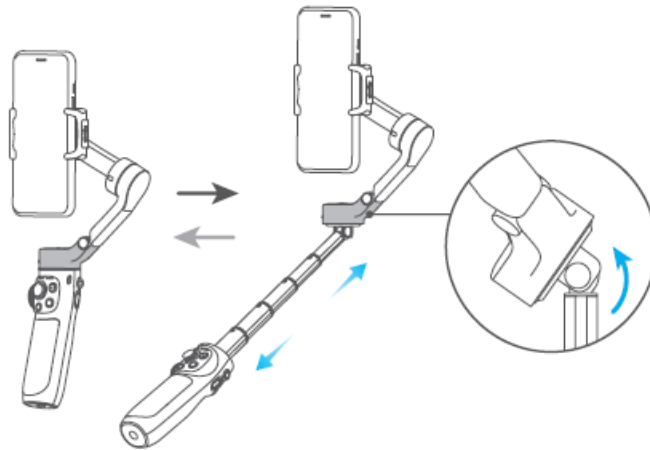

Connection

Bluetooth Connection Turn on the gimbal.

- **Method one:** Download and install the Feiyu ON App, run the App, follow the prompts to turn it on and connect with the Bluetooth.
- **Method two:** Turn on the smartphone Bluetooth, and connect the gimbal Bluetooth in the setting of the phone, e.g. FY_VB4_XX.

If fail to find the Bluetooth:

- **Method one:** Shut down the App in the background.
- **Method two:** Move downward the joystick and triple-tap the power button at the same time to reset the Bluetooth connection of the gimbal. (And the Bluetooth can only be reconnected after rebooting the gimbal)

App Connection

Download the Feiyu ON App

Scan the QR code to download the app, or search for “Feiyu ON” in the App Store or Google Play.

- Requires iOS 12.0 or above, Android 8.0 or above.



iOS



Android

Common Operation

1. **Basic:** VB 4 can achieve those functions after a balanced gimbal.
2. **Bluetooth:** A new available function achieved after connecting the smartphone via Bluetooth with the functions

in condition ① still available.

3. **App:** New available function achieved via Feiyu ON App with the functions in condition ①, ② still available.

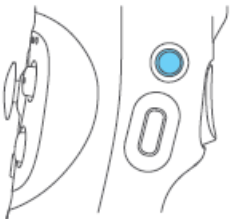
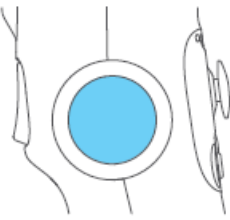
Button	Condition	Function
Power button 	Basic	Power off: <ul style="list-style-type: none">• Long press: power on• Single tap: check battery level Power on: <ul style="list-style-type: none">• Long press: power off• Double tap: enter standby mode (tap again to wake up)
	App	<ul style="list-style-type: none">• Single tap: enter/quit shortcut menu in App
Dial function switching button 	Basic	Switch the control object of dial: <ul style="list-style-type: none">• Single tap (tone: beep): When control zoom/focus: switch the control object of dial between <u>focus/zoom (default)</u> cyclically• When control axes: switch the control object of dial among <u>tilt/pan/roll (default) axis</u> cyclically• Long press (tone: beep beep): switch the dial between <u>control axes/control focus and zoom (default)</u>

Dial

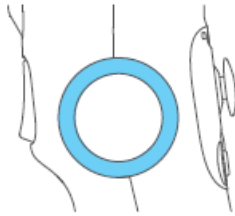

Basic

- Rotate:
When control focus/zoom:
control focus/zoom (default)
When control axes:
control the movement of the roll
(default)/tilt/pan axis

Basic

Control the movement of the tilt and pan axes

Joystick

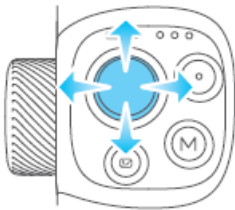

App

- Select setting option
- After enter album:
move to left to choose previous photo/video;
move to right to choose next photo/video;
move upward to play/pause;
move downward to play/pause

Shutter button

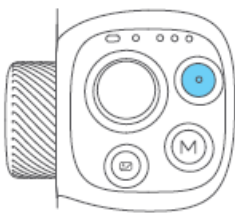

Bluetooth

- When original camera App is in photo/video mode:
- Press halfway: focus
- Single tap:
take photo, start/stop recording

App

- Press halfway: focus
- Single tap:
take photo, start/stop recording

M button

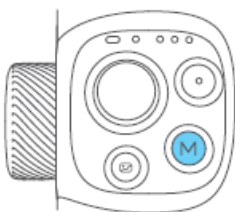

Basic

- Single tap:
switch among pan follow/
all follow/follow mode (default)
cyclically
- Double tap:
landscape and portrait mode
switching

App

Customize the function of single tap

Album button

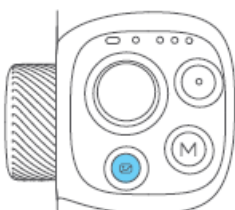

App

Single tap: enter/exit album

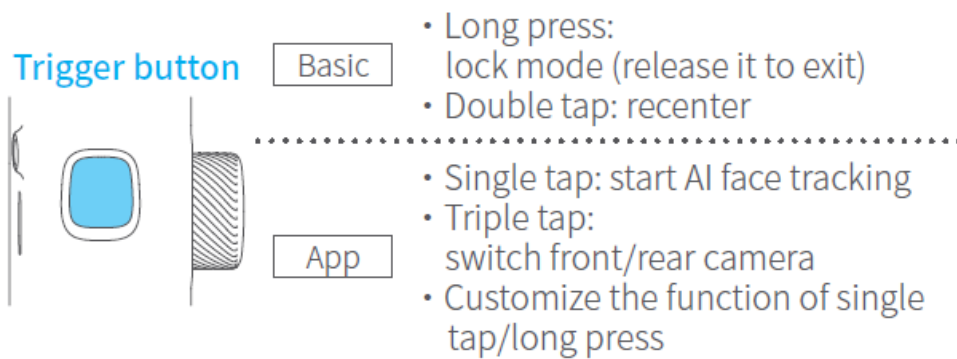

Indicator

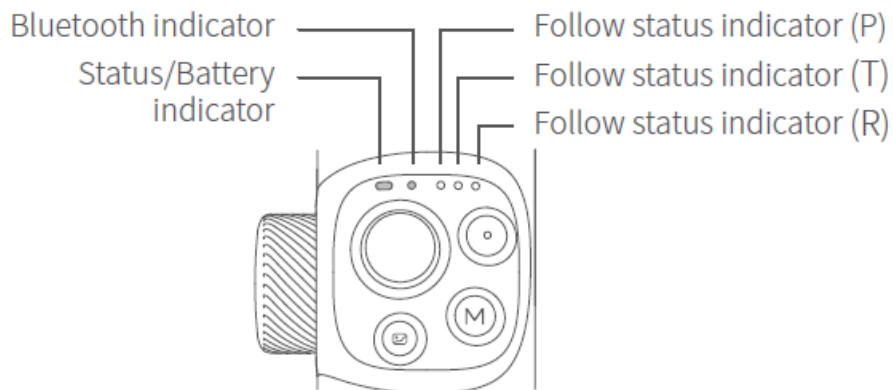

Status/Battery indicator

Indicator while charging:

Power off

- Green light stays on 100%
- Yellow light stays on 100%
- Green light stays on 70% ~ 100%
- Yellow light stays on 20% ~ 70%

Power on

- Flashes yellow and red alternately until turning off 2% ~ 20%
- Light off 2%

Indicator while using:

- Green light stays on 70% ~ 100%
- Blue light stays on 40% ~ 70%
- Red light stays on 20% ~ 40%
- The red light keeps flashing slowly 2% ~ 20%
- The red light keeps flashing quickly 2%

Bluetooth indicator

- Blue light stays on Bluetooth-connected
- Blue light flash Bluetooth disconnected/Bluetooth connected, App disconnected
- The blue light keeps flashing quickly Reset the Bluetooth connection of the gimbal

Follow status indicator







Follow status indicator	Descriptions
White lights turn on in turn then grow solid white	Powering on
 P T R	Pan follow
 P T R	Follow mode (default)
 P T R	All follow mode
 P T R	Lock mode

Figure:  Light on  Light off

Specifications

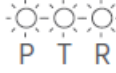
- **Product name:** Feiyu VB 4 3-Axis Handheld Gimbal for Smartphone
- **Product model:** FeiyuVB4
- **Max. Tilt Range:** $-20^{\circ} \sim +37^{\circ}$ ($\pm 3^{\circ}$)
- **Max. Roll Range:** $-60^{\circ} \sim +60^{\circ}$ ($\pm 3^{\circ}$)
- **Max. Pan Range:** $-80^{\circ} \sim +188^{\circ}$ ($\pm 3^{\circ}$)
- **Size:** About 98.5×159.5×52.8mm (folded)
- **Net gimbal Weight:** About 330g (not including tripod)
- **Battery:** 950mAh
- **Charging time:** ≤ 2.5 h
- **Battery Life:** ≤ 6.5 h (test in a lab environment with 205g load)
- **Payload Capability:** ≤ 260 g (after balancing)
- **Adapter smartphones:** iPhone & Android phones (the width of the phone ≤ 88 mm)

Packing list:

- Main body×1
- Tripod×1
- USB-C cable×1
- Portable bag×1
- Manual×1

Notice:

1. Make sure the motor spinning is not blocked by external force when the product is powered on.
2. The product DO NOT contact water or other liquid if the product is not marked waterproof or splash-proof.
Waterproof and splash-proof products DO NOT contact seawater or other corrosive liquid.
3. DO NOT disassemble the product except marked detachable. It needs to be sent to FeiyuTech after-sales or an authorized service centre to fix it if you accidentally disassemble it and cause abnormal work. The relevant costs are borne by the user.
4. Prolonged continuous operation may cause the product surface temperature to rise, please operate carefully.
5. DO NOT drop or strike the product. If the product is abnormal, contact FeiyuTech after-sales support.

Storage and Maintenance

1. Keep the product out of the reach of children and pets.
2. DO NOT leave the product near heat sources such as a furnace or heater. DO NOT leave the product inside of a vehicle on hot days.
3. Please store the product in a dry environment.
4. DO NOT overcharge or overuse the battery, otherwise it will cause damage to the battery core.
5. Never use the product when the temperature is too high or too low.

Official Social Media



Website



Facebook



Youtube



Twitter



Instagram

This document is subject to change without notice.



The latest user manual

FCC regulatory conformance

This device complies with Part 15 of the FCC Rules. Operation is subject to the following two conditions:

1. This device may not cause harmful interference.
2. This device must accept any interference received, including interference that may cause undesired operation.

NOTE:

This equipment has been tested and found to comply with the limits for a Class B digital device, under part 15 of the FCC Rules. These limits are designed to provide reasonable protection against harmful interference in a residential installation.

This equipment generates uses and can radiate radio frequency energy and, if not installed and used by the instructions, may cause harmful interference to radio communications. However, there is no guarantee that interference will not occur in a particular installation. If this equipment does cause harmful interference to radio or television reception, which can be determined by turning the equipment off and on, the user is encouraged to try to correct the interference by one or more of the following measures:

- Reorient or relocate the receiving antenna.
- Increase the separation between the equipment and the receiver.
- Connect the equipment to an outlet on a circuit different from that to which the receiver is connected.
- Consult the dealer or an experienced radio/TV technician for help.

NOTE:

The manufacturer is not responsible for any radio or TV interference caused by unauthorized modifications to this equipment. Such modifications could void the user's authority to operate the equipment.

RF Exposure:

This equipment complies with FCC radiation exposure limits set forth for an uncontrolled environment.

Warranty Card

- Product Model
- Serial Number
- Purchase Date
- Customer Name
- Customer Tel
- Customer Email

Warranty:

1. Within one year from the date of selling, the product is malfunctioning under normal due to non-artificial reasons.
2. The malfunction of the product is not caused by artificial reasons such as unauthorized disassembly conversion or addition.
3. The buyer can provide the certificate of maintenance service: the warranty card, legitimate receipts, invoices, or screenshots of purchase.

The following cases are not included under the warranty:

1. Unable to provide legitimate receipt and warranty card with buyer's info.
2. The damage caused by human or irresistible factors. For more details about the after-sales policy, please refer to the after-sales page on the website: <https://www.feiyu-tech.com/service>.
 - Our company reserves the right to the final interpretation of the above-mentioned after-sales terms and limitations.

Documents / Resources

	Feiyu Technology VB4 Tracking Module [pdf] User Guide VB4 Tracking Module, VB4, Tracking Module, Module
---	--

References

- [FeiyuTech - Official Website](#)
- [-](#)
- [After sales service--FeiyuTech](#)
- [User Manual](#)

[Manuals+](#), [Privacy Policy](#)

This website is an independent publication and is neither affiliated with nor endorsed by any of the trademark owners. The "Bluetooth®" word mark and logos are registered trademarks owned by Bluetooth SIG, Inc. The "Wi-Fi®" word mark and logos are registered trademarks owned by the Wi-Fi Alliance. Any use of these marks on this website does not imply any affiliation with or endorsement.