



# Features P 203 Audio Remote Controls Instruction Manual

[Home](#) » [Features](#) » **Features P 203 Audio Remote Controls Instruction Manual** 

## Contents

- 1 Features P 203 Audio Remote Controls Instruction Manual
- 2 Features (P 203)
- 3 Audio System
- 4 USB Ports
- 5 1USB Ports
- 6 USB charge
- 7 USB Port (2.5A)
- 8 Audio Remote Controls
- 9 Models with head-up display
- 10 Audio Remote Controls
- 11 Models with head-up display
- 12 Roll up or down:
- 13 Audio System Basic Operation
- 14 1Audio System Basic Operation
- 15 Read More About This Manual & Download PDF:
- 16 Documents / Resources
- 17 Related Posts

## Features P 203 Audio Remote Controls Instruction Manual



### Features (P 203)

Audio Remote Controls

➔ P. 208

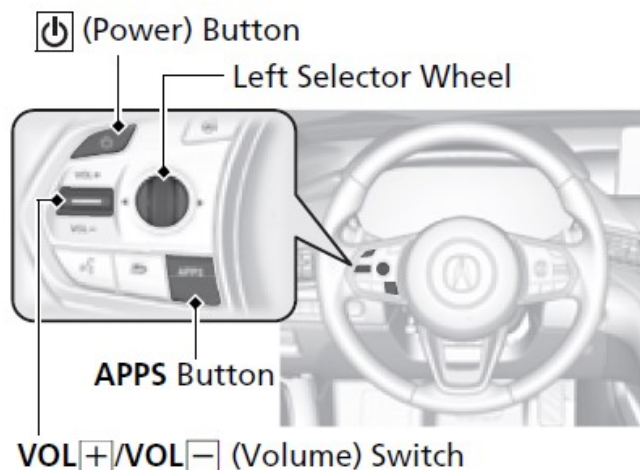

- VOL(+)/VOL(-) (Volume) Switch Press up or down to adjust the volume.

- (Power)  Button Press to turn the audio system on and off.
- Left Selector Wheel

When selecting the audio mode Press the APPS button, then roll up or down to select an item on the multiinformation display or the head-up display\*, and then press the left selector wheel.

Roll up or down: To cycle through the following items, roll up or down and then press the left selector wheel:

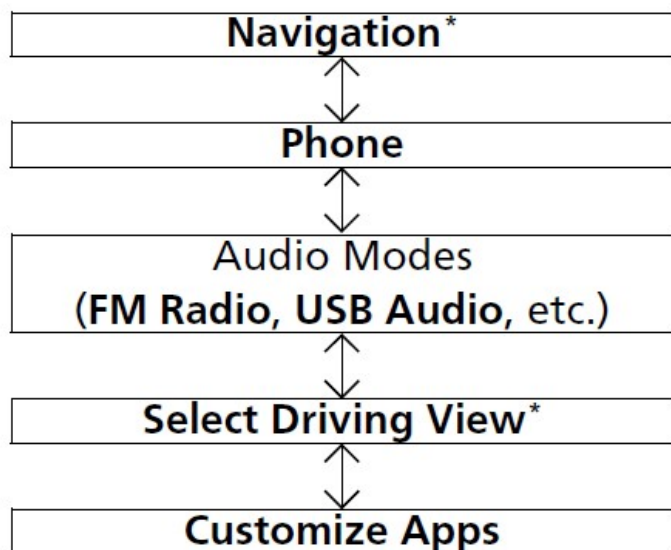

You can add or remove the items and change their order on multi-information display or the head-up display\*.

- When listening to the radio Move to a side to change the favorite radio station or channel.
- When listening to an iPod, USB flash drive, Bluetooth® Audio, or Smartphone Connection Move to a side to skip to the beginning of the next song or return to the beginning of the current or previous song.

## Audio System

For navigation system operation ( ) See the Navigation System Manual

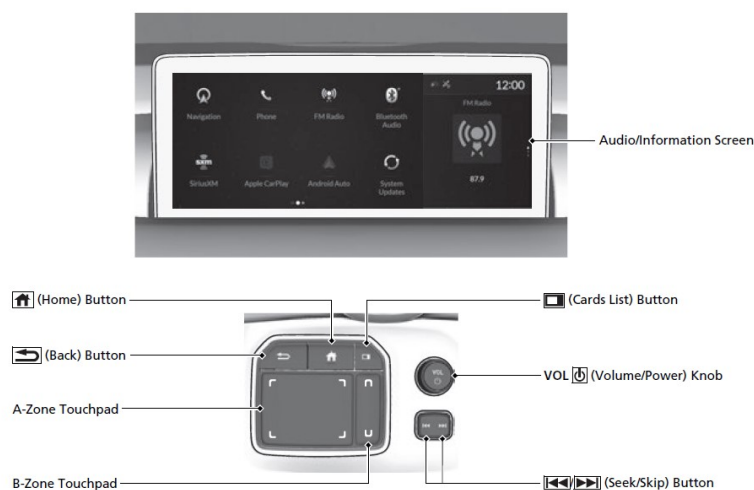

## USB Ports

Install the device USB connector or the USB flash drive in the USB port.

### ■ In the console compartment

The USB port (2.5A) is for charging devices, playing audio files and connecting compatible phones with Apple CarPlay or

Android Auto. To prevent any potential issues, be sure to use an Apple MFi Certified Lightning Connector for Apple CarPlay, and for

Android Auto, the USB cables should be certified by USB-IF to be compliant with USB 2.0 Standard.

The USB port (2.5A) is only for charging devices.

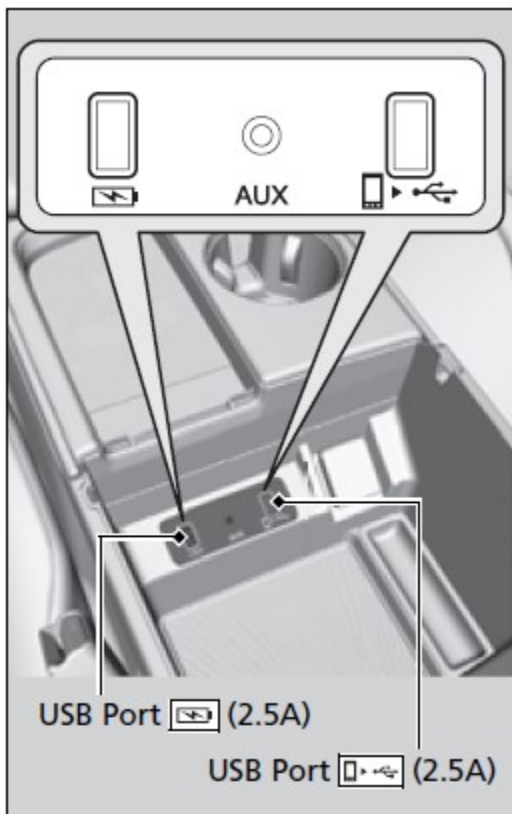

## 1USB Ports

- Do not leave the iPod or USB flash drive in the vehicle. Direct sunlight and high temperatures may damage it.
- We recommend that you use a USB cable if you are attaching a USB flash drive to the USB port.
- Do not connect the iPod or USB flash drive using a hub.
- Do not use a device such as a card reader or hard disk drive, as the device or your files may be damaged.
- We recommend backing up your data before using the device in your vehicle.
- Displayed messages may vary depending on the device model and software version.

## USB charge

The USB port can supply up to 2.5A of power. It does not output 2.5A unless the device requests.

For amperage details, read the operating manual of the device that needs to be charged.

Under certain conditions, a device connected to the port may generate noise in the radio you are listening to.

## USB Port (2.5A)

This port is for battery charge only. You cannot play music even if you have connected a music player to the port.

## Audio Remote Controls

Allow you to operate the audio system while driving. The information is shown on the multi-information display or head-up display\*.

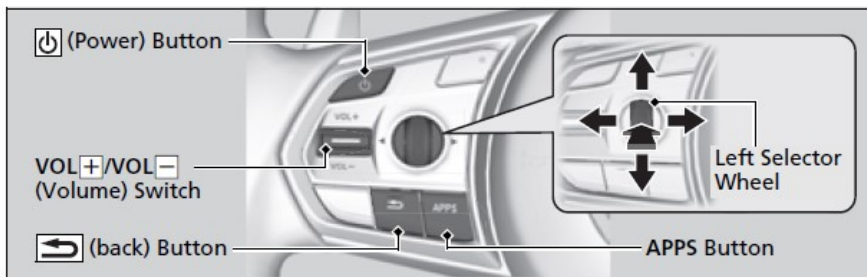

#### VOL(+)/VOL(- (Volume) Switch

Press Up: To increase the volume.

Press Down: To decrease the volume. (Power) Button

Press to turn the audio system on and off.

#### Left Selector Wheel

- When selecting the audio mode

Press the APPS button, then roll up or down to select an item on the multiinformation display or head-up display\*, and then press the left selector wheel.

### Models with head-up display

Move the left selector wheel to the right to display the Recents list, then scroll to an item selected in the past and press the wheel.

### Audio Remote Controls

Some modes appear only when an appropriate device or medium is used.

Depending on the Bluetooth® device you connect, some functions may not be available.

Press the (back) button for the multiinformation display or head-up display\* to go back to the previous screen or cancel a command.

Press the APPS button to go back to the menu screen of the multi-information display or head-up display\*

### Models with head-up display

Recents list is available when the following audio mode is selected.

- FM Radio
- AM Radio
- SiriusXM
- USB Audio

### Roll up or down:

To cycle through the modes, roll up or down and then press the left selector wheel:

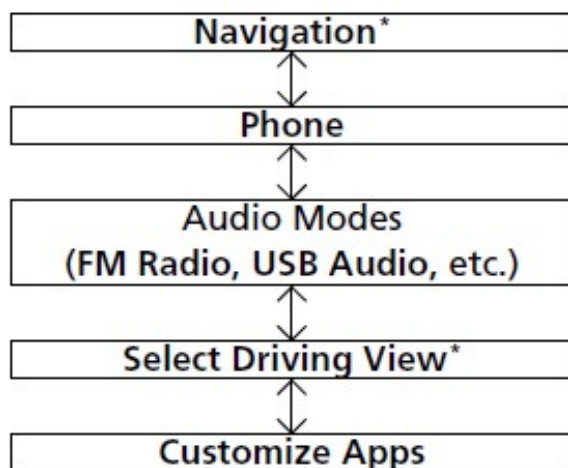

After an audio mode is selected, the left selector wheel can be operated for the following functions.

- When listening to the radio  
Move to the right: To select the next favorite radio station or channel.  
Move to the left: To select the previous favorite radio station or channel.
- When listening to an iPod, USB flash drive, Bluetooth® Audio, or Smartphone Connection  
Move to the right: To skip to the next song.  
Move to the left: To go back to the beginning of the current or previous song.

## Audio System Basic Operation

You can use the audio system for 30 minutes when the power mode is set to VEHICLE OFF (LOCK) with the driver's door closed. The system will then turn off automatically. If you want to keep using it, we recommend that you turn the power mode to ACCESSORY or ON.



VOL (Volume/Power) Knob: Push to turn the audio system on and off. Turn to adjust the volume when the audio system is on. / (Seek/Skip) Button: Press to change the station, channel, song or file.

(Back) Button: Press to go back to the previous display.

(Home) Button: Press to go to the home screen.

(Cards List) Button: Press to display the cards list of the B-zone on the audio/ information screen. 2 B-Zone P. 216

A-Zone Touchpad: Click or swipe the pad with your finger or move your finger along the pad to operate the A-zone on the audio/information screen.

B-Zone Touchpad: Click or swipe the pad with your finger to operate the B-zone on the audio/information screen.

## 1 Audio System Basic Operation

True Touchpad Interface  
2 True Touchpad Interface P. 211 A-Zone  
2 A-Zone P. 214  
B-Zone  
2 B-Zone P. 216

***Read More About This Manual & Download PDF:***

**Documents / Resources**

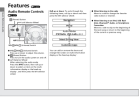
	<p><b><a href="#">Features P 203 Audio Remote Controls</a></b> [pdf] Instruction Manual P 203 Audio Remote Controls, P 203, Audio Remote Controls, Remote Controls</p>
---	--