

# FAQs How to Connect a Mobile for Wireless Music User Manual

[Home](#) » [FAQs](#) » FAQs How to Connect a Mobile for Wireless Music User Manual 

## Contents

- 1 [FAQs How to Connect a Mobile for Wireless Music](#)
- 2 [Documents / Resources](#)
- 3 [Related Posts](#)

# FAQ

## FAQs How to Connect a Mobile for Wireless Music

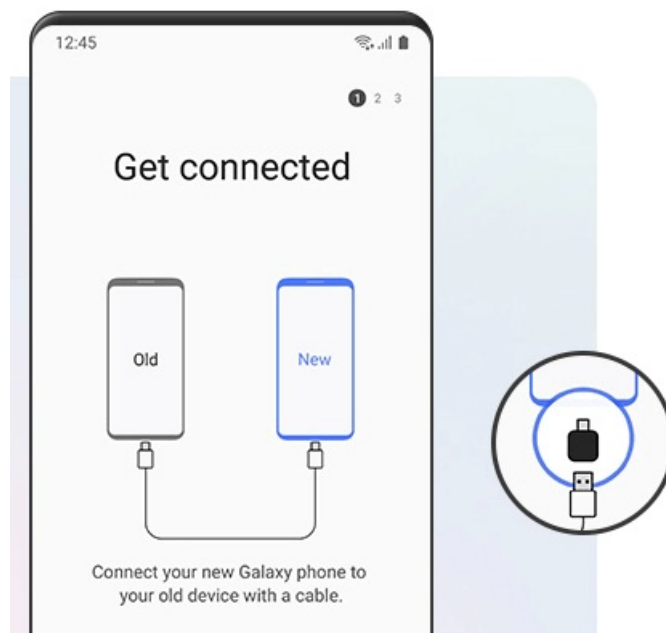

- Q: How to connect a mobile for wireless music ?

- A: When the speaker is in wireless mode, search for nearby BT devices in your mobile. Tap the name “ZEB-COUNTY” and connect it. (Password – 0000, if prompted)
- Q: What are the different modes in ZEB-COUNTY?  
A: Wireless BT/Micro SD card/USB/FM/AUX mode.
  - Q: How to tune FM channels?  
A: Switch the speaker to FM mode. Connect the micro USB cable to the micro USB port of the speaker and leave the other end free (this cable will act as the FM antenna). Press the Play/Pause button for once, to start scanning the FM channels.  
Once the scanning is done, the speaker will start playing from the first saved channel. To change the channels you can use +/- buttons.
  - Q: What are the different LED indicators?  
A: Red LED glowing – Charging Red LED turns OFF – Fully charged
  - Q: What is the operating range of the ZEB-COUNTY in wireless mode?  
A: 8-10 meters.
  - Q: How to decrease/increase the volume level?  
A: Press and hold “-/+” to decrease/increase the volume level respectively.
  - Q: What is the maximum capacity of USB/mSD card that ZEB-COUNTY can support?  
A: 32GB.
  - Q: Does the speaker has call function?  
A: Yes
  - Q: What is the charging voltage?  
A: DC 5V with micro USB cable.
  - Q: How to use USB/mSD card?  
A: Once a USB/mSD card is inserted into the speaker’s USB/mSD card slot, it will detect the USB/mSD card automatically start playing the songs from it.

## Documents / Resources

	<p><a href="#">FAQs How to Connect a Mobile for Wireless Music</a> [pdf] User Manual</p> <p>How to Connect a Mobile for Wireless Music</p>
---	--