

Fanvil
Fanvil A12V IP
Video Intercom



Fanvil A12V IP Video Intercom Installation Guide

[Home](#) » [Fanvil](#) » Fanvil A12V IP Video Intercom Installation Guide 

Contents

- [1 Fanvil A12V IP Video Intercom](#)
- [2 Package Contents](#)
- [3 Physical Specification](#)
- [4 Installation diagram](#)
- [5 Searching IP address](#)
- [6 Intercom configuration](#)
- [7 Documents / Resources](#)
 - [7.1 References](#)



Fanvil A12V IP Video Intercom



Package Contents



A12 Audio Intercom



Tools:
lineout cable ×1
Jumper cap ×1



Quick Installation
Guide

Physical Specification

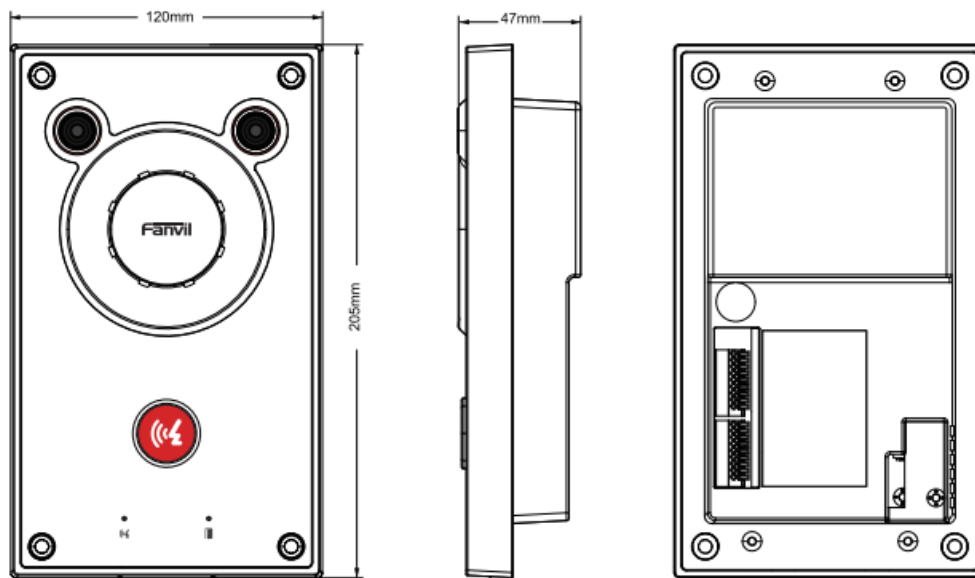

Dimensions: | 205 x 120 x 47 (mm)

Dimensions

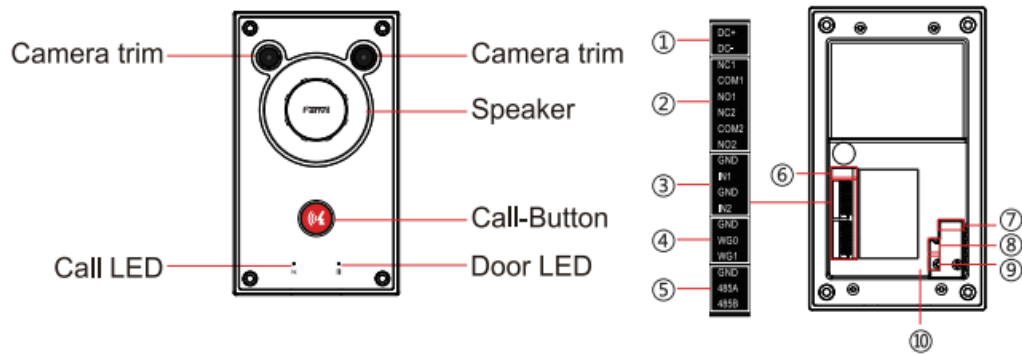

Interface description

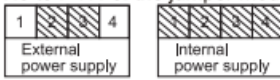
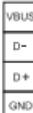

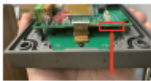
Serial number	Description	Wiring port description
①	Power port: DC12V~24V/2A input	DC +, DC-
②	Two groups of short-circuit output control ports: used to control electric locks, alarms, etc.	NC: Normally Close Contact COM: Common Contact NO: Normally Open Contact
③	Two groups of short-circuit input detection ports: for connecting switches, infrared probes, door magnets, vibration sensors and other input devices.	GND, IN
④	Wiegand port	GND WG0: Wiegand data0 WG1: Wiegand data1
⑤	RS485 port	GND, RS485A, RS485B
⑥	4pin Jumper module	Relay operating mode: External power supply (i.e. the relay does not supply external power): Connect PIN2 and PIN3 of the jumper module, and leave PIN1 and PIN4 in the air. (Default) Internal power supply (i.e. relay external power supply): Connect PIN1 to PIN2 and PIN3 to PIN4 of the jumper module. 
⑦	Ethernet port: standard RJ45 interface, 10/100M adaptive, it is recommended to use five or five types of network cable.	Support PoE 802.3 AT class 4
⑧	USB port	4pin, USB peripherals can be connected via a transfer cable 
⑨	Lineout port	2pin, can be connected through the cable external power amplifier, active speaker and other equipment. 
⑩	Micro SD card slot	SD cards up to 256GB can be attached. Note: The back cover should be removed before inserting the card 

Installation diagram

A12 series intercom has two types of accessories: WM612 wall-mounted bracket and EX612 flush-mounted bracket. You need to select the corresponding installation accessories before installation.

Mounting accessories are not included in the standard and need to be purchased separately!

WM612 Wall-mounted bracket

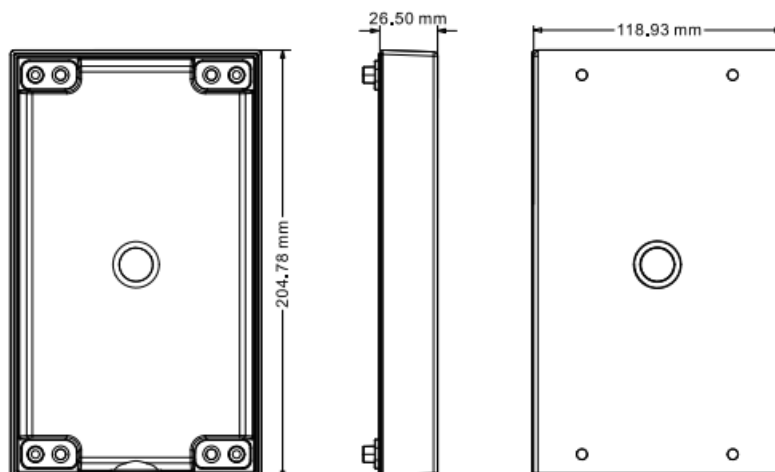

EX612 Flush-mounted bracket:

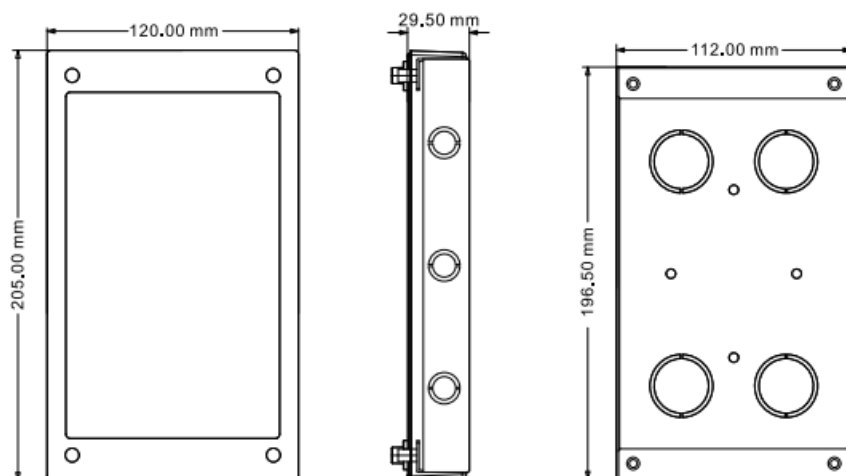

Wall-mounted installation:

1. Paste the installation drawing of the wall-mounted bracket on the wall, and then use the electric drill to make the corresponding hole position.

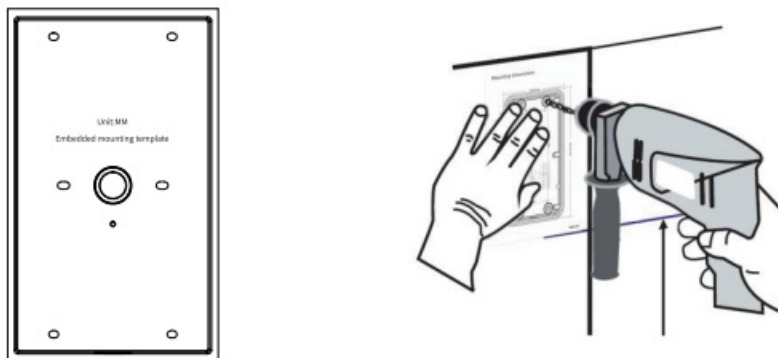

2. The white rubber was plugged into the wall and the wall-mounted bracket fixed with screws to the wall.

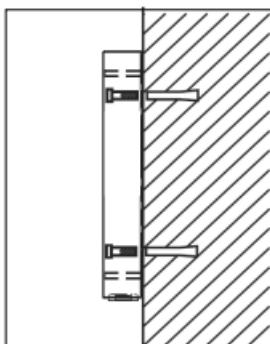

3. Fix the sealing silicone ring on the back of A 12 according to the hole position.

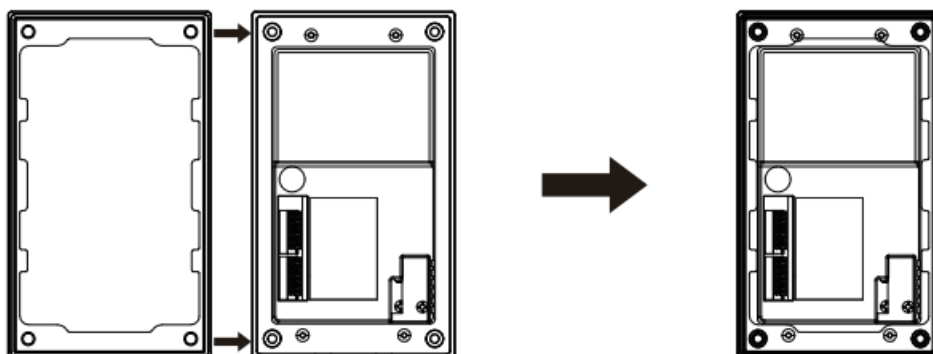

4. After connecting the power cables, network cables, and security interface cables, place the A 12 on the wall-mounted bracket.

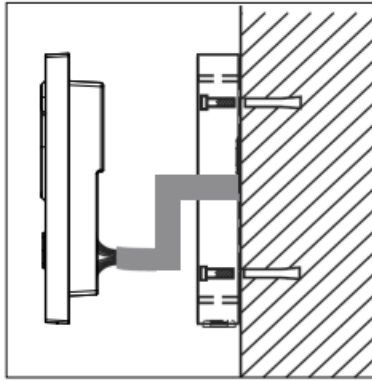

5. Power on the device, If it works normally, then use the screws to fix A12 to the wall-mounted bracket, and the installation is complete.

Flush-mounted installation:

1. Make a hole of the corresponding size on the wall (recommended size: the length range is 199-201 mm, the width range is 114-116mm, the depth range is 20-25mm), and paste the installation drawing of the flush-mounted bracket on the wall, and then use an electric drill to make the corresponding hole position.

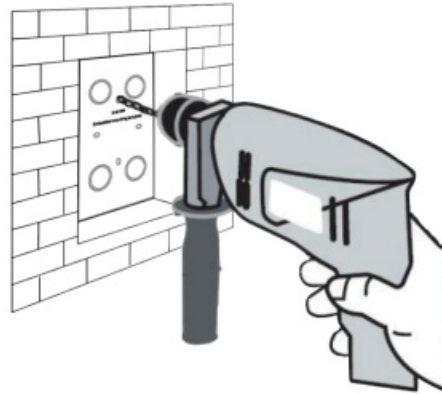
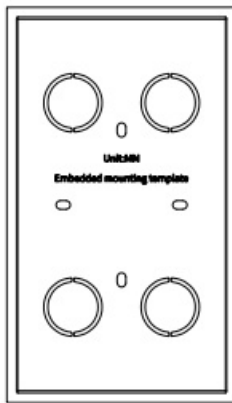

2. The white rubber plugged into the wall and the flush-mounted bracket fixed with screws to the wall, and insert the flush-mounted bracket cover plate stuck on the flush-mounted bracket.

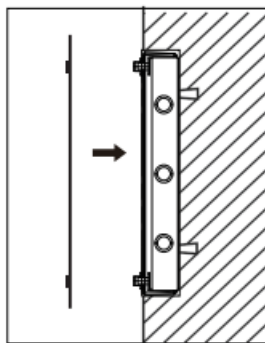

3. Fix the sealing silicone ring on the back of A12 according to the hole position.

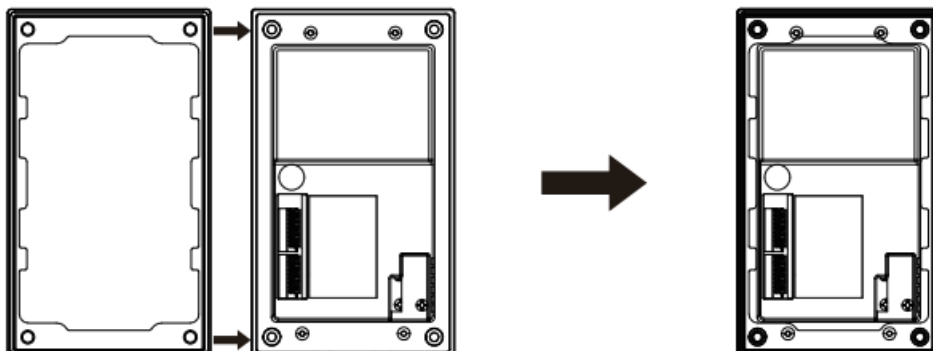

4. After connecting the power cables, network cables, and security interface cables, place the A12 on the flush-mounted bracket.

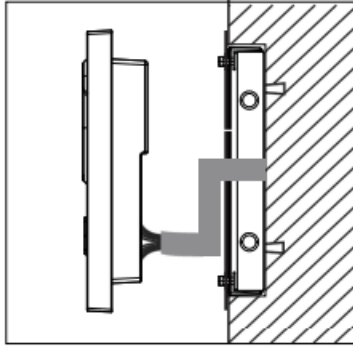

5. Power on the device, If it works normally, then use the screws to fix A 12 to the flushl-mounted bracket, and the installation is complete.

Searching IP address

There are two methods as shown below to search the device.

Methods 1:

The default WAN mode is DHCP, querying the IP address with the Device Manager: Download link for Device Manager:

<https://www.fanvil.com.cn/downloadfile.aspx?filepath=>

[https://www.fanvil.com.cn/upload/files/firmware/tools/20230919/DeviceManager_1.0.6\(Installation_free\).](https://www.fanvil.com.cn/upload/files/firmware/tools/20230919/DeviceManager_1.0.6(Installation_free).tar.gz&filename=DeviceManager_1.0.6(Installation_free).tar.gz)

[tar.gz&filename=DeviceManager_1.0.6\(Installation_free\).tar.gz](https://www.fanvil.com.cn/upload/files/firmware/tools/20230919/DeviceManager_1.0.6(Installation_free).tar.gz&filename=DeviceManager_1.0.6(Installation_free).tar.gz)

Method 2:

Press and hold the Call-Button for 3 seconds(after power-on for 30 seconds), and when the speaker beeps rapidly, press Call-Button again quickly, the beeps stop, the intercom will report the IP address by itself.

In addition, device provides the device surface Call-Button operation to switch IP address acquisition mode:

Press and hold the Call-Button for 3 seconds, and when the speaker beeps rapidly, and then press the Call-Button three times, after the success of the system automatically broadcasts the current IP address.

Intercom configuration

• Step 1: Log in the WEB admin interface of the device

- Input IP address (e.g.http://1172.18.26.7) into the address bar of the PC's web browser.
- The default user name and password are both admin.

• Step 2: Add SIP account

- (Line) » (SIP)
- Set the SIP server address, port, username, password and SIP user with assigned SIP account parameters. Select click to take effect.

• Step 3: Set the Intercom parameters

- (Intercom Settings) » (Media Settings) » (Media Settings) »Set the volume of the device » Click (Apply) to take effect.
- Speakerphone Volume: Set the speaker output volume.
- Hand-free mic Gain: Set the microphone volume.

• Step 4: Set the DSS key

- (Function Key) » (Function Key Settings) » Set speed dial parameters for DSS keys» Click (Apply) to take effect.

- Type: Memory Key
- Value: The DSS Key will dial to this Number 1
- Line: Working line.
- Subtype: Speed Dial
- **Step 5: Set the security function**
 - (Security Settings) » (Input Settings) / (Output Settings)
 - Two short circuits input and output configuration, trigger ring, tamper detection configuration.

Fanvil Technology Co., Ltd

Website: www.fanvil.com

Email: sales@fanvil.com

support@fanvil.com

Tel: +86-755-2640-2199

Fax: +86-755-2640-2618

Add: 10/F Block A, Dualshine Global Science Innovation Center, Honglang North 2nd Road, Bao'an District, Shenzhen, China

Documents / Resources



[Fanvil A12V IP Video Intercom](#) [pdf] Installation Guide
A12V IP Video Intercom, A12V, IP Video Intercom, Video Intercom

References

- [User Manual](#)

Manuals+, Privacy Policy

This website is an independent publication and is neither affiliated with nor endorsed by any of the trademark owners. The "Bluetooth®" word mark and logos are registered trademarks owned by Bluetooth SIG, Inc. The "Wi-Fi®" word mark and logos are registered trademarks owned by the Wi-Fi Alliance. Any use of these marks on this website does not imply any affiliation with or endorsement.