



fantech FKD-KD Inline Centrifugal Fans Instruction Manual

[Home](#) » [fantech](#) » fantech FKD-KD Inline Centrifugal Fans Instruction Manual 

fantech FKD-KD Inline Centrifugal Fans

**FKD 8XL / KD 8XL –
FKD 12XL / KD 12XL**

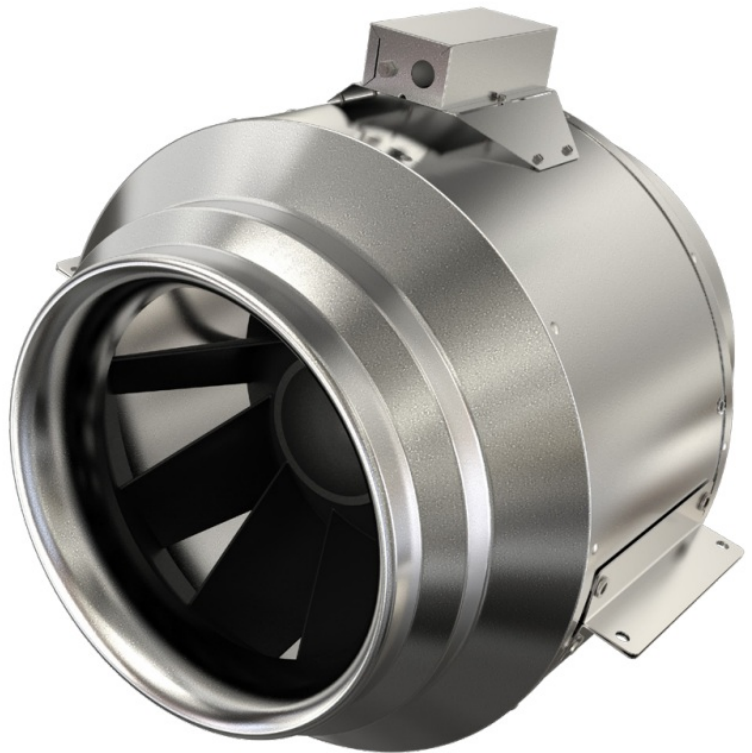

**FKD 12XL / KD 12XL–
FKD 20 / KD 20**

Contents

- 1 PARTS IN THE BOX
- 2 WARNING / IMPORTANT NOTES
 - 2.1 WARNINGS
- 3 MOUNTING
 - 3.1 MOUNTING ILLUSTRATION 1
 - 3.2 MOUNTING ILLUSTRATION 2
 - 3.3 MOUNTING ILLUSTRATION 3
- 4 DIMENSIONS
- 5 WIRING
- 6 Customer Support
- 7 Documents / Resources
 - 7.1 References
- 8 Related Posts

PARTS IN THE BOX

- Inline Fan FKD/KD, 1 pc
- Electrical Box Hardware, 1 pc
- Operation and Installation Manual, 1 pc



Fantech Inc. certifies that the FKD/KD Series shown herein is licensed to bear the AMCA Seal. The ratings shown are based on tests and procedures performed in accordance with AMCA Publication 211 and AMCA Publication 311, and comply with the requirements of the AMCA Certified Ratings Program.

WARNING / IMPORTANT NOTES



Before installation, servicing or cleaning unit, switch power off at service panel and lock the service disconnecting means to prevent power from being switched on accidentally. When the service disconnecting means cannot be locked, securely fasten a prominent warning device, such as a tag, to the service panel.

1. The compactness and adaptability of the FKD/KD Series fans permit easy installation. The fans are shipped fully assembled and can be mounted at any angle. For various mounting, see figures on the following page.
2. Because this unit has rotating parts, safety precautions should be exercised during all phases of installation, operation and maintenance.
3. **CAUTION:** For general ventilation use only, do not use to exhaust hazardous or explosive material and vapors.
For indoor installation only.
4. Remove unit from package and inspect within 15 days after receipt. If damaged, report damage to carrier. Do not operate this unit with visible damage to the blower or impeller assembly.

5. **CAUTION:** This unit has an unguarded impeller. Do not use in locations readily accessible to people or animals.

WEAR HAND PROTECTION AND STAY CLEAR OF SHARP EDGES!

6. Screen guards must be installed within reach of personnel, within (7) feet of the working area, or when advisable for safety.
7. PLEASE read the entire manual before installing.

WARNINGS

DO NOT CONNECT POWER SUPPLY until fan is completely installed. Make sure electrical service to the fan is in the locked “OFF” position.

1. The FKD/KD 8XL–12 fans are suitable for use with solid-state speed control. Three phase units must be wired through a motor contactor.
2. **WARNING!** TO REDUCE THE RISK OF FIRE, ELECTRIC SHOCK, OR INJURY TO PERSONS – OBSERVE THE FOLLOWING:
 - a. Use this unit in the manner intended by the manufacturer. If you have any questions, contact your manufacturer’s representative or contact us directly.
 - b. **CAUTION:** Before installation, servicing or cleaning unit, switch power off at service panel and lock the service disconnection means to prevent power from being switched on accidentally. When the service disconnection means cannot be locked, securely fasten a prominent warning device, such as tag, to the panel.
 - c. Installation work and electrical wiring must be done by qualified person(s) in accordance with all applicable codes and standards, including fire-rated construction.
3. Sufficient air is needed for proper combustion and exhausting of gases through the flue (chimney) of fuel burning equipment to prevent back drafting. Follow the heating equipment manufacturer’s guideline and safety standards such as those published by the National Fire Association (NFPA), and the American Society for Heating, Refrigeration and Air-Conditioning Engineers (ASHRAE), and the local code authorities.
 - a. When cutting or drilling into wall and ceiling, do not damage electrical wiring and other hidden utilities.
 - b. Ducted exhaust fans must always be vented to the outdoors.
 - c. If this unit is to be installed over a tub or shower, it must be marked as appropriate for the application and be connected to a GFCI (Ground Fault Circuit Interrupter) – protected branch circuit.
 - d. Use only on GFCI Protected Receptacles.
 - e. Do not use an extension cord with this fan.
 - f. If a power cord is connected, do not install this fan behind a suspended or structural wall, ceiling, or floor.
 - g. NEVER place a switch where it can be reached from a tub or shower.
4. **WARNING!** Check voltage at the fan to see if it corresponds to the motor name plate.

For installations in which the fan is connected to a range hood, or if an exhaust grill connected to the fan is located above or near the cooking surface, as shown, be sure to observe the following safety warning:

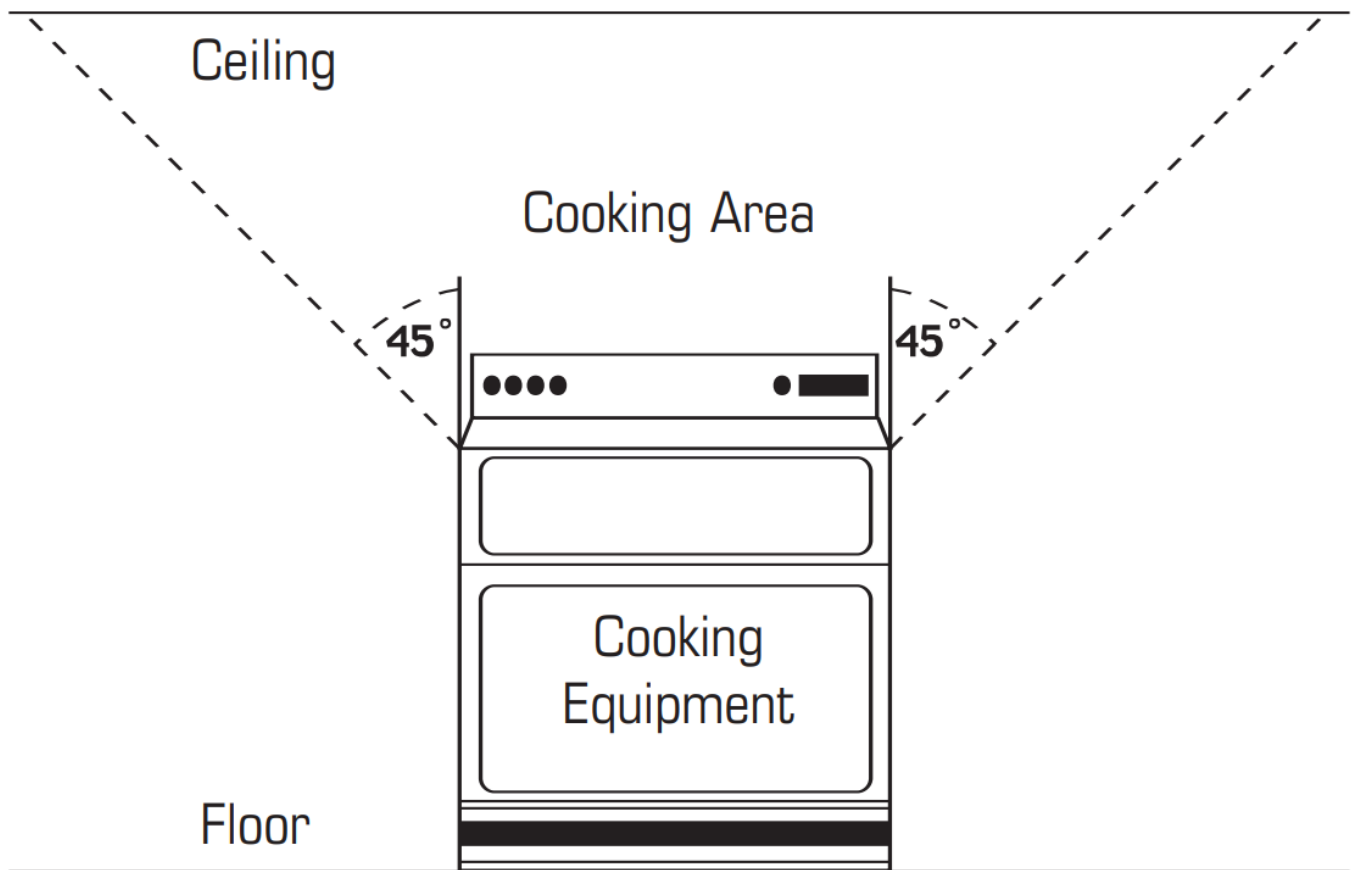

WARNING

TO REDUCE THE RISK OF FIRE, USE ONLY METAL DUCTWORK

(Use only galvanized steel ductwork)

Use only galvanized steel ductwork in accordance with all applicable codes.

(Note: If the fan is not connected to a range hood, or a grill in the vicinity of the cooking surface, other approved ducting may be used. Check your local codes.)

WARNING

TO REDUCE THE RISK OF A RANGE TOP GREASE FIRE:

- **A.** Never leave surface units unattended at high settings. Boilovers cause smoking and greasy spillovers that may ignite. Heat oils slowly on low or medium settings.
- **B.** Always turn hood ON when cooking at high heat or when flambeing food (i.e. Crepes Suzette, Cherries Jubilee, Peppercorn Beef Flambé').
- **C.** Clean ventilating fans frequently. Grease should not be allowed to accumulate on fan or filter.
- **D.** Use proper pan size. Always use cookware appropriate for the size of the surface element.

WARNING

TO REDUCE THE RISK OF INJURY TO PERSONS IN THE EVENT OF A RANGE TOP GREASE FIRE, OBSERVE THE FOLLOWING:

- **A.** SMOTHER FLAMES with a close-fitting lid, cookie sheet, or metal tray, then turn off the burner. BE CAREFUL TO PREVENT BURNS. If the flames do not go out immediately, EVACUATE AND CALL THE FIRE DEPARTMENT.

- **B. NEVER PICK UP A FLAMING PAN** – You may be burned
- **C. DO NOT USE WATER**, including wet dishcloths or towels – a violent steam explosion will result.
- **D. Use an extinguisher ONLY if:**
 1. You know you have a Class ABC extinguisher, and you already know how to operate it.
 2. The fire is small and contained in the area where it started.
 3. The fire department is being called.
 4. You can fight the fire with your back to an exit.

Make a scan of the QR code above to access Fantech's warranty in English, French, or Spanish. Includes a 5y warranty.



If additional support is needed to retrieve the warranty, visit fantech.net; call (800) 747-1762 (US), (800) 565-3548 (Canada), or +52 55 1328-7328 (Latin America); email support@fantech.net; or mail us at 10048 Industrial Blvd, Lenexa, KS 66215 United States or at 50 Kanalläkt Way, Bouctouche, NB E4S 3M5 Canada.

MOUNTING

MOUNTING ILLUSTRATION 1

Please follow all applicable codes when installing this unit

1. Equipment should be hung at its proper elevation by using temporary fixtures that can be removed after vibration hangers are installed (Vibration isolation mounts provided by others).
2. Hanger may be fastened directly to the structure or somewhere between suspended unit (be sure not to over tighten the neoprene element).
3. Install hangers.
4. Turn nuts on rod assembly clockwise one complete turn on each hanger. Repeat this procedure until temporary hanging fixtures are loose and load of piping or equipment is suspended completely on the vibration hangers.
5. Remove temporary hanger fixtures and level piping or equipment by taking additional turns on the spring/top hanger rod nut – clockwise to raise, counterclockwise to lower as required.
6. If equipping fan with isolators (FC Clamps), they should be attached at this time.
7. See wiring section to complete installation.

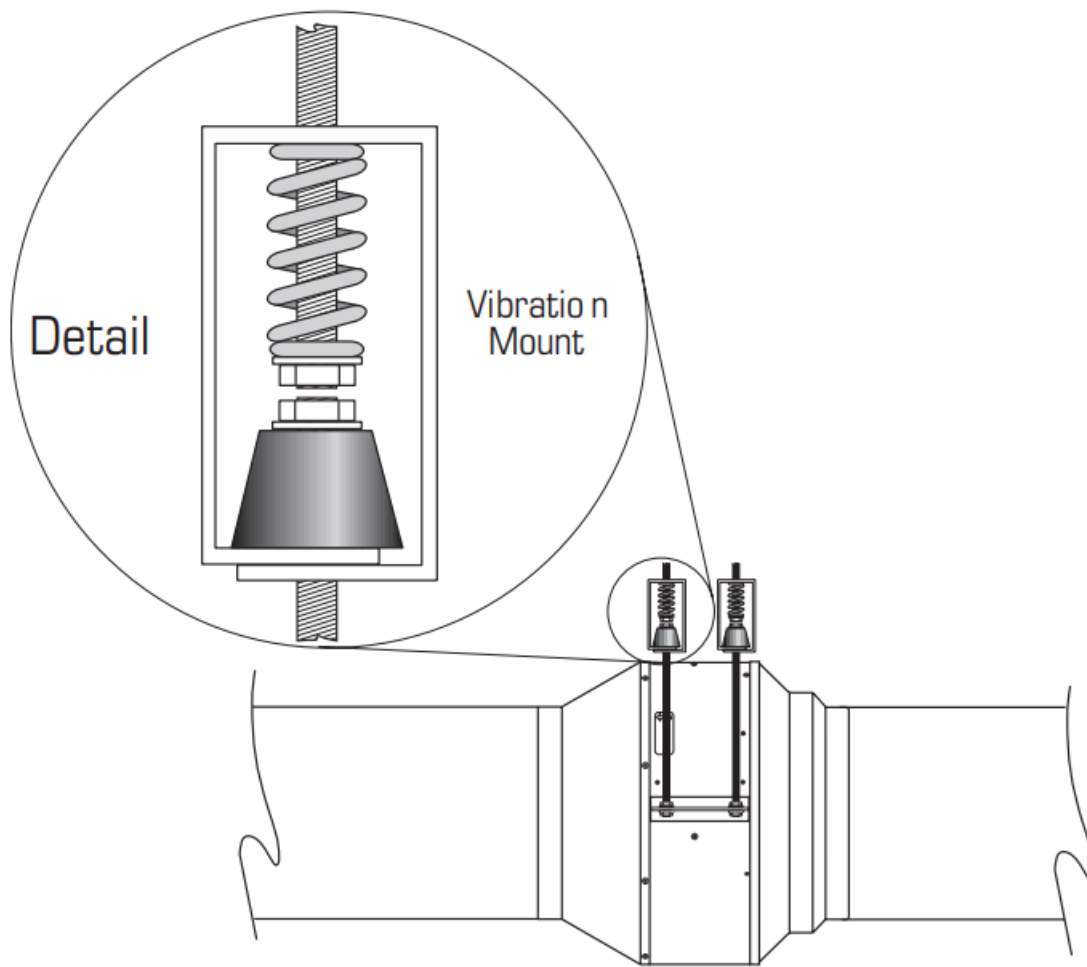

MOUNTING ILLUSTRATION 2

Please follow all applicable codes when installing this unit

1. Install wood supports to structure for fan mounting.
2. If equipping with vibration mounts, attach to supports.
3. Attach fan to vibration mounts, supplied by others (be sure not to over tighten the neoprene element).
4. If equipping fan with isolators (FC Clamps), they should be attached at this time.
5. See wiring section to complete installation.

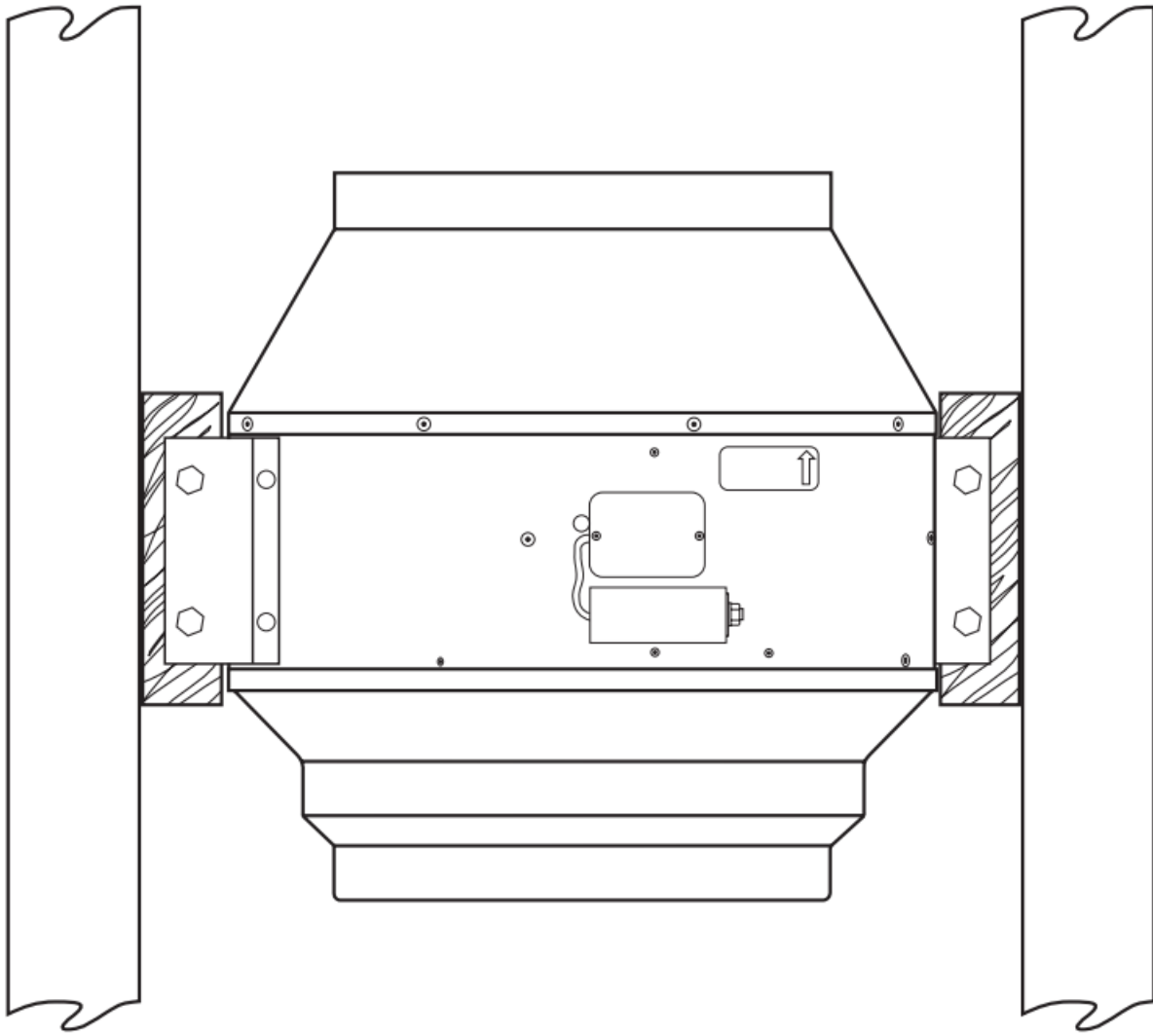

MOUNTING ILLUSTRATION 3

Please follow all applicable codes when installing this unit

1. Create/Install angle wood supports to structure for fan mounting.
2. If equipping with vibration mounts, attach to supports.
3. Attach fan to vibration mounts, supplied by others (be sure not to overtighten the neoprene element).
4. If equipping fan with isolators (FC Clamps), they should be attached at this time.
5. See wiring section to complete installation.

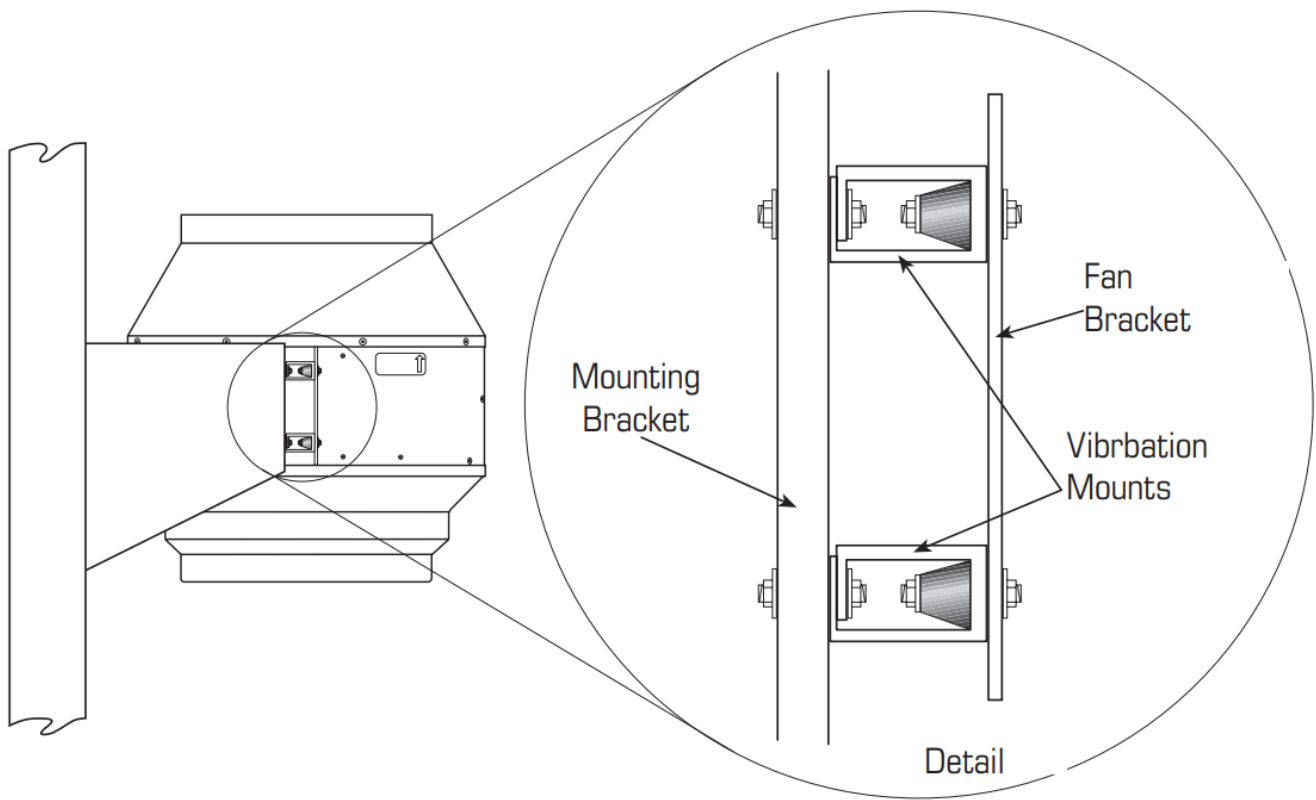

Vibration Mounts and Hardware are not supplied with fan. FC Clamps are sold separately.

DIMENSIONS

- **FKD Models: 8XL, 10, 10XL, and 12**
KD Models: 8XL, 10, 10XL, and 12

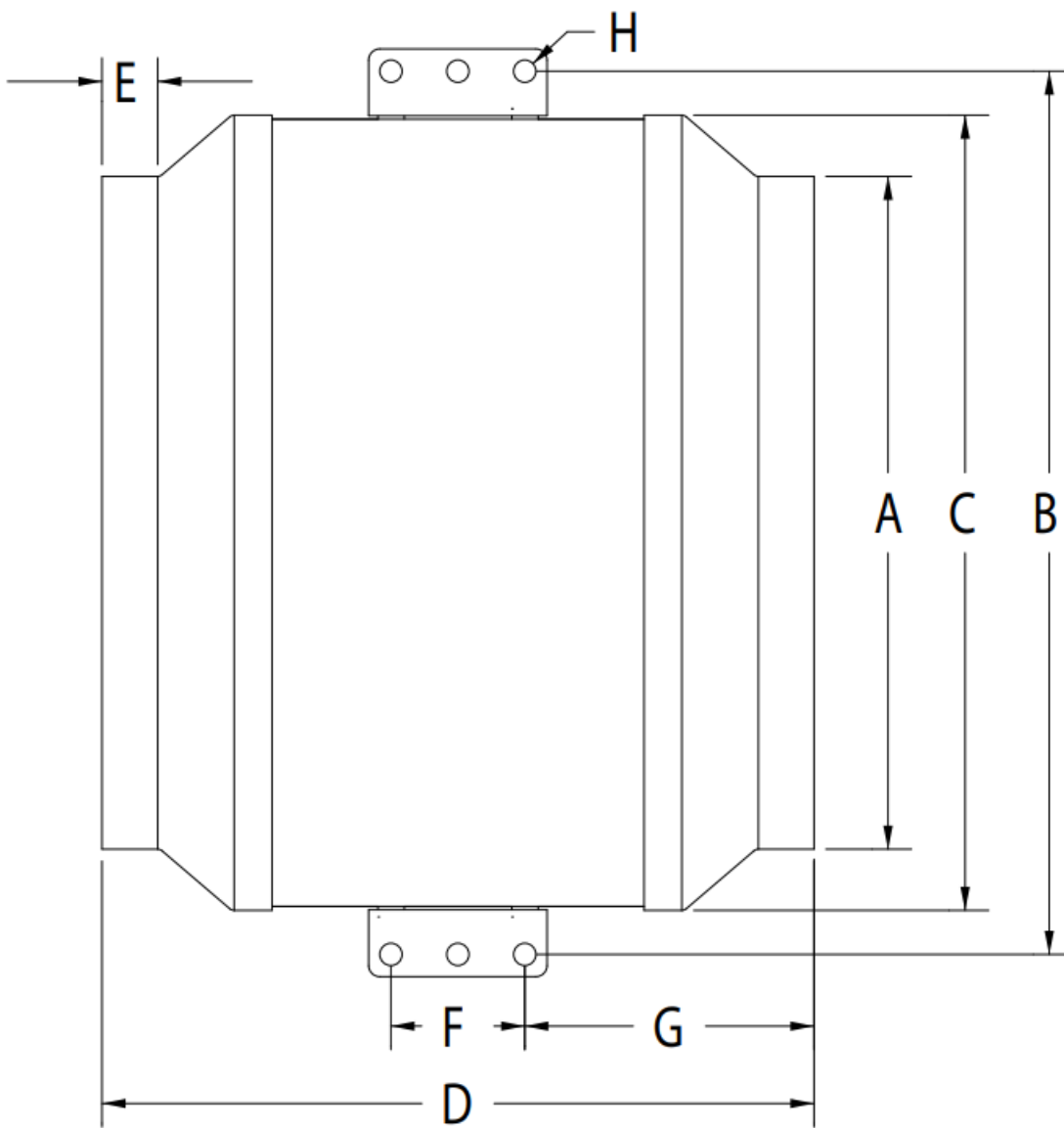

- **FKD Models:** 12XL, 14, 14XL, 16, 16XL, 18, 18XL, and 20
KD Models: 12XL, 14, 14XL, 16, 16XL, 18, 18XL, and 20

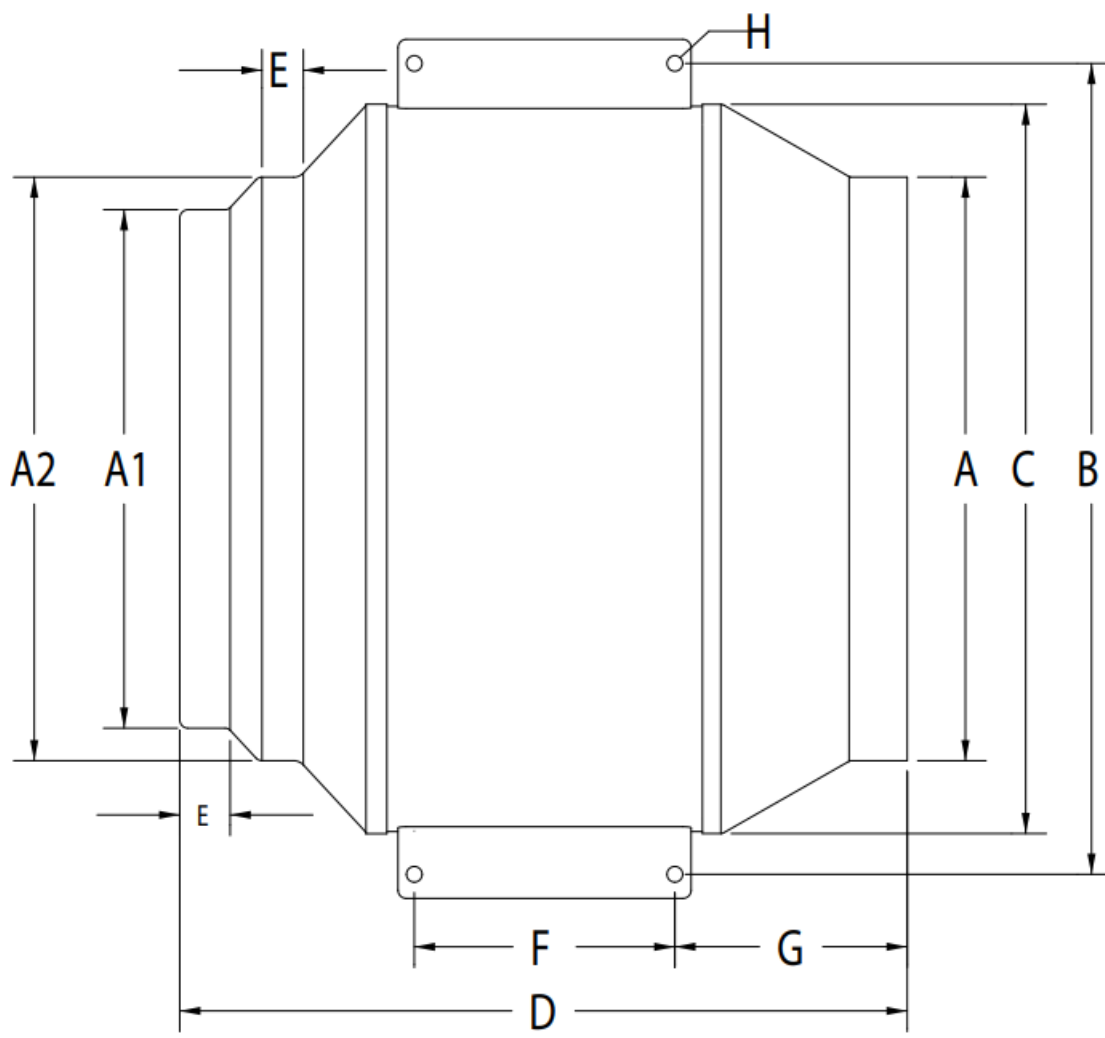

Model	A	A1	A2	B	C	D	E	F	G	H	Weight
8XL	8 (203)	–	–	14 (356)	12 1/2 (318)	15 1/2 (394)	3/4 (19)	2 3/8 (60)	6 1/8 (156)	3/8 (10)	15 (6.8)
10	10 (254)	–	–	14 (356)	12 1/2 (318)	12 1/2 (318)	3/4 (19)	2 3/8 (60)	5 (127)	3/8 (10)	15 (6.8)
10XL	10 (254)	–	–	15 5/8 (397)	14 (356)	15 (381)	3/4 (19)	2 3/8 (60)	6 3/8 (162)	3/8 (10)	21 (9.5)
12	12 (305)	–	–	15 5/8 (397)	14 (356)	12 1/2 (318)	3/4 (19)	2 3/8 (60)	5 1/8 (130)	3/8 (10)	20 (9.0)
12XL	12 (305)	12 (305)	14 (356)	20 3/8 (518)	17 7/8 (454)	18 7/8 (479)	1 3/8 (35)	4 (102)	8 1/2 (216)	3/8 (10)	38 (17.2)
14	14 (356)	12 (305)	14 (356)	20 3/8 (518)	17 7/8 (454)	17 1/4 (438)	1 1/4 (32)	4 (102)	6 3/4 (171)	3/8 (10)	37 (16.7)
14XL	14 (356)	14 (356)	15 5/8 (397)	22 3/8 (568)	19 3/4 (502)	20 1/4 (514)	1 1/2 (38)	4 (102)	8 3/4 (222)	3/8 (10)	45 (20.4)
16	15 5/8 (397)	14 (356)	15 5/8 (397)	22 3/8 (568)	19 3/4 (502)	18 3/4 (476)	1 1/2 (38)	4 (102)	7 1/8 (181)	3/8 (10)	44 (19.9)
16XL	15 5/8 (397)	15 5/8 (397)	17 5/8 (448)	24 1/2 (622)	22 1/8 (562)	23 3/4 (603)	1 1/4 (32)	7 7/8 (200)	8 1/2 (216)	1/2 (13)	75 (34.0)
18	17 5/8 (448)	15 5/8 (397)	17 5/8 (448)	24 1/2 (622)	22 1/8 (562)	21 3/4 (552)	1 1/4 (32)	7 7/8 (200)	7 (178)	1/2 (13)	74 (33.5)
18XL	17 5/8 (448)	17 5/8 (448)	19 5/8 (498)	28 1/2 (724)	26 (660)	27 1/4 (692)	1 3/4 (44)	7 7/8 (200)	10 1/2 (267)	1/2 (13)	98 (44.4)
20	19 5/8 (498)	17 5/8 (448)	19 5/8 (498)	28 1/2 (724)	26 (660)	27 1/4 (692)	1 3/4 (44)	7 7/8 (200)	10 1/2 (267)	1/2 (13)	99 (44.9)

All dimensions are in inches (mm) and weights are in pounds (kg).

WIRING

Wiring:

- **GNYE** – Green/Yellow
- **BU** – Blue
- **BK** – Black
- **BN** – Brown
- **GY** – Grey
- **OG** – Orange

- X – Not Applicable

120/230 Volt Single Phase Fans

FKD/KD: 8XL, 10, 10XL and 12

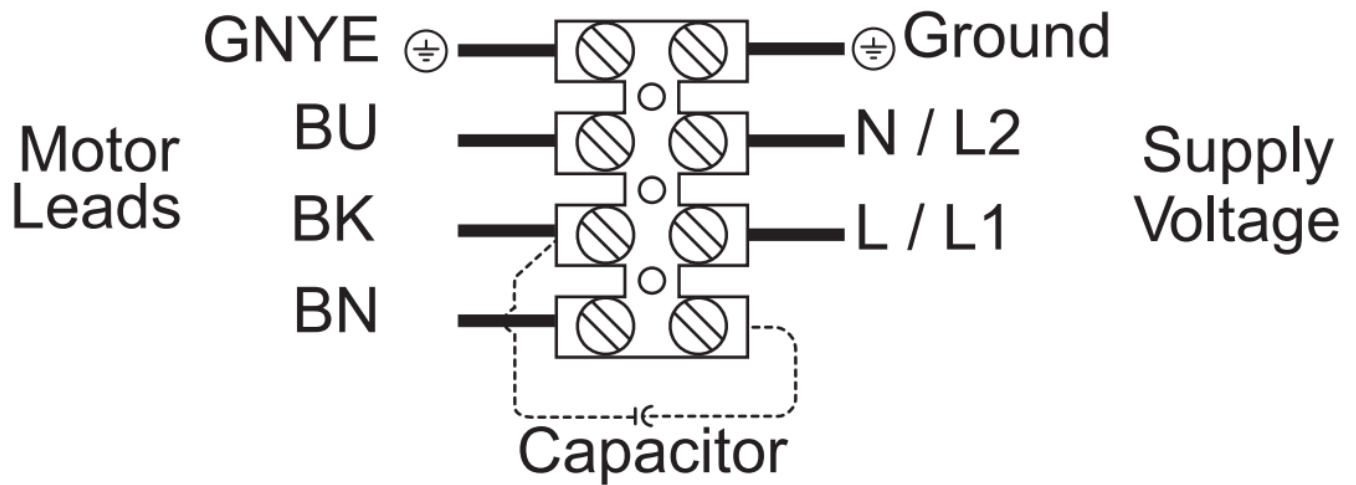

120 Volt Single Phase Fans

FKD/KD: 12XL, 14, 14XL, and 16

230 Volt Single Phase Fans

FKD/KD: 12XL, 14, 14XL, 16, and 16XL

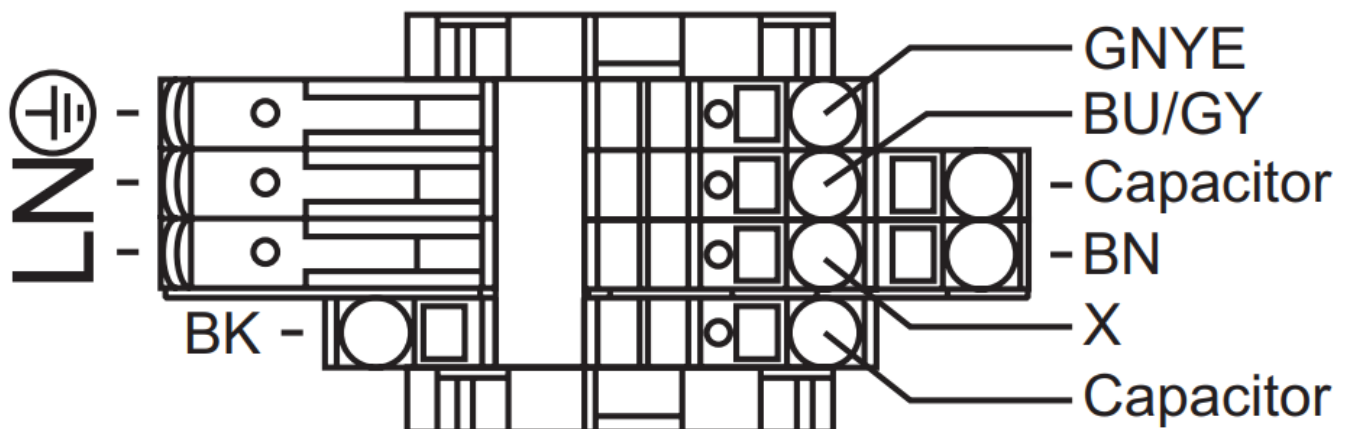

120 Volt Single Phase Fans

FKD/KD: 16XL and 18

FKD/KD: 16XL and 18

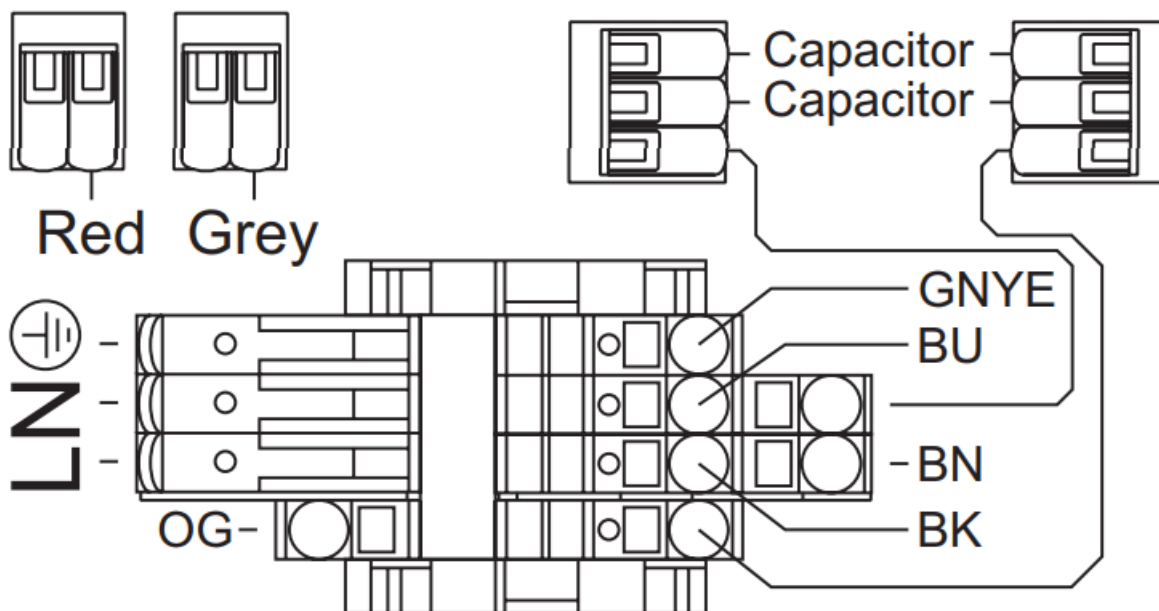

BU	-	Blue	BN	-	Brown
GNYE	-	Green-Yellow	BK	-	Black
OG	-	Orange			

230/460 Volt Three Phase Fans

FKD/KD: 18XL and 20

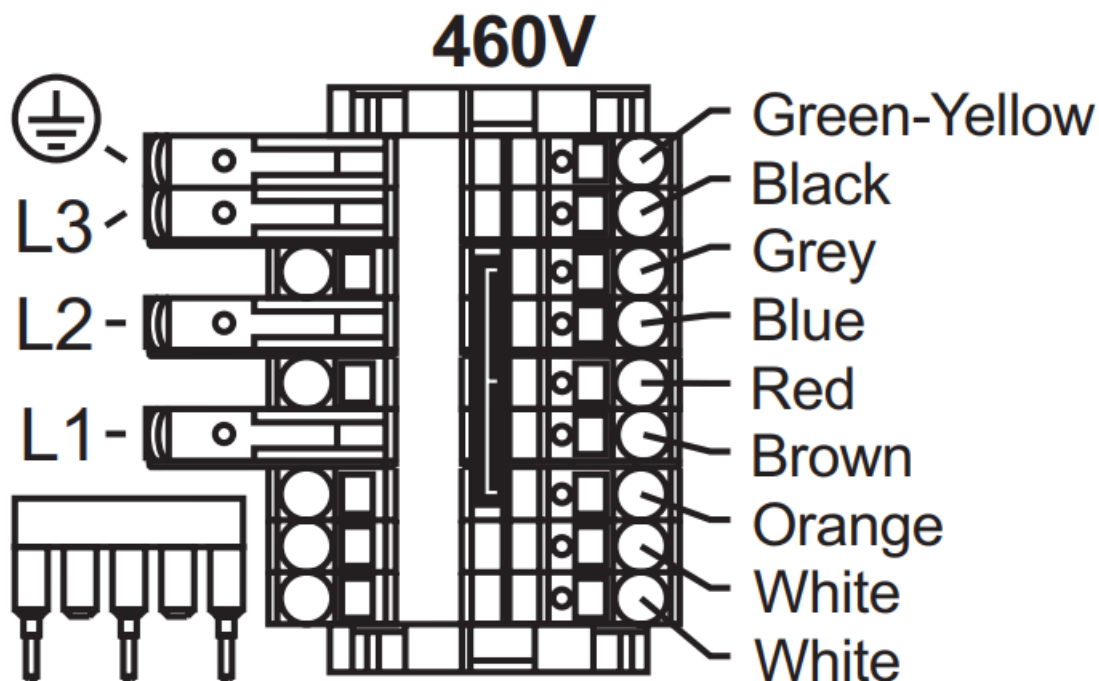
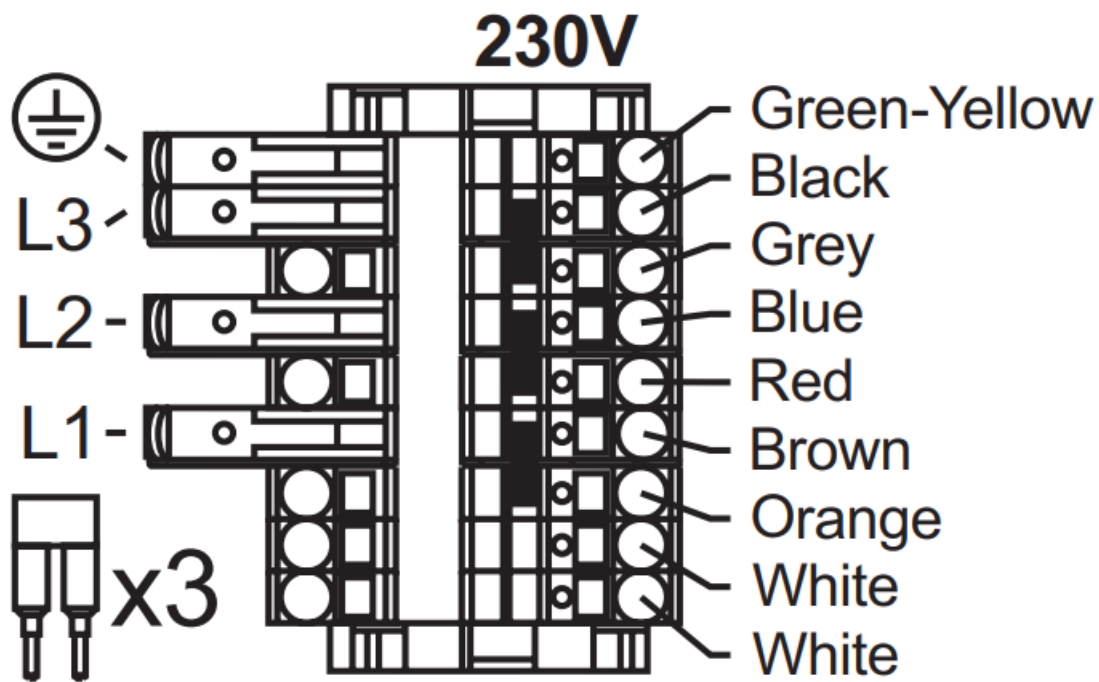

Customer Support

Fantech reserves the right to make technical changes.
For updated documentation please refer to www.fantech.net



REGISTER* THIS PRODUCT TO INCREASE YOUR PRODUCT WARRANTY BY AN EXTRA YEAR

registration.fantech.app

* in USA only



United States Tel.: 800 747 1762
Canada Tel.: 800 565 3548
Latin America Tel.: +52 55 1328 7328

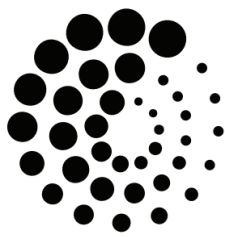

fantech®
a systemair company

Documents / Resources



[fantech FKD-KD Inline Centrifugal Fans](#) [pdf] Instruction Manual
FKD-KD, FKD-KD Inline Centrifugal Fans, Inline Centrifugal Fans, Centrifugal Fans, Fans

References

- [We simplify ventilation solutions | Fantech](#)
- [We simplify ventilation solutions | Fantech](#)
- [User Manual](#)