



FANTAS 42177 Display Case Box Instruction Manual

[Home](#) » [FANTAS](#) » FANTAS 42177 Display Case Box Instruction Manual 

Contents

[1 FANTAS 42177 Display Case Box Instruction Manual](#)

- [1.1 List of Parts](#)
- [1.2 Connector Location](#)
- [1.3 Pin-to-Connector](#)
- [1.4 Panel Assembly Sequence](#)

[2 Documents / Resources](#)

- [2.1 References](#)
- [3 Related Posts](#)

FANTAS 42177 Display Case Box Instruction Manual

Assembly Instruction

Scan for Assembly Instruction Video



FantasMall Arcylic Display Case for LEGO® Collections



Read instructions before assembling!

Warning: Do not let children use or play with the parts!



For AGE 12+ only!
CHOKING Hazard
Small Parts.

Keep away from children and pets!

List of Parts

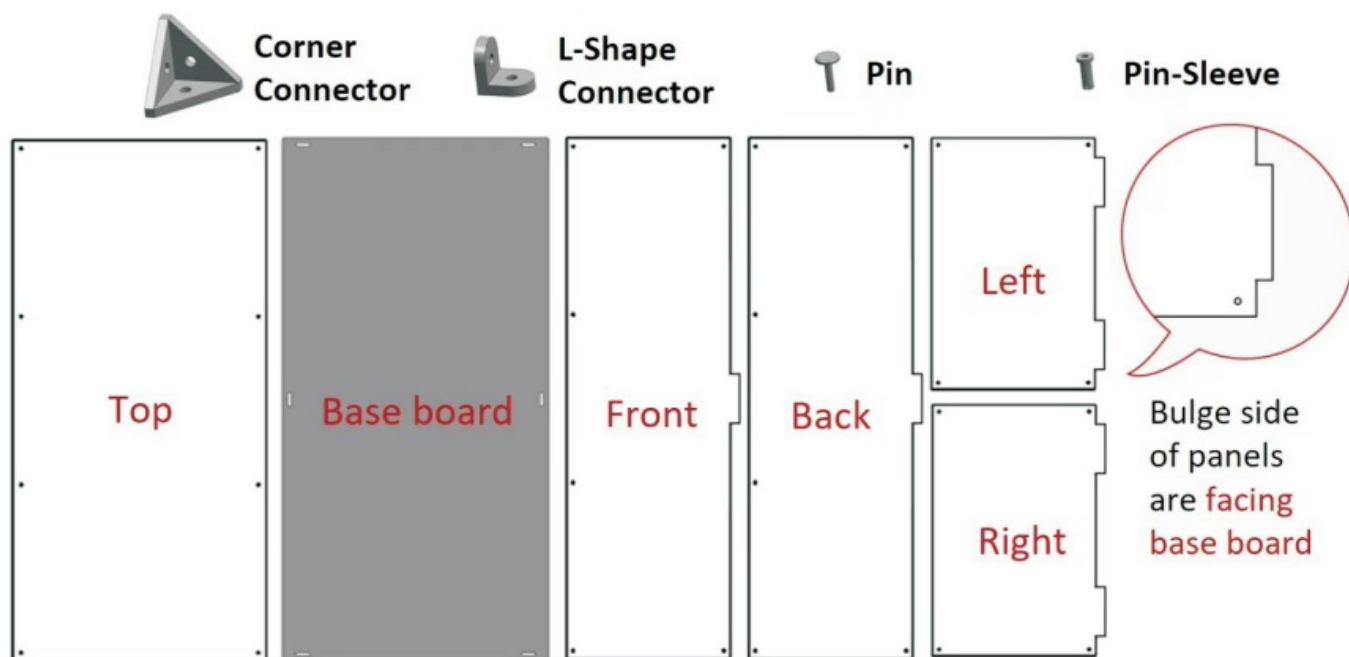

Note: Front/back boards are identical, left/right boards are identical.

Connector Location

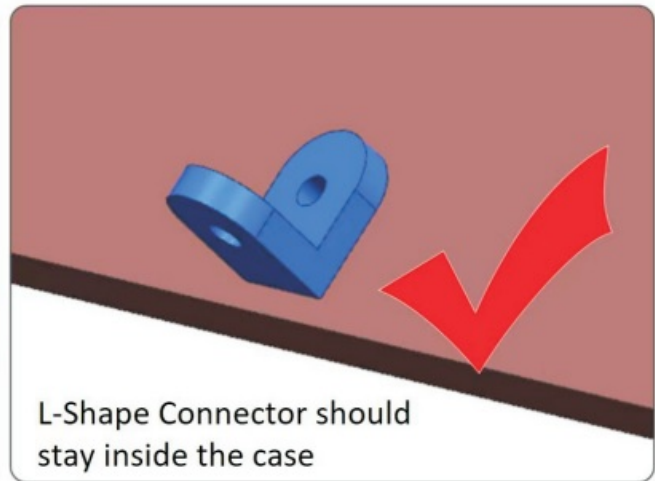
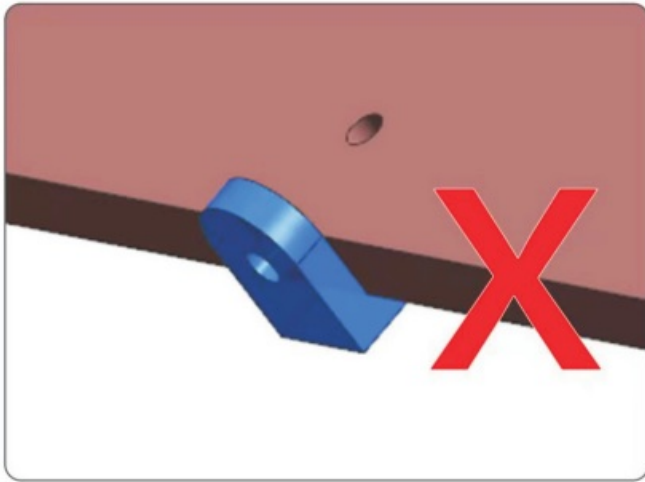
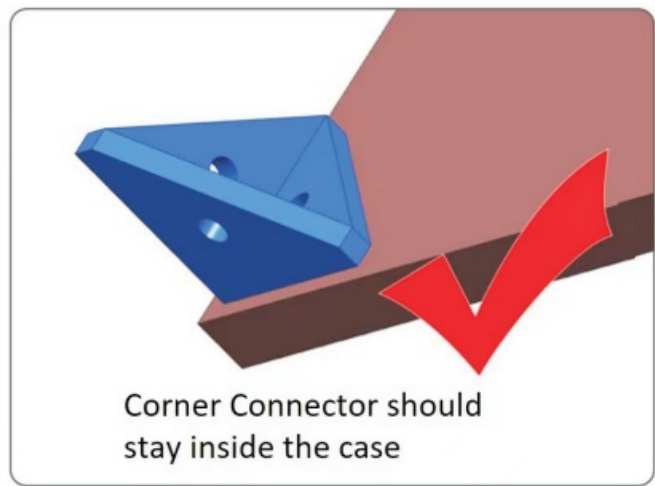
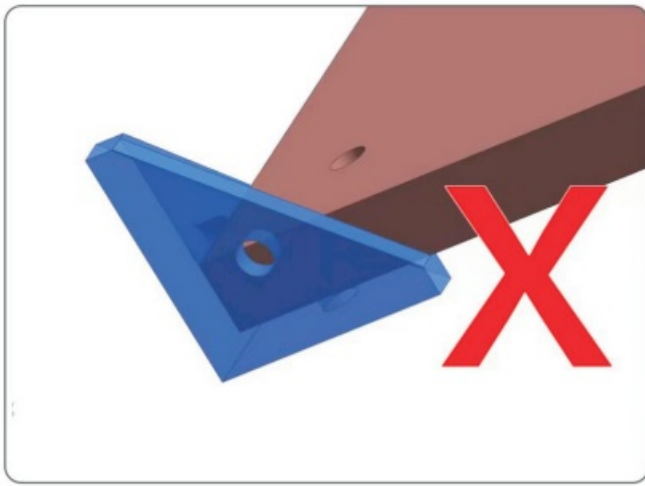

Pin-to-Connector

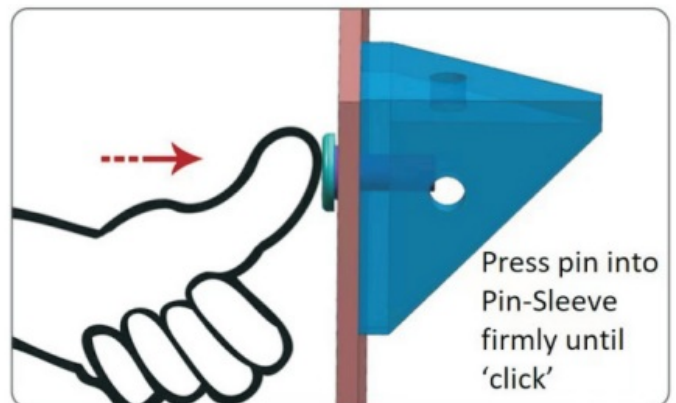
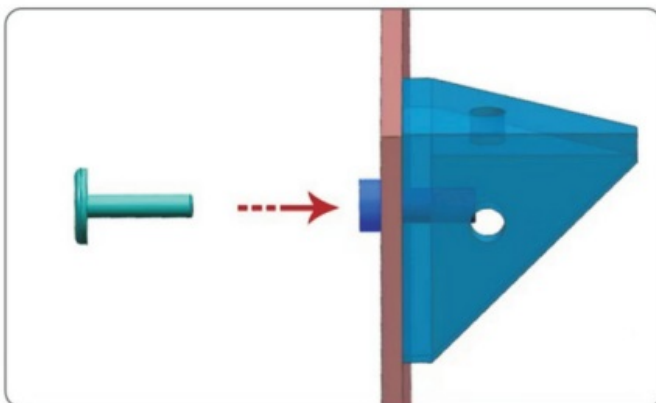
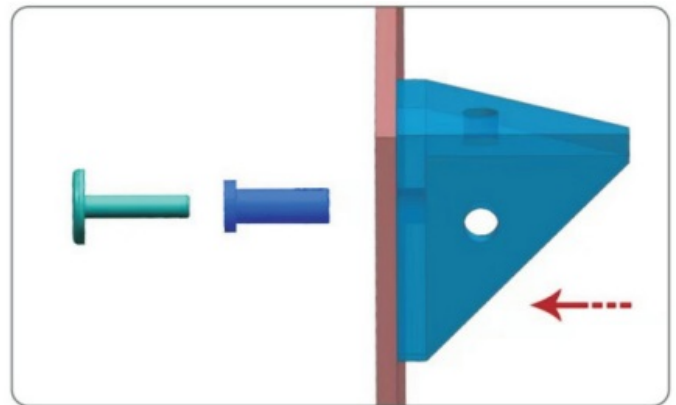
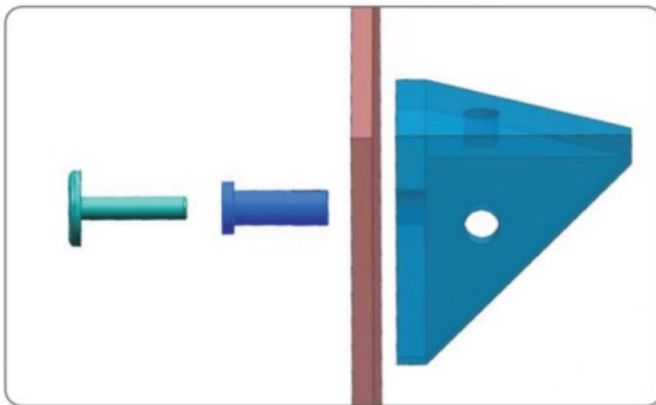

Panel Assembly Sequence

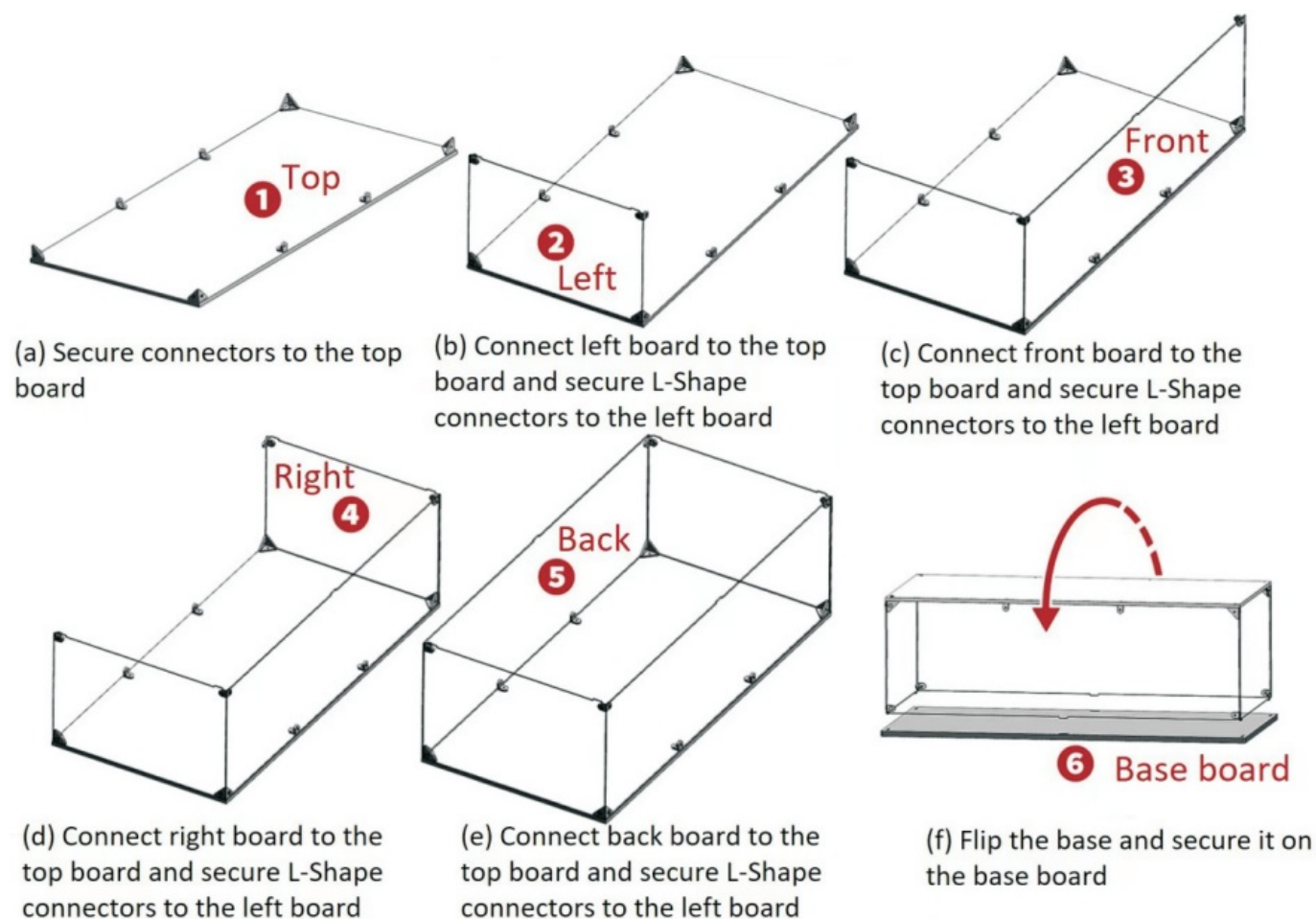

FANTAS

Contact:

support@fantasmall.com

Documents / Resources

	FANTAS 42177 Display Case Box [pdf] Instruction Manual 42177, 42177 Display Case Box, Display Case Box, Case Box, Box
---	--

References

- [User Manual](#)

[Manuals+](#), [Privacy Policy](#)

This website is an independent publication and is neither affiliated with nor endorsed by any of the trademark owners. The "Bluetooth®" word mark and logos are registered trademarks owned by Bluetooth SIG, Inc. The "Wi-Fi®" word mark and logos are registered trademarks owned by the Wi-Fi Alliance. Any use of these marks on this website does not imply any affiliation with or endorsement.