



# FANTAQI SQFX01K03-1 Fantasy Smart Display Box Starter Pack Instruction Manual

[Home](#) » [FANTAQI](#) » FANTAQI SQFX01K03-1 Fantasy Smart Display Box Starter Pack Instruction Manual 

## Contents

- [1 FANTAQI SQFX01K03-1 Fantasy Smart Display Box Starter Pack](#)
- [2 Product Usage Instructions](#)
- [3 Parts](#)
- [4 Reset](#)
- [5 Installation Instructions](#)
- [6 Precautions](#)
- [7 WARRANTY INFORMATION](#)
- [8 FCC STATEMENT](#)
- [9 DISPOSAL](#)
- [10 Specifications](#)
- [11 More Information](#)
- [12 Documents / Resources](#)
- [13 Related Posts](#)



**FANTAQI SQFX01K03-1 Fantasy Smart Display Box Starter Pack**



## **Product Usage Instructions**

**To use the product, please follow these steps:**

1. Ensure that you have a suitable surface to place the product on.
2. Take the product out of its packaging.
3. Place the product on the designated surface, ensuring that it is positioned securely.
4. Make any necessary adjustments to the product's position or orientation.
5. If applicable, connect any required cables or accessories to the product.
6. Power on the product using the designated power button or switch.
7. Refer to the user manual for specific instructions on how to operate and utilize the product's features.
8. When finished using the product, power it off and disconnect any cables or accessories as needed.
9. Carefully store the product in a safe and suitable location.

## **Parts**

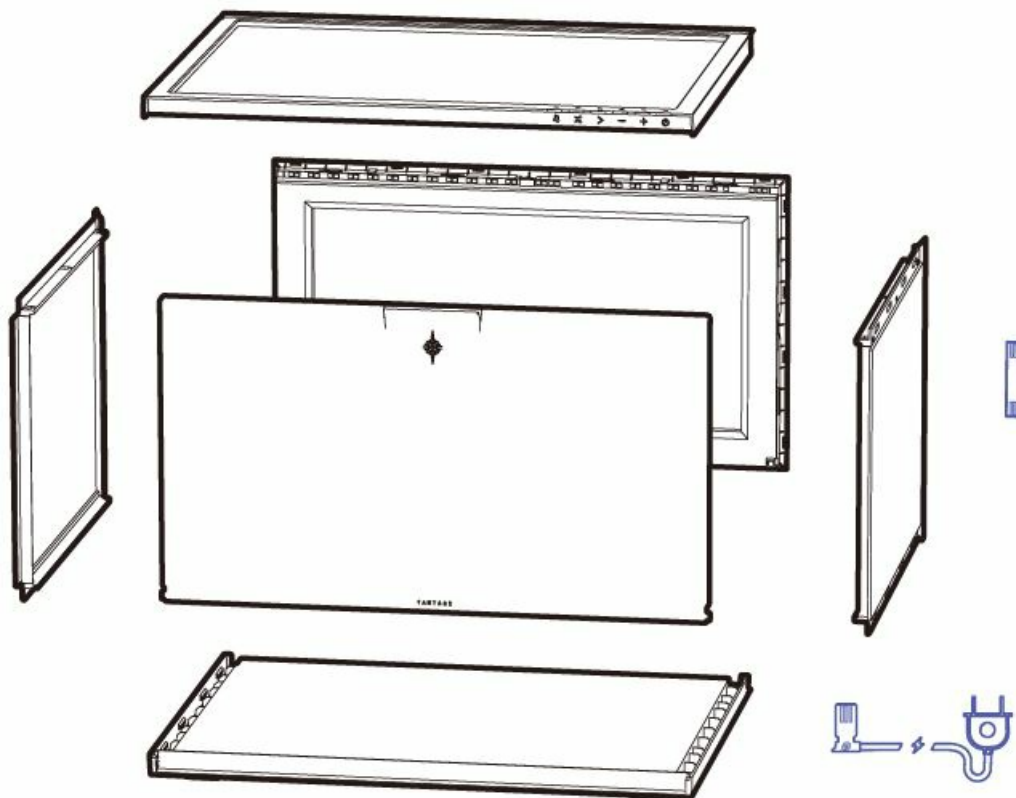

## Reset

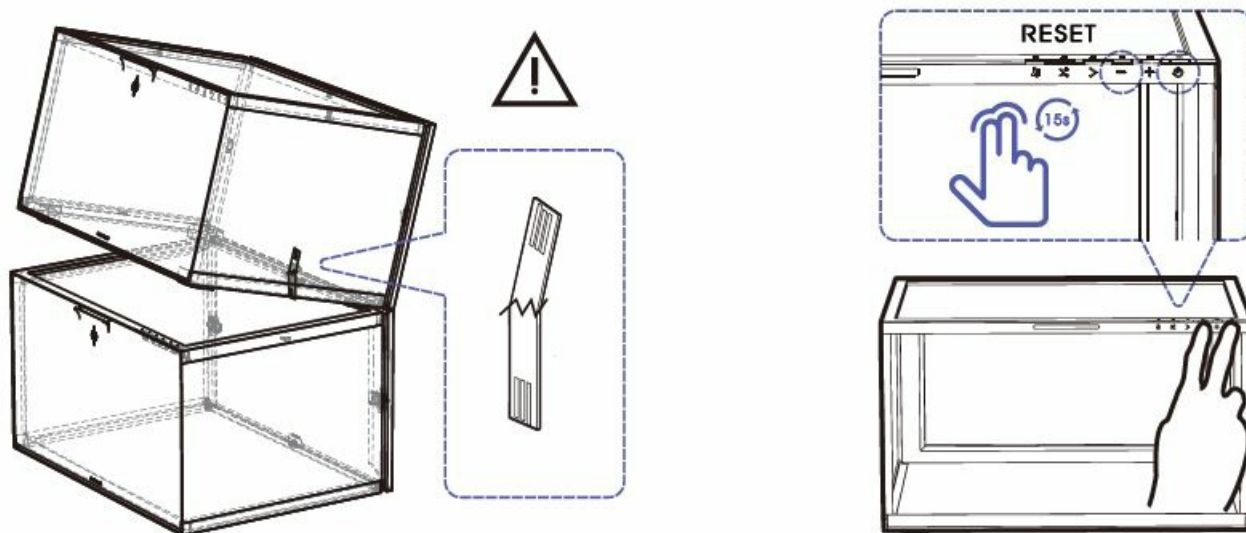

## Installation Instructions

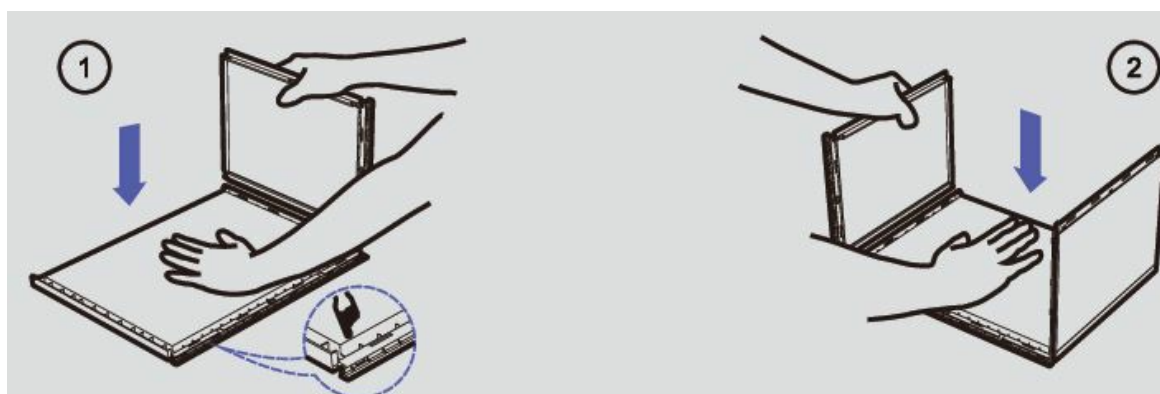

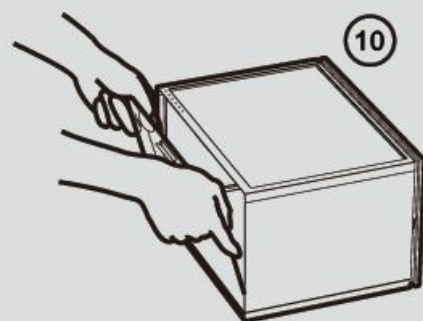
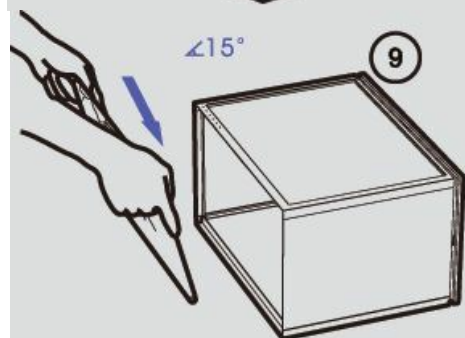
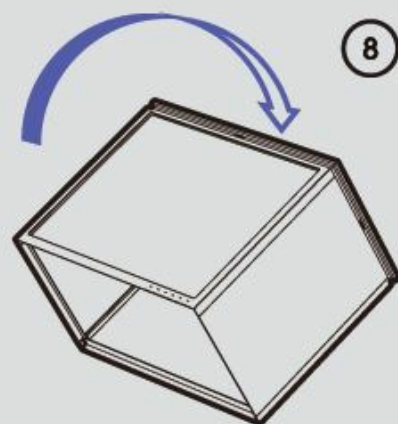
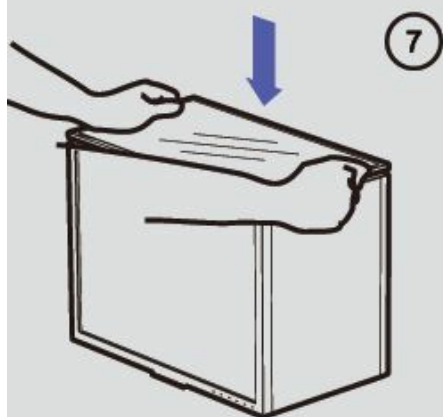
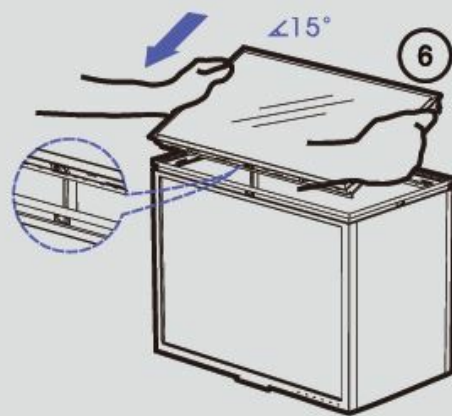
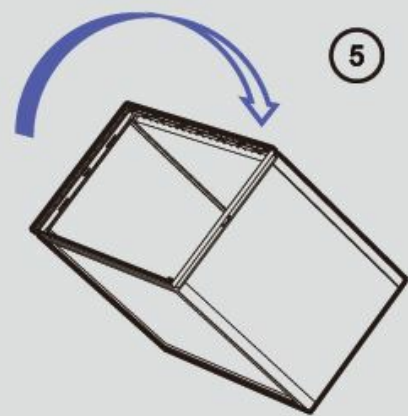
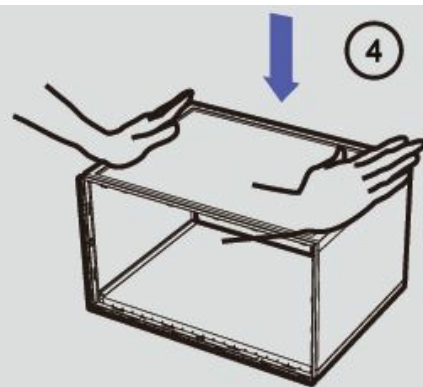
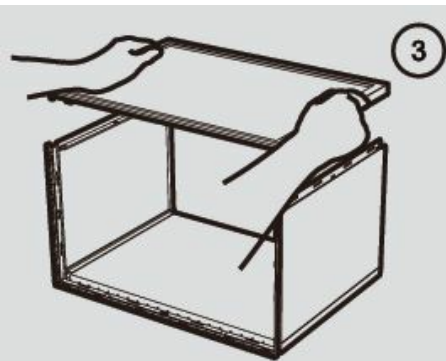

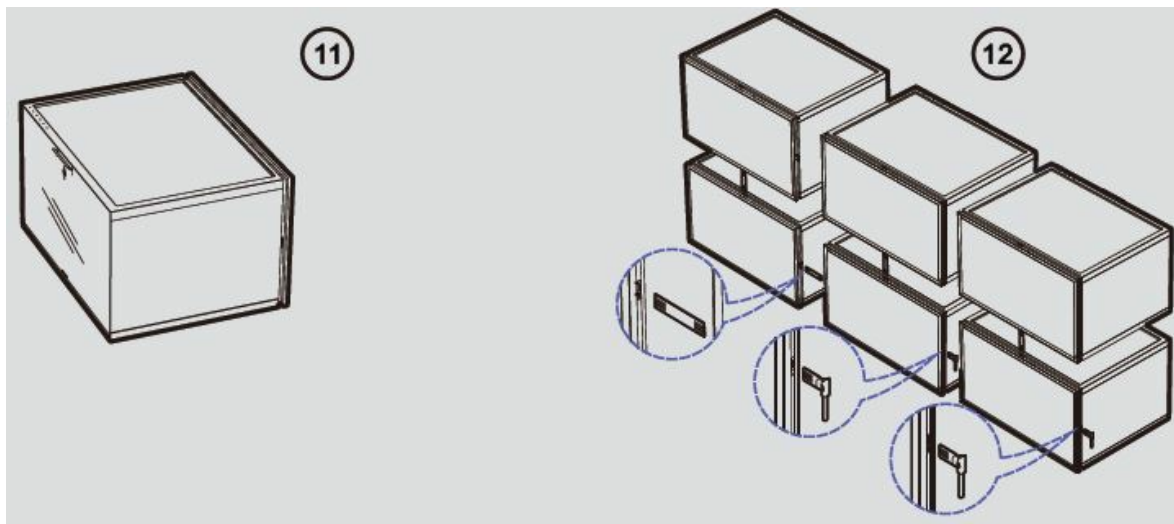

## Precautions

### WARNINGS & CAUTIONS

Please read this safety information carefully and keep this document for future reference. This FANTAQI® product is not designed, certified, nor intended for use in: enclosed locations that limit the flow of air and/or trap heat. Product is intended for environment temperature of 0-40 degrees Celsius and < 95% RH; emergency exits, emergency lighting, or other use cases involving critical systems for human safety; in conjunction with 3rd party devices that are not approved by FANTAQI® for use with FANTAQI® products; locations or use cases where there is a risk of electric shock; outdoor areas, regardless of weather conditions; wet or damp conditions; excessively hot environments that are consistently above 40 degrees Celsius for extended periods of time (for example: near ovens, space heaters, clothing dryers); excessively humid areas; regions or countries other than that in which the product was intended for and certified for sale in. When using this FANTAQI® product: Do not open or disassemble the device, as this will void the warranty and make the product unsafe for use.

While connected to the electrical supply of the building, line voltages will be present in the power supply, modular units, connectors, so do not place any metallic or conductive objects near any exposed metal contacts on any component. Unplug the power supply unit from the power source before dismantling the product. Do not allow small children to operate this device without adult supervision. This device contains small parts that may be a choking hazard to small children. Loose or dangling cords may cause an entanglement hazard to small children. Do not leave cords dangling or loose on the floor to help prevent accidents from tripping. Do not clean the device with liquid or sprays when it is connected to power. Clean the device with a soft dry cloth, and do not use harsh cleaning agents. Do not step on any part of the device, as this will cause breakage. Do not submerge any part of the device in water, or expose any part of the device to water. Do not attach the product together with any connector or device other than original equipment manufactured by FANTAQI®. Do not puncture any part of the device with sharp objects, as this will cause the device to cease working as designed and may present a safety hazard.

Optional secure mounting solutions for these use cases are available, sometimes through added accessories offered for purchase separately. Your warranty DOES NOT COVER damage caused by falling devices. The flexible cable and power supply cannot be replaced by another third party product. If the cable is damaged, the entire controller and power supply should only be replaced with original equipment manufactured by FANTAQI®. Using any non-approved replacement component will void the warranty and may present a serious safety hazard. This FANTAQI product is primarily intended for decorative use, with RGBW output function that can dim.

### WARRANTY INFORMATION

- **This product is covered by a limited warranty from FANTAQI®:** A two-year complimentary replacement of defective hardware for limited regions. Shipping charge may apply for remote regions.

## FCC STATEMENT

### WI-FI/RF

This equipment has been tested and found to comply with the limits of a Class B digital device, pursuant to part 15 of the FCC Rules and the Canadian ICES-003 Class B specifications. These limits are designed to provide reasonable protection against harmful interference in a residential installation. This equipment generates, uses and can radiate radio frequency energy and, if not installed and used in accordance with the instructions, may cause harmful interference to radio communications. However, there is no guarantee that interference will not occur in a particular installation. If this equipment does cause harmful interference to radio or television reception, which can be determined by turning the equipment off and on, the user is encouraged to try to correct the interference by one or more of the following measures: Reorient or relocate the receiving antenna; increase the separation between the equipment and receiver; connect the equipment into an outlet on a circuit different from that to which the receiver is connected. Consult the dealer or an experienced radio/TV technician for help.

This device complies with Part 15 of the FCC Rules. Operation is subject to the following two conditions:

1. This device may not cause harmful interference.
2. This device must accept any interference received, including interference that may cause undesired operation

Changes or modifications not expressly approved by the party responsible for compliance could void the user's authority to operate the equipment. This equipment should be installed and operated with a minimum distance of 20 cm between the radiator and your body. This device contains licence-exempt transmitters/receivers that comply with Innovation, Science and Economic Development Canada's licence-exempt RSS(s). Operation is subject to the following two conditions:

1. This device may not cause interference.
2. This device must accept any interference, including interference that may cause undesired operation of the device.

## DISPOSAL

### DISPOSAL OF YOUR OLD PRODUCT

Your product is designed and manufactured with high-quality materials and components, which can be recycled and reused. When this crossed-out wheellie bin symbol is attached to a product, it means that the product is covered by European Directive 2012/19/EU. Please find out about your local collection system for electrical and electronic products. Please act according to your local rules and do not dispose of your old products with your normal household waste. The correct disposal of your old product will help to prevent potential negative consequences for the environment and human health.

## Specifications

### FANTAQI EXPO-PRO SMART EDITION

- **Model:** SQFX01K
- **Rated Input:** 100-240V~, 50/60Hz
- **Operation Environment:** 0~40°C, 0%~93%RH
- **Rated Power:** 7W
- **FCC ID:** 2AEWY-SQFX01



- **IC:** 20489-SQFX01

### Frequency range

- **2.4GHz Wi-Fi:** 2412-2462 MHz, Max RF ei.r.p power < 20 dBm,
- **2.4GHz Radio:** 2402-2480 MHz, Max RF ei.r.p power <10 dBm

### More Information

**FANTAQI TECHNOLOGY CO., Ltd.**

- **Manufacturer:** NanoGrid Limited
- **Address:** #1301-483A Castle Peak Road, Kowloon, Hong Kong
- **Communication Protocol:** Wi-Fi 2.4GHz 802.11b/g/n, 2.4G Proprietary

App and smart home controls are enabled in conjunction with EXPO-PRO smart edition only.

### Scan

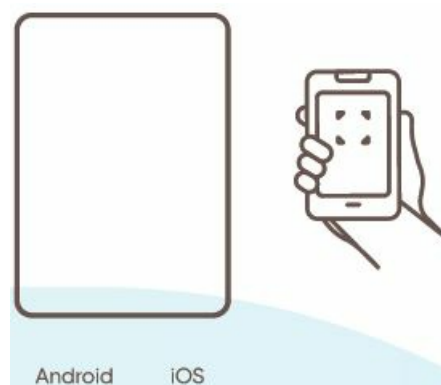

Download the Nanoleaf App on your smartphone to unlock full features



MacOS/Windows applications supported via [go.nanoleaf.me](https://go.nanoleaf.me)

Documents / Resources

	<a href="#">FANTAQI SQFX01K03-1 Fantasy Smart Display Box Starter Pack</a> [pdf] Instruction Manual SQFX01, 2AEWY-SQFX01, 2AEWYSQFX01, SQFX01K03-1 Fantasy Smart Display Box Starter Pack, Fantasy Smart Display Box Starter Pack, Smart Display Box Starter Pack, Display Box Starter Pack, Starter Pack
-----------------------------------------------------------------------------------	-----------------------------------------------------------------------------------------------------------------------------------------------------------------------------------------------------------------------------------------------------------------------------------------------------------

Manuals+.