

**FANATEC®
CSL-C-KH CSL
Cockpit Keyboard
Holder**



FANATEC CSL-C-KH CSL Cockpit Keyboard Holder Instruction Manual

[Home](#) » [FANATEC](#) » FANATEC CSL-C-KH CSL Cockpit Keyboard Holder Instruction Manual 

Contents

- 1 FANATEC CSL-C-KH CSL Cockpit Keyboard Holder
- 2 Product Usage Instructions
- 3 FAQ
- 4 PACKAGE CONTENT
- 5 GETTING STARTED
- 6 KEYBOARD HOLDER ASSEMBLY
- 7 SUPPORT
- 8 CONTACT
- 9 Documents / Resources
 - 9.1 References

FANATEC®

FANATEC CSL-C-KH CSL Cockpit Keyboard Holder



Product Usage Instructions

- Ensure you have the following components ready: 1x T1, 1x T3, 2x B13, 4x W2, and 2x N2.
- Follow the assembly instructions based on your language preference:
- For any other inquiries or information regarding the product, refer to the manufacturer's addresses provided.
- This product is not intended for use by children. Always follow safety guidelines during assembly and usage.

FAQ

- **Q: Where can I find additional assembly instructions?**
 - **A:** Additional assembly instructions can be found on the manufacturer's website or by contacting customer support.
- **Q: Is this product compatible with all keyboard sizes?**
 - **A:** The product is designed to accommodate standard keyboard sizes. For larger keyboards, please check the specifications or contact support for compatibility.

PACKAGE CONTENT

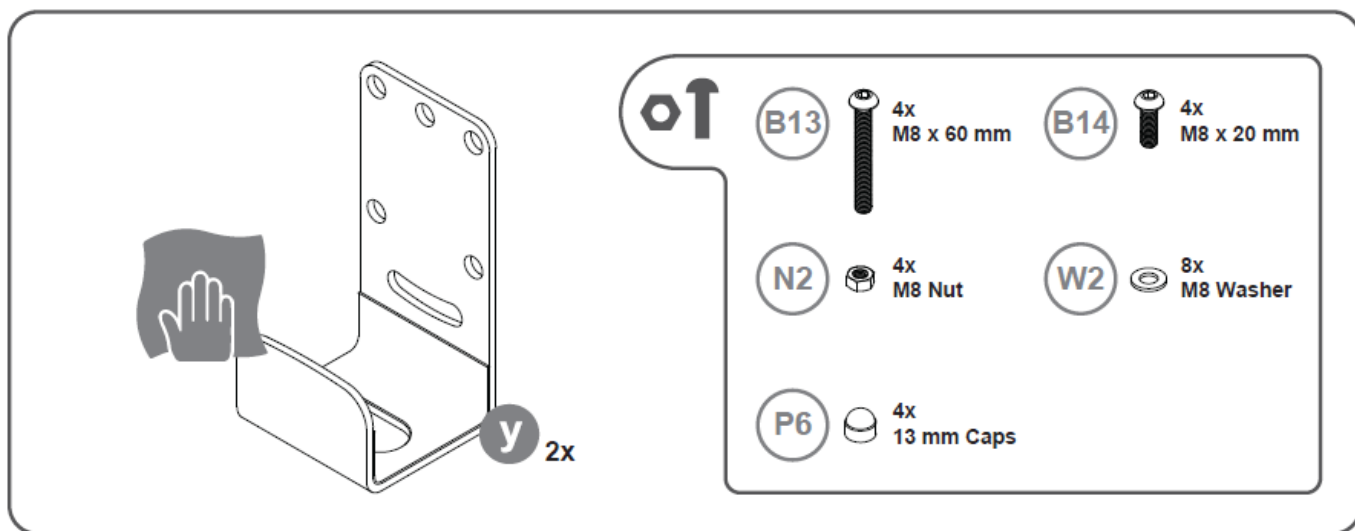

GETTING STARTED

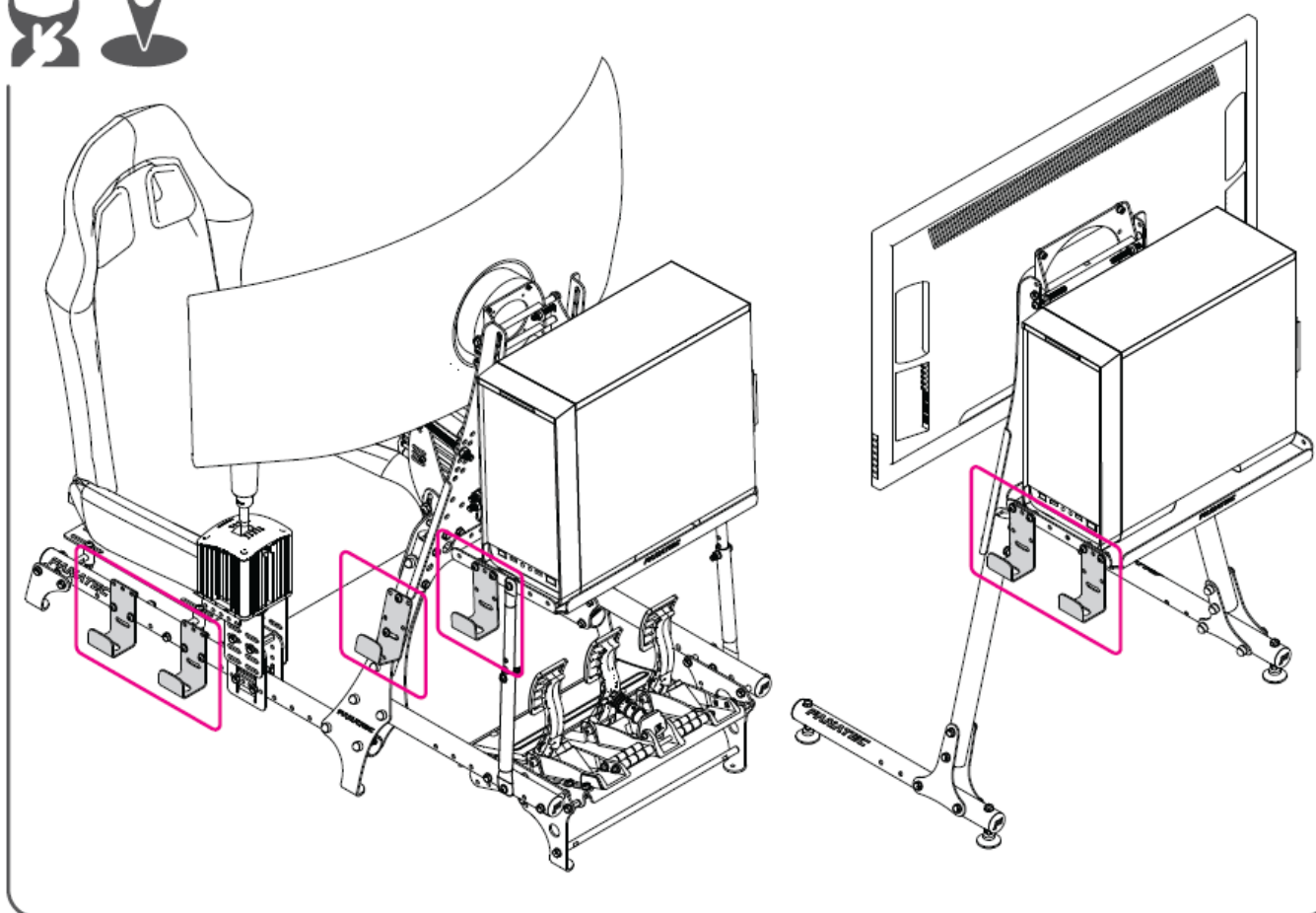

KEYBOARD HOLDER ASSEMBLY

- 1x **y**
- 2x **B13**
- 4x **W2**
- 2x **N2**

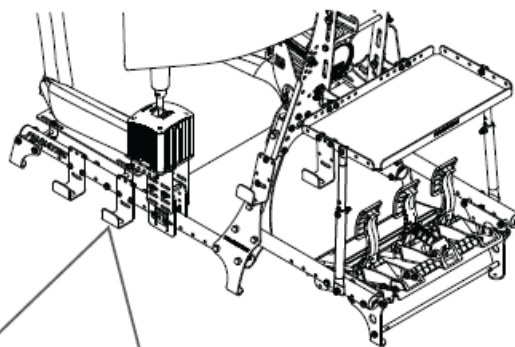
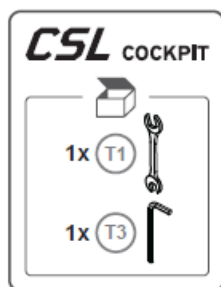

A

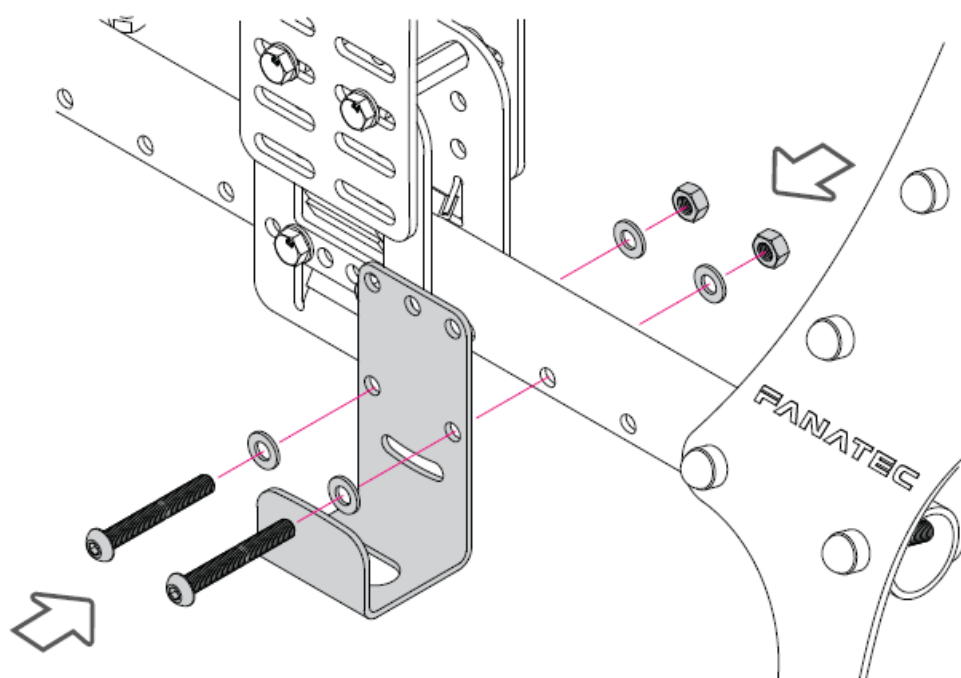

- 1x **y**
- 2x **B13**
- 4x **W2**
- 2x **N2**

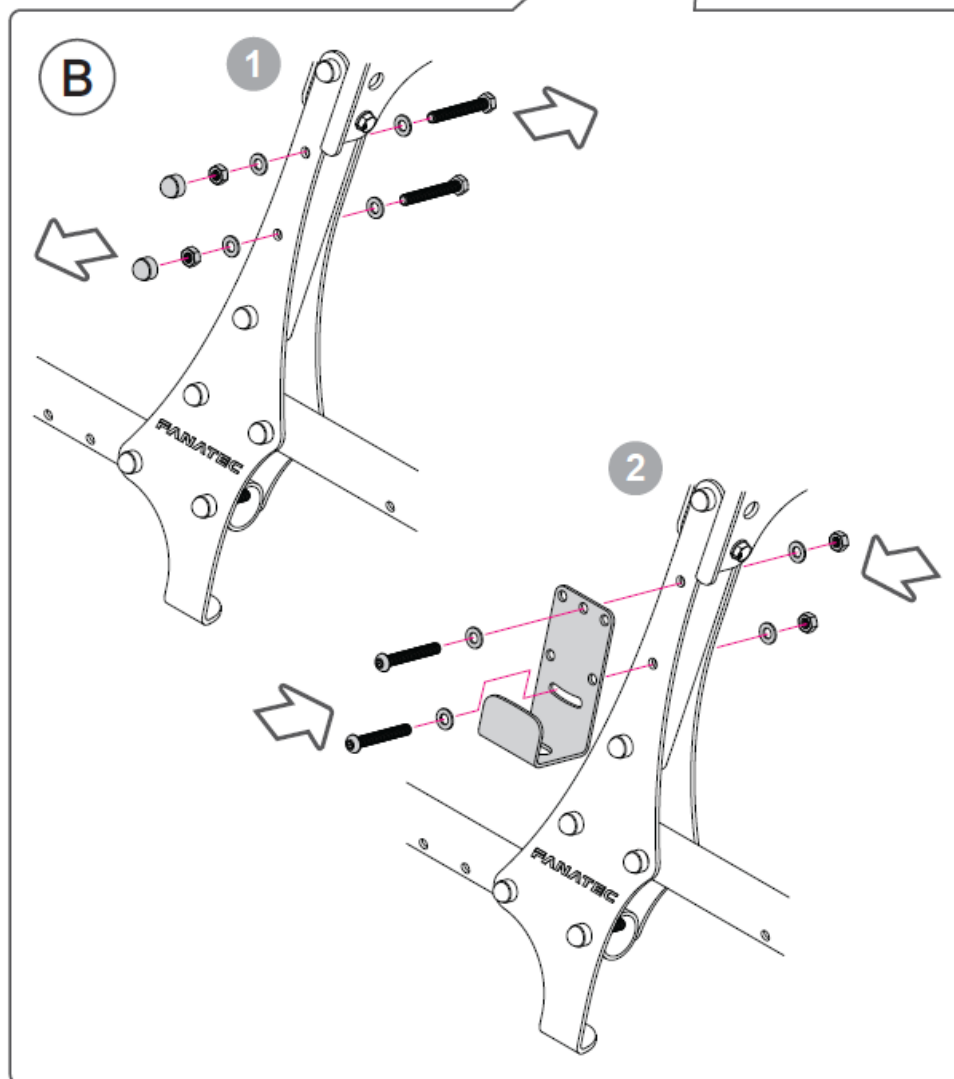
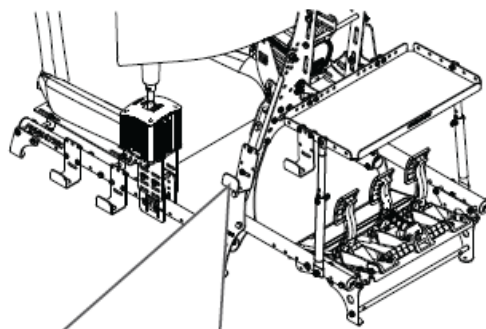
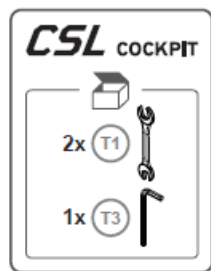

- 1x **y**
- 2x **B14**
- 4x **W2**
- 2x **N2**

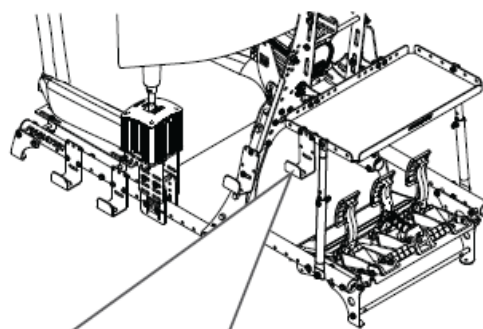
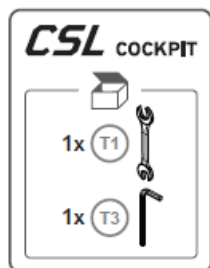

C

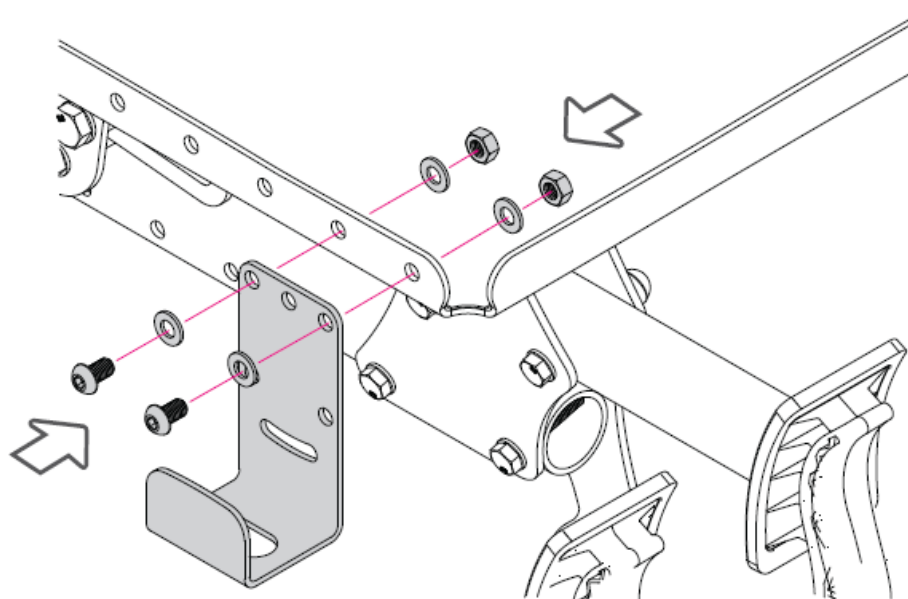

A

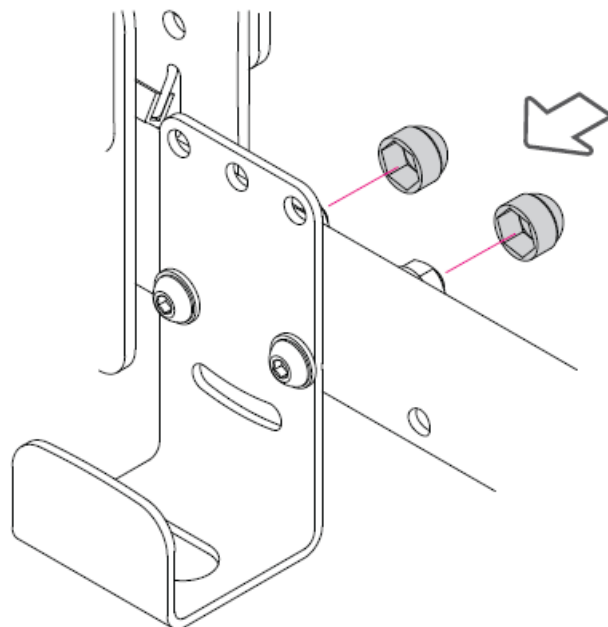

C

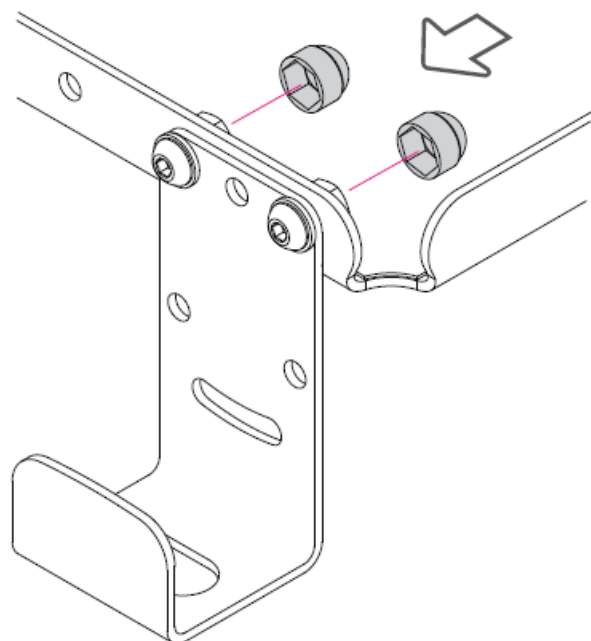

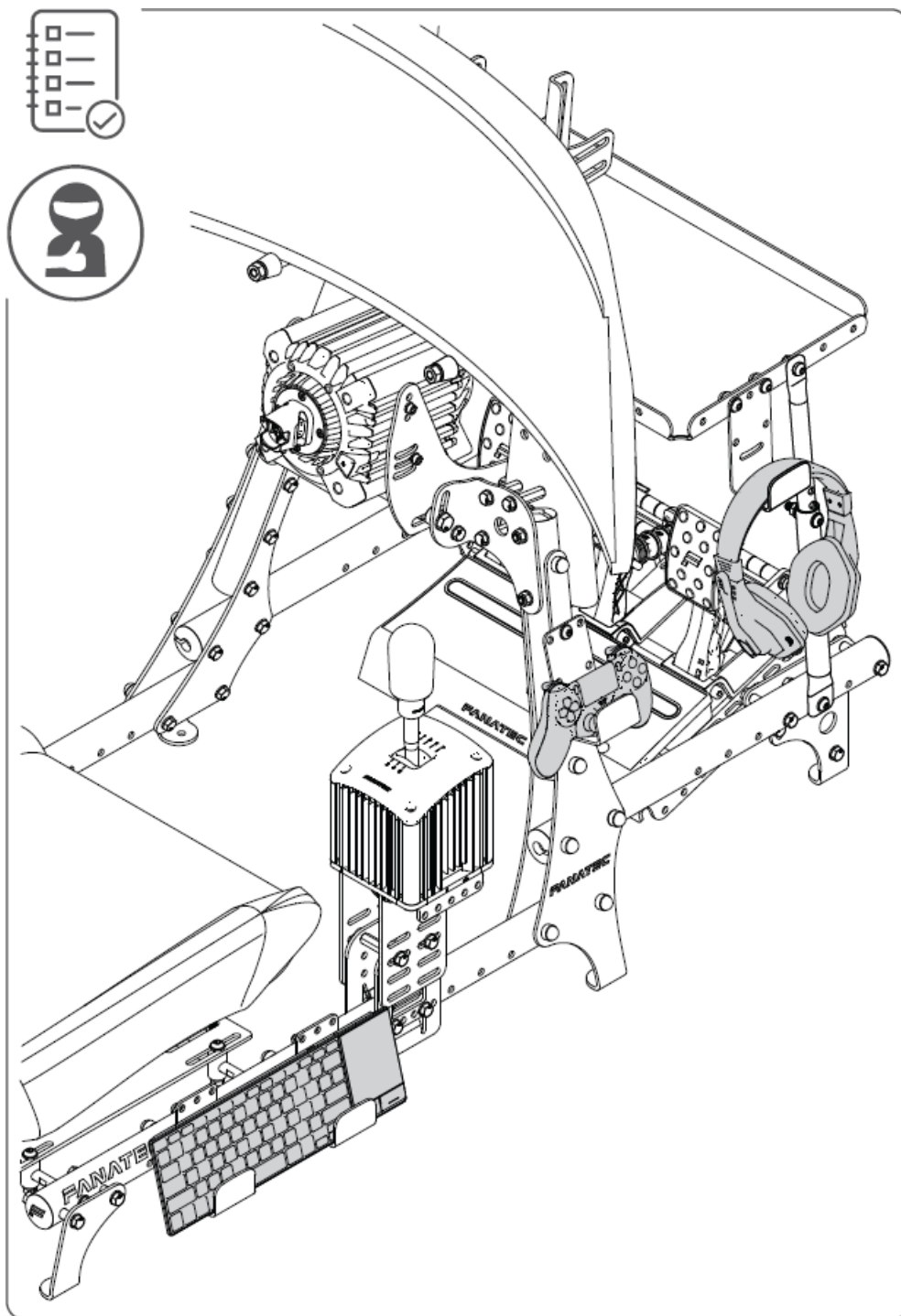

SUPPORT

- [Fanatec.com/QR/CSL-C-KH](https://fanatec.com/QR/CSL-C-KH)
- [Fanatec.com/app](https://fanatec.com/app)
- [Fanatec.com/support/faq](https://fanatec.com/support/faq)



The product warranty is provided by Corsair GmbH. Refer to the terms & conditions of Corsair GmbH on [fanatec.com](https://www.fanatec.com).

CONTACT

Fanatec® is a registered trademark of Corsair GmbH

- E.ON-Allee 5 – 84036 Landshut – Germany
- Telephone: 00800 0 FANATEC or +49 (871) 9221 -122
- US/CAN Telephone: 011 800 0 FANATEC or +49 (871) 9221 -122
- Australia Telephone: 00800 0 FANATEC or +49 (871) 9221 -122
- Japan Telephone: 03-6717-2719 or +49 (871) 9221 -122
- Email: info.webshop@fanatec.com
- Internet: www.fanatec.com – www.corsair.com

CORSAIR MEMORY, BV.

- Wormerweg 8, 1311 XB, Almere, Netherlands

CORSAIR COMPONENTS, Ltd.

- 1020 Eskdale Road, Winnersh Triangle,
- Wokingham, RG41 5TS, UK

CORSAIR MEMORY, Inc.

- 115 North McCarthy Blvd, Milpitas, CA 95035, USA

Documents / Resources

	<p>FANATEC CSL-C-KH CSL Cockpit Keyboard Holder [pdf] Instruction Manual CSL-C-KH, CSL-C-KH CSL Cockpit Keyboard Holder, CSL Cockpit Keyboard Holder, Cockpit Keyboard Holder, Keyboard Holder, Holder</p>
---	---

References

- [Fanatec USA | Fanatec](#)
- [app | Fanatec](#)
- [YouTube](#)
- [Support / FAQ | Fanatec](#)
- [CORSAIR | PC Components | Gaming Gear](#)
- [User Manual](#)

Manuals+. Privacy Policy

This website is an independent publication and is neither affiliated with nor endorsed by any of the trademark owners. The "Bluetooth®" word mark and logos are registered trademarks owned by Bluetooth SIG, Inc. The "Wi-Fi®" word mark and logos are registered trademarks owned by the Wi-Fi Alliance. Any use of these marks on this website does not imply any affiliation with or endorsement.