



# FALWEDI UC0214 All-in-one USB-C Hub with Triple Display User Guide

[Home](#) » [FALWEDI](#) » **FALWEDI UC0214 All-in-one USB-C Hub with Triple Display User Guide** 

**FALWEDI UC0214 All-in-one USB-C Hub with**

# Triple Display User Guide

# FALWEDI

## Product Manual

ALL-IN-ONE USB-C HUB WITH TRIPLE DISPLAY

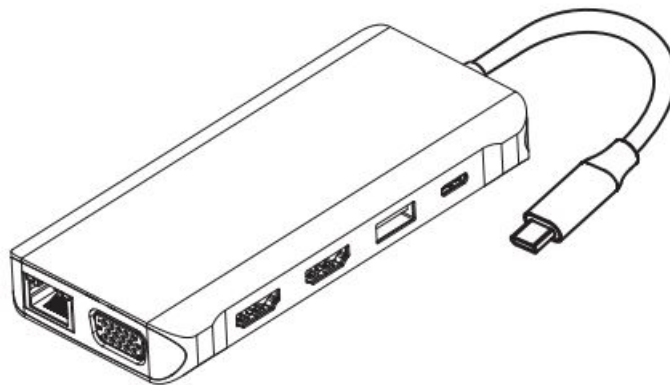

### Contents

- [1 Product Introduction](#)
- [2 Structure Diagram](#)
- [3 Specifications](#)
- [4 Sound Setting For Mac](#)
- [5 Sound Setting For Win 10](#)
- [6 Multiple Display Settings for Wins](#)
- [7 Dual Display Setting for Mac OS](#)
- [8 Resolution Setting](#)
- [9 Storage Conditions](#)
- [10 Troubleshooting](#)
- [11 Documents / Resources](#)
- [12 Related Posts](#)

### Product Introduction

This USB C 12 in 1 hub provides a stable connection and extensive compatibility to achieve multiple possibilities of connectivity and unlock ultimate convenience.

### Structure Diagram

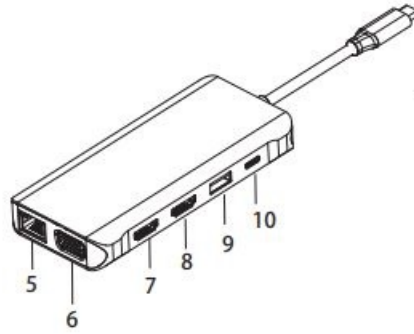
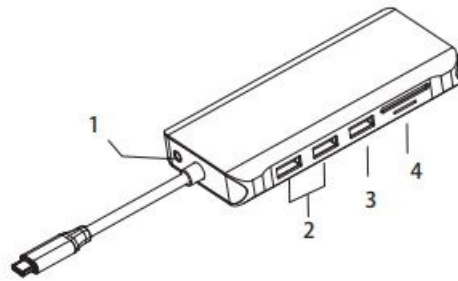

1. Audio/Mic
2. USB 3.0
3. USB 2.0
4. SD&TF
5. RJ45
6. VGA
7. HDMI 1
8. HDMI 2
9. USB 2.0
10. PD3.0

## Specifications

Product Model	UC0214
Connector	USB 3.1 Type-C connector
Dimension	4.8×2.13×0.65 inches
Cord Length	6 inches
Weight	0.37 lb
USB-C female charging port(PD3.0)	Only for USB-C laptop or USB-C smartphone charging. Input power can up to 87W but that request you to use at least 90W charger as the hub will consume part of the power.
HDMI output port	Resolution up to 4K/30Hz if two of them play simultaneously. When dual or triple display with VGA, they will be 1080P/60Hz. If your source is DP1.4, HDMI 2 can up to 4K/60Hz when single plays.
VGA output port	Resolution up to 1920×1080P/60Hz
RJ45 Gigabit Ethernet	Speed up to 1000Mbps max.
USB-A 3.0	Speed up to 5Gbps, 5V/0.9A@4.5W.
USB-A 2.0	Speed up to 480Mbps, 5V/0.5A@2.5W. We highly recommend to connect the mouse and keyboard( low rate devices)
SD/TF Card Reader	Support memory card capacity: up to 512 GB Read/write speed: up to 104 MB/s SD/TF memory cards can be used on the hub simultaneously.
Mic/Audio	Support Mic and Stereo Audio 2 in 1. If your headset/speaker is not CTIA /Apple standard, there will be a buzzing even if you fully plug it in. To solve the issue: please do not fully plug in.
Requirements	Laptop with available and fully functional USB-C port.
Plug and play	Yes

## Attention

1. Please confirm the compatibility of your device before using the hub (whether the Type C port of the computer is a full-function port).
2. When using the hub, please connect to the computer power supply synchronously to ensure the normal use of the various functions of the hub.
3. Please don't use violence to plug, to avoid damage to the port.

## Sound Setting For Mac

Apple logo>System Preferences>Sound

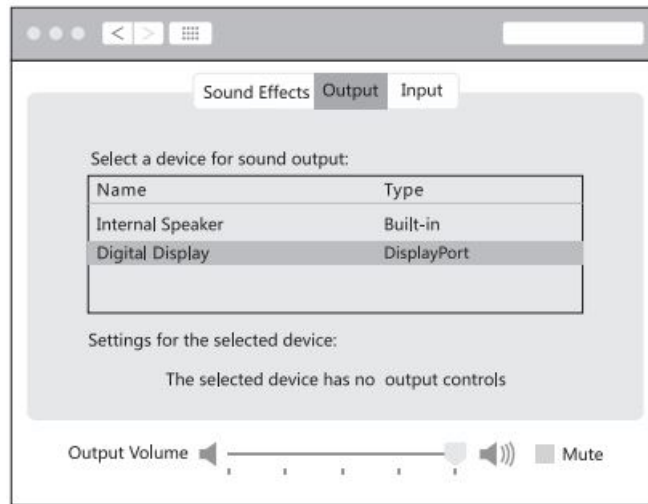

## Sound Setting For Win 10

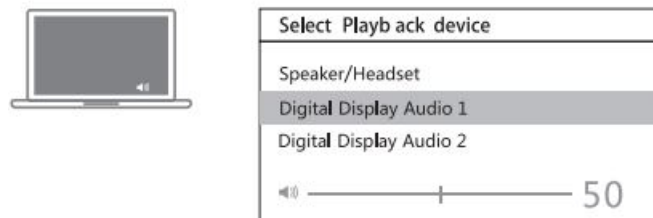

### Prerequisites for simultaneous operation of “computer screen + 3 display screens”:

(1) DP1.4 and AMD processor or (2) Computer models listed by Apple after 2018, when dual system is installed and WIN system is used.

## Multiple Display Settings for Wins

### NOTE

For most WIN system computers, when multiple external monitors are connected, at most 3 different screens will appear (one computer screen + external monitor 1 + external monitor 2, and the remaining external monitor will not light up), if you want the images of the three external monitors to be different, you need to turn off the computer screen.

### 1. Mirror Mode (Clone mode/SST)

Right click desktop >Graphics Settings >Display

General Settings	Select Display Mode
Color Settings	Single Display <span>1</span> <span>2</span> <span>3</span>
<b>Multiple Settings</b>	<input checked="" type="checkbox"/> Clone Display <span>Detect</span>
Custom Resolutions	Extended Desktop
DisplayPort Topology	Collage
	Select One or More Active Displays
	<span>Built-in Display</span> ▼
	<span>HDMI Display</span> ▼
	<span>HDMI Display</span> ▼

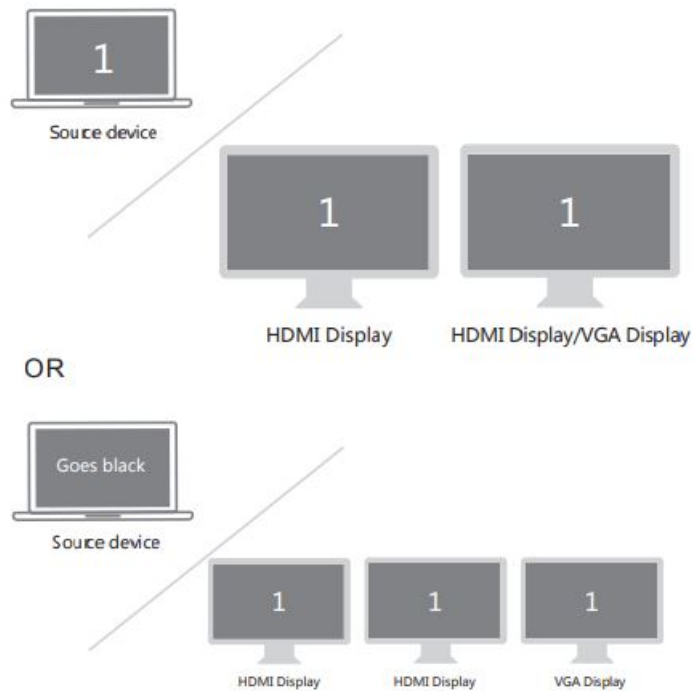

## 2. Extended Mode (MST)

Right click desktop >Graphics Settings >Display

General Settings	Select Display Mode
Color Settings	Single Display <input type="text" value="1"/> <input type="text" value="2"/> <input type="text" value="3"/>
Multiple Settings	Clone Display Detect
Custom Resolutions	<input checked="" type="checkbox"/> Extended Desktop
DisplayPort Topology	Collage
	Select One or More Active Displays
	Built-in Display ▼
	HDMI Display ▼
	HDMI Display ▼

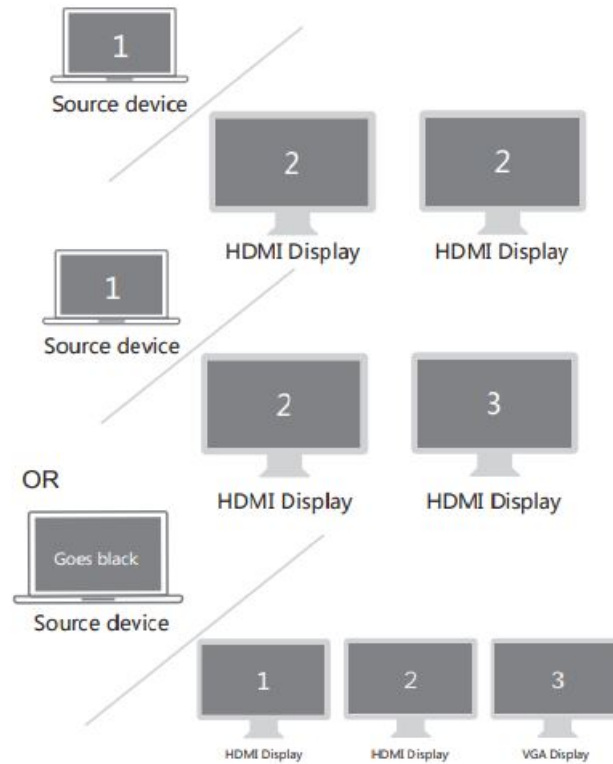

### 3. Collage

NOTE: For this mode, PC or Notebook's Video card MUST support MST  
 Right click desktop >Graphics Settings >Display

General Settings	Select Display Mode	Arrange Display		
Color Settings	Single Display	<input checked="" type="checkbox"/> Horizontally		
Multiple Settings	Clone Display	Vertically		
Custom Resolutions	<input checked="" type="checkbox"/> Extended Desktop	<table border="1"> <tr> <td>1</td> <td>2</td> </tr> </table>	1	2
1	2			
DisplayPort Topology	Collage	Detect		
	<input checked="" type="checkbox"/> Enable			
	Disable			
	Select One or More Active Displays			
	Built-in Display ▼			
	HDMI Display ▼			
	HDMI Display ▼			

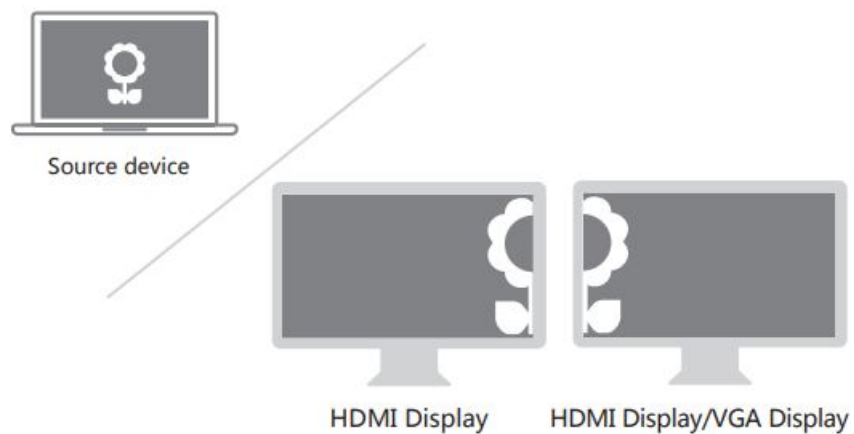

## Dual Display Setting for Mac OS

### 1. Mirror Display \_\_\_\_\_

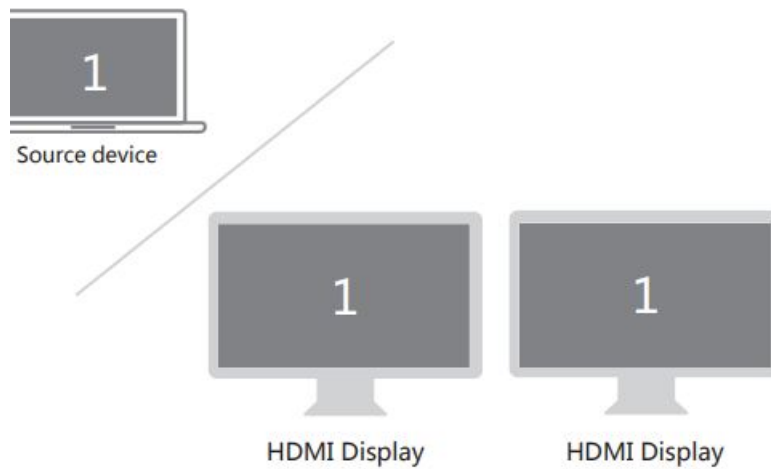
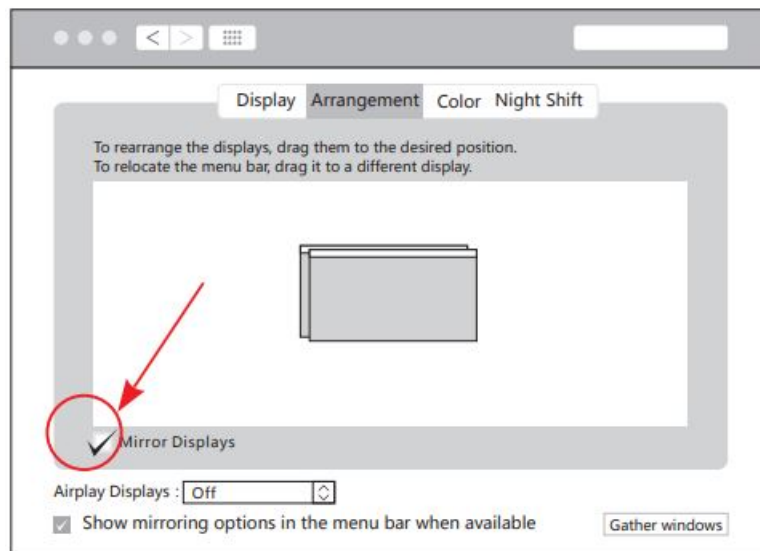

## 2. Extend Display —————

Apple logo>System Preferences >Displays

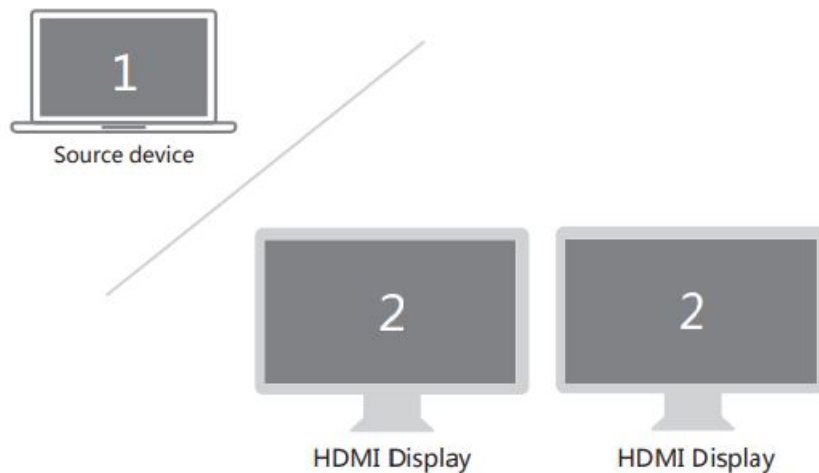
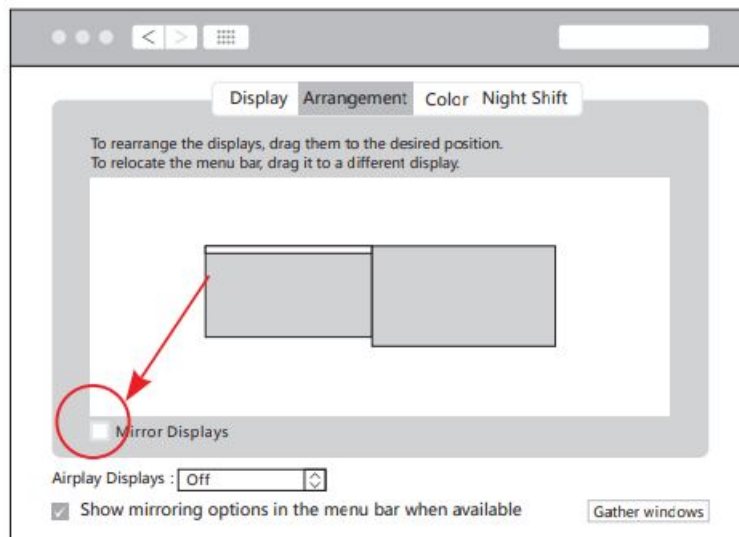

**Tip For Resolution:** The system will automatically select the resolution that is most suitable for the device currently in use. In order to reduce CPU consumption, it may not be the highest resolution supported by the device. If necessary, you can set it according to the following steps. (The specific resolution is determined by the device and connection method. If you have any questions, please contact us for confirmation.)

## Resolution Setting

### For Wins

Right click desktop > Display Settings

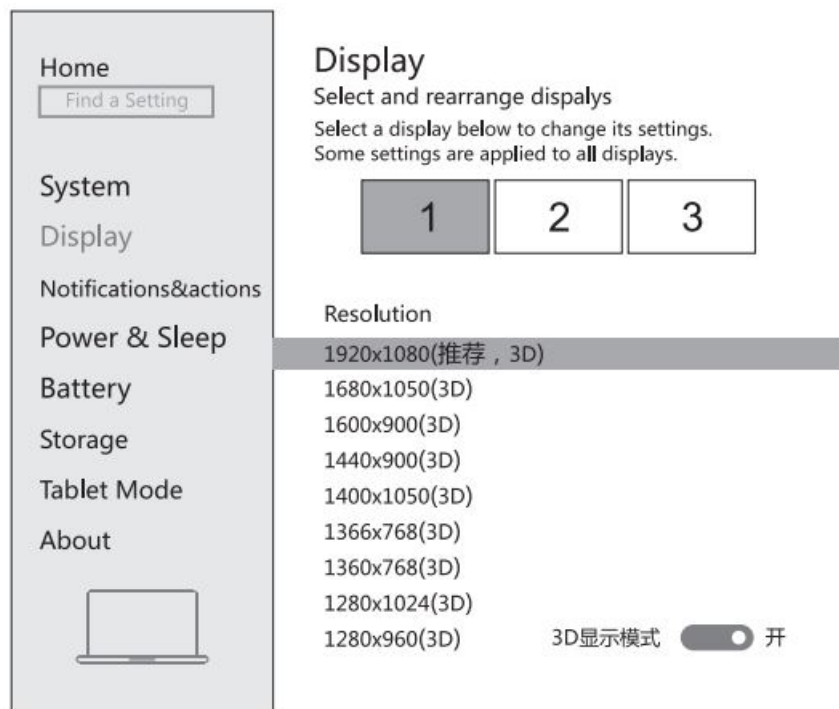

## For Mac OS

Apple logo>System Preferences>Display

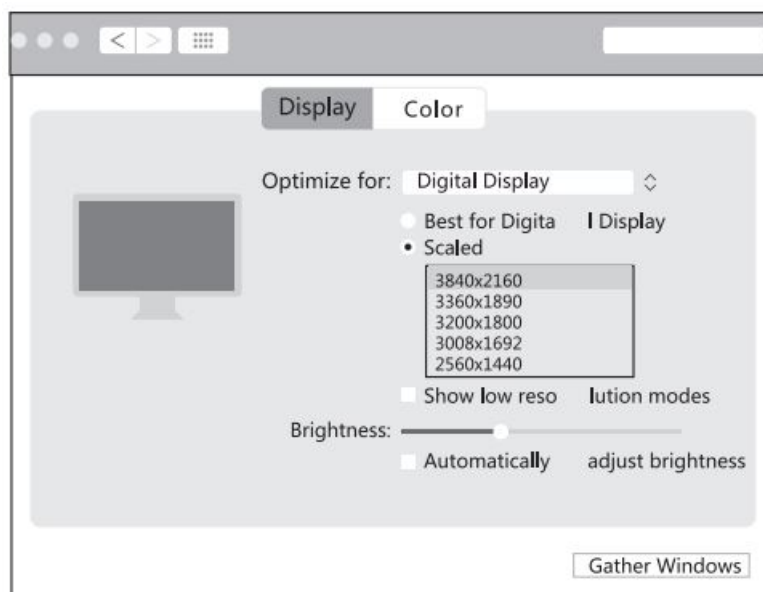

## Note:

1. Supports VGA and HDMI simultaneous output. However, the maximum resolution is 1080P when using them simultaneously.
2. This product DOES NOT support replication or extended displays when connecting the gaming device.
3. When a device with large power consumption such as a hard disk, it cannot be connected normally, please connect the charger to the USB-C female port of the product to power the computer, hard disk, etc.

## Storage Conditions

Ambient Operating Temperature: 0℥ to 70℥(32℥ to 158℥)  
Storage Temperature: -30℥ to 120℥(-22℥ to 248℥)  
Ambient Operating Humidity: 20%-80%RH  
Storage Humidity: 20%-90%RH

## Troubleshooting

- ① Please contact E-mail: [support@myfalwedi.com](mailto:support@myfalwedi.com)
- ② Or through the below steps on the product page to send the message:

The image shows three sequential steps for contacting support on an Amazon product page:

- Step 1:** A screenshot of the product page showing the 'Add to Cart' and 'Buy Now' buttons. Below them, it says 'Secure transaction' with a red circle '1' and 'Click Here'. Further down, 'Ships from Amazon' and 'Sold by Falwedi Direct' are shown, with a red box around 'Falwedi Direct' and a red arrow pointing to it.
- Step 2:** A screenshot of a section titled 'Have a question for Falwedi Direct?'. It features a red circle '2' and 'Click Here' next to an 'Ask a question' button, which has a red arrow pointing to it.
- Step 3:** A screenshot of the 'Seller Messaging Assistant' interface. It shows a message from the assistant: 'Hi, I'm the messaging assistant for Amazon's selling partners. What can I help you with? 12:53 AM'. Below this are two buttons: 'An order I have placed' and 'An item for sale'. A red circle '3' and the text 'Select a corresponding option to send us message.' are at the bottom, with a red arrow pointing to the 'An item for sale' button.

## Documents / Resources

	<a href="#">FALWEDI UC0214 All-in-one USB-C Hub with Triple Display</a> [pdf] User Guide All-in-one USB-C Hub with Triple Display, UC0214
--	----------------------------------------------------------------------------------------------------------------------------------------------

