



Contents [[hide](#)]

- [1 Fala IOT S22 Series Remote Detector](#)
- [2 Product Information](#)
- [3 Product Overview](#)
- [4 Operating Steps](#)
- [5 External Sensor Port](#)
- [6 Charging](#)
- [7 Product Specifications](#)
- [8 Troubleshooting Guide](#)
- [9 Warranty Statement](#)
- [10 FCC Statement](#)
- [11 FAQ](#)
- [12 Documents / Resources](#)
 - [12.1 References](#)

Fala IOT

Fala IOT S22 Series Remote Detector



Product Information

This product is designed to provide users with efficient performance and easy usability. It comes with multiple features to enhance user experience.

Product Overview

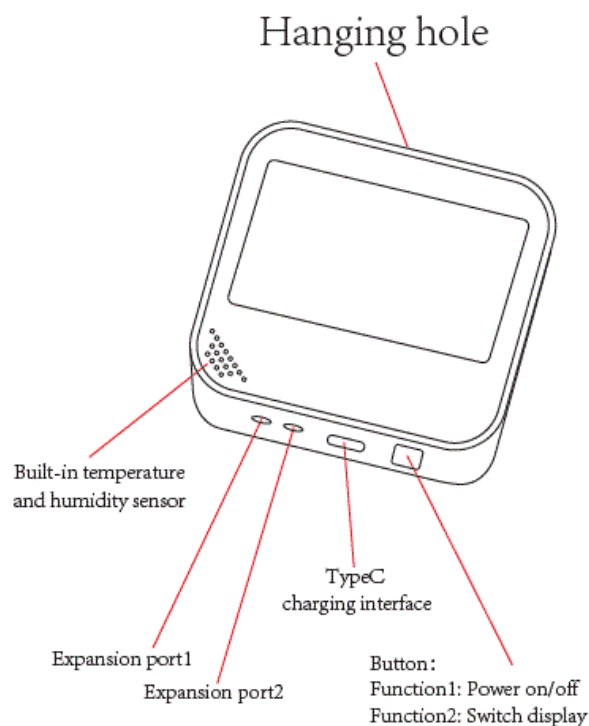

Operating Steps

- Scan QR code or go to website to get instant video guide.
- **Website:** <https://ws.fala-iot.com/youtube.html>



1. Power On

Open battery cover at the back, insert original lithium battery. Then device will power on automatically. Ensure correct polarity. Note: Differentiate battery polarity when installing.

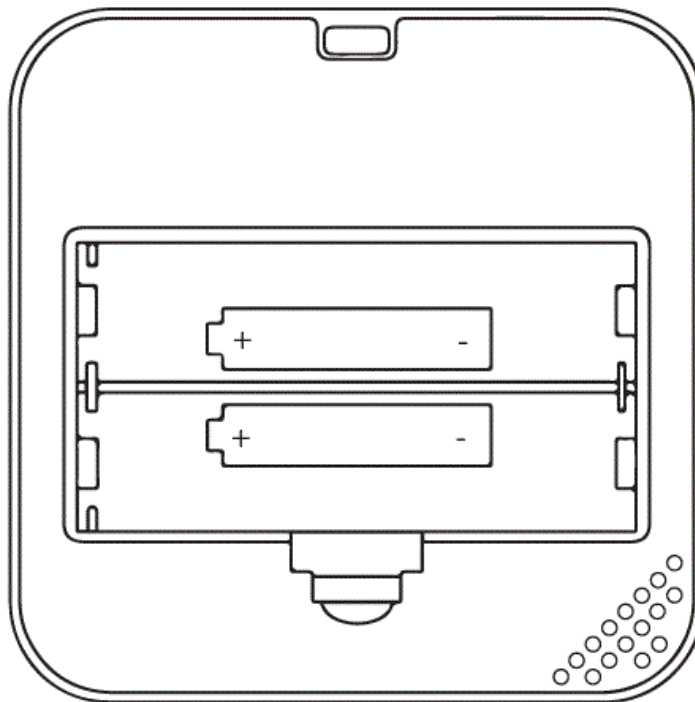

2. Download the free App



- **Android:** Scan QR code above in your browser to download app.
- **IPhone:** Get “FALA IOT” from App Store.
- **Pad/PC:** <https://fala-iot.com/ipc>

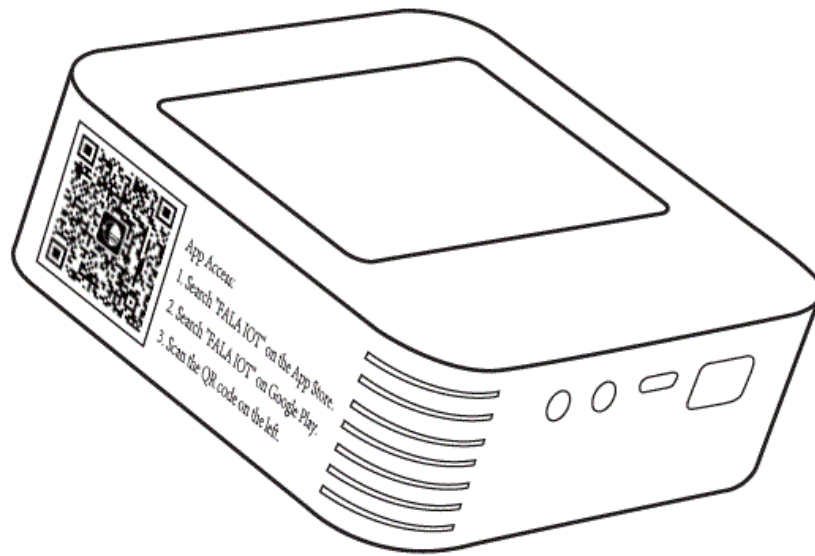

Note: You can also find this QR code for download on the left side of the product.



After installing the app, “FALA IOT” will appear on your phone’s home screen. Please enter the app and register your account.

Device Binding

Open the “FALA IOT” App.

1. Sign in your account, go to the “Home” page and click the ‘+’ to add a new device.
2. Scan or manually enter the device number, name the device, and then complete the addition.

If your model is S22D (Wi-Fi version), follow the in-app instructions to finish network setup.

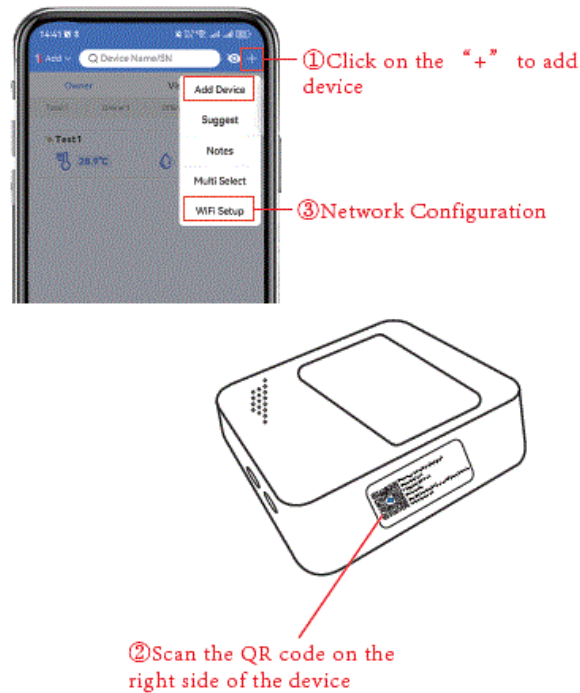

External Sensor Port

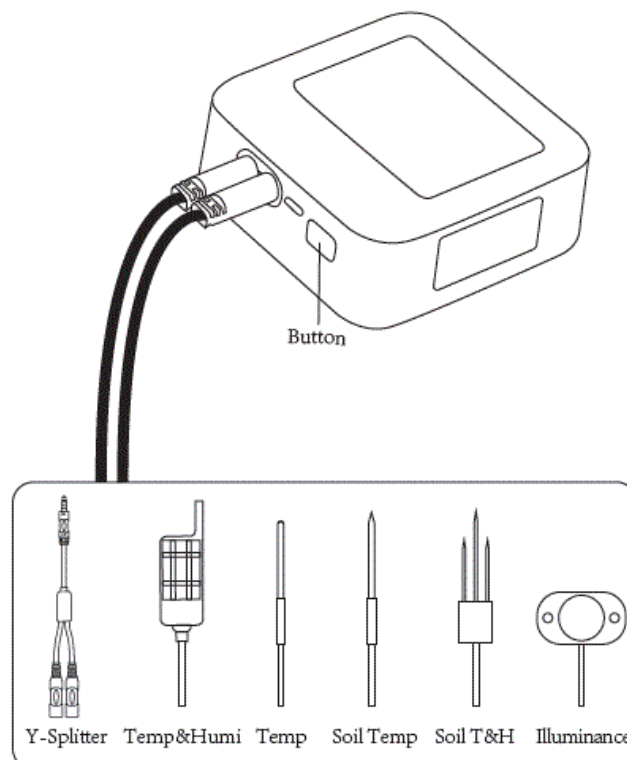

- The S22 series products have two sensor expansion ports reserved, in addition to the built-in temperature and humidity sensor.
- The ports only support the connection of external sensors manufactured by FALA IOT.
- The device needs to be restarted after each plug/unplug sensor operation.

- **Long-press button:** Power on/off
- **Click button:** Switch the displayed sensor

Charging

Charging with a TypeC Cable and a 5V1A Adapter

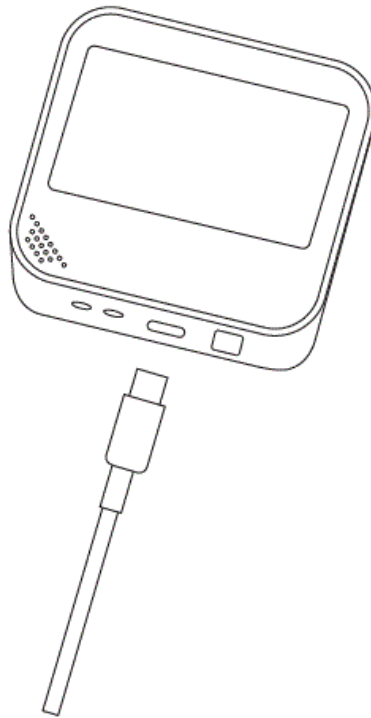

Product Specifications

Model	S22D
Communication Protocol	2.4GHz WIFI & Bluetooth 5.2
Average Power Consumption	≤15mW
Data Upload Frequency	≥3 minutes/time (adjustable)
Alarm Delay	About 15 seconds (affected by network signal)
Operating ambient temperature	-20°C~ 60°C (-4°F~ 140°F)
Temperature Measurement Range	-20°C~ 60°C (-4°F~ 140°F)

Temperature Measurement Accuracy	±0.3°C (0.6°F)
Humidity Measurement Range	0~100%RH
Humidity Measurement Accuracy	±3%RH
Battery	18650 lithium battery 3.7V 2600mAh ×2
Charging	USB TypeC
Adapter	5V1A
Power Time	About 4 months (@ 5-min uploads in good signal)
Device Dimensions	90mm*90mm*32mm
External Sensor Ports	Yes
Data Storage Duration	1 Year (@5min upload)

Cautions

1. Please use this product in an area with good signal coverage.
2. Please place this product in a cool and ventilated area or add a sunshade to avoid direct sunlight that can cause the shell to heat up, as it will severely affect the measurement accuracy.
3. Please keep the device clean.
4. This is a high-precision device. Do not disassemble it!

Troubleshooting Guide

Product Series	S22D	
Error Codes	Cause	Solution

Err 01	Network module startup exception	<ol style="list-style-type: none"> 1. Check the battery health status. 2. Remove the battery, wait for 1-2 minutes, then reinstall it.
Err 04	Router connection abnormality	<ol style="list-style-type: none"> 1. Check if the device is connected to the network and try reconnecting it. 2. Check if the router is functioning properly or if there are not too many devices connected to it. You
Err 05	Server connection failure	<ol style="list-style-type: none"> 1. Check router for smooth Internet. 2. Confirm no device restrictions on router. 3. Consider upgrading router for better performance if overloaded.
Err 06		
Err 07		
Err 12	Network module startup exception	<ol style="list-style-type: none"> 1. Check the battery health status. 2. Remove the battery, wait for 1-2 minutes, then reinstall it.
—	Sensor probe failure.	
Momentary value is -45°C	Check if there is any wire wrapped around the probe.	

Attention

1. S22DN does not have built-in sensors, please connect external sensors first.
2. If the display is still abnormal after troubleshooting the above code, please contact FALA IOT Customer Service Team for resolution.

Warranty Statement

FALA IOT guarantees to all direct purchasers the following:

1. 7-Day Return, Exchange, or Repair Policy
 - If the product is defective within 7 days of purchase, the consumer has the option to return, exchange, or repair the product.
2. 8-12 Day Exchange or Repair Policy
 - If the product exhibits performance issues within 8 to 12 days of purchase, the consumer may choose to exchange or repair the product.
 - In case of an exchange request, FALA IOT will provide a replacement product of the same model and specifications. If the same model is no longer in production, FALA IOT will offer a product that is not inferior in performance to the original. However, if the FALA IOT after-sales service department determines that the product is not faulty, it will be returned to the consumer.
 - The consumer is advised to backup all important data regularly, as FALA IOT only repairs the product and assumes no responsibility for any failure in data recovery.
 - This warranty is offered solely to the original purchaser and is non-transferable.

Warranty Exclusions

The product warranty does not cover the following scenarios:

1. Failures resulting from unauthorized modifications, disassembly, or repairs.
2. Damages caused by force majeure events (e.g., floods, fires, earthquakes, lightning, typhoons) or intentional misuse (e.g., impact, drops, ruptures, blows, improper handling).
3. Damage to the product's shell, deformation, or other abnormalities due to external forces.
4. Claims made after the expiration of the warranty period.

FCC Statement

This equipment has been tested and found to comply with the limits for a Class B digital device, pursuant to part 15 of the FCC rules. These limits are designed to provide reasonable protection against harmful interference in a residential installation.

This equipment generates, uses and can radiate radio frequency energy and, if not installed and used in accordance with the instructions, may cause harmful interference to radio communications. However, there is no guarantee that interference will not occur in a particular installation. If this equipment does cause harmful interference to radio or television reception, which can be determined by turning the equipment off and on, the user is encouraged to try to correct the interference by one or more of the following measures:

- Reorient or relocate the receiving antenna.
- Increase the separation between the equipment and receiver.
- Connect the equipment into an outlet on a circuit different from that to which the receiver is connected.
- Consult the dealer or an experienced radio/TV technician for help.

To assure continued compliance, any changes or modifications not expressly approved by the party. Responsible for compliance could void the user's authority to operate this equipment. (Example- use only shielded interface cables when connecting to computer or peripheral devices).

This equipment complies with Part 15 of the FCC Rules. Operation is subject to the following two conditions:

1. This device may not cause harmful interference, and
2. This device must accept any interference received, including interference that may cause undesired operation.

FCC Radiation Exposure Statement

The equipment complies with FCC Radiation exposure limits set forth for uncontrolled environment. This equipment should be installed and operated with minimum distance 20cm between the radiator and your body.

Certificate of Conformity

- **Inspector:**
- **Production Date:**
- Xuzhou Fala Electronic Technology Co., Ltd.
- **Address:** C10, Yongjia Science and Technology Park, Xuzhou, Jiangsu Province, China.
- **Phone number:** +86 051687879980
- **Email:** support@fala-iot.com
- **Sensor Login:** fala-iot.com/ipc

FAQ

- **Q: How do I troubleshoot if the device is not powering on?**
 - A: Make sure the power source is working and the device is properly connected. If the issue persists, contact customer support.
- **Q: Can I use this product with other devices?**
 - A: This product is compatible with most devices that support a 5V power input. Check the device specifications before use.

Documents / Resources

	Fala IOT S22 Series Remote Detector [pdf] User Manual S22D, 2BQHJ-S22D, 2BQHJS22D, S22 Series Remote Detector, S22 Series, Remote Detector, Detector
---	---

References

- [User Manual](#)

■ Fala

IOT

◆ 2BQHJ-S22D, 2BQHJS22D, Detector, Fala IOT, Remote Detector, S22 Series, S22 Series Remote Detector, S22D

Leave a comment

Your email address will not be published. Required fields are marked *

Comment *

Name

Email

Website

☐ Save my name, email, and website in this browser for the next time I comment.

Post Comment

Search:

e.g. whirlpool wrf535swhz

Search

[Manuals+](#) | [Upload](#) | [Deep Search](#) | [Privacy Policy](#) | [@manuals.plus](#) | [YouTube](#)

This website is an independent publication and is neither affiliated with nor endorsed by any of the trademark owners. The "Bluetooth®" word mark and logos are registered trademarks owned by Bluetooth SIG, Inc. The "Wi-Fi®" word mark and logos are registered trademarks owned by the Wi-Fi Alliance. Any use of these marks on this website does not imply any affiliation with or endorsement.