

FAGERHULT
FAGERHULT G3 Sensor
With Quick Connection
Box



FAGERHULT G3 Sensor With Quick Connection Box Instruction Manual

[Home](#) » [FAGERHULT](#) » FAGERHULT G3 Sensor With Quick Connection Box Instruction Manual 

Contents

- [1 FAGERHULT G3 Sensor With Quick Connection Box](#)
- [2 Key Features](#)
- [3 Recessed](#)
- [4 Surface](#)
- [5 Suspended](#)
- [6 FAQs](#)
- [7 Documents / Resources](#)
 - [7.1 References](#)
- [8 Related Posts](#)

FAGERHULT

FAGERHULT G3 Sensor With Quick Connection Box



Key Features

1. **Occupancy and Daylight Sensing:** The G3 Sensor uses occupancy detection to turn lights on or off based on whether a space is in use. It also incorporates daylight harvesting, adjusting lighting based on available natural light to maintain an optimal level of illumination.
2. **Energy Efficiency:** The automatic dimming or switching off of lights reduces energy consumption, helping to cut electricity costs and lower carbon footprints.
3. **Quick Installation:** The Quick Connection Box simplifies the installation process, enabling faster and easier integration into existing systems without the need for complex wiring or specialized tools.
4. **Integration with Building Management Systems (BMS):** The sensor can be linked to broader BMS setups, enhancing control and facilitating smart building management.

Organic Response I/O box

Recessed

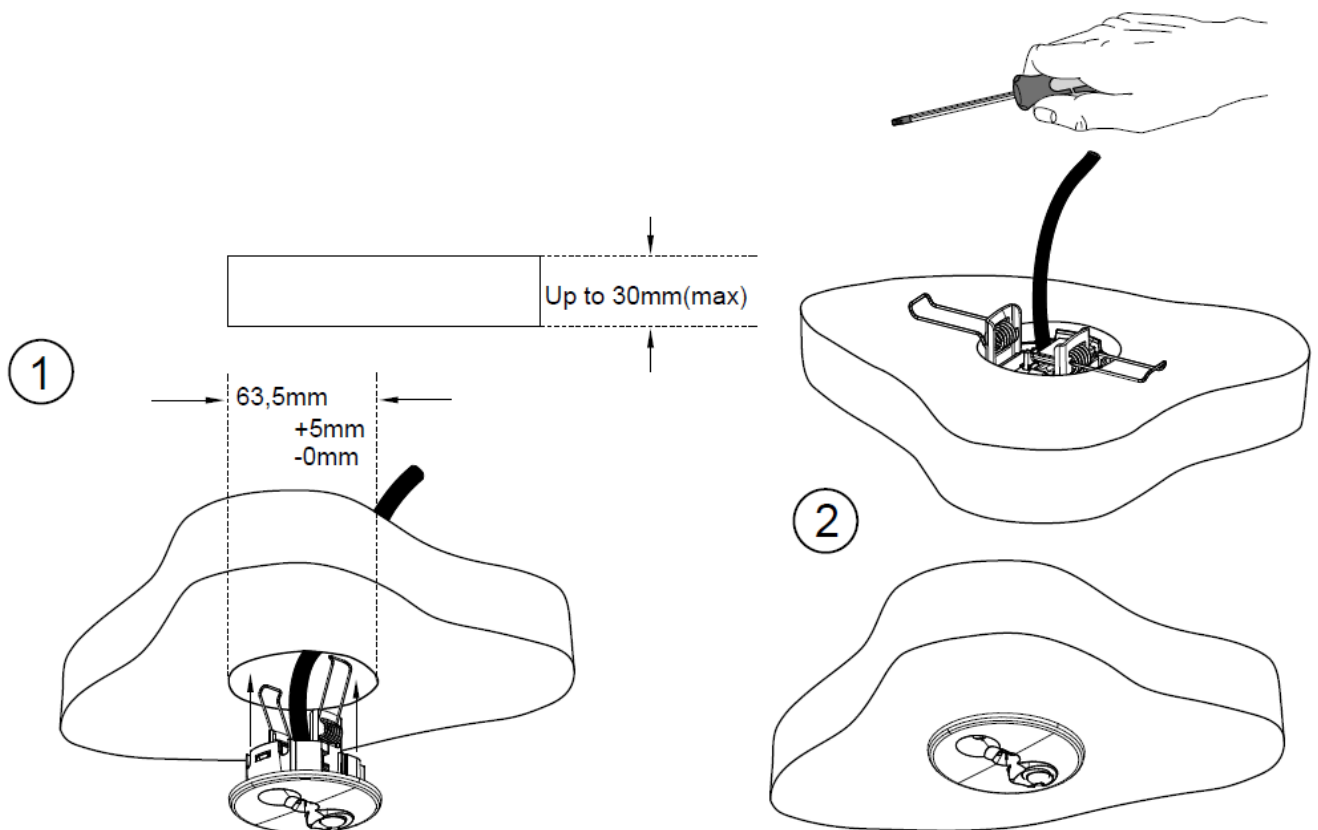

Surface

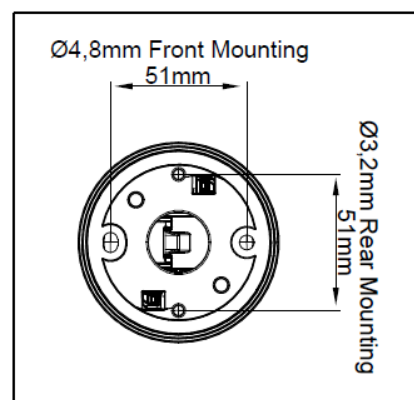
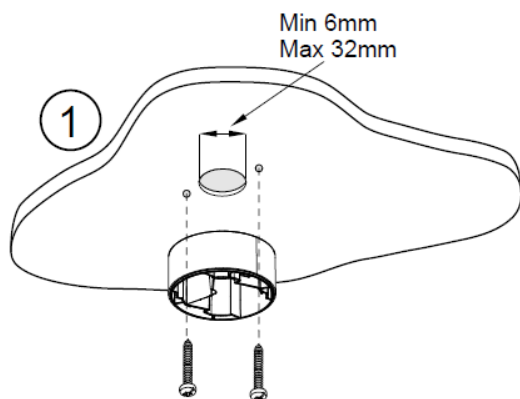

ALT

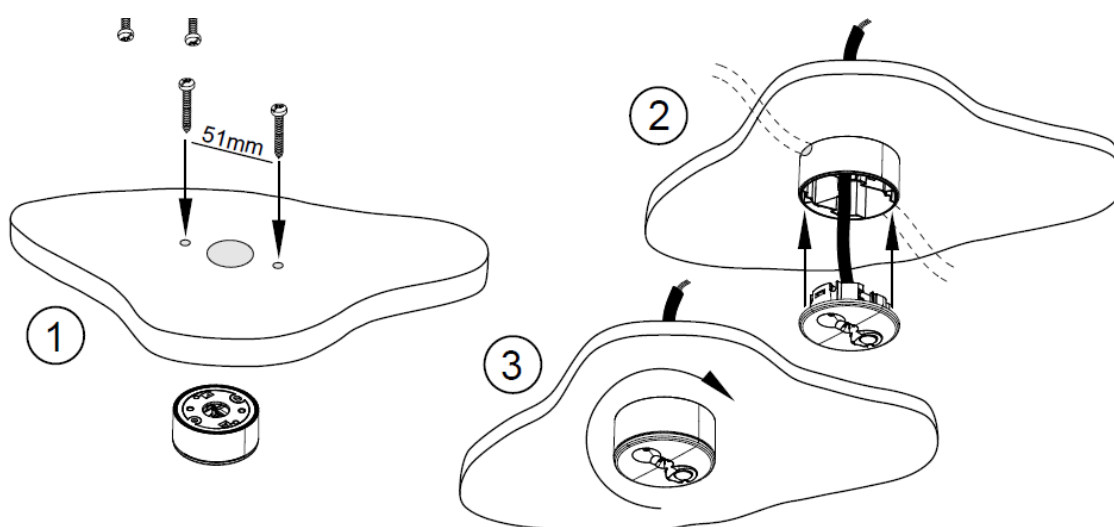

It is appropriate that this information is passed on to the users of the installation.

Manufactured by Fagerhult Sweden. For UK market importer Fagerhult UK 33-34 Dolben Street, London, SE1
OUQ

Suspended

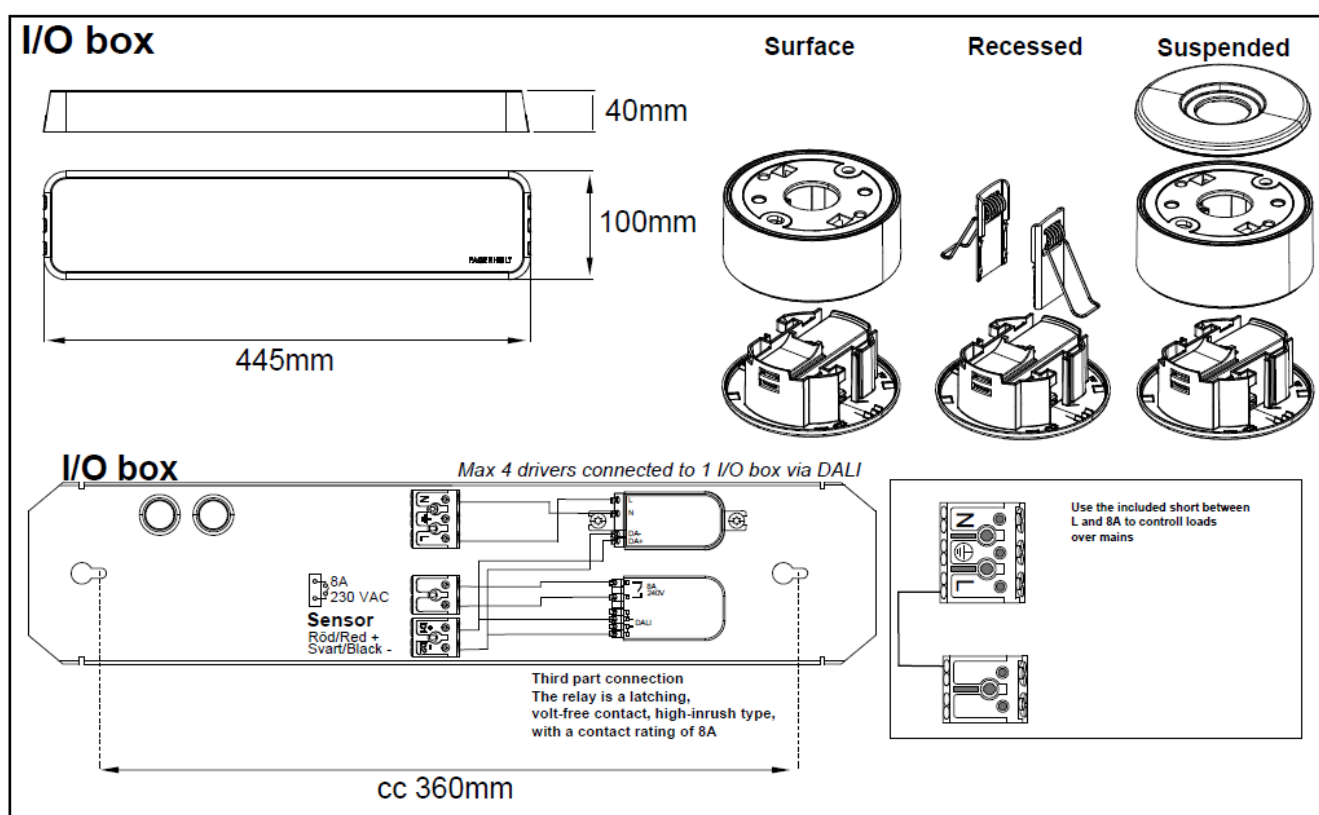
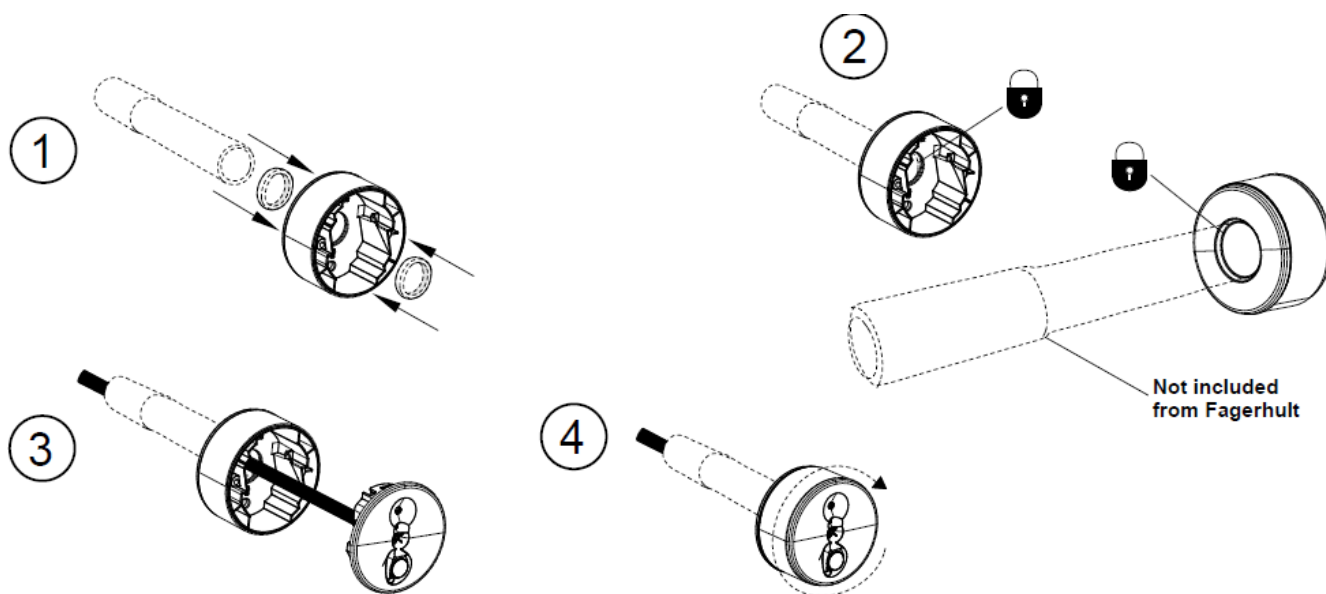

Basic insulation between mains and control wiring.

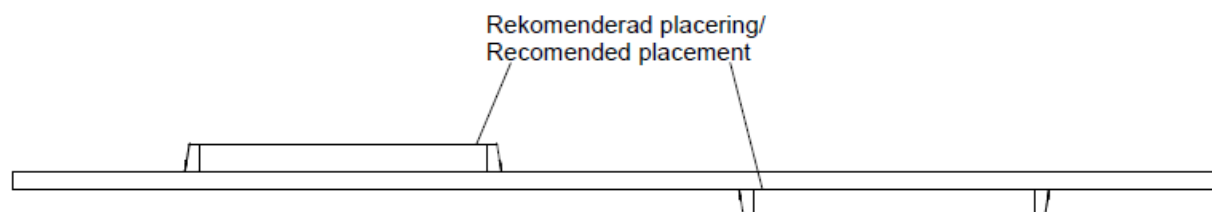

<https://www.fagerhult.com/lighting-control/>

FAQs

1. How does the G3 sensor optimize energy use?

It automatically dims or switches off lights based on room occupancy and ambient light levels, reducing energy consumption when lighting is not required.

2. Is the G3 sensor compatible with other Fagerhult products?

Yes, it is designed to work seamlessly with other components of the Organic Response system and can integrate with a variety of lighting systems.

3. Can the sensor be used in outdoor environments?

While primarily designed for indoor applications, specific models may be suitable for outdoor use depending on environmental factors and additional protective casing.

4. What are the installation requirements?

The Quick Connection Box allows for fast, tool-free installation, reducing setup time and making it easier to integrate into existing lighting systems.

5. What types of spaces are best suited for the G3 sensor?

It is ideal for spaces like offices, corridors, meeting rooms, and other commercial or industrial environments where lighting needs change throughout the day.

Documents / Resources

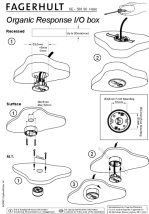
 A technical diagram of the Fagerhult Organic Response I/O box. It shows the internal components, including a sensor, a microcontroller, and a power supply. The diagram is labeled with 'FAGERHULT Organic Response I/O box' and includes a 'WARNING' section with safety instructions. It also shows the connection points for the sensor and the power supply.	<p>FAGERHULT G3 Sensor With Quick Connection Box [pdf] Instruction Manual G3 Sensor With Quick Connection Box, G3, Sensor With Quick Connection Box, Quick Connection Box, Connection Box</p>
---	---

References

- [F Lighting control - Fagerhult](#)
- [User Manual](#)

[Manuals+](#), [Privacy Policy](#)

This website is an independent publication and is neither affiliated with nor endorsed by any of the trademark owners. The "Bluetooth®" word mark and logos are registered trademarks owned by Bluetooth SIG, Inc. The "Wi-Fi®" word mark and logos are registered trademarks owned by the Wi-Fi Alliance. Any use of these marks on this website does not imply any affiliation with or endorsement.