



EZVIZ T51C Temperature and Humidity Sensor User Guide

[Home](#) » [ezviz](#) » EZVIZ T51C Temperature and Humidity Sensor User Guide 

EZVIZ™ T51C Temperature and Humidity Sensor User Guide

Contents

- [1 Overview](#)
- [2 Setup](#)
- [3 Installation](#)
- [4 Specifications](#)
- [5 BATTERY INSTALLATION and REPLACEMENT](#)
- [6 Operations on the EZVIZ App](#)
- [7 INFORMATION FOR PRIVATE HOUSEHOLDS](#)
- [8 Documents / Resources](#)
 - [8.1 References](#)

Overview

1. Package Contents



Temperature & Humidity Monitor (x1)



3M Tape (x1)

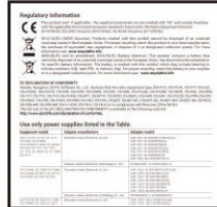

Regulatory Information (x1)



Quick Start Guide (x1)

2. Basics

Temperature & Humidity Monitor detects and displays the indoors temperature and humidity and then sends the related data to the linked EZVIZ gateway. After adding the Monitor to EZVIZ APP, you can view the related data on your phone in real time; moreover, it can trigger other EZVIZ smart products to provide you a smart home life.

Structure

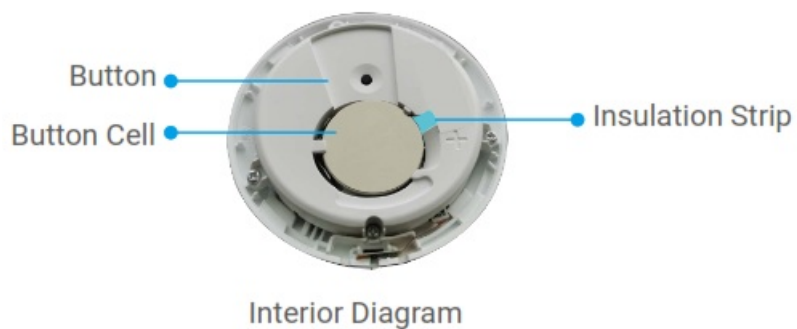

Name	Description
Button	<ul style="list-style-type: none"> • Press and hold the Button for 5s, the Temperature & Humidity Monitor will restart and then enter device adding mode; at the same time, the signal icon on the device screen will flash quickly. • Short press the Button to switch data display between degree centigrade (°C) and Fahrenheit degree (°F). • Quickly press the Button twice to switch between Normal Mode and High-performance Mode.

Display Screen



Setup

Follow the steps to set your monitor:

1. Get the EZVIZ app.
2. Power on your Temperature & Humidity Monitor.
3. Add the Monitor to your EZVIZ account.

1. Get the EZVIZ App

1. Connect your mobile phone to Wi-Fi (suggested).
2. Download and install the EZVIZ app by searching for “EZVIZ” in the App Store or Google Play™.
3. Launch the app and register an EZVIZ user account.

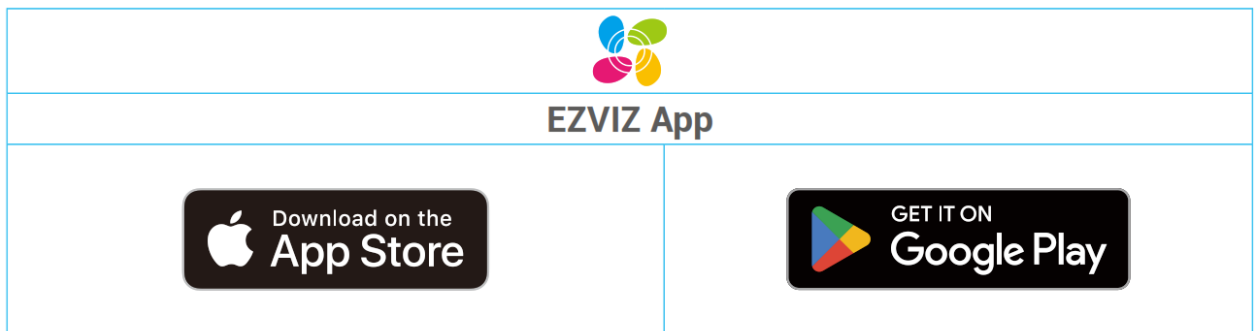

i If you have already used the app, please make sure that it is the latest version. To find out if an update is available, go to the app store and search for “EZVIZ”.

2. Power on Temperature & Humidity Monitor

Step 1 Remove Rear Cover

Remove the rear cover of the Temperature & Humidity Monitor by rotating it anticlockwise as shown in the figure below.

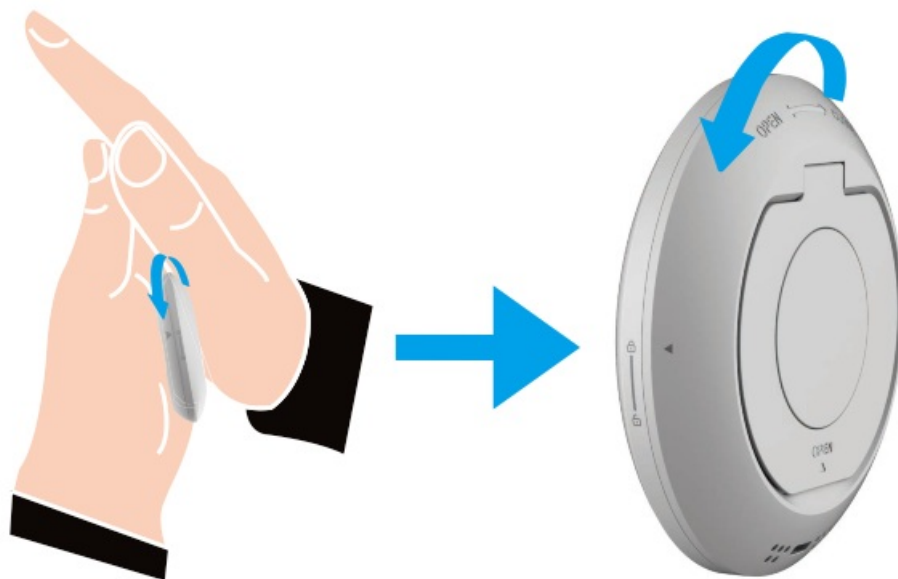

i It is recommended to put the Temperature & Humidity Monitor on your hands to press and twist it by your palm.

Step 2 Remove Insulation Strip

Take out the battery and draw out the battery insulation strip with your hand.



Insulation Strip

-  Please replace the battery in time when low power prompts on your phone.
- If you need to replace the battery, please purchase one CR2450.
- When replacing batteries, please insert with the positive side facing up.

3. Add Temperature & Humidity Monitor

-  The Monitor should be used along with EZVIZ ZigBee Smart Gateway (afterinafter referred to as "gateway"). Please add gateway to the EZVIZ Cloud by referring to the gateway user manual, and then add the Monitor to the gateway by following the below steps.

Method One: Add by Scanning QR Code

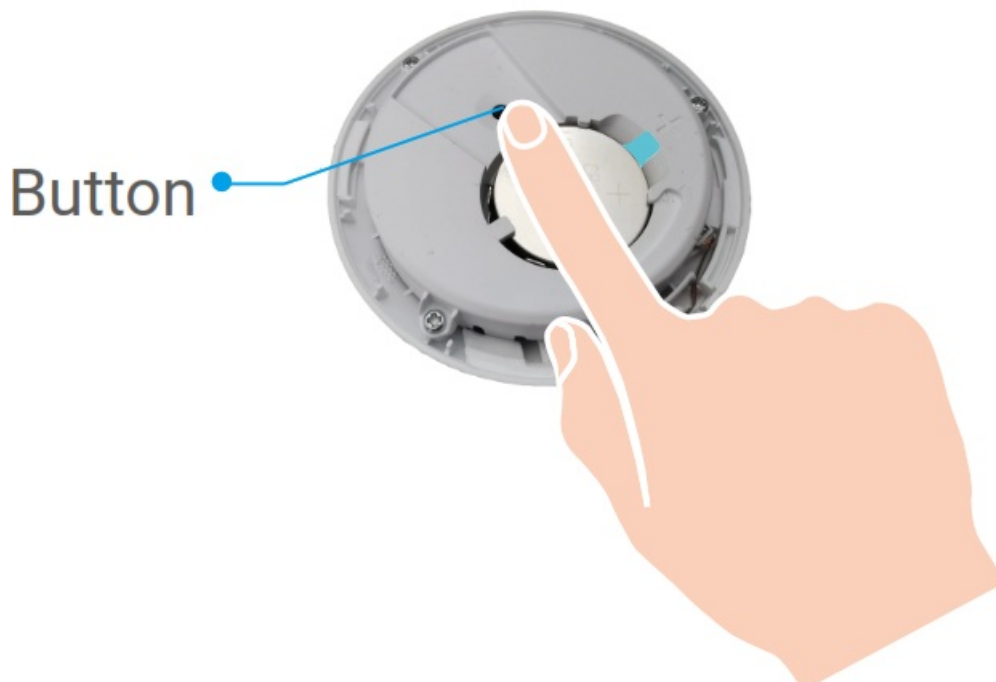

1. Log in to your account through EZVIZ app, tap the device adding icon and then the QR code scanning interface will be displayed.
2. Press and hold the Button of the Monitor for over 5s till the signal icon on Monitor screen flashes, and then the Monitor enters device adding mode.



Button

-  The Monitor will exit device adding mode automatically over 3 minutes.
3. Scan the QR code on the inner side of the cover or the cover of the user manual, and then add the Temperature & Humidity Monitor to the gateway.



4. Add the Temperature & Humidity Monitor to the gateway by following the wizard on the app.
5. Rotate tightly the rear cover of the Temperature & Humidity Monitor clockwise till the aligning mark  on rear cover is aligned with the mark  on the front cover.



Method Two: Add by the Gateway

 When adding Temperature & Humidity Monitor by the gateway, place the Monitor as close to the gateway as possible.

1. Press the Function Button of the gateway to make the gateway enter device adding mode.



2. Press and hold the Button of the Monitor for over 5s till the signal icon on Monitor screen flashes, and then the Monitor enters device adding mode.

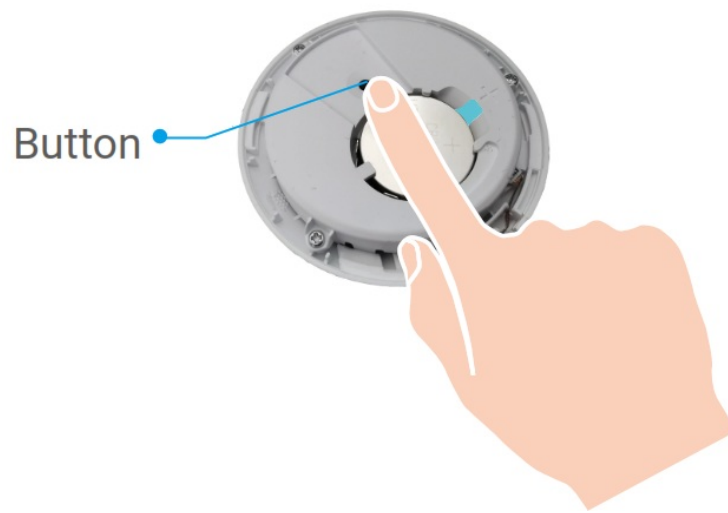

3. The Monitor has been added to the gateway successfully and the gateway prompts adding successfully.
4. After the Temperature & Humidity Monitor is added successfully, rotate the Monitor rear cover clockwise to tighten the rear cover till the aligning mark ► on rear cover is aligned with the mark 🔒 on the front cover.



Installation

- ⓘ Metal will cause ZigBee signal attenuation, so please do not install the Monitor on a metal door, it is recommended to install it on the wall next to the door.
- Do not install the Monitor in an environment with corrosivity or intense magnetic fields.
- It is recommended that the distance between the Monitor and gateway be less than 20m. If there are walls between them, the number of walls should be no more than 2.
- It is recommended to use the Monitor in a house with an area of no more than 200 square meters; if your house is too large, please purchase two or more Monitors for a better using experience.
- Before sticking 3M tape, please swipe the dust on the installation surface to enhance the tape stickiness; do not stick it on a lime wall.

Please place the Monitor on desktop as you needed, or you can stick it on the wall below 1 meter with 3M tape.

Place on the desktop

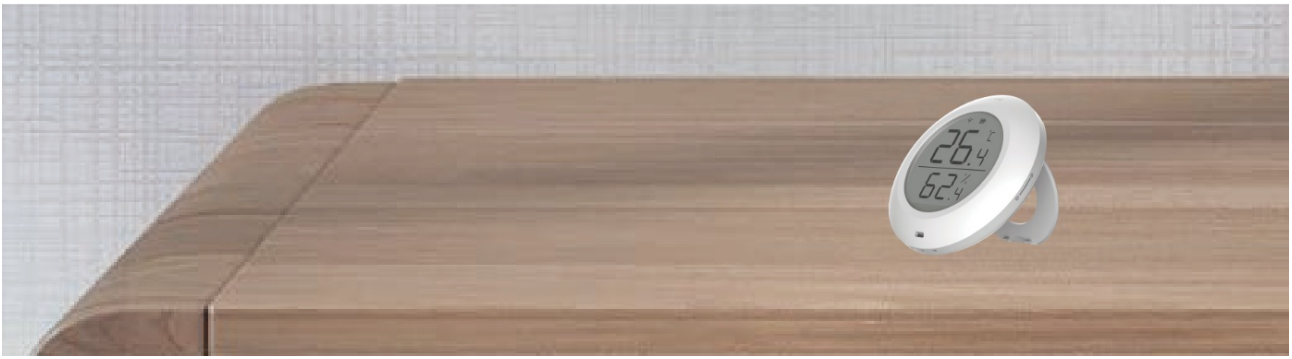

Stick on the place you needed (with 3M tape)



Specifications

Working Temperature	-10°C ~ 60°C
Working Humidity	0%~99%RH
Wireless Protocol	ZigBee 3.0
Battery Type	CR2450
Battery Duration	12 months

 For additional information about the device, please refer to www.ezviz.eu.

BATTERY INSTALLATION and REPLACEMENT

1. Install Battery

Tear off the battery insulation, put the battery into the baseplate and insert it to the end.

2. Replace Battery

Remove the battery from baseplate and replace battery with the Lithium Battery CR2450 purchased by a regular manufacturer. Test the device for correct operation whenever the batteries are replaced after re-fitting the device onto the base plate.

If the device is not working properly, please add the device and configure the network again by following the steps in Setup part or directly contact our technical support.

- Risk of explosion if the battery is replaced by an incorrect type.
- Improper replacement of the battery with an incorrect type may defeat a safeguard(for example, in the case of some lithium battery types).
- Do not dispose of the battery into fire or a hot oven, or mechanically crush or cut the battery, which may result in an explosion.
- Do not leave the battery in an extremely high temperature surrounding environment or extremely low air pressure, which may result in an explosion or the leakage of flammable liquid or gas.
- Dispose of used batteries according to the instructions.
-  identifies the battery holder itself and identifies the positioning of the cell(s) inside the battery holder.
- “+” identifies the positive terminal(s) of device which is used with, or generates direct current, “-” identifies the negative terminal(s) of device which is used with, or generates direct current.

3. Removable Lithium ion Battery(CR2450)

Ingredient	CAS No.	Content (wt%)
Lithium	7439-93-2	2.55(0.176 gram)
Propylene Carbonate	108-32-7	6.8
Manganese dioxide	1313-13-9	33.9
1,2-Dimethoxyethane	110-71-4	4.9
Lithium perchlorate	3/9/7791	1.8
Graphite	7782-42-5, 1333-86-4	3.7
Polypropylene	9003-07-0	1.8
Teflon	9002-84-0	1.8
Stainless steel	7439-89-6	42.75

Operations on the EZVIZ App

 The app interface may be different due to version update, and the interface of the app you installed on your phone shall prevail.

1. Homepage

Launch the EZVIZ app, open the homepage of the related gateway, you can manage your Temperature & Humidity Monitor as needed on the page.

Log	Detection log of the Mc
-----	-------------------------

2. Settings

parameter	Description
Device Name	Customize the name of your device.
Temperature/ Humidity Alarm	When enabled, the device will send an alarm message to notice you that the temperature or humidity exceeds the set values.
Temperature unit	You can check the current temperature unit of the Monitor.
Performance Mode	You can check the current performance mode of the Monitor.
Related Devices	You can see the gateway connected to your monitor.
Device Information	You can see the device information here.
Share	Share your device.
Delete Device	Tap to delete the Monitor from EZVIZ cloud.

INFORMATION FOR PRIVATE HOUSEHOLDS

1. Separate collection of waste equipment: Electrical and electronic equipment that has become waste is referred to as waste equipment. Owners of waste equipment must dispose of it separately from unsorted municipal waste. In particular, waste equipment does not belong in household waste, but in special collection and return systems.
2. Batteries and rechargeable batteries as well as lamps: Owners of waste equipment shall, as a rule, separate waste batteries and rechargeable batteries that are not enclosed in the waste equipment, which can be removed from the waste equipment without being destroyed, from the waste equipment before handing them in at a collection point. This does not apply if waste equipment is prepared for reuse with the participation of a public waste management authority.
3. Options for returning waste equipment: Owners of waste equipment from private households can return it free of charge to the collection points of the public waste management authorities or to the take-back points set up by manufacturers or distributors within the meaning of the Electrical and Electronics Equipment Law. Stores with a sales area of at least 400 m² for electrical and electronic equipment and those grocery stores with a total sales area of at least 800 m² that offer electrical and electronic equipment several times a year or on a permanent basis and make it available in the market are required to take it back. This also applies in the case of distribution using means of distance communication, if the storage and shipping areas for electrical and electronic equipment are at least 400 m² or the total storage and shipping areas are at least 800 m². Distributors shall, in principle, ensure take-back by providing suitable return facilities at a reasonable distance from the respective end user.

The possibility of returning waste equipment free of charge exists for distributors who are obliged to take it back, among other things, if a new similar device that essentially fulfills the same functions is delivered to an end user.

4. Privacy Notice: Waste equipment often contains sensitive personal data. This applies in particular to devices of information and telecommunications technology such as computers and smartphones. In your own interest, please note that each end user is responsible for deleting the data on the waste equipment to be disposed of.
5. Meaning of the symbol “crossed-out wheelie bin”: The symbol of a crossed-out wheelie bin regularly depicted on electrical and electronic equipment indicates that the respective device is to be collected separately from unsorted municipal waste at the end of its service life.

COPYRIGHT © Hangzhou EZVIZ Software Co., Ltd. ALL RIGHTS RESERVED.

Any and all information, including, among others, wordings, pictures, graphs are the properties of Hangzhou EZVIZ Software Co., Ltd. (hereinafter referred to as “EZVIZ”).

This user manual (hereinafter referred to as “the Manual”) cannot be reproduced, changed, translated, or distributed, partially or wholly, by any means, without the prior written permission of EZVIZ. Unless otherwise stipulated, EZVIZ does not make any warranties, guarantees or representations, express or implied, regarding to the Manual.

About this Manual

The Manual includes instructions for using and managing the product. Pictures, charts, images and all other information hereinafter are for description and explanation only. The information contained in the Manual is subject to change, without notice, due to firmware updates or other reasons. Please find the latest version in the

EZVIZ™ website (<http://www.ezviz.com>).

Revision Record

New release – January, 2022

Trademarks Acknowledgement



and other EZVIZ's trademarks and logos are the properties of EZVIZ in various jurisdictions. Other trademarks and logos mentioned below are the properties of their respective owners.

Legal Disclaimer

TO THE MAXIMUM EXTENT PERMITTED BY APPLICABLE LAW, THE PRODUCT DESCRIBED, WITH ITS HARDWARE, SOFTWARE AND FIRMWARE, IS PROVIDED “AS IS”, WITH ALL FAULTS AND ERRORS, AND EZVIZ MAKES NO WARRANTIES, EXPRESS OR IMPLIED, INCLUDING WITHOUT LIMITATION, MERCHANTABILITY, SATISFACTORY QUALITY, FITNESS FOR A PARTICULAR PURPOSE, AND NON-INFRINGEMENT OF THIRD PARTY. IN NO EVENT WILL EZVIZ, ITS DIRECTORS, OFFICERS, EMPLOYEES, OR AGENTS BE LIABLE TO YOU FOR ANY SPECIAL, CONSEQUENTIAL, INCIDENTAL, OR INDIRECT DAMAGES, INCLUDING, AMONG OTHERS, DAMAGES FOR LOSS OF BUSINESS PROFITS, BUSINESS INTERRUPTION, OR LOSS OF DATA OR DOCUMENTATION, IN CONNECTION WITH THE USE OF THIS PRODUCT, EVEN IF EZVIZ HAS BEEN ADVISED OF THE POSSIBILITY OF SUCH DAMAGES.

TO THE MAXIMUM EXTENT PERMITTED BY APPLICABLE LAW, IN NO EVENT SHALL EZVIZ'S TOTAL LIABILITY FOR ALL DAMAGES EXCEED THE ORIGINAL PURCHASE PRICE OF THE PRODUCT.

EZVIZ DOES NOT UNDERTAKE ANY LIABILITY FOR PERSONAL INJURY OR PROPERTY DAMAGE AS THE RESULT OF PRODUCT INTERRUPTION OR SERVICE TERMINATION CAUSED BY: A) IMPROPER INSTALLATION OR USAGE OTHER THAN

AS REQUESTED; B) THE PROTECTION OF NATIONAL OR PUBLIC INTERESTS; C) FORCE MAJEURE; D) YOURSELF OR THE THIRD PARTY, INCLUDING WITHOUT LIMITATION, USING ANY THIRD PARTY'S PRODUCTS, SOFTWARE, APPLICATIONS, AND AMONG OTHERS.

REGARDING TO THE PRODUCT WITH INTERNET ACCESS, THE USE OF PRODUCT SHALL BE WHOLLY AT YOUR OWN RISKS. EZVIZ SHALL NOT TAKE ANY RESPONSIBILITIES FOR ABNORMAL OPERATION, PRIVACY LEAKAGE OR OTHER DAMAGES RESULTING FROM CYBER ATTACK, HACKER ATTACK, VIRUS INSPECTION, OR OTHER INTERNET SECURITY RISKS; HOWEVER, EZVIZ WILL PROVIDE TIMELY TECHNICAL SUPPORT IF REQUIRED. SURVEILLANCE LAWS AND DATA PROTECTION LAWS VARY BY JURISDICTION. PLEASE CHECK ALL RELEVANT LAWS IN YOUR JURISDICTION BEFORE USING THIS PRODUCT IN ORDER TO ENSURE THAT YOUR USE CONFORMS TO THE APPLICABLE LAW. EZVIZ SHALL NOT BE LIABLE IN THE EVENT THAT THIS PRODUCT IS USED WITH ILLEGITIMATE PURPOSES.

IN THE EVENT OF ANY CONFLICTS BETWEEN THE ABOVE AND THE APPLICABLE LAW, THE LATTER PREVAILS.



Documents / Resources

<p>Copyright © 2019 EZVIZ Technology Co., Ltd. All Rights Reserved. All rights reserved. No part of this publication may be reproduced, stored in a retrieval system, or transmitted, in any form or by any means, electronic, mechanical, photocopying, recording, or by any information storage and retrieval system, without the prior written permission of EZVIZ Technology Co., Ltd.</p> <p>The content herein is for reference only. The actual product appearance and specifications are subject to change without notice. The actual product appearance and specifications are subject to change without notice. The actual product appearance and specifications are subject to change without notice.</p> <p>Disclaimer: The information herein is for reference only. The actual product appearance and specifications are subject to change without notice. The actual product appearance and specifications are subject to change without notice. The actual product appearance and specifications are subject to change without notice.</p> <p>Warranty: EZVIZ Technology Co., Ltd. warrants that the product is free from defects in materials and workmanship under normal use for a period of 12 months from the date of purchase. This warranty does not cover the product if it has been damaged by fire, flood, or other external causes, or if it has been used for purposes other than those intended.</p> <p>Limitation of Remedies: In the event of a claim, EZVIZ Technology Co., Ltd. shall be liable for the replacement or repair of the product, at its discretion. It shall not be liable for any consequential or incidental damages, including but not limited to, lost profits, lost data, or any other damages.</p> <p>Force Majeure: In the event of a natural disaster or other force majeure event, EZVIZ Technology Co., Ltd. shall not be liable for any delays or non-performance of its obligations under this warranty.</p> <p>Entire Agreement: This warranty constitutes the entire agreement between the parties. It shall not be modified, amended, or supplemented by any other agreements, oral or written.</p> <p>Governing Law: This warranty shall be governed by the laws of the People's Republic of China.</p> <p>Seal: The product shall be sealed with a tamper-evident seal. If the seal is broken, the product shall not be used.</p> <p>Notes: 1. The product shall be used in accordance with the instructions for use. 2. The product shall not be used in hazardous environments. 3. The product shall not be used for purposes other than those intended.</p>	<h3>EZVIZ T51C Temperature and Humidity Sensor [pdf] User Guide</h3> <p>T51C, T51C Temperature and Humidity Sensor, Temperature and Humidity Sensor, Humidity S ensor, Sensor</p>
---	---

References

-  [EZVIZ - Creating Easy Smart Homes](#)

Manuals+.com