



EZVIZ CST51C Temperature and Humidity Monitor User Guide

[Home](#) » [ezviz](#) » EZVIZ CST51C Temperature and Humidity Monitor User Guide 



CST51C Temperature and Humidity Monitor User Guide

Contents

- [1 Overview](#)
- [2 Setup](#)
- [3 Installation](#)
- [4 Specifications](#)
- [5 Operations on the EZVIZ App](#)
- [6 Documents / Resources](#)
 - [6.1 References](#)
- [7 Related Posts](#)

Overview

1. Package Contents



Temperature & Humidity Monitor (x1)



3M Tape (x1)



Regulatory Information (x1)



Quick Start Guide (x1)

2. Basics

Temperature & Humidity Monitor detects and displays the indoor temperature and humidity and then sends the related data to the linked EZVIZ gateway. After adding the Monitor to EZVIZ APP, you can view the related data on your phone in real-time; moreover, it can trigger other EZVIZ smart products to provide you with smart home life.

Structure



Front View

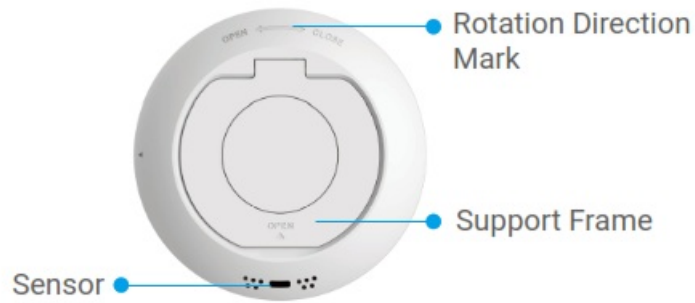

Back View

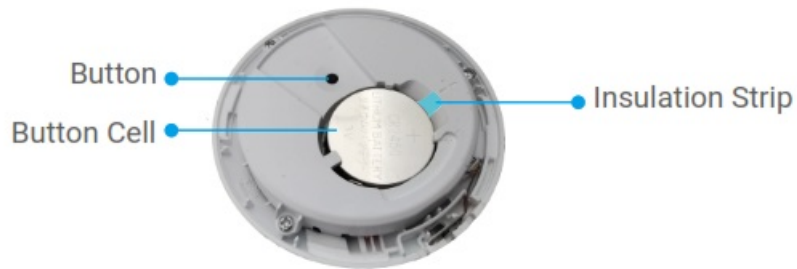

Interior Diagram

Name	Description
Button	<ul style="list-style-type: none"> • Press and hold the Button for 5s, and the Temperature & Humidity Monitor will restart and then enter device adding mode; at the same time, the signal icon on the device screen will flash quickly. • Short press the Button to switch the data display between degrees centigrade (°C) and Fahrenheit degree (°F). • Quickly press the Button twice to switch between Normal Mode and High-performance Mode.

Display Screen



Setup

Follow the steps to set your monitor:

1. Get the EZVIZ app.
2. Power on your Temperature & Humidity Monitor.
3. Add the Monitor to your EZVIZ account.

1. Get the EZVIZ App

1. Connect your mobile phone to Wi-Fi (suggested).
2. Download and install the EZVIZ app by searching for “EZVIZ” in the App Store or Google Play TM.
3. Launch the app and register an EZVIZ user account.

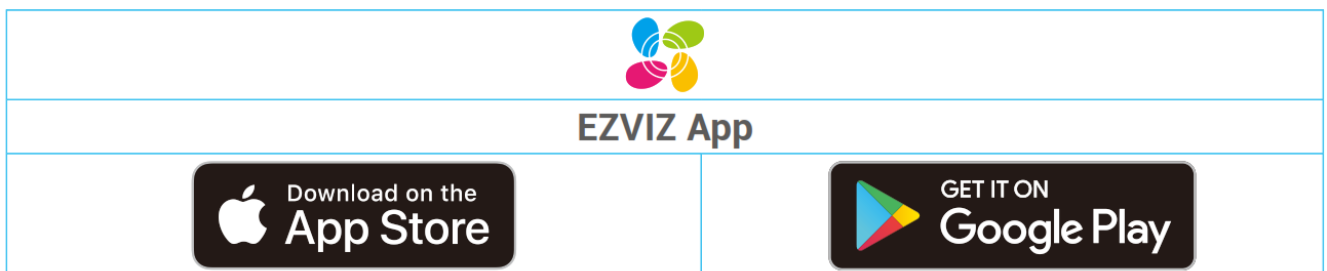

i If you have already used the app, please make sure that it is the latest version. To find out if an update is available, go to the app store and search for “EZVIZ”.

2. Power on Temperature & Humidity Monitor

Step 1 Remove Rear Cover

Remove the rear cover of the Temperature & Humidity Monitor by rotating it anticlockwise as shown in the figure below.

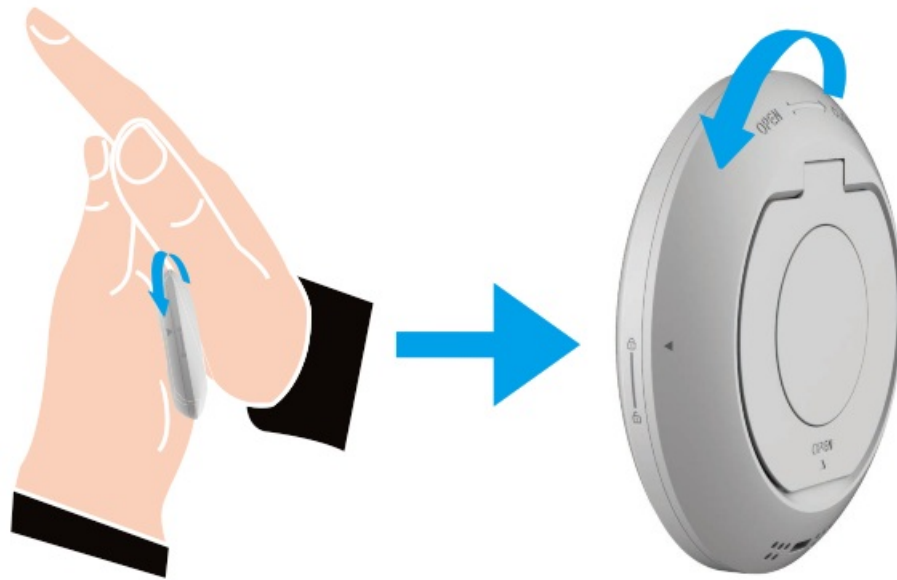

i It is recommended to put the Temperature & Humidity Monitor on your hands to press and twist it by your palm.

Step 2 Remove Insulation Strip

Draw out the battery insulation strip with your hand.



Insulation Strip

i • Please replace the battery in time when low power prompts on your phone.

- If you need to replace the battery, please purchase one CR2450.
- When replacing batteries, please insert with the positive side facing up.

3. Add Temperature & Humidity Monitor

i The Monitor should be used along with EZVIZ Zigbee Smart Gateway (after referred to as “gateway”). Please add a gateway to the EZVIZ Cloud by referring to the gateway user manual, and then add the Monitor to the gateway by following the below steps.

Method One: Add by Scanning QR Code

1. Log in to your account through the EZVIZ app, tap the device adding an icon, and then the QR code scanning interface will be displayed.
2. Press and hold the Button of the Monitor for over 5s till the signal icon on the Monitor screen flashes, and then

the Monitor enters device adding mode.

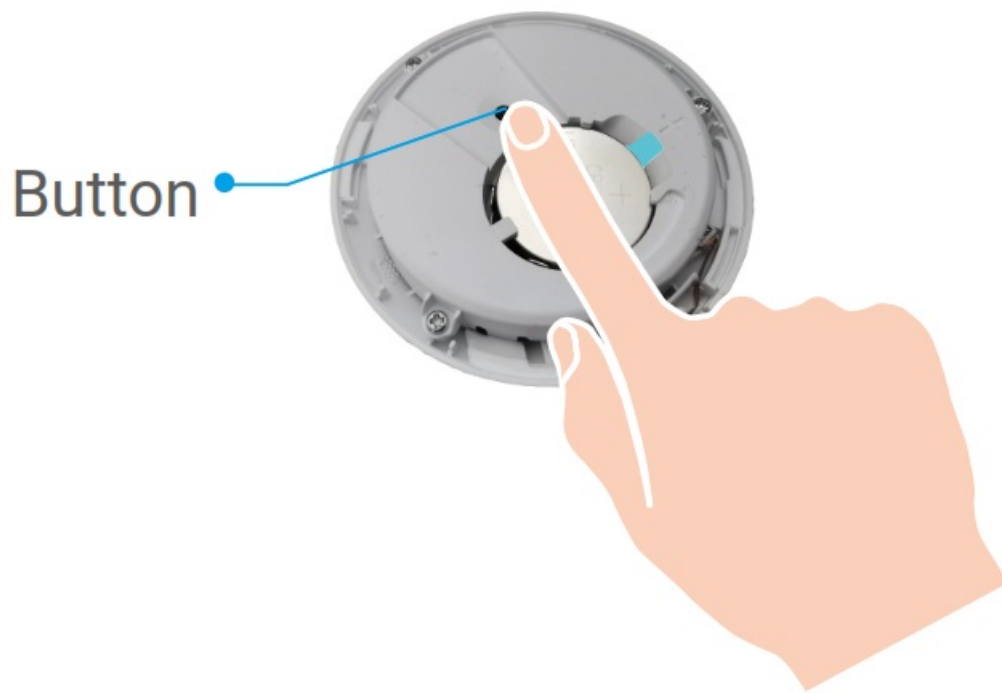

i The Monitor will exit the device adding mode automatically over 3 minutes.

3. Scan the QR code on the inner side of the cover or the cover of the user manual, and then add the Temperature & Humidity Monitor to the gateway.



4. Add the Temperature & Humidity Monitor to the gateway by following the wizard on the app.
5. Rotate tightly the rear cover of the Temperature & Humidity Monitor clockwise till the aligning mark ► on the rear cover is aligned with the mark  on the front cover.



Method Two: Add by the Gateway

When adding Temperature & Humidity Monitor by the gateway, place the Monitor as close to the gateway as possible.

1. Press the Function Button of the gateway to make the gateway enter device adding mode.



2. Press and hold the Button of the Monitor for over 5s till the signal icon on the Monitor screen flashes, and then the Monitor enters device adding mode.

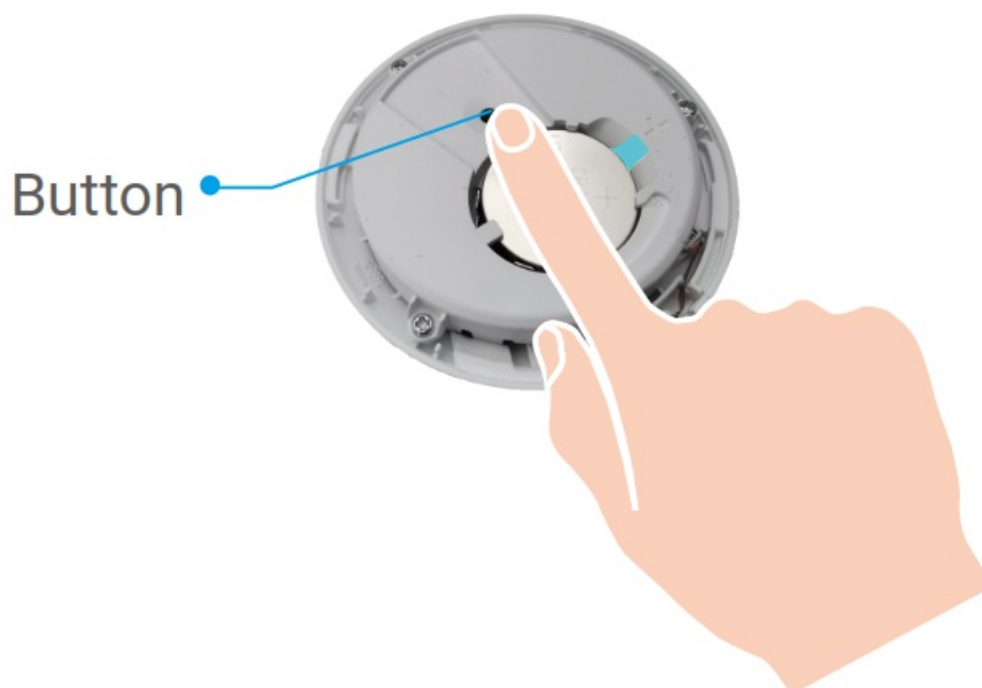

3. The Monitor has been added to the gateway successfully and the gateway prompts adding successfully.
4. After the Temperature & Humidity Monitor is added successfully, rotate the Monitor rear cover clockwise to tighten the rear cover till the aligning mark ► on rear cover is aligned with the mark 🔒 on the front cover.



Installation

-  Metal will cause ZigBee signal attenuation, so please do not install the Monitor on a metal door, it is recommended to install it on the wall next to the door.
- Do not install the Monitor in an environment with corrosivity or intense magnetic fields.
- It is recommended that the distance between the Monitor and gateway be less than 20m. If there are walls between them, the number of walls should be no more than 2.
- It is recommended to use the Monitor in a house with an area of no more than 200 square meters; if your house is too large, please purchase two or more Monitors for a better user experience.
- Before sticking 3M tape, please swipe the dust on the installation surface to enhance the tape stickiness; do not stick it on a lime wall.

Please place the Monitor on the desktop as you needed, or you can stick it on the wall below 1 meter with 3M tape.

Place on the desktop

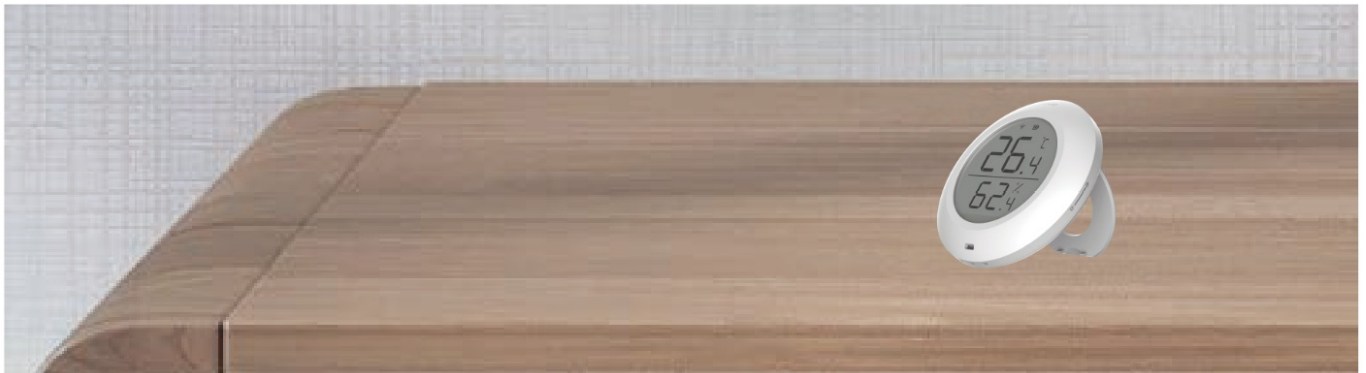

Stick on the place you needed (with 3M tape)



Specifications

Working Temperature	-10°C ~ 60°C
StoringTemperature	-10°C ~ 60°C
Working Humidity	0%~95%RH
Wireless Protocol	Zigbee 3.0
Battery Type	CR2450
Battery Duration	8 months



For additional information about the device, please refer to www.ezvizlife.com.

Operations on the EZVIZ App



The app interface may be different due to version updates, and the interface of the app you installed on your phone shall prevail.

1. Homepage

Launch the EZVIZ app, open the homepage of the related gateway, you can manage your Temperature & Humidity Monitor as needed on the page.

Log	Detection log of the Monitor.
-----	-------------------------------

2. Settings

Parameter	Description
Device Name	Customize the name of your device.
Temperature/ Humidity Alarm	When enabled, the device will send an alarm message to notice that the temperature or humidity exceeds the set values.
Temperature unit	You can check the current temperature unit of the Monitor.
Performance Mode	You can check the current performance mode of the Monitor.
Related Devices	You can see the gateway connected to your monitor.
Device Information	You can see the device information here.
Share	Share your device.
Delete Device	Tap to delete the Monitor from the EZVIZ cloud.

Regulatory Information



This product and – if applicable – the supplied accessories too are marked with “CE” and comply therefore with the applicable harmonized European standards listed under the Radio Equipment Directive 2014/53/EU, the EMC Directive 2014/30/EU, the RoHS Directive 2011/65/EU.



2012/19/EU (WEEE directive): Products marked with this symbol cannot be disposed of as unsorted municipal waste in the European Union. For proper recycling, return this product to your local supplier upon the purchase of equivalent new equipment, or dispose of it at designated collection points. For more information see www.recyclethis.info.







2006/66/EC and its amendment 2013/56/EU (battery directive): This product contains a battery that cannot be disposed of as unsorted municipal waste in the European Union. See the product documentation for specific battery information. The battery is marked with this symbol, which may include lettering to indicate cadmium (Cd), lead (Pb), or mercury (Hg). For proper recycling, return the battery to your supplier or to a designated collection point. For more information see www.recyclethis.info.

EC DECLARATION OF CONFORMITY

Hereby, Hangzhou EZVIZ Software Co., Ltd. declares that the radio equipment type [refer to the cover of the quick start guide] is in compliance with Directive 2014/53/EU.

The full text of the EC DECLARATION OF CONFORMITY is available at the following web link: <http://www.ezviz.com/page/declaration-of-conformity>.

Important Safety Information

	Direct current.
	Note: Please read the manual before using the device.
	This symbol on the device indicates that the safety compatibility manual and/or installation manual must be read, which contains information related to the safe operation of the device. Caution: Be sure to read these instructions before operating the equipment.
	Warning: For SELV DC input: the DC power source shall comply with the Safety Extra-Low Voltage (SELV) requirements of IEC/EN 60950-1, IEC/EN 62368-1. Warning: The power source should meet limited power source or PS2 requirements according to IEC/EN 60950-1 or IEC/EN 62368-1.
	Warning: If you want to disconnect the device from the power source, please unplug the DC power terminal that connects the power adapter and device. Warning: Disposal of a battery into fire or a hot oven, or mechanically crushing or cutting of a battery that can result in an explosion. Warning: Leaving a battery in an extremely high temperature surrounding environment that can result in an explosion or the leakage of flammable liquid or gas. Warning: A battery subjected to extremely low air pressure may result in an explosion or the leakage of flammable liquid or gas. Warning: Dispose of used batteries according to the instructions. Warning: Replace only with the same or equivalent type recommended by the manufacturer. Caution: THE PRODUCT IS BUILT IN A REPLACEABLE BATTERY. Warning: Do not ingest battery, Chemical Burn Hazard. Caution: This product contains a coin/button cell battery. If the coin/button cell battery is swallowed, it can cause severe internal burns in just 2 hours and can lead to death. Caution: Keep new and used batteries away from children. Caution: If the battery compartment does not close securely, stop using the product and keep it away from children. Caution: If you think batteries might have been swallowed or placed inside any part of the body, seek immediate medical attention. Caution: Risk of fire or explosion if the battery is replaced by an incorrect type.

FCC Information

Please take attention that changes or modifications not expressly approved by the party responsible for compliance could void the user's authority to operate the equipment.

FCC compliance

This equipment has been tested and found to comply with the limits for a Class B digital device, pursuant to part 15 of the FCC Rules. These limits are designed to provide reasonable protection against harmful interference in a residential installation. This equipment generates, uses and can radiate radio frequency energy and, if not installed and used in accordance with the instructions, may cause harmful interference to radio communications. However, there is no guarantee that interference will not occur in a particular installation. If this equipment does cause harmful interference to radio or television reception, which can be determined by turning the equipment off and on, the user is encouraged to try to correct the interference by one or more of the following measures:

- Reorient or relocate the receiving antenna.
- Increase the separation between the equipment and receiver.
- Connect the equipment into an outlet on a circuit different from that to which the receiver is connected.
- Consult the dealer or an experienced radio/TV technician for help.

This equipment should be installed and operated with a minimum distance of 20cm between the radiator and your body.

FCC Conditions

This device complies with part 15 of the FCC Rules. Operation is subject to the following two conditions:

1. This device may not cause harmful interference.
2. This device must accept any interference received, including interference that may cause undesired operation.

FCC Supplier's Declaration of Conformity

Equipment Model: refer to the cover of the quick start guide

FCC Compliance Statement:

This device complies with part 15 of the FCC Rules. Operation is subject to the following two conditions: (1) This device may not cause harmful interference, And (2) this device must accept any interference received, including interference that may cause undesirable operation.

Responsible Party -U.S. Contact Information:

Company name EZVIZ Inc.

Company address 908 Canada Court, City of Industry, CA 91748, United States

Internet contact information www.ezviz.com/us

Industry Canada ICES-003 Compliance

This device meets the CAN ICES-3 (B)/NMB-3(B) standards requirements.

This device complies with Industry Canada licence-exempt RSS standard(s). Operation is subject to the following two conditions:

1. this device may not cause interference, and
2. this device must accept any interference, including interference that may cause undesired operation of the device.

Under Industry Canada regulations, this radio transmitter may only operate using an antenna of a type and maximum (or lesser) gain approved for the transmitter by Industry Canada. To reduce potential radio interference to other users, the antenna type and its gain should be so chosen that the equivalent isotropically radiated power (e.i.r.p.) is not more than that necessary for successful communication.

This equipment should be installed and operated with a minimum distance of 20cm between the radiator and your body.

COPYRIGHT © Hangzhou EZVIZ Software Co., Ltd. ALL RIGHTS RESERVED.

Any and all information, including, among others, wordings, pictures, graphs are the properties of Hangzhou EZVIZ Software Co., Ltd. (hereinafter referred to as "EZVIZ").

This user manual (hereinafter referred to as "the Manual") cannot be reproduced, changed, translated, or distributed, partially or wholly, by any means, without the prior written permission of EZVIZ. Unless otherwise stipulated, EZVIZ does not make any warranties, guarantees or representations, express or implied, regarding to the Manual.

About this Manual

The Manual includes instructions for using and managing the product. Pictures, charts, images and all other information hereinafter are for description and explanation only. The information contained in the Manual is subject to change, without notice, due to firmware updates or other reasons. Please find the latest version in the TM website (<http://www.ezviz.com>).

Revision Record

New release – January 2022

Trademarks Acknowledgement



TM, TM, and other EZVIZ trademarks and logos are the properties of EZVIZ in various jurisdictions. Other trademarks and logos mentioned below are the properties of their respective owners.

Legal Disclaimer

TO THE MAXIMUM EXTENT PERMITTED BY APPLICABLE LAW, THE PRODUCT DESCRIBED, WITH ITS HARDWARE, SOFTWARE AND FIRMWARE, IS PROVIDED "AS IS", WITH ALL FAULTS AND ERRORS, AND

EZVIZ DOES NOT UNDERTAKE ANY LIABILITY FOR PERSONAL INJURY OR PROPERTY DAMAGE AS THE RESULT OF PRODUCT INTERRUPTION OR SERVICE TERMINATION CAUSED BY: A) IMPROPER INSTALLATION OR USAGE OTHER THAN AS REQUESTED; B) THE PROTECTION OF NATIONAL OR PUBLIC INTERESTS; C) FORCE MAJEURE; D) YOURSELF OR THE THIRD PARTY, INCLUDING WITHOUT LIMITATION, USING ANY THIRD PARTY'S PRODUCTS, SOFTWARE, APPLICATIONS, AND AMONG OTHERS. REGARDING THE PRODUCT WITH INTERNET ACCESS, THE USE OF THE PRODUCT SHALL BE WHOLLY AT YOUR OWN RISK. EZVIZ SHALL NOT TAKE ANY RESPONSIBILITY FOR ABNORMAL OPERATIONS, PRIVACY LEAKAGE, OR OTHER DAMAGES RESULTING FROM CYBER ATTACKS, HACKER ATTACKS, VIRUS INSPECTIONS, OR OTHER INTERNET SECURITY RISKS; HOWEVER, EZVIZ WILL PROVIDE TIMELY TECHNICAL SUPPORT IF REQUIRED. SURVEILLANCE LAWS AND DATA PROTECTION LAWS VARY BY JURISDICTION. PLEASE CHECK ALL RELEVANT LAWS IN YOUR JURISDICTION BEFORE USING THIS PRODUCT IN ORDER TO ENSURE THAT YOUR USE CONFORMS TO THE APPLICABLE LAW. EZVIZ SHALL NOT BE LIABLE IN THE EVENT THAT THIS PRODUCT IS USED FOR ILLEGITIMATE PURPOSES. IN THE EVENT OF ANY CONFLICTS BETWEEN THE ABOVE AND THE APPLICABLE LAW, THE LATTER PREVAILS.

Documents / Resources

EZVIZ CST51C Temperature and Humidity Monitor [pdf] User Guide
CST51C, 2APV2-CST51C, 2APV2CST51C, Temperature and Humidity Monitor, Temperature
Monitor, Humidity Monitor, CST51C Temperature and Humidity Monitor

- [!\[\]\(bffc5a43e4029132691ecfbd6a8d011d_img.jpg\) EZVIZ - Creating Easy Smart Homes](#)
- [!\[\]\(44ee2a373a3d5354f74c802368baefa6_img.jpg\) EC Declaration of Conformity | EZVIZ](#)
- [!\[\]\(e65c77514b56a29aa5926cbeff111366_img.jpg\) EZVIZ - Creating Easy Smart Homes](#)
- [!\[\]\(8fafdd156273648625bbba06d0f3466b_img.jpg\) EZVIZ - Creating Easy Smart Homes](#)
- [!\[\]\(430e9618d31d59c502f66bb036d66e55_img.jpg\) HOME](#)