



# EZVIZ CSC6N1G2 Smart Home Camera User Guide

[Home](#) » [ezviz](#) » EZVIZ CSC6N1G2 Smart Home Camera User Guide 

## Contents

- [1 Regulatory Information](#)
- [2 Use only power supplies listed in the Table.](#)
- [3 Important Safety Information](#)
- [4 Package Contents](#)
- [5 Basics](#)
- [6 Setup](#)
  - [6.1 1 Power-on](#)
  - [6.2 2 Camera Setup](#)
- [7 Installation \(Optional\)](#)
  - [7.1 1 Install the Micro SD Card \(Optional\)](#)
  - [7.2 2 Install the Base](#)
  - [7.3 3 Install the Camera](#)
- [8 Documents / Resources](#)
  - [8.1 References](#)
- [9 Related Posts](#)

## Regulatory Information



This product and – if applicable – the supplied accessories too are marked with “CE” and comply therefore with the applicable harmonized European standards listed under the Radio Equipment Directive 2014/53/EU, the EMC Directive 2014/30/EU, the RoHS Directive 2011/65/EU.



2012/19/EU (WEEE directive): Products marked with this symbol cannot be disposed of as unsorted municipal waste in the European Union. For proper recycling, return this product to your local supplier upon the purchase of equivalent new equipment, or dispose of it at designated collection points. For more information see: [www.recyclethis.info](http://www.recyclethis.info)



2006/66/EC and its amendment 2013/56/EU (battery directive): This product contains a battery that cannot be disposed of as unsorted municipal waste in the European Union. See the product documentation for specific battery information. The battery is marked with this symbol, which may include lettering to indicate cadmium (Cd), lead (Pb), or mercury (Hg). For proper recycling, return the battery to your supplier or to a designated collection point. For more information see:

## EC DECLARATION OF CONFORMITY

Hereby, Hangzhou EZVIZ Software Co., Ltd. declares that the radio equipment type [CS-C1C, CS-C1HC, CS-C1T, CS-C2C, CS-CV206, CS-CV310, CS-C3N, CS-C3W, CS-C3WN, CS-C3X, CS-C6N, CS-CV246, CS-CV248, CS-C6CN, CS-C6C, CS-C6W, CS-TY1, CS-TY2, CS-TY3, CS-CV336, CS-DP1, CS-DP1C, CS-DP2C, CS-DB2C, CS-C4W, CS-C4C, CS-CV228, CS-C5W, CS-C5C, CS-C5HC, CS-C5X, CS-C5HX, CS-C8W, CS-C8C, CS-C3A, CS-BC1, CS-W2H, CS-X5S-4W, CS-X5S-8W, CS-A1-32W, CS-T9-A, CS-T4-A] is in compliance with Directive 2014/53/EU.

The full text of the EC DECLARATION OF CONFORMITY is available at the following web link:

<http://www.ezvizlife.com/declaration-of-conformity>.

Use only power supplies listed in the Table.

Equipment model	Adapter manufacture	Adapter model
CS-C1C/ CS-C1HC/ CS-C1T/ CS-C2C/ CS-CV206/ CS-CV246/ CS-C6N/ CS-C6CN/ CS-C6C/ CS-TY1/ CS-TY2/ CS-TY3/ CS-W2D/ CS-A1-32W/ CS-T9-A	Shenzhen Honor Electronic Co Ltd	ADS-5RE-06 05050EPCU/EPC(US), ADS-5RH-06 05050EPB(UK), ADS-5RH-06 05050EPG(EU), ADS-5RH-06 05050EPSA(AU), ADS-5RH-06 05050EPBR(BR), ADS-5RH-06 05050EPI(IN), ADS-5MA-06A 05050GPK(KR)
CS-CV248/ CS-C6W/ CS-C6Wi/ CS-CV336/ CS-DP1/ CS-DP1C/ CS-DP2C/ CS-C3A/ CS-BC1	Shenzhen Honor Electronic Co Ltd	ADS-10LA-06 05010EPCU/EPC(US), ADS-10RH-06 05010EPB (UK), ADS-10RH-06 05010EPG(EU), ADS-10RH-06 05010EPSA(SA), ADS-10RH-06 05010EPBR(BR), ADS-10RH-06 05010EPI(IN), ADS-12CG-06 05010EPC(JP)
CS-CV310/ CS-C3N/ CS-C3W/ CS-C3WN/ CS-C3X/ CS-SD1/ CS-C4W/ CS-C4C/ CS-CV228/ CS-C8W/ CS-C8C/ CS-W2H/ CS-W3C-WD1200G/ CS-T8-B	Shenzhen Honor Electronic Co Ltd	ADS-12FG-12N 12012EPCU(US), ADS-12FG-12N 12012EPB(UK), ADS-12FG-12N 12012EPG(EU), ADS-12FB-12 12012EPSA(AU), ADS-12FG-12N 12012EPBR(BR), ADS-12FG-12N 12012EPI(IN)
CS-X5S-4W/ CS-X5S-8W	Moso Power Supply Technology Co. Ltd	MSA-C1500IC12.0-18P-GB(UK), MSA-C1500IC12.0-18P-DE, MSA-C1500IC12.0-18P-AU(AU), MSA-C1500IC12.0-18P-BR(BR), ADS-25FSG-12 12018GPI(IN)

## Important Safety Information

---



**Note:** Please read the manual before using the device.

---



**Caution:** This symbol on the device indicates that the safety compatibility manual and / or installation manual must be read, which contains information related to the safe operation of the device. Be sure to read these instructions before operating the equipment.

---



**Warning:** The separate earthing terminal must be permanently connected to earth.

**Warning:** For SELV DC input: the DC power source shall comply with the Safety Extra-Low Voltage (SELV) requirements of IEC 60950-1.

---



**Caution:** Do not block ventilation openings while the system is on, and keep at least 2 cm distance from ventilation openings and walls or other things which may block the openings.

**Warning:** Disposal of a battery into fire or a hot oven, or mechanically crushing or cutting of a battery that can result in an explosion.

**Warning:** Leaving a battery in an extremely high temperature surrounding environment that can result in an explosion or the leakage of flammable liquid or gas.

**Warning:** A battery subjected to extremely low air pressure that may result in an explosion or the leakage of flammable liquid or gas.

**Warning:** Dispose of used batteries according to the instructions.

**Warning:** Replace only with the same or equivalent type recommended by the manufacturer.

**Caution:** THE PRODUCT IS BUILT IN A REPLACEABLE BATTERY.

**Warning:** Do not ingest battery, Chemical Burn Hazard.

**Caution:** This product contains a coin/button cell battery. If the coin / button cell battery is swallowed, it can cause severe internal burns in just 2 hours and can lead to death.

**Caution:** Keep new and used batteries away from children.

**Caution:** If the battery compartment does not close securely, stop using the product and keep it away from children.

**Caution:** If you think batteries might have been swallowed or placed inside any part of the body, seek immediate medical attention.

**Caution:** Risk of fire or explosion if the battery is replaced by an incorrect type.

---

## FCC Information

Please take attention that changes or modification not expressly approved by the party responsible for compliance could void the user's authority to operate the equipment.

## FCC compliance

This equipment has been tested and found to comply with the limits for a Class B digital device, pursuant to part 15 of the FCC Rules. These limits are designed to provide reasonable protection against harmful interference in a

residential installation. This equipment generates, uses and can radiate radio frequency energy and, if not installed and used in accordance with the instructions, may cause harmful interference to radio communications. However, there is no guarantee that interference will not occur in a particular installation. If this equipment does cause harmful interference to radio or television reception, which can be determined by turning the equipment off and on, the user is encouraged to try to correct the interference by one or more of the following measures:

- Reorient or relocate the receiving antenna.
- Increase the separation between the equipment and receiver.
- Connect the equipment into an outlet on a circuit different from that to which the receiver is connected.
- Consult the dealer or an experienced radio/TV technician for help.

This equipment should be installed and operated with a minimum distance 20cm between the radiator and your body.

### FCC Conditions

This device complies with part 15 of the FCC Rules. Operation is subject to the following two conditions:

1. This device may not cause harmful interference.
2. This device must accept any interference received, including interference that may cause undesired operation.

### Industry Canada ICES-003 Compliance

This device meets the CAN ICES-3 (B)/NMB-3(B) standards requirements.

This device complies with Industry Canada licence-exempt RSS standard(s). Operation is subject to the following two conditions:

- (1) this device may not cause interference, and
- (2) this device must accept any interference, including interference that may cause undesired operation of the device.

Under Industry Canada regulations, this radio transmitter may only operate using an antenna of a type and maximum (or lesser) gain approved for the transmitter by Industry Canada. To reduce potential radio interference to other users, the antenna type and its gain should be so chosen that the equivalent isotropically radiated power (e.i.r.p.) is not more than that necessary for successful communication.

This equipment should be installed and operated with a minimum distance 20cm between the radiator and your body.



102026549, B

### Package Contents



Camera (x1)



Base (x1)

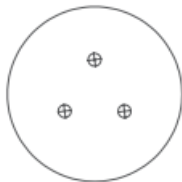

Screw Kit (x1)

Drill Template (x1)

Power Cable (x1)

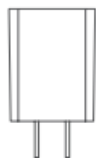

Power Adapter (x1)

Quick Start Guide (x1)



The camera appearance is subject to the actual model you have purchased.

## Basics

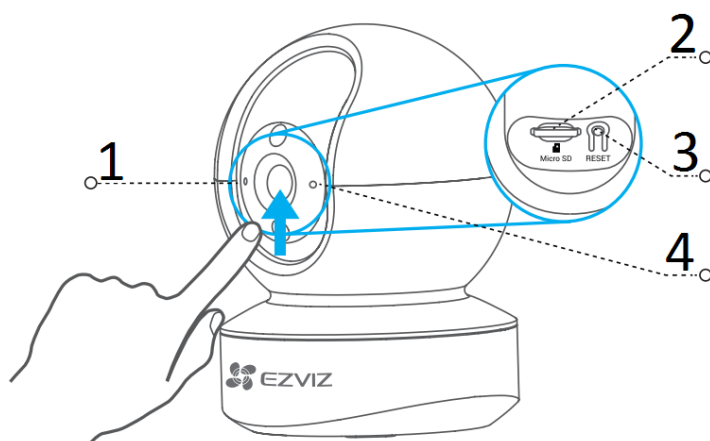

1. LED Indicator
2. Micro SD Card Slot
3. Reset Button
4. MIC

Name	Description
LED Indicator	<p>● Solid Red: Camera is starting up.  Slow-flashing Red: Wi-Fi connection has failed.  Fast-flashing Red: Device exception (e.g. MicroSD card error).</p>
	<p>● Solid Blue: Video is being viewed or played back in EZVIZ App.  Slow-flashing Blue: Camera is running properly.  Fast-flashing Blue: Camera is ready for the Wi-Fi connection.</p>
Micro SD Card (sold separately)	Initialize the card in the EZVIZ app before using it.
Reset Button	Hold for 5 seconds to restart and set all parameters to default.
MIC	For audio in.
Speaker	For audio out.

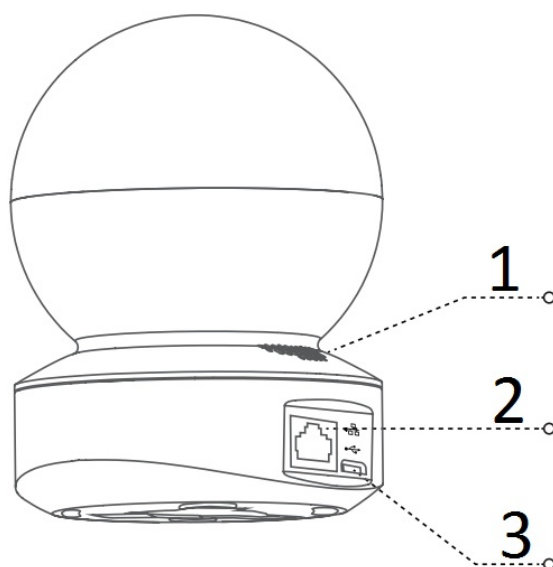

1. Speaker
2. Ethernet Port
3. Power Port

## Setup

### 1 Power-on

Plug the power cable into the camera, and then plug the power adapter into an outlet as shown in the figure below.

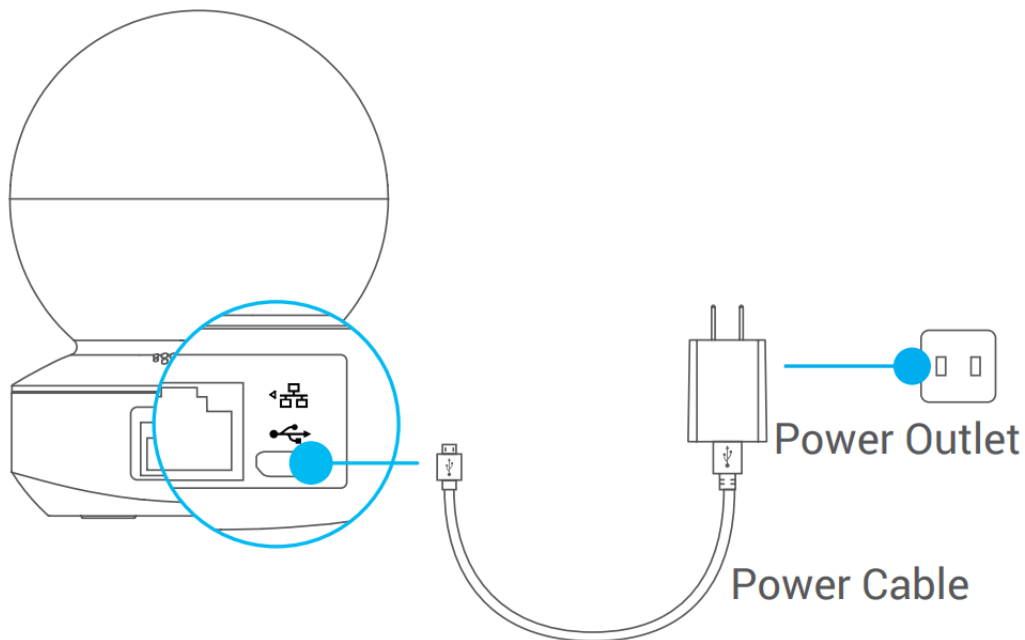

The LED turning fast-flashing blue indicates that the camera is powered on and ready for Wi-Fi configuration.

## 2 Camera Setup

### 1. Create a user account

- Connect your mobile phone to Wi-Fi using your **2.4GHz** network.
- Search for “EZVIZ” in the App Store or Google Play<sup>(TM)</sup>.
- Download and install the EZVIZ app.
- Launch the app.
- Create and register an EZVIZ user account by following the start-up wizard.



The camera works with **2.4GHz** Wi-Fi signals. If you have a dual-band router with separate 2.4GHz and 5GHz networks, make sure your phone is connected to the 2.4GHz one.

### 2. Add a camera to EZVIZ

- Log in to your account using the EZVIZ app.
- On the Home screen, tap “+” on the upper-right corner to go to the Scan QR Code interface.

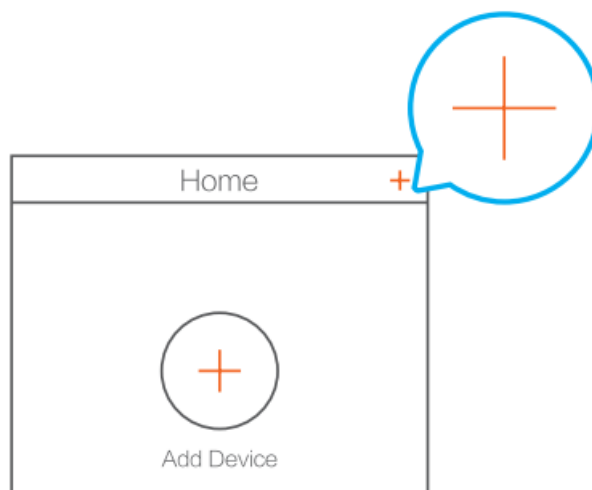

- Scan the QR code on the bottom of the camera.

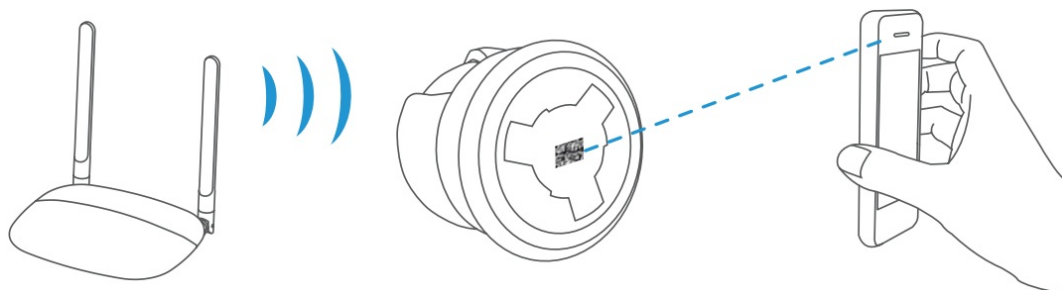

– Follow the EZVIZ app wizard to finish Wi-Fi configuration.



Hold the Reset button for 5s in any of the following cases:

- The camera fails to connect to your Wi-Fi network.
- You want to select another Wi-Fi network.

### Installation (Optional)

#### 1 Install the Micro SD Card (Optional)

1. Rotate the sphere upwards until you see the card slot.
2. Insert the Micro SD card (sold separately) into the card slot as shown in the figure below.

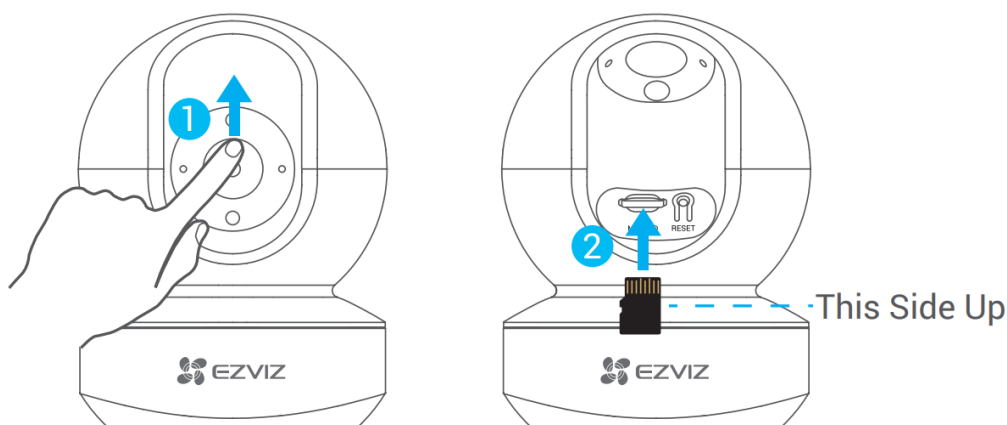

After installing the Micro SD card, you should initialize the card in the EZVIZ app before using it.

3. In the EZVIZ app, tap the **Storage Status** in the Device Settings interface to check the SD card status.
4. If the memory card status displays as **Uninitialized**, tap to initialize it.



The status will then change to **Normal** and it can store videos.

#### 2 Install the Base

The camera can be placed horizontally or mounted on the ceiling. Here we take ceiling mounting as an example.





- Make sure the ceiling is strong enough to withstand three times the weight of the camera.
- Avoid positioning the camera in an area that gets a lot of light shining directly into the camera lens.
  - Place the drill template onto the surface you have chosen to mount the camera.
  - **(For cement wall/ceiling only)** Drill screw holes according to the template, and insert three anchors.
  - Use three metal screws to fix the camera base according to the template.

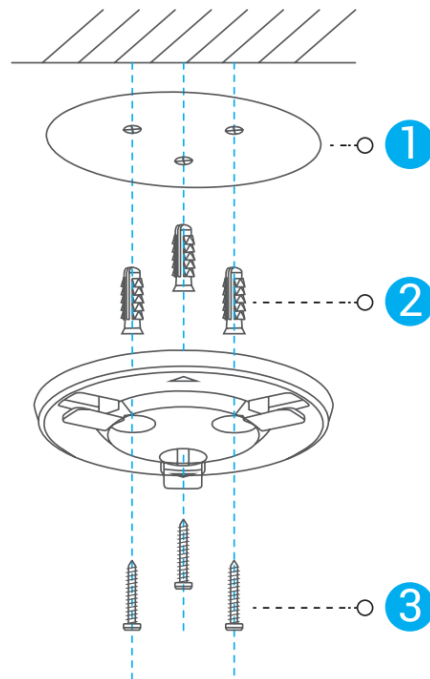

1. Drill Template
2. Anchors
3. Metal Screws



Please tear up the drill template after installing the base if needed.

### 3 Install the Camera

Mount the camera to the base, and turn it clockwise until it is fixed.



A large white rectangular area, likely a placeholder for a document or image, occupying the right two-thirds of the page.

- [!\[\]\(87eaa371aa6012ba00cb26e93903d0a5\_img.jpg\) EZVIZ - Creating Easy Smart Homes](#)
- [!\[\]\(8a1d5b9fde0fea2f88f8d429f3f09b62\_img.jpg\) Declaration of Conformity | EZVIZ](#)
- [!\[\]\(4f36a4ec1451cdf93d7d9ac7b778e19d\_img.jpg\) HOME](#)