



eyecool ECX333 Multimodal Face Recognition All-in-One Terminal User Manual

[Home](#) » [eyecool](#) » eyecool ECX333 Multimodal Face Recognition All-in-One Terminal User Manual 



ECX333 Multimodal Face Recognition All-in-One Terminal User Manual



Contents

- 1 ECX333 Multimodal Face Recognition All-in-One Terminal
- 2 Getting Started
- 3 Product use
- 4 Door opening mode
- 5 Detailed introduction of management setting function
- 6 Documents / Resources
 - 6.1 References
- 7 Related Posts

ECX333 Multimodal Face Recognition All-in-One Terminal

Version Description

Version No.	Revision Description	Revised by	Reviewed by
V0.1	First draft		

Thank you for purchasing ECX333 multimodal face recognition terminal!

We believe that you've made a wise choice and will enjoy wonderful changes and joyful daily life together with global users who trust ECX333 multimodal face recognition terminal. Every ECX333 multimodal face recognition terminal is produced with diligent efforts of Eyecool. Every component is the achievement of wisdom of numerous engineers. Our sophisticated skills and expertise have been demonstrated in our excellent world-class products. With our unremitting efforts, we contribute to opening a wonderful and infinite life experience for all ECX333 users. We always strive to provide you with intimate and comfortable experience in all-round way, from products to services.

Disclaimers

We've tried our best to ensure the correctness and reliability of information provided in this manual, but it may have deviation before and during printing.

We may upgrade the product from time to time in order to improve the performance, reliability and installation of the components and systems. This may be inconsistent with the description in the manual, but it will not affect the actual operation. Please understand! The functions specified in this manual shall not serve as a reason for applying this product for special purposes. The company shall not bear any responsibility for the accidents and hazards caused by the misoperation of the user.

Getting Started

1.1 Registration instruction

When using iris & face multimodal access control, please follow the steps below for operation involving registration or identification:

1. Stand in front of the iris & face multi-modal access control, and look at the screen of the access;
2. Make sure the eyes are within the preview box at the top of the screen. If the eyes are out of the preview box at the top of the screen, the camera will automatically adjust to align.

1.2 Startup

Connect the supporting power adapter at the interface, and the system will start automatically within 15 sec.

Product use

2.1 Device activation – Registration

- Select language after startup: Chinese and English

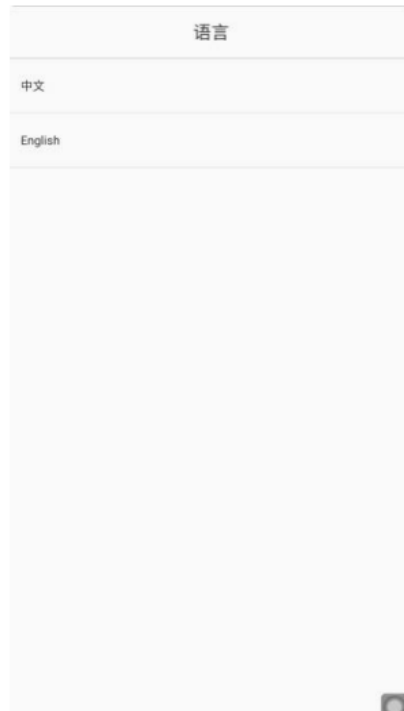

- Select local or network version after selecting language



Local: Click skip in the upper right corner of the page to enter the local version with no need to select network;

Network: connect to the network for data interaction. The network can be connected via wire or WiFi.

Wired network: insert the cable, connect the wired network to save, upload and download the data.

WiFi: connect WiFi, save data, upload and download data.

Note: the application of local version is simpler than that of network version. You can register and activate by skipping some irrelevant steps. It is recommended to apply

the network version. The registration and activation of the two versions are shown as follows.

- Local

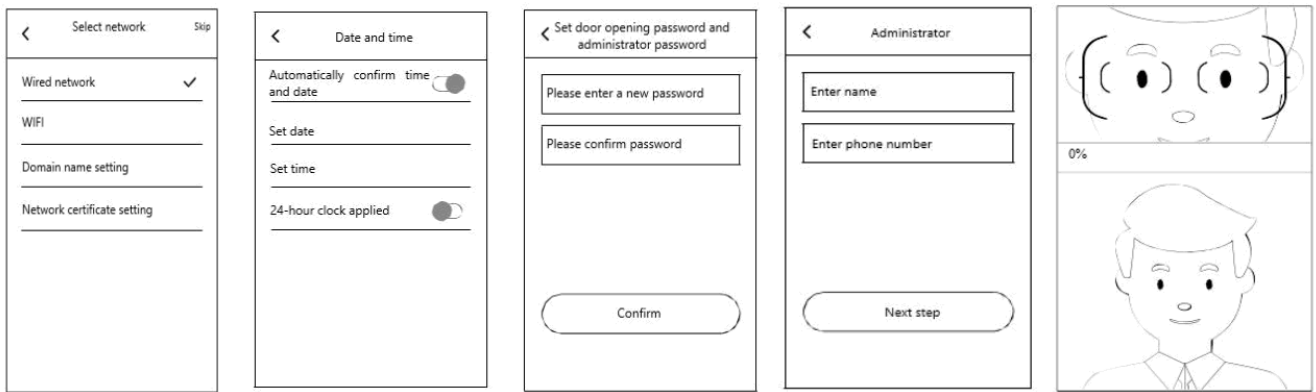

- Click “Skip” to enter the local version and select the date and time.
- Set door opening password and administrator password.

Enter and confirm the new password, click “Confirm”, a prompt will pop up for device or network check, and click Skip to enter the administrator registration page.

- Enter name and phone number.
- Enter the administrator registration interface and ensure the eyes within the preview box at the top of the screen at an appropriate distance. After 100% of the registration progress is completed, the successful extraction of iris feature will pop at the bottom of the screen, indicating that the registration of the local version is successful.

• Network

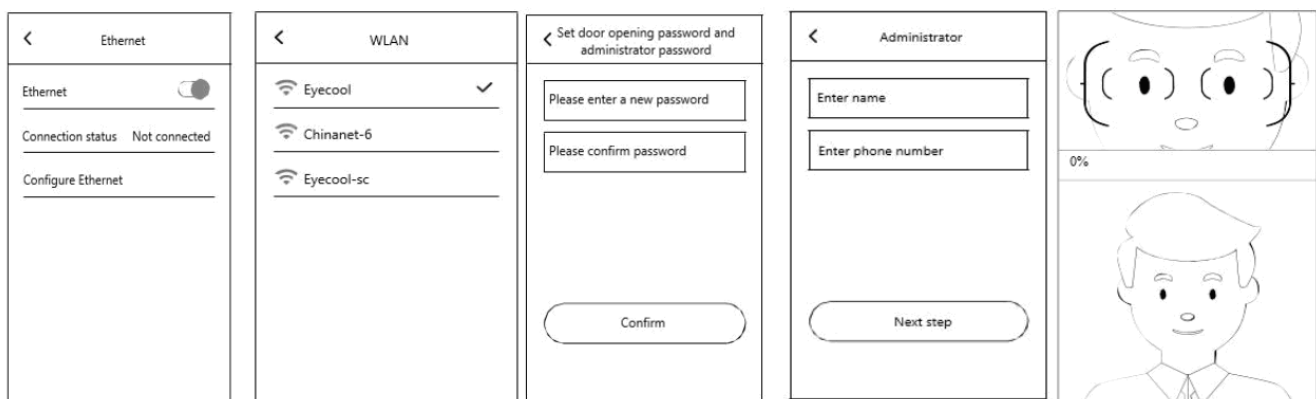

- After selecting WiFi, select the WiFi to be connected and enter correct password; Or after selecting wired network, insert the network cable, turn on Ethernet to connect the wired network.
- Set the door opening password and administrator password: enter and confirm the new password, and click “Confirm”, password setting is successful and jump to the administrator registration interface.
- Enter name and phone number.
- Enter the administrator registration interface and ensure the eyes within the preview box at the top of the screen at an appropriate distance. After 100% of the registration progress is completed, the bottom of the screen will prompt that the iris feature extraction is successful, data is uploaded and jump to main interface of identification, indicating that the registration of the network version is successful.

2.2 ID card registration in face & ID card comparison

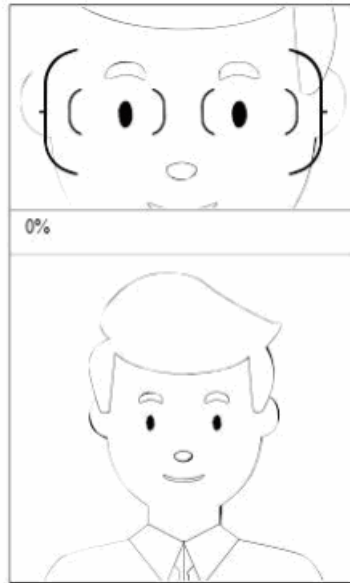

- Enter “Advanced settings” to open the “ID card switch” (this switch can be displayed after 3 quick clicks in the blank of the screen) and click “Verification settings” to open the “Swiping switch”.
- Enter the “Comparison mode setting” and switch to the “Face & ID card comparison mode”.
- The specific registration steps are as follows:

Get close to the iris & face multimodal access control, the main identification interface pops up when the person is sensed, clicks ID card registration to prompt to swipe ID card, put the ID card close to the logo area, ID card information is recognized, enter the registration waiting interface, and enter the registration main interface after 3 seconds, ensuring the eyes within the preview box at the top of the screen at an appropriate distance. After 100% of the registration progress is completed, the successful extraction of iris feature will pop at the bottom of the screen, indicating that the identification comparison registration is successful.

2.3 Add users

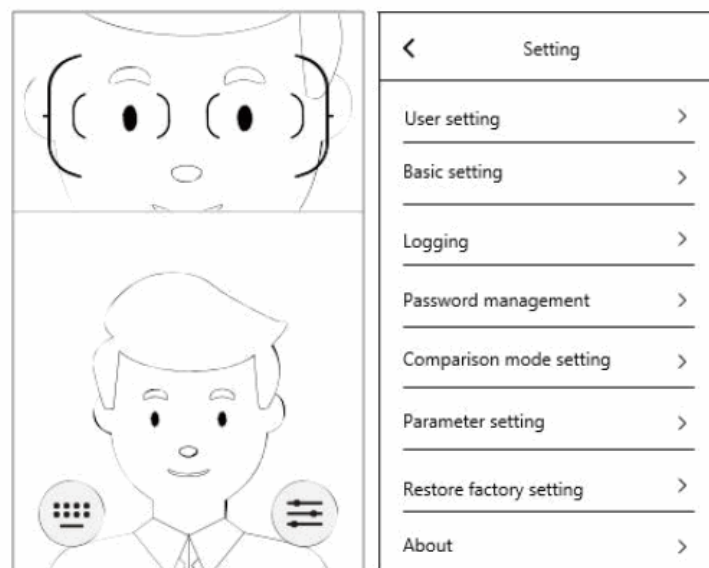

1. Enter settings and add users

- Swipe the screen upward in the main identification interface to show the door opening password input button and the set entry button. Click the set entry button on the right, enter the administrator password and click “Confirm” to confirm the entry setting (administrator can enter the setting via iris recognition).

2. Start adding

- Select user setting and click Add user to select two types of users: register as administrator and general user:
Administrator registration: the registration steps are the same as (3) and (4) in 2.1 Device activation – registration; General user registration: the same as administrator registration.

Door opening mode

3.1 Door opening by identification

Get close to the iris & face multimodal access control, the main identification interface pops up when the person is sensed, align the eyes to the identification frame of the main interface, at an appropriate distance (about 55mm) to open the door by identification.

3.2 Password opening

Get close to the iris & face multimodal access control, the main identification interface pops up when the person is sensed. Press and hold the left mouse button on the main identification interface to swipe the screen upward, and the password input button and setting entry button will appear. Click the password input button on the left, input the door opening password, and click “OK” to open the door by password.



Detailed introduction of management setting function

The administrator user enters the setting interface by referring to Step 1 in 2.3 Add user.

After entering the management setting menu, set the related functions of iris & face multimodal access control.

The specific functions are as follows:

4.1 User setting

<p>< Languages</p>	<p>< User information</p>
<p>中文</p>	<p>Name Xiaobo  Mobile 15898933333</p>
<p>English</p>	<p>Authority management General users</p>
	<p>M1 card No. Swipe card</p>
	<p>Iris feature </p>
	<p>Face feature </p>

You can search users by name and add users in user setting, click registered users to modify their “Name” and “Management Authority”, click “Iris Feature” and “Face Feature” to prompt whether to upload features. Click “OK” to enter the registration interface to update features, and click “Delete” button below to delete users.

4.2 Basic setting

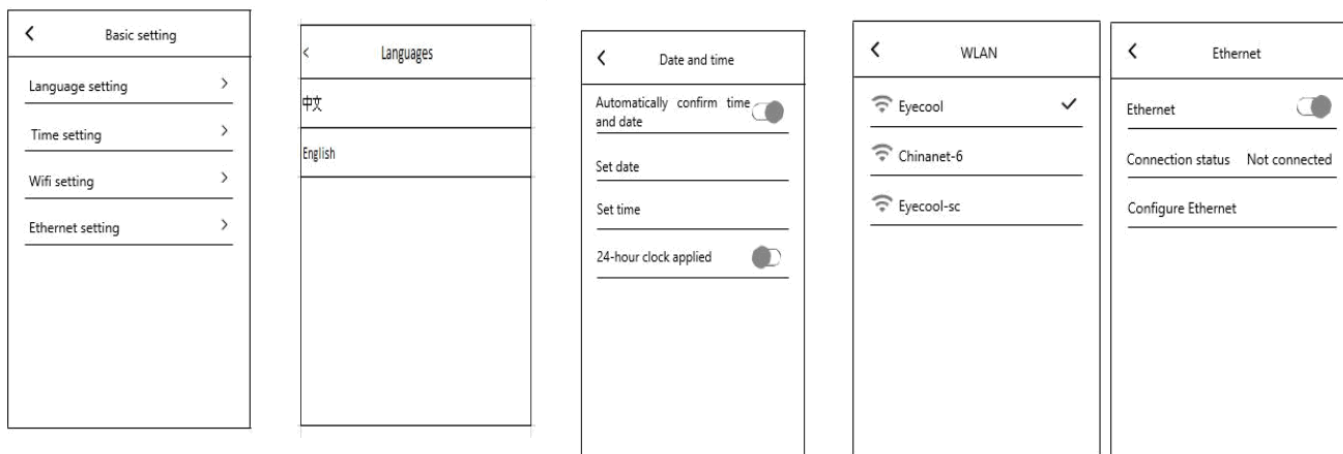

You can change and set the language, time and date, WiFi and Ethernet in basic setting.

4.3 Logging

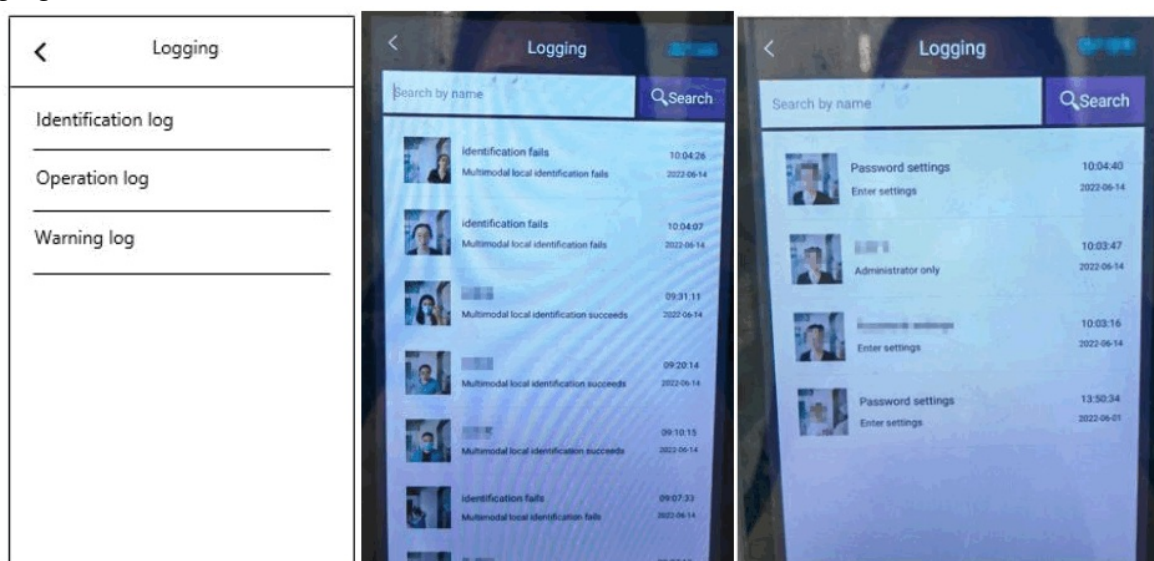

You can see the identification log, operation log and alarm log in logging. You can search by user's name to view the identification opening records and identification failure records in identification log. These records include the specific name, temperature, photo, identification result and time. Enter the operation log to view the entry setting record and time; enter the alarm log to view the monitoring video of the operation when the equipment is removed from the special brackets.

4.4 Password management

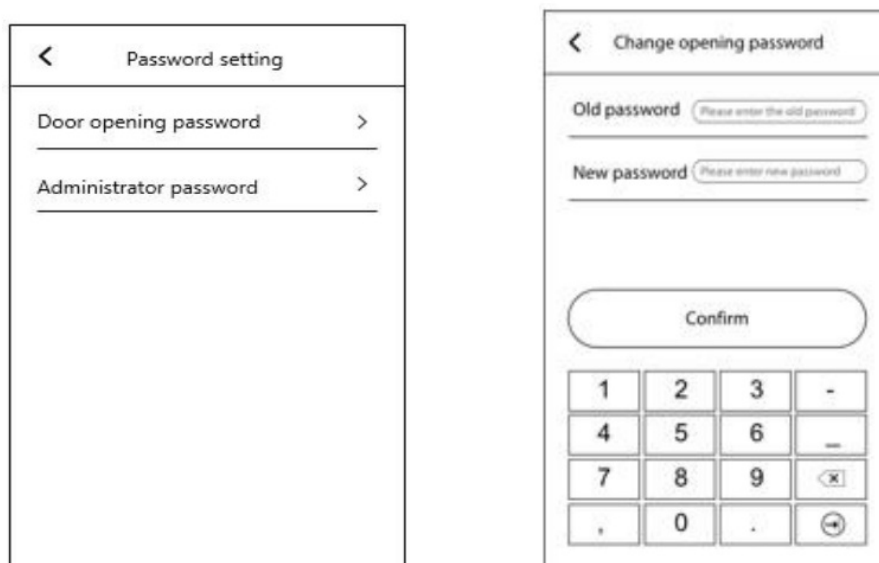

Enter the password management to modify the door opening password and administrator password.

4.5 Comparison mode setting

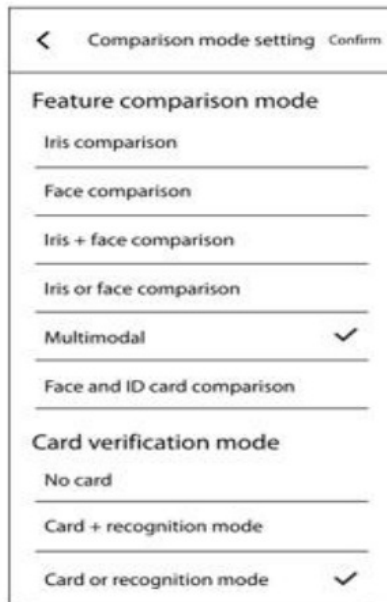

You can change the device and feature comparison modes in the comparison mode setting. The device comparison mode includes: local comparison, network comparison, local + network comparison. The feature comparison mode includes: Iris comparison, face comparison, iris & face comparison, iris or face comparison, multimodal comparison and face & ID card comparison. The ID card verification mode includes: no card, card + identification mode, card or identification mode, the comparison mode above can be changed according to user requirements.

4.6 Advanced setting

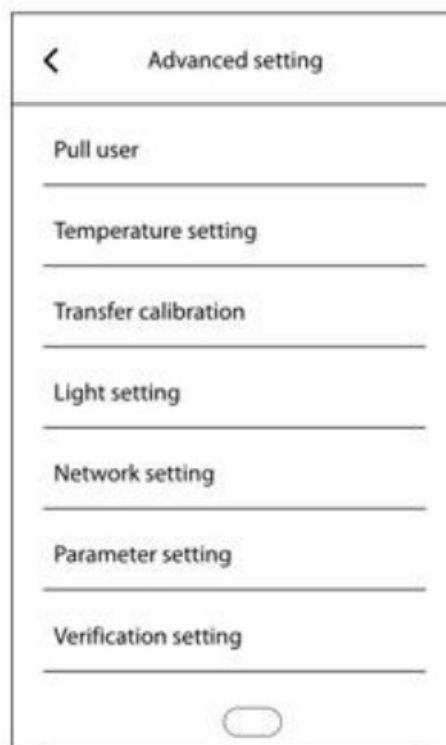

In advanced settings, you can perform user pull, temperature setting, rotation calibration, lighting setting, network setting, parameter settings, and verification setting.

Clicking to pull users can force the user information in the download server to synchronize with the local information in case of poor network connection; Click temperature setting to set the temperature measuring switch, temperature difference, overtemperature prompt and overtemperature setting; Click rotate calibration to calibrate the camera; Click the light setting to adjust the light switch and brightness; Click network settings to set the domain name and network certificate; Click parameter settings to set the door opening delay time, recognition time, default rotation angle of the device and face size; Click verification setting to select the card swiping switch and feature supplementary entry.

4.7 Restore factory setting

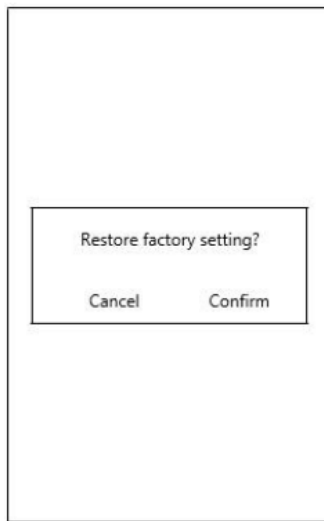

Click to restore factory setting, and a prompt will pop up to confirm whether to restore factory settings. click “Confirm”, and the system will restore to the factory setting.

4.8 About



Enter About to view SN, iris version, face version, face detection version, access control version and other information of the device.

Warranty card

Dear customer, thank you for purchasing Eyecool products. In order to offer you with better service, please carefully read, fill in and properly keep this warranty card after purchasing.

Customer name		Contact	
Customer address		Tel	
Product name		Model	
Date of purchase		Ex-factory No.	
Maintenance records	Date	Fault cause and treatment	

Warranty description

1. Please keep this warranty card properly as maintenance voucher.
2. The warranty period of product is one year from the date of purchase.
3. With the normal use and maintenance during the warranty period, if there is any problem or fault in the material and process, our company will provide maintenance and replacement parts free of charge after investigation.
4. The company has the right to refuse service or charge materials and service fees as appropriate during the warranty period when:
 - 1) It is unable to provide this warranty card and valid purchase certificate.
 - 2) Product failure and damage is caused by improper use by users.
 - 3) The damage is caused by artificial abnormal external force.
 - 4) The damage is caused by disassembly and repair by maintenance technician not authorized by our company.
 - 5) Others damage is caused intentionally.
5. We reserve the right to modify and interpret all the contents.

Federal Communications Commission (FCC) Statement

This device complies with part 15 of the FCC Rules. Operation is subject to the following two conditions: (1) This device may not cause harmful interference, and (2) this device must accept any interference received, including interference that may cause undesired operation.

Note: This equipment has been tested and found to comply with the limits for a Class B digital device, pursuant to part 15 of the FCC Rules. These limits are designed to provide reasonable protection against harmful interference in a residential installation. This equipment generates, uses and can radiate radio frequency energy and, if not installed and used in accordance with the instructions, may cause harmful interference to radio communications. However, there is no guarantee that interference will not occur in a particular installation. If this equipment does cause harmful interference to radio or television reception, which can be determined by turning the equipment off and on, the user is encouraged to try to correct the interference by one or more of the following measures:

- Reorient or relocate the receiving antenna.
- Increase the separation between the equipment and receiver.
- Connect the equipment into an outlet on a circuit different from that to which the receiver is connected.
- Consult the dealer or an experienced radio/TV technician for help.

Warning: Changes or modifications made to this device not expressly approved by Beijing Eyecool Technology Co., Ltd. may void the FCC authorization to operate this device.

Note: The manufacturer is not responsible for any radio or TV interference caused by unauthorized modifications to this equipment. Such modifications could void the user's authority to operate the equipment.

RF exposure statement:

The transmitter must not be colocated or operated in conjunction with any other antenna or transmitter. This equipment complies with the FCC RF radiation exposure limits set forth for an uncontrolled environment. This equipment should be installed and operated with a Minimum distance of 20cm between the radiator and any part of your body.





<http://weixin.qq.com/r/vy20rl3EK9BUrcnP93it>

Tel: 010-59713131 Fax: 01059713031 Email: 6s@eyecool.cn

Address: 8F, Building 1, Brilliant International, Shangdi 10
Street, Haidian District, Beijing

www.eyecool.cn

Documents / Resources

	<p>eyecool ECX333 Multimodal Face Recognition All-in-One Terminal [pdf] User Manual ECX333, 2A7N9-ECX333, 2A7N9ECX333, ECX333 Multimodal Face Recognition All-in-One Terminal, ECX333, Multimodal Face Recognition All-in-One Terminal, Face Recognition All-in-One Terminal, Recognition All-in-One Terminal, All-in-One Terminal, Terminal</p>
---	--

References

-  [\[Link\]](#)