

**exway**  
RP1 Remote Control  
Handle



# exway RP1 Remote Control Handle User Manual

[Home](#) » [exway](#) » exway RP1 Remote Control Handle User Manual 

## Contents

- 1 [exway RP1 Remote Control Handle](#)
- 2 [Product Information](#)
- 3 [Product Usage Instructions](#)
- 4 [Frequently Asked Questions \(FAQ\)](#)
- 5 [Charging port](#)
- 6 [External discharge](#)
- 7 [Power button](#)
- 8 [Skateboard indicator light operations and status](#)
- 9 [Battery replacement](#)
- 10 [Remote control](#)
- 11 [User interface](#)
- 12 [Operation Guides](#)
- 13 [Touch screen instructions](#)
- 14 [Safety Instructions & Disclaimer](#)
- 15 [FCC Caution](#)
- 16 [Documents / Resources](#)
  - 16.1 [References](#)
- 17 [Related Posts](#)



**exway RP1 Remote Control Handle**



## Product Information

### Specifications:

- **Compliance:** FCC Part 15
- **RF Exposure:** General RF exposure requirement met
- **Usage:** Portable exposure condition without restriction

## Product Usage Instructions

### FCC Caution:

This device complies with part 15 of the FCC Rules. Operation is subject to the following two conditions:

1. This device may not cause harmful interference.
2. This device must accept any interference received, including interference that may cause undesired operation.

### Changes and Modifications:

Any changes or modifications not expressly approved by the party responsible for compliance could void the user's authority to operate the equipment.

### RF Exposure:

The device has been evaluated to meet general RF exposure requirement. It can be used in portable exposure conditions without any restrictions.

## Frequently Asked Questions (FAQ)

- **Can this device be used in areas with high interference?**

The device is designed to accept interference and can be used in various environments, including those with interference, as long as it does not cause harmful interference.

- **Are there any restrictions on where this device can be used?**

The device can be used in portable exposure conditions without any restrictions, ensuring flexibility in its usage.

## Charging port

Please charge Flex Paragon with original charger only.

(After the skateboard is fully charged, the charger indicator light turns green. The cover must be closed after charging to ensure waterproof performance.)

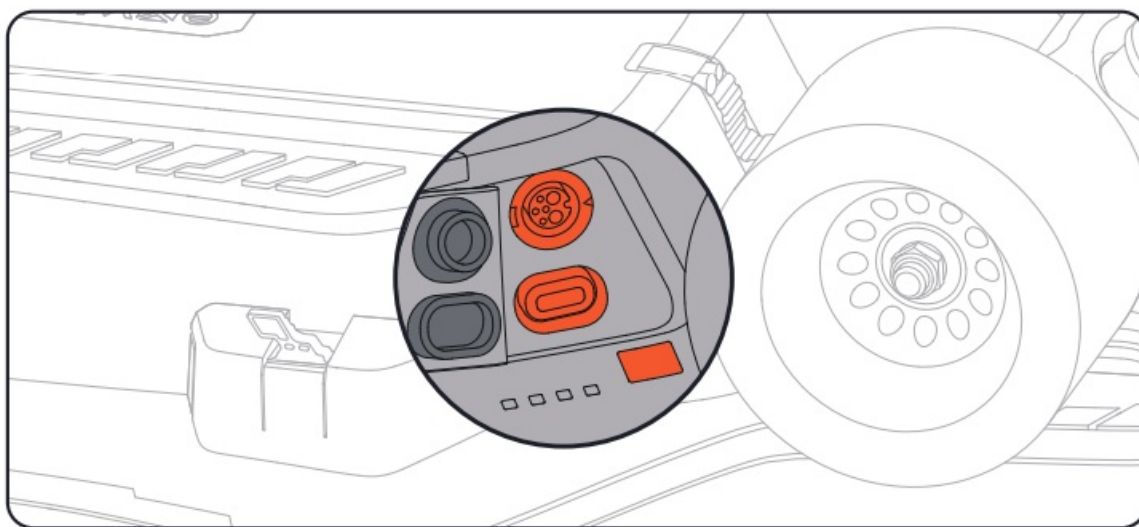

## External discharge

Short press once to display the battery level; long press for 3 seconds to turn on/off the USB-C external discharge function, 60WMax.

## Power button

The power button is located on the ESC at the back of the skateboard. By default, the skateboard in standby mode will turn off after 24 hours. (Can be modified in settings.)

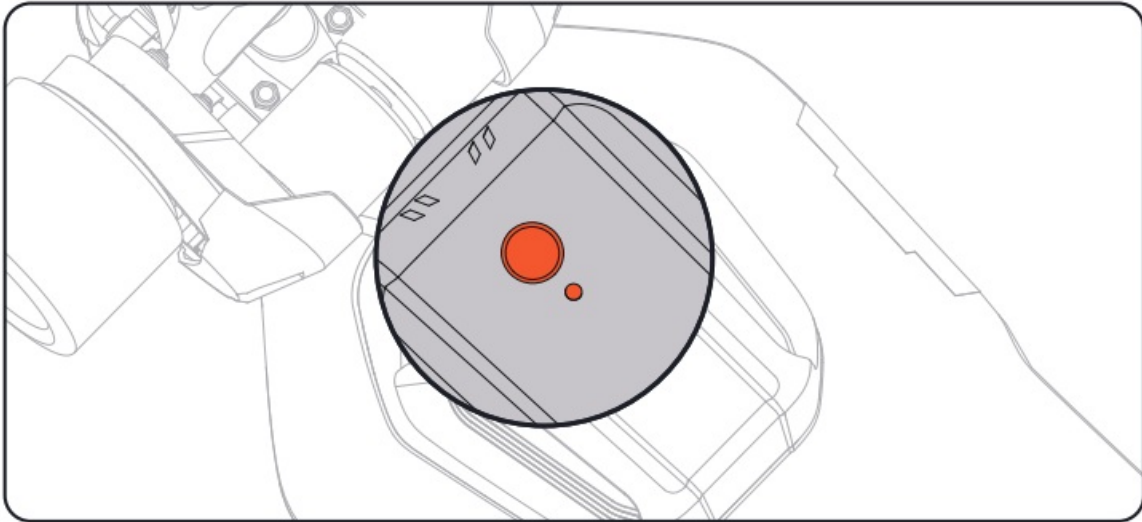

## Skateboard indicator light operations and status

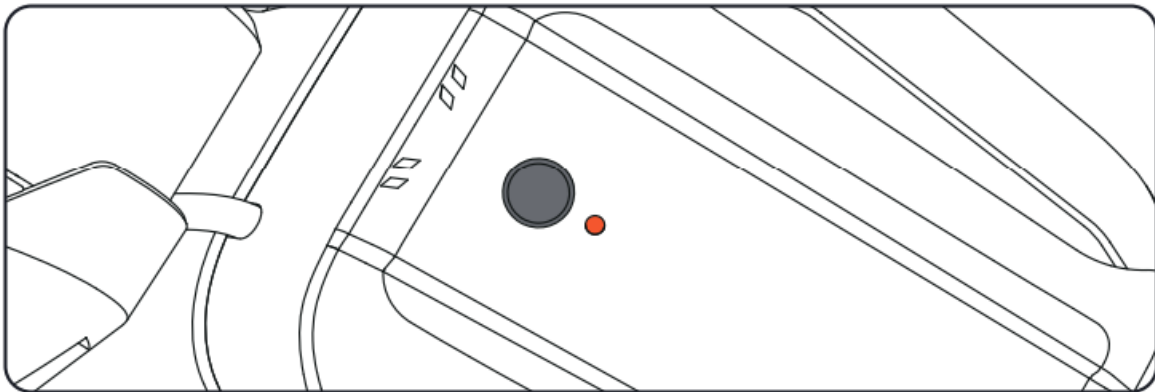

- **Power on**

Press the power button for 1 time



- **Power off**

Long press the power button for 3 seconds



- **Pair**

Press and hold the power button for 8 seconds (When the skateboard is turned off)



- **Green light always on**

Normal working status



- **Green light flashes slowly**

Upgrading



- **Motor matching**

After turn in on the skateboard, s ? art press the button for 5 times



- **Red light always on**

The skateboard is not connected to the remote control



- **Red light flashes slowly**

Charging



- **Red and green lights flash alternately**

Pairing mode



## Battery replacement

1. Press the buckle to unplug the power connector.

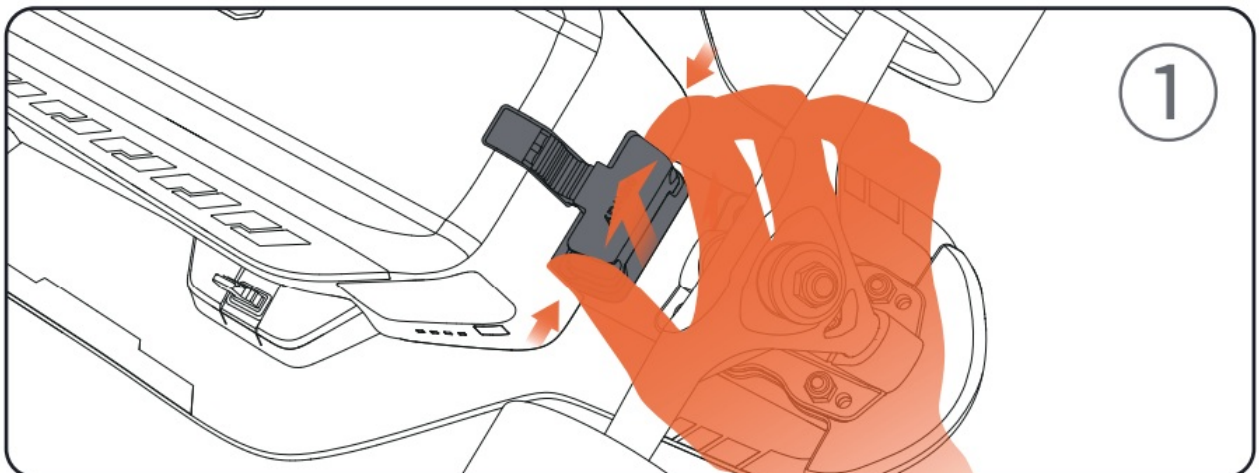

2. Open the two locks on the left and right respectively, push back to remove the battery pack.

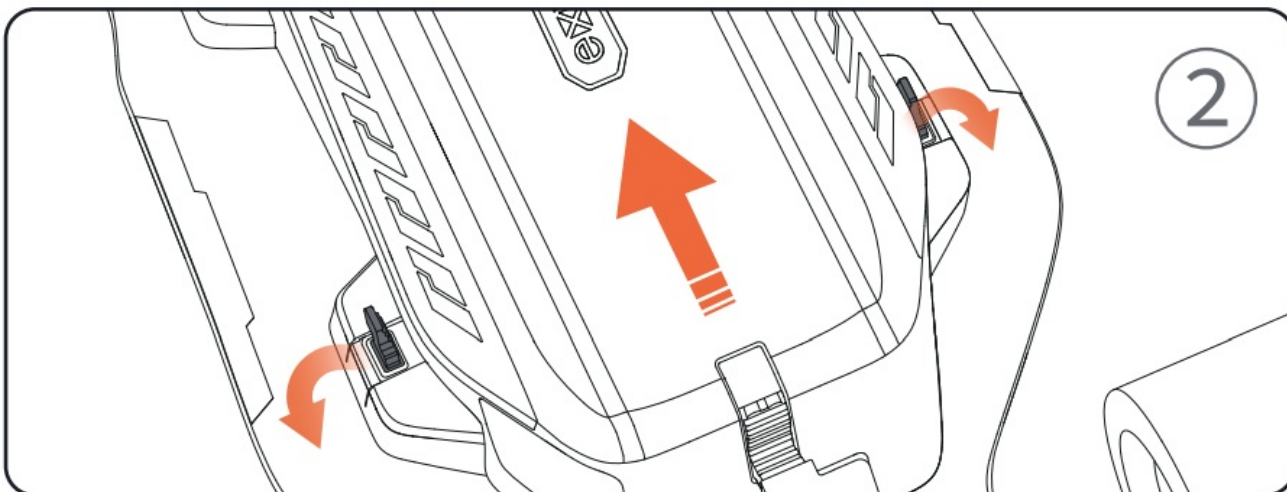

3. Lift the battery connector and push the battery in. Connect the power connector and make sure both locks are well fasten.

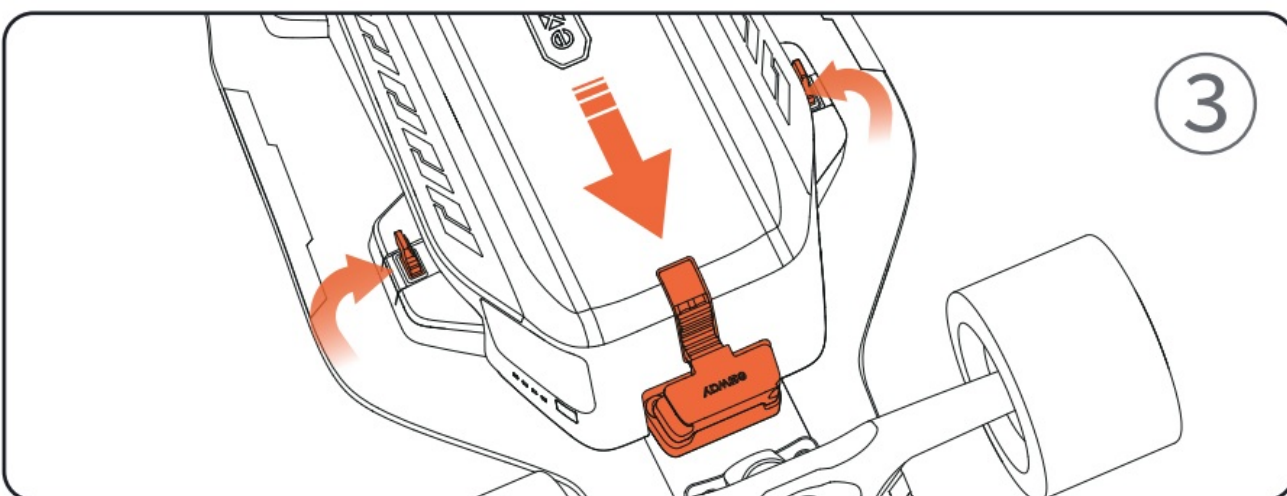

**Remote control**

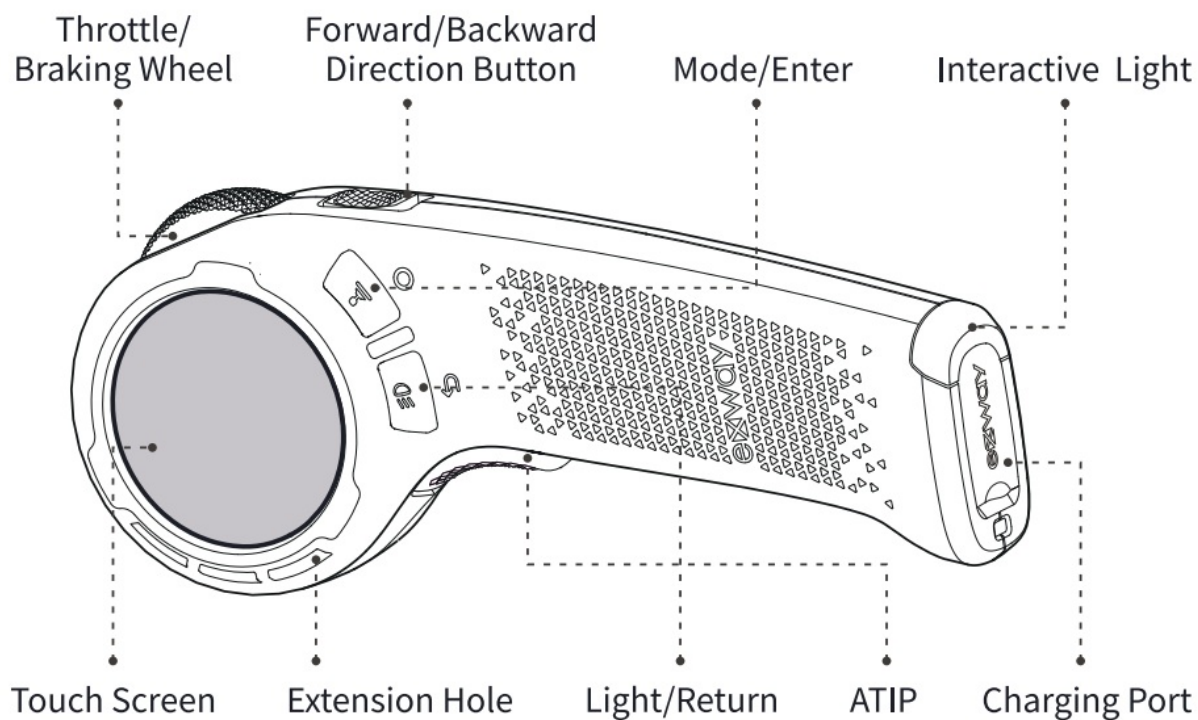

Charging parameters : 5V = 1A

## User interface

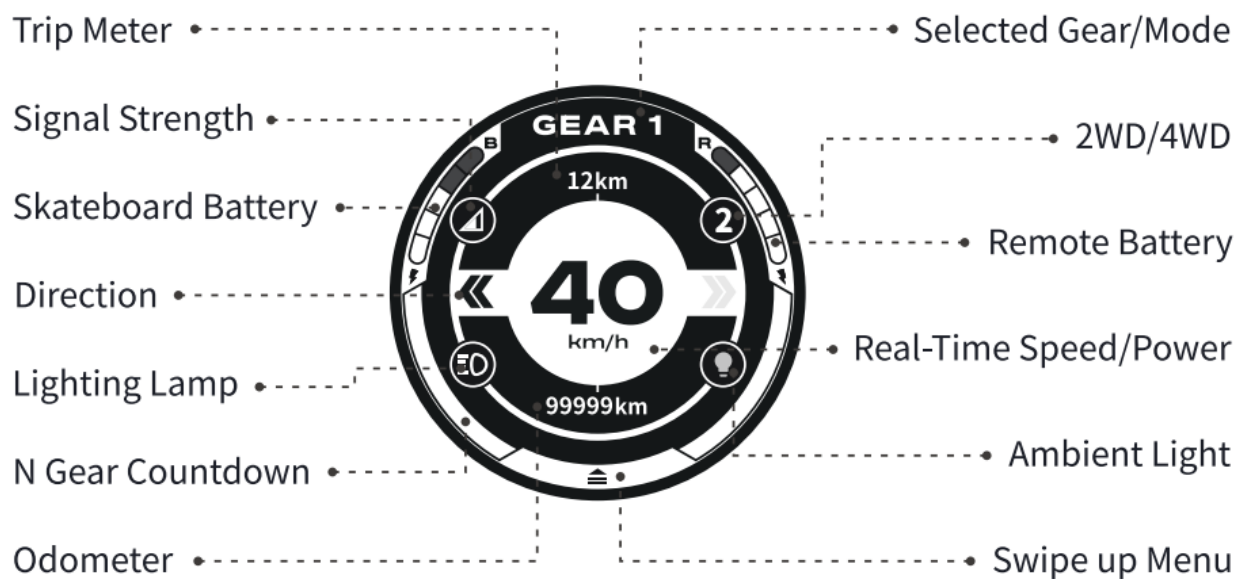

## Operation Guides

### Gear button/direction button operation instructions

- **Power On/Off**

Press and hold the gear button for 2 second





- **Accelerate/Brake**

Spin forward to accelerate Pull back to brake



- **Switch Directions**

Slide to change the board's riding direction (when Speed<5km/h)



- **Switch Gears**

Short press once to select the next speed mode



- **Turbo Mode**

Short press for 3 times



- **Cruise control**

Hold the throttle still+ short press twice to activate cruise control (Speed is 5~25km/h)

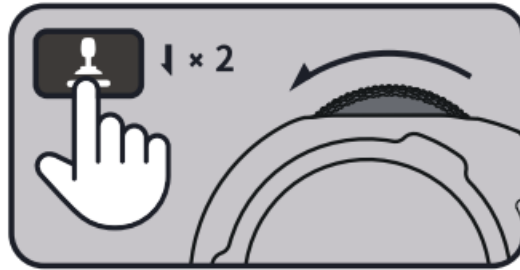

- Menu callout, tank mode (4WD), parking function only take effect when speed is less than 5km/h, but better set them when the skateboard is totally stationary.
- CRUISE Control: After this function is turned on, if the speed of the board changes greater than 5km/h or the throttle wheel is operated, cruise control will deactivate.
- Shift Lock: This function is turned off by default and gear can be shifted only when the skateboard is stationary. This function can be unlocked from the setting menu. Once it's turned on, the gear can be switched as long the remote roller is centered when the skateboard is rolling.

### Light Button/ATIP Button Operation Instructions

- **Turn on/off the ambient light**

Short press the button 1 time



- **Switch ambient light animation**

Short press the button 2 times



- **Turn on/ off the lighting lamp**

Short press the button 3 times



- **Left/right turn signal**

Tilt the remote control left/right+ short press unlock button 2 times to activate it



- **Operation mode/setting menu switching**

Long press the button for 2 seconds (Speed < 5km/h)



- **N Gear**

No input of throttle wheel for a period of 5 seconds will automatically activate neutral gear mode. Push ATIP button to activate previously selected speed mode



- **Parking mode**

Pull the throttle wheel to the braking position while the board is stationary+ short press the ATIP button 3 times

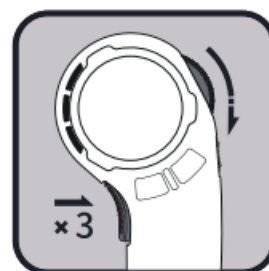

- **Remove parking mode**

In the parking mode, press the ATIP button one time



- Atlas Pro, Flex Pro and other devices do not have lighting and ambient lighting functions, so turning on the functions will have no effect.
- Turn signal: In the operation mode, twist your wrist and press the ATIP button twice to enter the turn signal mode and it automatically exits after 5 seconds.
- ATIP: After the anti-accidental touch function is turned on, the brake and turn signal functions are available, but the throttle acceleration is not available.

## **Touch screen instructions**

### **Speed mode/power mode switching**

Double-tap the center of the screen, you can switch speed mode/power mode.

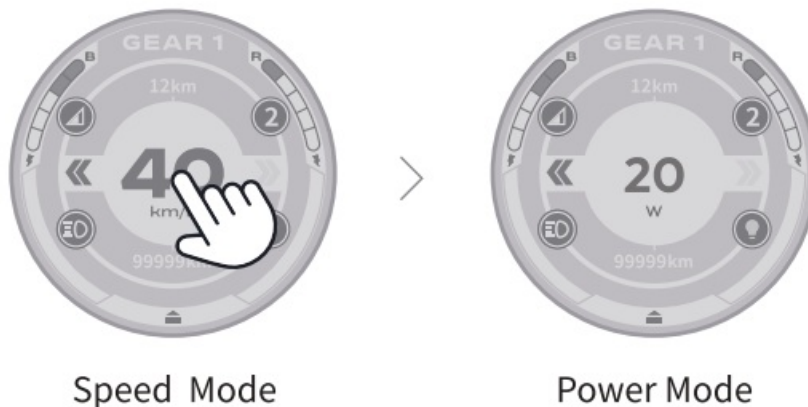

### **Enter the setting interface**

Swipe up from the bottom/Swipe down from the top. Click the return button to Exit and return back.

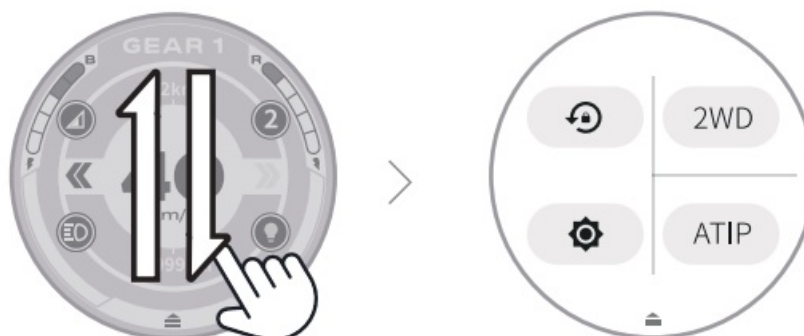

## **Introduction to setting interface**



Screen Rotation Lock Switch.



2WD/4WD Switch.



Screen Brightness Switch.



Accidental Throttle Input Prevention Switch/ATIP.

**ATIP** ATIP:When ATIP function is turned on, the gear N will be entered when the countdown is ended.

**2WD** 2WD/4WD switching, it can be switched successfully only when the board selected is workable with 4WD.

 Screen rotation currently supports two directions. (After unlocking the screen lock, keep the screen vertical to the ground for 1 second to switch the direction.)

### Lighting Parameter Settings

Swipe right from the left edge/swipe left from the right edge to enter the settings interface. Click the return button to exit the setting.



### Introduction to setting interface



Slide to adjust the brightness of the display.



Jump to the light speed frequency setting page.



Jump to the light color setting page.

### This device complies with Part 15 of the FCC Rules.

Operation is subject to the following two conditions.

1. This device may not cause harmful interference.and
2. This device must accept interference received,including interference that may cause undesired operation.

### Safety Instructions & Disclaimer

1. Using an electric skateboard has the same potential risks as other sports and may cause injury. even death.
2. You must read the instruction manual before use and wear protective gear.
3. The belt will wear out under normal use, please refer to Exway related tutorial videos for correct replacement Damaged belt.
4. Please follow local traffic laws and regulations and use it safely within the permitted scope.
5. Children under 14 years old, disabled people, pregnant women, the elderly, etc., as well as those with mental

- disorders, diseases, It is prohibited for use by people with impairments in normal body movement.
6. Skateboard, remote control, App will be continuously updated, and there may be differences between the manual and the final version of the firmware . For details, please refer to the official website for the latest version.
  7. If not used for a long time, please charge and discharge the skateboard every 30 days to have around 30-75% battery left for storage to ensure battery life.
  8. After replacing the battery, please ensure that the plug and fixing buckle are installed in place, otherwise it may affect the power supply and Waterproof properties.
  9. The product has certain waterproof performance, but failure caused by water ingress is not covered by the warranty. Please pay attention to waterproofing.
  10. Please cover the rubber plug after using the external discharge function to ensure waterproof performance.

## FCC Caution

This device complies with part 15 of the FCC Rules. Operation is subject to the following two conditions:

1. This device may not cause harmful interference
2. this device must accept any interference received, including interference that may cause undesired operation.

Any Changes or modifications not expressly approved by the party responsible for compliance could void the user's authority to operate the equipment.

**Note:** This equipment has been tested and found to comply with the limits for a Class B digital device, pursuant to part 15 of the FCC Rules. These limits are designed to provide reasonable protection against harmful interference in a residential installation. This equipment generates uses and can radiate radio frequency energy and, if not installed and used in accordance with the instructions, may cause harmful interference to radio communications. However, there is no guarantee that interference will not occur in a particular installation. If this equipment does cause harmful interference to radio or television reception, which can be determined by turning the equipment off and on, the user is encouraged to try to correct the interference by one or more of the following measures:

- Reorient or relocate the receiving antenna.
- Increase the separation between the equipment and receiver.
- Connect the equipment into an outlet on a circuit different from that to which the receiver is connected.
- Consult the dealer or an experienced radio/TV technician for help.

The device has been evaluated to meet general RF exposure requirement. The device can be used in portable exposure condition without restriction.

## Documents / Resources

<p>Exway Flex Paragon Manual 数显说明书</p> <p>exway</p>	<p><a href="#">exway RP1 Remote Control Handle</a> [pdf] User Manual 2APTF-RP1, 2APTFRP1, rp1, RP1 Remote Control Handle, RP1, Remote Control Handle, Control Handle, Handle</p>
---	--

## References

- [User Manual](#)

[Manuals+](#), [Privacy Policy](#)

This website is an independent publication and is neither affiliated with nor endorsed by any of the trademark owners. The "Bluetooth®" word mark and logos are registered trademarks owned by Bluetooth SIG, Inc. The "Wi-Fi®" word mark and logos are registered trademarks owned by the Wi-Fi Alliance. Any use of these marks on this website does not imply any affiliation with or endorsement.