



EXPLORÉ Thermo/Hygro Sensor ST2001H Instruction Manual

[Home](#) » [EXPLORÉ](#) » EXPLORÉ Thermo/Hygro Sensor ST2001H Instruction Manual

EXPLORÉ Thermo/Hygro Sensor ST2001H
Instruction Manual

EXPLORE[®]

SCIENTIFIC

Thermo/Hygro Sensor

Art.No.: ST2001H

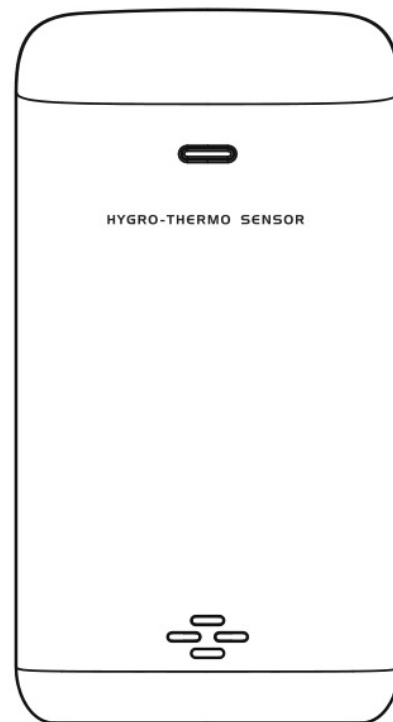

INSTRUCTION MANUAL

ABOUT THIS INSTRUCTION MANUAL



These operating instructions are to be considered a component of the device. Please read the safety instructions and the operating instructions carefully before use. Keep these instructions for renewed use at a later date. When the device is sold or given to someone else, the instruction manual must be provided to the new owner/user of the product.



GENERAL WARNINGS

- Risk of electric shock — This device contains electronic components that operate via a power source (batteries). Children should only use the device under adult supervision. Only use the device as described in the manual; otherwise, you run the risk of an electric shock.
- Choking hazard — Children should only use the device under adult supervision. Keep packaging material, like

plastic bags and rubber bands, out of the reach of children, as these materials pose a choking hazard.

- Risk of chemical burn — Keep batteries out of the reach of children! Make sure you insert the batteries correctly. Leaking battery acid can lead to chemical burns. Avoid contact of battery acid with skin, eyes and mucous membranes. In the event of contact, rinse the affected region immediately with a plenty of water and seek medical attention.
- Risk of fire/explosion — Do not expose the device to high temperatures. Use only the recommended batteries. Do not short-circuit the device or batteries, or throw them into a fire. Excessive heat or improper handling could trigger a short-circuit, a fire, or an explosion.
- Do not disassemble the device. In the event of a defect, please contact your dealer. The dealer will contact the Service Centre and can send the device in to be repaired, if necessary.
- Use only the recommended batteries. Always replace weak or empty batteries with a new, complete set of batteries at full capacity. Do not use batteries from different brands or with different capacities. The batteries should be removed from the unit if it has not been used for a long time.

SCOPE OF DELIVERY

Sensor, Operating instructions.

BEFORE YOU BEGIN

- We recommend using alkaline batteries. If temperatures regularly fall below 0°C (32°F), we recommend using lithium batteries.
- Avoid using rechargeable batteries. (Rechargeable batteries cannot maintain correct power requirements.)
- Insert batteries before first use, matching the polarity in the battery compartment. 2x AA Batteries are required.

EC DECLARATION OF CONFORMITY



Hereby, Bresser GmbH declares that the equipment type with part number: ST2001H is in compliance with Directive: 2014/53/

EU. The full text of the EU declaration of conformity is available at the following internet address:

www.bresser.de/download/ST2001H/CE/ST2001H_CE.pdf

FCC DECLARATION OF CONFORMITY



This device complies with Part 15 of the FCC Rules. Operation is subject to the following two conditions:

(1) this device may not cause harmful interference, and (2) this device must accept any interference received, including interference that may cause undesired

operation. Please note that changes or modifications not expressly approved by the party responsible for compliance could void the user's authority to operate the equipment.

NOTES ON CLEANING

- Remove the batteries before cleaning.

- Only use a dry cloth to clean the exterior of the device. To avoid damaging the electronics, do not use any cleaning fluid.
- Protect the device from dust and moisture.

WARRANTY & SERVICE

The regular guarantee period is 2 years and begins on the day of purchase. To benefit from an extended voluntary guarantee period as stated on the gift box, registration on our website is required. You can consult the full guarantee terms as well as information on extending the guarantee period and details of our services at www.bresser.de/warranty_terms. Would you like detailed instructions for this product in a particular language? Then visit our website via the link below (QR code) for available versions. Alternatively you can also send an email to manuals@bresser.de or leave a message on +49 (0) 28 72 – 80 74-220*. Please always state your name, precise address, a valid phone number and email address, as well as the article number and name.

*Number charged at local rates in Germany (the amount you will be charged per phone call will depend on the tariff of your phone provider); calls from abroad will involve higher costs.



http://archive.bresser.de/download/warranty_terms/warranty_terms.pdf

OVERVIEW

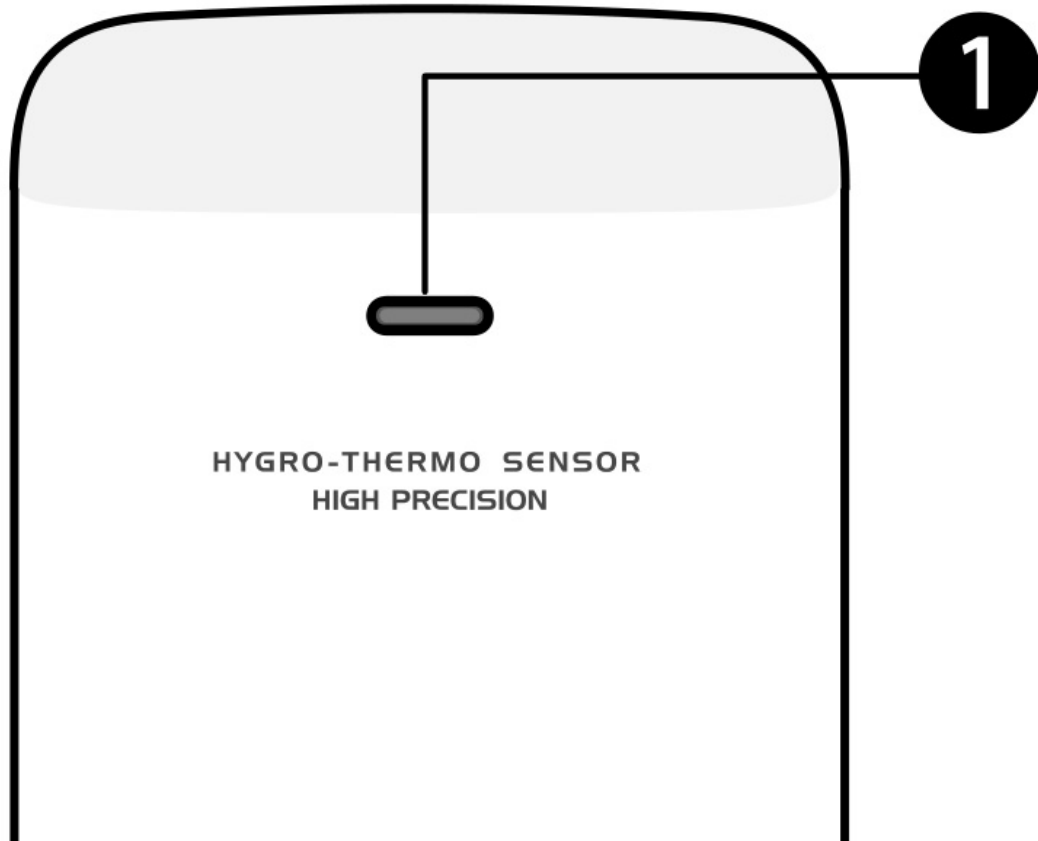

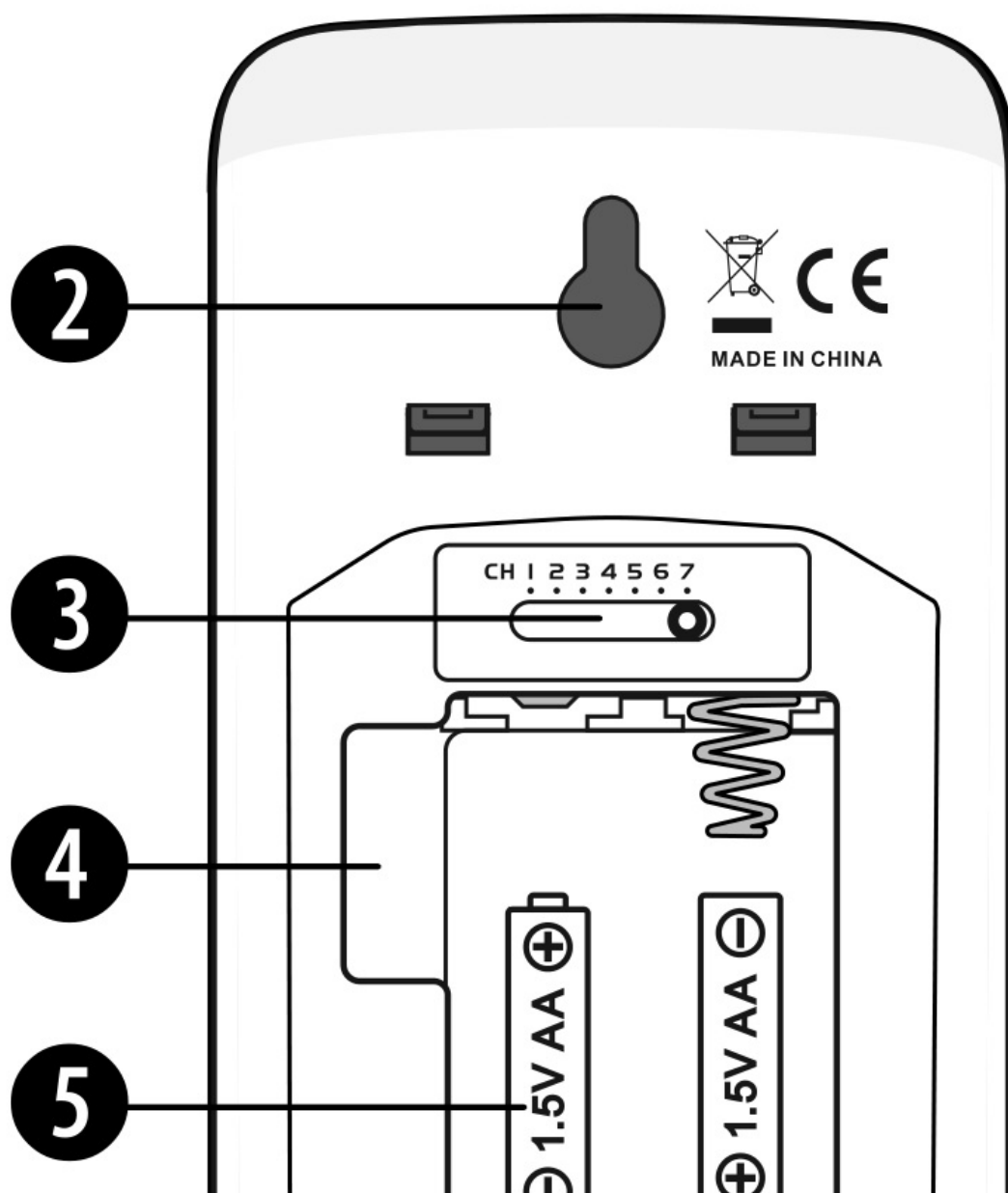
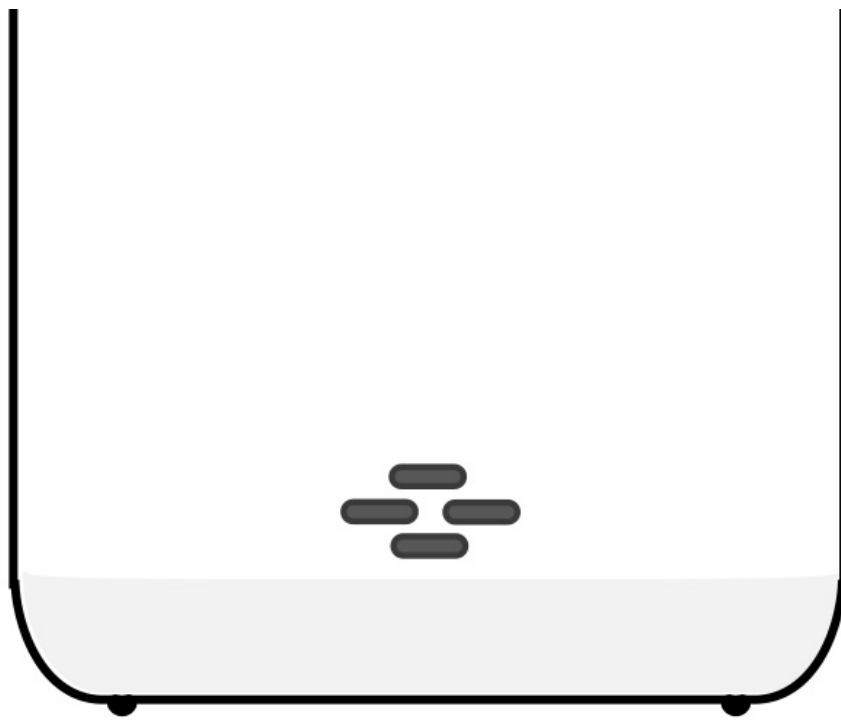

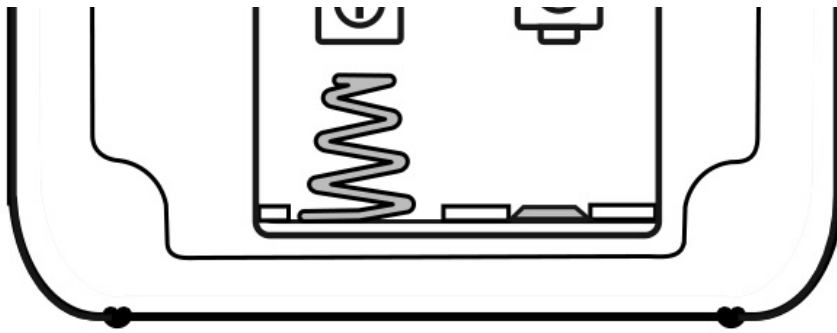

WIRELESS THERMO-HYGRO SENSOR

1. Remove the battery door.
2. Slide the [**CHANNEL**] slide switch to choose a channel.
3. Insert 2 x AA size batteries into the battery compartment according to the polarity mark on the battery compartment..
4. Close the battery door.

Note:

- Ensure to assign different channels of different sensors, in case you need to pair more than one sensors.
- Once the channel is assigned to a Wireless Thermo-Hygro sensor, you can only change it by removing the batteries or resetting the unit.
- Avoid placing the sensor in direct sunlight, rain or snow.

PAIRING THE WIRELESS SENSORS WITH THE CONSOLE

The console will automatically search and connect to your wireless sensor(s). Once your sensor(s) pair up successful, the sensor(s) signal strength indication and weather information will appear on your console display.

RESET THE SENSOR

In case of mal-function, press [**RESET**] button to reset the sensor.

HOW TO PLACE THE SENSOR

- Choose a location on the exterior of the home where can shield the sensor from direct sunlight or wet conditions for an accurate reading.
- Hang it with the wall mount hole or place it directly on flat surface, and make sure the transmission is within 150 meters approx.
- Minimize obstructions such as doors, walls, furniture, etc.

IMPORTANT NOTE

- Read and keep these instructions.
- Do not cover the ventilation holes with any items such as newspapers, curtains etc.
- Do not clean the unit with abrasive or corrosive materials.
- Technical specifications and user manual contents for this product are subject to change without notice.

SPECIFICATIONS

Dimensions (W x H x D)	61 x 113 x 39.5mm (2.4 x 4.4 x 1.6 in)
Weight	144g (with batteries)
Main power	2 x AA size 1.5V batteries (Lithium battery recommended for low temperature environment)
Weather data	Temperature and humidity
RF frequency	868Mhz (EU, UK) / 917Mhz (AU) / 915Mhz (US)
RF transmission range	150m (300feet) straight distance
Number of channels	7 (CH1 ~ 7)
Transmission interval	60 seconds
Operating temperature range	-40 ~ 60°C (-40 ~ 140°F)
Operating humidity range	RH 1% to 99 %

DISPOSAL



Dispose of the packaging materials properly, according to their type, such as paper or cardboard. Contact your local waste-disposal service or environmental authority for information on the proper disposal.



 Do not dispose of electronic devices in the household garbage! As per the Directive 2002/96/EC of the European Parliament on waste electrical and electronic equipment and its adaptation into German law, used electronic devices must be collected separately and recycled in an environmentally friendly manner.



In accordance with the regulations concerning batteries and rechargeable batteries, disposing of them in the normal household waste is explicitly forbidden. Please make sure to dispose of your used batteries as required by law — at a local collection point or in the retail market. Disposal in domestic waste violates the Battery Directive. Batteries that contain toxins are marked with a sign and a chemical symbol.



Cd¹



Hg²



Pb³

1. battery contains cadmium
2. battery contains mercury
3. battery contains lead

Contents [[hide](#)

[1 Documents / Resources](#)

[2 Related Posts](#)

Documents / Resources



[EXPLORE Thermo/Hygro Sensor ST2001H](#) [pdf] Instruction Manual

EXPLORE, Thermo, Hygro Sensor, ST2001H