

## expert4house RF433 Smart Touch Switch Instruction Manual

[Home](#) » [EXPERT4HOUSE](#) » expert4house RF433 Smart Touch Switch Instruction Manual 

### Contents

- [1 expert4house RF433 Smart Touch Switch](#)
- [2 Wiring diagram](#)
- [3 Wi-Fi Switch \( wifi 2.4G\)](#)
- [4 Documents / Resources](#)
- [5 Related Posts](#)



### expert4house RF433 Smart Touch Switch

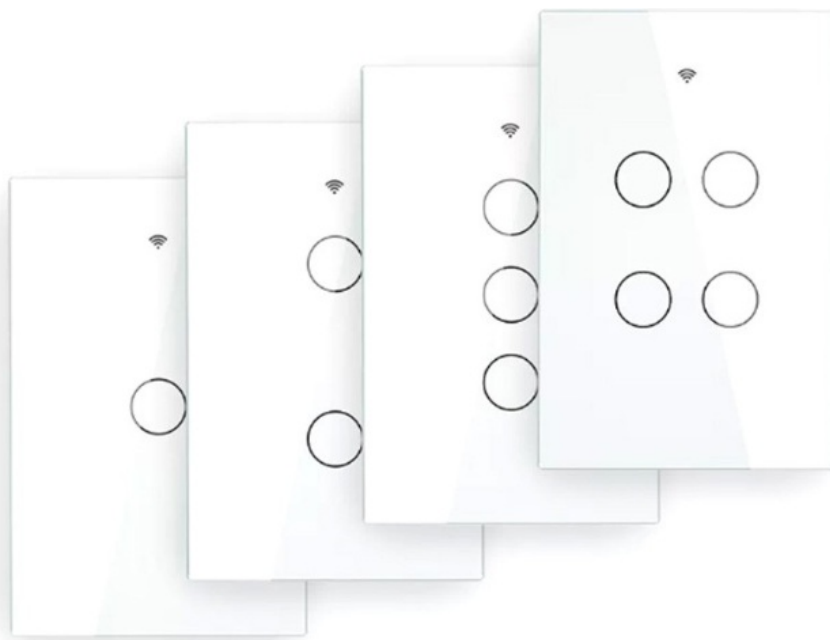

## Wiring diagram

1. Make Sure electricity is cut off during the installation.
2. The switch must be installed without electricity Electricity must be turn on after the installation(Cover the glass touch panel), Touch for test after 10 seconds, Or the switch will not work well.

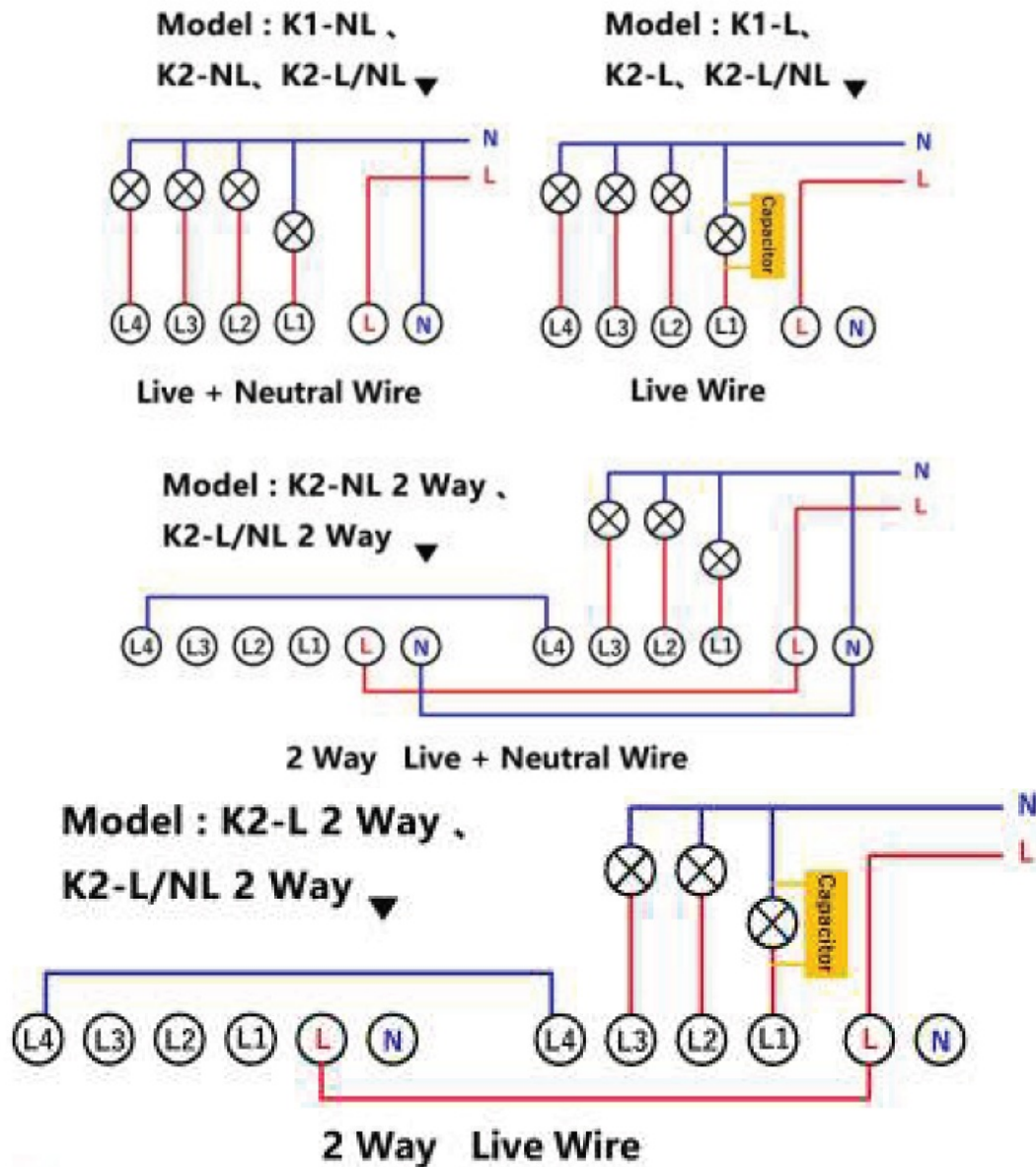

Without neutral wire is installed, The yellow Capacitor components must be distributed in parallel to Land N of the lamp holder connected in L 1 position (As shown in the wiring diagram)

### RF Switch ( rf433 )

RF pairing: press the switch L 1 touch key for 3-5 seconds, and the signal light is red. After pressing, click the key a of the remote control device (or the key that needs to control the switch) and wait for 1-2 seconds to pair  
Powered signal light goes out (L2 / L3 / L4 rf433 control repeats the above operation process)  
Remove rf433 and Wifi pairing connection operation process: press the switch L1 touch key for 10 seconds, and the product will restart Press after starting standby.

### Wi-Fi Switch ( wifi 2.4G)

1. Scan the QR code below or search Smart Life in !OS App store or Google play.



## 2. Download & Registration

- Scan the QR code to download 'Smart Life' Application.
- Enter the register/login interface, Input the phone number for getting verification code to register or through other methods at the bottom of page connecting to related authentication interface to log in.



## 3. Easy Mode (Recommend)

**Preparation :** Device has connected with electricity, long press on/off button for 5 seconds until indicator light quickly flashes, the application already stepped into 'My Device' interface

- Phone has connected to Wi-Fi and been able to connect to internet
- Tap the icon '+' on the top right corner of 'My Device' choose your device type, enter into 'Add Device'.

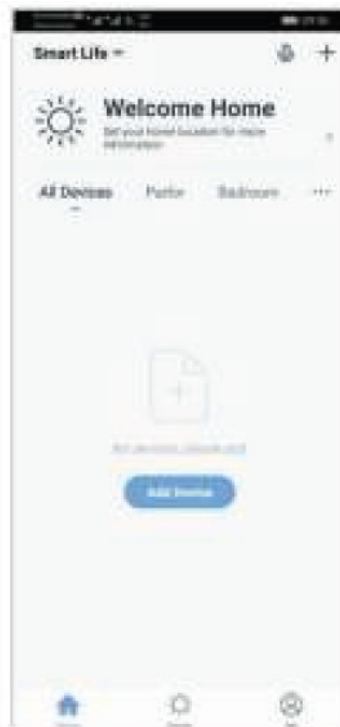

- Make sure the indicator light is flashing quickly, then tap the related button in application.
- Choose the local Wm and enter the correct password, tap 'Next' .
- Wait for configuring successfully, and click 'Complete'.
- Now you can control the smart switch through Smart Life App.
- Once the configuration is completed successfully, the indicator light will turn to solid blue and the device will be added to the "Device list"

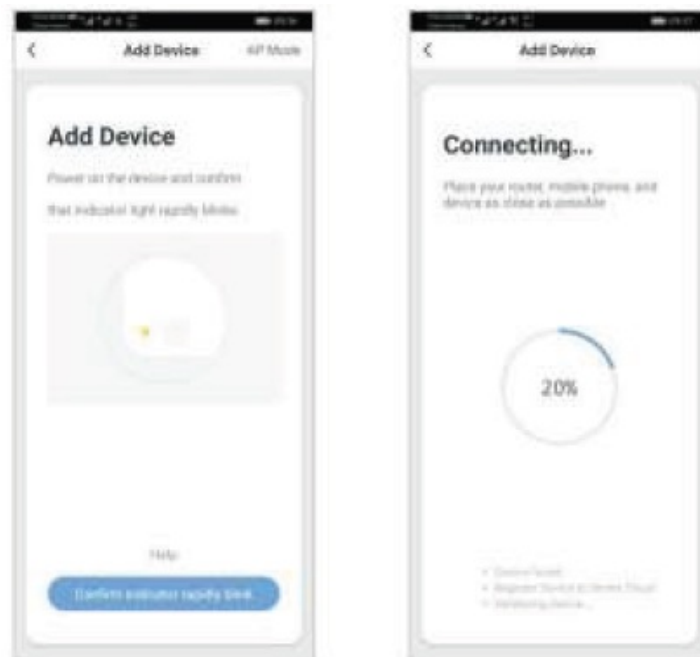

**Note:** there is no Internet connected while the blue light flashing slowly

## Documents / Resources

	<p><a href="#">expert4house RF433 Smart Touch Switch</a> [pdf] Instruction Manual RF433 Smart Touch Switch, RF433, Smart Touch Switch, Touch Switch, Switch</p>
-------------------------------------------------------------------------------------	---------------------------------------------------------------------------------------------------------------------------------------------------------------------