

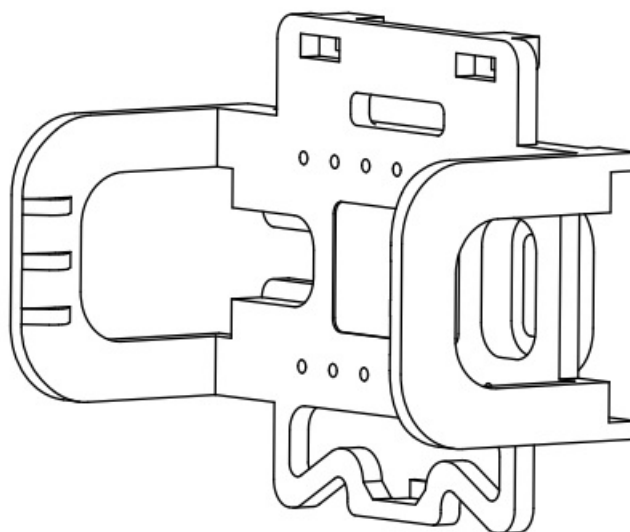

## expert4house MS-105B 2 Gang Wi-Fi Dimmer Switch Module Instruction Manual

[Home](#) » [EXPERT4HOUSE](#) » expert4house MS-105B 2 Gang Wi-Fi Dimmer Switch Module Instruction Manual 

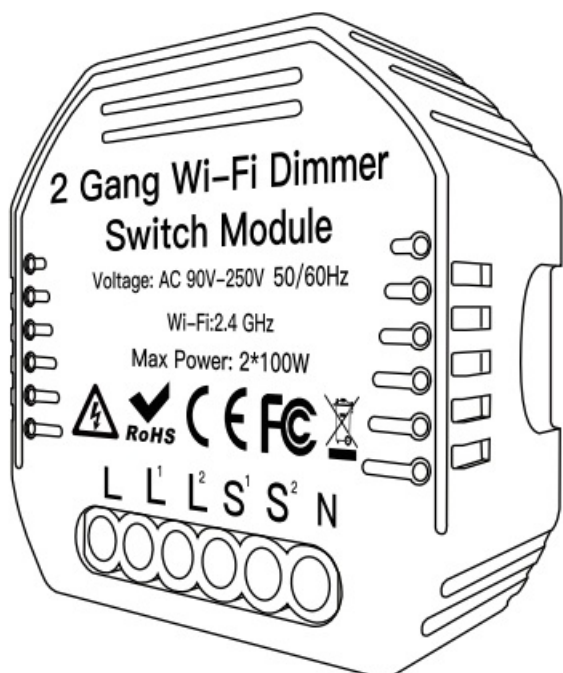

Mounting Clip

### Contents

- [1 MS-105B 2 Gang Wi-Fi Dimmer Switch Module](#)
- [2 INSTALLATION](#)
- [3 TECHNICAL SPECIFICATIONS](#)
- [4 FAQ](#)
- [5 MANUAL OVERRIDE](#)
- [6 Documents / Resources](#)
- [7 Related Posts](#)

## MS-105B 2 Gang Wi-Fi Dimmer Switch Module



### Deutsches Handbuch

[https://drive.google.com/file/d/1GQhNKO\\_LHDq-dRPhJ419HBsVqbY0pkqsj/view?usp=sharing](https://drive.google.com/file/d/1GQhNKO_LHDq-dRPhJ419HBsVqbY0pkqsj/view?usp=sharing)



Schedule timer



Voice control-work  
with Google Home

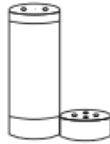

Voice control-work  
with Amazon Alexa



Device Sharing

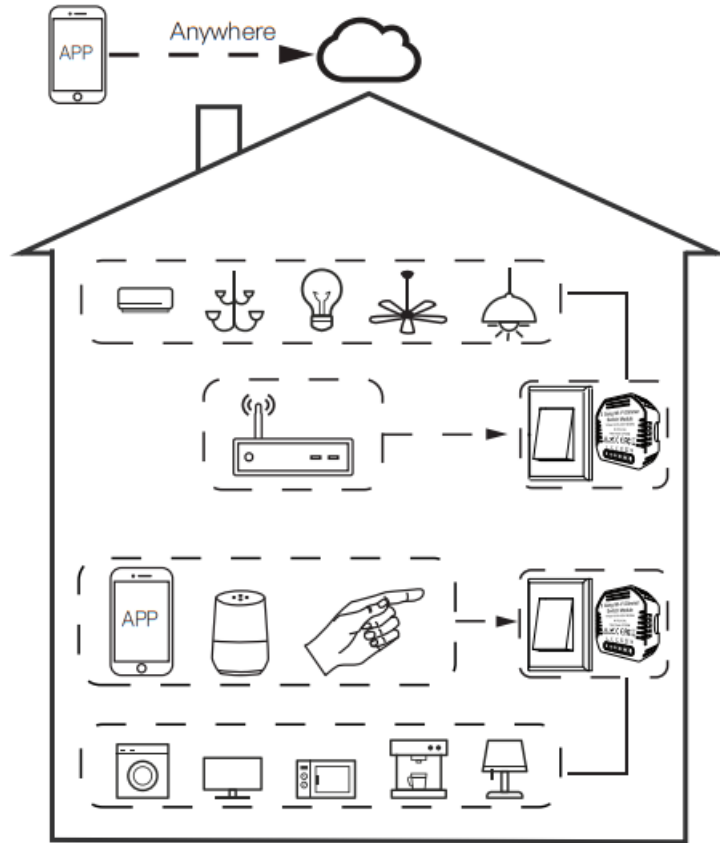

### Inhouse local operation



App

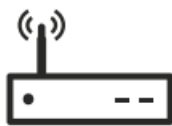

Router



Voice control

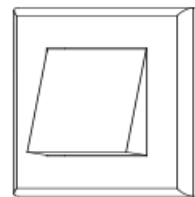

Push switches

**Reset  
switch**

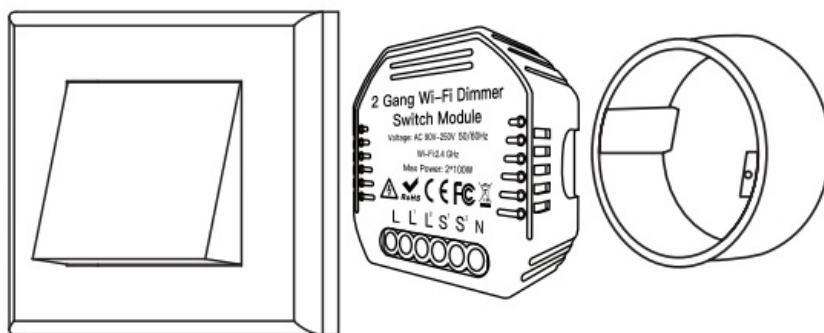
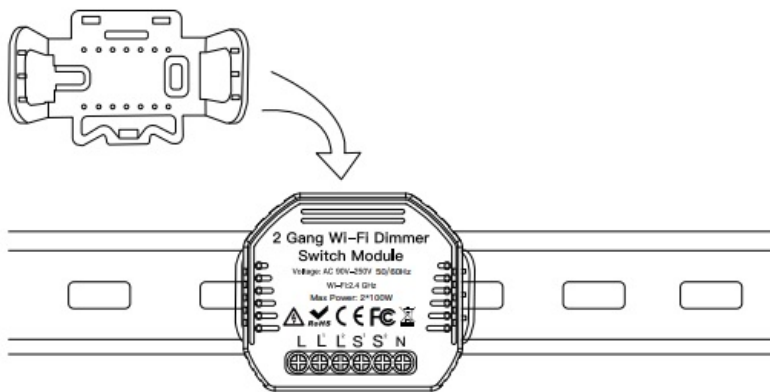

Global international operation Whenever & Wherever You are, All-in-one Mobile App

## INSTALLATION

### Warnings:

1. electrician in acco Installation must be carried out by a qualified rdance with local regulations.
2. Keep the device out of the reach of children.
3. Keep the device away from water , damp or hot environment.
4. Install the device away from strong signal sources such as microwave oven that may cause signal interruption resulted in abnormal operation of the device.
5. Obstruction by concrete wall or metallic materials may reduce the effective operation range of the device and should be avoided.
6. Do NOT attempt to disassemble, repair or modify the device.

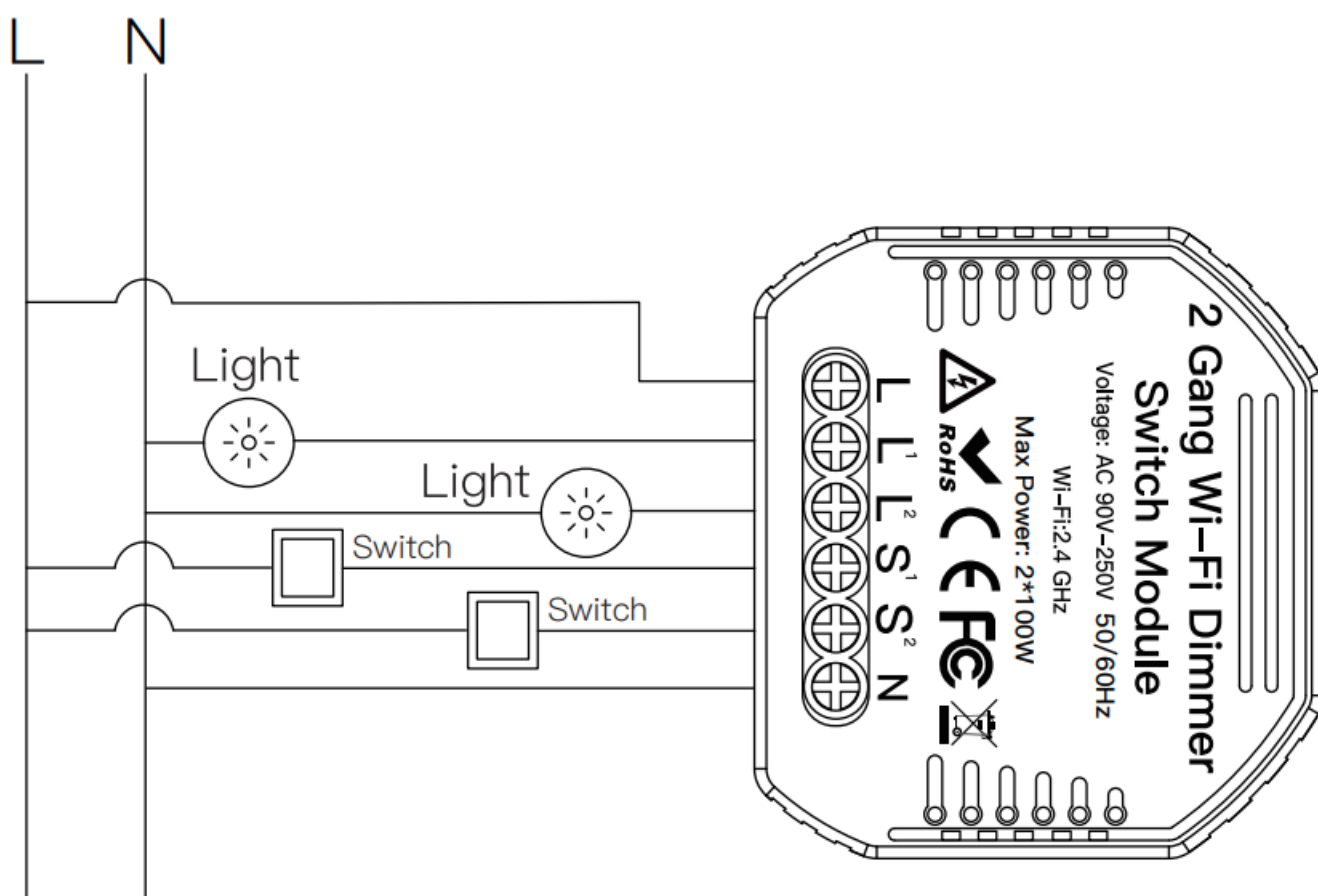
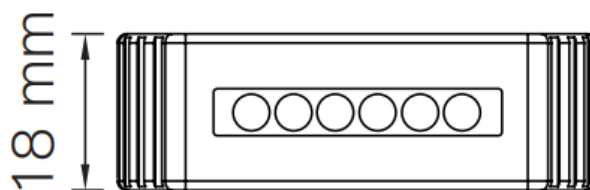
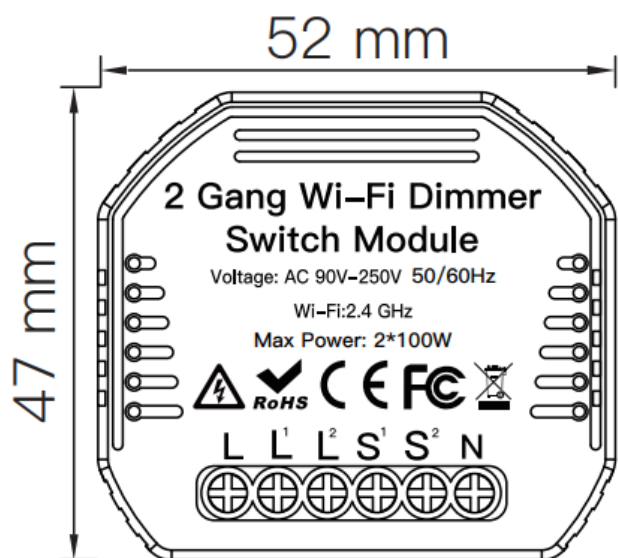

WIRING DIAGRAM

## TECHNICAL SPECIFICATIONS

Product type	2 Gang WiFi Dimmer Switch Module
Voltage	90-250V AC
Max Power	2*100w
WiFi frequency	2.4GHz WiFi
Operation temp. Case temp.	-10°C – +40°C
Case temp.	Tc: +80°C (Max.)
Operation range	≤ 200 m
Dims (WxDxH)	52x47x18 mm
IP rating	IP20
Warranty	1 years

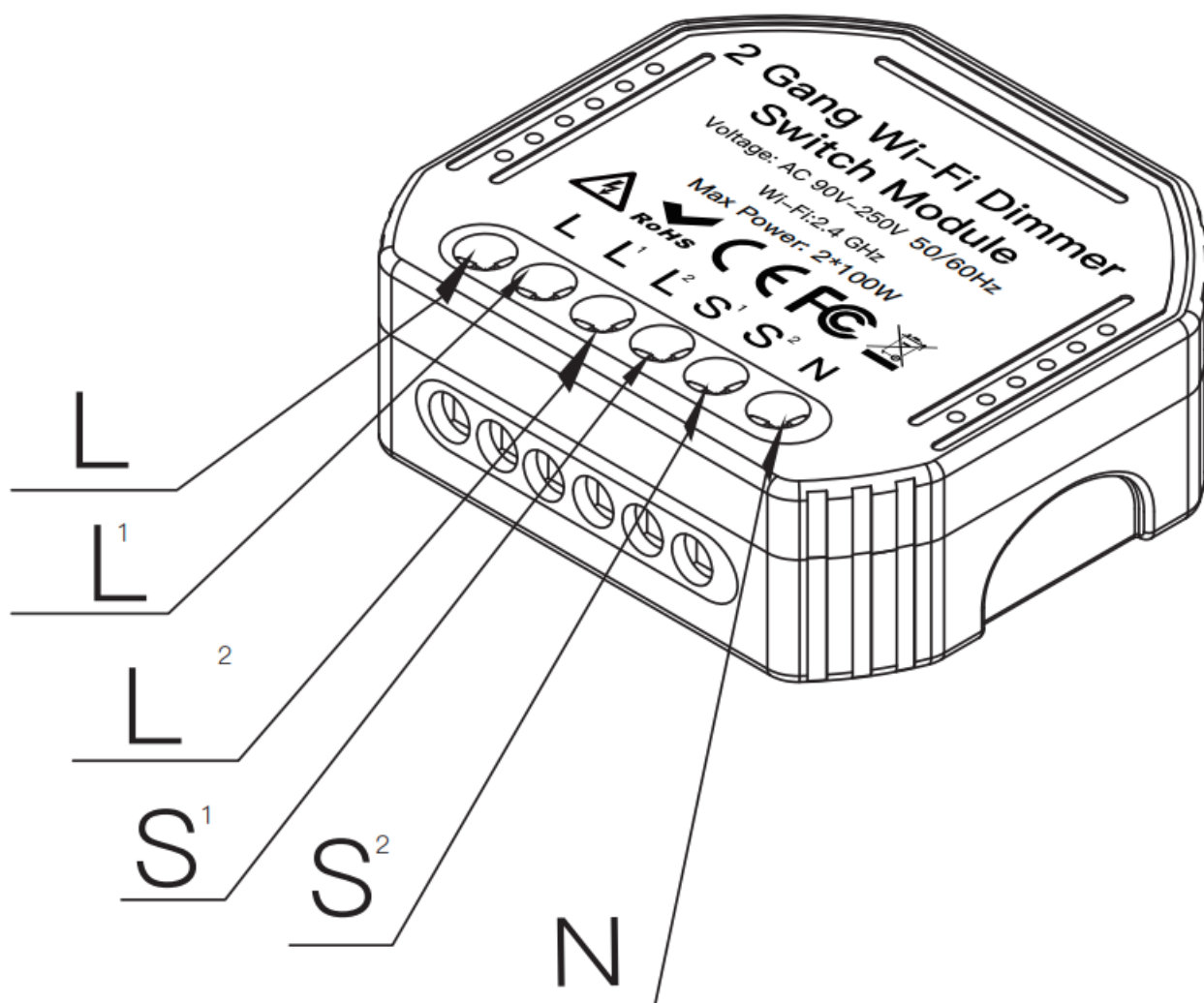

#### EMC Standard (EMC)

EN 300 328 V2.1.1 (2016-11),  
 EN 301489-1 V2.1.1 (2017-02),  
 EN 301489-17 V3.1.1 (2017-02),  
 EN 62311: 2008, EN 55015:2013 +A1:2015, EN 61547:2009

#### Safety Standard (LVD)

IEC 60669-2-1:2002/AMD1:2008/  
 AMD2:2015, IEC 60669-1:1998/

AMD1:1999/AMD2:2006,  
EN 60669-2-1:2004+A1: 2009+ A2:2010,  
EN 60669-1:2018  
RoHS Standard (RoHS) 2011/65/EU, (EU) 2015/883Wiring Instructions and Diagrams

1. Turn off the power supply before carrying out any electrical installation work.
2. Connect wires according to the wiring diagram.
3. Insert the module into the junction box.
4. Connect the power supply and follow switch module configuration instructions.

**Notes:** Put your smartphone close to the switch module when you're configuring, and make sure you have min. 50% Wi-Fi signal.

## **FAQ**

### **Q1: What should I do if I can't configure the switch module?**

- a. Please check whether device is powered on.
- b. Make sure your mobile and switch module are under the same 2.4 GHz Wi-Fi network.
- c. Whether it's in good internet conditions.
- d. Make sure the password entered in App is correct.
- e. Make sure the wiring is correct.

### **Q2: What device can be connected to this Wi-Fi switch module?**

- Most of your household electrical appliances can be, such as lamps, laundry machine, coffee maker, etc.

### **Q3: What happens if the Wi-Fi goes off?**

- You can still control the device connected to the switch module with your traditional switch and once Wi-Fi is active again the device connected to module will connect automatically to your Wi-Fi network.

### **Q4: What should I do if I change the Wi-Fi network or change the password?**

- You have to re-connect our Wi-Fi switch module to the new Wi-Fi network according to the App User Manual.

### **Q5: How do I reset the device?**

- Power on/off device 10 times until the beeper on the module sounds continuously.

## **MANUAL OVERRIDE**

The switch module terminal reserves the access of manual override function for the end-user to switch on/off .

- Switch on/off for permanent on/off function.

### **Notes:**

1. Both the adjustment on App and switch can be reset , the last adjustment remains in memory.
2. The App control is synchronized with the manual switch.



iOS App / Android App

<http://smartapp.tuya.com/smartlife>

A line-art illustration of a smartphone. The screen displays a registration form with the following elements:

- A back arrow icon followed by the text "Register".
- A text input field containing the placeholder text "Region".
- A text input field containing the placeholder text "Mobile number/e-mail address".
- A grey button with the text "Obtain verification code".

Reset Switch

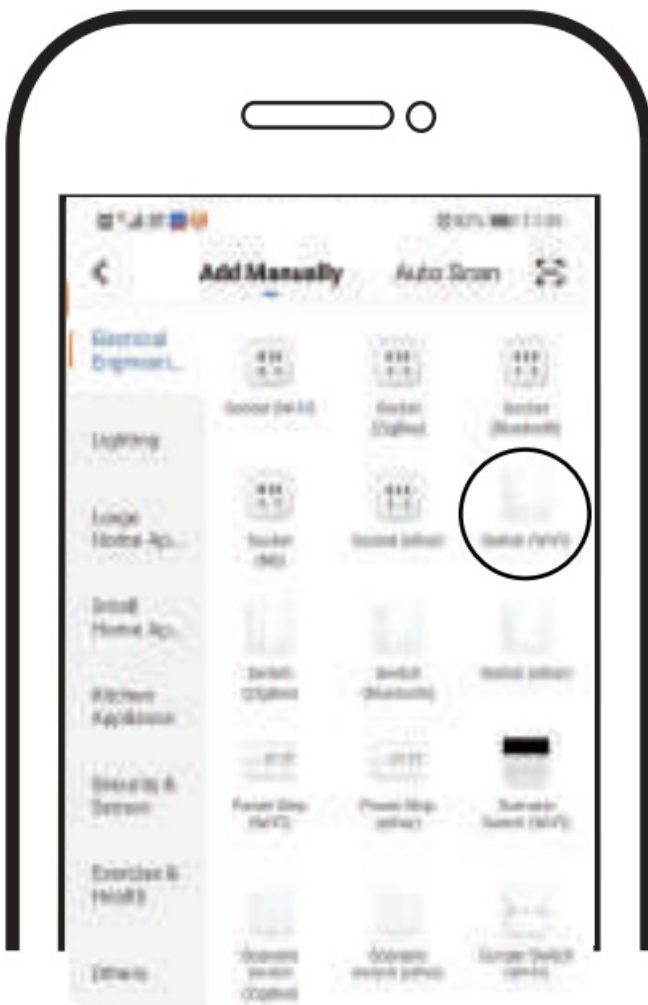
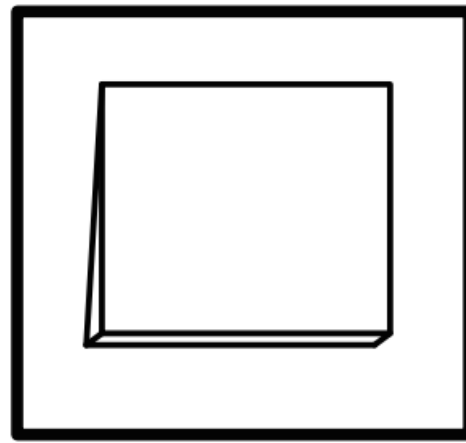
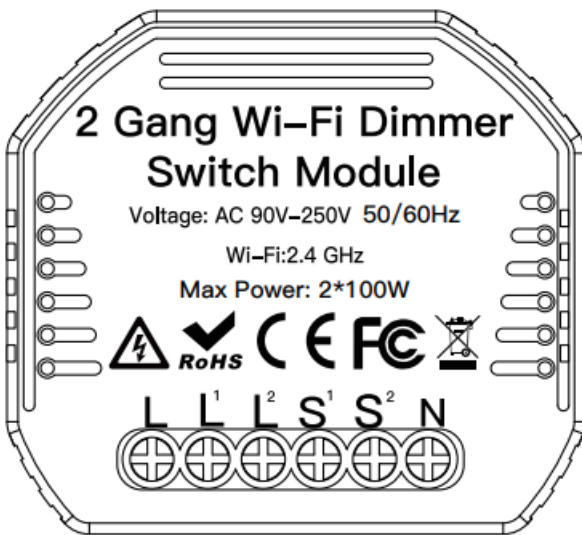

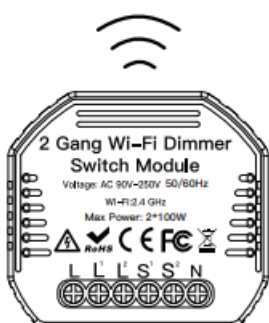
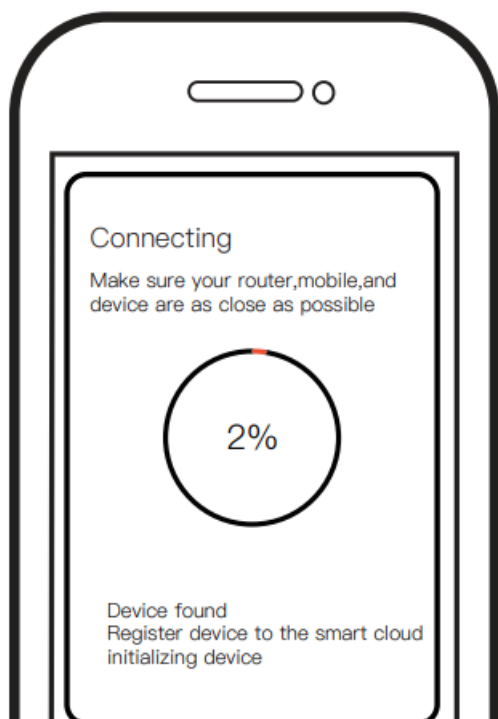
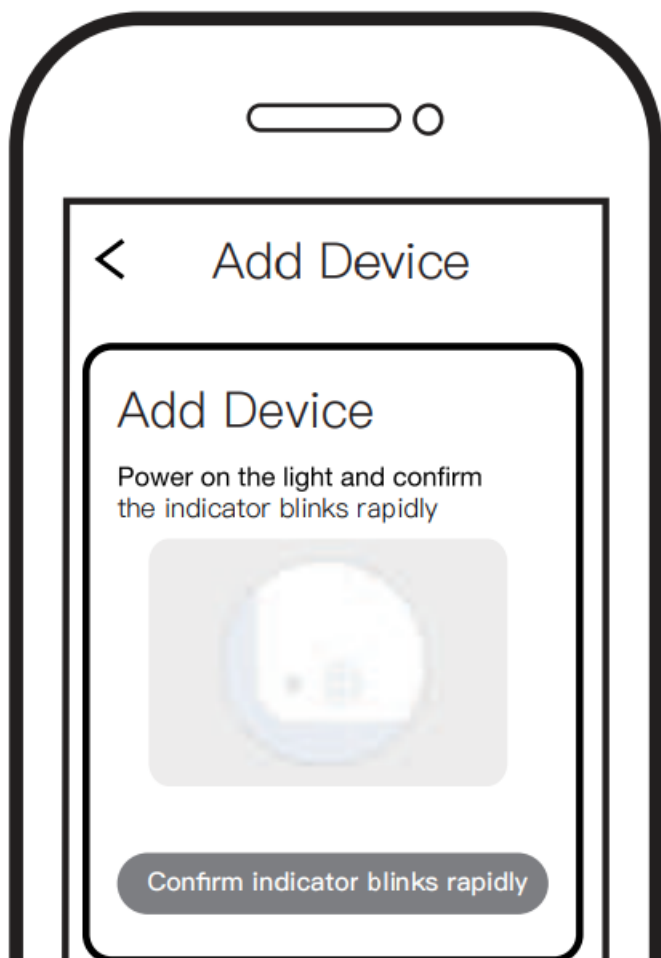

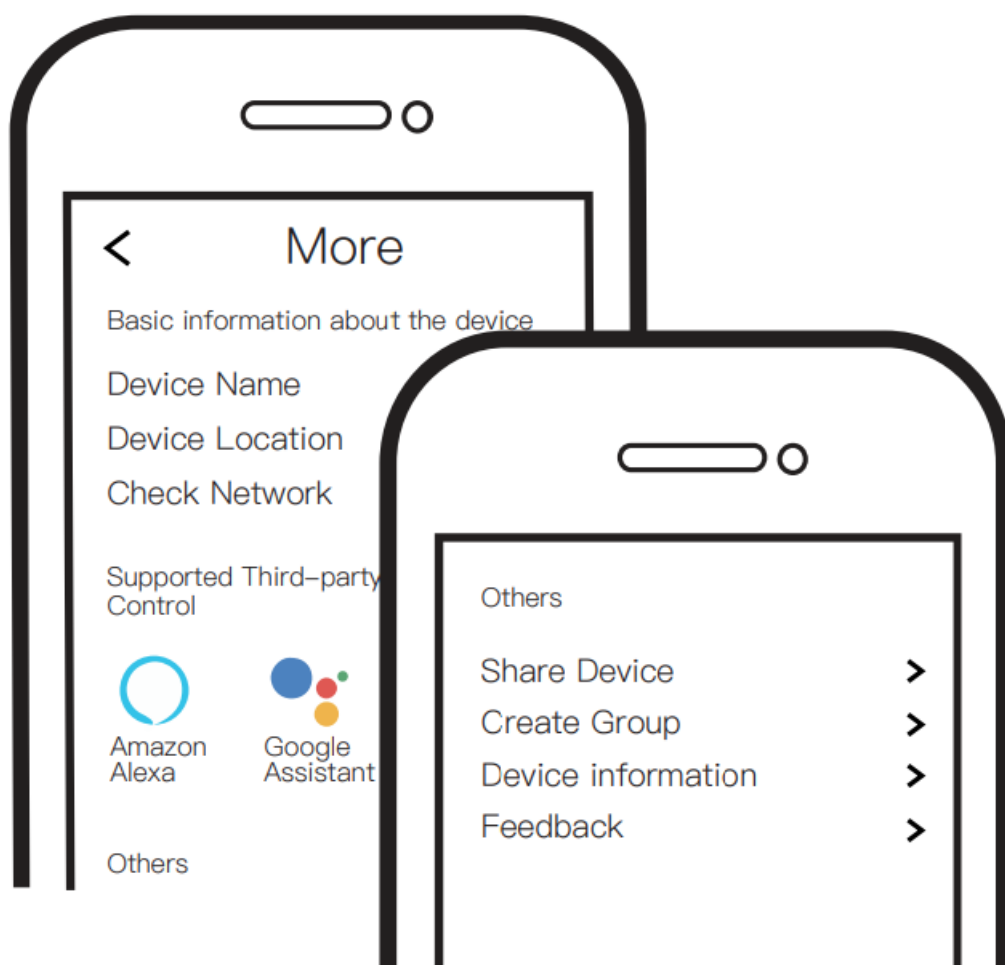
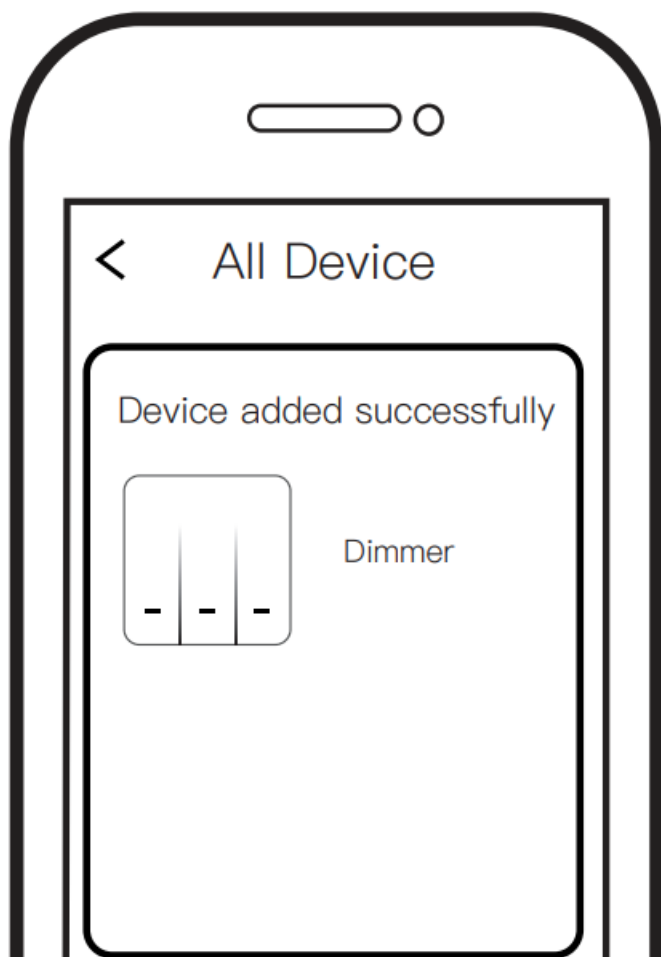

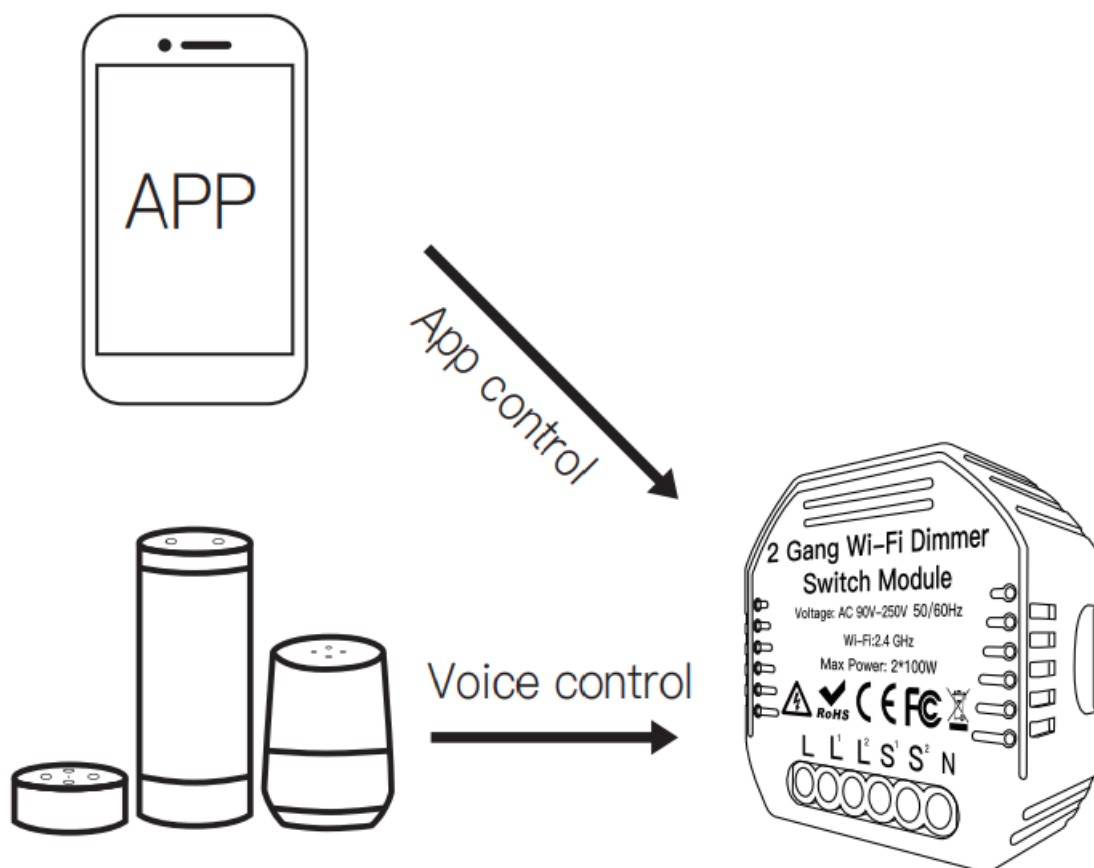

Scan the QR code to download Smart Life App, or you can also search keyword “Smart Life” at App Store or Googleplay to download App. Log in or register your account with your mobile number or e-mail address. Type in the verification code sent to your mobile or mail box, then set your login password. Click “Create Family” to enter into the App. **Note:** This smart switch module can only be used with reset switch.

After the wiring of switch module is done, press the return button switch for 10 times (keep time interval not too short) until the beep sounds continuously and rapidly as Di-Di-Di... for pairing mode. Open the App, select “+” on top right and choose “Switch (Wi-Fi)” to add device. Make sure your smart phone and WiFi switch module are under the same WiFi network at 2.4GHz connection. Confirm when the light blinks rapidly (twice a second). The connecting will take about 10-120 seconds to complete depending on your network condition. When pairing is done, the Dimmer will be shown on the App, and you are able to change the device name to your own taste. Connect to Amazon Alexa or Google Assistant for voice control, or share the devices with your families or friends. Enjoy your smart life of home automation for lighting control by using our All-in-one mobile App wherever you are in the world or simply by voice control when you are sitting at home comfortably.

## Documents / Resources

	<a href="#">expert4house MS-105B 2 Gang Wi-Fi Dimmer Switch Module</a> [pdf] Instruction Manual MS-105B 2 Gang Wi-Fi Dimmer Switch Module, MS-105B, 2 Gang Wi-Fi Dimmer Switch Modul e, Dimmer Switch Module, Switch Module, Module
--	---