



EXLENE Gamecube Controller Switch User Manual

[Home](#) » [EXLENE](#) » EXLENE Gamecube Controller Switch User Manual 

Contents

- [1 EXLENE Gamecube Controller Switch](#)
- [2 Product Information](#)
- [3 Basic Setting](#)
- [4 FCC](#)
- [5 Documents / Resources](#)
 - [5.1 References](#)

EXLENE™

EXLENE Gamecube Controller Switch



Product Information

The Exlene Gamecube Controller Switch is an upgraded version (V1.0) released on November 18, 2021. It is a versatile controller that can be used wirelessly via Bluetooth or with a USB connection. The controller is compatible with the Nintendo Switch, PC, and Android devices. It features a Bluetooth pairing mode, receiver mode, back-connect mode, automatic hibernation, charging indication, and USB wired mode.

Bluetooth Pairing Mode

To enter the Bluetooth pairing mode, short press the HOME button. When the controller is in shutdown status, long press the HOME button for 3 seconds to enter the Bluetooth pairing mode. The light will flash during pairing. If pairing is unsuccessful, the controller will go into sleep mode after 2 minutes. The controller automatically identifies the Switch host, and the light stays on continuously after a successful connection. In Bluetooth mode, the controller can be connected to a Switch or PC. The operation is the same for both platforms. Stream and body feeling functions are available for use.

Android Mode:

To enter Bluetooth pairing mode in Android mode, press and hold the A button and HOME button simultaneously. Two lights will flash during pairing, and after a successful connection, one light will stay on continuously.

IOS Mode:

To enter Bluetooth pairing mode in IOS mode, press and hold the Y button and HOME button simultaneously. Three lights will flash during pairing, and after a successful connection, all three lights will stay on continuously. Please note that XOBX protocol needs to be used in IOS mode.

After successfully connecting in any Bluetooth mode (including back-to-connect), the controller will have a short vibration to indicate successful connection.

Receiver Mode:

To enter the receiver pairing mode, press and hold the HOME button for 3 seconds. The light will blink during pairing. The controller automatically recognizes Android, Switch Pro, and PC when connected. One light will stay on when connected, and the controller will have a short vibration. The receiver LED flashes when connected and stays on when the controller is connected.

To enter the receiver Xinput mode, the light will flash. After a successful connection, all four lights will stay on, and the controller will have a short vibration. You can switch between X-INPUT and D-INPUT mode by simultaneously long pressing the '+' key and '-' key for 3 seconds. The switch is successful when the four lights flash two lights, and the controller has a short vibration.

Back-connect Mode:

If the SWITCH host is in sleep mode (not in flight mode), a short press on the HOME button will wake up the host and automatically connect to its paired host. The LED will slow flash during this process. If reconnection is unsuccessful after 1 minute, the controller will automatically sleep. Note that other keys do not wake up the controller in this mode.

Automatic Hibernation:

When the Switch host's screen is off, the controller will automatically hibernate. If no button is pressed within 5 minutes, it will automatically sleep, including when the sensor does not move. The hibernation time can be adjusted according to demand. To shut down the controller, long press the HOME button for 5 seconds. This will disconnect it from the host and put it into hibernation. The hibernation time can also be adjusted according to

demand.

Charging Indication:

When the controller is off, the corresponding power light will flash while charging. The indicator light will turn off when the controller is fully charged. When the controller is on, the current channel indicator will flash while charging, and the current indicator will stay on continuously when fully charged. If the battery voltage is low, the current channel will flash rapidly. The voltage can be adjusted according to demand.

USB Wired Mode:

The controller automatically recognizes the Switch, PC, and Android platform in USB wired mode. By default, the PC platform is identified as X-INPUT mode. You can switch between X-INPUT and D-INPUT mode by simultaneously long pressing the '+' key and '-' key for 3 seconds. The controller will vibrate when connected.

Bluetooth Pairing Mode

- Short press the HOME button connect. In shutdown status, long press the HOME button for 3 seconds to enter the Bluetooth pairing mode, the light flashes; If pairing unsuccessful, it go to sleep mode in 2 minutes.
- Automatic identification of Switch host, the light is always on after successful connection (with 4 channel lights)
- Bluetooth mode can be connected to Switch or PC, the operation is same. Stream is available to use, body feeling is available to use.
- Android mode: "A" button + Home button, enter Bluetooth pairing mode, 2 lights flashing, after successful connection, the light is always on;
 - **IOS mode:** "Y" button + Home button, enter Bluetooth pairing mode, 3 lights flashing, after successful connection, the light is always on; (Note need to use XOBX protocol)
 - **Note:** After all Bluetooth modes are successfully connected (including back-to-connect), the controller has a short vibrate, indicating successful connection

Receiver Mode

- Press and hold the HOME button for 3 seconds to enter the receiver pairing (light blinking). Automatically recognizes Android, Switch Pro, and PC when connected, the 1 light will be on and the controller has a short vibrate at the same time;
- The receiver LED flashes when connected and is always on when the controller is connected.
- Enter the receiver Xinput mode, the light flashes, after successful connection, 4 lights are always on, and the controller has a short vibrate at the same time;
- You can simultaneously long press the '+' key '-' key for 3 seconds to switch between X-INPUT and D-INPUT mode, (X/Dinput conversion when the 4 lights flash 2 lights), switch successfully after the controller has a short vibration;

Back-connect Mode

If the SWITCH host is in sleep (not in flight mode), a short press on the HOME button will wake up the host, and automatically connect to its paired host (slow flashing LED), after 1 minute of unsuccessful reconnection, it will automatically sleep. (Other keys do not wake up the controller.)

Automatic hibernation

- When Switch host screen off, the controller will automatically hibernate.
- If no button is pressed within 5 minutes, it will automatically sleep (including the sensor does not move). (Time can be adjusted according to demand)
- Long press the HOME button for 5 seconds to shut down, disconnect from the host, the controller will hibernate. (Time can be adjusted according to demand)

Charging indication

- **Controller is off:** the corresponding power light flashes when charging, the indicator light is off when fully charged;
- **Controller is on:** the current channel indicator flashes when charging, the current indicator is always on when fully charged.
- **Battery low voltage alarm:** current channel flashing fast.

Low voltage alarm

If the lithium battery voltage is lower than $3.55V \pm 0.1V$, the red light flashes fast to indicate low voltage; (voltage can be adjusted according to demand) If the lithium battery voltage is lower than $3.45V \pm 0.1V$, it will automatically sleep; (voltage can be adjusted according to demand)

USB Wired Mode

Automatic recognition of Switch, PC, Android platform. PC platform automatically identified as X INPUT mode by default, you can simultaneously long press the '+' key '-' key for 3 seconds to switch between X INPUT and D INPUT mode, connected to the handle vibration; Automatic recognition of Switch and Android platforms, the controller has a short vibration.

Controller hardware reset

Hardware reset button is at the back of the controller.

Turbo and AUTO TURBO

Any mode Press (for the first time) A/B/X/Y/L1/L2/L3/R1/R2/R3 (any button of those) + Turbo button to set the Turbo function, the controller has a short vibration; Again (for the second time) press the A/B/X/Y/L1/L2/L3/R1/R2/R3 (Any button of those) + TURBO button to achieve AUTO TURBO function, the controller has a short vibration; (For example, A button has been chosen to set AUTO TURBO function, you need to press the A button again to open AUTO TURBO, and then press the A key to close AUTO TURBO); Press (for the third time) the A/B/X/Y/L1/L2/L3/R1/R2/R3 (Any button of those) the Turbo button to clear the Turbo function of the single button you chose.

Turbo speed is 12 times/sec;

- Press and hold the Turbo button for more than 3S and then press the minus key to clear the Turbo function for all buttons, and the LED will resume the current mode indicator;
- Adjustment: (Press and hold turbo, use the right stick (up and down) to control adjustment, three gears are 20 times / second, 12 times / second, 5 times / second;
- Default speed is 12 times / second. It records user's last adjustment.

Vibration Adjustment

Combination operation: firstly press and hold the TURBO key, then press the plus key (+) for increase, minus

key (-)for decrease (20% 40% 70% 100% 0%) Default value is 70% 70%. It record s user's last adjustment
Corresponding intensity will vibrate differently when adjust the vibration.

Basic Setting

How to connect with Switch/Switch Lite console?



Just simply go into the “Controller” menu on your Nintendo Switch/Switch Lite



Go to the “Change Grip/Order” sub menu



Hold down the Home button on the controller till the below blue light flash.



Press L + R button



Press A button when you are ready.



Connected!

How to wake up the switch?



hold down the Home button to wake the Nintendo Switch from sleep mode, the controller immediately registers as controller number one.

How to set Turbo and Auto Turbo function?

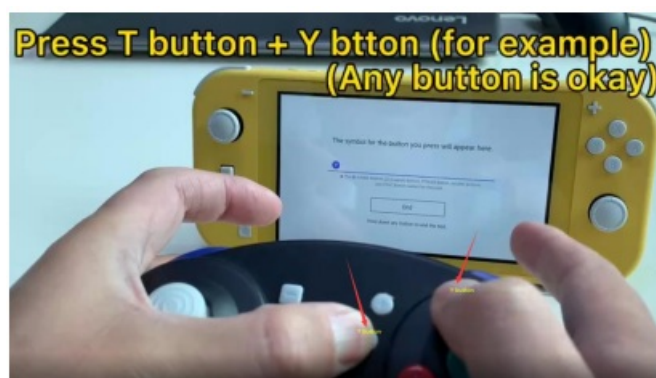

Hold "Turbo" down and press any button (A/B/X/Y/L/R/ZL/ to make that button become a "Turbo" version of the button in question that repeatedly presses over and over again when you hold it down.



Enter Turbo function.



Do it again to make the button an "always on" Turbo button



Enter Auto Turbo.



Do it a third time to return the button's function to normal.

How to adjust vibration?



Press "Turbo" and "-" to decrease



Press "Turbo" and "+" to increase

How to pair it with your mobile device?

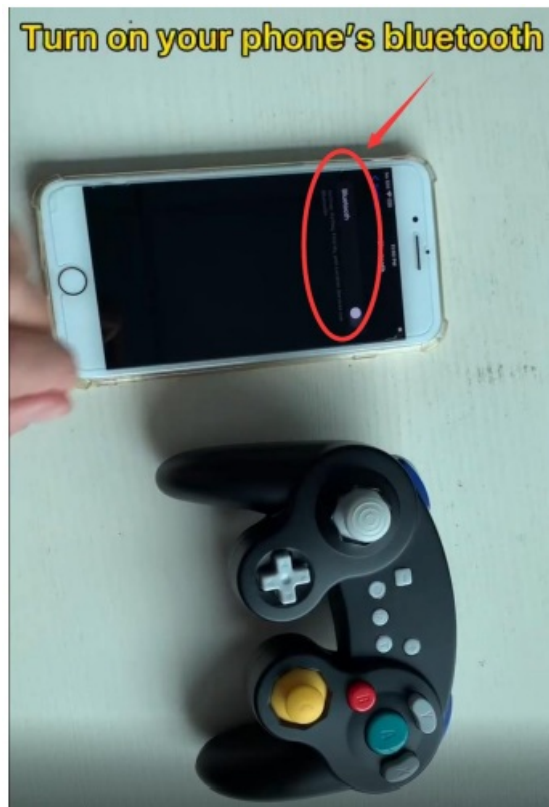

Turn on your mobile's Bluetooth



you must either hold A (for Android) or Y (for iOS) while you briefly hold down the Home button while your mobile device is in pairing mode.



Choose "Xbox wireless controller" to connect.



How to swap the A/B/X/Y buttons?

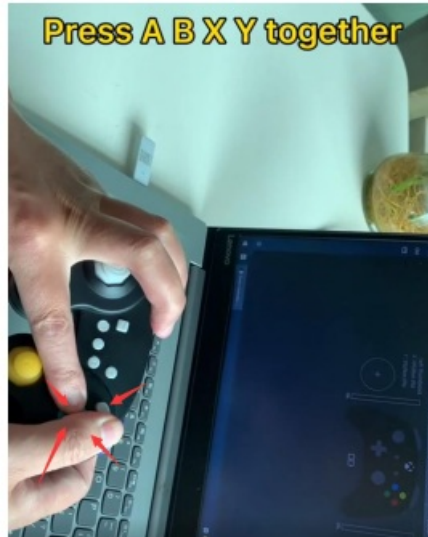

Please hold down A, X, B, Y together to swap the buttons' bindings with the placement typical of Xbox controllers

(optional) How to pair it with your Windows 7, 8, 9, 10, or Windows XP PC? (if you want to use Bluetooth adapter, you can buy it in our website

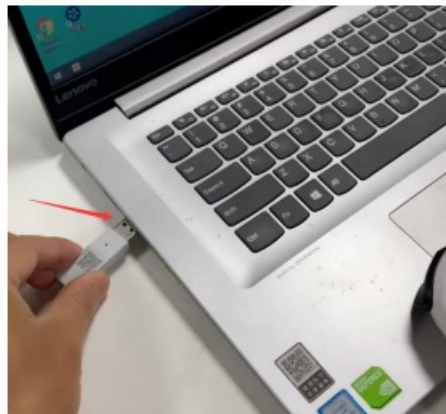

the bluetooth dongle is plugged into the PC.

Press the pairing button on the dongle before holding down the Home button on your controller

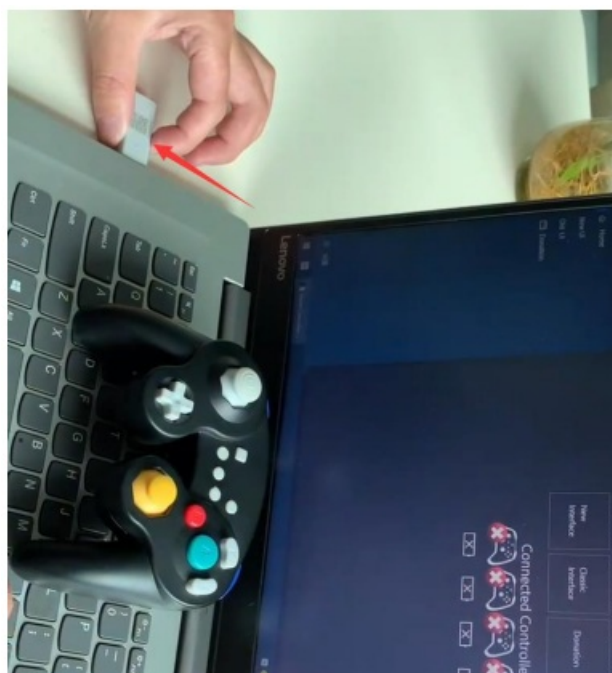

The pairing button on the dongle is on (blue) , the indicator on the controller is on (blueblue), successfully connected with PC.

For videos watching, please check with our youtube channel “Wilson Wang”, or go to Exlene official website: <https://exlene.com/blogs/news/exlene-wireless-gamecube-controller-for-switch-pc-official-gbatemp-review>

Contact email: service@exlene.com;
support@exlene.com

FCC

FCC Caution.

(1) 15.19 Labelling requirements.

This device complies with part 15 of the FCC Rules. Operation is subject to the following two conditions:

(1) This device may not cause harmful interference, and (2) this device must accept any interference received, including interference that may cause undesired operation.

15.21 Changes or modification warning

Any Changes or modifications not expressly approved by the party responsible for compliance could void the user's authority to operate the equipment.

§ 15.105 Information to the user.

Note: This equipment has been tested and found to comply with the limits for a Class B digital device, pursuant to part 15 of the FCC Rules. These limits are designed to provide reasonable protection against harmful interference in a residential installation. This equipment generates uses and can radiate radio frequency energy and, if not installed and used in accordance with the instructions, may cause harmful interference to radio communications. However, there is no guarantee that interference will not occur in a particular installation. If this equipment does cause harmful interference to radio or television reception, which can be determined by turning the equipment off and on, the user is encouraged to try to correct the interference by one or more of the following measures:

- Reorient or relocate the receiving antenna.
- Increase the separation between the equipment and receiver.
- Connect the equipment into an outlet on a circuit different from that to which the receiver is connected.
- Consult the dealer or an experienced radio/TV technician for help.

RF warning for Portable device:

The device has been evaluated to meet general RF exposure requirement. The device can be used in portable exposure condition without restriction.

According to §15.247(e)(i) and §1.1307(b)(1), systems operating under the provisions of this section shall be operated in a manner that ensures that the public is not exposed to radio frequency energy level in excess of the Commission's guidelines.

According to KDB 447498 (2)(a)(i)

Documents / Resources

	<p>EXLENE Gamecube Controller Switch [pdf] User Manual EX-GC 2A9OW, EX-GC 2A9OWEXGC, ex gc, Gamecube Controller Switch, Gamecube, Controller Switch, Switch, Gamecube Controller</p>
---	--

References

- [EXLENE Wireless Gamecube Controller for Switch/PC: Official GBAtemp Re – EXLENE offical store](#)

Manuals+.