

[Skip to content](#)

Manuals+

User Manuals Simplified.

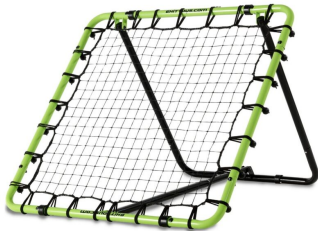

EXIT TEMPO 1000 Rebounder User Manual

[Home](#) » [EXIT](#) » EXIT TEMPO 1000 Rebounder User Manual 

EXIT TEMPO 1000 Rebounder User Manual

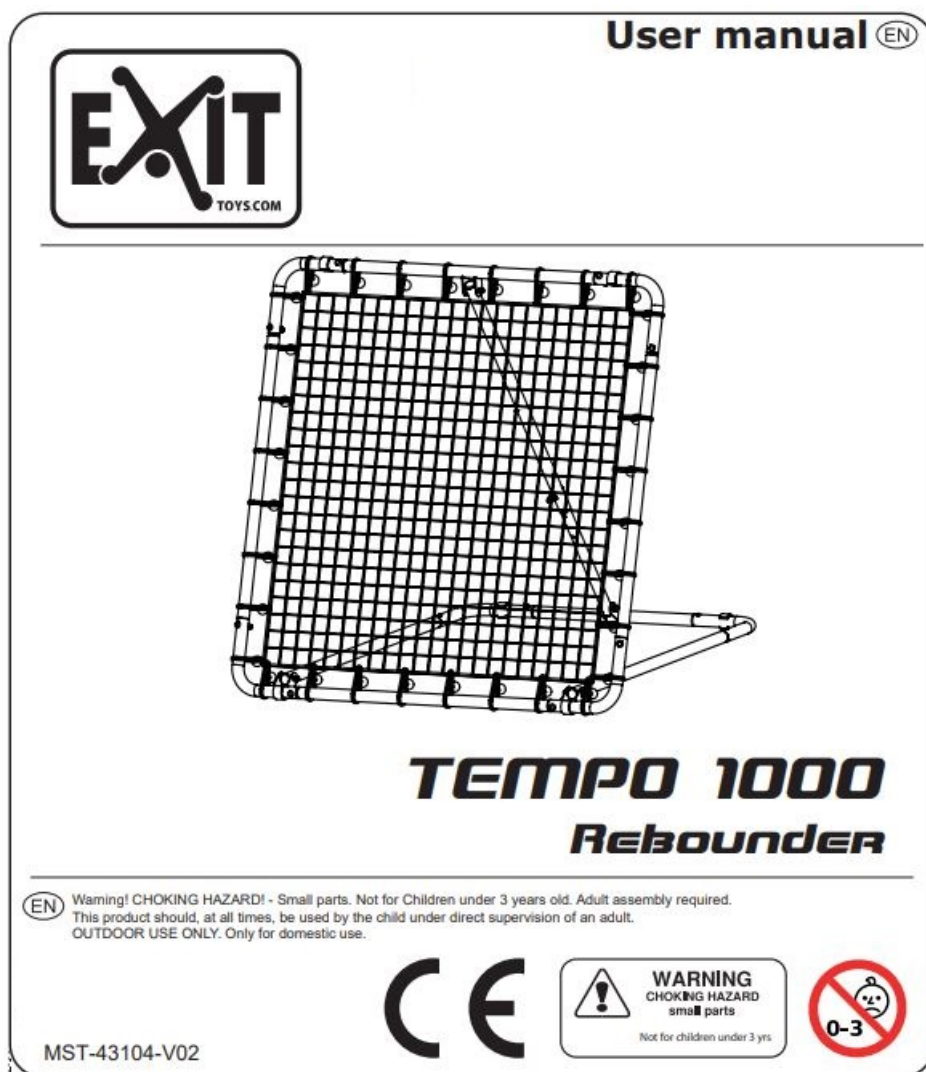

Technical specifications

Product name : EXIT TEMPO Rebounder 1000

Age range : 3+ years

Weight : 10,3 KG / 23 lbs

Dimensions : 1000 x 1000 x 870 mm

Contents

[1 1.0 Introduction](#)

[2 2.0 Warnings for safe use:](#)

- [3 3.0 Assembly and Installation Instructions](#)
- [4 4.0 Care and Maintenance Instructions](#)
- [5 5.0 Guarantee Conditions & Service](#)
- [6 Documents / Resources](#)
- [7 Related Posts](#)

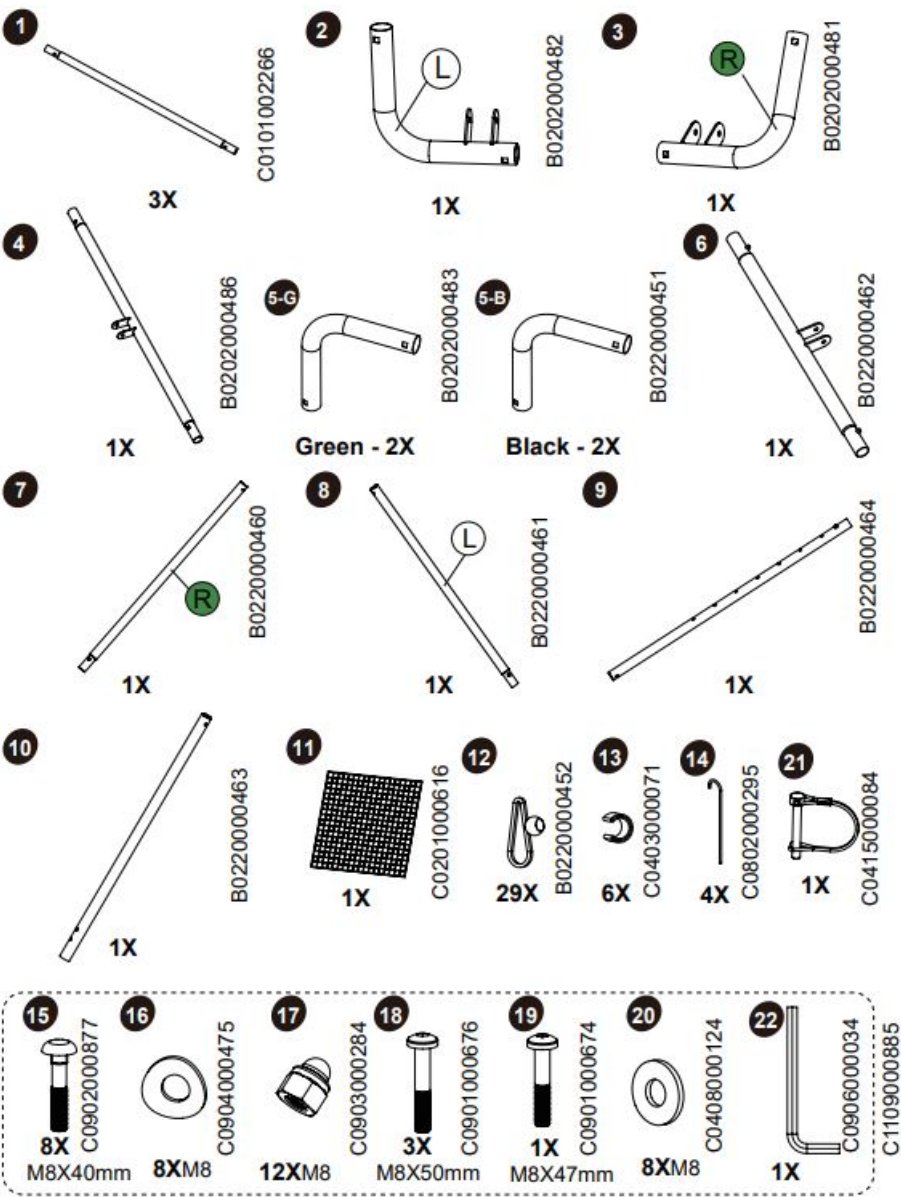

1

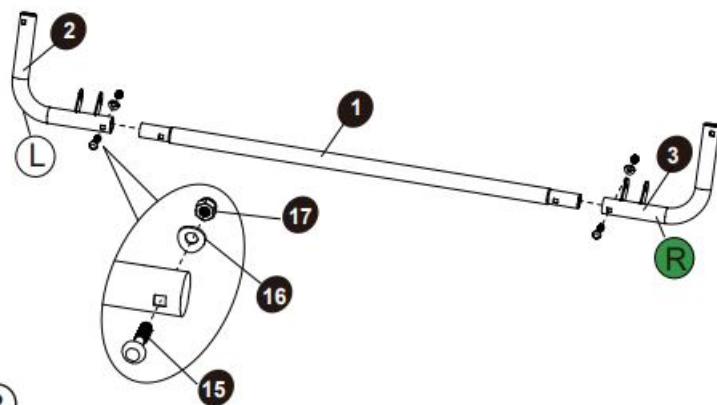

2

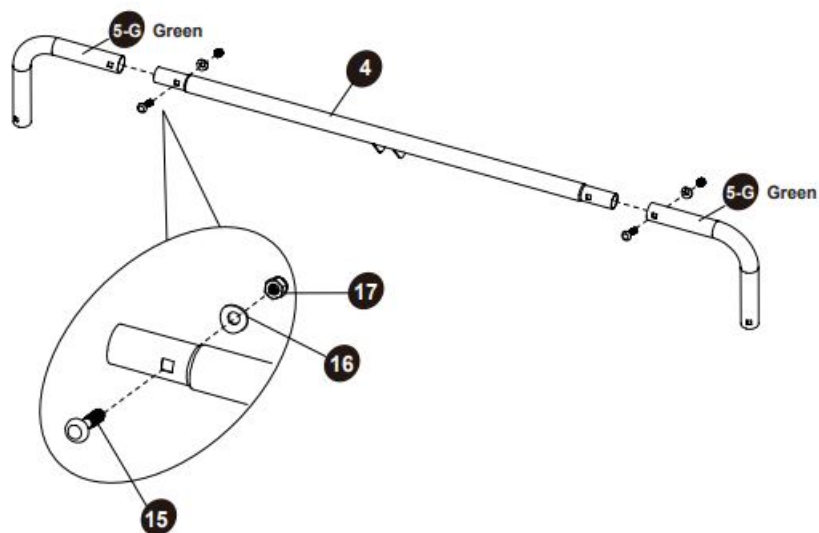

3

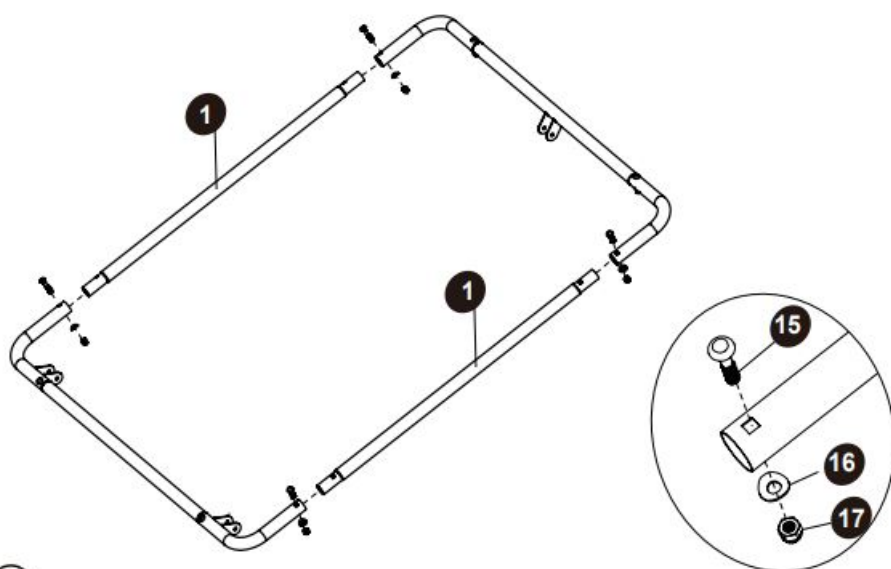

4

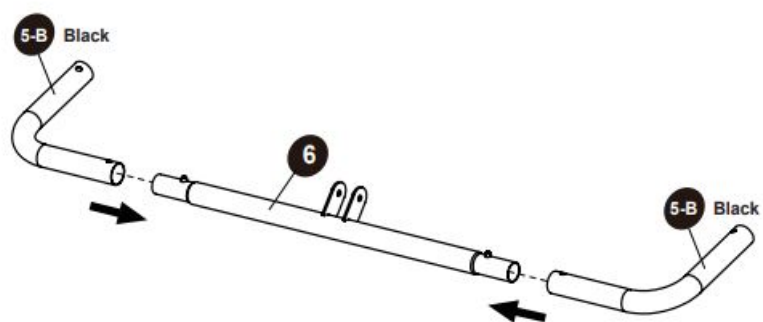

5

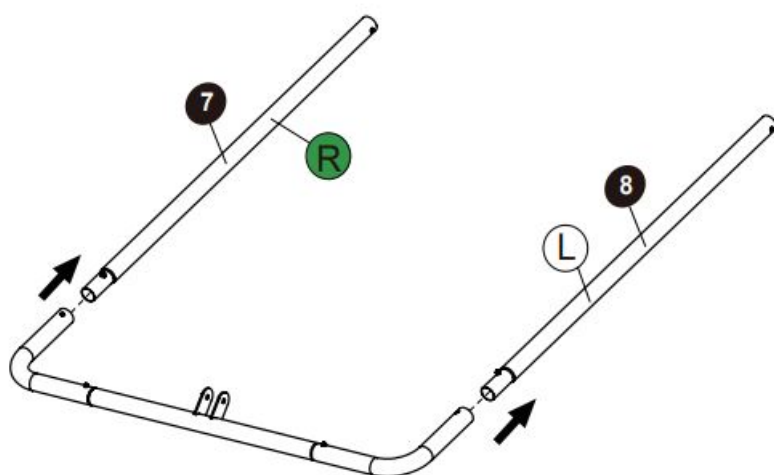

6

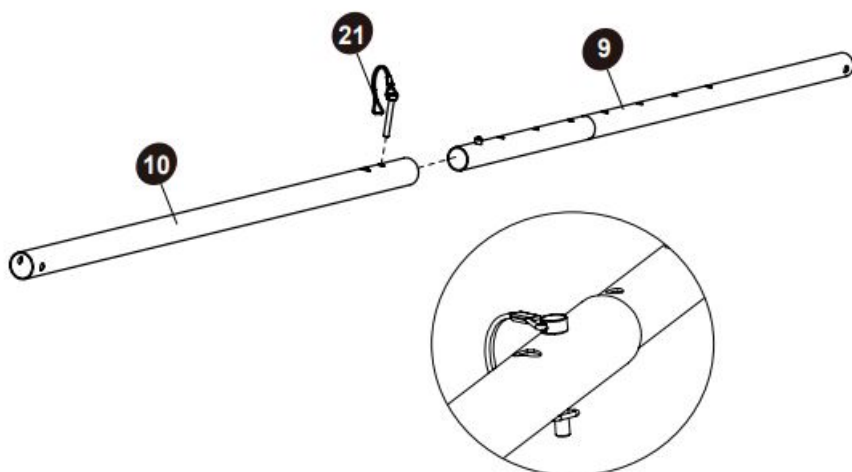

7

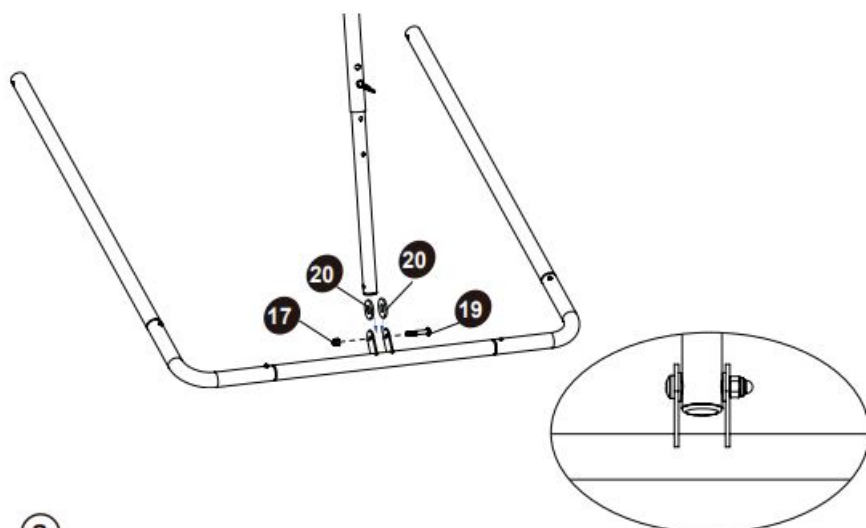

8

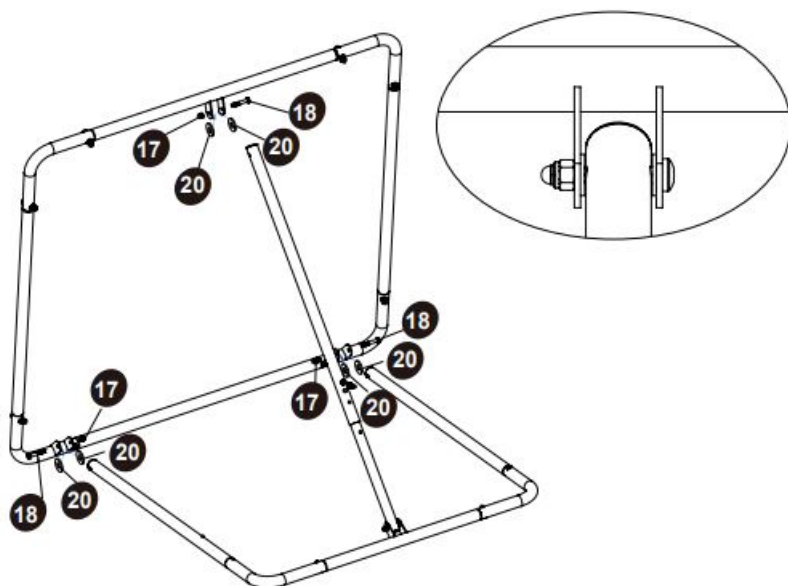

9

8X

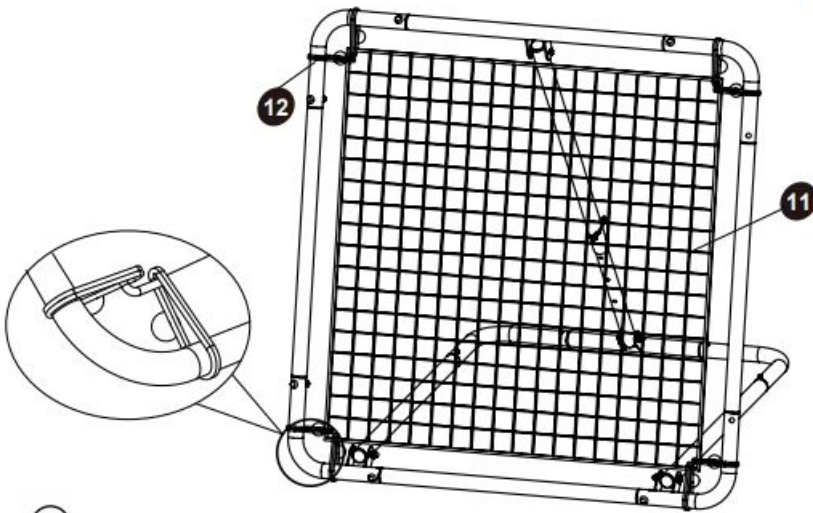

10

21X

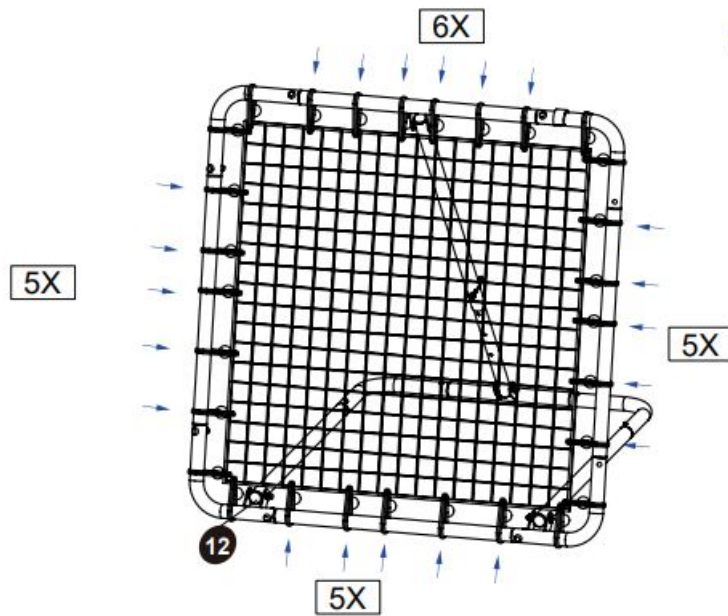

11

6X

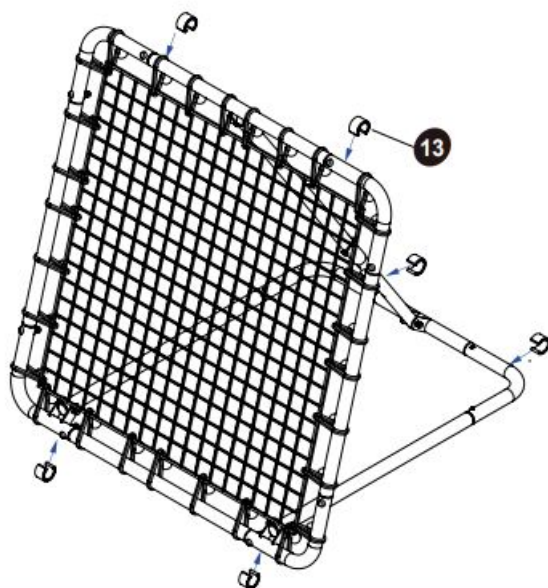

12

4X

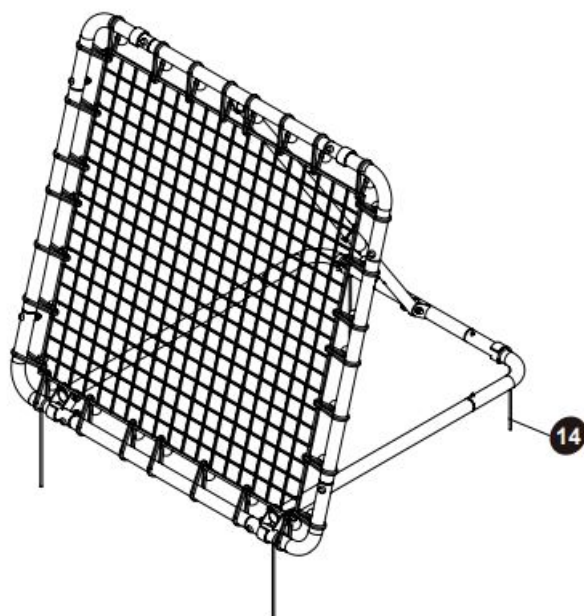

1.0 Introduction

Congratulations on choosing the EXIT Tempo rebounder!

Have fun, be active and play outdoors.....

That's what keeps driving us to develop innovative, quality toys for cool kids.

We do everything possible to develop safe products for children. As our products are classed as toys, we comply with the toughest consumer safety regulations. Before launching our products onto the market, we have independent tests carried out for certification. We also continuously test our production runs and periodically have independent tests performed again as a further check. Only products which live up to the highest EXIT Toys standard are marked with and recognized by the EXIT-brand. your kids will have as much fun as we did during development. Being openminded, we really appreciate all comments and ideas which will help us improve our products or develop new ones. You are invited to send your ideas to us at info@exittoys.com

Please visit www.exittoys.com and discover more cool new products.

The EXIT Toys team

2.0 Warnings for safe use:

To simplify the assembly, please read the following instructions before beginning. It will be helpful to have an additional person assist in the assembly process.

Keep this manual for future reference.

- Adult supervision is required at all times when Rebounder is used by children.
- To reduce risk of entanglement, keep small children away from net area at all times.
- When properly assembled and used as intended, this rebounder is designed to Provide many hours of playing enjoyment.
- Never let children climb, hang or swing on rebounder as this can result in rebounder falling over causing serious injury or death.
- The metal frame of the rebounder will conduct electricity. Lights, extension cords, and all such electrical equipment must never be allowed to come in contact with the rebounder.
- Inspect the rebounder before each use. Make sure the strips and all parts are correctly and securely positioned and attached. Tighten any loose hardware. Replace any worn, defective, or missing parts.
- Wear comfortable clothing free of hooks, snaps, drawstrings or anything which may snag or catch in the rebounder mesh. Remove jewellery, necklaces, and earrings.
- Read all instructions and complete all assembly before using.
- Ensure that this rebounder is secured at all times by means of the appropriate anchoring system for its intended use and when not in use (storage)
essential safety of the rebounder

⚠ WARNING

ALWAYS ANCHOR REBOUNDER

Unsecured Rebounder can fall over causing serious injury or death

3.0 Assembly and Installation Instructions

- Adequate overhead clearance is essential. Provide clearance for wires, tree limbs, and other possible hazards.
- Lateral clearance is essential. Place the Rebounder away from walls, structures, fences, and other play areas. Maintain a clear space on all sides of the rebounder. A minimum of 3 meter from frame edge is recommended.
- The rebounder is heavy, two able-bodied adults are required to set it up.
- Never set-up the rebounder in heavy rain, wind or storm conditions, especially storms. It is recommended that the rebounder be taken apart and stored.
- When moving the assembled rebounder, have at least two people evenly the · Place the rebounder on a level surface before use. · Secure the rebounder against unauthorized and unsupervised use.

4.0 Care and Maintenance Instructions

Inspect the rebounder before each use and replace any worn, defective, or missing parts. The following conditions could present potential hazards:

1. Missing, improperly positioned, or insecurely attached frame padding, barrier or enclosure
2. Punctures, frays, tears, or holes worn in the rebounder mesh.
3. A bent or broken frame.
4. Sharp protrusions on the frame or suspension.
5. Loosened or missing hardware, system

5.0 Guarantee Conditions & Service

The owner of this product has the following guarantees on the product:

- 2 years from date of purchase on the frame (regular use).
- A 6-month guarantee is given on the other parts (regular use).
- The guarantee only applies for material/construction errors of the product and/or parts thereof. The guarantee is not applicable and/or is invalidated in the following cases:
 - The rebounder has been handled without due care, has been involved in an
 - The product has not been assembled as per instructions or has not been correctly maintained.
 - The rebounder is used for professional purposes (hire, schools, etc.).
 - Technical repairs to the product were not carried out professionally.
 - Replacement of parts were not carried out on time.

The owner of the product can only claim a guarantee by presenting the original bill for the purchase to EXIT Toys or the dealer from whom the product was bought.

If the claim under the guarantee is refused, then all costs incurred must be paid By the owner.

Guarantee is not transferable to third parties.

Dutch Toys Group P.O. Box 369, 7000 AJ, Doetinchem Edisonstraat 83, 7006 RB, Doetinchem the Netherlands

info@exittoys.com

www.exittoys.com

EXIT is a registered trade mark of Dutch Toys Group

Documents / Resources

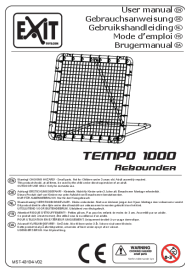

[EXIT TEMPO 1000 Rebounder](#) [pdf] User Manual
TEMPO 1000 Rebounder, TEMPO 1000, Rebounder

[Manuals+](#),