



EXIT MSP-30111-V02 Pool Ladder User Manual

[Home](#) » [EXIT](#) » EXIT MSP-30111-V02 Pool Ladder User Manual 

Contents

- [1 EXIT MSP-30111-V02 Pool Ladder](#)
- [2 Specifications](#)
- [3 Part reference](#)
- [4 INSTALLATION](#)
- [5 Introduction](#)
- [6 Care and usage](#)
- [7 Limited warranty](#)
- [8 Frequently Asked Questions](#)
- [9 Documents / Resources](#)
 - [9.1 References](#)



EXIT MSP-30111-V02 Pool Ladder



Specifications

- **Product Name:** Pool Ladder
- **Dimensions:** 42.9in (109 cm)
- **Model Number:** MSP-30111-V02

Guidelines for Safe Use

Failure to follow these guidelines may result in serious injuries:

- Always ensure that the ladder is securely attached to the pool edge before use.
- Do not exceed the maximum weight capacity specified for the ladder.
- Keep the ladder area clear of any obstacles or debris.
- Do not use the ladder if it is damaged or unstable.
- Children should always be supervised when using the ladder.

Important safety rules: Before installing and using this product read, understand, follow all instructions carefully and keep it for future reference!

Part reference

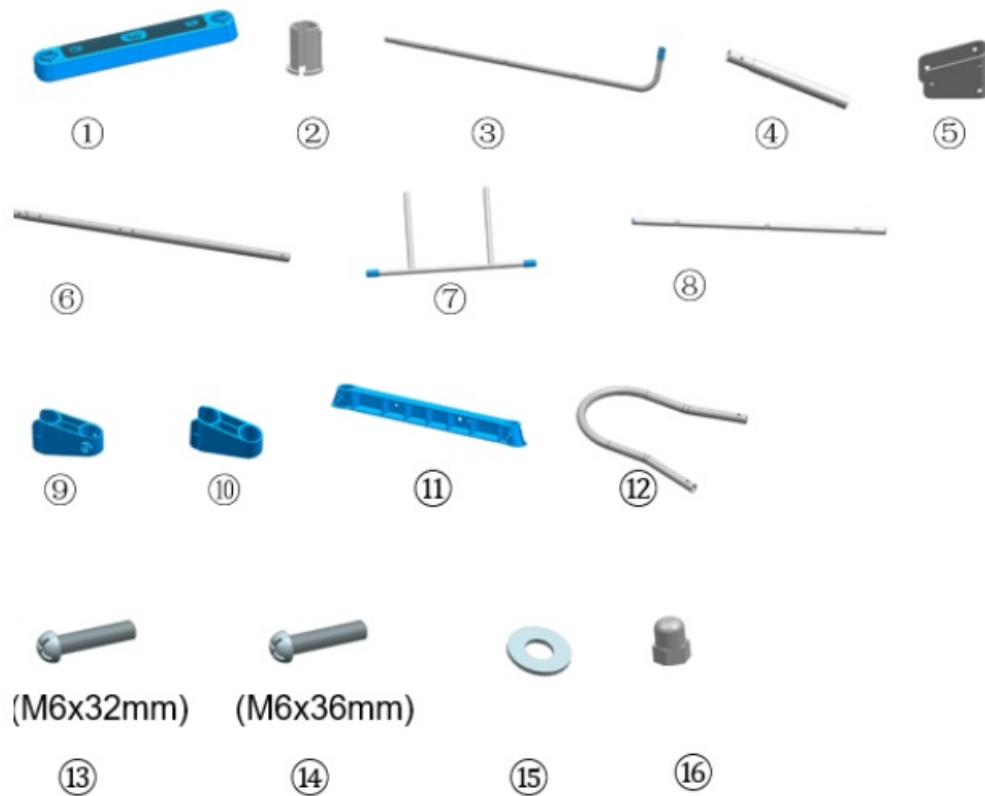

NOTE: Drawing for illustration purposes only. Actual products may vary. Not to scale. Before assembling your p, layout and review the contents to become familiar with all the parts you will be using during the assembly:

Part	Item no.	#
1	395238	6
2	395239	12
3	395240	2
4	395241	2
5	395242	2
6	395243	2
7	395244	1
8	395245	2
9	395246	2
10	395247	2
11	395248	1
12	395249	2
13	395250	8
14	395251	12
15	395252	40
16	395253	20

INSTALLATION

1.

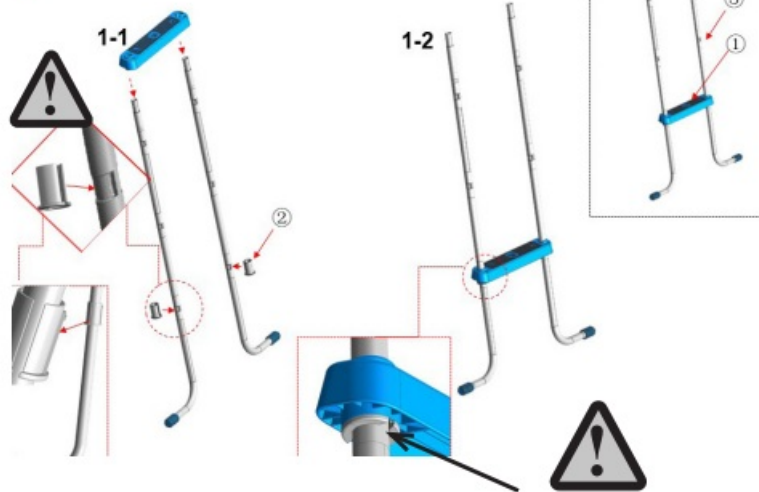

2.

2-1

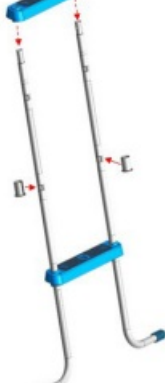

2-2

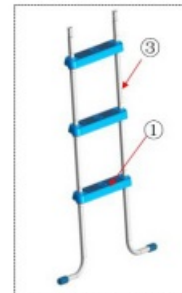

3.

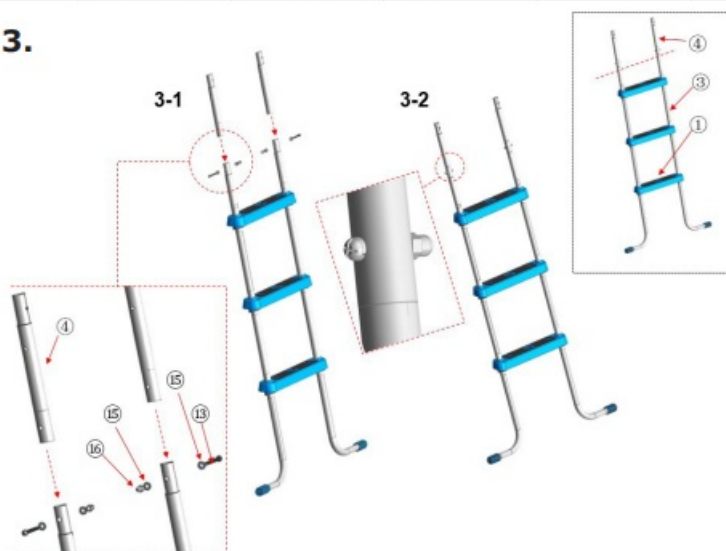

4.

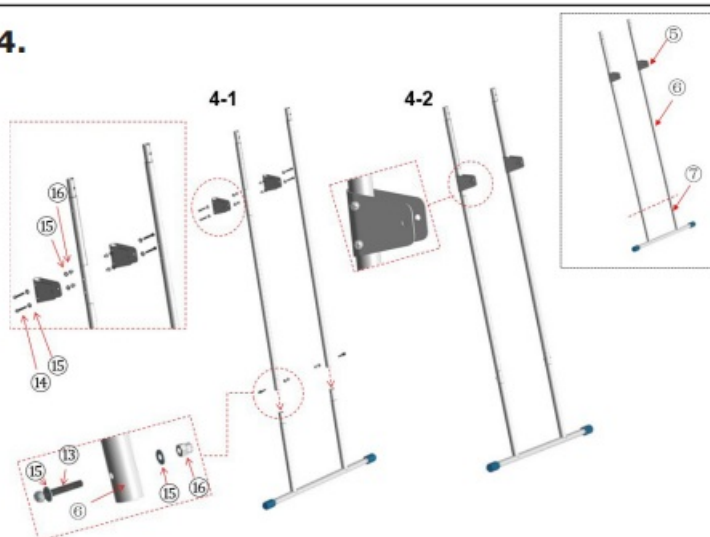

5.

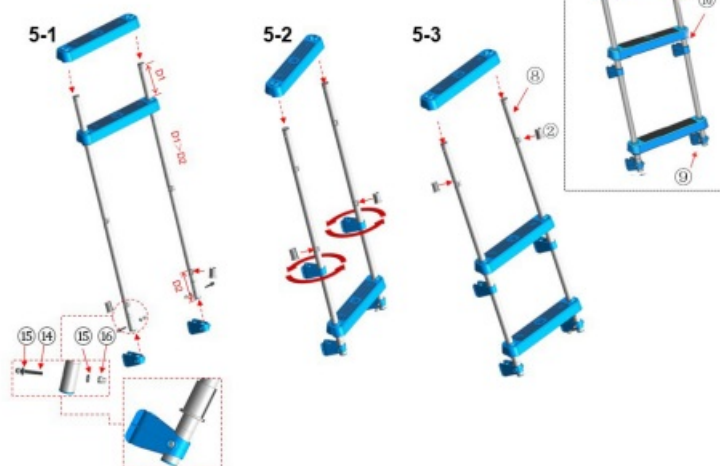

6.

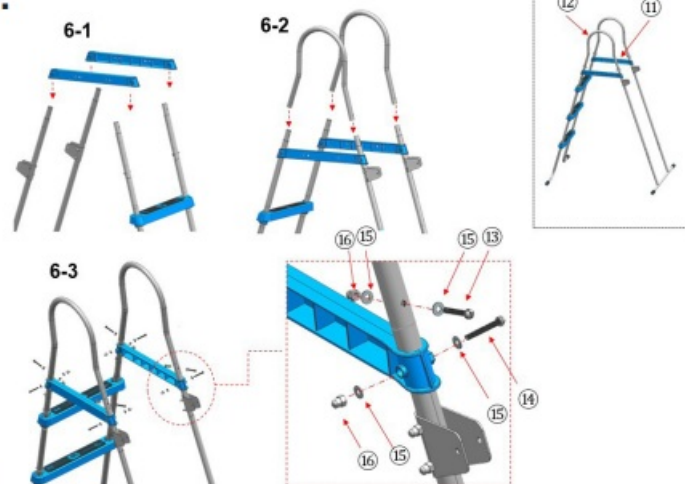

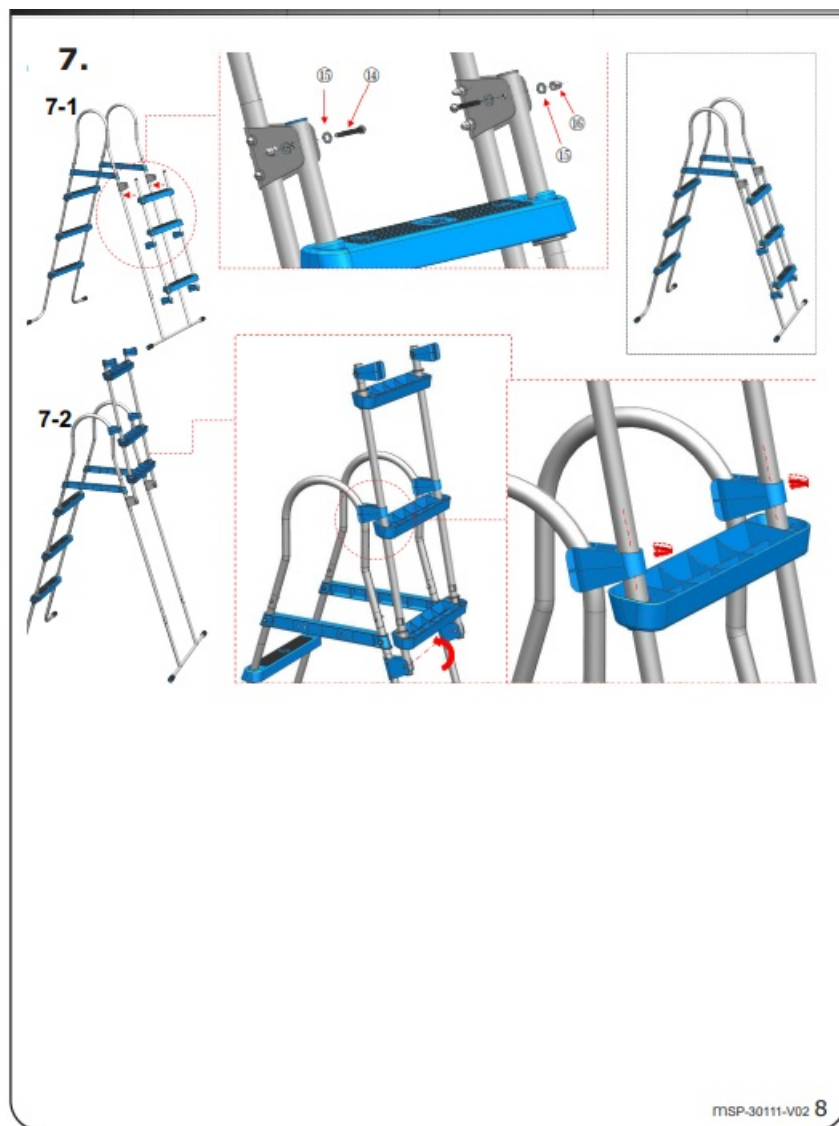

Introduction

Congratulations on choosing an EXIT Toys Pool Ladder!

Have fun, be active and play outdoors.....

- That's what keeps driving us to develop innovative, quality toys for cool kids and parents.
- We do everything possible to develop safe products for children. As our products are classed as toys, we comply with the toughest consumer safety regulations. Before launching our products onto the market, we have independent tests carried out for certification. We also continuously test our production runs and periodically have independent tests performed again as a further check. Only products that live up to the highest EXIT Toys standard are marked with and recognized by the EXIT-brand.
- We want to thank you for your custom and your confidence in this product. We're sure your kids will have as much fun as we did during development. Being open-minded, we appreciate all comments and ideas that will help us improve our products or develop new ones. You are invited to send your ideas to us at info@exittoys.com
- Please visit www.exittoys.com and discover more cool new products.

The EXIT Toys team

WARNING: Failure to follow these warnings may result in broken bones, entrapment, paralysis, drowning or other serious injuries.

1. Supervise children and those with disabilities at all times.
2. Always assist children when they use the ladder to avoid falls and/or serious injury.
3. Never dive or jump from this ladder.
4. Locate the ladder on a level, solid base.
5. One person on this ladder at a time.
6. Maximum load: 300 lbs (136 kg). Complies with EN16582 strength requirements.
7. Face the ladder at all times for entry/exit of the pool.
8. Remove and secure the ladder when the pool is not occupied.
9. Do not swim under, through or behind a ladder.
10. Check all nuts and bolts regularly to ensure the ladder stays sturdy.
11. If swimming at night use artificial lighting to illuminate all safety signs, ladders, pool floor and walkways.
12. Assembly and disassembly by adults only.
13. This ladder is designed and manufactured for a specific pool wall height and/or deck of the pool. Do not use it with other pools.
14. Failure to follow the maintenance instructions and warnings may result in adverse health effects or injury, particularly to children.
15. Only use this ladder for the purposes described in this manual.

These product warnings, instructions and safety rules provided with the product represent some common risks of water recreation devices and do not cover all instances of risk and danger. Please use common sense and good judgment when enjoying any water activity.

Care and usage

1. Store the ladder in a safe and dry place.
2. Never store any materials on the ladder.
3. Keep the ladder clean and free of all foreign materials.
4. Do periodic maintenance on screws, when the ladder is not in use, put some anti-rust oil on them.
5. Do not use the ladder in the temperature below -5°C
6. Recommend removing the pool ladder from the swimming pool during the off-season (winter months).
7. Disassemble all the components and dry thoroughly.
8. Store in a dry location out of children's reach

Limited warranty

- We warrant all components contained in this Pool ladder against defects in materials and workmanship under normal use and service, for 90 days from the date of purchase for the original owner only.
- If any of the components have been consumer-replaced, damaged, or misused, the corresponding warranty on those components is invalidated. In this situation, you will be advised of the cost of replacement parts and processing instructions.
- If a verifiable manufacturing defect is found during the relevant period, we agree to replace at its option any product under warranty provided proper proof of purchase is presented.

- This limited warranty is not valid if the product is used for commercial purposes, or if the damage is caused by an accident, consumer misuse, neglect or abuse, vandalism, improper use of chemicals, exposure to extreme weather conditions or negligence during product set up or disassembly.
- We cannot be held responsible for the cost of installation, labour, or transportation expenses incurred due to the replacement of defective parts. This limited warranty, furthermore, does not cover any unauthorized alterations to the product.

Frequently Asked Questions

- **Q: What is the maximum weight capacity of the pool ladder?**
 - A: The maximum weight capacity of the pool ladder is not specified in the user manual. It is recommended to contact the manufacturer for this information.
 - **Q: Can the pool ladder be used for above-ground pools?**
 - A: The user manual does not specify if the pool ladder is suitable for above-ground pools. It is recommended to contact the manufacturer for clarification.
 - **Q: How should I clean the pool ladder?**
 - A: The user manual suggests cleaning the ladder with mild soap and water to remove dirt and debris.
-

Documents / Resources

 <p>The image shows the cover of the EXIT Pool Ladder User Manual. It features the EXIT logo at the top left, followed by the text 'User manual', 'Gebrauchsanleitung', and 'Mode d'emploi'. Below this is 'POOL LADDER' and '105 CM'. A small illustration of the ladder is shown. At the bottom, there is a warning section with text in multiple languages.</p>	<p>EXIT MSP-30111-V02 Pool Ladder [pdf] User Manual MSP-30111-V02 Pool Ladder, MSP-30111-V02, Pool Ladder, Ladder</p>
---	---

References

-  [SHANGHAI JILONG SPORT AND LEISURE PRODUCTS CO., LTD-redirect](#)
- [User Manual](#)